

**LEGEND**

|                                 |                                 |
|---------------------------------|---------------------------------|
| CONCRETE BARRIER CURB           | LIMIT OF CONSTRUCTION           |
| CONCRETE WALKWAY                | DRAINAGE SWALE                  |
| PROPOSED ASPHALT                | DRAINAGE DITCH                  |
| STORM SEWER MANHOLE             | SLOPING AT 3:1 UNLESS SPECIFIED |
| CATCHBASIN MANHOLE              | SURFACE ELEVATION               |
| AREA DRAIN CATCHBASIN           | SWALE ELEVATION                 |
| CATCHBASIN                      | TOP OF WALL ELEVATION           |
| AREA DRAIN CATCHBASIN           | BOTTOM OF WALL ELEVATION        |
| AREA DRAIN CATCHBASIN           | OVERLAND FLOW ROUTE             |
| AREA DRAIN CATCHBASIN           | SILT FENCE BARRIER              |
| SANITARY SEWER MANHOLE          | STRAW BALE CHECK DAM            |
| FIRE HYDRANT                    | PROPOSED WALL                   |
| WATER VALVE                     |                                 |
| WATER METER                     |                                 |
| REMOTE WATER METER              |                                 |
| ROOF DRAIN                      |                                 |
| LANDSCAPE CATCHBASIN            |                                 |
| LANDSCAPE CATCHBASIN AREA DRAIN |                                 |
| SIAMSESE CONNECTION             |                                 |
| SUBDRAIN                        |                                 |

**FOR REVIEW ONLY**  
NOT FOR CONSTRUCTION

|     |                   |               |
|-----|-------------------|---------------|
| 5   | ISSUED FOR REVIEW | MAR 10, 2022  |
| 4   | ISSUED FOR REVIEW | DEC 10, 2021  |
| 3   | ISSUED FOR REVIEW | NOV 29, 2021  |
| 2   | ISSUED FOR TENDER | NOV 10, 2021  |
| 1   | ISSUED FOR REVIEW | JUNE 30, 2021 |
| No. | Revisions         | Date          |

Check and verify all dimensions before proceeding with the work. Do not scale drawings.

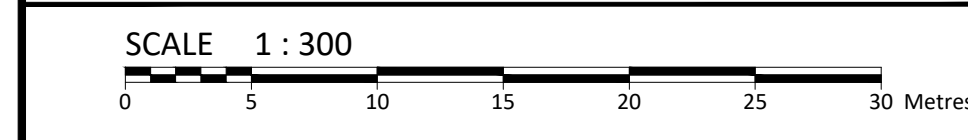

**McINTOSH PERRY**  
115 Walgreen Road, RR3, Carp, ON K0A 1L0  
Tel: 613-836-2184 Fax: 613-836-3742  
www.mcintoshperry.com

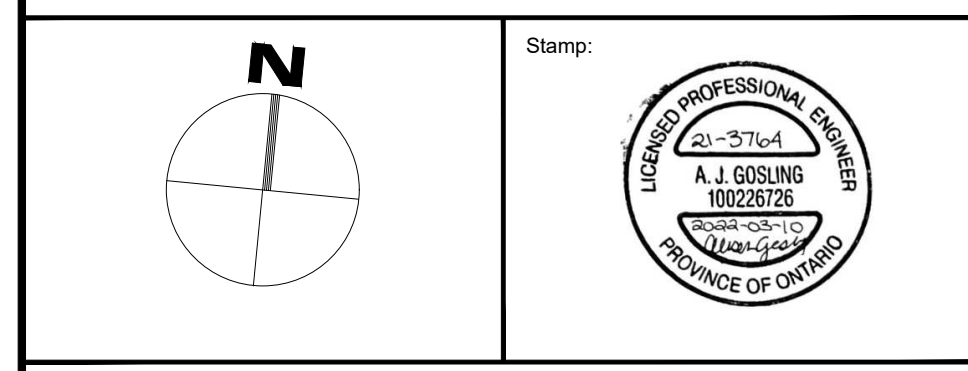

Client: **KANATA WOODS INC**  
205 - 1600 LAPERRIERE AVE  
OTTAWA, ON K1Z 8P5

Project: **THE WOODS**  
180 KANATA AVE

Drawing Title: **SITE SERVICING PLAN**

|                    |                             |
|--------------------|-----------------------------|
| Scale: 1:300       | Project Number: CCO-21-3764 |
| Drawn By: R.R.R.   | Checked By: C.J.M.          |
| Checked By: C.J.M. | Designed By: C.J.M.         |

**SAN STRUCTURE TABLE**

| NAME | RIM ELEV. | INVERT IN | INVERT OUT | DESCRIPTION   |
|------|-----------|-----------|------------|---|
| MH2A | 100.56    | N97.950   | S97.920    | COVER CITY STD S34 FRAME CITY STD S25 STRUC. OPSD 701.010 1200mm DIAMETER |

**Storm STRUCTURE TABLE**

| NAME | RIM ELEV. | INVERT IN | INVERT OUT | DESCRIPTION   |
|------|-----------|-----------|------------|---|
| AD1  | 100.32    |           |            | OPSD 705.010  |
| AD2  | 100.32    |           |            | OPSD 705.010  |
| AD3  | 100.28    |           |            | OPSD 705.010  |
| AD8  | 100.45    |           |            | PER CITY S31 C/W RODENT GRATE AND FILTER SOCK                               |
| AD9  | 100.32    |           |            | OPSD 705.010  |
| AD10 | 100.54    |           |            | PER CITY S31 C/W RODENT GRATE AND FILTER SOCK                               |
| AD11 | 100.21    |           |            | PER CITY S30 C/W RODENT GRATE AND FILTER SOCK                               |
| MH1  | 100.52    | N96.420   | S96.396    | COVER CITY STD S24.1 FRAME CITY STD S25 STRUC. OPSD 701.012 1200mm DIAMETER |
| MH2  | 101.21    | N98.100   |            | COVER CITY STD S24.1 FRAME CITY STD S25 STRUC. OPSD 701.012 1200mm DIAMETER |
| TCB4 | 100.30    | W97.897   | E97.880    | PER CITY S30 C/W RODENT GRATE AND FILTER SOCK                               |
| TCB5 | 100.30    | SW98.150  | E98.110    | PER CITY S30 C/W RODENT GRATE AND FILTER SOCK                               |
| TCB6 | 100.46    | NE98.230  | W98.121    | PER CITY S30 C/W RODENT GRATE AND FILTER SOCK                               |
| TCB7 | 100.30    | E98.040   | S97.780    | PER CITY S30 C/W RODENT GRATE AND FILTER SOCK                               |

**WATER COVER TABLE**

| LOCATION          | STATION  | FINISHED GRADE | TOP OF PIPE | COVER |
|-------------------|----------|----------------|-------------|-------|
| A - 200 X 300 TEE | 0+100.00 | 99.87          | 97.470      | 2.40  |
| BUILDING          | 0+116.72 | 100.400        | 98.000      | 2.40  |
| B - 250 X 150 TEE | 0+200.00 | 100.65         | 98.24       | 2.40  |
| VALVE             | 0+208.01 | 100.45         | 98.21       | 2.40  |
| HYDRANT           | 0+209.06 | 100.60         | 98.59       | 2.40  |
| C - 200 X 300 TEE | 0+100.00 | 99.87          | 97.470      | 3.60  |
| VALVE             | 0+117.05 | 100.400        | 98.000      | 2.40  |
| BUILDING          | 0+120.82 | 100.50         | 98.24       | 2.40  |

**CROSSING CONFLICT TABLE**

| LOCATION | DESCRIPTION                  | SEPARATION |
|----------|------------------------------|------------|
| 1        | 200mm WTR SERVICE OBV 96.42  | 0.45       |
| 2        | 375mm STM SEWER INV 95.97    | 0.46       |
| 3        | 200mm WTR SERVICE OBV 96.42  | 1.31       |
| 4        | 150mm HYDRANT LEAD INV 97.99 | 0.48       |
| 5        | 375mm STM SEWER INV 96.68    | 0.41       |
| 6        | 150mm HYDRANT LEAD INV 98.10 | 0.41       |
| 7        | 200mm WTR SERVICE OBV 96.38  | 4.20       |
| 8        | 200mm WTR SERVICE OBV 96.42  | 4.81       |

- GENERAL NOTES**
- THE ORIGINAL TOPOGRAPHY, GROUND ELEVATION AND SURVEY DATA SHOWN ARE SUPPLIED FOR INFORMATION PURPOSES ONLY, AND IMPLY NO GUARANTEE OF ACCURACY. IT SHALL BE THE RESPONSIBILITY OF THE CONTRACTOR TO VERIFY ALL INFORMATION SHOWN.
  - THIS PLAN IS NOT A CADASTRAL SURVEY SHOWING LEGAL PROPERTY BOUNDARIES AND EASEMENTS. THE PROPERTY BOUNDARIES SHOWN HEREON HAVE BEEN DERIVED FROM INFORMATION SUPPLIED BY (OR SHOWN ON) FARLEY, SMITH & DENIS SURVEYING LTD FILE # 139-21 AND CANNOT BE RELIED UPON TO BE ACCURATE OR COMPLETE. THE PRECISE LOCATION OF THE CURRENT PROPERTY BOUNDARIES AND EASEMENTS CAN ONLY BE DETERMINED BY AN UP-TO-DATE LAND TITLES SEARCH AND A SUBSEQUENT CADASTRAL SURVEY PERFORMED AND CERTIFIED BY AN ONTARIO LAND SURVEYOR.
  - THE CONTRACTOR IS TO OBTAIN AND PAY FOR ALL NECESSARY PERMITS AND APPROVALS FROM THE CITY BEFORE COMMENCING CONSTRUCTION.
  - THE CONTRACTOR IS RESPONSIBLE FOR ALL LAYOUT.
  - THE CONTRACTOR IS TO DETERMINE THE EXACT LOCATION, SIZE, MATERIAL AND ELEVATION OF ALL EXISTING UTILITIES PRIOR TO COMMENCING CONSTRUCTION. PROTECT AND ASSURE ALL RESPONSIBILITY FOR EXISTING UTILITIES WHETHER OR NOT SHOWN ON THESE DRAWINGS. IF THERE IS ANY DISCREPANCY THE CONTRACTOR IS TO NOTIFY THE ENGINEER PROMPTLY.
  - RESTORE ALL TRENCHES AND SURFACES OF PUBLIC ROAD ALLOWANCES TO CONDITION EQUAL OR BETTER THAN ORIGINAL CONDITION AND TO THE SATISFACTION OF THE CITY AUTHORITIES.
  - EXCAVATE AND DISPOSE OF ALL EXCESS EXCAVATED MATERIAL, SUCH AS ASPHALT, CURBING AND DEBRIS, OFF SITE AS DIRECTED BY THE ENGINEER AND THE CITY.
  - TOPSOIL TO BE STRIPPED AND STOCKPILED FOR REHABILITATION. CLEAN FILL TO BE PLACED IN FILL AREAS AND COMPACTED TO 95% STANDARD PROCTOR DENSITY.
  - ALL DISTURBED AREAS TO BE RESTORED TO ORIGINAL CONDITION OR BETTER UNLESS OTHERWISE SPECIFIED.
  - THE CONTRACTOR SHALL BE RESPONSIBLE FOR ALL TRAFFIC CONTROL AND SAFETY MEASURES DURING THE CONSTRUCTION PERIOD, INCLUDING THE SUPPLY, INSTALLATION, AND REMOVAL OF ALL NECESSARY SIGNAGE, DELINEATORS, MARKERS AND BARRIERS.
  - DO NOT ALTER GRADING OF THE SITE WITHOUT PRIOR APPROVAL OF THE ENGINEER/CITY.

- SEWER NOTES:**
- CONSTRUCT ALL SEWERS, CATCH BASINS, MANHOLES AND APPURTENANCES IN ACCORDANCE WITH OPSD STANDARDS AND SPECIFICATIONS, AS WELL AS CITY STANDARDS.
  - SEWER TRENCHING AND BEDDING SHALL CONFORM TO OPSD 802.010 AND 802.013 UNLESS NOTED OTHERWISE.
    - BEDDING SHALL BE A MINIMUM 150mm OF GRANULAR "A", COMPACTED TO MINIMUM 95% STANDARD PROCTOR DRY DENSITY. CLEAR STONE BEDDING SHALL NOT BE PERMITTED.
    - SUB-BEDDING, IF REQUIRED SHALL CONSIST OF 450mm OF COMPACTED GRANULAR "B" TYPE 1
    - BACKFILL TO AT LEAST 300mm ABOVE TOP OF PIPE WITH GRANULAR "A" OR GRANULAR "B" TYPE 1.
    - TO MINIMIZE DIFFERENTIAL FROST HEAVING, TRENCH BACKFILL FROM FINISHED SUBGRADE TO 2.0 METRES BELOW FINISHED GRADE) SHALL MATCH EXISTING SOIL CONDITIONS.
  - SANITARY SEWERS AND CONNECTIONS 150mm Ø AND SMALLER TO BE PVC SDR-28.
  - SEWERS AND CONNECTIONS 200mm Ø AND LARGER TO BE PVC SDR-35. BEDDINGS TO BE TYPE "B" EXCEPT AT RISERS, UNLESS NOTED OTHERWISE.
  - INSULATE ALL STORM AND SANITARY SEWERS/SERVICES THAT HAVE LESS THAN 1.5m OF COVER WITH THERMAL INSULATION AS PER OPSD 1109.030.
  - SEWER CONNECTIONS ARE TO BE MADE ABOVE THE SPRINGLINE OF THE SEWERMAIN AS PER CITY OF OTTAWA STANDARD DRAWING S11.1 & S11.2.
  - SUPPLY AND INSTALL ALL PIPING AND APPURTENANCES AS SHOWN AND DETAILED TO WITHIN 1.0m OF BUILDING. ALL ENDS OF SERVICES TO BE PROPERLY CAPPED AND LOCATED WITH 2"x4"x8" LONG MARKER.
  - CONTRACTOR TO TELETYPE (CCTV) ALL PROPOSED SEWERS ON SITE, OUTLET CONNECTION TO THE MAIN AND PIPES 150mm Ø OR GREATER PRIOR TO BASE COURSE ASPHALT. UPON COMPLETION OF CONTRACT, THE CONTRACTOR IS RESPONSIBLE TO FLUSH AND CLEAN ALL SEWERS & APPURTENANCES.
  - DYE TESTING IS TO BE COMPLETED ON SANITARY SERVICE TO CONFIRM PROPER CONNECTION TO SANITARY SEWER MAIN.

- WATERMAIN NOTES**
- CONSTRUCT ALL WATERMANS AND APPURTENANCES IN ACCORDANCE WITH OPSD STANDARDS AND SPECIFICATIONS, AS WELL AS CITY STANDARDS.
  - INDUSTRIAL/COMMERCIAL SERVICE CONNECTIONS TO BE 50mm COPPER PIPING AND SHALL CONFORM TO ASTM 888 TYPE "K" SOFT.
  - WATERMANS AND/OR WATER SERVICES ARE TO HAVE A MINIMUM COVER OF 2.0m. OTHERWISE THERMAL INSULATION IS REQUIRED AS PER CITY STANDARDS (IF AVAILABLE) OR OPSD 1109.030.
  - IF THE WATERMAIN MUST BE DEFLECTED TO MEET ALIGNMENT, ENSURE THAT THE AMOUNT OF DEFLECTION USED IS EQUAL TO OR LESS THAN THAT WHICH IS RECOMMENDED BY THE MANUFACTURER.
  - THERMAL INSULATION OF WATERMANS AT OPEN STRUCTURES AS PER CITY STANDARDS (IF AVAILABLE) OR OPSD 1109.030.
  - VALVES TO BE OPERATED BY CITY STAFF ONLY.
  - NO CONNECTION TO EXISTING WATER NETWORK SHALL BE COMPLETED UNTIL A WATER PERMIT IS OBTAINED FROM THE CITY. CITY TO BE PRESENT FOR WATERMAIN CONNECTION, CONNECTION, EXCAVATION, BACKFILLING AND REINSTATEMENT TO BE COMPLETED BY CONTRACTOR.
  - IT WILL BE THE RESPONSIBILITY OF THE CONTRACTOR TO PERFORM ANY WATERMAIN CONNECTION(S) REQUIRED. THIS SHALL BE COMPLETED IN THE PRESENCE OF A DESIGNATED MUNICIPAL WATER OPERATOR AND THE SELECTED CONTRACTOR SHALL PROVE TO THE SATISFACTION OF THE CITY THAT THEY ARE COMPETENT TO PERFORM THE WORKS PRIOR TO INITIATING CONSTRUCTION.
  - ALL WATERMANS SHALL BE EQUIPPED WITH BUTTERFLY AND GATE VALVES AS PER OPSD 1100.011.
  - ALL FIRE HYDRANTS, VALVE AND VALVE BOX SHALL CONFORM TO OPSD 1103.020.
  - CONCRETE THRUST BLOCKS TO CONFORM TO OPSD 1103.010 AND OPSD 1103.020.
  - ALL WATERMAIN TO BE CLASS 150 DR-18 OR APPROVED EQUIVALENT.
  - ALL WATERMAIN TO BE EQUIPPED WITH TRACER WIRE.

FILENAME: U:\Chw\01\Project - Proposed\2021\06\CCO-21-3764\_Site Servicing - The Woods\_0905\_CompLETE.dwg  
 USER: R.R.R.  
 DATE: 2022-03-10 10:00:00  
 LAST SAVED: Thursday, March 10, 2022 10:00:00  
 LAST PLOTTED: Thursday, March 10, 2022 10:00:00

D07-12-21-0098

**C102**