

**NOTES**

THIS PLAN IS ISSUED FOR SITE PLAN CONTROL SUBMISSION ONLY. ADDITIONAL DETAILING AND SPECIFICATIONS ARE REQUIRED PRIOR TO TENDERING OR CONSTRUCTION.

DRAWING TO BE READ IN CONJUNCTION WITH TREE CONSERVATION REPORT. REFER TO TREE CONSERVATION REPORT PREPARED BY RUHLAND & ASSOCIATES LTD. DATED MAY 26, 2021 FOR TREE PROTECTION MEASURES AND DETAILS.

SERVICING INFORMATION SHOWN AS REFERENCE ONLY. REFER TO CIVIL DRAWINGS.

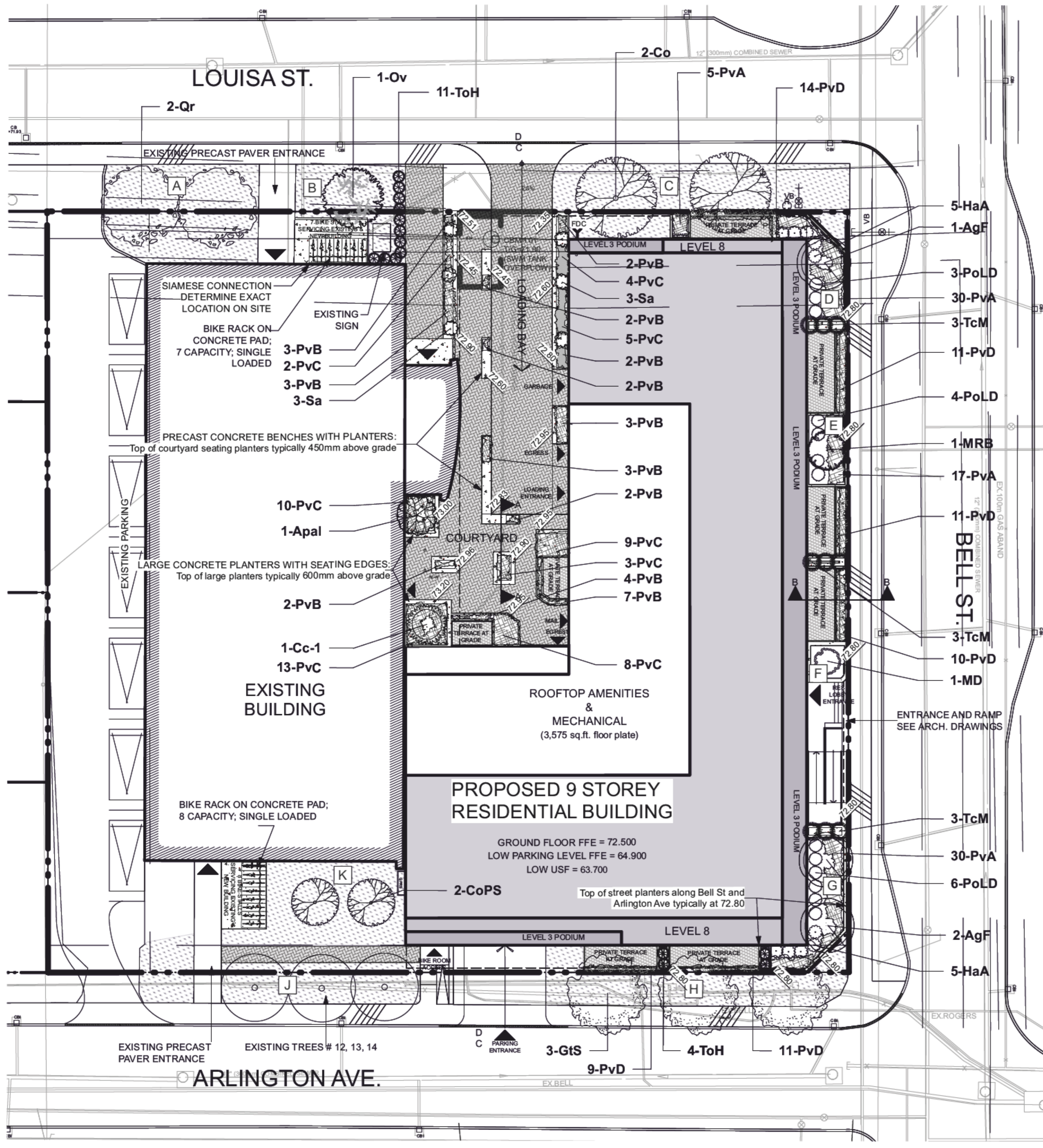

1 LANDSCAPE PLAN AT GRADE  
Scale: 1:200

**LEGEND**

- PROPERTY LINE
- - - EXTENT OF PROPOSED UNDERGROUND PARKING SLAB
- PROPOSED TOP OF PLANTER/SEATING PLANTER ELEVATION
- [Pattern] PROPOSED COURTYARD PAVERS
- [Pattern] PROPOSED PRIVATE TERRACE PAVERS
- [Pattern] PROPOSED PAVER PATHWAY
- [Symbol] PROPOSED BIKE RACK ON CONCRETE PAD
- [Symbol] PROPOSED PLANTER
- [Symbol] PROPOSED TREES
- [Symbol] PROPOSED SHRUBS
- [Symbol] PROPOSED PERENNIALS AND ORNAMENTAL GRASSES
- [Symbol] EXISTING TREES

**Plant List**

| ID                | Qty | Botanical Name                         | Common Name                              | Scheduled Size | Remarks    |
|-------------------|-----|--|--|----------------|------------|
| <b>TREES</b>      |     |  |  |                |            |
| AgF               | 3   | Acer ginnala 'Flame'                   | Flame Amur Maple                         | 45mm caliper   | WB, Staked |
| Apal              | 1   | Acer palmatum 'Bloodgood'              | Bloodgood Japanese Maple                 | 40mm Caliper   | WB Staked  |
| Cc-1              | 1   | Carpinus caroliniana                   | Bluebeech                                | 50mm caliper   | WB Staked  |
| Co                | 2   | Celtis occidentalis                    | Common Hackberry                         | 60mm caliper   | WB Staked  |
| CoPS              | 2   | Celtis occidentalis 'Prairie Sentinel' | Prairie Sentinel Hackberry               | 60mm dia.      | WB Staked  |
| GTS               | 3   | Gleditsia triacanthos 'Shademaster'    | Shademaster Honey Locust                 | 60mm caliper   | WB Staked  |
| MD                | 1   | Malus 'Dreamweaver'                    | Dreamweaver Crabapple                    | 50mm caliper   | WB Staked  |
| MRB               | 1   | Malus x 'Royal Beauty'                 | Royal Beauty Crabapple                   | 50mm dia.      | WB, Staked |
| Ov                | 1   | Ostrya virginiana                      | Ironwood                                 | 50mm dia.      | WB Staked  |
| Qr                | 2   | Quercus rubra                          | Northern Red Oak                         | 60mm caliper   | WB Staked  |
| <b>SHRUBS</b>     |     |  |  |                |            |
| HaA               | 10  | Hydrangea arborescens 'Annabelle'      | Annabelle Hydrangea                      | 2 gallon pot   | 0.9m o.c.  |
| PoLD              | 13  | Physocarpus opulifolius 'Little Devil' | Little Devil Ninebark                    | 50cm ht.       | Potted     |
| Sa                | 6   | Symphocarpus albus                     | Common Snowberry                         | 50 cm ht.      | Potted     |
| TcM               | 9   | Taxus cuspidata 'Monkoo'               | Emerald Spreader Japanese Yew            | 60cm spd       | 0.5m o.c.  |
| ToH               | 19  | Thuja occidentalis ssp.                | Dwarf Cedar ssp.                         | 100 cm ht.     | Potted     |
| <b>PERENNIALS</b> |     |  |  |                |            |
| PvA               | 82  | Perennial Mix A - Sun-Shade            | Coral Bells, Sedge, Hostas               | 150mm pot      |            |
| PvB               | 35  | Perennial Mix B - Sun-Shade            | Ornamental Grasses-Shade                 | 150mm pot      |            |
| PvC               | 54  | Perennial Mix C - Shade                | Ferns, Hostas, Daylilies, Solomon's Seal | 150mm pot      |            |
| PvD               | 93  | Sun Grasses Mix D                      | Sedges, Feather Reed Grasses             | 150mm pot      |            |

| Soil Volume Area, Tree Quantity and Size  | Tree Quantity | OTTAWA TARGET SOIL VOLUME (m3) | Design Soil Volume | SOIL ADEQUACY percentage |
|---|---------------|--------------------------------|--------------------|--------------------------|
| <b>AREA A - 2 Large shade trees in plant bed new soil profile</b><br>Plant bed (80 sq m x 0.45 metre deep)    | 2             | 36.0                           | 36.0               | 100.00%                  |
| <b>AREA B - 1 Medium shade tree in plant bed new soil profile</b><br>plant bed (39 sq m x 0.6 metre deep)     | 1             | 25.0                           | 23.4               | 93.60%                   |
| <b>AREA C - 2 large shade trees in plant bed new soil profile</b><br>Plant bed (81.5 sq m x 0.45 metre deep)  | 2             | 36.0                           | 36.7               | 101.88%                  |
| <b>AREA D - 1 Ornamental tree in planter</b><br>plant bed (21 sq m x 0.6 metre deep)                          | 1             | 15.0                           | 12.6               | 84.00%                   |
| <b>AREA E - 1 Small Ornamental tree in planter (10-15cm DBH)*</b><br>plant bed (13.6 sq m x 0.6 metre deep)   | 1             | 8.0                            | 8.2                | 102.00%                  |
| <b>AREA F - 1 Small Ornamental tree in planter (8-10cm DBH)*</b><br>plant bed (6 sq m x 0.6 metre deep)       | 1             | 5.0                            | 3.6                | 72.00%                   |
| <b>AREA G - 2 Ornamental trees in planter</b><br>plant bed (26.7 sq m x 0.6 metre deep)                       | 2             | 18.0                           | 16.0               | 89.00%                   |
| <b>AREA H - 3 large trees in plant bed new soil profile</b><br>plant bed (57 sq m x 1.0 metre deep)           | 3             | 54.0                           | 57.0               | 105.56%                  |
| <b>AREA I - 3 Large existing trees in plant bed ex soil profile</b><br>plant bed (45.5 sq m x 1.0 metre deep) | 3             | 54.0                           | 45.5               | 84.26%                   |
| <b>AREA K - 2 Medium trees in plant bed new soil profile</b><br>plant bed (66 sq m x 0.45 metre deep)         | 2             | 30.0                           | 29.7               | 99.00%                   |

\* Small ornamental trees with growth to 8-15cm DBH using 'How much soil to grow a big tree' by DeepRoot as a guide

- GENERAL NOTES**
- All general site information and conditions compiled from existing plans, surveys and consultant's field notes. Report all discrepancies prior to any work. No responsibility is born by the Consultant for unknown subsurface conditions.
  - The location of the utilities is approximate only, and the exact location should be determined by consulting the municipal authorities and utility companies concerned. The Contractor shall prove the location of utilities and shall be responsible for adequate protection from damage.
  - All dimensions shown are to be verified on site prior to any construction. No deviations are to be made from the layouts as shown on this plan without prior consultation with the Landscape Architect and Owner.
  - Obtain approval of Landscape Architect for granular base and layout of all pavement areas prior to construction.
  - Stake planting locations and receive approval of Landscape Architect, prior to excavation of any planting pits. No substitutions of plant material shall be made without prior approval of the Landscape Architect.
  - Where clay is encountered proper drainage must be ensured in tree/shrub pits, prior to planting. Have method approved by Landscape Architect.
  - All sodded areas to receive a minimum of 150mm of topsoil over graded sub-base. If sod with mesh is used, mesh to be removed completely during sodding operations. Sod shall come from an approved source and shall be laid within 24 hours of being cut in the nursery. Only nursery sod shall be used.
  - Final subgrade is to be approved by the Landscape Architect prior to sod being laid.
  - Maintain positive surface runoff through the entire construction period.
  - Reinstate all areas and items damaged as a result of construction activities.
  - Street tree species locations and numbers were selected based on soil volume calculations in accordance with the City of Ottawa's requirements for tree planting.

**PROJECT TEAM**

- ARCHITECT**  
HOBIN ARCHITECTURE  
David Anderson  
danderson@hobinarc.com  
613.238.7200 x122  
Patrick Blison  
pblison@hobinarc.com  
613.238.7200 x128
- OWNERSHIP**  
IRONWOOD FUND LIMITED PARTNERSHIP  
Kenneth Jennings  
kjennings@ironwoodfund.com  
613.688.3459
- PLANNING**  
FOTENI PLANNING + DESIGN  
Oshadi Zaki  
zakif@foteni.com  
613.730.5709 ext. 226  
Brian Casagrande  
casagrande@foteni.com  
613.730.5709 ext. 235
- CIVIL**  
NOVATECH  
Francis Thauvette  
fthauvette@novatech-eng.com  
613.254.9643 Ext. 219
- LANDSCAPE ARCHITECT**  
RUHLAND & ASSOCIATES  
Mareeta Ruhland  
mruhlnd@rala.ca  
613.224.4744 x.222
- TRANSPORTATION**  
CGH TRANSPORTATION  
Andrew Harte  
andrew.harte@cgtransportation.com  
343-999-9117
- ENVIRONMENTAL**  
GRADIENT WIND  
Justin Ferraro/Justin Ferraro@gradientwind.com  
Vincent Ferraro/vincent.ferraro@gradientwind.com  
613.836.0934 x112
- GEOTECHNICAL**  
PATERSON GROUP  
Faisal Abou-Saido  
FAbou-Saido@patersongroup.ca  
(613) 226-7381 Ext. 210  
David Gilbert  
dgilbert@patersongroup.ca  
(613) 226-7381 Ext. 205

|   |                                |            |
|---|--------------------------------|------------|
| 6 |                                |            |
| 5 |                                |            |
| 4 |                                |            |
| 3 |                                |            |
| 2 | Reissued for site plan control | 2021/11/12 |
| 1 | Issued for site plan control   | 2021/06/01 |

| no. | issue / revision | date |
|-----|------------------|------|
|     |                  |      |

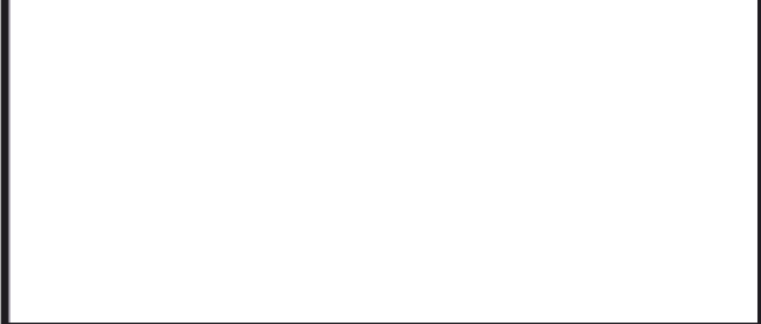

**Ruhland & Associates Ltd**  
landscape architecture • urban design • site planning  
Ph 613-224-4744 Fx 613-224-1331 info@rala.ca www.rala.ca

project  
**18 LOUISA STREET**  
OTTAWA, ON

drawing title  
**LANDSCAPE PLAN**

|                                  |                                 |                            |
|----------------------------------|---------------------------------|----------------------------|
| scale                            | drawn by<br>J. K. / T.F.        | designed by<br>J.K. / M.R. |
| date<br>JUNE 2021                | checked by<br>M. R.             | plot date<br>2021 06 01    |
| project number<br><b>20-1629</b> | drawing number<br><b>L - 01</b> |                            |

Contractor to check and verify all dimensions on the job



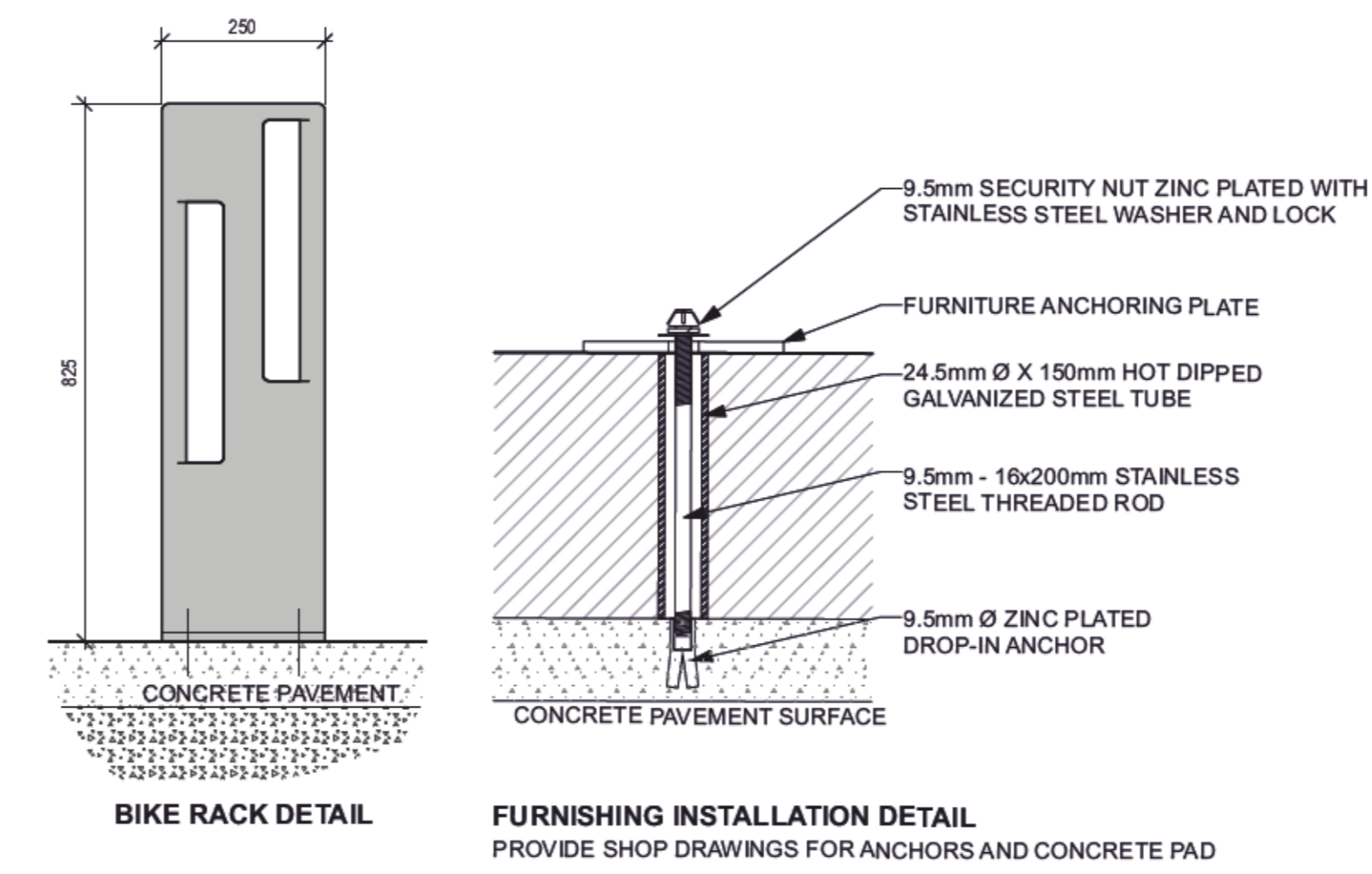
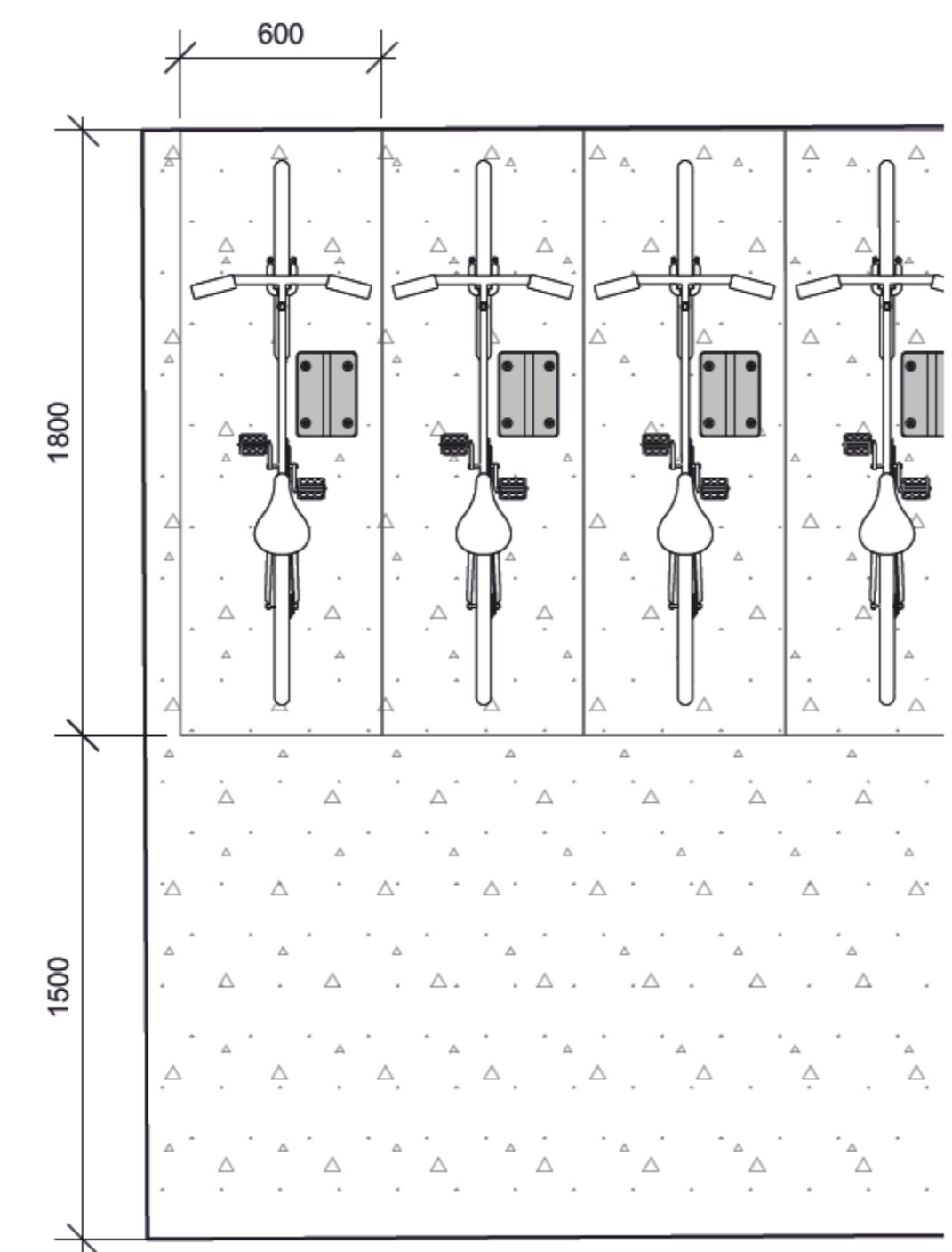
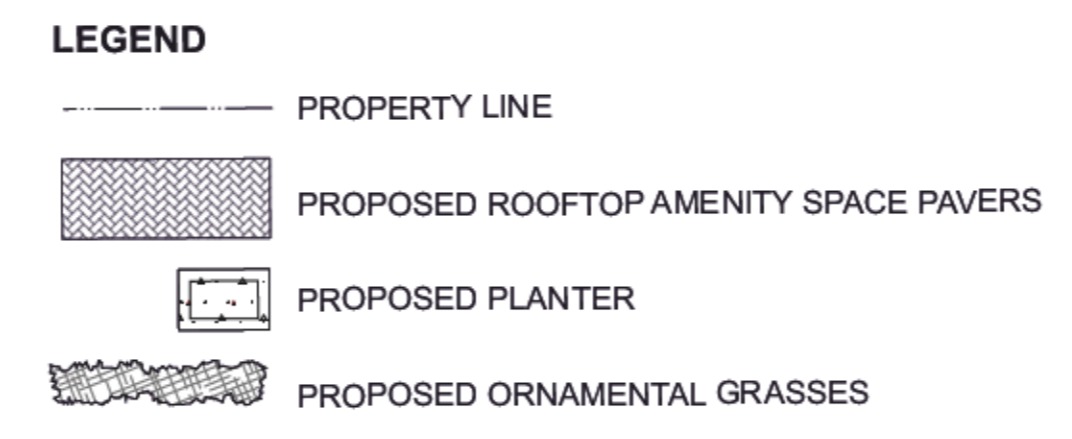
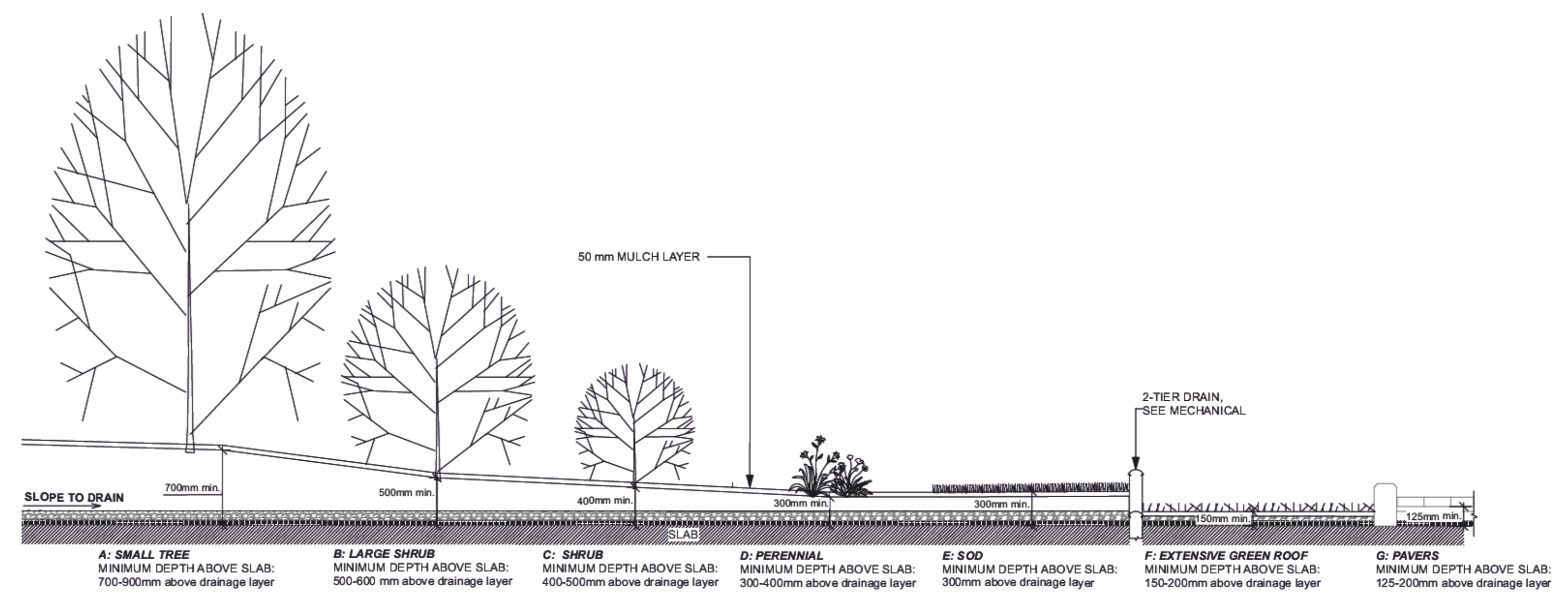
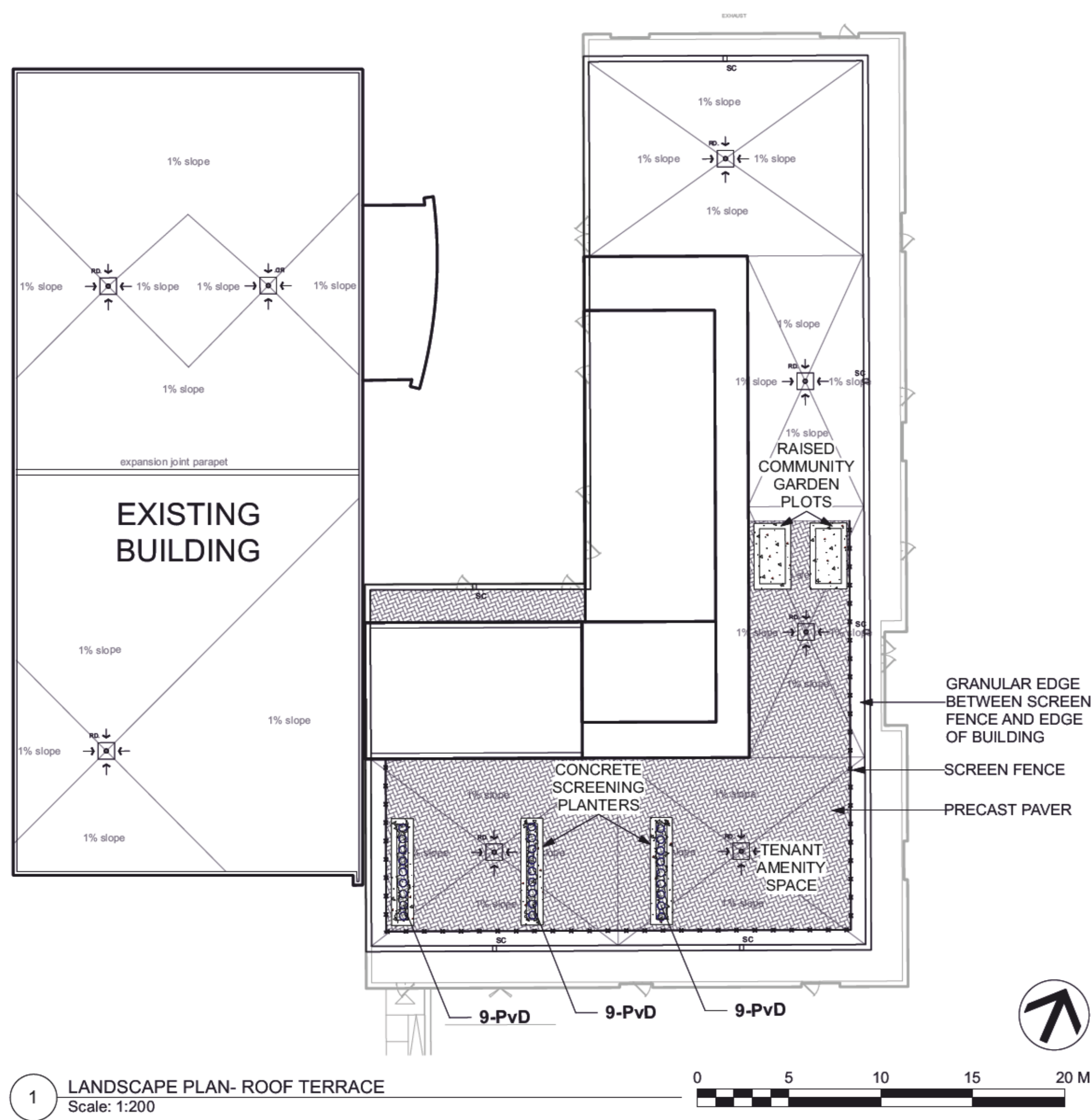

**Equiparc**  
T: 450 346 1882  
F: 450 346 2538

**EP 5900 Bike rack**

**SPECIFICATIONS**  
Frame: Aluminum components  
Finish: Polyester powder coated  
Height: 32 1/2" Width: 7" Length: 10" Weight: 35 lb

**CONCRETE SLABS AND ANCHORS**  
7003 1 slab 36" X 36" X 6"  
7005 1 slab 24" X 24" X 6"  
7016 1 slab 24" dia. X 8" high.  
QS 4 stainless steel kwik bolts  
QAV 4 drop-in anchors with stainless steel theftproof bolts

www.equiparc.com  
1001, rue James-Broude  
Saint-Jean-sur-Richelieu  
QC Canada J2K 0C1

**PROJECT TEAM**

**ARCHITECT**  
HOBIN ARCHITECTURE  
David Anderson  
danderson@hobinarc.com  
613.238.7200 x122  
Patrick Bisson  
pbisson@hobinarc.com  
613.238.7200 x128

**OWNERSHIP**  
IRONWOOD FUND LIMITED PARTNERSHIP  
Kenneth Jennings  
kjennings@jenningsdevelopments.com  
613-688-3459

**PLANNING**  
FOTENI PLANNING + DESIGN  
Ghazla Zak  
zak@foteni.com  
613.730.5709 ext. 226  
Brian Casagrande  
casagrande@foteni.com  
613-730-5709 ext. 235

**CIVIL**  
NOVATECH  
Francis Thauvette  
fthauvette@novatech-eng.com  
613.254.9643 Ext. 219

**LANDSCAPE ARCHITECT**  
RUHLAND & ASSOCIATES  
Murieta Ruhland  
mruhlund@rala.ca  
613 224-4744 x 222

**TRANSPORTATION**  
CGH TRANSPORTATION  
Andrew Harte  
andrew.harte@cghtransportation.com  
343-999-9117

**ENVIRONMENTAL**  
GRADIENT WIND  
Justin Ferraro  
justin.ferraro@gradientwind.com  
Vincent Ferraro  
vincent.ferraro@gradientwind.com  
613 836 0934 x112

**GEOCHEMICAL**  
PATERSON GROUP  
Faisal Abou-Seido  
FAbou-Seido@patersongroup.ca  
(613) 226-7381 Ext. 210  
David Gilbert  
dgilbert@patersongroup.ca  
(613) 226-7381 Ext. 205

|   |                                |            |
|---|--------------------------------|------------|
| 6 |                                |            |
| 5 |                                |            |
| 4 |                                |            |
| 3 |                                |            |
| 2 | Reissued for site plan control | 2021/11/12 |
| 1 | Issued for site plan control   | 2021/06/01 |

| no. | issue / revision | date |
|-----|------------------|------|
|     | seal             |      |

**Ruhland & Associates Ltd**  
landscape architecture • urban design • site planning  
Ph 514-224-4744 Fx 514-224-1331 info@rala.ca www.rala.ca

project  
**18 LOUISA STREET**  
OTTAWA, ON

drawing title  
**ROOF PLAN / BIKE RACK LAYOUT**

| scale          | drawn by       | designed by |
|----------------|----------------|-------------|
|                | J. K. / T.F.   | J.K. / M.R. |
| date           | checked by     | plot date   |
| JUNE 2021      | M. R.          | 2021 06 01  |
| project number | drawing number |             |
| <b>20-1629</b> | <b>L - 02</b>  |             |

Contractor to check and verify all dimensions on the job



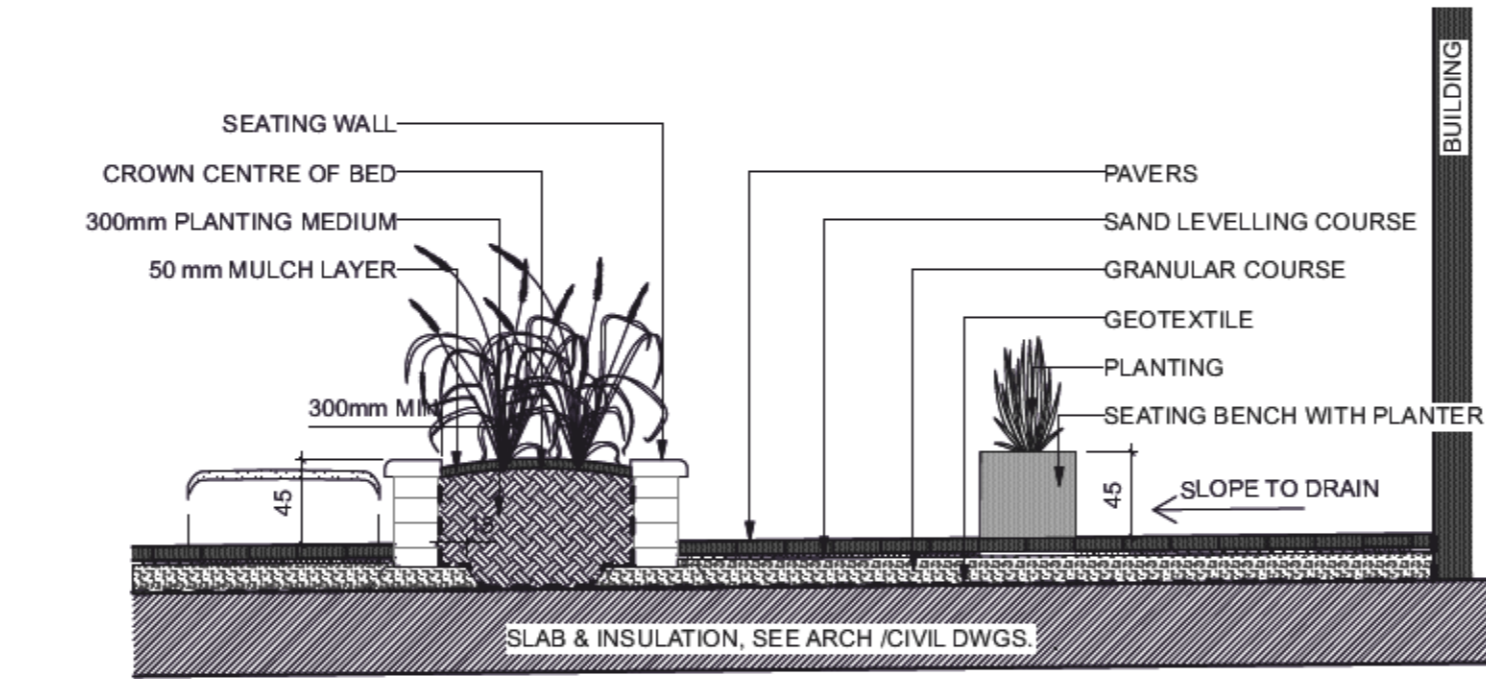
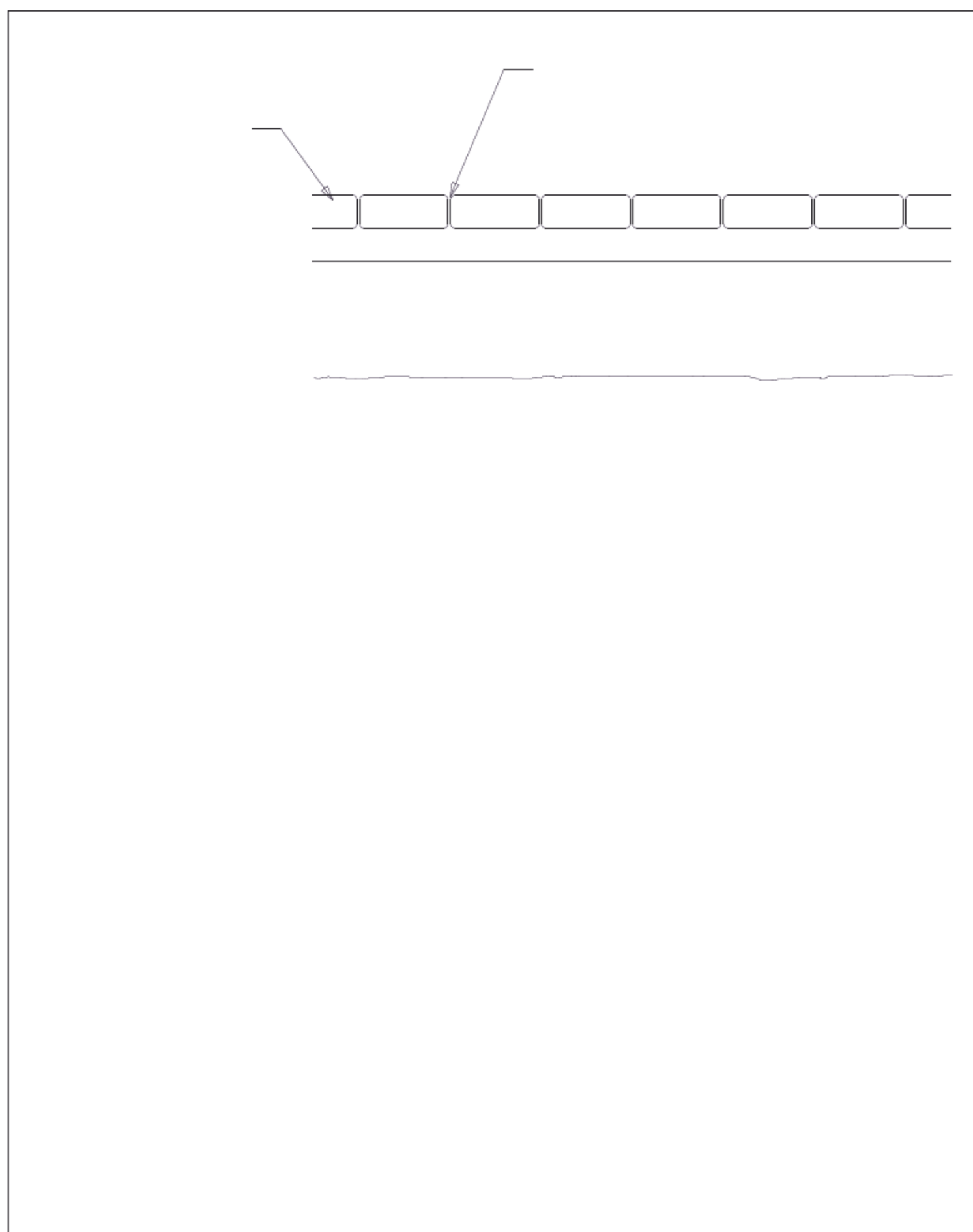
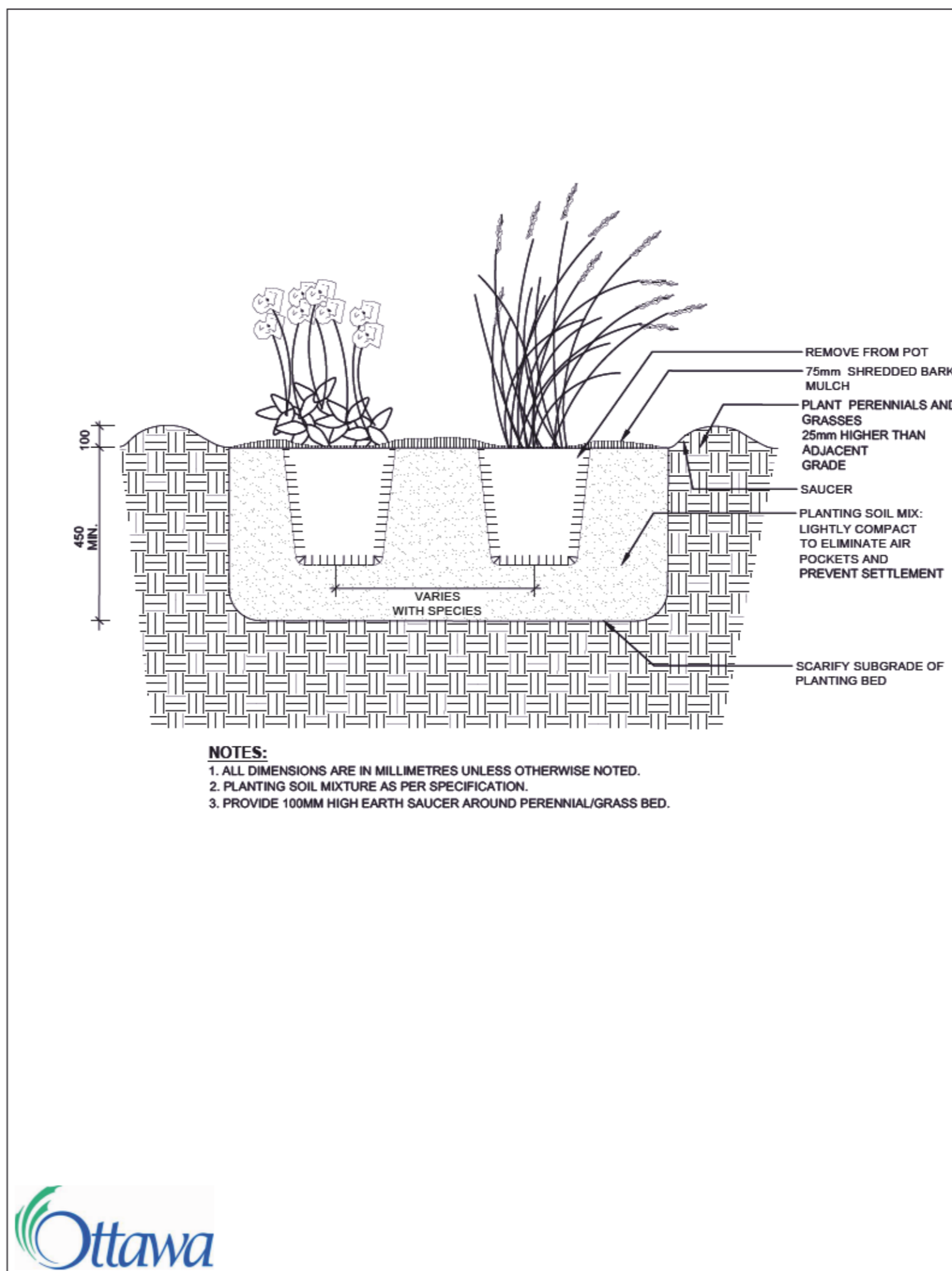
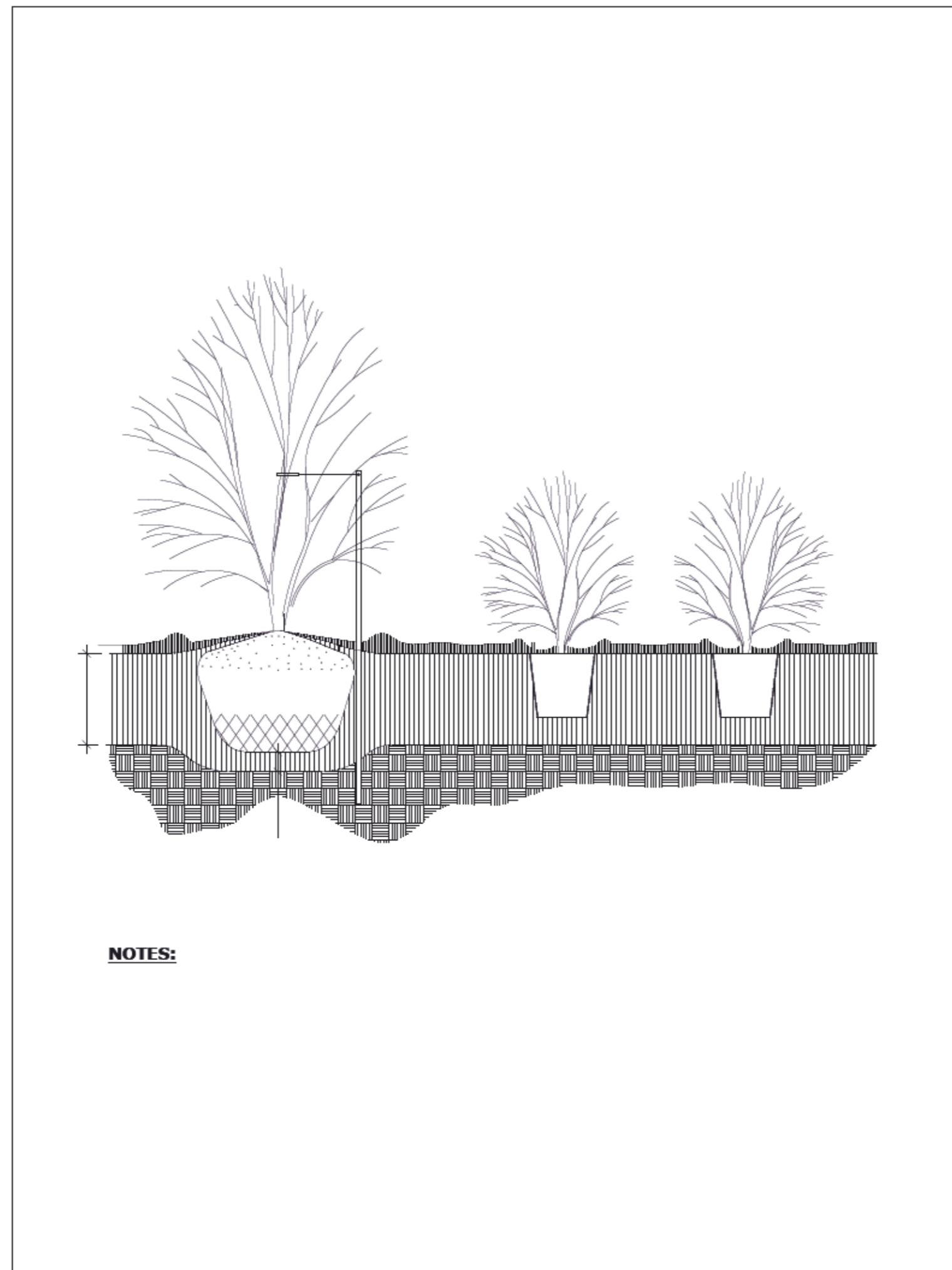
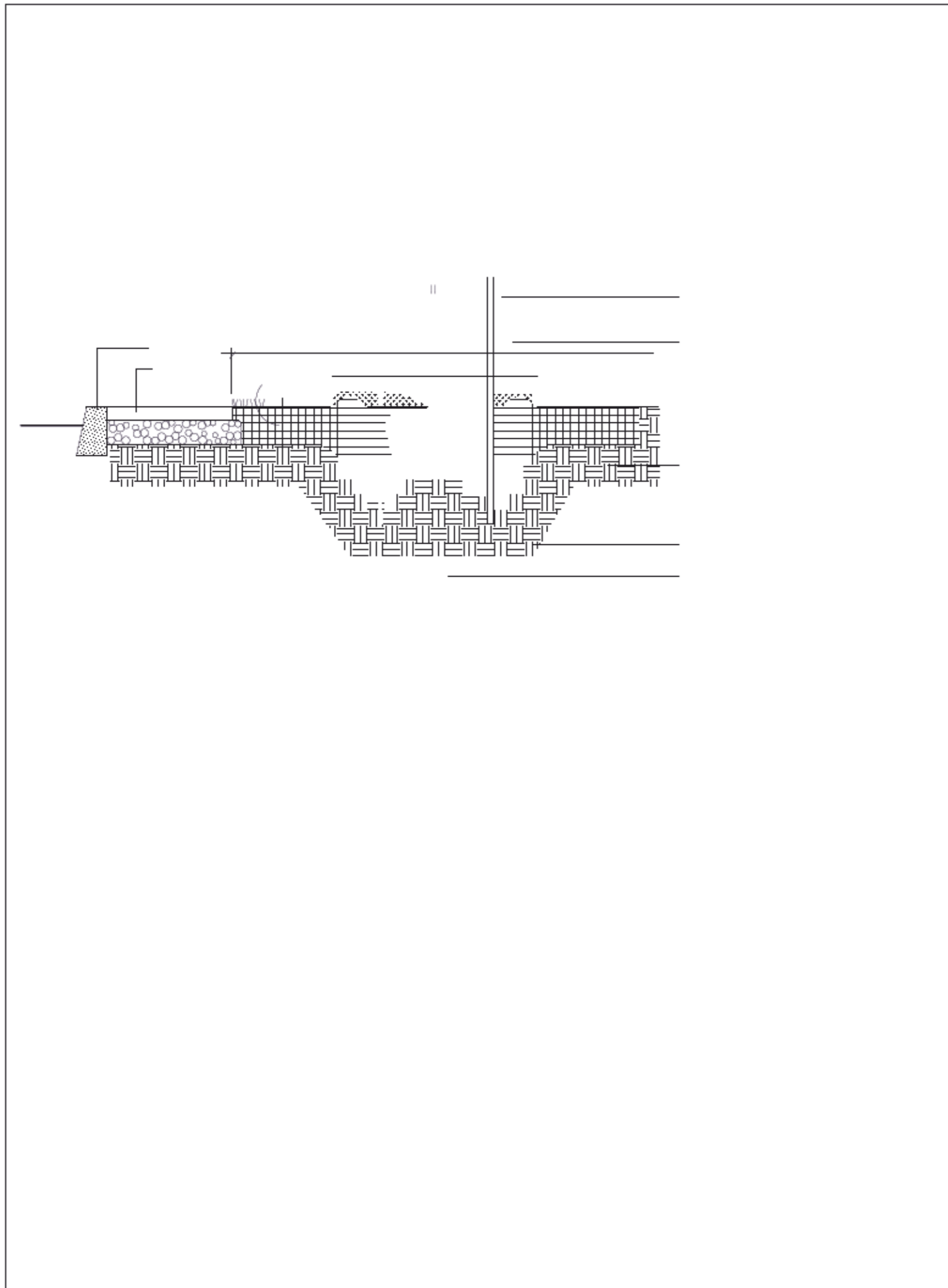

1 SECTION A-A - INTERIOR COURTYARD SEATING PLANTERS  
Scale: NTS

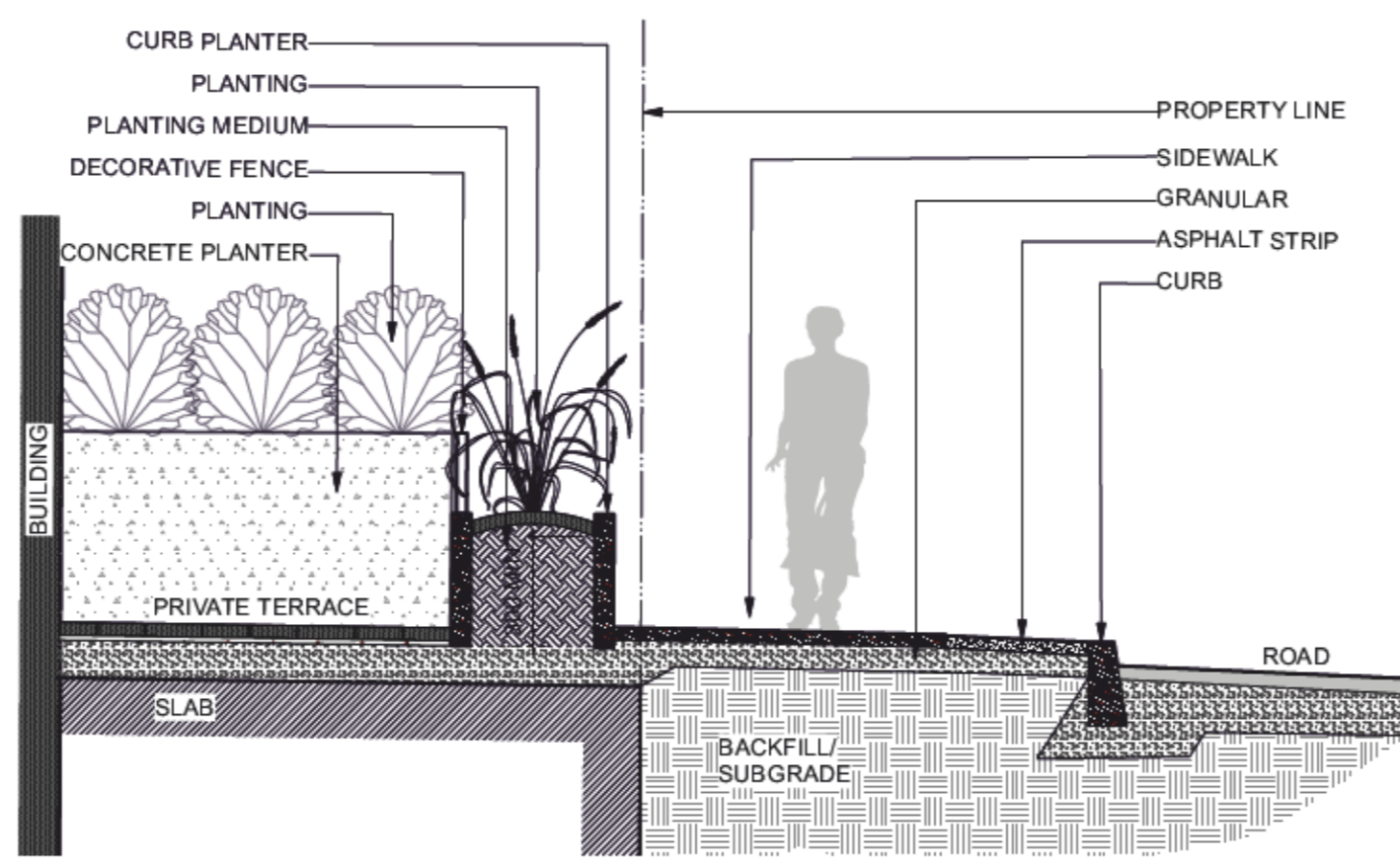

2 SECTION B-B - EXTERIOR TERRACE  
Scale: NTS

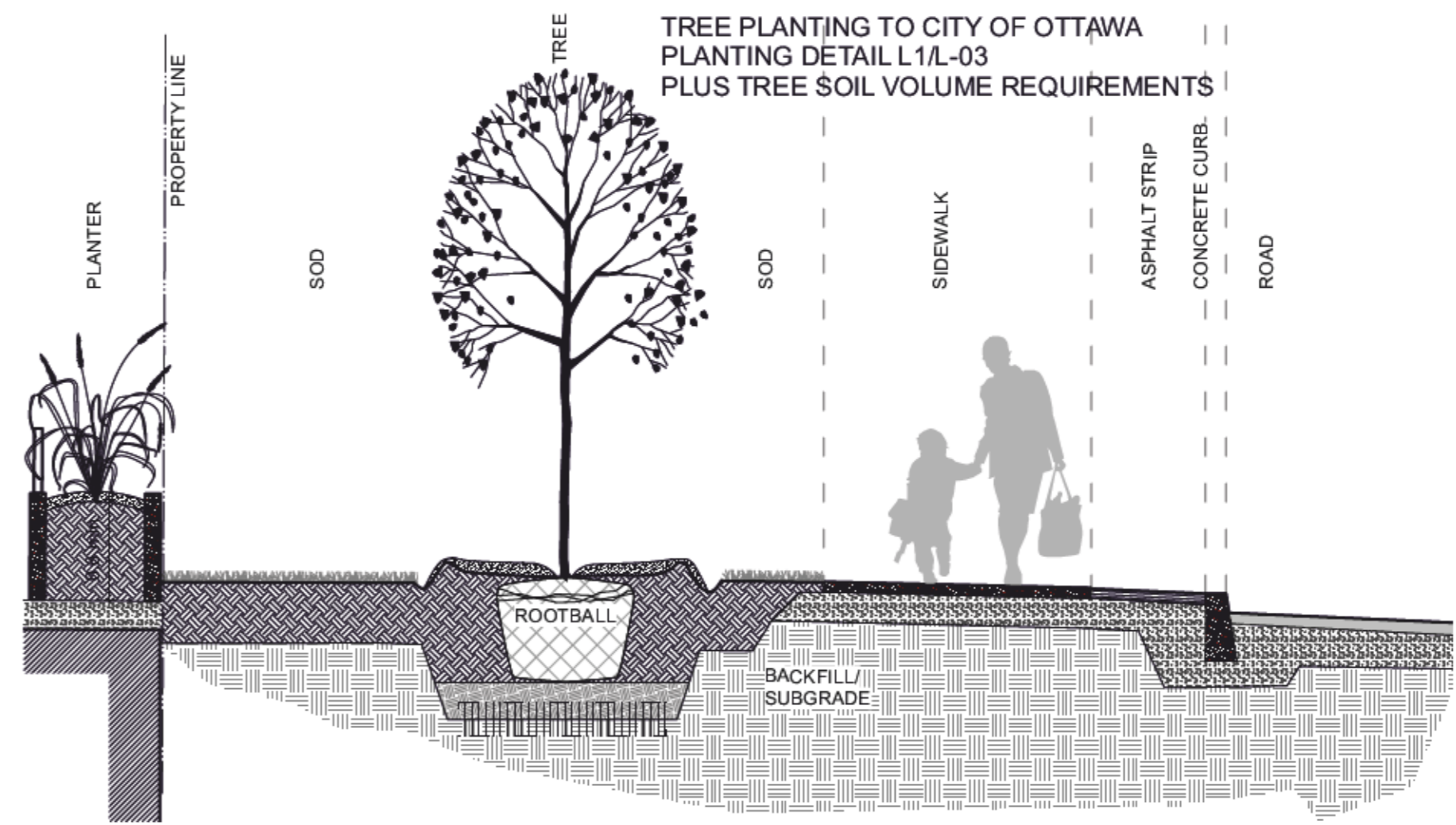

3 SECTION AT STREET TREE PLANTING  
Scale: NTS

ADDITIONAL NOTES FOR NUMBER 5: PRECAST PAVERS IN VEHICULAR AREAS TO RECEIVE SAME BASE STRUCTURES FOR GRANULAR 'A' AND 'B' AS GEOTECHNICAL RECOMMENDATIONS FOR HEAVY DUTY PAVEMENT. PEDESTRIAN AREAS ARE TO RECEIVE 200mm COMPACTED GRANULAR 'A' MINIMUM, ADJUSTMENTS TO BE SPECIFIED IN RELATION TO SITE CONDITIONS AND GEOTECHNICAL RECOMMENDATIONS.

**PROJECT TEAM**

**ARCHITECT**  
HOBINARCHITECTURE  
David Anderson  
danderson@hobinarc.com  
613.238.7200 x122  
Patrick Bisson  
pbisson@hobinarc.com  
613.238.7200 x128

**OWNERSHIP**  
IRONWOOD FUND LIMITED PARTNERSHIP  
Kenneth Jennings  
kjennings@jenningsdevelopments.com  
613-688-3459

**PLANNING**  
FOTENN PLANNING + DESIGN  
Ghada Zaki  
zak@fotenn.com  
613.730.5709 ext. 226  
Brian Casagrande  
casagrande@fotenn.com  
613-730-5709 ext. 235

**CIVIL**  
NOVATECH  
Francis Thauvette  
fthauvette@novatech-eng.com  
613.254.9643 Ext. 219

**LANDSCAPE ARCHITECT**  
RUHLAND & ASSOCIATES  
Marilisa Ruhland  
mruhlund@rala.ca  
613 224-4744 x 222

**TRANSPORTATION**  
CGH TRANSPORTATION  
Andrew Harte  
andrew.harte@cghttransportation.com  
343-999-9117

**ENVIRONMENTAL**  
GRADIENT WIND  
Justin Ferraro  
justin.ferraro@gradientwind.com  
Vincent Ferraro  
vincent.ferraro@gradientwind.com  
613 836 0934 x112

**GEOTECHNICAL**  
PATERSONGROUP  
Faisal Abou-Seido  
FAbou-Seido@Patersongroup.ca  
(613) 226-7381 Ext. 210  
David Gilbert  
dgilbert@patersongroup.ca  
(613) 226-7381 Ext. 205

|   |                                |            |
|---|--------------------------------|------------|
| 6 |                                |            |
| 5 |                                |            |
| 4 |                                |            |
| 3 |                                |            |
| 2 | Reissued for site plan control | 2021/11/12 |
| 1 | Issued for site plan control   | 2021/06/01 |

| no. | issue / revision | date |
|-----|------------------|------|
|     | seal             |      |

north

**Ruhland & Associates Ltd**  
landscape architecture • urban design • site planning  
Ph 613-224-4744 Fx 613-224-1311 info@rala.ca www.rala.ca

project  
**18 LOUISA STREET**  
OTTAWA, ON

drawing title  
**SECTIONS / DETAILS**

|                                  |                                 |                            |
|----------------------------------|---------------------------------|----------------------------|
| scale                            | drawn by<br>J. K. / T.F.        | designed by<br>J.K. / M.R. |
| date<br>JUNE 2021                | checked by<br>M. R.             | plot date<br>2021 06 01    |
| project number<br><b>20-1629</b> | drawing number<br><b>L - 03</b> |                            |

Contractor to check and verify all dimensions on the job