

LEGEND:

— STM —	PROPOSED STORM SEWER LINE
— SAN —	PROPOSED SANITARY SEWER LINE
— WAT —	PROPOSED WATERMAIN LINE
■ CB1	PROPOSED CATCHBASIN
⊙ OGS	PROPOSED OIL/GRIT SEPARATOR
⊙ CBMH1	PROPOSED MAINTENANCE HOLE AND CATCHBASIN
⊕	PROPOSED WATERMAIN VALVE
●	SANITARY MH

Not For Construction

A	ISSUE FOR REVIEW	P.P.	2021.07.21
NO.	ISSUE / REVISION	BY	DATE

The contractor shall check and verify all dimensions and report all errors and omissions to the Engineer before proceeding with the work. This drawing is the property of the Engineer and must be returned on completion of the work. Do not scale drawings.

PROJECT:
18630_1195 NEWMARKET STREET
1195 NEWMARKET STREET, OTTAWA ONTARIO

DRAWING:
SITE SERVICING PLAN

GRUPE ORTAM INC.
1200, rue de Louvain Ouest
Montréal (Québec) H4N 1G5
Tél: (514) 982-0990,
www.ortamgroupe.com

DRAWN BY : P.L.	CHECKED BY : P.P.
SCALE: AS SHOWN	DATE: JULY 21, 2021
PROJECT NO: 14166	DRAWING NO: 14166 - 03

SITE SERVICING PLAN
1:500

- NOTES:
- ALL ELEVATIONS and STATIONS ARE IN METERS. DIMENSIONS ARE IN MILLIMETERS.
 - THIS SET OF DRAWINGS IS FOR THE PURPOSE OF THE SITE GRADING.
 - FOR THE INFORMATION OF THE SITE PLAN, TOPOGRAPHIC, PROPERTY BOUNDARY, AND SET BACK PLEASE REFER TO THE RELEVANT DOCUMENTS FROM THE CLIENT.
 - ALL ELEVATIONS and DIMENSIONS SHOWN ARE IN METERS, UNLESS NOTED OTHERWISE.
 - THE CONTRACTOR SHALL OBTAIN APPROVED SERVICE CONNECTION PERMITS FROM THE CITY OF OTTAWA BEFORE CONNECTING TO EXISTING SEWER, OR WATER MAIN.
 - THE CONTRACTOR SHALL NOT OPERATE EXISTING MUNICIPAL WATER SYSTEM VALVES. WATER MAIN FLUSHING, DISINFECTING AND TESTING PLAN TO BE SUBMITTED TO, AND APPROVED BY THE CITY OF NIAGARA FALLS PRIOR TO THE PERFORMANCE OF WORK. VALVES CAN ONLY BE OPERATED BY THE CITY OF NIAGARA FALLS OPERATIONAL STAFF. THE CITY REQUIRES A MINIMUM OF 48 HOURS WRITTEN NOTICE PRIOR TO ALL WORKS.
 - PROVIDE APPROPRIATE SHORING FOR TRENCH EXCAVATION IN ACCORDANCE WITH THE LATEST REVISION OF THE OHSA GUIDELINE FOR CONSTRUCTION PROJECTS.
 - MINIMUM HORIZONTAL SEPARATION BETWEEN WATER MAINS AND SEWERS SHALL BE 2.5m. MINIMUM VERTICAL CLEARANCE BETWEEN SEWERS AND WATER MAINS WHICH CROSS IS 500mm.
 - THE CONTRACTOR SHALL ENSURE ALL NEW MANHOLES / CATCHBASINS / VALVES AND ANY OTHER APPURTENANCE WITHIN THE CONSTRUCTION AREA, TO MATCH FINISHED GRADE, AS REQUIRED.
 - NEW MAINTENANCE HOLES TO CONFORM TO OPSD 701.010 - 701.015 AS APPROPRIATE, WITH TYPICAL MAINTENANCE HOLE BENCHING AS PER OPSD 701.021.
 - NEW CATCH BASINS TO BE PER OPSD 705.010 WITH GRATES TO OPSD 400.020.
 - ALL EXISTING AND PROPOSED DOWNSPOUTS SHALL DISCHARGE ONTO SPLASH PADS AT GRADE LEVEL WITH FLOWS DIRECTED AWAY FROM THE BUILDING FOUNDATIONS WITHOUT EROSION OR INCONVENIENCE TO OTHERS.
 - ALL SEWER PIPES AND WATERMAIN CONNECTION HAVE TO BE INSULATED BECAUSE OF FROST REQUIREMENT.
 - ROOFTOP STORAGE TO BE PROVIDED FOR STORMWATER MANAGEMENT CONTROL FOR THE 100 YEAR STORM EVENT. PROVIDE 1% ROOF SLOPE AND MAX. 150mm DEPTH AT THE DRAIN FOR THE ROOF STORAGE. THE DISCHARGE AND CONNECTION SYSTEM WILL REFER TO MECHANICAL DESIGN DOCUMENTS.
 - ALL WORK IS TO BE CARRIED OUT IN ACCORDANCE WITH OPSS AND OPSD REQUIREMENTS AND TO THE REQUIREMENTS OF THE CITY OF OTTAWA.



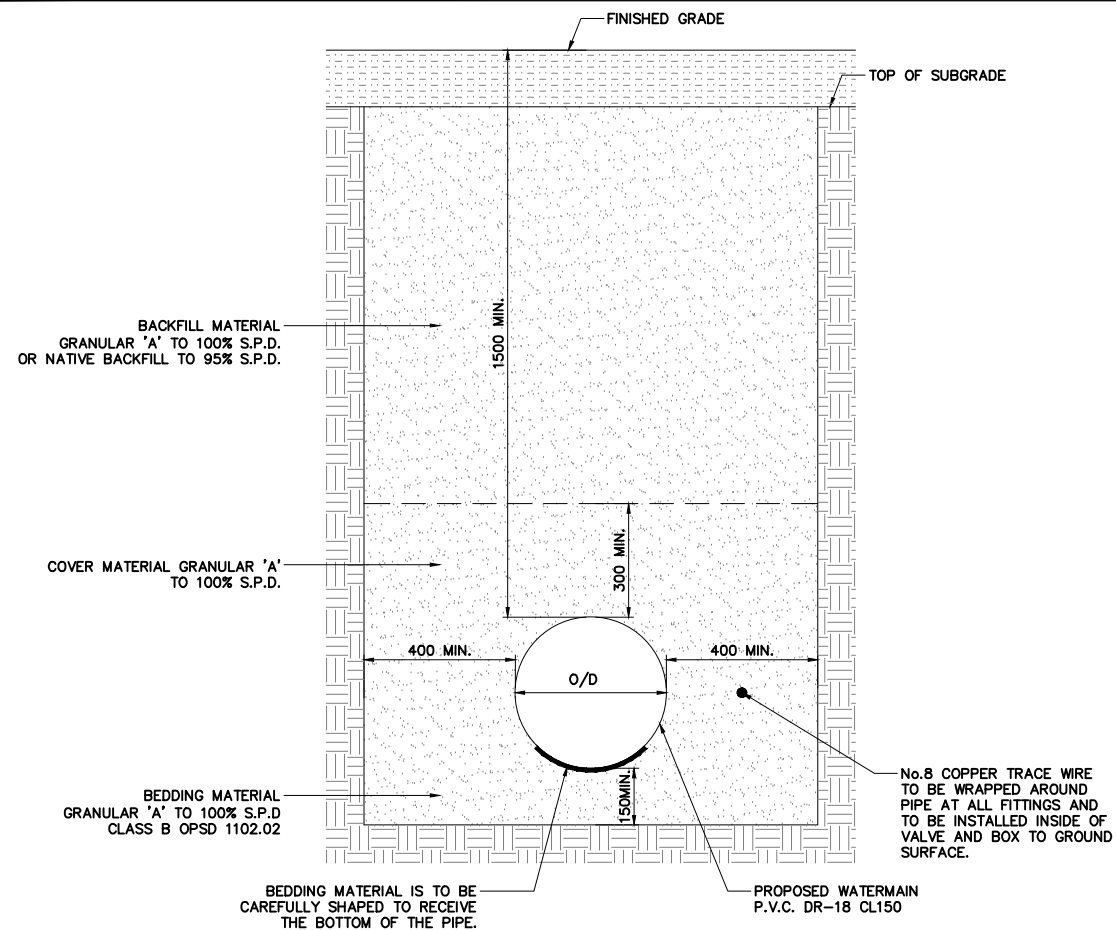

DETAIL 1 - TYPICAL WATERMAIN CROSS-SECTION

N.T.S.

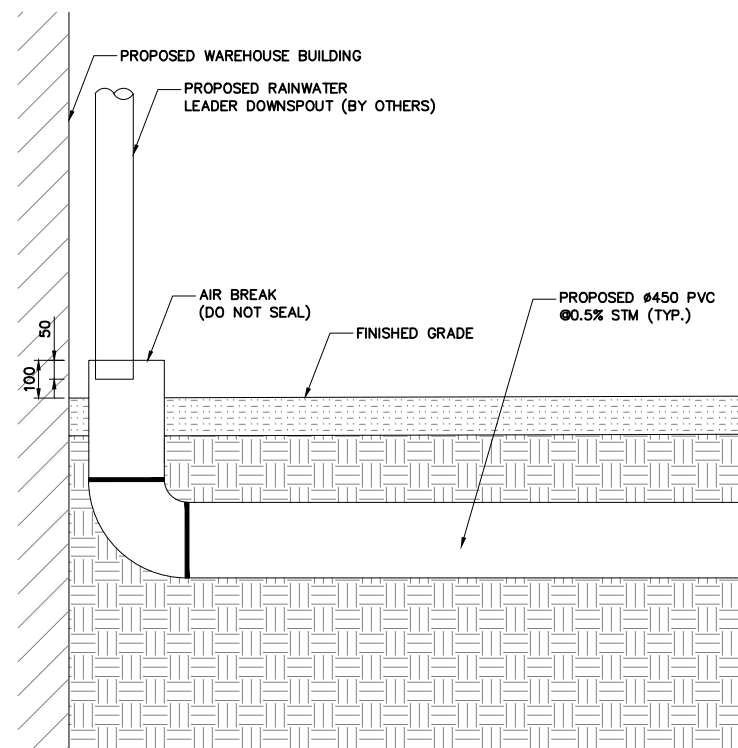

DETAIL 3 - DOWNSPOUT CONNECTION

N.T.S.

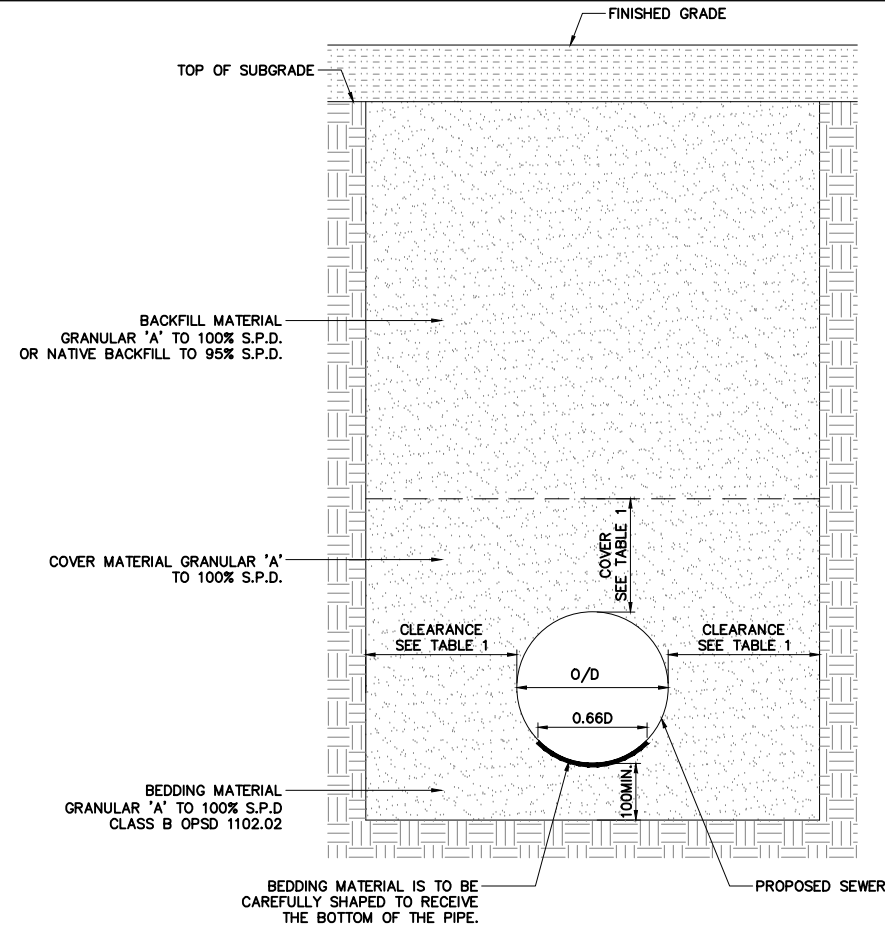

*1. THIS IS STANDARD CROSS-SECTION IS TO BE APPLIED IN STABLE CONDITIONS OR AFTER TRENCH HAS BEEN BROUGHT TO STABLE CONDITIONS.

2. WHERE THE TRENCH IS SHEATHED THE CLEARANCE IS THE DISTANCE BETWEEN THE INSIDE FACE OF SHEATHING AND THE PIPE.

DETAIL 2 - TYPICAL SEWER CROSS-SECTION

N.T.S.

TABLE 1 - CLEARANCE AND COVER

PIPE TYPE		CLEARANCE (mm)	COVER (mm)
RIGID PIPE INSIDE DIA. (mm)	900 OR LESS	300	300
	OVER 900	500	300
FLEXIBLE PIPE INSIDE DIA. (mm)	LESS THAN 600	300	400
	600 TO 1800	400	300+D/4

NOTES:

- ALL ELEVATIONS and STATIONS ARE IN METERS. DIMENSIONS ARE IN MILLIMETERS.
- THIS SET OF DRAWINGS IS FOR THE PURPOSE OF THE SITE GRADING.
- FOR THE INFORMATION OF THE SITE PLAN, TOPOGRAPHIC, PROPERTY BOUNDARY, AND SET BACK PLEASE REFER TO THE RELEVANT DOCUMENTS FROM THE CLIENT.
- ALL ELEVATIONS AND DIMENSIONS SHOWN ARE IN METERS, UNLESS NOTED OTHERWISE.
- THE CONTRACTOR SHALL OBTAIN APPROVED SERVICE CONNECTION PERMITS FROM THE CITY OF OTTAWA BEFORE CONNECTING TO EXISTING SEWER, OR WATER MAIN.
- THE CONTRACTOR SHALL NOT OPERATE EXISTING MUNICIPAL WATER SYSTEM VALVES. WATER MAIN FLUSHING, DISINFECTING AND TESTING PLAN TO BE SUBMITTED TO, AND APPROVED BY THE CITY OF NIAGARA FALLS PRIOR TO THE PERFORMANCE OF WORK. VALVES CAN ONLY BE OPERATED BY THE CITY OF NIAGARA FALLS OPERATIONAL STAFF. THE CITY REQUIRES A MINIMUM OF 48 HOURS WRITTEN NOTICE PRIOR TO ALL WORKS.
- PROVIDE APPROPRIATE SHORING FOR TRENCH EXCAVATION IN ACCORDANCE WITH THE LATEST REVISION OF THE OHSA GUIDELINE FOR CONSTRUCTION PROJECTS.
- MINIMUM HORIZONTAL SEPARATION BETWEEN WATER MAINS AND SEWERS SHALL BE 2.5m. MINIMUM VERTICAL CLEARANCE BETWEEN SEWERS AND WATER MAINS WHICH CROSS IS 500mm.
- THE CONTRACTOR SHALL ENSURE ALL NEW MANHOLES / CATCHBASINS / VALVES AND ANY OTHER APPURTENANCE WITHIN THE CONSTRUCTION AREA, TO MATCH FINISHED GRADE, AS REQUIRED.
- NEW MAINTENANCE HOLES TO CONFORM TO OPSD 701.010 - 701.015 AS APPROPRIATE, WITH TYPICAL MAINTENANCE HOLE BENCHING AS PER OPSD 701.021.
- NEW CATCH BASINS TO BE PER OPSD 705.010 WITH GRATES TO OPSD 400.020.
- ALL EXISTING AND PROPOSED DOWNSPOUTS SHALL DISCHARGE ONTO SPLASH PADS AT GRADE LEVEL WITH FLOWS DIRECTED AWAY FROM THE BUILDING FOUNDATIONS WITHOUT EROSION OR INCONVENIENCE TO OTHERS.
- ALL SEWER PIPES AND WATERMAIN CONNECTION HAVE TO BE INSULATED BECAUSE OF FROST REQUIREMENT.
- ROOFTOP STORAGE TO BE PROVIDED FOR STORMWATER MANAGEMENT CONTROL FOR THE 100 YEAR STORM EVENT. PROVIDE 1% ROOF SLOPE AND MAX. 150mm DEPTH AT THE DRAIN FOR THE ROOF STORAGE. THE DISCHARGE AND CONNECTION SYSTEM WILL REFER TO MECHANICAL DESIGN DOCUMENTS.
- ALL WORK IS TO BE CARRIED OUT IN ACCORDANCE WITH OPSD AND OPSD REQUIREMENTS AND TO THE REQUIREMENTS OF THE CITY OF OTTAWA.



- LEGEND:
- STM — PROPOSED STORM SEWER LINE
 - SAN — PROPOSED SANITARY SEWER LINE
 - WAT — PROPOSED WATERMAIN LINE
 - CB1 PROPOSED CATCHBASIN
 - OGS PROPOSED OIL/GRIT SEPARATOR
 - ⊙ CBMH1 PROPOSED MAINTENANCE HOLE AND CATCHBASIN
 - ✕ PROPOSED WATERMAIN VALVE
 - SANITARY MH



Not For Construction

A	ISSUE FOR REVIEW	P.P.	2021.07.21
NO.	ISSUE / REVISION	BY	DATE
The contractor shall check and verify all dimensions and report all errors and omissions to the Engineer before proceeding with the work. This drawing is the property of the Engineer and must be returned on completion of the work. Do not scale drawings.			
PROJECT: 18630_1195 NEWMARKET STREET 1195 NEWMARKET STREET, OTTAWA ONTARIO			
DRAWING: SITE SERVICING DETAILS			
GROUPE ORTAM INC. 1200, rue de Louvain Ouest Montréal (Québec) H4N 1G5 Tél: (514) 982-0990, www.ortamgroupe.com			
DRAWN BY : P.L.		CHECKED BY : P.P.	
SCALE: AS SHOWN		DATE: JULY 21, 2021	
PROJECT NO: 14166		DRAWING NO: 14166 - 04	