

EXISTING TREE LIST						
KEY	QTY	BOTANICAL NAME	COMMON NAME	SIZE	CONDITION	REMARKS
<b>TREES</b>						
AN	5	Acer negundo	Manitoba Maple	150-600mm DBH	FAIR-GOOD	See plan
AN1	8	Acer negundo	Manitoba Maple	100-400mm DBH	FAIR-GOOD	See plan
GT	1	Gleditsia triacanthos	Honey Locust	350mm DBH	GOOD	To remain
PN	5	Pinus nigra	Austrian Pine	200-400mm DBH	FAIR-GOOD	To remain
UP	12	Ulmus pumila	Siberian Elm	100-250mm DBH	DEAD-GOOD	See plan
UP1	3	Ulmus pumila	Siberian Elm	100mm DBH	GOOD	To remain
SI	1	Acer saccharinum	Silver Maple	710mm DBH	FAIR	To remain
112-134 Nelson Street Joint with 140 Nelson Street City of Ottawa 110 Nelson Street 112-134 Nelson Street 140 Nelson Street City of Ottawa						

PROPOSED PLANT LIST						
KEY	QTY	BOTANICAL NAME	COMMON NAME	SIZE	CONDITION	REMARKS
<b>TREES</b>						
HA	5	Crataegus crus-galli var. nemris	Thornless Cockspur Hawthorn	50mm cal.	B&B	Single Leader
JL	2	Syringa reticulata	Japanese Tree Lilac	50mm cal.	B&B	Single Leader
<b>SHRUBS</b>						
RR	28	Rosa rugosa	Rugosa Rose	800mm ht.	Potted	800 mm o.c.
<b>PERENNIALS AND ORNAMENTAL GRASSES</b>						
DL	108	Hemerocallis 'Stella D'Oro'	Stella D'Oro Daylily	100mm pot	Potted	300 mm o.c.
HM	9	Panicum virgatum 'Heavy Metal'	Heavy Metal Switch Grass	250mm pot	Potted	600 mm o.c.
PD	72	Hemerocallis 'Purple D'Oro'	Purple D'Oro Daylily	100mm pot	Potted	300 mm o.c.

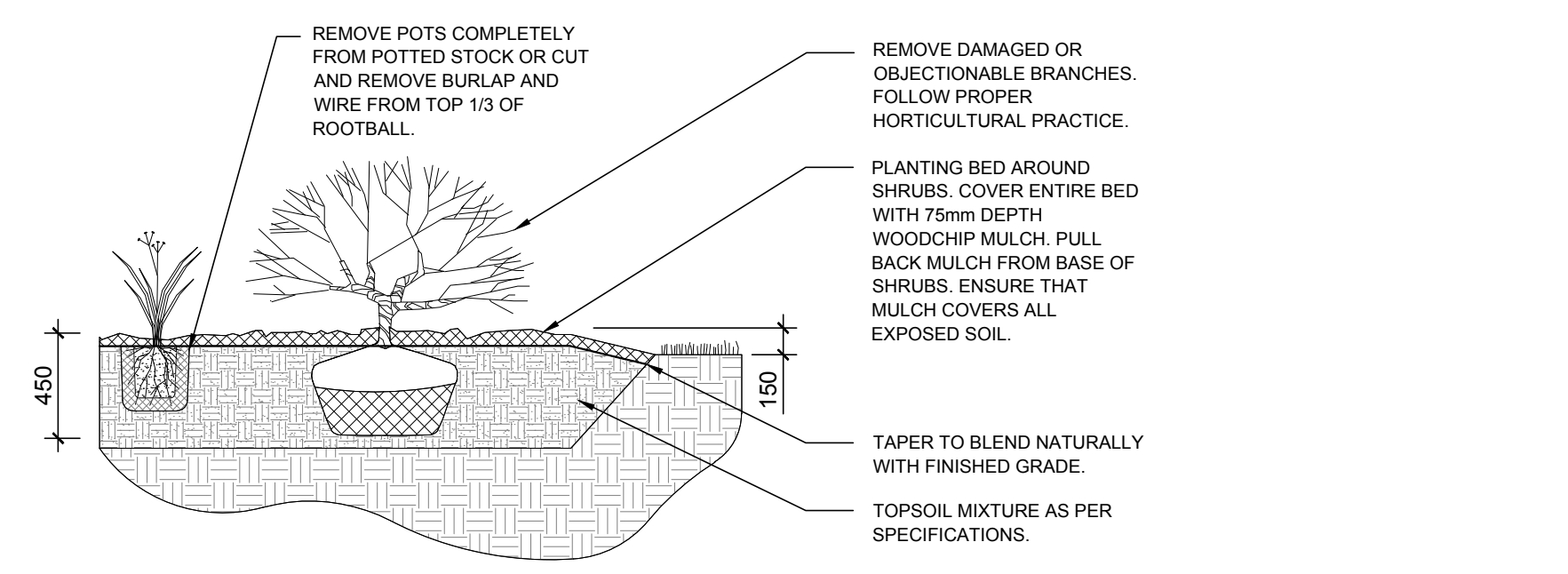

2 L.1 SHRUB AND ORNAMENTAL GRASS PLANTING SCALE: NTS

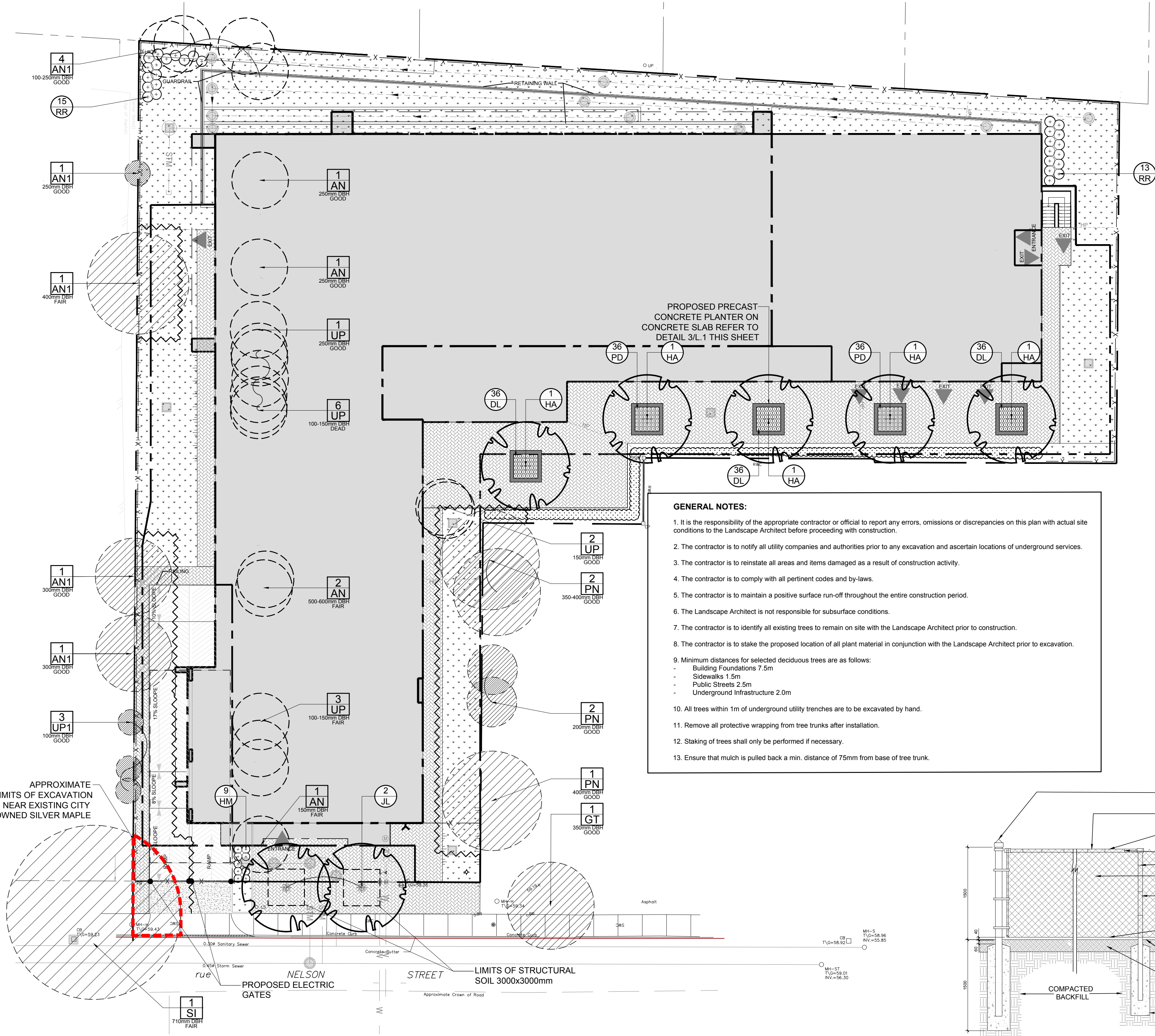

1 L.1 TREE CONSERVATION REPORT & LANDSCAPE PLAN SCALE 1:200

**GENERAL NOTES:**

- It is the responsibility of the appropriate contractor or official to report any errors, omissions or discrepancies on this plan with actual site conditions to the Landscape Architect before proceeding with construction.
- The contractor is to notify all utility companies and authorities prior to any excavation and ascertain locations of underground services.
- The contractor is to reinstate all areas and items damaged as a result of construction activity.
- The contractor is to comply with all pertinent codes and by-laws.
- The contractor is to maintain a positive surface run-off throughout the entire construction period.
- The Landscape Architect is not responsible for subsurface conditions.
- The contractor is to identify all existing trees to remain on site with the Landscape Architect prior to construction.
- The contractor is to stake the proposed location of all plant material in conjunction with the Landscape Architect prior to excavation.
- Minimum distances for selected deciduous trees are as follows:
  - Building Foundations 7.5m
  - Sidewalks 1.5m
  - Public Streets 2.6m
  - Underground Infrastructure 2.0m
- All trees within 1m of underground utility trenches are to be excavated by hand.
- Remove all protective wrapping from tree trunks after installation.
- Staking of trees shall only be performed if necessary.
- Ensure that mulch is pulled back a min. distance of 75mm from base of tree trunk.

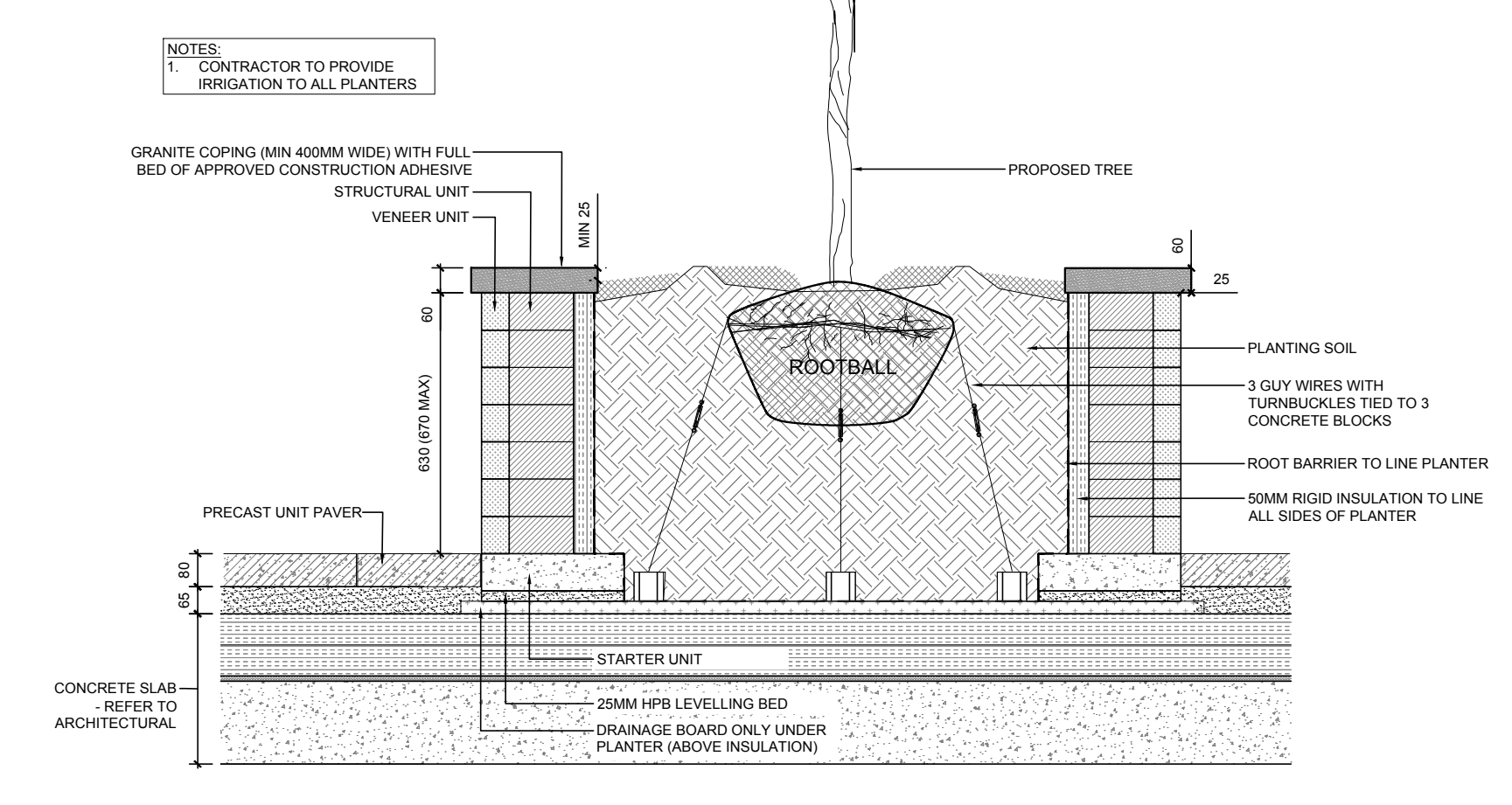

3 L.1 PRECAST CONCRETE PLANTER ON CONCRETE SLAB SCALE: NTS

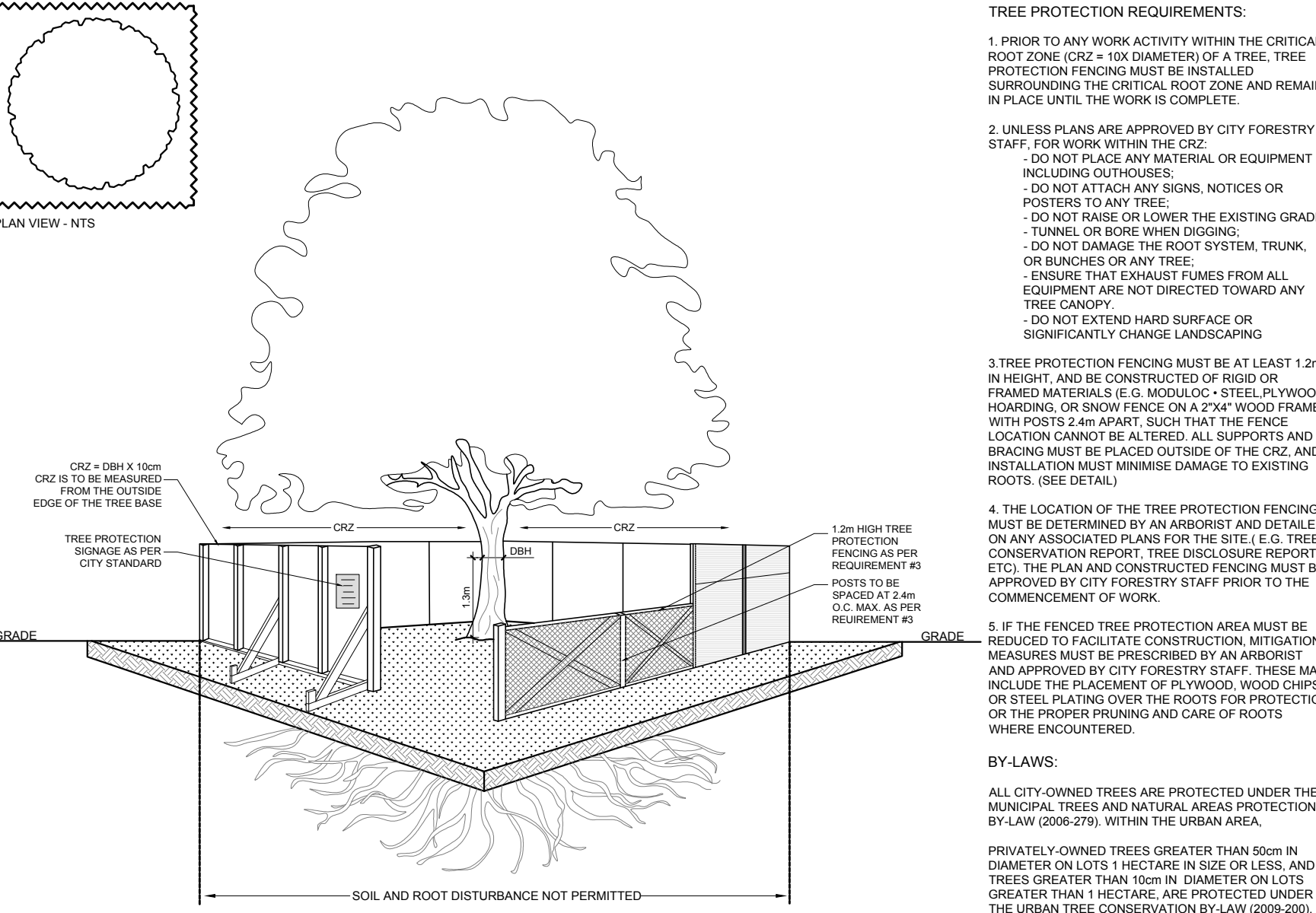

4 L.1 TREE PROTECTION FENCE SCALE: NTS

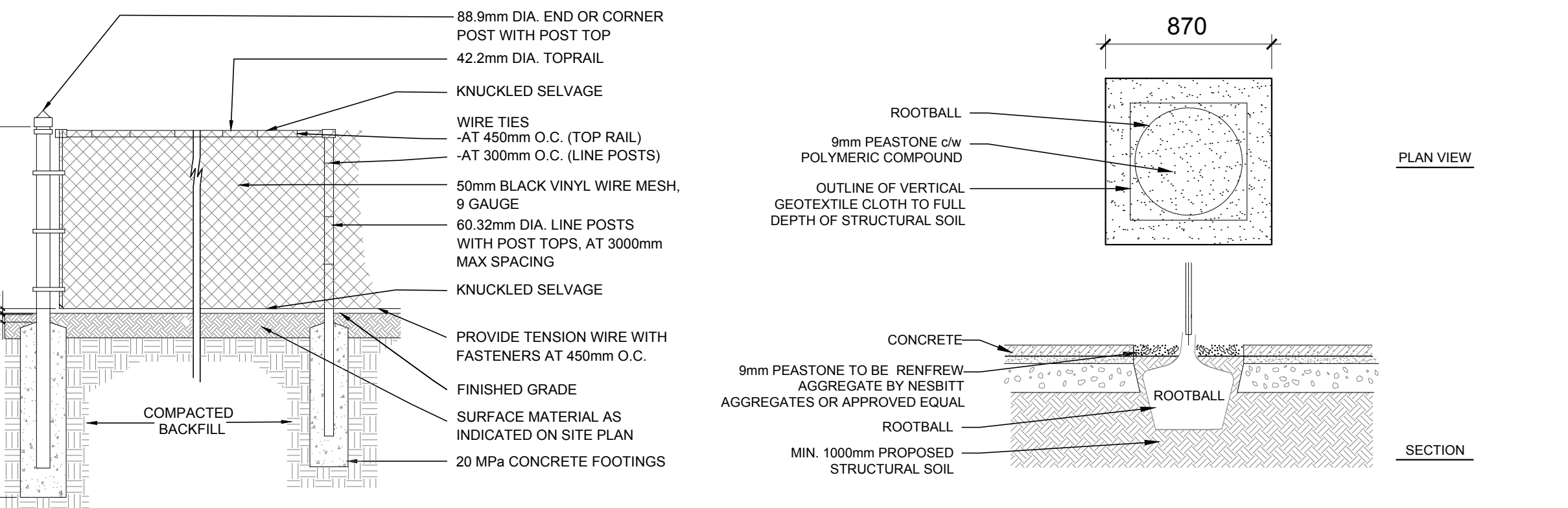

5 L.1 1500mm ht. BLACK VINYL CHAIN LINK FENCE SCALE: NTS

6 L.1 DECIDUOUS TREE PLANTING IN STRUCTURAL SOIL SCALE: NTS

CLIENT

SMART LIVING PROPERTIES

CONSULTANTS

ARCHITECTS: **WOODMAN ARCHITECT & ASSOCIATES LTD.**

SURVEYORS: ANNIS, O'SULLIVAN, VOLLEBEKK LTD. 14 Concourse Gate, Suite 500, Mississauga, Ont. M2E 7S6. Phone: (613) 727-0850 / Fax: (613) 727-1079

CIVIL ENGINEERS: **wsp**

300-3811 QUEENSWAY DRIVE, OTTAWA, ONTARIO, CANADA K2B 9C2. TEL: 1-613-629-2800 / FAX: 1-613-629-5299 / WWW.WSPGROUP.COM

LEGEND

- EXISTING TREE TO REMAIN
- EXISTING TREE TO BE REMOVED
- PROPOSED PLANTING AS PER OWNER'S DISCRETION
- PROPOSED UNIT CONCRETE PAVERS
- PROPOSED 1500mm ht. BLACK VINYL CHAIN LINK FENCE
- PROPOSED TREE PROTECTION FENCE
- PROPOSED SHRUBS / PERENNIALS / ORNAMENTAL GRASSES
- PROPOSED SOD
- PROPOSED DECIDUOUS TREE
- APPROXIMATE LIMIT OF EXCAVATION WITHIN CRITICAL ROOT ZONE

No.	Issue	Date	DR	CK
9	REVISED PER CITY COMMENTS	12/04/2023	ML	JL
8	REVISED PER NEW CIVIL DRAWING	07/18/2023	ML	JL
7	REVISED PER CITY COMMENTS	06/28/2023	ML	JL
6	REVISED PER NEW CIVIL PLAN	02/22/2023	WF	JL
5	REVISED PER NEW SITE PLAN	02/06/2023	ML	JL
4	REVISED PER NEW SITE PLAN	01/27/2023	ML	JL
3	REVISED PER NEW SITE PLAN	01/18/2023	ML	JL
2	ISSUED FOR COMMENTS AND REVIEW	08/27/2021	LC	JL
1	ISSUED FOR COMMENTS AND REVIEW	08/19/2021	LC	JL

JAMES B. LENNOX & ASSOCIATES INC. LANDSCAPE ARCHITECTS. 3332 CARLING AVE. OTTAWA, ONTARIO K2H 5A8. Tel: (613) 722-5168 Fax: (613) 722-5168

PROJECT: 112-134 NELSON STREET REDEVELOPMENT 112-134 NELSON STREET, OTTAWA ON

DRAWING: TREE CONSERVATION REPORT & LANDSCAPE PLAN

STAMP: ASSOCIATION OF LANDSCAPE ARCHITECTS OF ONTARIO MEMBER

SCALE: AS SHOWN

START DATE: JULY 2021

PROJECT NO.: 20-SMT-2175

PROJECT NORTH

DRAWING NO.: L.1

PLOT SIZE ARCH-D