

EXISTING TREE LIST						
KEY	QTY	BOTANICAL NAME	COMMON NAME	SIZE	CONDITION	REMARKS
<b>TREES</b>						
AN	5	Acer negundo	Manitoba Maple	150-600mm DBH	FAIR-GOOD	See plan
AN1	8	Acer negundo	Manitoba Maple	100-400mm DBH	FAIR-GOOD	To be removed
GT	1	Gleditsia triacanthos	Honey Locust	350mm DBH	GOOD	To remain
PN	5	Pinus nigra	Austrian Pine	200-400mm DBH	FAIR-GOOD	To remain
UP	12	Ulmus pumila	Siberian Elm	100-250mm DBH	DEAD-GOOD	See plan
UP1	3	Ulmus pumila	Siberian Elm	100mm DBH	GOOD	To remain
SI	1	Acer saccharinum	Silver Maple	710mm DBH	FAIR	To remain

PROPOSED PLANT LIST						
KEY	QTY	BOTANICAL NAME	COMMON NAME	SIZE	CONDITION	REMARKS
<b>TREES</b>						
HA	1	Crataegus crus-galli var. inermis	Thornless Cockspur Hawthorn	50mm cal.	B&B	Single Leader
JL	2	Syringa reticulata	Japanese Tree Lilac	50mm cal.	B&B	Single Leader
SB	3	Amenanchier canadensis	Serviceberry	50mm cal.	B&B	Single Leader
<b>PERENNIALS AND ORNAMENTAL GRASSES</b>						
DL	40	Hemerocallis 'Stella D'Oro'	Stella D'Oro Daylily	100mm pot	Potted	300 mm o.c.
PD	40	Hemerocallis 'Purple D'Oro'	Purple D'Oro Daylily	100mm pot	Potted	300 mm o.c.

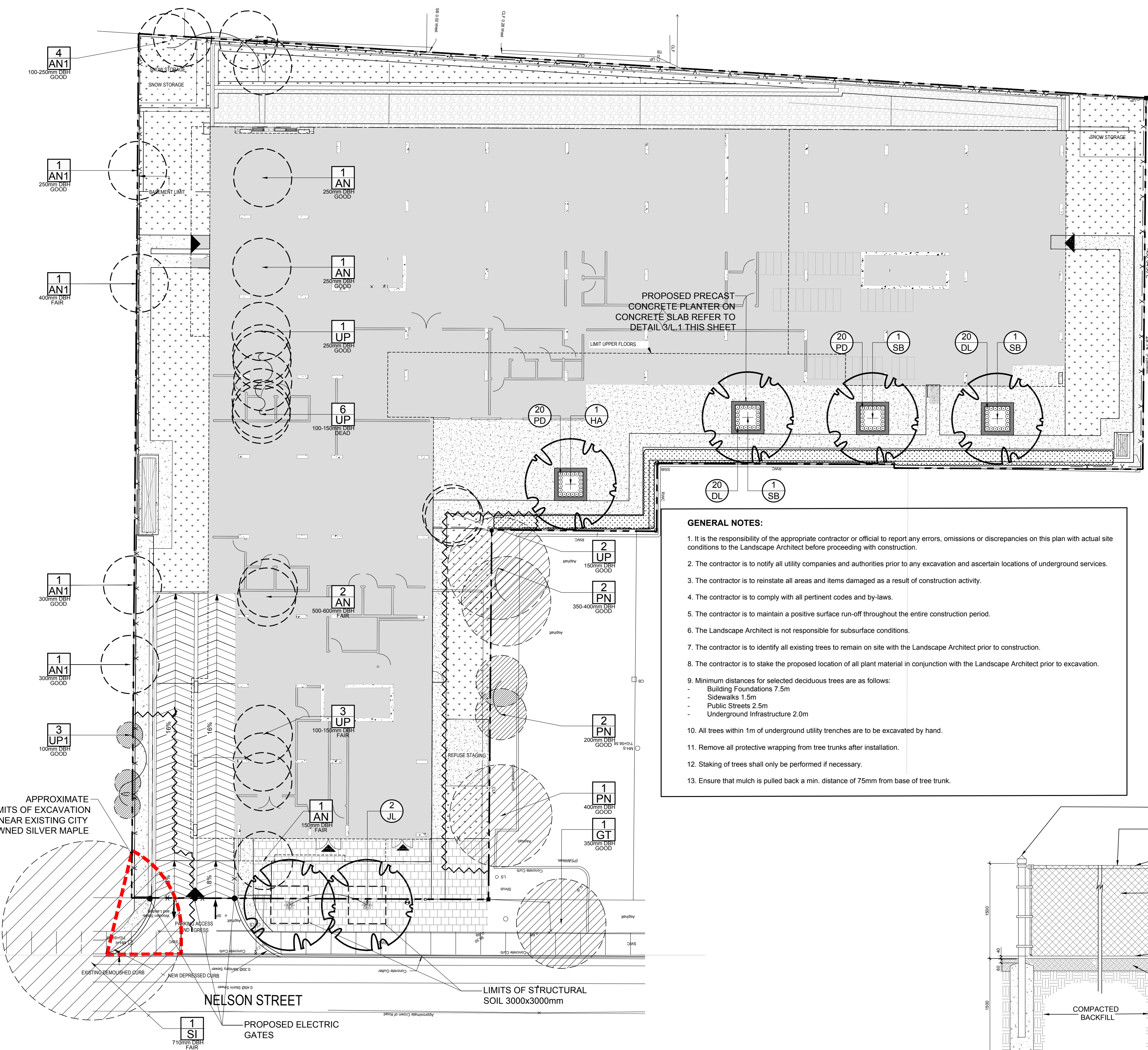

- GENERAL NOTES:**
- It is the responsibility of the appropriate contractor or official to report any errors, omissions or discrepancies on this plan with actual site conditions to the Landscape Architect before proceeding with construction.
  - The contractor is to notify all utility companies and authorities prior to any excavation and ascertain locations of underground services.
  - The contractor is to reinstate all areas and items damaged as a result of construction activity.
  - The contractor is to comply with all pertinent codes and by-laws.
  - The contractor is to maintain a positive surface run-off throughout the entire construction period.
  - The Landscape Architect is not responsible for subsurface conditions.
  - The contractor is to identify all existing trees to remain on site with the Landscape Architect prior to construction.
  - The contractor is to stake the proposed location of all plant material in conjunction with the Landscape Architect prior to excavation.
  - Minimum distances for selected deciduous trees are as follows:
    - Building Foundations 7.5m
    - Sidewalks 1.5m
    - Public Streets 2.5m
    - Underground Infrastructure 2.0m
  - All trees within 1m of underground utility trenches are to be excavated by hand.
  - Remove all protective wrapping from tree trunks after installation.
  - Staking of trees shall only be performed if necessary.
  - Ensure that mulch is pulled back a min. distance of 75mm from base of tree trunk.

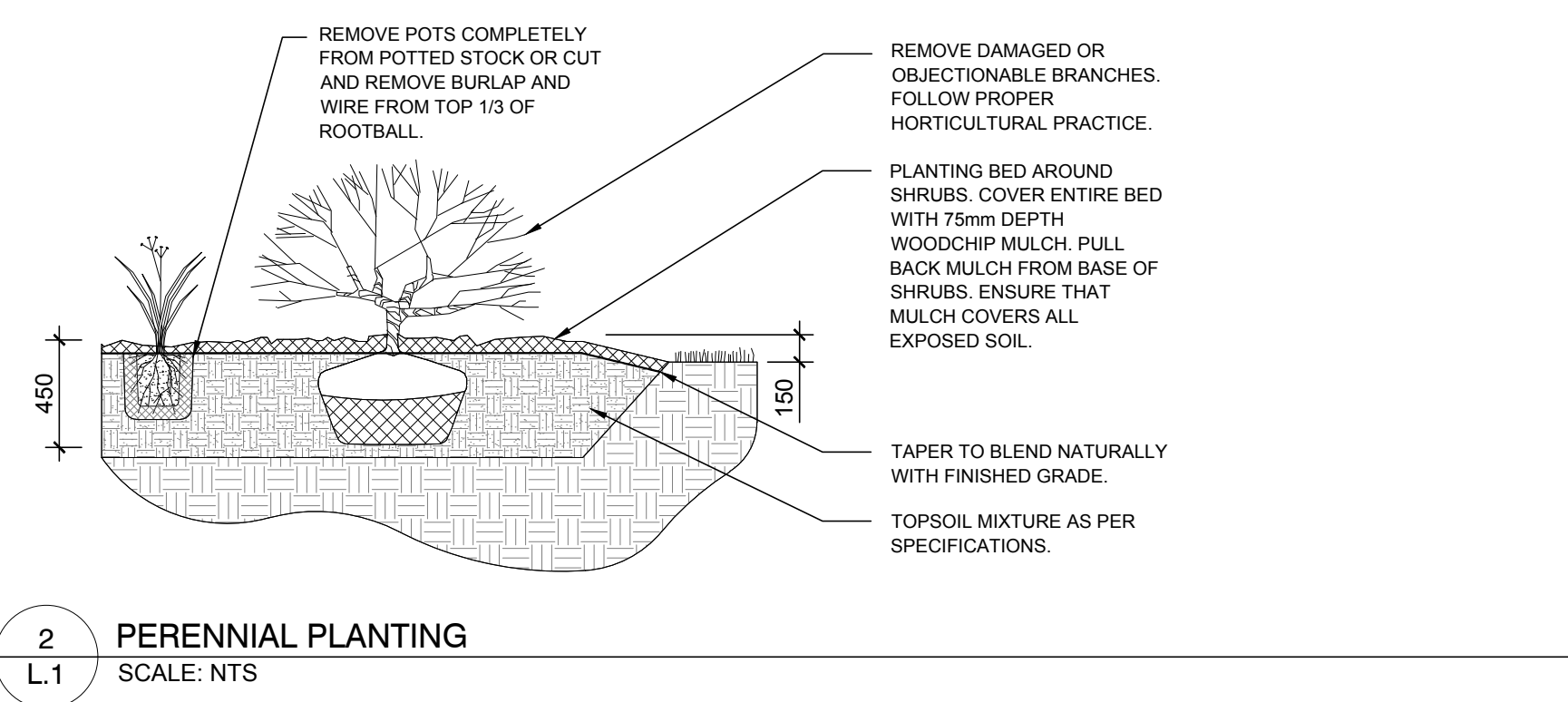
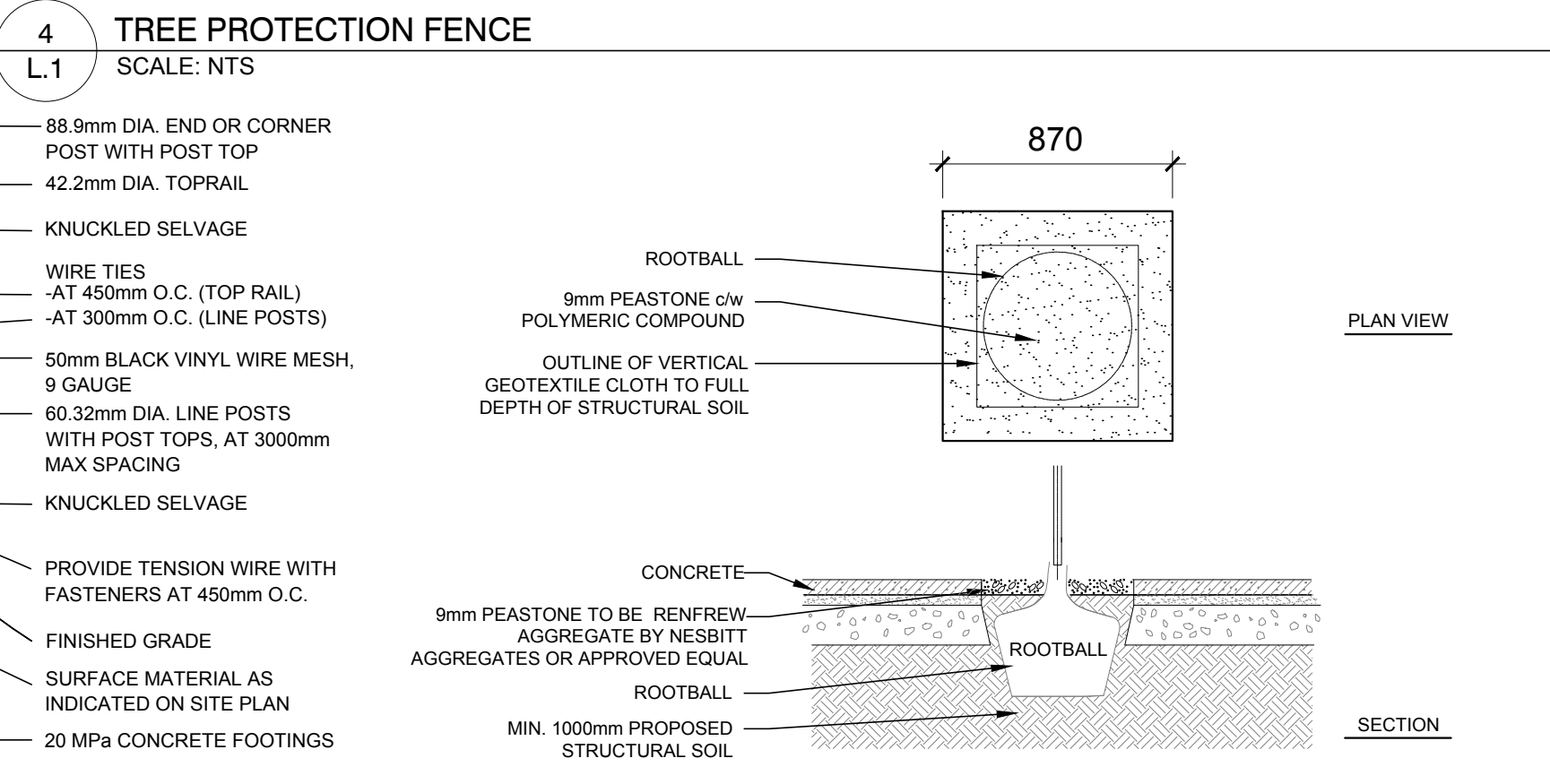
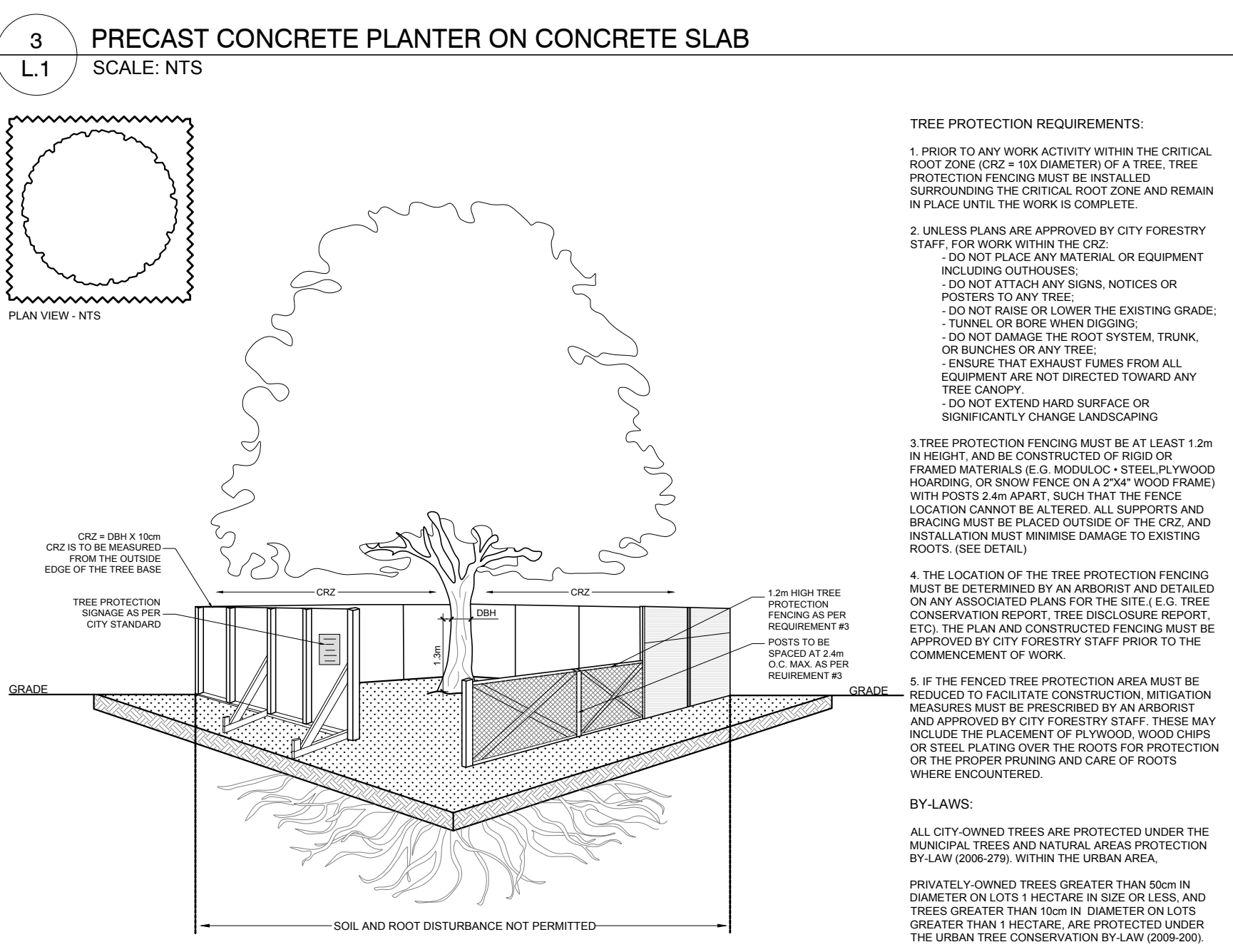
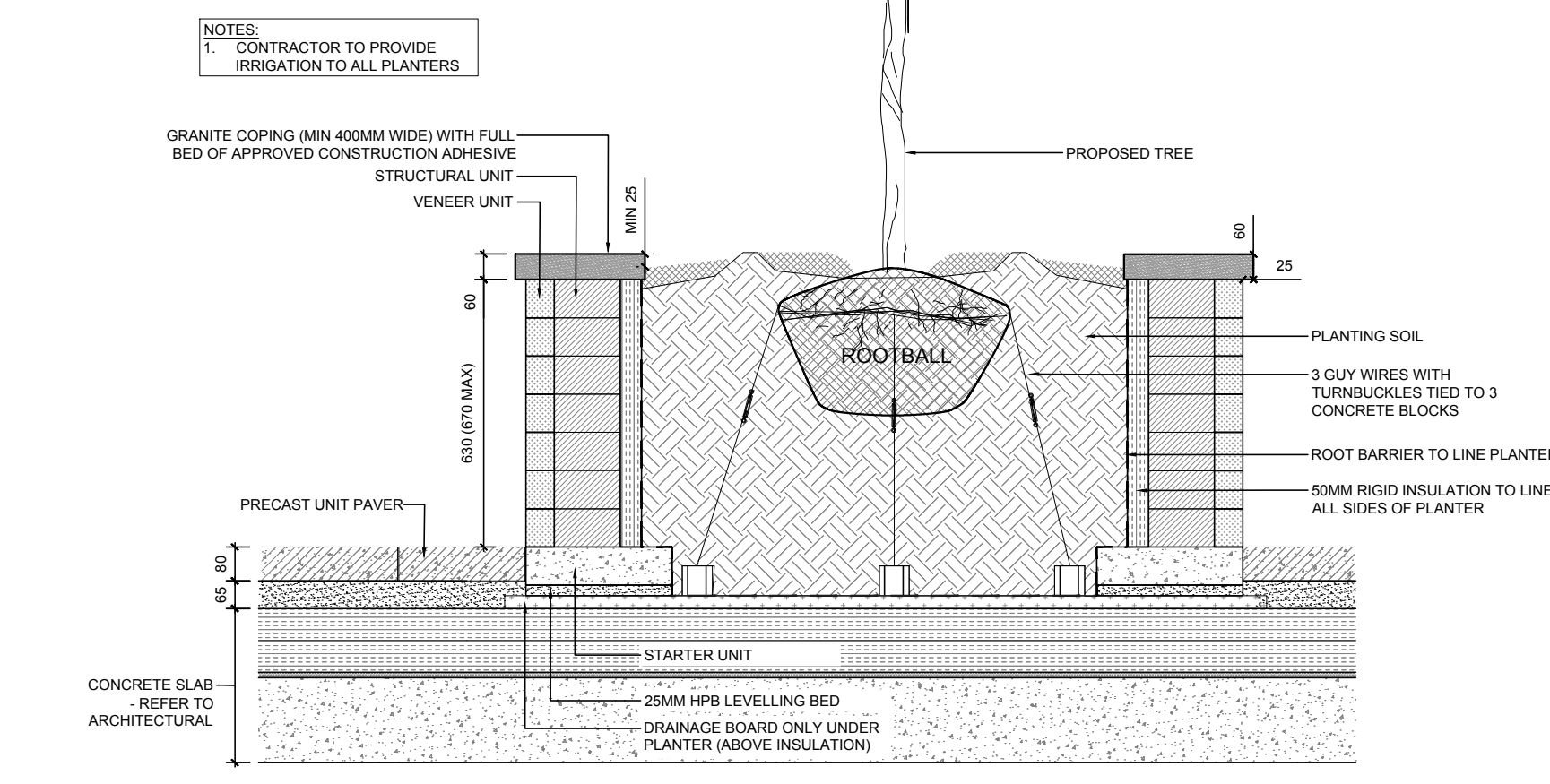

CLIENT

SMART LIVING PROPERTIES

CONSULTANTS ARCHITECTS

**NEUF** ARCHITECTS

SURVEYORS

ANNIS, O'SULLIVAN, VOLLEBECK LTD.  
14 Concourse Gate, Suite 500  
Nepean, Ont. K2E 7S6  
Phone: (613) 727-0650 / Fax: (613) 727-1079

CIVIL ENGINEERS

**wsp**

300-381 QUEENVIEW DRIVE  
OTTAWA, ONTARIO CANADA K2E 9K2  
TEL: 1-813-829-2800 / FAX: 1-813-829-8299 / WWW.WSPGROUP.COM

LEGEND

- EXISTING TREE TO REMAIN
- EXISTING TREE TO BE REMOVED
- PROPOSED PLANTING AS PER OWNER'S DISCRETION
- PROPOSED UNIT CONCRETE PAVERS
- PROPOSED RIVERSTONE
- PROPOSED 1500mm ht. BLACK VINYL CHAIN LINK FENCE
- PROPOSED TREE PROTECTION FENCE
- PROPOSED PERENNIALS
- PROPOSED SOD
- PROPOSED DECIDUOUS TREE
- APPROXIMATE LIMIT OF EXCAVATION WITHIN CRITICAL ROOT ZONE

No.	Issue	Date	DR	CK
10	REVISED PER NEW SITE PLAN	07/08/2024	ML	JL
9	REVISED PER CITY COMMENTS	12/04/2023	ML	JL
8	REVISED PER NEW CIVIL DRAWING	07/18/2023	ML	JL
7	REVISED PER CITY COMMENTS	06/28/2023	ML	JL
6	REVISED PER NEW CIVIL PLAN	02/22/2023	WF	JL
5	REVISED PER NEW SITE PLAN	02/06/2023	ML	JL
4	REVISED PER NEW SITE PLAN	01/27/2023	ML	JL
3	REVISED PER NEW SITE PLAN	01/18/2023	ML	JL
2	ISSUED FOR COMMENTS AND REVIEW	08/27/2021	LC	JL
1	ISSUED FOR COMMENTS AND REVIEW	08/19/2021	LC	JL

**JAMES B. LENNOX & ASSOCIATES INC.**  
LANDSCAPE ARCHITECTS  
3332 CARLING AVE. OTTAWA, ONTARIO K2H 5A8  
Tel. (613) 722-5168 Fax. (1866) 343-3942

PROJECT  
112-134 NELSON STREET REDEVELOPMENT  
112-134 NELSON STREET, OTTAWA ON

DRAWING  
TREE CONSERVATION REPORT & LANDSCAPE PLAN

STAMP

ASSOCIATION OF LANDSCAPE ARCHITECTS OF ONTARIO

SCALE: AS SHOWN

START DATE: JULY 2021

PROJECT NO.: 20-SMT-2175

PROJECT NORTH

DRAWING NO.: **L.1**

PLOT SIZE ARCH-D

1 TREE CONSERVATION REPORT & LANDSCAPE PLAN  
L.1 SCALE: 1:200

5 1500mm ht. BLACK VINYL CHAIN LINK FENCE  
L.1 SCALE: NTS

6 DECIDUOUS TREE PLANTING IN STRUCTURAL SOIL  
L.1 SCALE: NTS

D02-02-21-0076