

DISCLAIMER: COPYRIGHT: THIS DRAWING AND DESIGN IS COPYRIGHT PROTECTED WHICH SHALL NOT BE USED, REPRODUCED OR REVISED WITHOUT WRITTEN PERMISSION BY WSP. THE CONTRACTOR SHALL CHECK AND VERIFY ALL DIMENSIONS AND UTILITY LOCATIONS AND REPORT ALL ERRORS AND OMISSIONS PRIOR TO COMMENCING WORK.



NO.	REVISION	DATE
9	ISSUED FOR CITY COMMENTS	12/09/24
8	ISSUED FOR REVIEW	06/08/24
7	REISSUED FOR SPA	28/06/24
6	REVISED PER CITY COMMENTS	25/07/23
5	REVISED AND ISSUED FOR SPA	17/07/23
4	REVISED AND ISSUED FOR SPA	26/05/23
3	REVISED AND ISSUED FOR SPA	17/02/23
2	REISSUED FOR SPA	08/25/21
1	ISSUED FOR SPA	07/16/21



DISCIPLINE:  
**CIVIL**

PROJECT:  
**112-134 NELSON ST**

DRAWING:  
**SERVICING PLAN**

DATE: 12/09/24

PROJECT NO: 211-04788-00

SCALE: AS NOTED

DRAWING NO: **C03**

DRAWN BY: S.M.

APPROVED BY: I.J.

**ANDREW MCCREIGHT**  
MANAGER, DEVELOPMENT REVIEW CENTRAL  
PLANNING, DEVELOPMENT & BUILDING SERVICES  
DEVELOPMENT DEPARTMENT, CITY OF OTTAWA

**APPROVED**  
By Andrew McCreight at 10:13 am, Oct 15, 2024

MH-H  
TV=59.76

MH-H  
TV=59.77

WEST

LOT 2

pin 04213 - 0152

40m RADIUS FROM EX. HYDRANT

MH-H  
TV=59.37  
INV=56.88

MH-H  
TV=59.36

007-12-21-0015

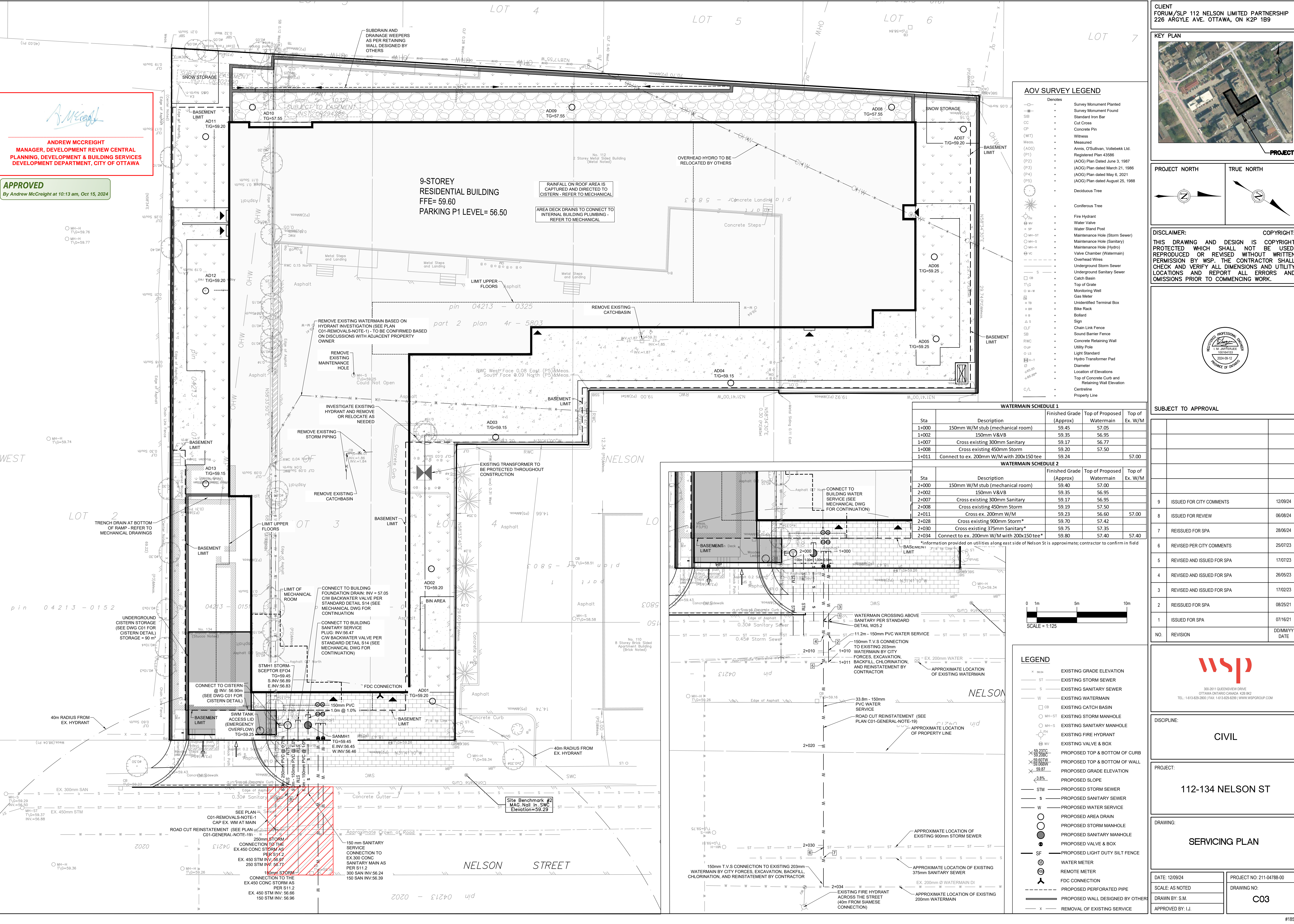

**AOV SURVEY LEGEND**

Denotes

- Survey Monument Planted
- Survey Monument Found
- Standard Iron Bar
- Cast Cross
- Concrete Pin
- Witness
- Measured
- Annis, O'Sullivan, Vollebek Ltd.
- Registered Plan 43586
- (ADG) Plan Dated June 3, 1987
- (P1)
- (P2)
- (P3)
- (P4)
- (P5)
- (ADG) Plan dated March 21, 1986
- (ADG) Plan dated May 8, 2021
- (ADG) Plan dated August 25, 1988
- Deciduous Tree
- Coniferous Tree
- Fire Hydrant
- Water Valve
- Water Stand Post
- Maintenance Hole (Storm Sewer)
- Maintenance Hole (Sanitary)
- Maintenance Hole (Hydro)
- Valve Chamber (Watermain)
- Overhead Wires
- Underground Storm Sewer
- Underground Sanitary Sewer
- Catch Basin
- Top of Grate
- Monitoring Well
- Gas Meter
- Undersized Terminal Box
- Bike Rack
- Bollard
- Sign
- Chain Link Fence
- Sound Barrier Fence
- Concrete Retaining Wall
- Utility Pole
- Light Standard
- Hydro Transformer Pad
- Diameter
- Location of Elevations
- Top of Concrete Curb and Retaining Wall Elevation
- Centreline
- Property Line

**WATERMAIN SCHEDULE 1**

Sta	Description	Finished Grade (Approx)	Top of Proposed Watermain	Top of Ex. W/M
1+000	150mm W/M stub (mechanical room)	59.45	57.05	
1+002	150mm V8V8	59.35	56.95	
1+007	Cross existing 300mm Sanitary	59.17	56.77	
1+008	Cross existing 450mm Storm	59.20	57.50	
1+011	Connect to ex. 200mm W/M with 200x150 tee	59.24		57.00

**WATERMAIN SCHEDULE 2**

Sta	Description	Finished Grade (Approx)	Top of Proposed Watermain	Top of Ex. W/M
2+000	150mm W/M stub (mechanical room)	59.40	57.00	
2+002	150mm V8V8	59.35	56.95	
2+007	Cross existing 300mm Sanitary	59.17	56.95	
2+008	Cross existing 450mm Storm	59.19	57.50	
2+011	Cross ex. 200mm W/M	59.23	56.60	57.00
2+028	Cross existing 900mm Storm*	59.70	57.42	
2+030	Cross existing 375mm Sanitary*	59.75	57.35	
2+034	Connect to ex. 200mm W/M with 200x150 tee*	59.80	57.40	57.40

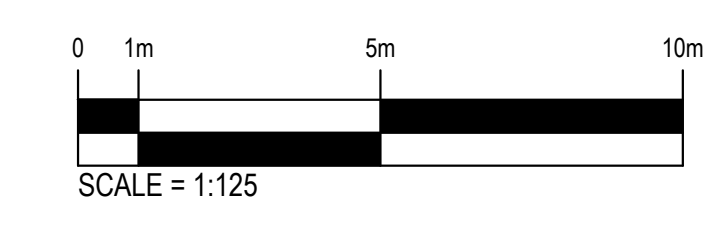

**LEGEND**

- EXISTING GRADE ELEVATION
- EXISTING STORM SEWER
- EXISTING SANITARY SEWER
- EXISTING WATERMAIN
- EXISTING CATCH BASIN
- EXISTING STORM MANHOLE
- EXISTING SANITARY MANHOLE
- EXISTING FIRE HYDRANT
- EXISTING VALVE & BOX
- PROPOSED TOP & BOTTOM OF CURB
- PROPOSED TOP & BOTTOM OF WALL
- PROPOSED GRADE ELEVATION
- PROPOSED SLOPE
- PROPOSED STORM SEWER
- PROPOSED SANITARY SEWER
- PROPOSED WATER SERVICE
- PROPOSED AREA DRAIN
- PROPOSED STORM MANHOLE
- PROPOSED SANITARY MANHOLE
- PROPOSED VALVE & BOX
- PROPOSED LIGHT DUTY SILT FENCE
- WATER METER
- REMOTE METER
- FDC CONNECTION
- PROPOSED PERFORATED PIPE
- PROPOSED WALL DESIGNED BY OTHER
- REMOVAL OF EXISTING SERVICE