

Copyright Reserved  
 The Copyrights to all designs and drawings are the property of Fotenn Consultants Inc. Unauthorized reproduction or use is forbidden. DO NOT SCALE DRAWING  
 Copyright réservés  
 Les droits d'auteur à tous les modèles et dessins sont la propriété de Fotenn Consultants Inc. Reproduction ou utilisation non autorisée est interdite. NE PAS L'ÉCHELLE DE DESSIN

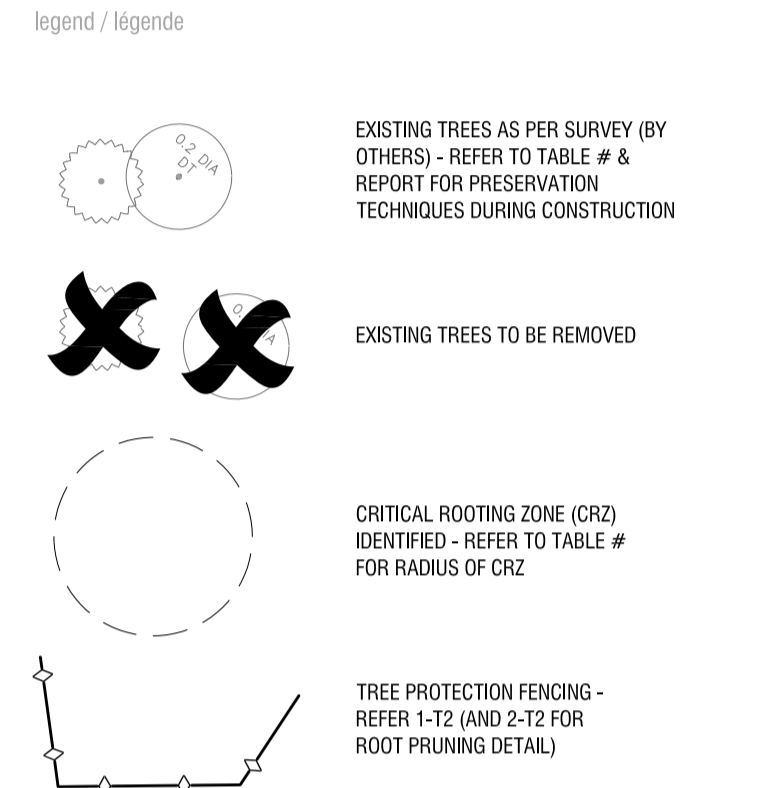

key plan / plan repère



**PRELIMINARY**  
 NOT FOR CONSTRUCTION

rev'n	description / la description	yyyy/mm/dd
01	Issued for SPA	2021/09/01
00	Issued for Team Coordination	2021/08/26

**FOTENN Planning + Design**  
 396 Cooper Street, Suite 300  
 Ottawa, ON, CANADA K2P 2H7  
 613.730.5709  
 fotenn.com

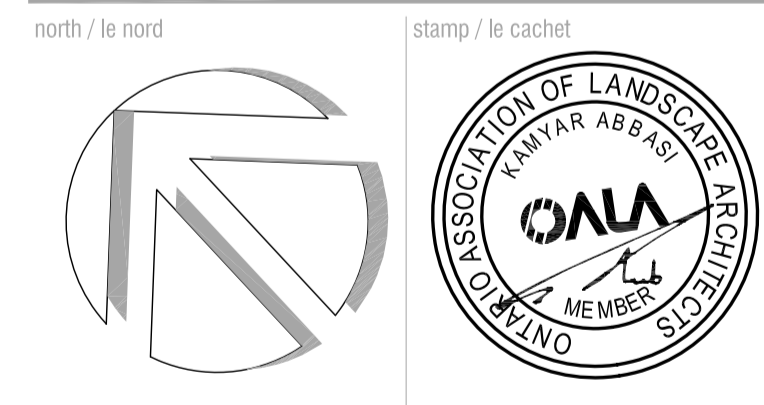

project / projet  
**ENBRIDGE OTTAWA OPERATIONS CENTRE**  
**2571 LANCASTER ROAD**

drawing / dessin

**TREE CONSERVATION PLAN**

designed / conçu	drawn / dessiné	reviewed / examiné
<b>KA</b>	<b>SP / MB</b>	<b>KA</b>
date	project number / No. du projet	

drawing number / No. du dessin

**T1 of 2**

**1**  
**T1**  
**TREE CONSERVATION PLAN**  
**1:500**

SEE FOLLOWING SHEET T2 FOR TREE INVENTORY TABLE >

**THIS PLAN IS APPROVED BY THE CITY OF OTTAWA UNDER SECTION 41 OF THE PLANNING ACT THIS 28 DAY OF SEPTEMBER, 2022.**

**LILY XU, MCIP, RPP, MANAGER**  
**DEVELOPMENT REVIEW SOUTH**  
**PLANNING, INFRASTRUCTURE AND ECONOMIC**  
**DEVELOPMENT DEPARTMENT, CITY OF OTTAWA**

- NOTES:**
- DO NOT SCALE DRAWINGS;
  - NOTES ARE APPLICABLE TO ALL DRAWINGS IN THE SET;
  - Fotenn Consultants Inc. IS NOT RESPONSIBLE FOR ACCURACY OF BASE INFORMATION;
  - THE CONTRACTOR IS RESPONSIBLE FOR CONFIRMING SITE CONDITIONS AND REPORTING ANY DISCREPANCIES TO THE LANDSCAPE ARCHITECT;
  - THE CONTRACTOR IS RESPONSIBLE FOR CONFIRMING EXACT LOCATIONS OF ALL UNDERGROUND SERVICES AND OBTAINING CLEARANCE FROM ALL APPLICABLE UTILITIES;
  - EXISTING TREES INFORMATION ON THE ABOVE PLAN DRAWING AND FOLLOWING TREE INVENTORY TABLE IS EXTRACTED FROM AND TO BE READ IN CONJUNCTION WITH "TREE CONSERVATION REPORT FOR 2571 LANCASTER ROAD, OTTAWA" DATED AUGUST 30 2021 PREPARED BY IFS ASSOCIATES.
  - ANY WORKS WITHIN CRITICAL ROOT ZONE OF THE RETAINED TREES NEEDS TO BE UNDERTAKEN BY HAND AND/OR LIGHT EQUIPMENT TO THE SATISFACTION OF THE ARBORIST/LANDSCAPE ARCHITECT. SEE ALSO NOTE (5) ON #1/T2 FOR MORE INFORMATION.

