

DATE	ISSUED WITH SD REPORT	ISSUANCE	NO.
2021.07.05	ISSUED WITH SD REPORT		
2021.08.25	ISSUED FOR SITE PLAN CONTROL		

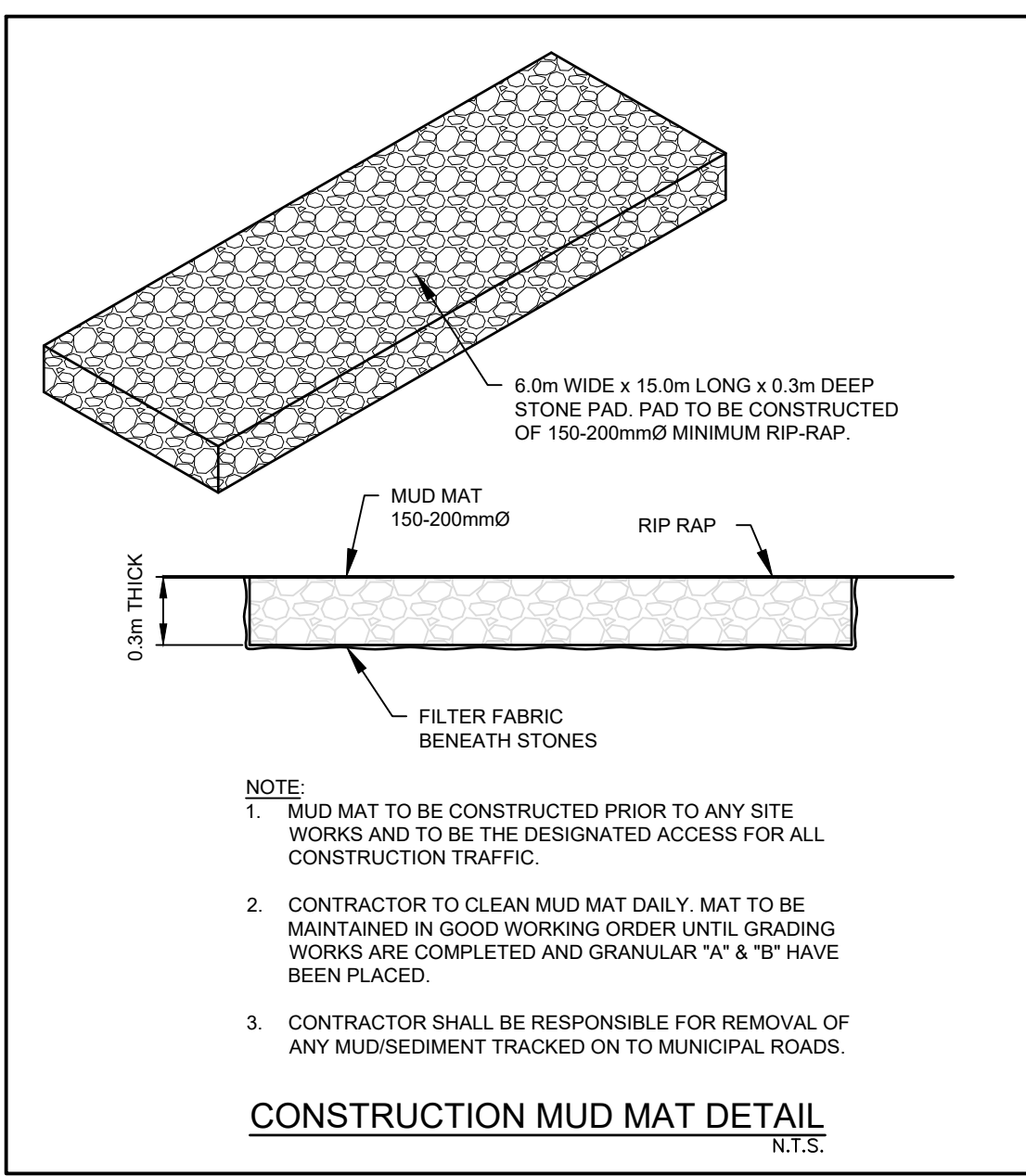

- GENERAL NOTES**
- LEGAL BOUNDARY DATA AND TOPOGRAPHICAL INFORMATION OF 2571 AND 2585 LANCASTER ROAD, OTTAWA, ONTARIO FROM SURVEY BY J.D. BARNES LIMITED, DATED MAY 19, 2021.
 - BOREHOLE LOCATIONS AND GEOTECHNICAL INFORMATION FROM REPORT BY MALROZ ENGINEERING INC. DATED JULY 19, 2021.
 - THIS SET OF PLANS SHALL NOT BE USED FOR CONSTRUCTION UNTIL STAMPED BY THE DESIGN ENGINEER AND APPROVED BY THE LOCAL MUNICIPALITY.
 - NO CHANGES ARE TO BE MADE WITHOUT THE APPROVAL OF THE DESIGN ENGINEER.
 - THIS PLAN NOT TO BE REPRODUCED IN WHOLE OR IN PART WITHOUT THE PERMISSION OF WALTERFEDY.
 - THE POSITION OF POLE LINES, CONDUITS, WATERMANS, SEWERS, AND OTHER UNDERGROUND AND OVERGROUND UTILITIES AND STRUCTURES IS NOT NECESSARILY SHOWN ON THE CONTRACT DRAWINGS AND, WHERE SHOWN, THE ACCURACY OF THE POSITION OF SUCH UTILITIES AND STRUCTURES IS NOT GUARANTEED. BEFORE STARTING WORK, THE CONTRACTOR SHALL INFORM THEMSELVES OF THE EXACT LOCATION OF ALL SUCH UTILITIES AND STRUCTURES AND SHALL ASSUME ALL LIABILITY FOR DAMAGE TO THEM AND THOSE NOT LOCATED PRIOR TO CONSTRUCTION.
 - ANY AREA DISTURBED DURING CONSTRUCTION SHALL BE RESTORED TO ITS ORIGINAL CONDITION OR BETTER TO THE SATISFACTION OF THE CONSULTANT AND AUTHORITY HAVING JURISDICTION. THE CONTRACTOR IS RESPONSIBLE FOR RESTORING ALL DAMAGED AND/OR DISTURBED PROPERTY WITHIN THE MUNICIPAL RIGHT-OF-WAY TO MUNICIPAL STANDARDS.
 - ALL HEALTH AND SAFETY RELATED SIGNAGE MUST BE POSTED AT THE SITE AS REQUIRED BY APPLICABLE LAW AND BEST MANAGEMENT PRACTICES.
 - AT THE END OF CONSTRUCTION, THE CONTRACTOR SHALL PROVIDE THE CONSULTANT WITH A DIGITAL FILE OF AS-CONSTRUCTED DRAWINGS. THE DRAWINGS MUST REFLECT THE CONSTRUCTED STATE OF THE WORK. SUBMISSION OF UNALTERED DESIGN DRAWINGS AND CONTRACT CHANGES WILL NOT BE ACCEPTED.

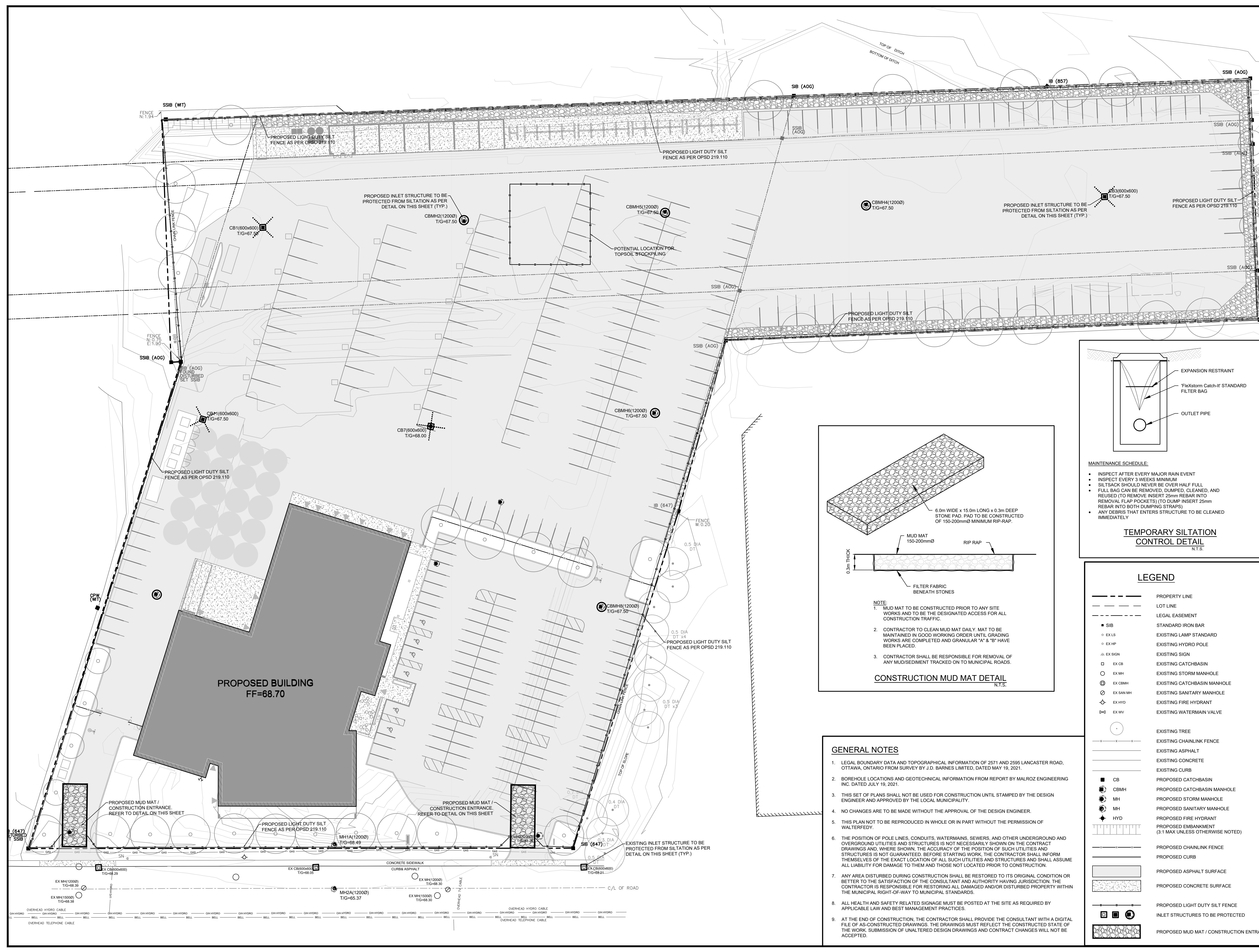
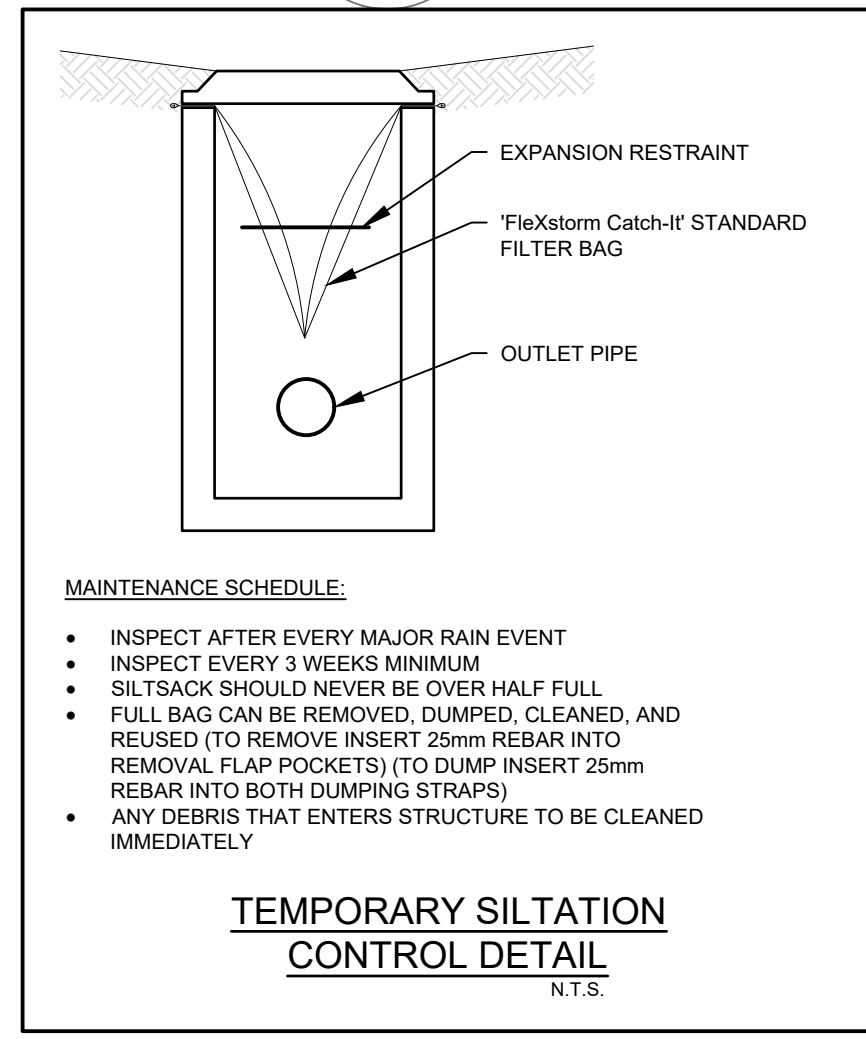

- MAINTENANCE SCHEDULE:**
- INSPECT AFTER EVERY MAJOR RAIN EVENT
 - INSPECT EVERY 3 WEEKS MINIMUM
 - SILTSACK SHOULD NEVER BE OVER HALF FULL
 - FULL BAGS CAN BE REMOVED, DUMPED, CLEANED, AND REUSED (TO REMOVE INSERT 25mm REBAR INTO REMOVAL FLAP POCKETS) (TO DUMP INSERT 25mm REBAR INTO BOTH DUMPING STRAPS)
 - ANY DEBRIS THAT ENTERS STRUCTURE TO BE CLEANED IMMEDIATELY

LEGEND

---	PROPERTY LINE
---	LOT LINE
---	LEGAL EASEMENT
■ SIB	STANDARD IRON BAR
○ EX LLS	EXISTING LAMP STANDARD
○ EX HP	EXISTING HYDRO POLE
△ EX SIGN	EXISTING SIGN
□ EX CB	EXISTING CATCHBASIN
○ EX MH	EXISTING STORM MANHOLE
⊙ EX CBMH	EXISTING CATCHBASIN MANHOLE
⊙ EX SAN MH	EXISTING SANITARY MANHOLE
⊙ EX HYD	EXISTING FIRE HYDRANT
⊙ EX WW	EXISTING WATERMAIN VALVE
○	EXISTING TREE
---	EXISTING CHAINLINK FENCE
---	EXISTING ASPHALT
---	EXISTING CONCRETE
---	EXISTING CURB
■ CB	PROPOSED CATCHBASIN
⊙ CBMH	PROPOSED CATCHBASIN MANHOLE
⊙ MH	PROPOSED STORM MANHOLE
⊙ MH	PROPOSED SANITARY MANHOLE
⊙ HYD	PROPOSED FIRE HYDRANT
---	PROPOSED EMBANKMENT (3:1 MAX UNLESS OTHERWISE NOTED)
---	PROPOSED CHAINLINK FENCE
---	PROPOSED CURB
---	PROPOSED ASPHALT SURFACE
---	PROPOSED CONCRETE SURFACE
---	PROPOSED LIGHT DUTY SILT FENCE
⊙	INLET STRUCTURES TO BE PROTECTED
---	PROPOSED MUD MAT / CONSTRUCTION ENTRANCE

CLIENT
ENBRIDGE INC.

500 CONSUMERS RD, NORTH YORK, ON

PROJECT
OTTAWA OPERATIONS CENTRE
2571 LANCASTER RD, OTTAWA, ON

TITLE
EROSION AND SEDIMENT CONTROL PLAN

WALTERFEDY
KITCHENER HAMILTON 800.685.1378 walterfedy.com



REPRODUCTION OR DISTRIBUTION FOR PURPOSES OTHER THAN AUTHORIZED BY WALTERFEDY IS FORBIDDEN. CONTRACTORS SHALL VERIFY AND BE RESPONSIBLE FOR ALL DIMENSIONS AND CONDITIONS ON THE JOB AND REPORT ANY VARIATIONS FROM THE DIMENSIONS AND CONDITIONS SHOWN ON DRAWINGS TO WALTERFEDY. DO NOT SCALE THIS DRAWING.

COPYRIGHT © 2021 WalterFedy

SCALE: 1:400 SHEET NO.:
DATE: 2021-08-24
PROJECT NO.: 2020-0566-10
CAD FILE: 2020-0566-10_ESC_PLOT
DRAWN BY: TK
CHECKED BY: JZ