

**1** TREE CONSERVATION PLAN  
**T1** 1:500

SEE FOLLOWING SHEET T2 FOR TREE INVENTORY TABLE >

- NOTES:**
- DO NOT SCALE DRAWINGS;
  - NOTES ARE APPLICABLE TO ALL DRAWINGS IN THE SET;
  - Fotenn Consultants Inc. IS NOT RESPONSIBLE FOR ACCURACY OF BASE INFORMATION;
  - THE CONTRACTOR IS RESPONSIBLE FOR CONFIRMING SITE CONDITIONS AND REPORTING ANY DISCREPANCIES TO THE LANDSCAPE ARCHITECT;
  - THE CONTRACTOR IS RESPONSIBLE FOR CONFIRMING EXACT LOCATIONS OF ALL UNDERGROUND SERVICES AND OBTAINING CLEARANCE FROM ALL APPLICABLE UTILITIES;
  - EXISTING TREES INFORMATION ON THE ABOVE PLAN DRAWING AND FOLLOWING TREE INVENTORY TABLE IS EXTRACTED FROM AND TO BE READ IN CONJUNCTION WITH "TREE CONSERVATION REPORT FOR 2571 LANCASTER ROAD, OTTAWA" DATED AUGUST 30 2021 PREPARED BY IFS ASSOCIATES.
  - ANY WORKS WITHIN CRITICAL ROOT ZONE OF THE RETAINED TREES NEEDS TO BE UNDERTAKEN BY HAND AND/OR LIGHT EQUIPMENT TO THE SATISFACTION OF THE ARBORIST/LANDSCAPE ARCHITECT. SEE ALSO NOTE (5) ON #1/T2 FOR MORE INFORMATION.

Copyright Reserved  
 The Copyrights to all designs and drawings are the property of Fotenn Consultants Inc. Unauthorized reproduction or use is forbidden. DO NOT SCALE DRAWING  
 Copyright réservés  
 Les droits d'auteur à tous les modèles et dessins sont la propriété de Fotenn Consultants Inc. Reproduction ou utilisation non autorisée est interdite. NE PAS L'ÉCHELLE DE DESSIN



key plan / plan repère

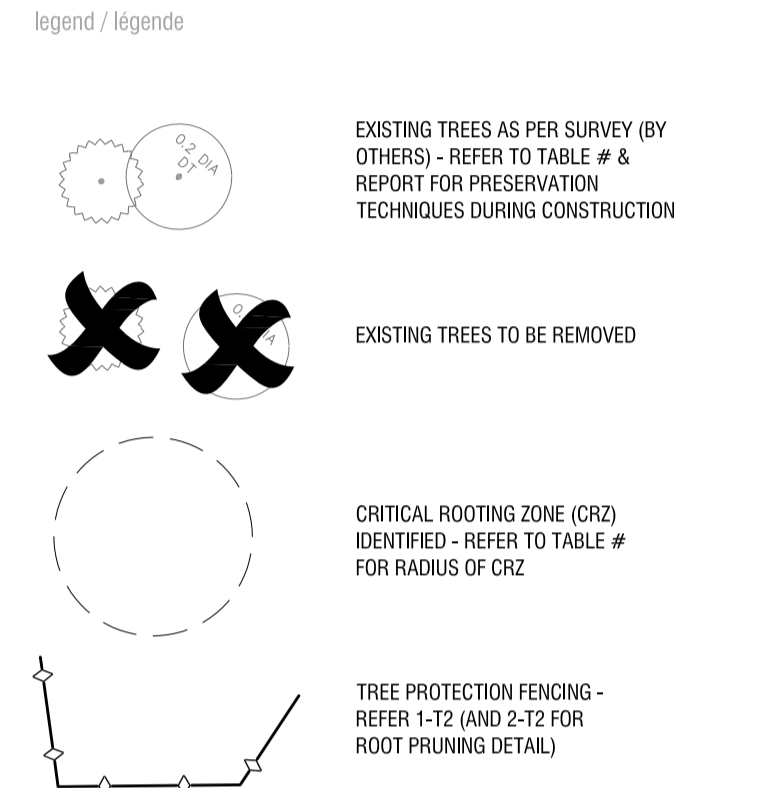

**PRELIMINARY**  
 NOT FOR CONSTRUCTION

rev'n	description / la description	yyyy/mm/dd
01	Issued for SPA	2021/09/01
00	Issued for Team Coordination	2021/08/26

**FOTENN Planning + Design**  
 396 Cooper Street, Suite 300  
 Ottawa, ON, CANADA K2P 2H7  
 613.730.5709  
 fotenn.com

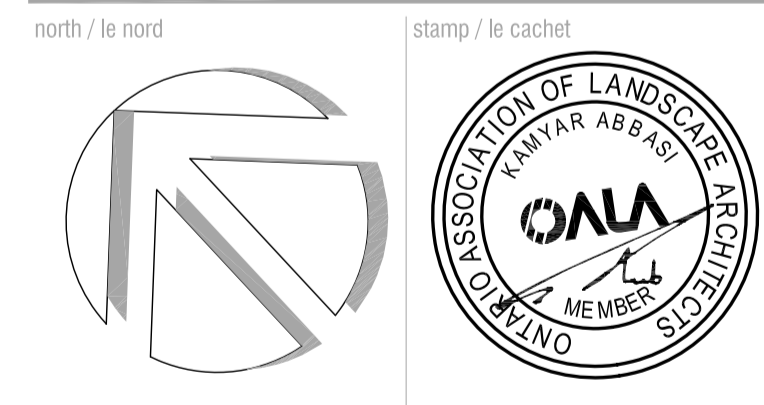

project / projet  
**ENBRIDGE OTTAWA OPERATIONS CENTRE**  
**2571 LANCASTER ROAD**

drawing / dessin

**TREE CONSERVATION PLAN**

designed / conçu	drawn / dessiné	reviewed / examiné
<b>KA</b>	<b>SP / MB</b>	<b>KA</b>
date	project number / No. du projet	

drawing number / No. du dessin

**T1 of 2**



TABLE 1: TREE INVENTORY AND ASSESSMENT						
NO.	SPECIES	D.B.H. <sup>1</sup> (cm)	OWNERSHIP	TREE CONDITION	STATUS <sup>2</sup>	CRZ <sup>3</sup> (m)
1	Eastern cottonwood ( <i>Populus deltoides</i> )	43	Private	Good; Maturing; central dominant stem with suppressed laterals starting at 2m from grade; native species	To be removed	4.3
2	Russian-olive ( <i>Elaeagnus angustifolia</i> )	30	Private	Fair; Mature; co-dominant leaders; divergent; introduced invasive species	To be removed	3.0
3	Manitoba Maple ( <i>Acer negundo</i> )	35	Private	Fair; Mature; divergent form; originated from seed; naturalized species	To be removed	3.5
4	Balsam poplar ( <i>Populus balsamifera</i> )	30	Private	Fair; Maturing; upright form; competing leaders; native species	To be removed	3.0
5	Balsam poplar	25	Private	Fair; Maturing; upright form; competing leaders	To be removed	2.5
6	Eastern cottonwood	76	Private	Good; Mature; central stem with competing lateral on east at 4m and suppressed at 2.5m on west	To be removed	7.6
7	Golden weeping willow ( <i>Salix alba</i> var. <i>vitellina</i> )	>100	Neighbour	Very poor; Overmature; double-stemmed from grade; north stem topped at +/-10m, south stem multi-stemmed at 2m - one dead, one broken; tree is senescent; cultivar	To be preserved and protected (but should be pruned from over 2571)	10.0
8	Golden weeping willow	+/-60	Neighbour	Poor; Mature; tri-stemmed at 1m - one dead towards 2571, one broken and hung up in crown	To be preserved and protected (but should be pruned from over 2571)	6.0
9	Golden weeping willow	+/-100	Neighbour	Poor; Overmature; multiple co-dominant stems at 2.5m - one dead towards 2571	To be preserved and protected (but should be pruned from over 2571)	10.0
10	Norway maple ( <i>Acer platanoides</i> )	+/-40	Neighbour	Poor; Mature; central stem dead, lateral towards south now dominant; introduced invasive species	To be preserved and protected	4.0
11	Colorado spruce ( <i>Picea pungens</i> )	32	Private	Poor; Mature; leader dead; fair crown density, growth increment and needle colour below; restricted rooting area; introduced species	To be removed	3.2
12	Colorado spruce	30	Private	Poor; Mature; leader dead; fair density, increment and colour below; restricted rooting area	To be removed	3.0
13	Colorado spruce	26	Private	Good; Mature; narrow, upright form; good density, increment and colour	To be removed	2.6
14	Colorado spruce	34	Private	Good; Mature; lower crown asymmetric; good density, increment and colour	To be removed	3.4
15	Colorado spruce	35	Private	Fair; Mature; planting ropes still present; poor density, fair increment and colour	To be removed	3.5
16	Colorado spruce	25	Private	Fair; Mature; lower crown asymmetric; fair density, good increment and colour	To be removed	2.5
17	Colorado spruce	32	Private	Good; Mature; lower crown thin due to intercompetition for sunlight; good density, increment and colour above	To be removed	3.2
18	Colorado spruce	31	Private	Fair; Mature; fair crown density, growth increment and needle colour; restricted rooting area	To be removed	3.1
19	Colorado spruce	29	Private	Fair; Mature; fair crown density, growth increment and needle colour; restricted rooting area	To be removed	2.9
20	Colorado spruce	35 (at 0.5m)	Private	Fair; Mature; double stemmed at 1.4m; lower crown thin due to intercompetition; good density, increment and colour above	To be removed	3.5
21	Colorado spruce	31	Private	Fair; Mature; lower crown thin due to intercompetition; good density, increment and colour above	To be removed	3.1
22	Colorado spruce	33 (at 0.5m)	Private	Fair; Mature; double stemmed at 1.3m; fair density, increment and colour; restricted rooting area	To be removed	3.3
23	Colorado spruce	30	Private	Fair; Mature; fair density, increment and colour; scattered dead branches due to cytospora canker ( <i>Cytospora canker</i> var. <i>picca</i> ); restricted rooting area	To be removed	3.0
24	Colorado spruce	29	Private	Good; Mature; good density, increment and colour; restricted rooting area	To be removed	2.9
25	Colorado spruce	22	Private	Poor; Mature; leader dead; many scattered dead branches due to cytospora canker; poor density, fair increment and colour; restricted rooting area	To be removed	2.2
26	Colorado spruce	23 & 25	Private	Fair; Mature; double stemmed at grade; good density, increment and colour; lower crown asymmetric; fair density, increment and colour	To be removed	2.3 & 2.5
27	Colorado spruce	34	Private	Fair; Mature; co-dominant leaders at 4m; many scattered dead branches due to cytospora canker; poor density, fair increment and colour	To be removed	3.4
28	Red maple ( <i>Acer rubrum</i> )	23	Private	Fair; Mature; thin crown with chlorotic foliage; very restricted and compacted rooting area; fair density, increment and colour; native species	To be removed	2.3
29	Colorado spruce	34 (at 0.2m)	Private	Fair; Mature; tri-stemmed at 0.7m - central stem with two competing laterals; fair density, increment and colour; restricted rooting area	To be removed	3.4
30	Colorado spruce	35 (at 1m)	Private	Fair; Mature; double stemmed at 1.4m; scattered dead branches due to cytospora canker; fair density, good increment and colour	To be removed	3.5
31	Colorado spruce	30	Private	Poor; Mature; very poor density (only holding 50 percent living foliage); fair increment and colour; restricted rooting area	To be removed	3.0
32	Colorado spruce	27	Private	Fair; Mature; fair density, increment and colour; crown asymmetric; restricted rooting area	To be removed	2.7
33	Colorado spruce	30	Private	Fair; Mature; leader dead; fair density, increment and colour; divergent towards southwest	To be removed	3.0
34	Colorado spruce	26	Private	Poor; Mature; leader dead; many scattered dead branches due to cytospora canker; poor density, fair increment and colour	To be removed	2.6
35	White elm ( <i>Ulmus americana</i> )	54	City	Good; Mature; tri-dominant stems at 3m; lower crown asymmetric towards southwest; no outward signs of Dutch elm disease ( <i>Ophiostoma novo-ulmi</i> ); native species	To be preserved and protected	5.4
36	Norway maple	+/-30	Neighbour	Fair; Mature; single dominant stem for most of height; crown asymmetric towards southeast	To be preserved and protected	3.0
37	Manitoba maple	+/-70	Neighbour	Dead; Mature; has grown through chain link fence	Recommended for removal (hazardous)	7.0
38	Norway maple	+/-40	Neighbour	Fair; Mature; central stem with two competing laterals at 1.5 and 2m on south	To be preserved and protected	4.0
39	Honey-locust ( <i>Gleditsia triacanthos</i> )	+/-40	Neighbour	Good; Mature; co-dominant leaders at 3m with competing laterals at 2m, broad, asymmetric crown towards south; introduced species	To be preserved and protected	4.0
40	Honey-locust	+/-30	Neighbour	Fair; Mature; central stem with competing laterals starting at 1.5m; generally symmetric crown	To be preserved and protected	3.0
41	Honey-locust	+/-25	Neighbour	Fair; Mature; asymmetric towards southeast/southwest due to shading from nearby maple; physical injury to lower crown from piling of snow	To be preserved and protected	2.5
42	Norway maple	+/-50	Neighbour	Fair; Mature; central stem with competing laterals on south and west; physical injury to lower crown from piling of snow	To be preserved and protected	5.0
43	Norway maple	+/-30	Neighbour	Poor; Mature; central stem dead, lateral on northwest now dominant; physical injury to stem and lower crown from piling of snow	To be preserved and protected	3.0
44	Norway maple	+/-25	Neighbour	Poor; Mature; branch cluster at 2m - central stem dead, laterals dominant	To be preserved and protected	2.5
45	Norway maple	+/-25	Neighbour	Fair; Mature; co-dominant stems at 2m with two suppressed stems; generally upright form; physical injury to stem and lower crown from piling of snow	To be preserved and protected	2.5
46	Norway maple	+/-25	Neighbour	Fair; Mature; co-dominant stems at 3m - central with competing lateral on southeast	To be preserved and protected	2.5
47	White cedar ( <i>Thuja occidentalis</i> )	+/-10	Neighbour	Poor - Fair; Mature; hedge form; seedling deciduous trees and restricted rooting area causing trees to decline; native species	To be preserved and protected	1.0
48	Ash species ( <i>Fraxinus</i> spp.)	31	Shared	Dead; Mature; dead due to emerald ash borer ( <i>Agrilus planipennis</i> ); native species	Recommended for removal (hazardous)	3.1
49	Mixed species: ash ( <i>Fraxinus</i> spp.), willow, white elm, Manitoba and amur maple ( <i>Acer tataricum</i> subsp. <i>giraldii</i> ), trembling aspen ( <i>Populus tremuloides</i> )	>10	Privacy	Good to Poor; Immature to maturing; tree composition primarily trembling aspen and ash (45 and 35 percent respectively by stem count) - aspen generally in good condition, ash mostly infested with emerald ash borer; shrub layer mainly buckthorn ( <i>Rhamnus</i> spp.), ash, dogwood ( <i>Cornus</i> spp.) and honeysuckle ( <i>Lonicera</i> spp.)	Entire area to be cleared of vegetation	1.0

<sup>1</sup> D.B.H.: INDICATES DIAMETER (cm) MEASUREMENT AT BREAST HEIGHT (1.3m ABOVE GRADE);  
<sup>2</sup> TO BE RETAINED OR REMOVED  
<sup>3</sup> CRZ: INDICATES RADIUS OF CRITICAL ROOTING ZONE AND IS ESTABLISHED AS BEING 10 CENTIMETERS FROM THE TRUNK OF A TREE FOR EVERY 1 CENTIMETER OF TRUNK DIAMETER AT BREAST HEIGHT (DBH). THE CRZ IS CALCULATED AS DBH x 10cm  
 REFER TO RECOMMENDATIONS IN REPORT PREPARED BY IFS ASSOCIATES FOR TECHNIQUES TO PRESERVE TREES.

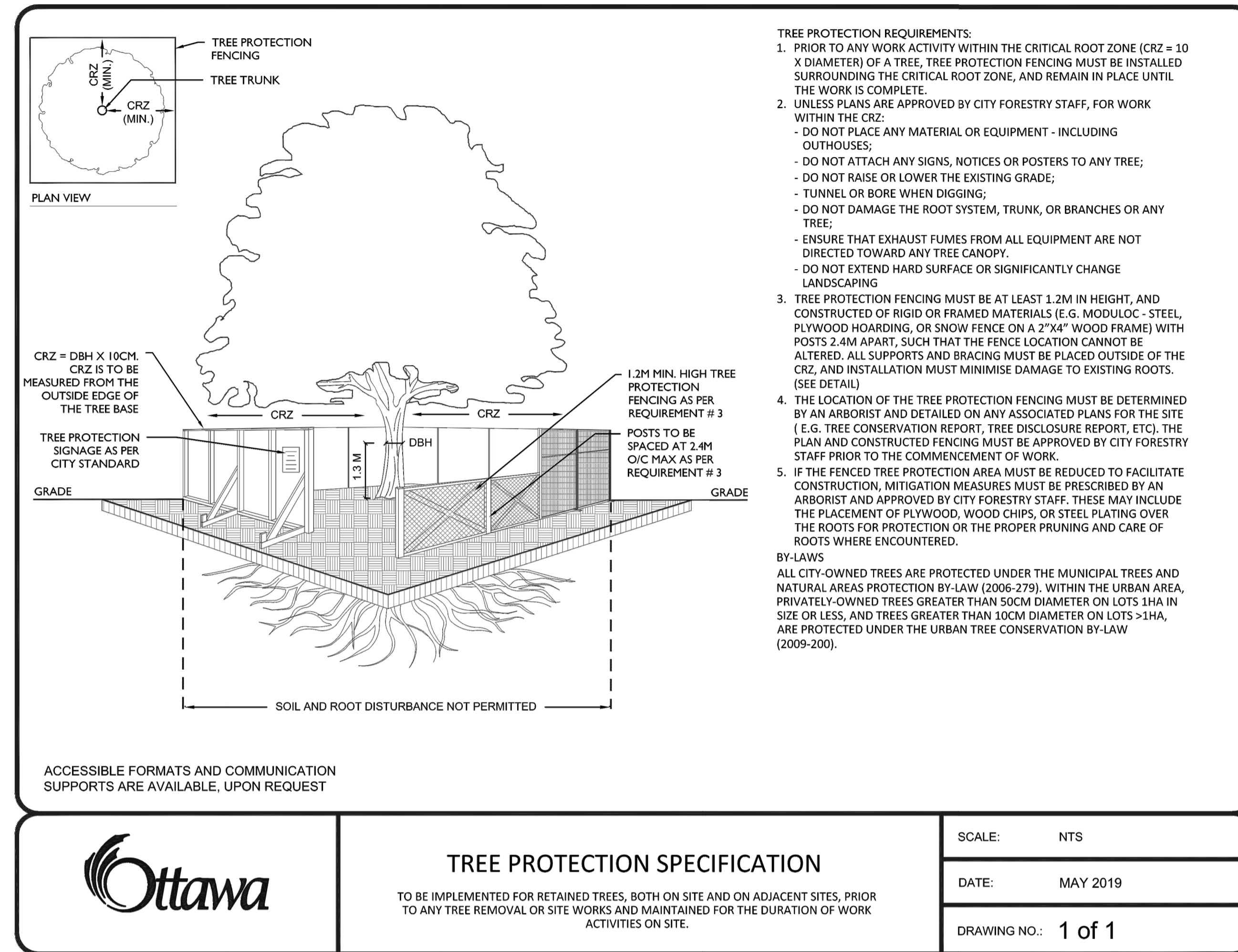

## 1 TREE PROTECTION FENCING DETAIL

T2 n.t.s.

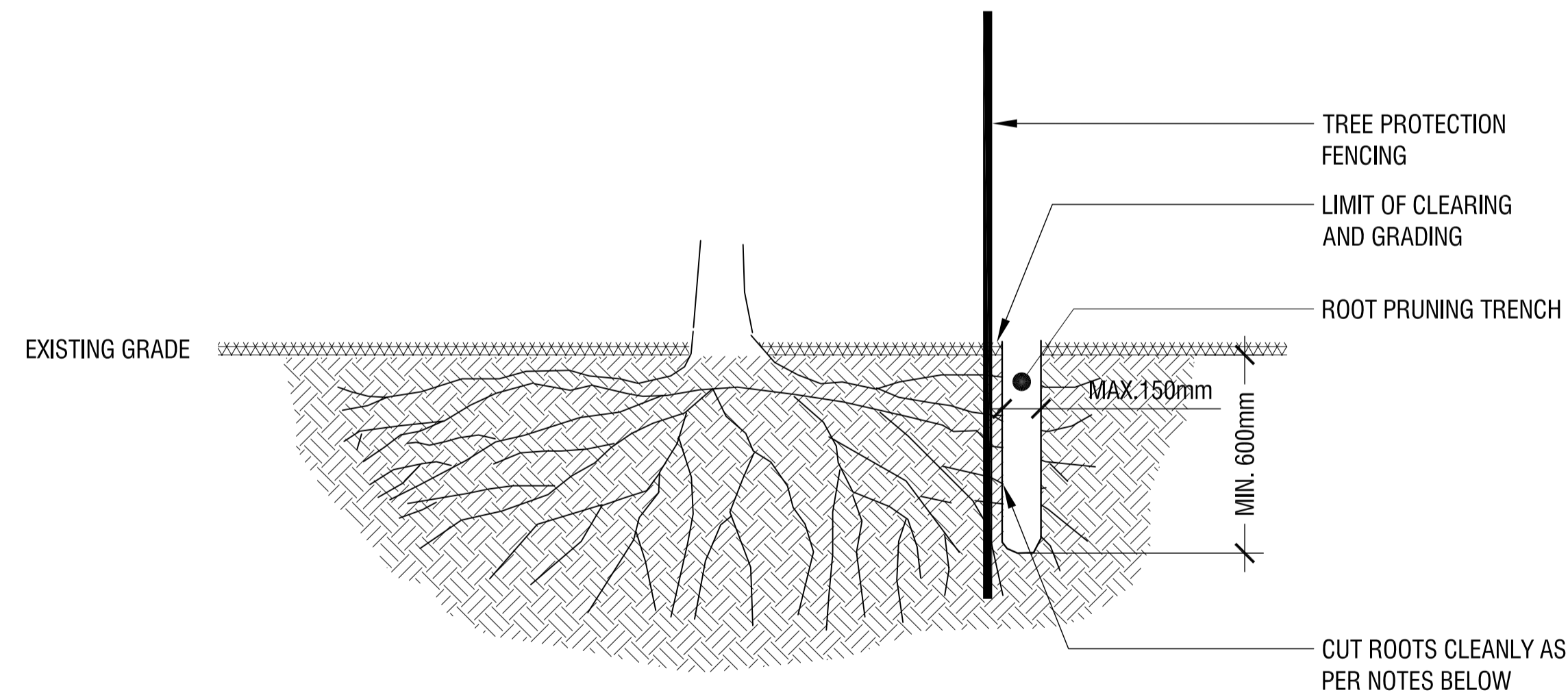

## 2 ROOT PRUNING DETAIL

T2 n.t.s.



**PRELIMINARY**  
 NOT FOR CONSTRUCTION

rev'n	description / la description	yyyy/mm/dd
01	Issued for SPA	2021/09/01
00	Issued for Team Coordination	2021/08/26

396 Cooper Street, Suite 300  
 Ottawa, ON, CANADA K2P 2H7  
 613.730.5709  
 fotenn.com

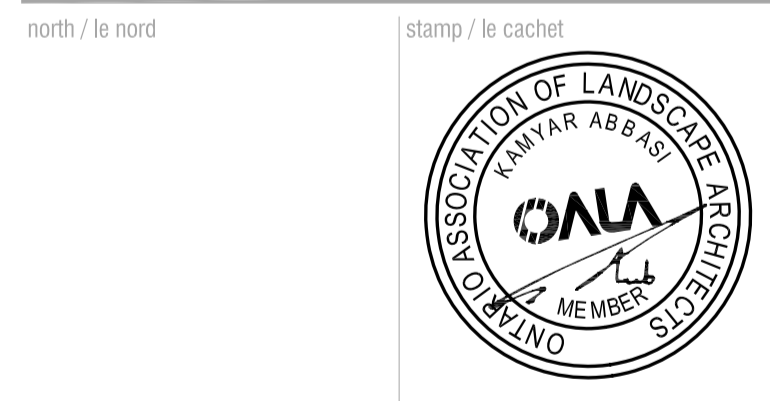

**ENBRIDGE OTTAWA**  
**OPERATIONS CENTRE**  
**2571 LANCASTER ROAD**

drawing / dessin

## TREE INVENTORY & PRESERVATION DETAILS

designed / conçu	drawn / dessiné	reviewed / examiné
KA	SP / MB	KA
date	project number / No. du projet	

drawing number / No. du dessin

**T2 of 2**