

Copyright Reserved

The Contractor shall verify and be responsible for all dimensions. DO NOT scale the drawing - any errors or omissions shall be reported to Stantec without delay.
The Copyrights to all designs and drawings are the property of Stantec. Reproduction or use for any purpose other than that authorized by Stantec is forbidden.

Legend

- AREA ID
- RUNOFF COEFFICIENT
- STORM DRAINAGE AREA ho.
- STORM DRAINAGE BOUNDARY
- DIRECTION OF OVERLAND FLOW
- PROPOSED STORM SEWER
- PROPOSED STORMCEPTOR
- PROPOSED CATCHBASIN
- EXISTING CATCHBASIN
- EXISTING STORM SEWER
- APPROXIMATE LOCATION OF PROPOSED SCUPPER. REFER TO ARCHITECTURAL PLANS FOR DETAILS.
- APPROXIMATE LOCATION OF PROPOSED ROOF DRAIN. REFER TO ARCHITECTURAL PLANS FOR DETAILS.

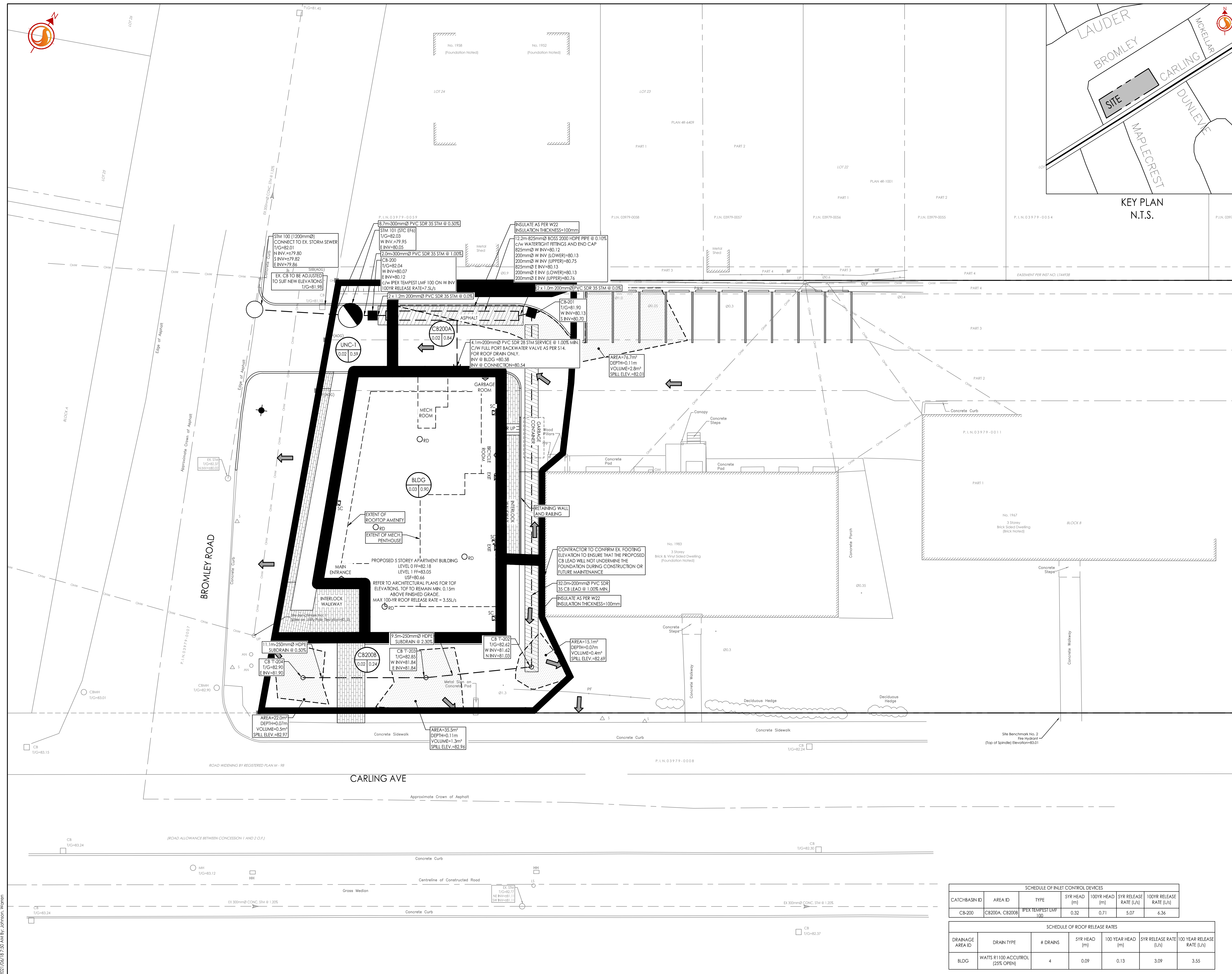

Revision	By	Appd.	YY.MM.DD
1	WAJ	KJK	21.06.18
2	WAJ	KJK	21.05.05



Client/Project
247393 ONTARIO INC

1951 CARLING AVE

Ottawa, ON

Title
STORM DRAINAGE PLAN

CATCHBASIN ID	AREA ID	TYPE	5YR HEAD (m)	100YR HEAD (m)	5YR RELEASE RATE (L/s)	100YR RELEASE RATE (L/s)
CB-200	CB200A, CB200B	PEX TEP/PEST LMF 100	0.32	0.71	5.07	6.36

DRAINAGE AREA ID	DRAIN TYPE	# DRAINS	5YR HEAD (m)	100 YEAR HEAD (m)	5YR RELEASE RATE (L/s)	100 YEAR RELEASE RATE (L/s)
BLDG	WATTS R1100 ACCUTROL (25% OPEN)	4	0.09	0.13	3.09	3.55