

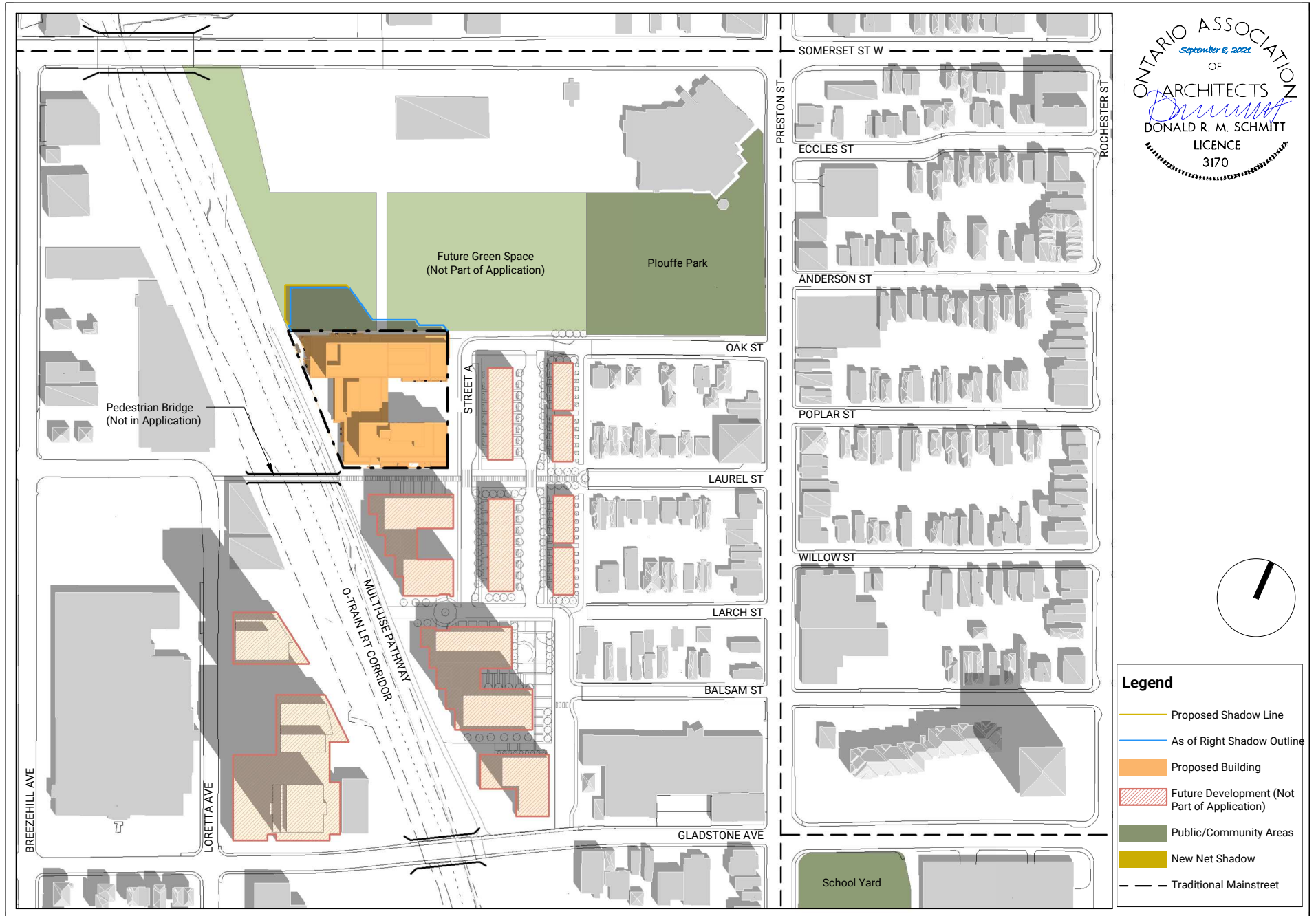

Disclaimer: Geometry used to illustrate future developments based on most recently used available documents for draft Subdivision Application for 933 Gladstone, ZBL application for 951 Gladstone Ave. and 145 Loretta St.

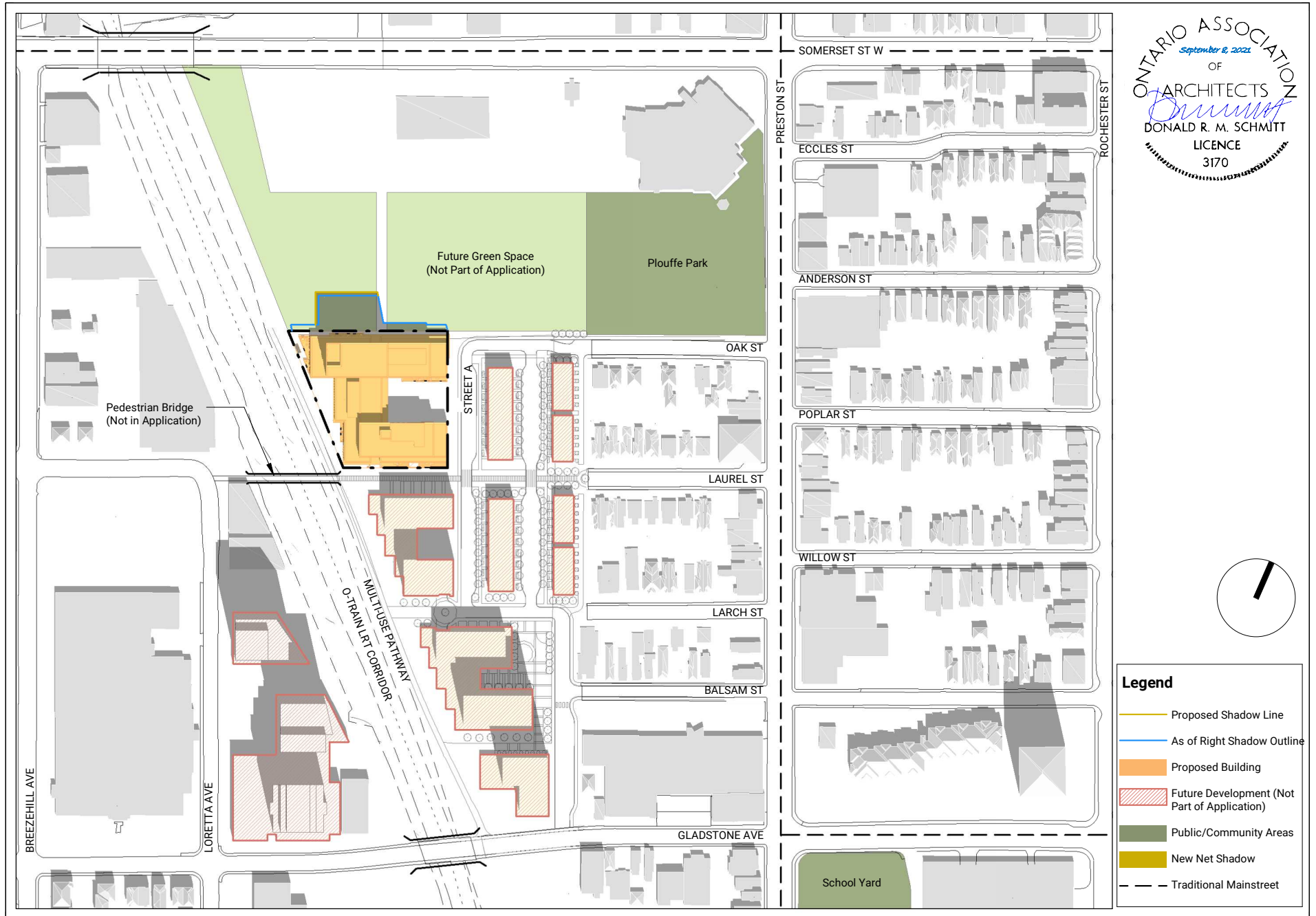





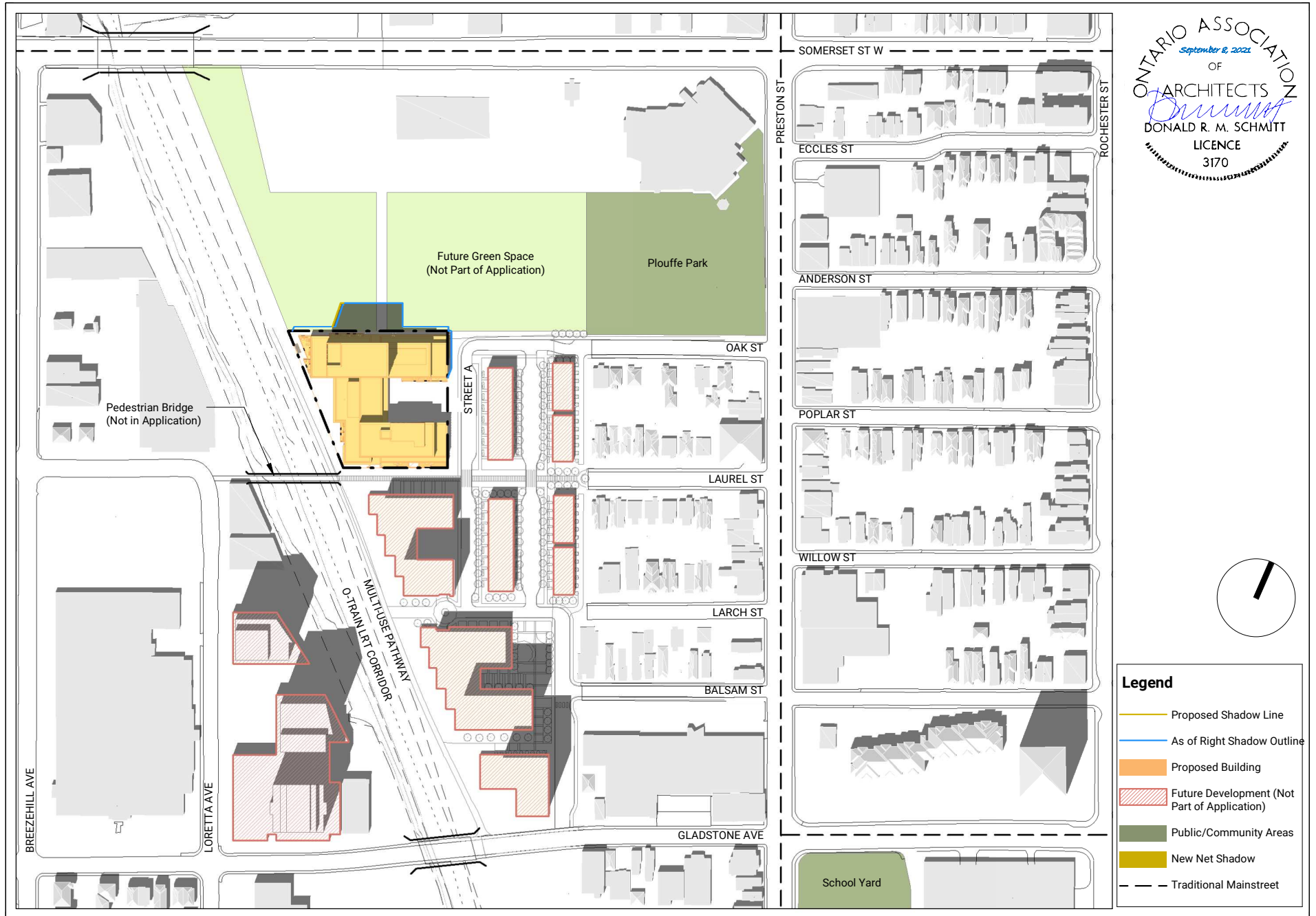



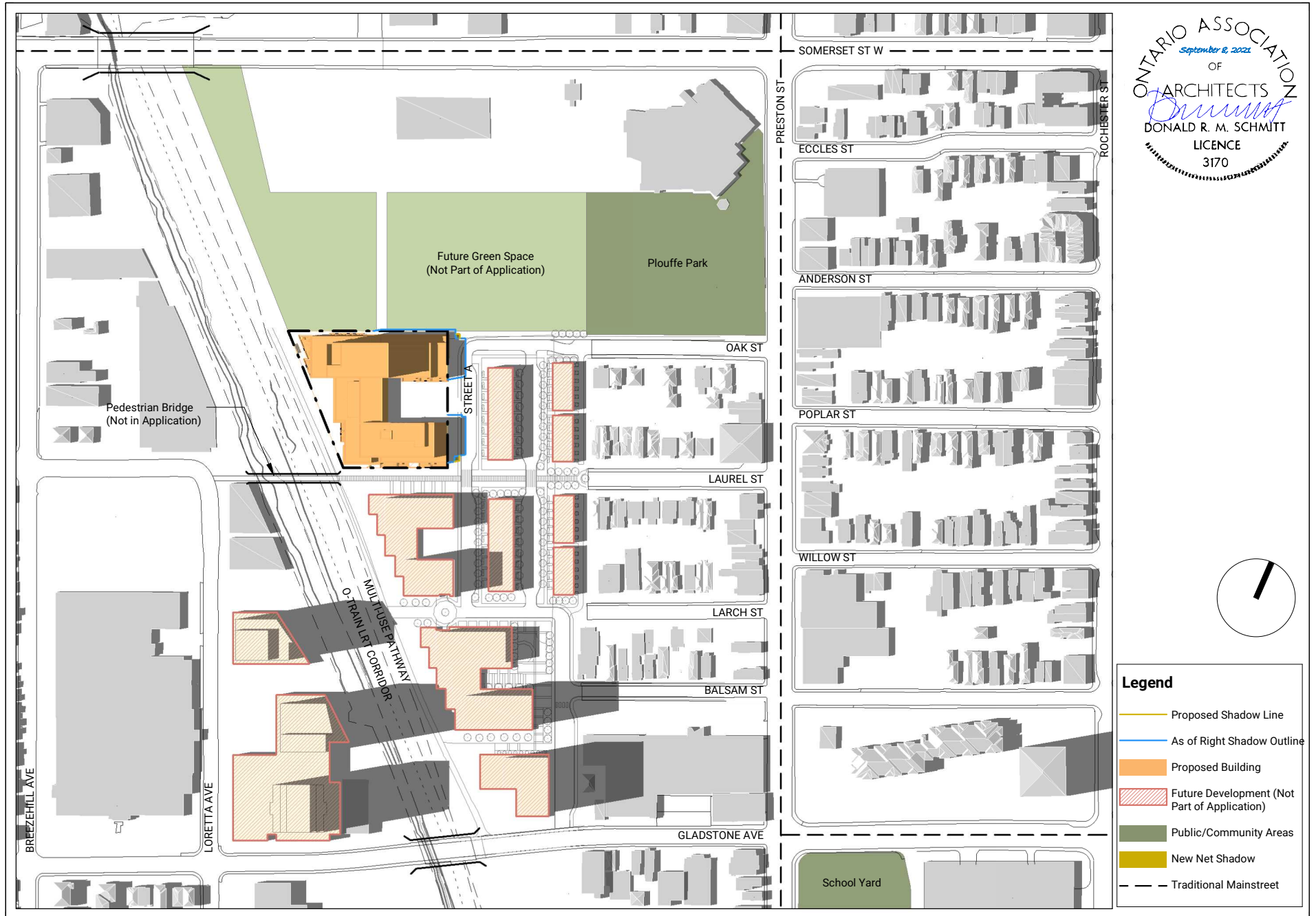

**Legend**

- Proposed Shadow Line
- As of Right Shadow Outline
- Proposed Building
- Future Development (Not Part of Application)
- Public/Community Areas
- New Net Shadow
- Traditional Mainstreet

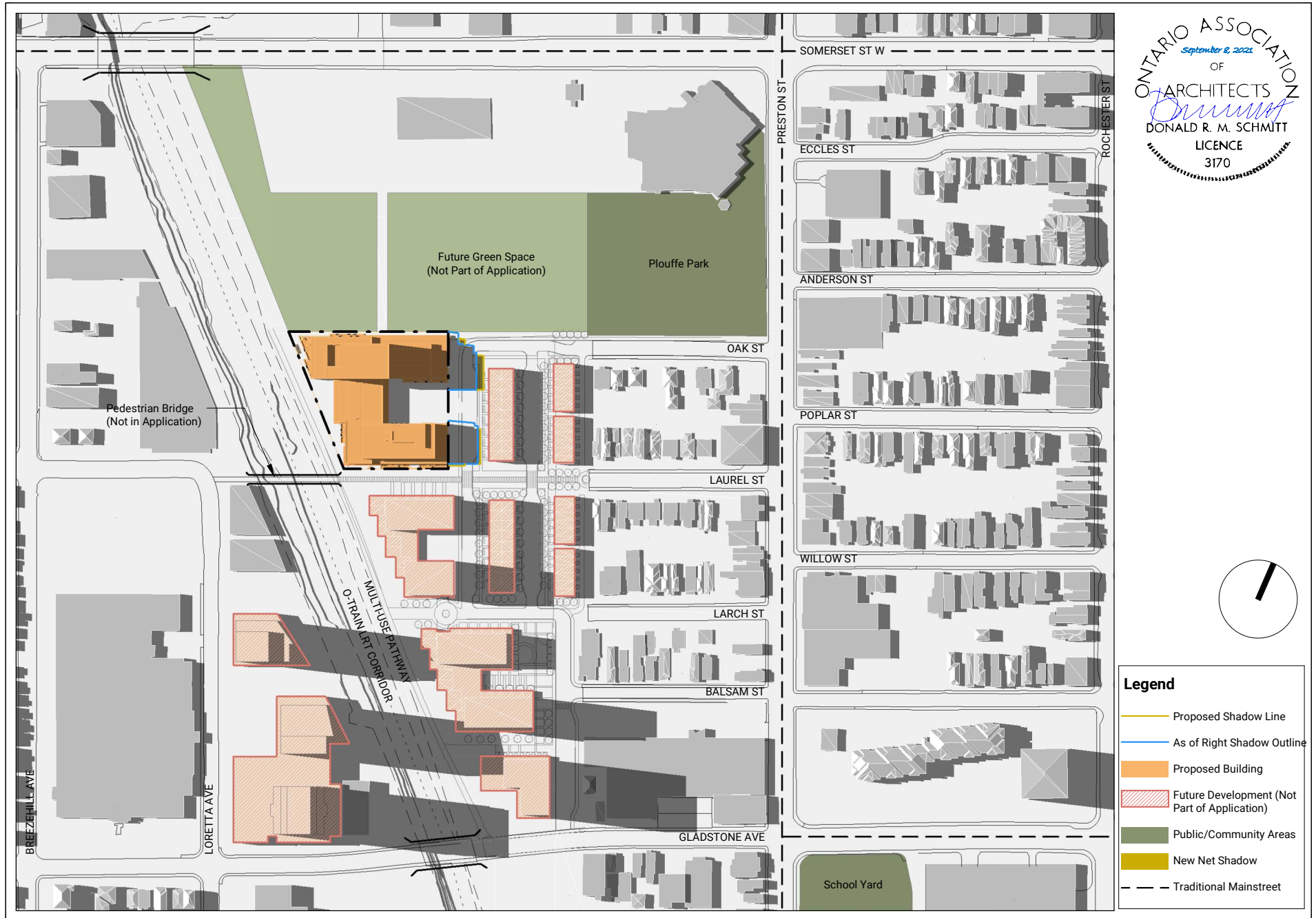





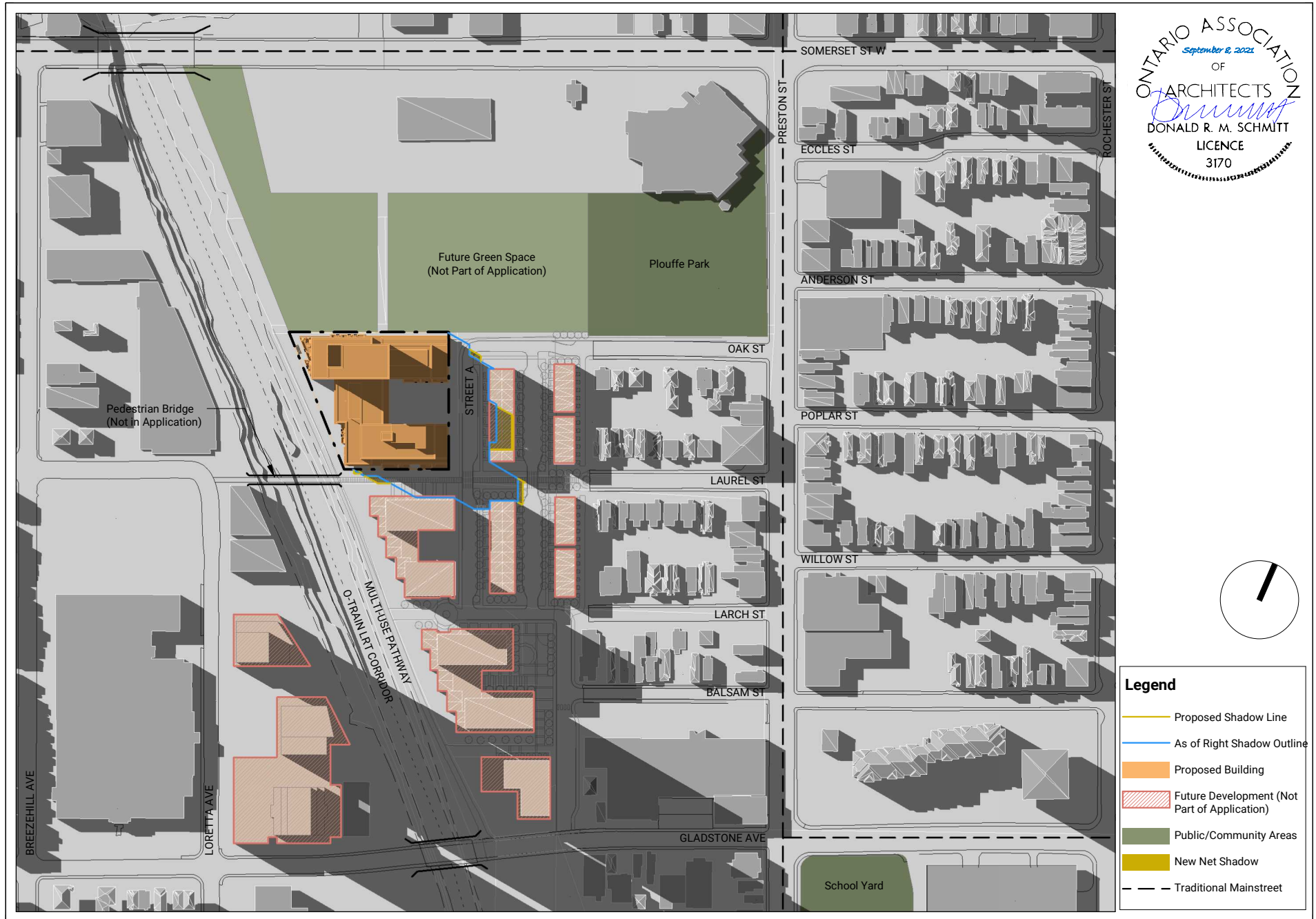

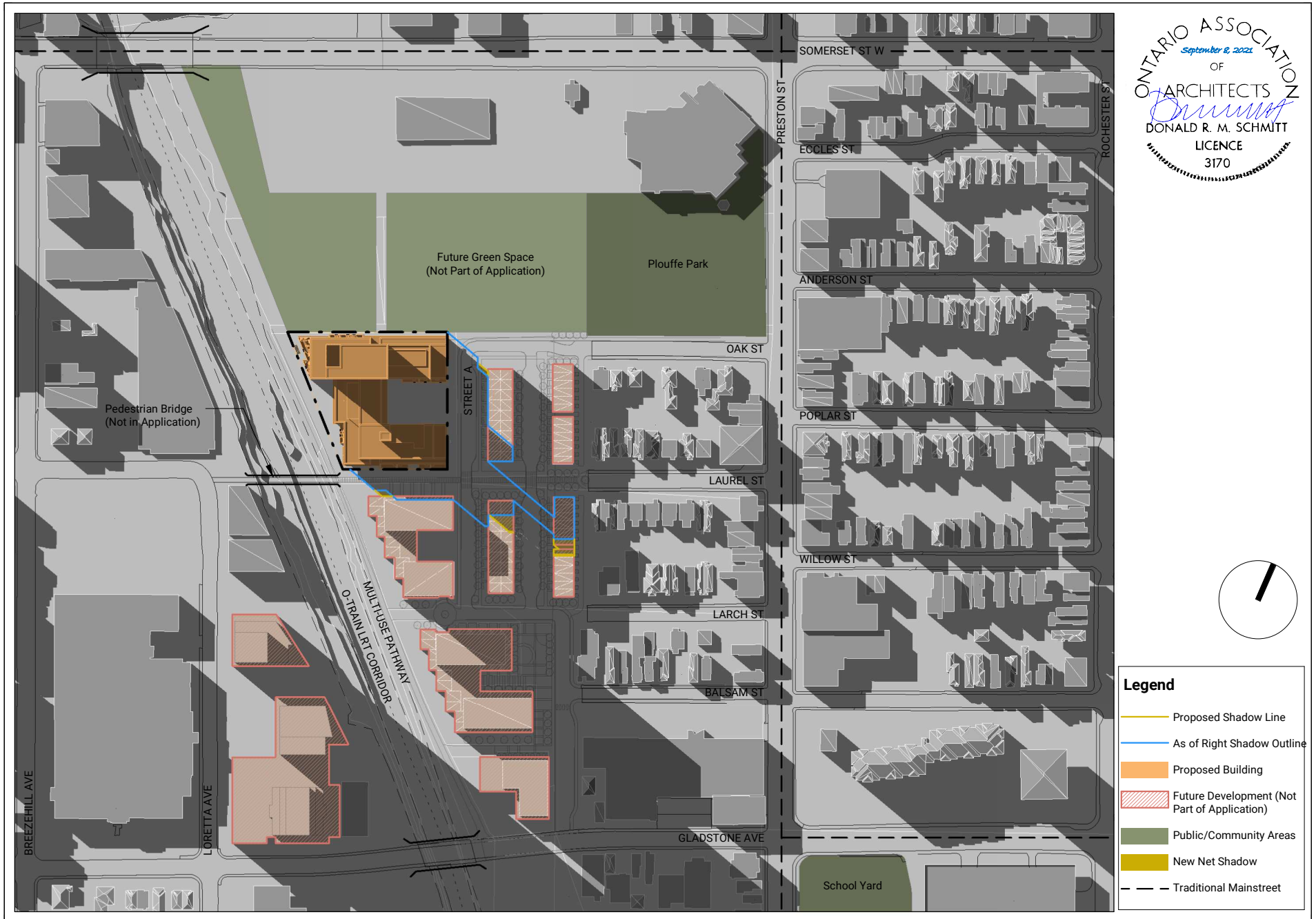

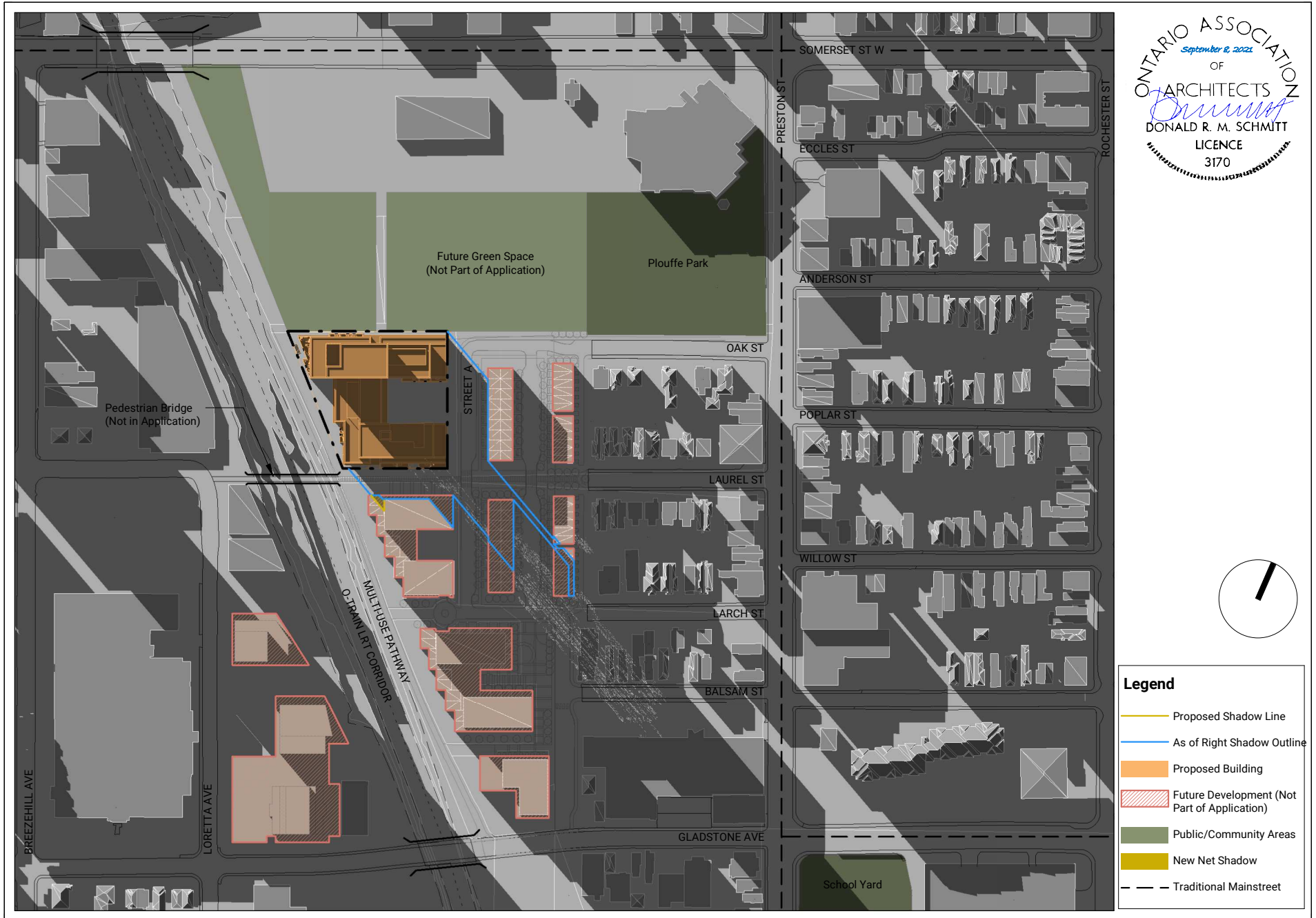

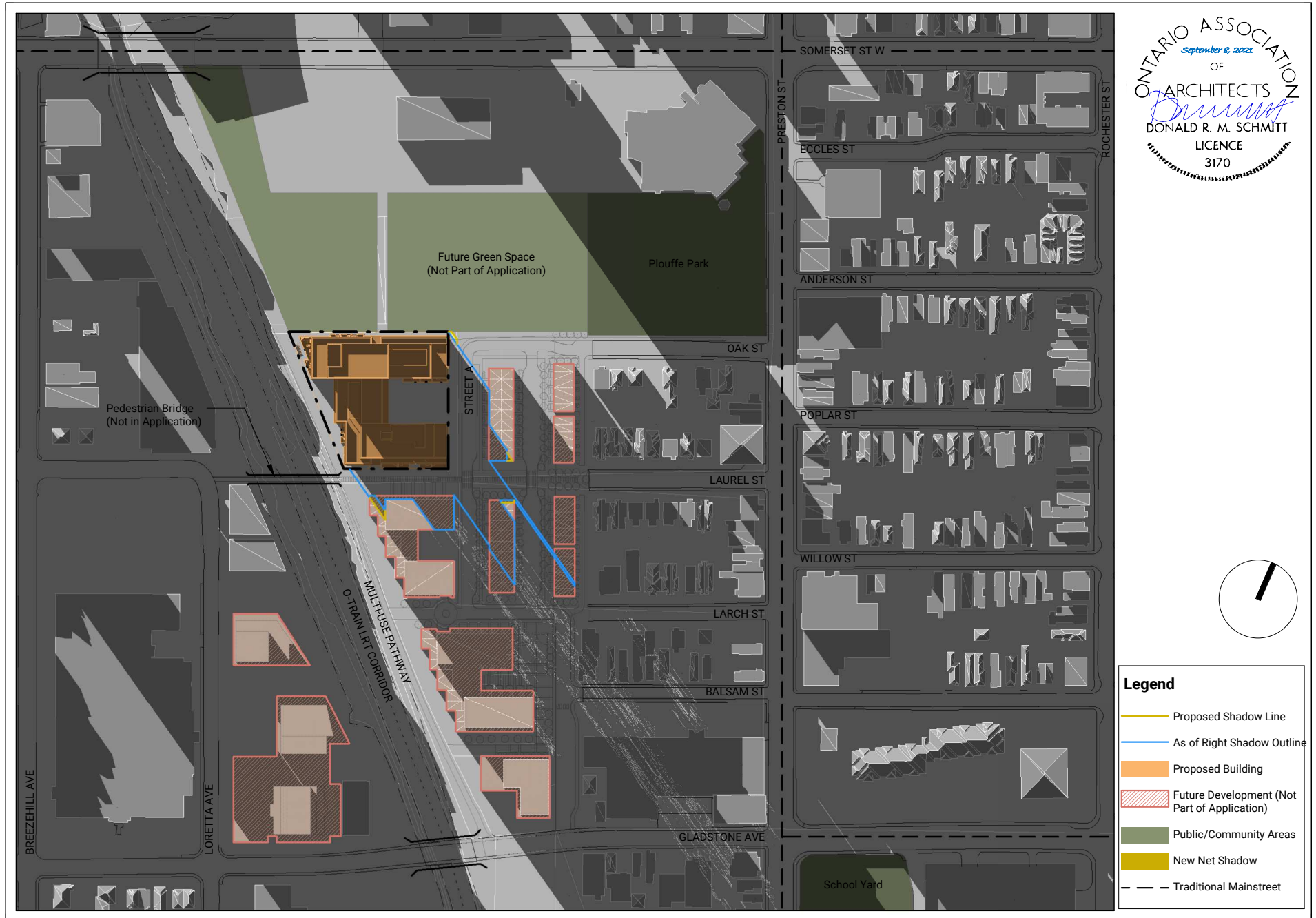
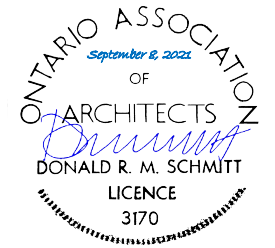



Disclaimer: Geometry used to illustrate future developments based on most recently used available documents for draft Subdivision Application for 933 Gladstone, ZBL application for 951 Gladstone Ave. and 145 Loretta St.



Disclaimer: Geometry used to illustrate future developments based on most recently used available documents for draft Subdivision Application for 933 Gladstone, ZBL application for 951 Gladstone Ave. and 145 Loretta St.



Disclaimer: Geometry used to illustrate future developments based on most recently used available documents for draft Subdivision Application for 933 Gladstone, ZBL application for 951 Gladstone Ave. and 145 Loretta St.





Disclaimer: Geometry used to illustrate future developments based on most recently used available documents for draft Subdivision Application for 933 Gladstone, ZBL application for 951 Gladstone Ave. and 145 Loretta St.

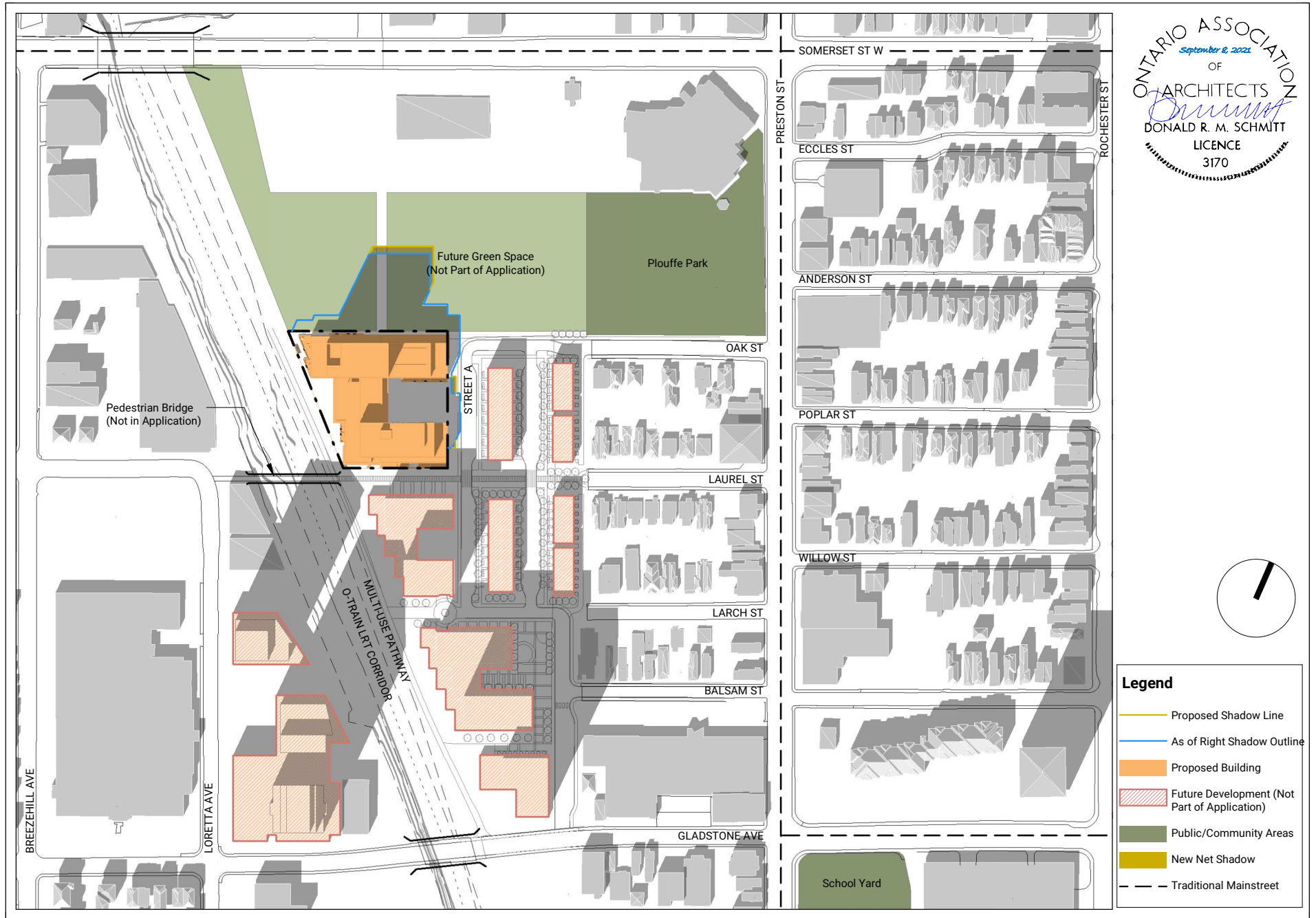

Disclaimer: Geometry used to illustrate future developments based on most recently used available documents for draft Subdivision Application for 933 Gladstone, ZBL application for 951 Gladstone Ave. and 145 Loretta St.

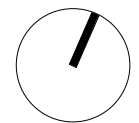
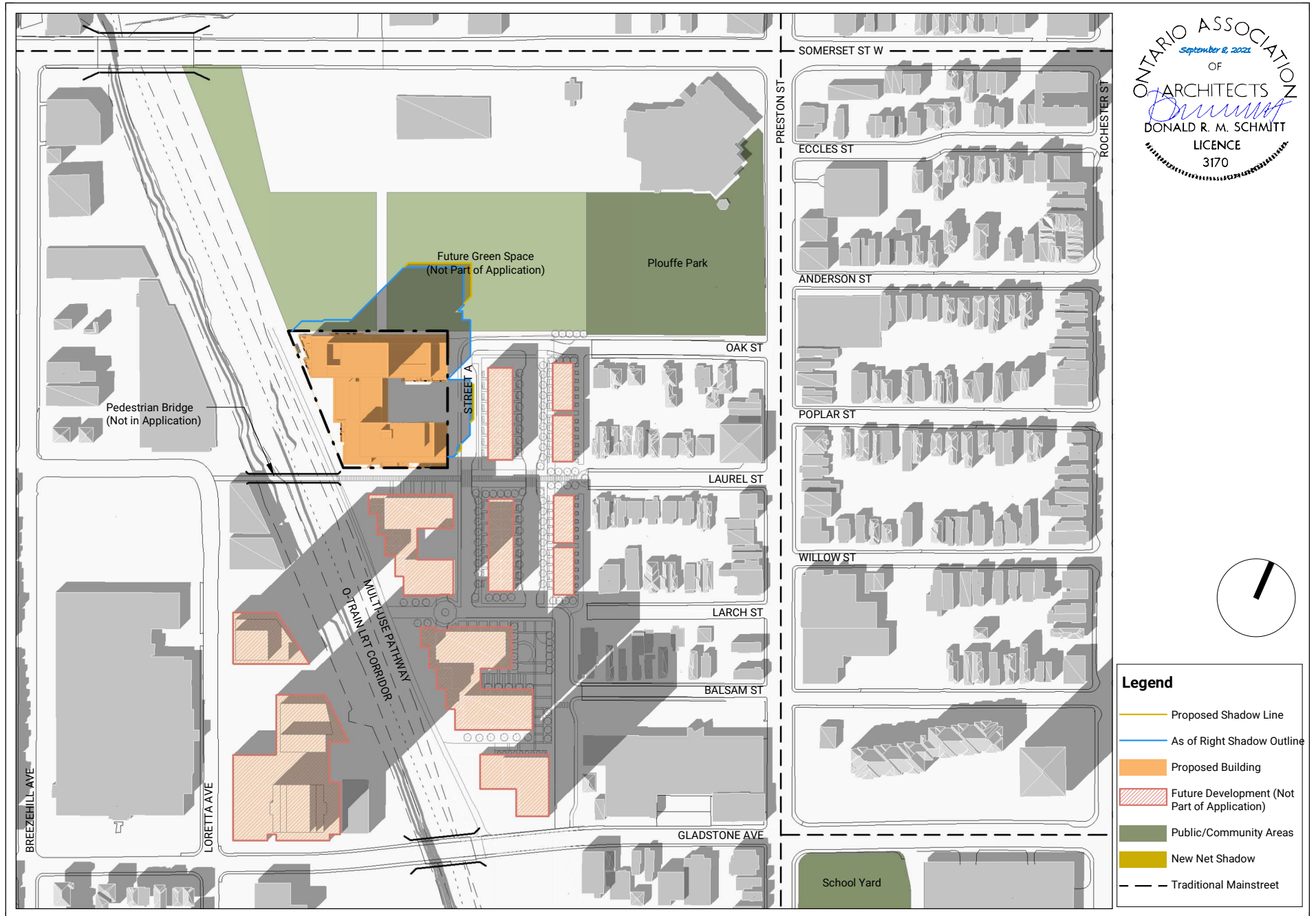
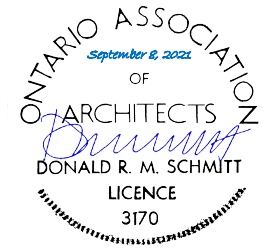

**Legend**

- Proposed Shadow Line
- As of Right Shadow Outline
- Proposed Building
- Future Development (Not Part of Application)
- Public/Community Areas
- New Net Shadow
- Traditional Mainstreet

Disclaimer: Geometry used to illustrate future developments based on most recently used available documents for draft Subdivision Application for 933 Gladstone, ZBL application for 951 Gladstone Ave. and 145 Loretta St.



Disclaimer: Geometry used to illustrate future developments based on most recently used available documents for draft Subdivision Application for 933 Gladstone, ZBL application for 951 Gladstone Ave. and 145 Loretta St.

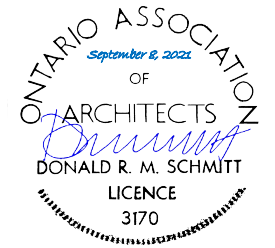

Disclaimer: Geometry used to illustrate future developments based on most recently used available documents for draft Subdivision Application for 933 Gladstone, ZBL application for 951 Gladstone Ave. and 145 Loretta St.

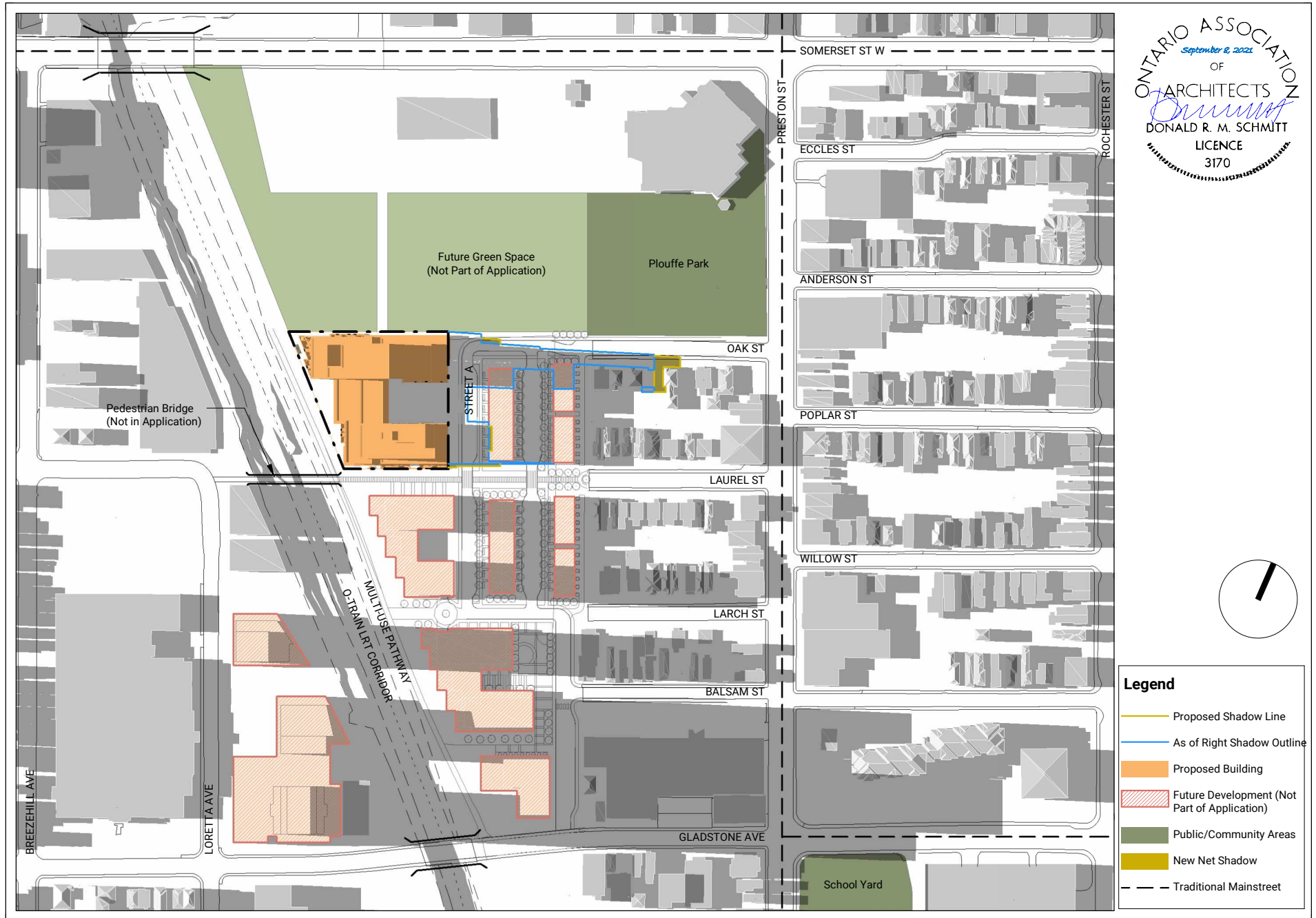

**Legend**

- Proposed Shadow Line
- As of Right Shadow Outline
- Proposed Building
- Future Development (Not Part of Application)
- Public/Community Areas
- New Net Shadow
- Traditional Mainstreet

Disclaimer: Geometry used to illustrate future developments based on most recently used available documents for draft Subdivision Application for 933 Gladstone, ZBL application for 951 Gladstone Ave. and 145 Loretta St.

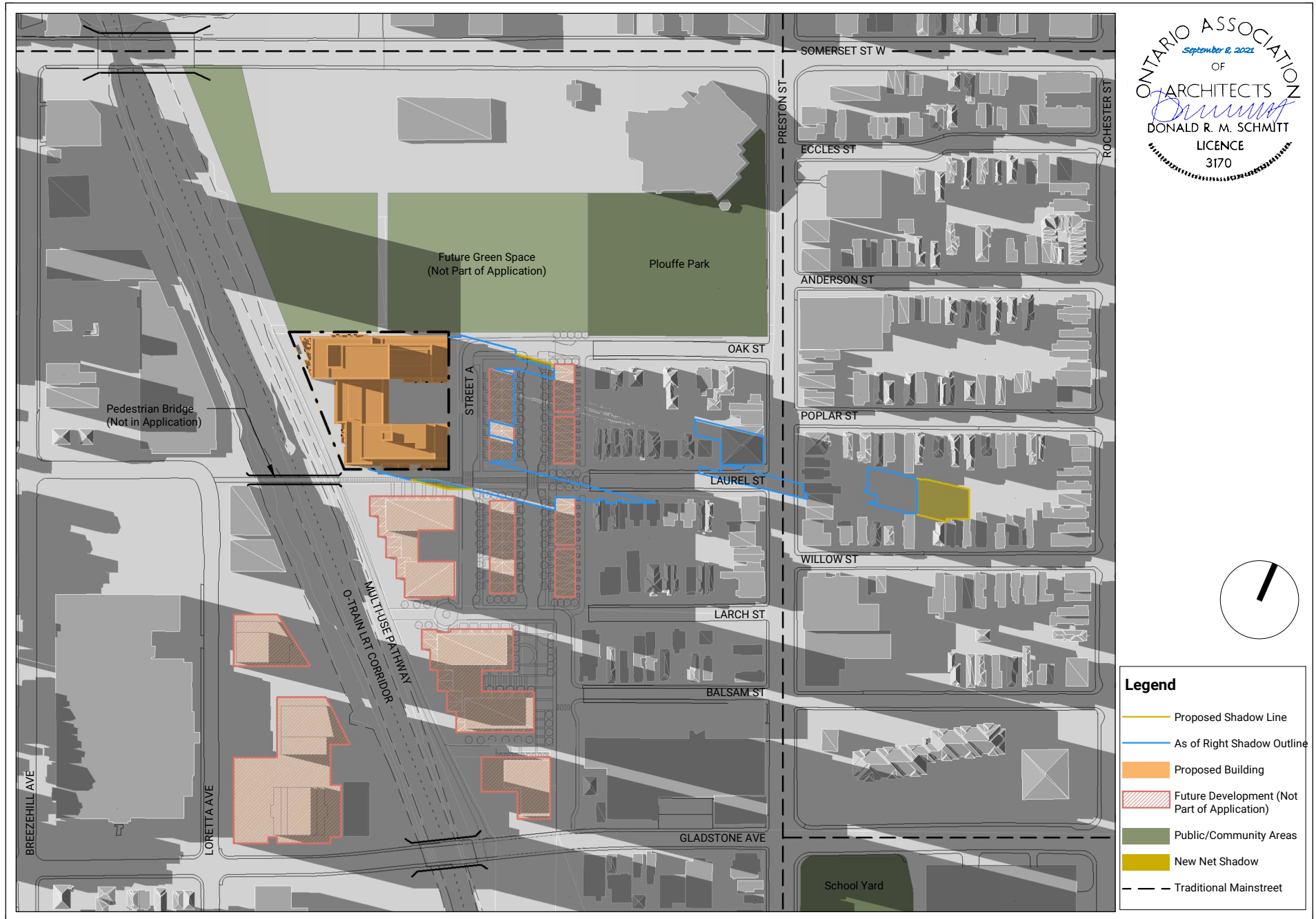
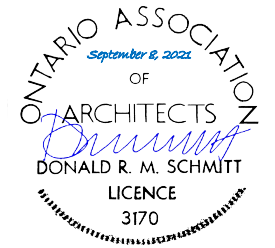

Disclaimer: Geometry used to illustrate future developments based on most recently used available documents for draft Subdivision Application for 933 Gladstone, ZBL application for 951 Gladstone Ave. and 145 Loretta St.

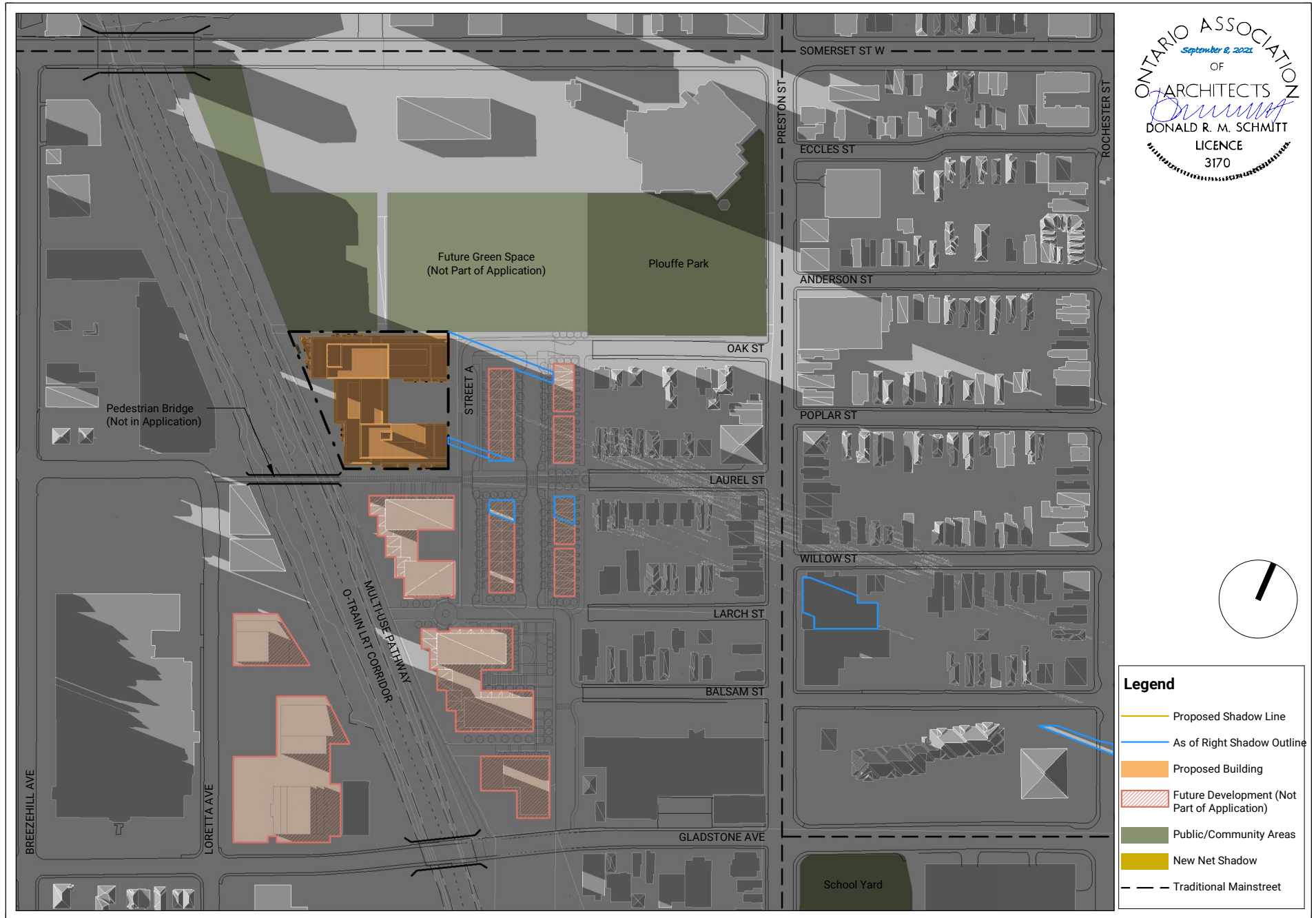

Disclaimer: Geometry used to illustrate future developments based on most recently used available documents for draft Subdivision Application for 933 Gladstone, ZBL application for 951 Gladstone Ave. and 145 Loretta St.



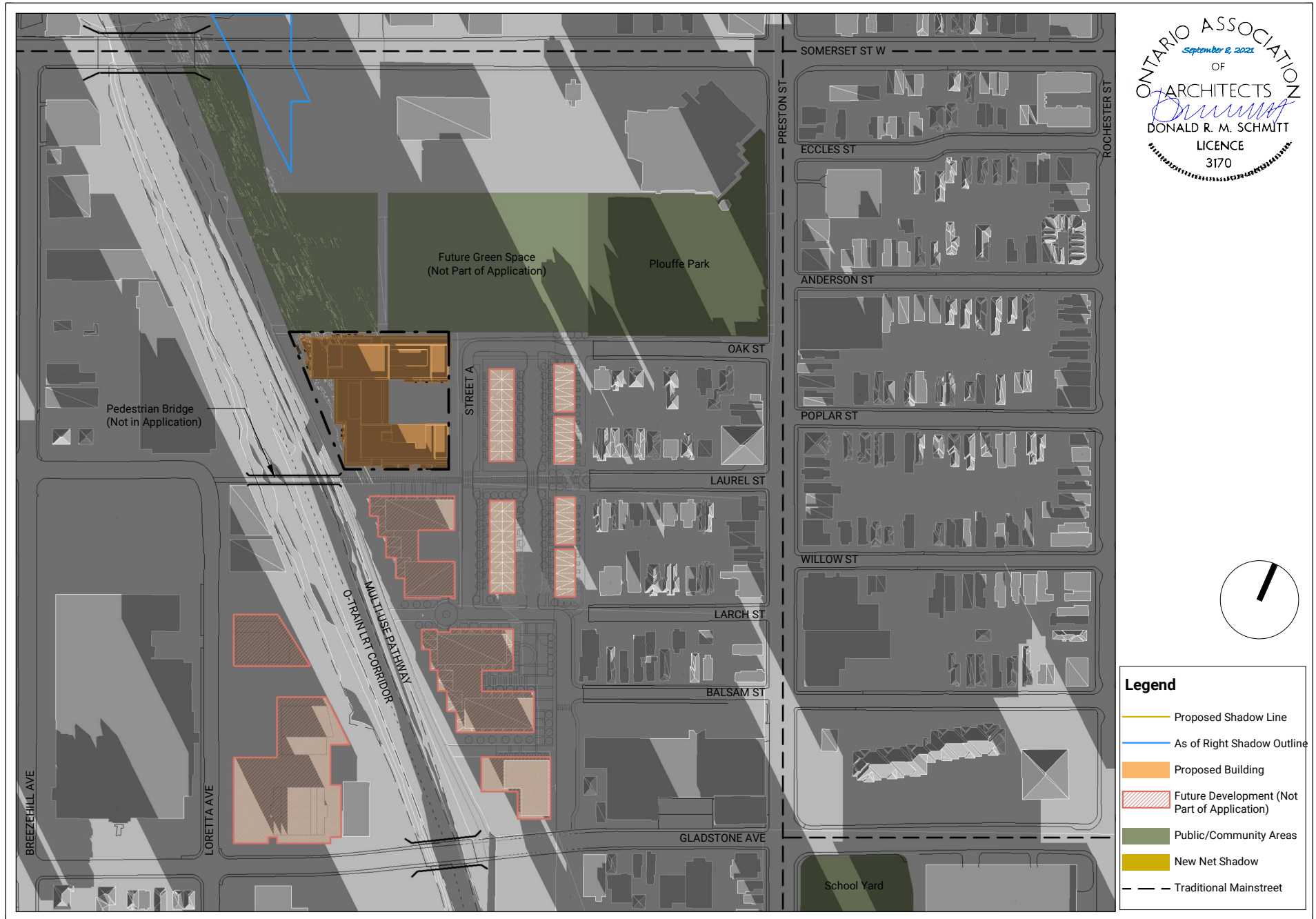
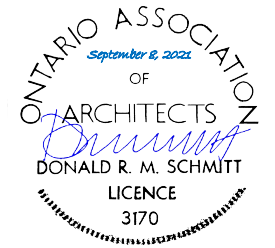

Disclaimer: Geometry used to illustrate future developments based on most recently used available documents for draft Subdivision Application for 933 Gladstone, ZBL application for 951 Gladstone Ave. and 145 Loretta St.

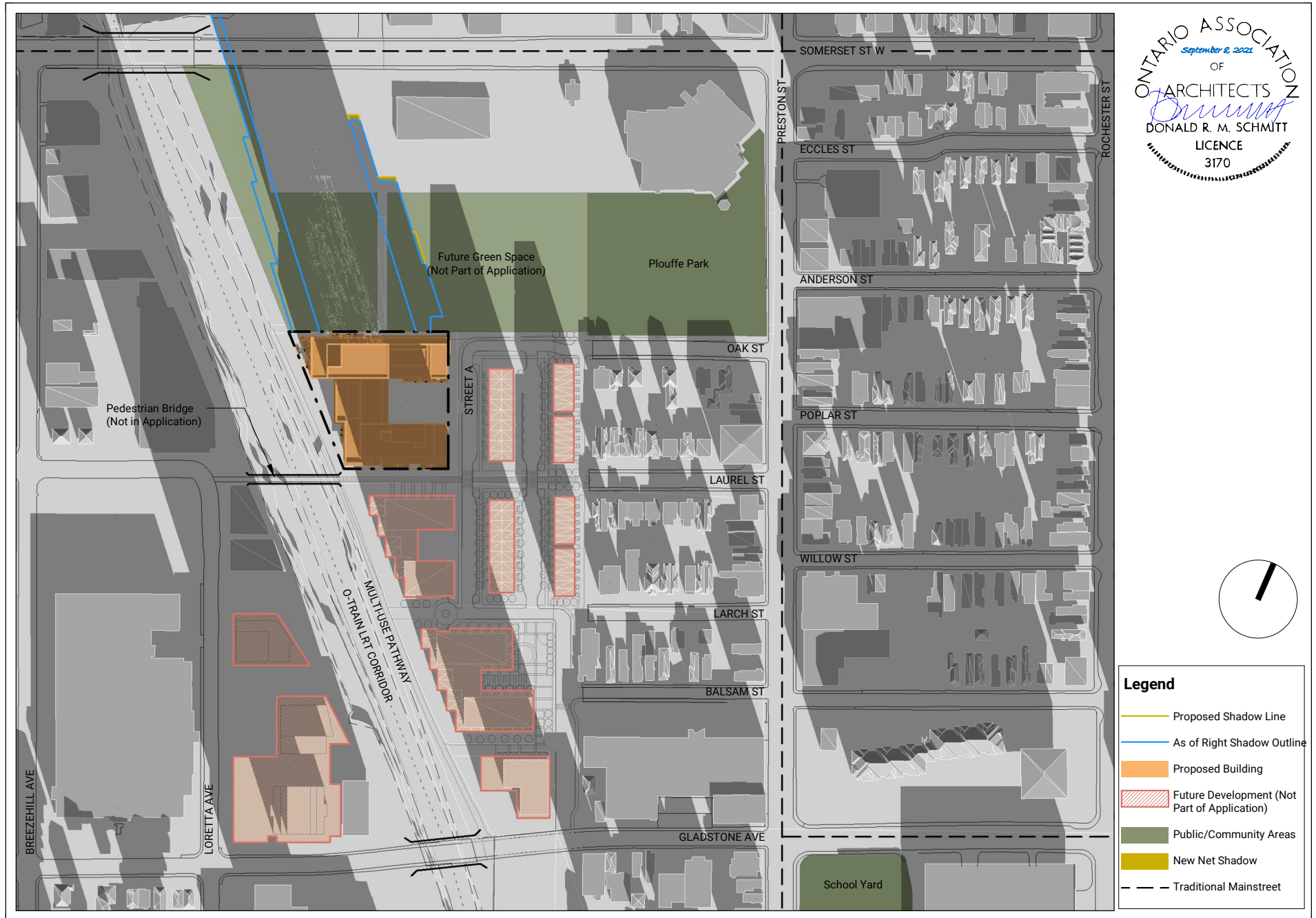
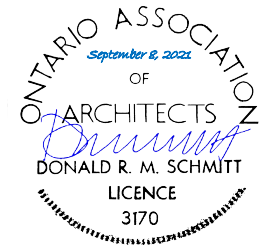

Disclaimer: Geometry used to illustrate future developments based on most recently used available documents for draft Subdivision Application for 933 Gladstone, ZBL application for 951 Gladstone Ave. and 145 Loretta St.

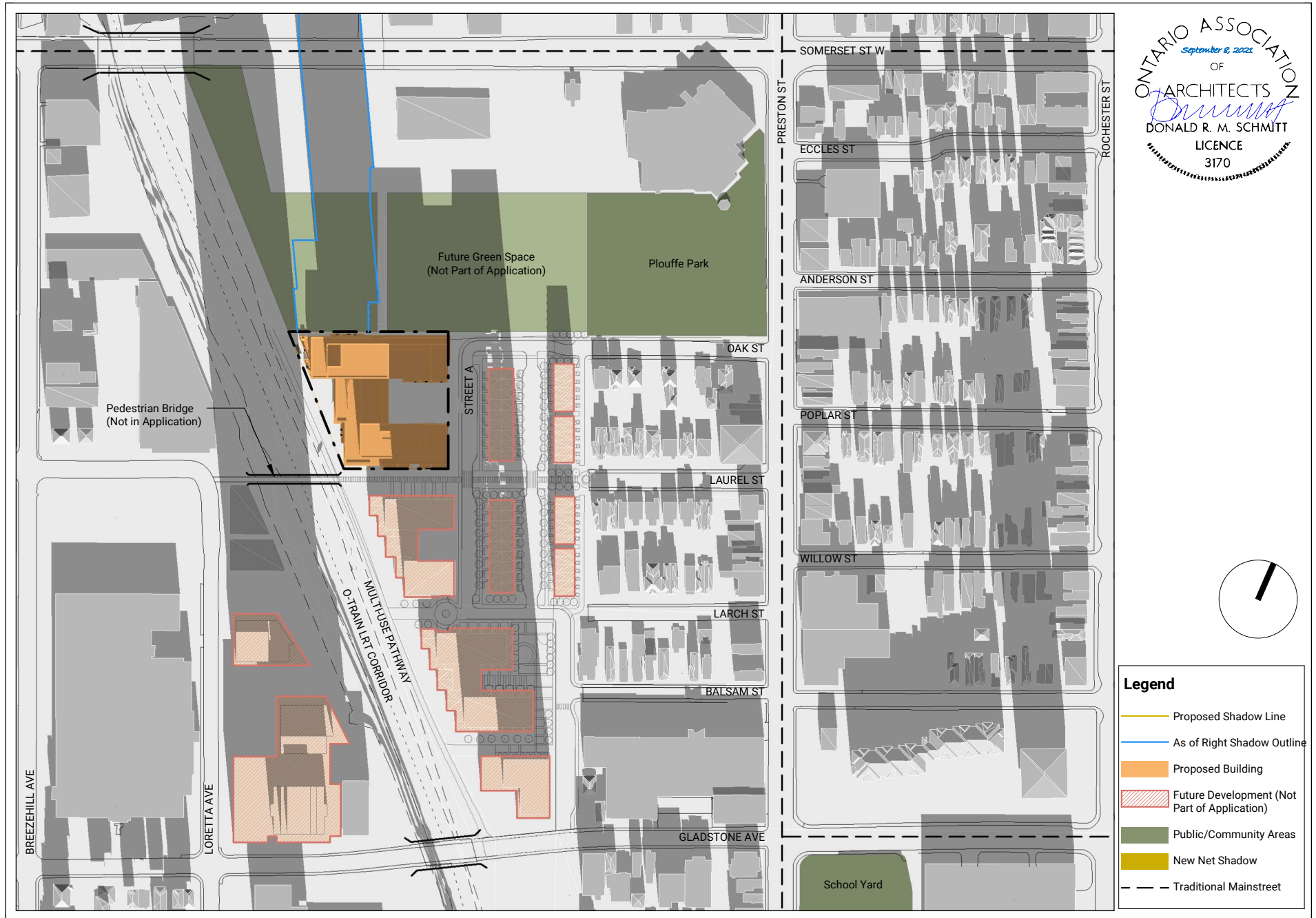
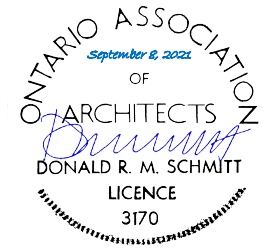

Disclaimer: Geometry used to illustrate future developments based on most recently used available documents for draft Subdivision Application for 933 Gladstone, ZBL application for 951 Gladstone Ave. and 145 Loretta St.

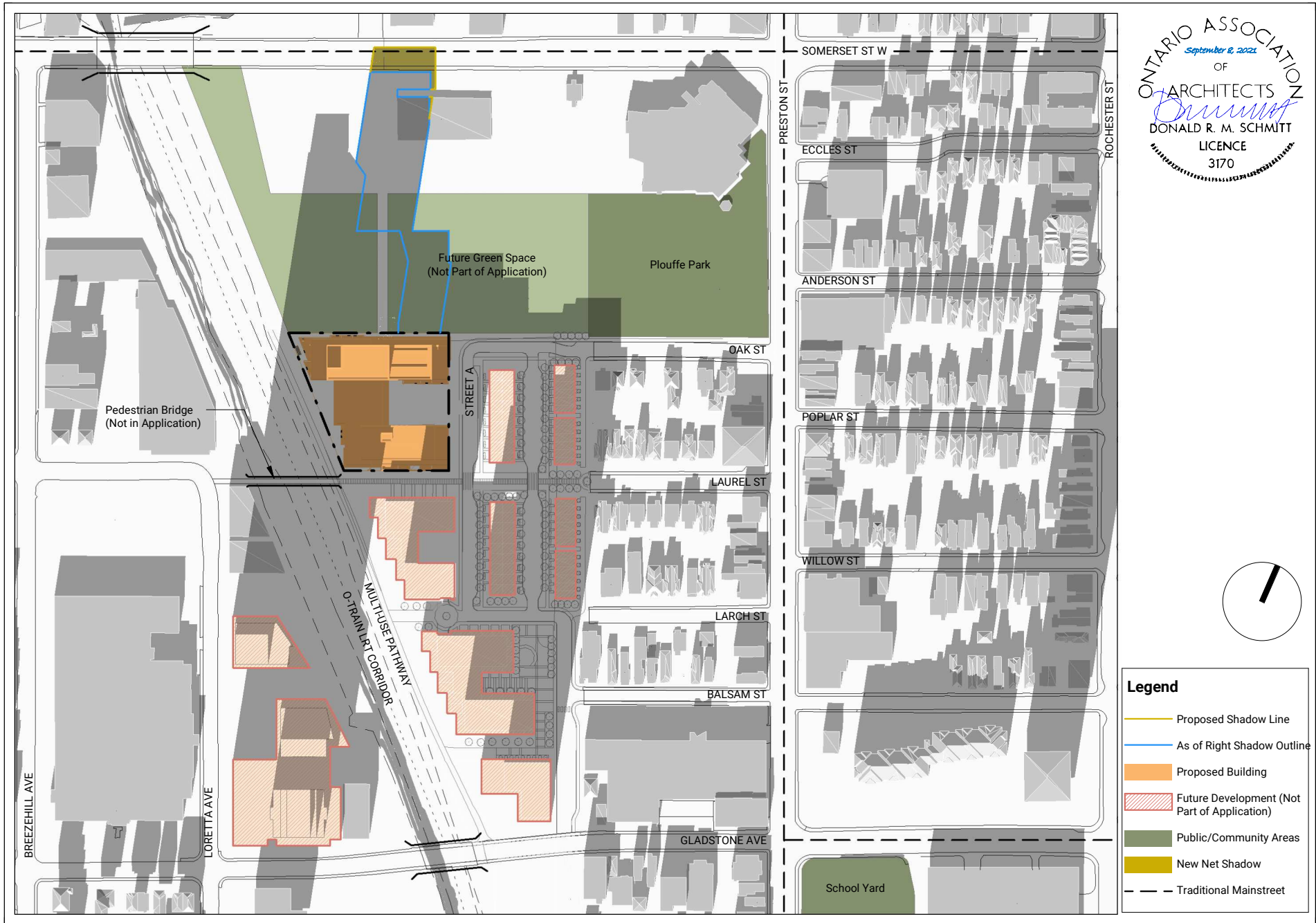

Disclaimer: Geometry used to illustrate future developments based on most recently used available documents for draft Subdivision Application for 933 Gladstone, ZBL application for 951 Gladstone Ave. and 145 Loretta St.

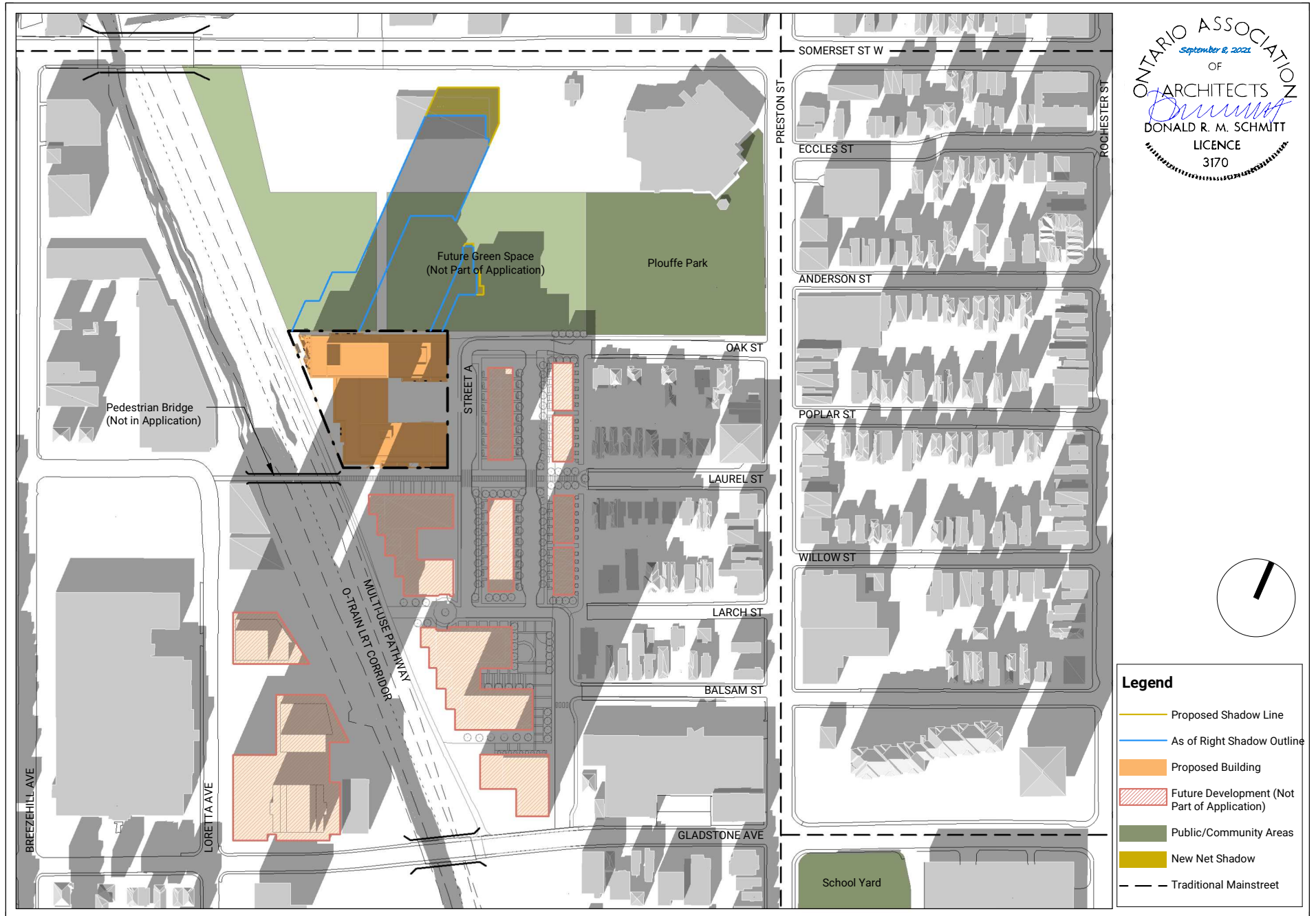
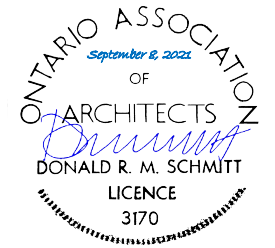

Disclaimer: Geometry used to illustrate future developments based on most recently used available documents for draft Subdivision Application for 933 Gladstone, ZBL application for 951 Gladstone Ave. and 145 Loretta St.

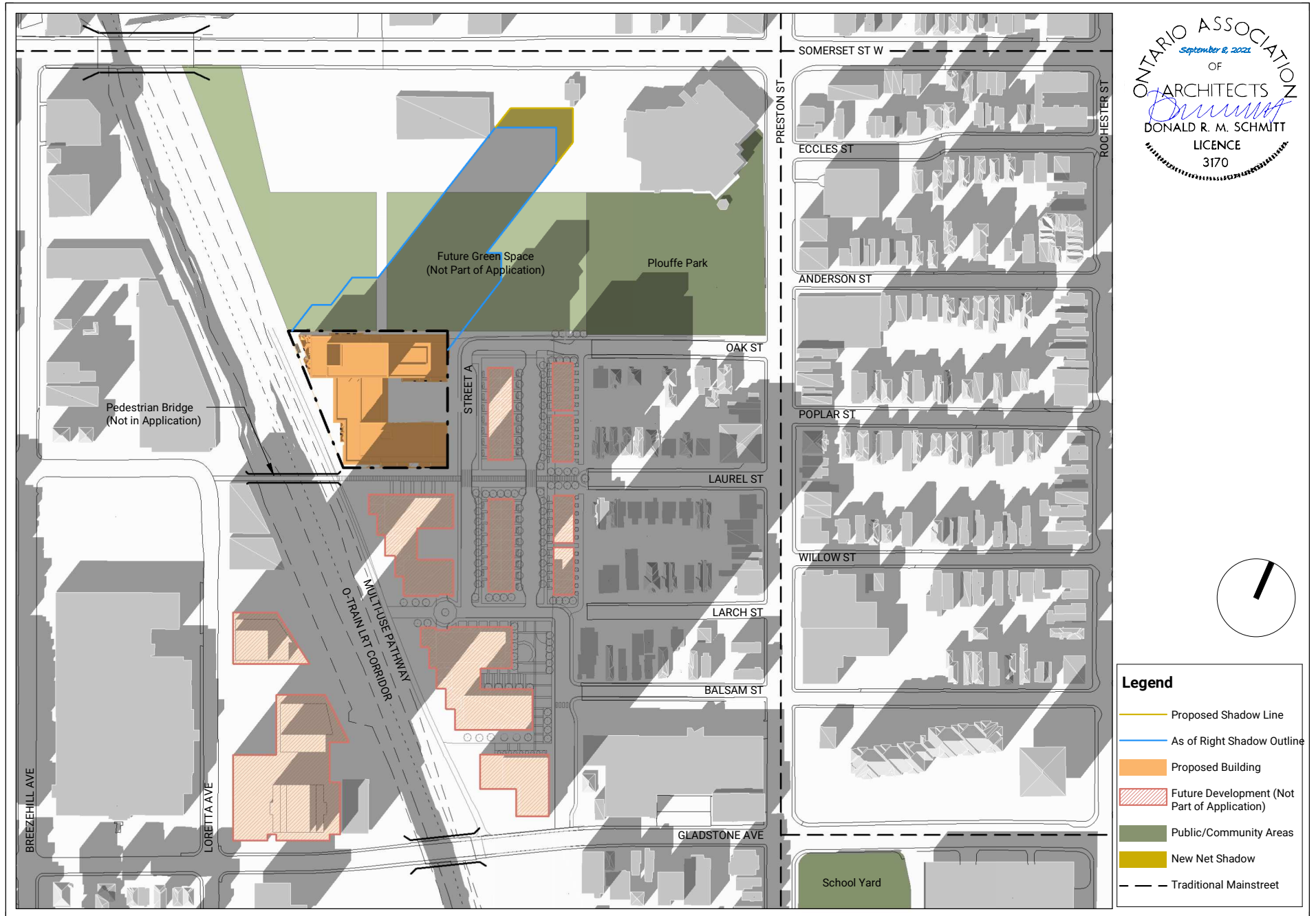

Disclaimer: Geometry used to illustrate future developments based on most recently used available documents for draft Subdivision Application for 933 Gladstone, ZBL application for 951 Gladstone Ave. and 145 Loretta St.

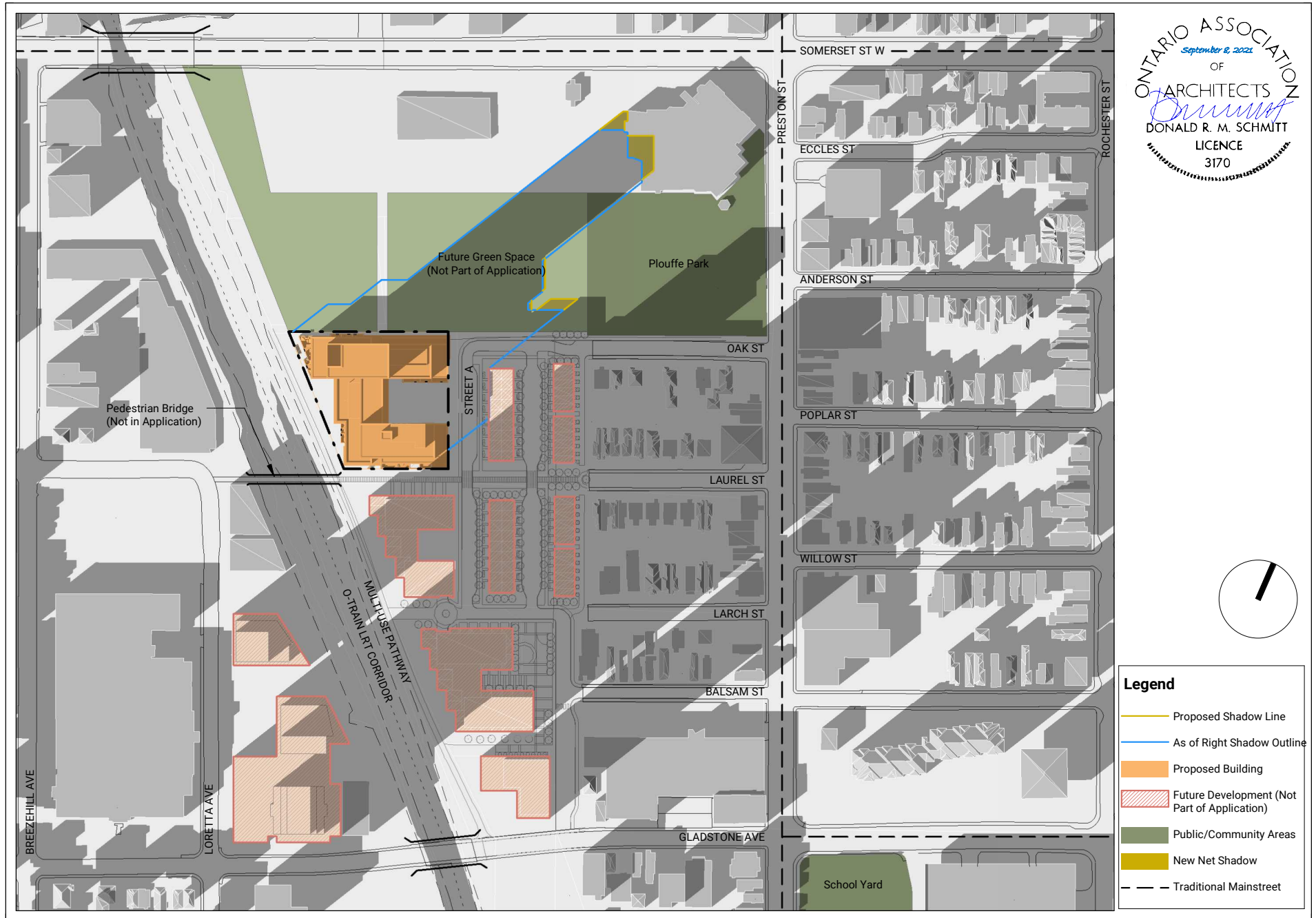

Disclaimer: Geometry used to illustrate future developments based on most recently used available documents for draft Subdivision Application for 933 Gladstone, ZBL application for 951 Gladstone Ave. and 145 Loretta St.