

Code	Qty.	Botanical Name	Common Name	Size	Condition
AC	3	Amelanchier canadensis	Tree Serviceberry	60mm cal	B + B specimen
CC	3	Crataegus crus-galli 'Inermis'	Thornless Cockspur Hawthorn	60mm cal	B + B specimen
MH	3	Malus 'Harvest Gold'	Harvest Gold Crabapple	60mm cal	B + B specimen

Code	Qty.	Botanical Name	Common Name	Size	Condition
ac	3	Amelanchier canadensis	Serviceberry	250cm HT.	B + B specimen
cr	5	Cornus racemosa	Grey Dogwood	250cm HT.	B + B specimen
lr	3	Syringa reticulata	Japanese Tree Lilac	250cm HT.	B + B specimen
vl	7	Viburnum lentago	Nannyberry	250cm HT.	B + B specimen

Code	Qty.	Botanical Name	Common Name	Size	Condition
HK	225	Hypericum kalmianum	St. John's Wort	30cm HT.	Pot
SA	110	Spiraea alba	Meadowsweet	60cm HT.	Pot

Drawing Remains the Property of/Copyright Reserved by Gino J. Aiello Landscape Architect. Do Not Use or Reproduce Without Approval of Gino J. Aiello. NOT To Be Used For Construction Unless indicated by Revision: "FOR LANDSCAPE CONSTRUCTION". Contractor is Responsible for Verification of Site Locations of all Utilities. Report any Discrepancies Between Site and Drawing Immediately to Gino J. Aiello. Do NOT Proceed Until Clarified.

REFER TO TCR BY IFS  
 Circle Indicates DBH x 10 (CRZ)  
 4 Existing Tree To Remain  
 4 Existing Tree To Be Removed  
**LANDSCAPE PLAN LEGEND**

- Proposed Coniferous Tree
  - Proposed Deciduous Tree
  - Proposed Planting Bed
  - Proposed Riverwash Stone On Filter Cloth
  - Proposed Concrete Paving
  - Proposed Patio Screen / Fence
  - Parking Garage Wall
- BELOW GRADE SERVICES REFER TO CIVIL /CUP**
- U/G Water Service
  - U/G Storm Service
  - U/G Sanitary Service
  - U/G Gas Service
  - U/G TelCo Service
  - U/G Hydro Service
  - O/H Hydro Service
  - Fire Hydrant
  - FD Siamese Connection
  - Light Standard Base

**Circum Bicycle Rack**  
 P5-76-101-TP- Circum Bike Rack  
 Our Circum Bicycle Rack features a welded tubular and flat bar steel construction. It is available in your choice of HAUSER® powdercoat finishes, or HAUSER®ELED Thermoplastic finishes.

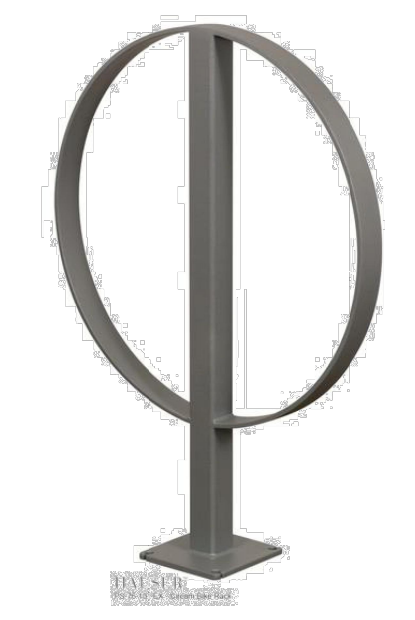

TURF AREAS TO BE SOD C/W 150MM DEPTH TOPSOIL ON APPROVED SUBGRADE | SOD TO BE #1 GRADE TURFGRASS NURSERY SOD per NSGA - Fine Fescue/Kentucky Bluegrass Sod | PLANTING MIX TO BE APPROVED BY LANDSCAPE ARCHITECT | PLANT MATERIAL TO MEET CNLA STANDARDS/BE APPROVED BY LANDSCAPE ARCHITECT PRIOR TO PLANTING | ALL MATERIALS & WORK TO BE MAINTAINED UNTIL FINAL ACCEPTANCE. (MOWING TURF, WEEDING BEDS, WATERING TURF & PLANTS) & INCLUDE 1 YEAR WARRANTY FROM DATE OF FINAL ACCEPTANCE | PROVIDE WATERING OF ALL PLANT MATERIAL AS REQUIRED FOR PROPER ESTABLISHMENT, UNTIL END OF WARRANTY PERIOD | REFER TO CIVIL ENGINEER'S DRAWING FOR ELEVATIONS / GRADING |

The Landscape Plan is to be read in conjunction with the grading, servicing, site and survey plan | Bare root material to be planted in season only | All plant material locations to be staked on site by the landscape contractor and checked by the landscape architect prior to planting | All trees to be preserved on or directly adjacent to the site will be protected | Plant material are to be installed a minimum of: 3.0m away from any part of any hydro transformer, 3.0m corridor between a fire hydrant and the curb, a 2.5m radius beside or behind a fire hydrant, 2.0m from any servicing/utility line or structure |

**HAUSER SITE FURNITURE**  
 sales@hausersite.com  
 800-268-7328  
 hausersite.com

**TYPICAL DETAILS**

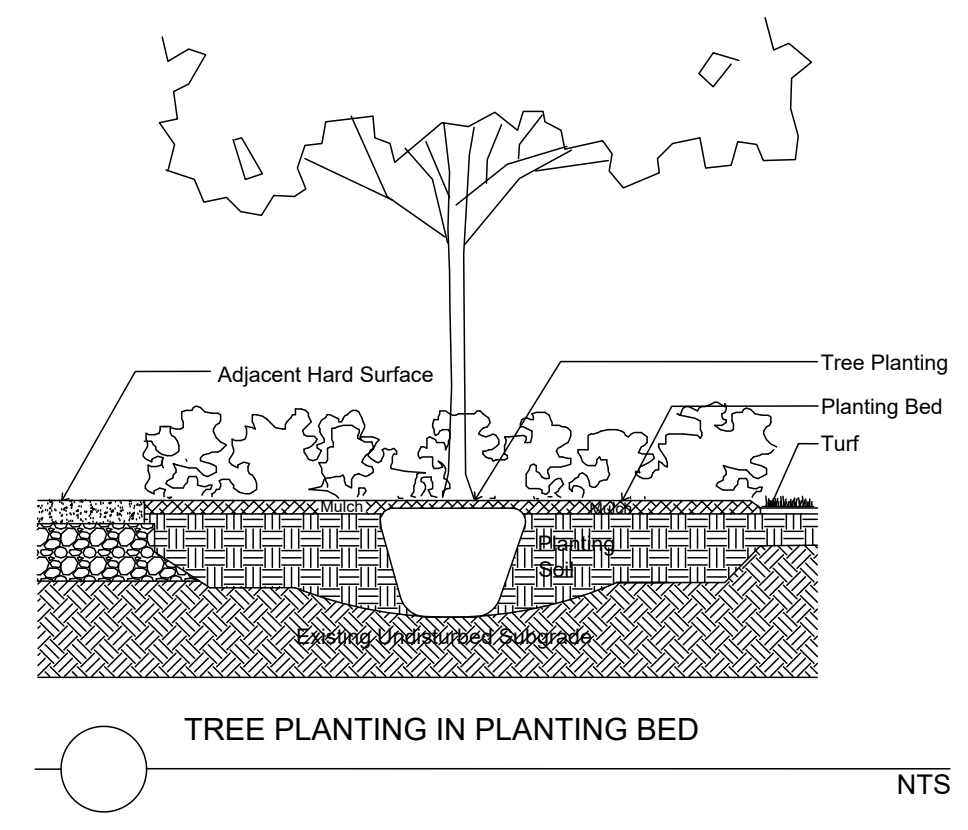
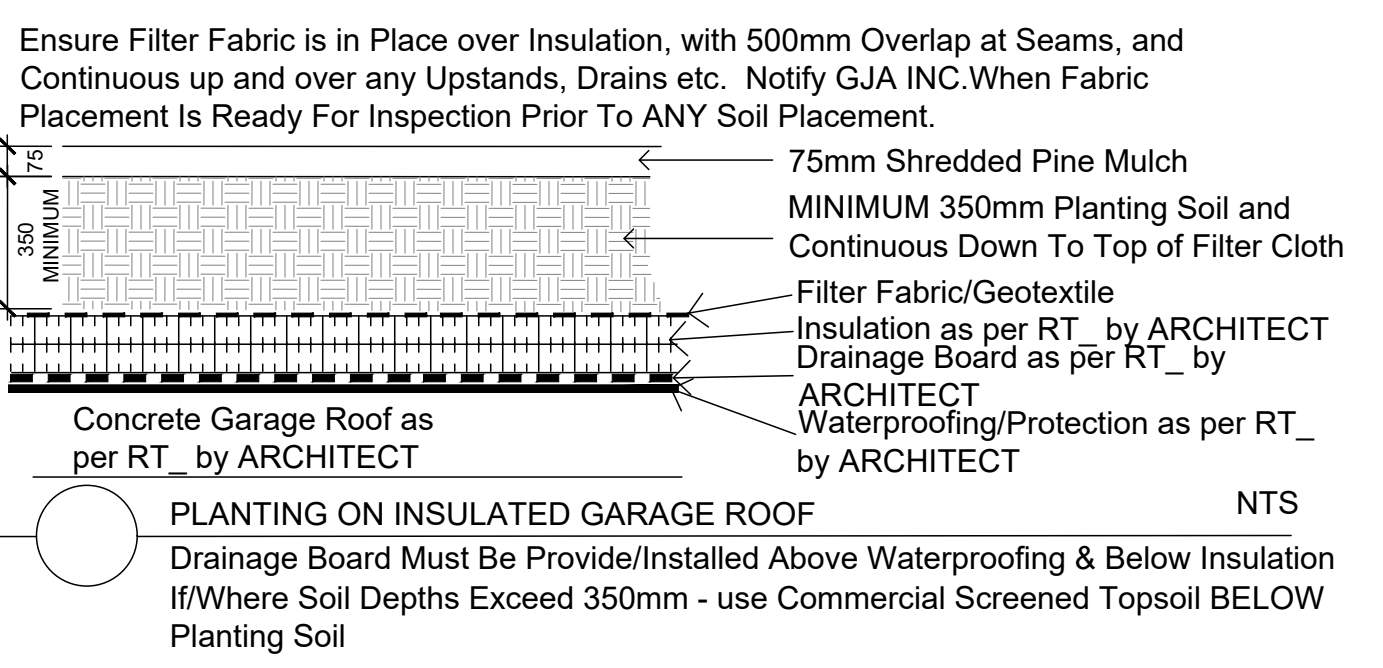
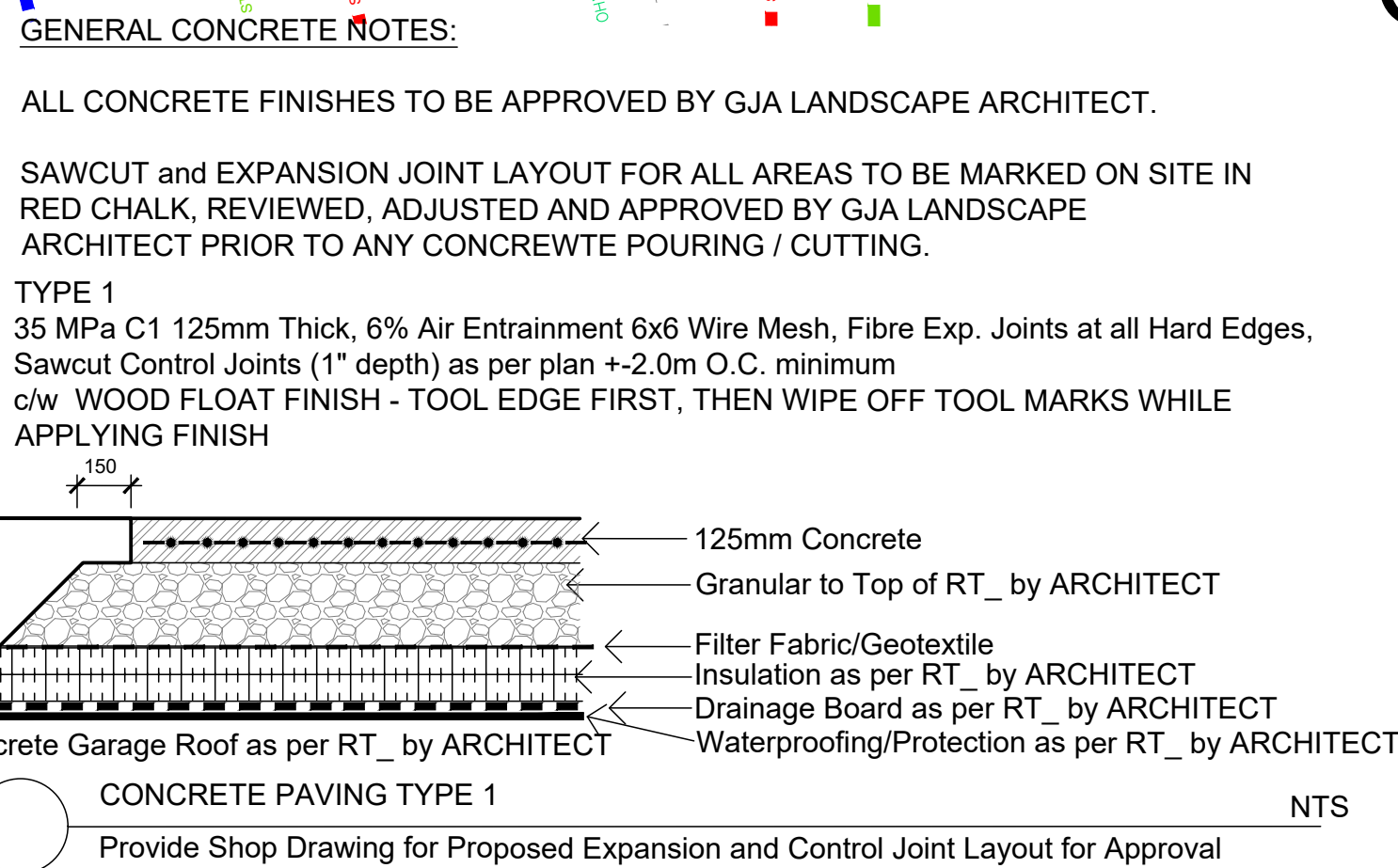
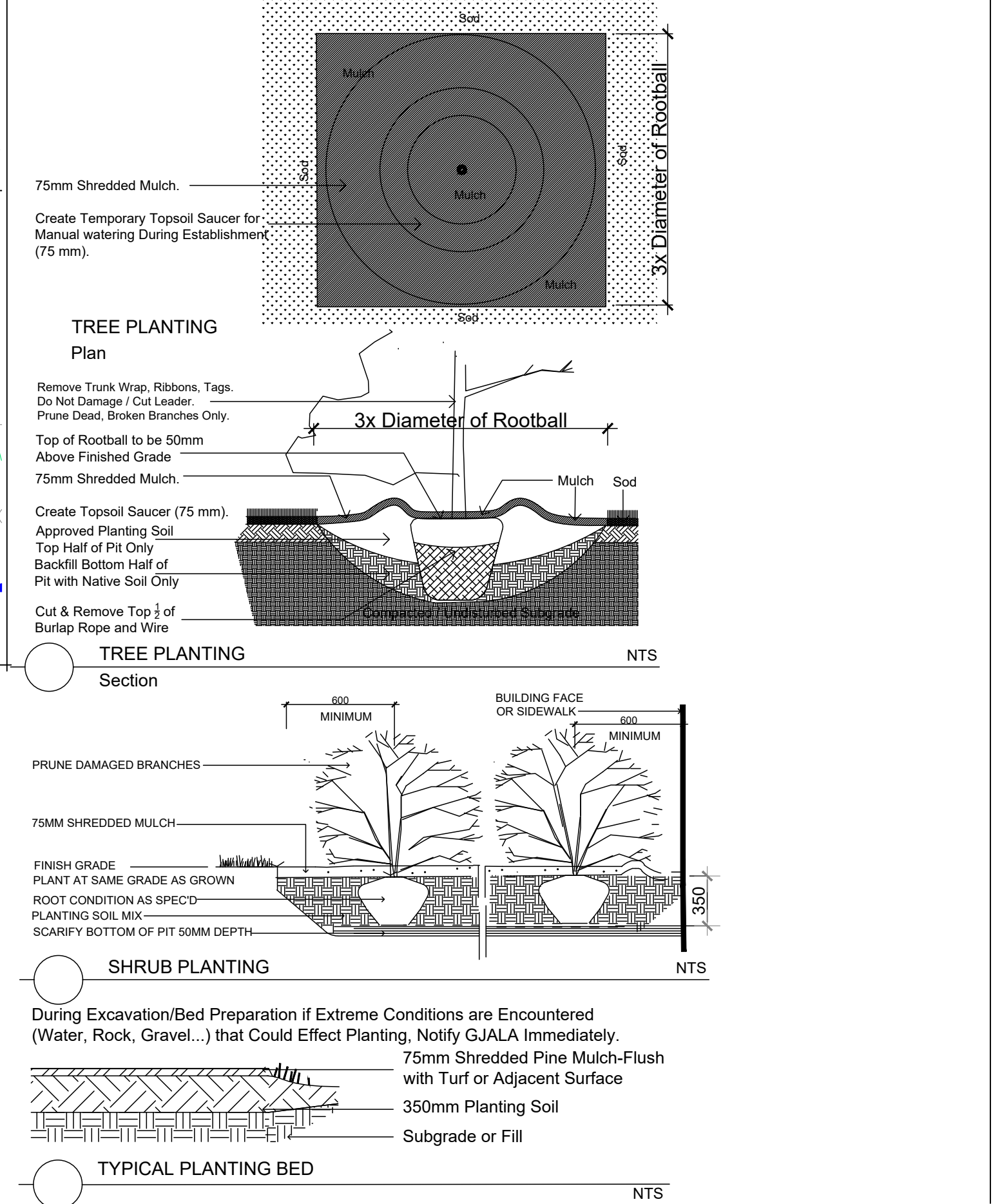

3.0	THIRD SUBMISSION SPC	NOVEMBER 7 2022
2.0	SECOND SUBMISSION SPC	FEBRUARY 28 2021
1.0	FIRST SUBMISSION SPC	SEPTEMBER 21 2021
0.0	REVIEW / COORDINATION	2021
No.	Revision	Date

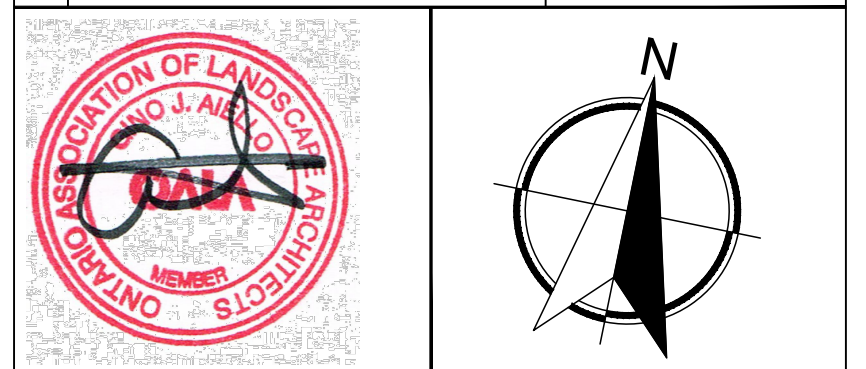

Property **Gemstone (River Road)**  
 Owner **GP Inc.**  
 252 Argyle Ave Ottawa, ON, K2P 1B9

Gino J. Aiello | landscape architect GJALA.com  
 GJA Inc. Gino@GJALA.com (613) 286 5130  
 110 Dabroy Road Unit # 9 | Ottawa Ontario | K2T 0C2

Project **Proposed 5 Storey Condominium Building**  
 949 North River Road

Drawing **Landscape Plan**

Scale: 1:125  
 City of Ottawa  
 Dwg #18583

Sheet Number **L1**

D07-12-21-0150