

| Code  | Qty. | Botanical Name         | Common Name         | Size      | Condition      |
|---|------|------------------------|---------------------|-----------|----------------|
| AC  | 3    | Amelanchier canadensis | Tree Serviceberry   | 60mm cal  | B + B specimen |
| B AND B SMALL MULTI STEM TREES / LARGE SHRUBS - 949 North River Road @ Ontario Street |      |                        |                     |           |                |
| ac  | 3    | Amelanchier canadensis | Serviceberry        | 250cm Ht. | B + B specimen |
| cr  | 5    | Cornus racemosa        | Grey Dogwood        | 250cm Ht. | B + B specimen |
| sr  | 3    | Syringa reticulata     | Japanese Tree Lilac | 250cm Ht. | B + B specimen |
| vf  | 7    | Viburnum lentago       | Nannyberry          | 250cm Ht. | B + B specimen |
| POTTED SHRUBS - 949 North River Road @ Ontario Street                                 |      |                        |                     |           |                |
| HK  | 225  | Hypericum kalmianum    | St. John's Wort     | 30cm Ht.  | Pot            |
| SA  | 110  | Spiraea alba           | Meadowweet          | 60cm Ht.  | Pot            |

**Circum Bicycle Rack**  
 PS-76-101-TP- Circum Bike Rack  
 Our Circum Bicycle Rack features a welded tubular and flat-bar steel construction. It is available in your choice of HauserKOTE powdercoat finishes, or HauserSHIELD Thermoplastic finishes.

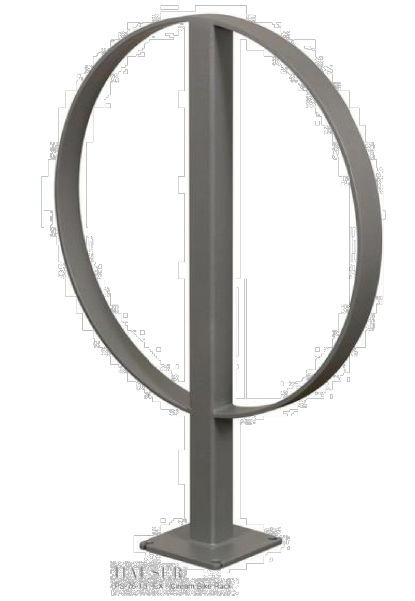

Depth: 2' (5.1 cm)  
 Diameter: 24" (61.0 cm)  
 Height: 33" (83.8 cm)  
 Weight: 21.7 lb (9.9 kg)



sales@hausersite.com  
 800-268-7328  
 hausersite.com

- REFER TO TCR BY IFS**
- Existing Tree to Remain
  - Existing Tree to be Removed
  - Protection for Existing Trees
  - Garage Below

- LANDSCAPE PLAN LEGEND**
- Proposed Coniferous Tree
  - Proposed Deciduous Tree
  - Proposed Planting Bed
  - Proposed Riverwash Stone On Filter Cloth
  - Proposed Pavers
  - PS-76-101-TP- Circum Bike Rack by HAUSER Anchor to Concrete
  - Patio Fencing
  - Fire Hydrant
  - FD Siamese Connection

- BELOW GRADE SERVICES REFER TO CIVIL /CUP**
- U/G Water Service
  - U/G Storm Service
  - U/G Sanitary Service
  - U/G Gas Service
  - U/G TelCo Service
  - U/G Hydro Service
  - O/H Hydro Service

**TYPICAL DETAILS**

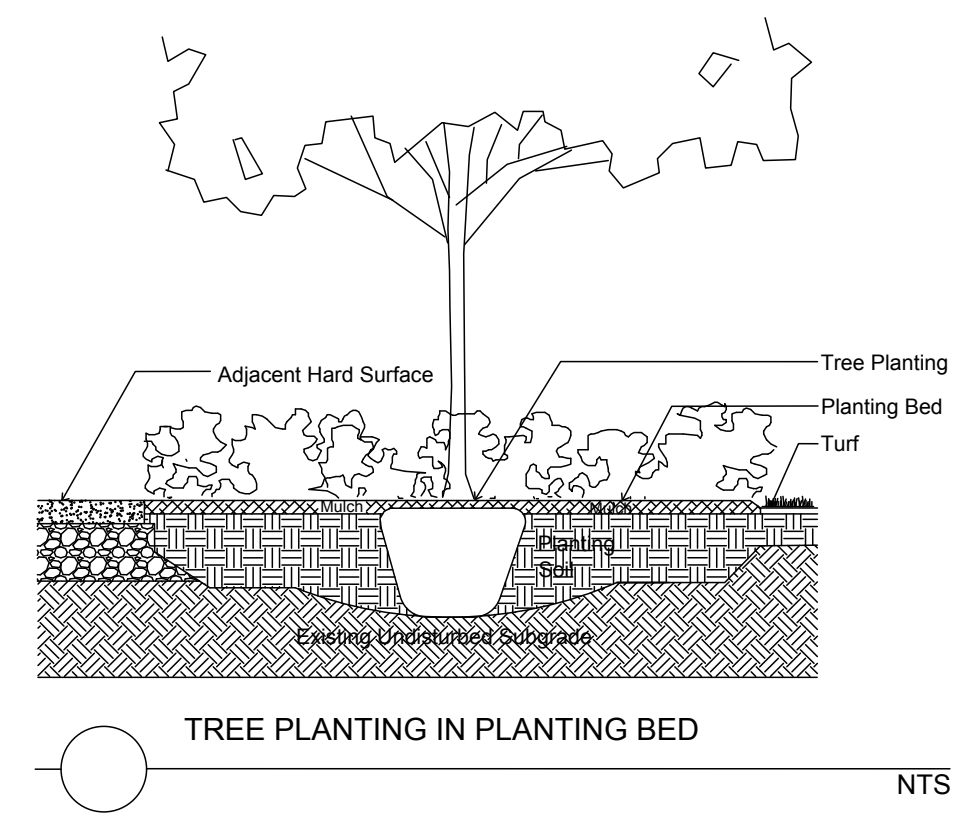
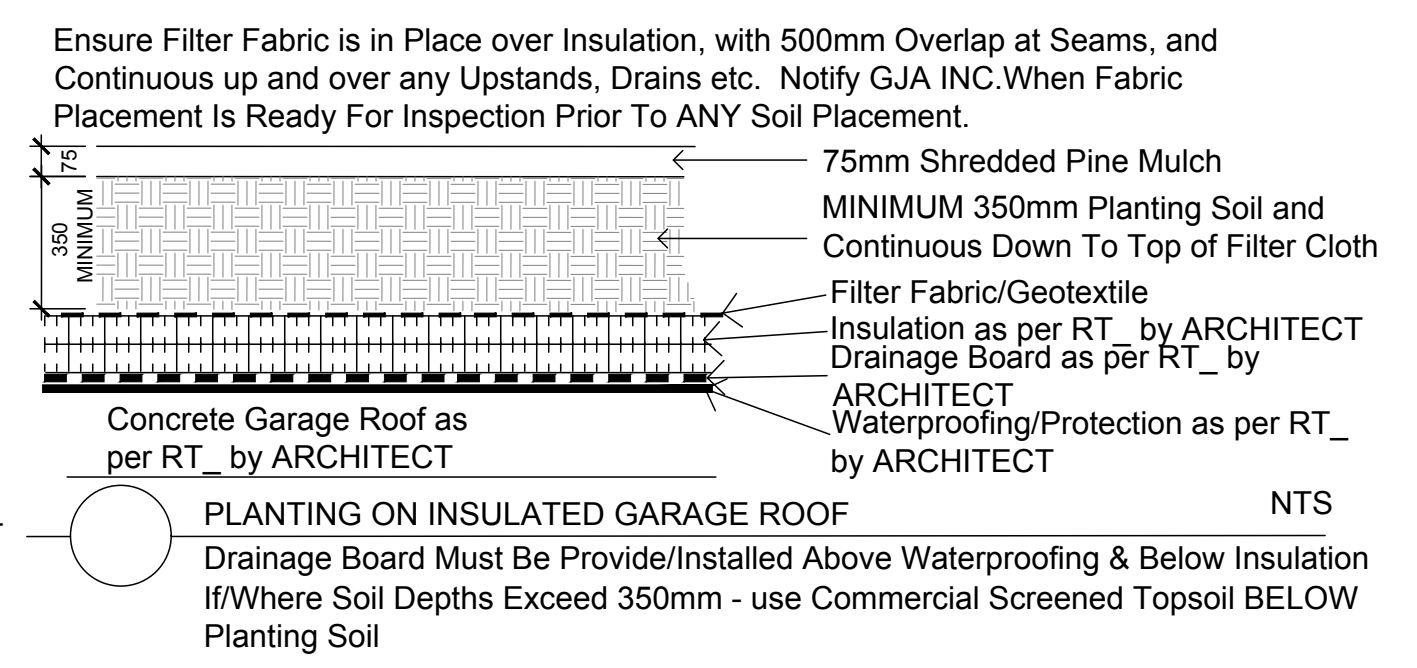
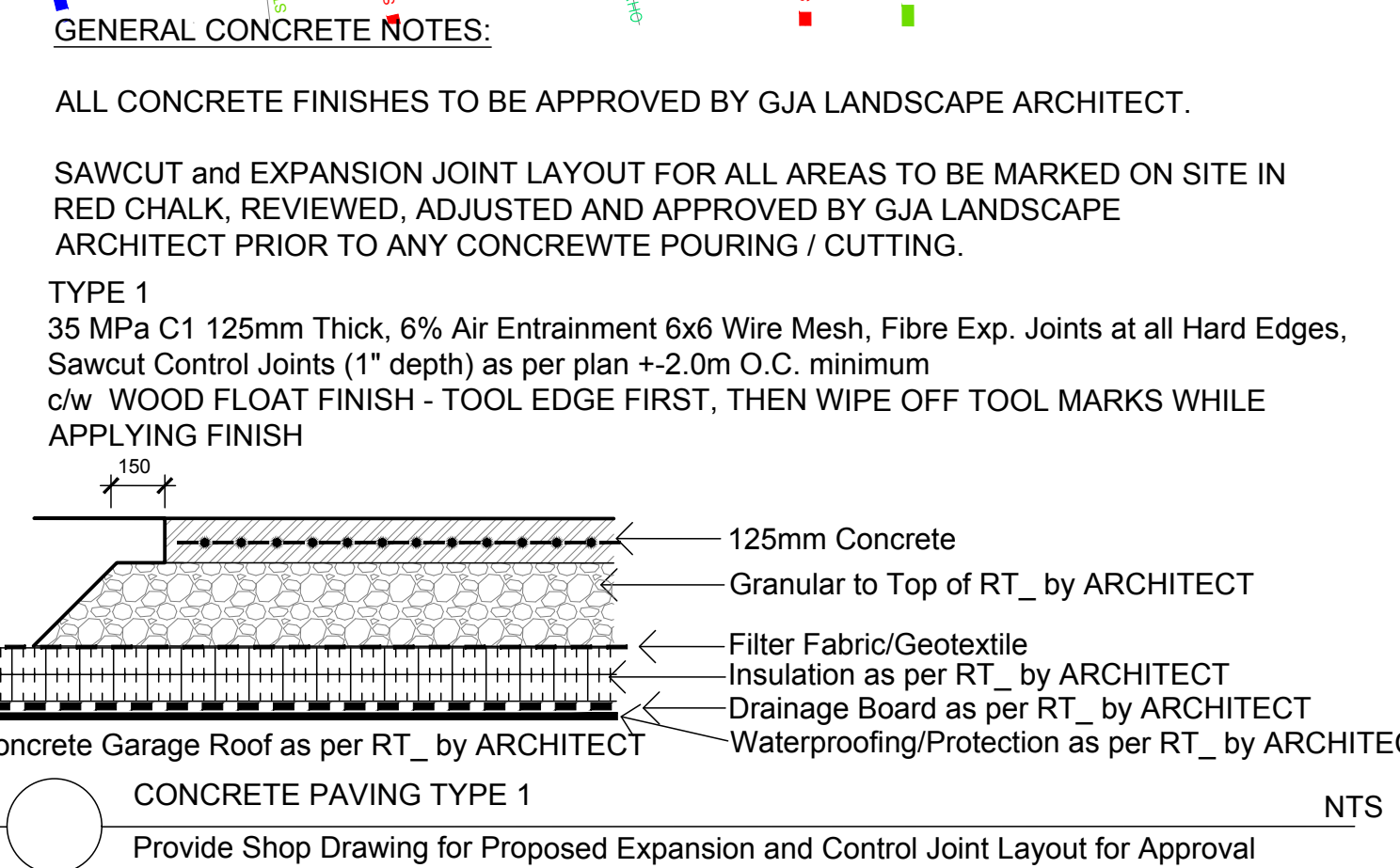
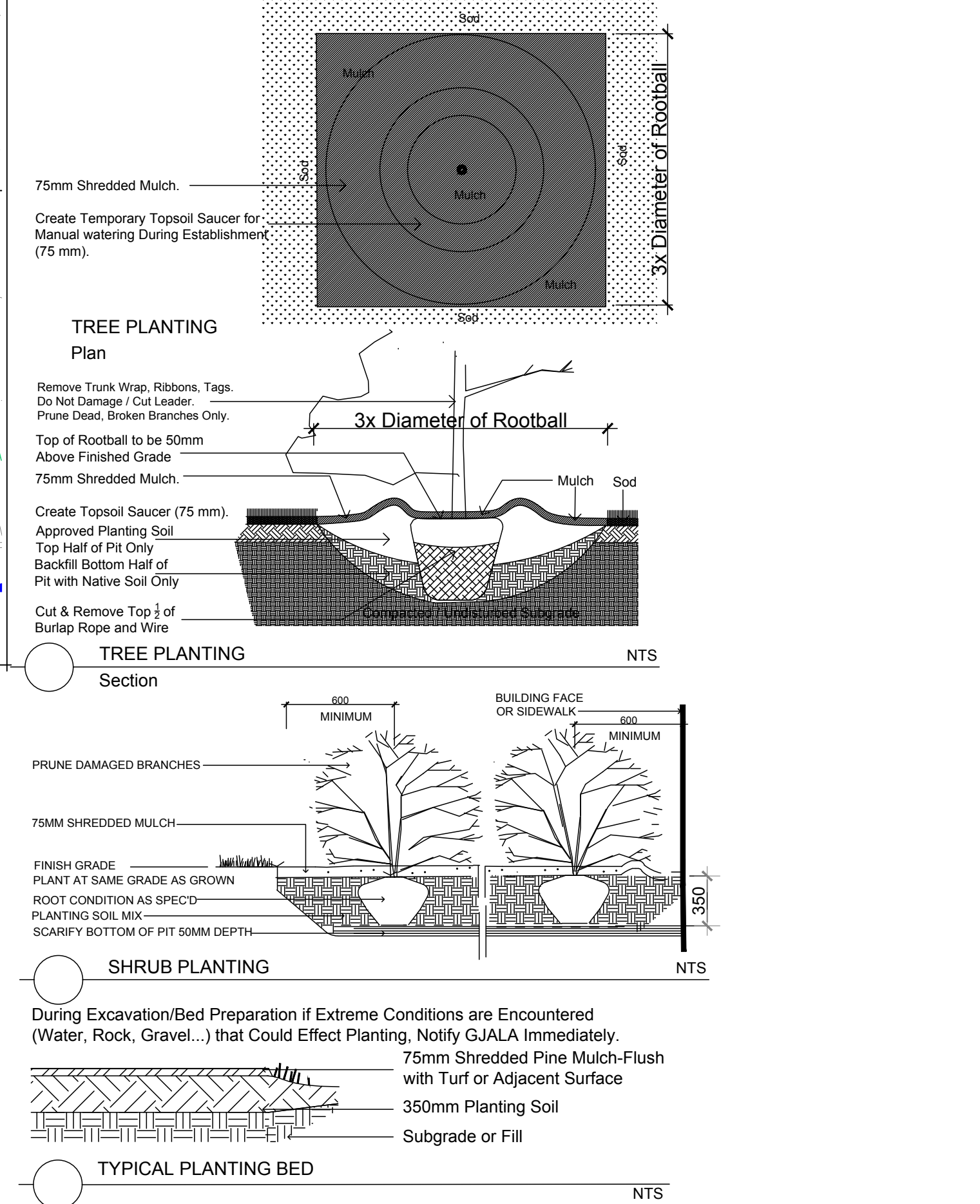

Drawing Remains the Property of/Copyright Reserved by Gino J. Aiello Landscape Architect. Do Not Use or Reproduce Without Approval of Gino J. Aiello. NOT To Be Used For Construction Unless indicated by Revision: "FOR LANDSCAPE CONSTRUCTION". Contractor is Responsible for Verification of Site Locations of all Utilities. Report any Discrepancies Between Site and Drawing Immediately to Gino J. Aiello. Do NOT Proceed Until Clarified.

TURF AREAS TO BE SOD C/W 150MM DEPTH TOPSOIL ON APPROVED SUBGRADE | SOD TO BE #1 GRADE TURFGRASS NURSERY SOD per NSGA - Fine Fescue/Kentucky Bluegrass Sod | PLANTING MIX TO BE APPROVED BY LANDSCAPE ARCHITECT | PLANT MATERIAL TO MEET CNLA STANDARDS/BE APPROVED BY LANDSCAPE ARCHITECT PRIOR TO PLANTING | ALL MATERIALS & WORK TO BE MAINTAINED UNTIL FINAL ACCEPTANCE. (MOWING TURF, WEEDING BEDS, WATERING TURF & PLANTS) & INCLUDE 1 YEAR WARRANTY FROM DATE OF FINAL ACCEPTANCE | PROVIDE WATERING OF ALL PLANT MATERIAL AS REQUIRED FOR PROPER ESTABLISHMENT, UNTIL END OF WARRANTY PERIOD | REFER TO CIVIL ENGINEER'S DRAWING FOR ELEVATIONS / GRADING |

The Landscape Plan is to be read in conjunction with the grading, servicing, site and survey plan | Bare root material to be planted in season only | All plant material locations to be staked on site by the landscape contractor and checked by the landscape architect prior to planting | All trees to be preserved on or directly adjacent to the site will be protected | Plant material are to be installed a minimum of, 3.0m away from any part of any hydro transformer, 3.0m corridor between a fire hydrant and the curb, a 2.5m radius beside or behind a fire hydrant, 2.0m from any servicing/utility line or structure |

|     |                       |                   |
|-----|-----------------------|-------------------|
| 1.0 | FIRST SUBMISSION SPC  | SEPTEMBER 21 2021 |
| 0.0 | REVIEW / COORDINATION | 2021              |
| No. | Revision              | Date              |

Property Owner: **Gemstone (River Road) GP Inc.**  
 252 Argyle Ave Ottawa, ON, K2P 1B9

Gino J. Aiello | landscape architect | GJALA.com  
 GJA Inc. | 110 Dabury Road Unit #9 | Ottawa Ontario K2P 0C2

Project: **Proposed 5 Storey Condominium Building**  
 949 North River Road

Drawing: **Landscape Plan**

Scale: 1:125  
 City of Ottawa  
 Dwg - #####

Sheet Number: **L1**  
 D07-####