

**GENERAL NOTES**

NOTE-A: ALL DRAWINGS ARE TO BE READ IN CONJUNCTION WITH ALL OTHER DRAWINGS AND SPECIFICATIONS, INCLUDING OTHER CONSULTANTS DRAWINGS AND SPECIFICATIONS. ANY DISCREPANCIES BETWEEN DRAWINGS WILL BE REPORTED TO THE PROJECT LEAD IMMEDIATELY FOR CLARIFICATION PRIOR TO COMMENCING ANY CONSTRUCTION.

NOTE-B: ALL GENERAL SITE INFORMATION AND CONDITIONS HAVE BEEN COMPILED FROM EXISTING PLANS AND SURVEYS.

NOTE-C: REFER TO LANDSCAPE PLANN FOR ALL EXTERIOR LANDSCAPING.

NOTE-D: DO NOT SCALE DRAWINGS.

NOTE-E: ALL CONTRACTORS MUST COMPLY WITH ALL APPLICABLE CODES AND REGULATIONS.

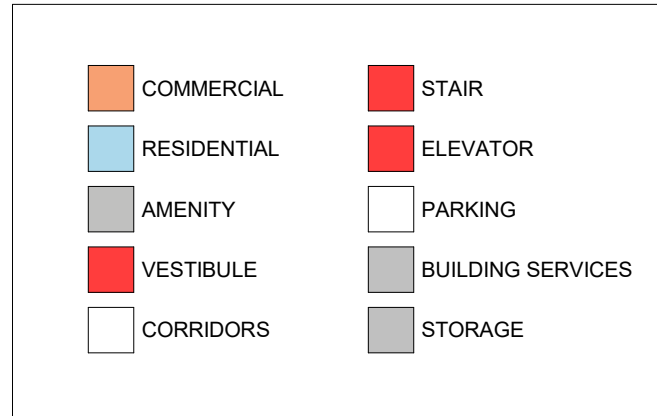

**DRAWING NOTES**

This document and all information herein is confidential and the intellectual property of Rossmann Architects. It is disclosed in confidence on terms that it will not be disclosed to any third party, used, copied, licensed, or reproduced in whole or in any part in any manner or form for manufacturing, rendering or for any other purpose without the written permission of Rossmann Architects.

The copyright is retained by Rossmann Architects and Associates Inc. Ce document, ainsi que tous renseignements contenus à l'intérieur, est la propriété de Rossmann Architects. Il est divulgué en confiance sous les termes qu'il ne sera pas divulgué à aucun tiers, utilisé, vendu, prêté, licencié ou reproduit en son entier ou en partie d'aucune manière pour la manufacture, soumission ou pour autres fins sans la permission écrite de Rossmann Architects.

Le droit d'auteur est retenu par Rossmann Architects.

**NOT FOR / PAS POUR CONSTRUCTION**

**ROSSMANN ARCHITECTURE**  
 88 Saint-Joseph  
 Boulevard, Gatineau QC J8Y 3W5  
 819-600-1555

Drawn by / Dessiné par JDL  
 Reviewed by / Révisé par ES

**TEAM / ÉQUIPE**



Revision	Date	Description
1	2021-09-22	SITE PLAN CONTROL
Release	Date	Description

Revision	Date	Description
1.0	2021-09-22	SITE PLAN APPLICATION
Revision	Date	Description



21019  
**EMD KANATA**  
 Kanata Town Centre (Parcels 2 & 3)  
 Kanata Ave / Maritime Way

**GROUND FLOOR PLAN**