

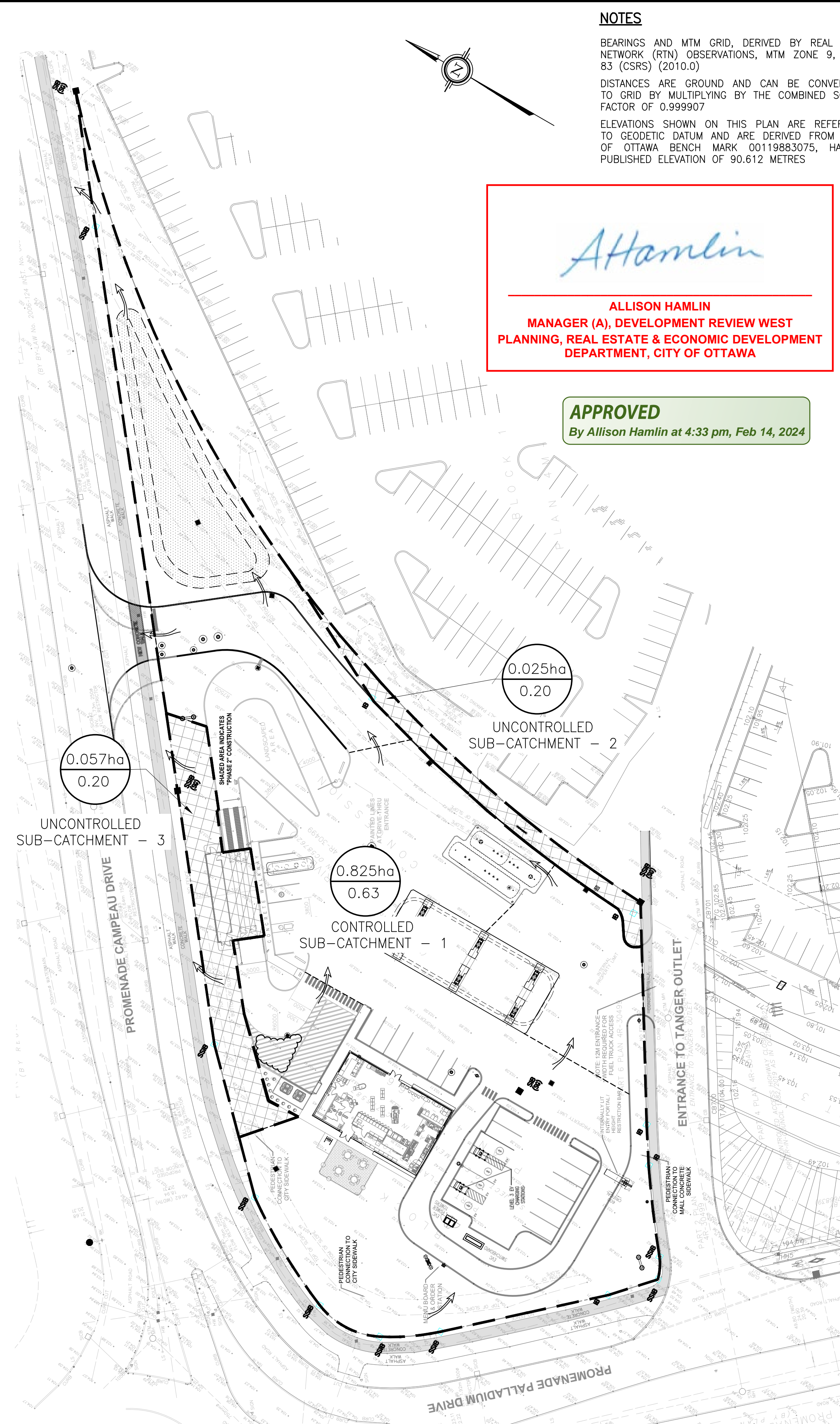

1 PRE-DEVELOPMENT DRAINAGE PLAN  
SCALE: 1:500



2 POST-DEVELOPMENT DRAINAGE PLAN  
SCALE: 1:500

**NOTES**

BEARINGS AND MTM GRID, DERIVED BY REAL TIME NETWORK (RTN) OBSERVATIONS, MTM ZONE 9, NAD 83 (CSRS) (2010.0)  
DISTANCES ARE GROUND AND CAN BE CONVERTED TO GRID BY MULTIPLYING BY THE COMBINED SCALE FACTOR OF 0.999907  
ELEVATIONS SHOWN ON THIS PLAN ARE REFERRED TO GEODETIC DATUM AND ARE DERIVED FROM CITY OF OTTAWA BENCH MARK 00119883075, HAVING PUBLISHED ELEVATION OF 90.612 METRES

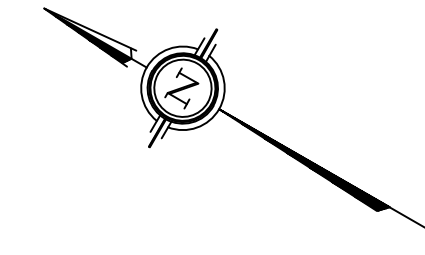

*Allison Hamlin*

**ALLISON HAMLIN  
MANAGER (A), DEVELOPMENT REVIEW WEST  
PLANNING, REAL ESTATE & ECONOMIC DEVELOPMENT  
DEPARTMENT, CITY OF OTTAWA**

**APPROVED**  
By Allison Hamlin at 4:33 pm, Feb 14, 2024

PLAN OF SURVEY  
PART 1 - PLAN OF SURVEY OF  
PART OF BLOCK 6  
PLAN 4M-1566  
AND  
PART OF LOT 3  
CONCESSION 1  
GEOGRAPHIC TOWNSHIP OF HUNTLEY  
CITY OF OTTAWA

**SUBJECT SITE**

**KEY PLAN**  
NTS

**GENERAL NOTES**

1. VERIFY ALL DIMENSIONS PRIOR TO CONSTRUCTION.
2. DO NOT SCALE DRAWINGS.
3. REPORT ALL DISCOVERIES OF ERRORS, OMISSIONS OR DISCREPANCIES TO THE DESIGN ENGINEER AS APPLICABLE.
4. USE ONLY LATEST REVISED DRAWINGS OR THOSE THAT ARE MARKED "ISSUED FOR CONSTRUCTION".
5. DESIGN AND CONSTRUCTION OF THIS PROJECT SHALL COMPLY WITH THE PROVINCIAL AND LOCAL BUILDING CODES LATEST EDITION.
6. ALL WORKS AND MATERIALS USED SHALL COMPLY AS REQUIRED BY THE BUILDING CODE LATEST EDITION.
7. THIS DRAWING SHALL BE READ IN CONJUNCTION WITH ALL RELEVANT DRAWINGS & SPECIFICATIONS.
8. EVERYTHING IS TO BE CONSIDERED NEW UNLESS SPECIFIED EXISTING OTHERWISE.

**REVISION TABLE**

REV.	DESCRIPTION	DRAWN	APP'D.	DATE
0	REVISED AS PER SITE PLAN MAR 14, 2023 AND CITY COMMENTS	MJ	JS	14 MAR 23
1	REVISED AS PER SITE PLAN JUN 07, 2023 AND CITY COMMENTS	MJ	JS	15 JUN 23
2	REVISED AS PER SITE PLAN JUL 17, 2023	SS	JS	19 JUL 23

**ISSUE TABLE**

TO	FOR	DATE
SUNCOR	FOR REVIEW	08 JUL 22
CITY	ISSUED FOR SPA	28 JUL 22
SUNCOR	FOR REVIEW	24 FEB 23
CITY	RE-ISSUED FOR SPA	17 MAR 23
CITY	RE-ISSUED FOR SPA	15 JUN 23

**LEGEND**

- EXISTING ELEVATION
- EXISTING CATCHBASIN
- EXISTING MANHOLE
- NEW CATCHBASIN
- NEW C.B./M.H.
- DRAINAGE AREA (ha)  
RUNOFF COEFFICIENT
- OVERLAND FLOW
- NEW MANHOLE
- PROPERTY LINE
- RIDGE LINE
- CATCHMENT BOUNDARY
- UNCONTROLLED AREA
- DRY POND

**METRIC**  
ALL DIMENSIONS ARE IN MILLIMETRES U.N.O. CONTRACTOR TO CHECK/VERIFY ALL DIMENSIONS PRIOR TO COMMENCEMENT OF WORK. ALL DISCREPANCIES TO BE REPORTED TO THE PROJECT DESIGNER. DO NOT SCALE DRAWINGS.

CONSULTANT:

**J + B ENGINEERING INC.**  
TORONTO: 25 CANTERBURY DR. SUITE 201 MARKHAM, ON L3R 9W8 416 328 2816  
CALGARY: 7020 STEELES AVE. SW SUITE 100 CALGARY, AB T2R 0B3 403 305 2395

**PETRO-CANADA**  
A Suncor Energy Business

DRAWING TITLE:  
**PRE-POST DRAINAGE PLAN**

PROJECT:  
**PROMENADE PALLADIUM DRIVE  
@ PROMENADE CAMPEAU DRIVE**  
OTTAWA, ON



ISSUE TABLE		TO	FOR	DATE
		CITY	RE-ISSUED FOR SPA	21 JUL 23
DRAWN BY:	BR	CAD INEO:	D	(559 x 864)
DRAWING SCALE:	1:300	CONSULTANT	PETRO-CANADA	CAD FILE No.
DATE DRAWN:	2022-07-01	CONSULTANT	PETRO-CANADA	CAD FILE No. 200258-P303
CHECKED BY:	JS	PLOT SCALE	1:1	PLOT DATE
APPROVED BY:	JK	PLOT CONFIGURATION		
STD No./OUTLET No.	10565		P303	