

87 Lloydalex Crescent 85 Lloydalex Crescent 83 Lloydalex Crescent 81 Lloydalex Crescent

75 ac
50 cr
50 sva
75 vl

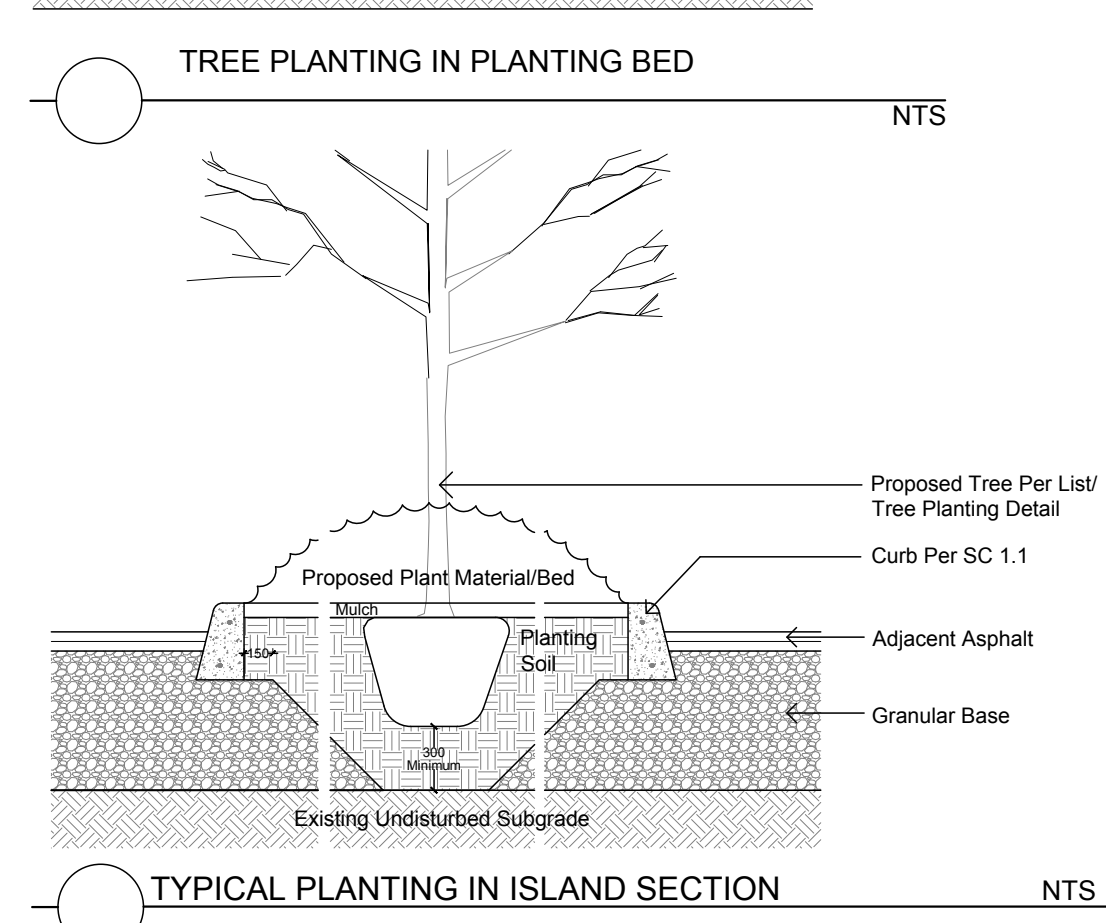
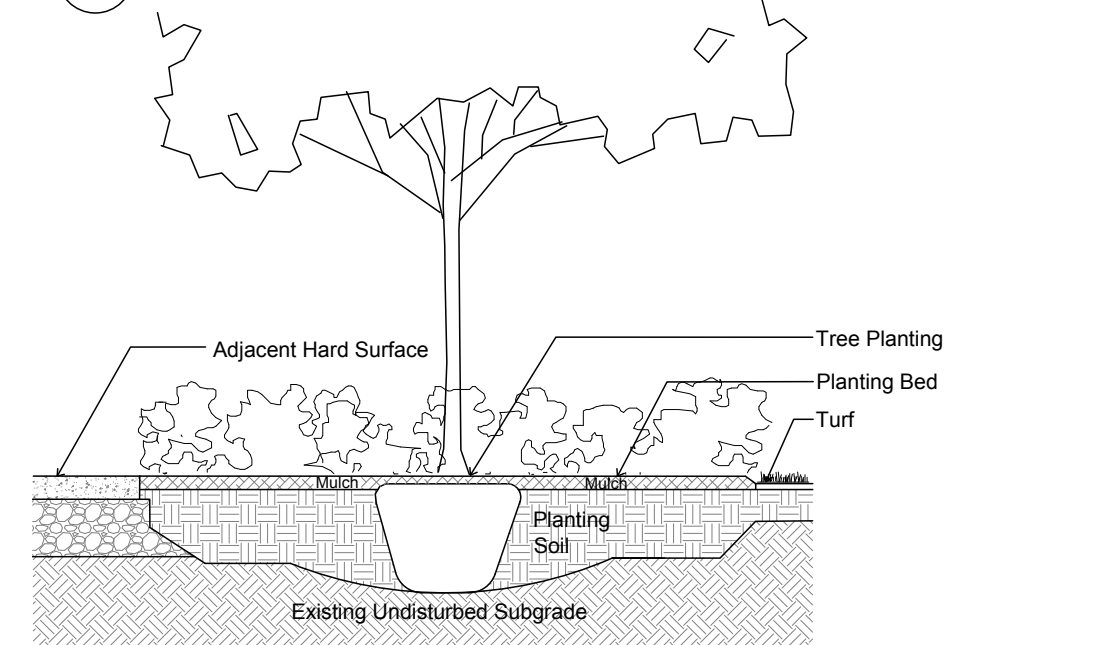
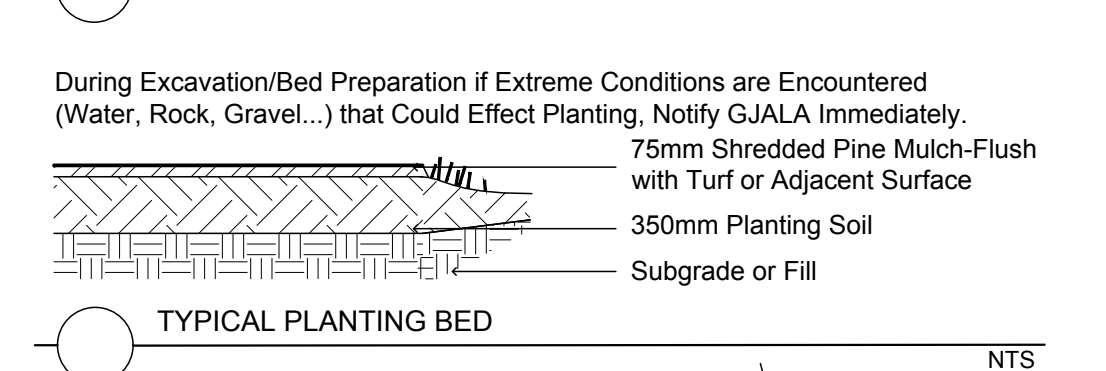
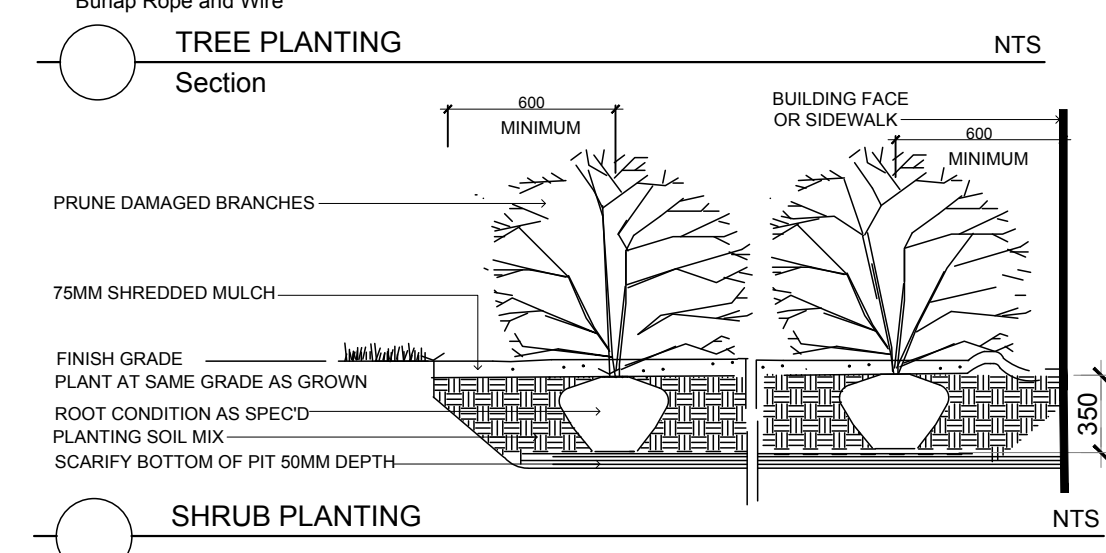
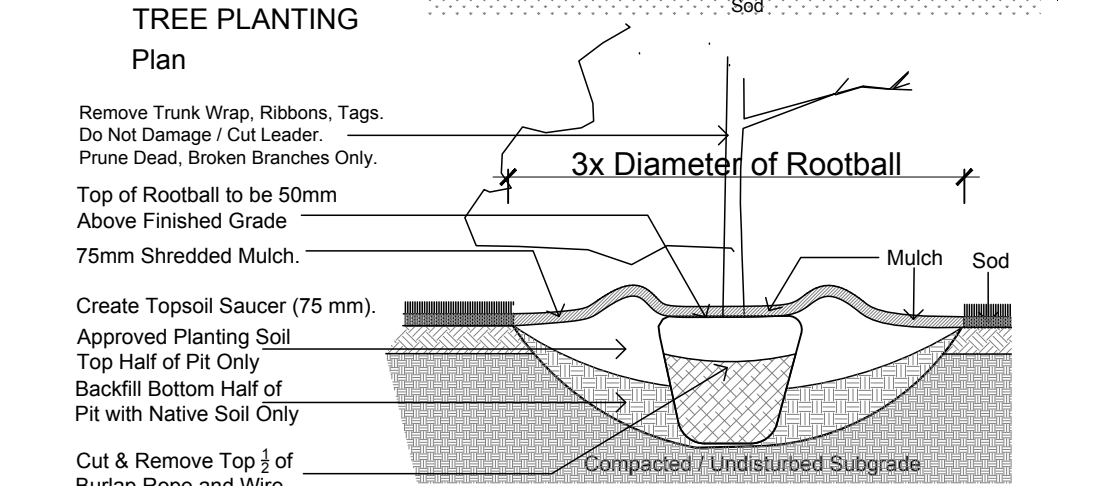
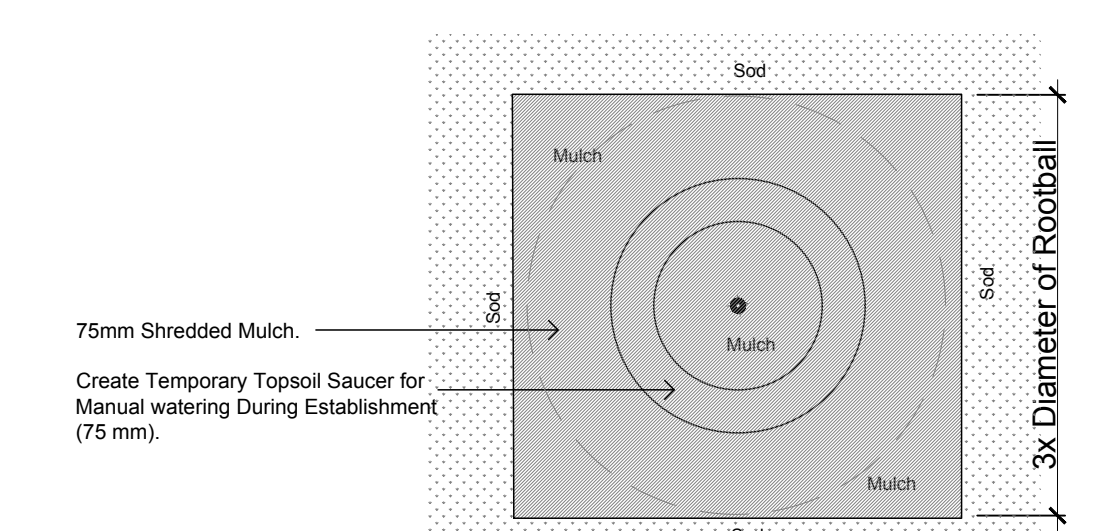
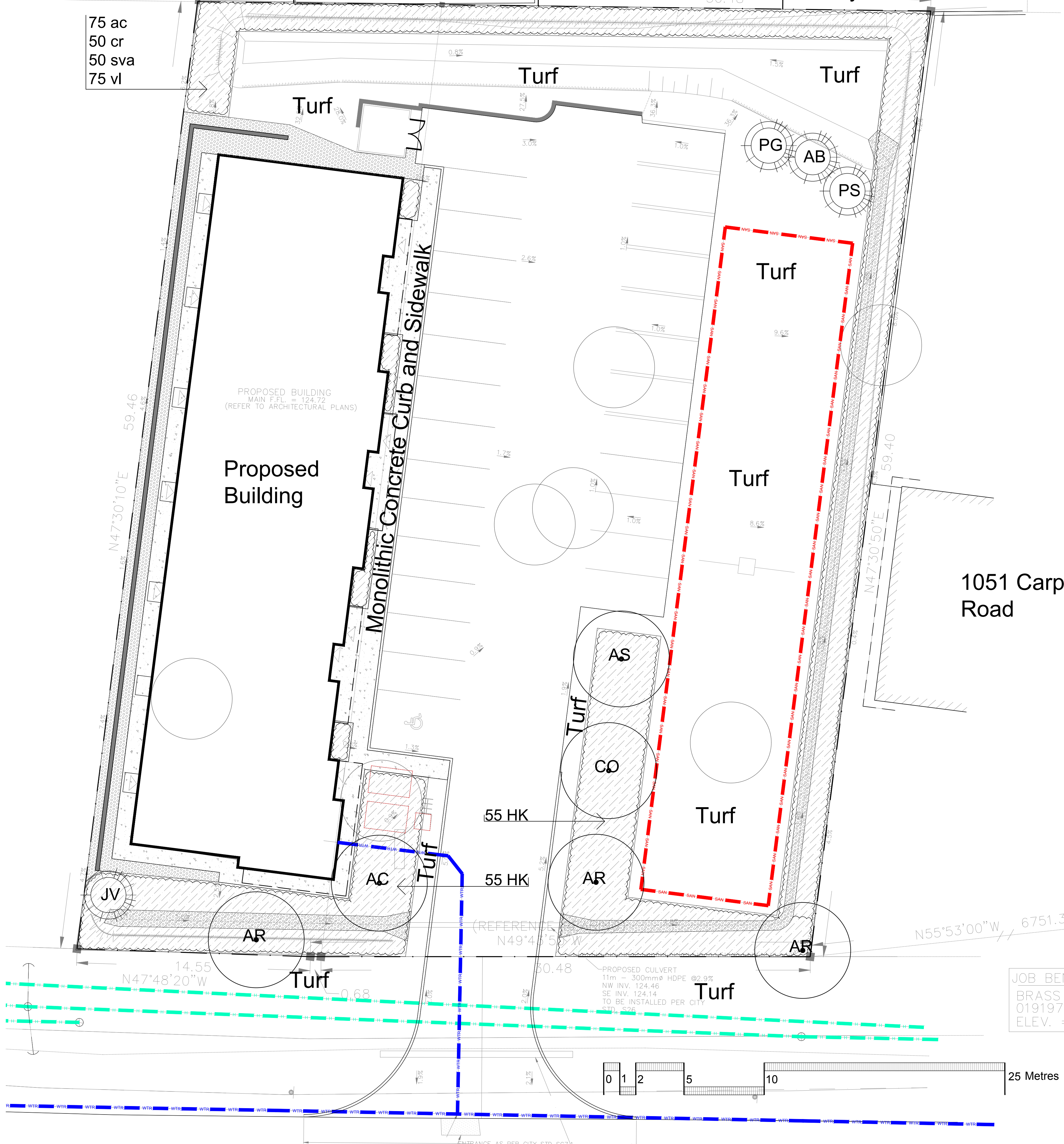

Code	Qty.	Botanical Name	Common Name	Size	Condition
AC	1	Amelanchier canadensis	Serviceberry	50mm cal	B + B specimen
AR	2	Acer rubrum	Red Maple	70mm cal	B + B specimen
AS	1	Acer saccharum	Sugar Maple	70mm cal	B + B specimen
CO	1	Celtis occidentalis	Common Hackberry	60mm cal	B + B specimen
AB	1	Abies balsamea	Balsam Fir	1.75m Ht.	B + B specimen
JV	1	Juniperus virginiana	Eastern Red Cedar	1.5m Ht.	B + B specimen
PG	1	Picea glauca	White Spruce	2.0m Ht.	B + B specimen
PS	1	Pinus strobus	White Pine	1.5m Ht.	B + B specimen

Code	Qty.	Botanical Name	Common Name	Size	Condition
ac	75	Amelanchier canadensis	Serviceberry	60cm Ht.	Pot
cr	50	Cornus racemosa	Grey Dogwood	60cm Ht.	Pot
HK	150	Hypericum kalmianum	St. John's Wort	40cm Ht.	Pot
sv	50	Syringa vulgaris 'Alba'	White Common Lilac	100cm Ht.	Pot
vl	75	Viburnum lentago	Nannyberry	80cm Ht.	Pot

Drawing Remains the Property of/Copyright Reserved by Gino J. Aiello Landscape Architect. Do Not Use or Reproduce Without Approval of Gino J. Aiello. NOT To Be Used For Construction Unless indicated by Revision: "FOR LANDSCAPE CONSTRUCTION". Contractor is Responsible for Verification of Site Locations of all Utilities. Report any Discrepancies Between Site and Drawing Immediately to Gino J. Aiello. Do NOT Proceed Until Clarified.

TURF AREAS TO BE SOD C/W 150MM DEPTH TOPSOIL ON APPROVED SUBGRADE | SOD TO BE #1 GRADE TURFGRASS NURSERY SOD per NSGA - Fine Fescue/Kentucky Bluegrass Sod | PLANTING MIX TO BE APPROVED BY LANDSCAPE ARCHITECT | PLANT MATERIAL TO MEET CNLA STANDARDS/BE APPROVED BY LANDSCAPE ARCHITECT PRIOR TO PLANTING | ALL MATERIALS & WORK TO BE MAINTAINED UNTIL FINAL ACCEPTANCE. (MOWING TURF, WEEDING BEDS, WATERING TURF & PLANTS) & INCLUDE 1 YEAR WARRANTY FROM DATE OF FINAL ACCEPTANCE | PROVIDE WATERING OF ALL PLANT MATERIAL AS REQUIRED FOR PROPER ESTABLISHMENT, UNTIL END OF WARRANTY PERIOD | REFER TO CIVIL ENGINEER'S DRAWING FOR ELEVATIONS / GRADING |

The Landscape Plan is to be read in conjunction with the grading, servicing, site and survey plan | Bare root material to be planted in season only | All plant material locations to be staked on site by the landscape contractor and checked by the landscape architect prior to planting | All trees to be preserved on or directly adjacent to the site will be protected | Plant material are to be installed a minimum of, 3.0m away from any part of any hydro transformer, 3.0m corridor between a fire hydrant and the curb, a 2.5m radius beside or behind a fire hydrant, 2.0m from any servicing/utility line or structure |

- REFER TO TCR BY IFS
- 1 Existing Tree to Remain
 - 1 Existing Tree to be Removed
 - Protection for Existing Trees
- LANDSCAPE PLAN LEGEND
- PG Proposed Coniferous Tree
 - CR Proposed Deciduous Tree
 - Proposed Planting Bed
 - Proposed Riverwash Stone On Filter Cloth
 - Proposed Pavers
 - PS-76-101-TP- Circum Bike Rack by HAUSER Anchor to Concrete
- BELOW GRADE SERVICES REFER TO CIVIL /CUP
- WTR U/G Water Service
 - STM U/G Storm Service
 - SAN U/G Sanitary Service
 - H O/H Hydro Service
 - GAS U/G Gas Service
 - BC U/G TelCo Service

No.	Revision	Date
1	FIRST SUBMISSION SPC	SEPTEMBER 08 2021
0	REVIEW COORDINATION	JAN-MARCH 2021

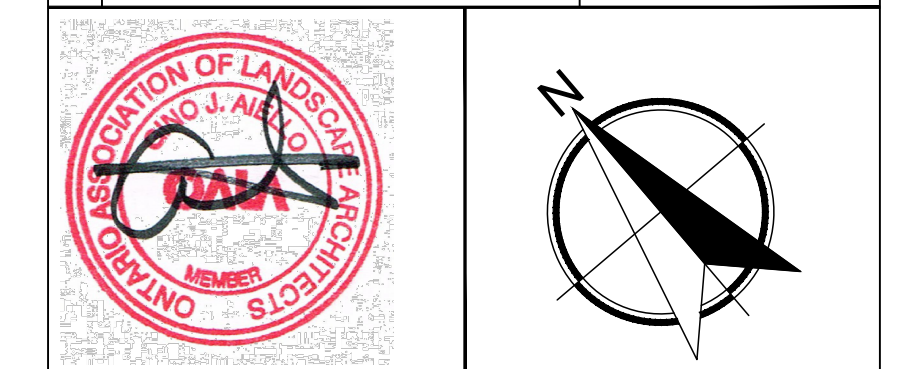

Property Owner: GJA Inc. GJALA.com
110 Didsbury Road Unit # 9 | Ottawa Ontario | K2T 0C2

Project: PROPOSED COMMERCIAL BUILDING 1037 CARP ROAD

Drawing: Landscape Plan

Date: DECEMBER 2020 Sheet Number: L1

Scale: 1:125

City of Ottawa Dwg - #####

JOB BEN BRASS 0191977 ELEV. =

