

| D DISTANCE FROM C.B. OR M.H. WALL | T REQUIRED INSULATION THICKNESS T=T ₁ +T ₂ |
|-----------------------------------------|---------------------------------------------------------------------------|
| 2400 - 1800 mm. | 50 mm |
| 1800 - 1500 mm. | 75 mm |
| 1500 - 1200 mm. | 100 mm |
| 1200 - 900 mm. | 125 mm |

NOTES

- FOR WATERMANS & SERVICES IN PROXIMITY TO CATCHBASINS MAINTENANCE HOLES, CULVERTS ETC.
- INSULATION SHALL EXTEND 1000 mm EACH WAY FROM THE ENDS OF THE STRUCTURE, PARALLELED TO THE WATERMAIN.
- STAGGER JOINTS OF MULTIPLE SHEETS.
- ALL DIMENSIONS ARE IN MILLIMETRES UNLESS SHOWN OTHERWISE.
- INSULATION CAN BE AT EITHER LOCATION OR BOTH.

Ottawa THERMAL INSULATION OF WATERMANS AT OPEN STRUCTURES

| | |
|------------|----------|
| DATE: | MAY 2001 |
| REV. DATE: | FEB 2004 |
| DWG. No.: | W.2.3 |

CONCRETE BARRIER CURB

NOTES

- THE FULL CURB DEPTH SHALL BE CARRIED THROUGH THE DEPRESSIONED ACCESS CROSSING.
- A CONCRETE SUPPORT IS REQUIRED WHEN BUILT ADJACENT TO THE SIDEWALK.
- IF AN EXTRUSION CURBING MACHINE IS USED, THE EXPANSION BITUMINOUS MATERIAL AND THE #15 DOWELS ARE TO BE PLACED AT THE END OF THE EXTRUSION.
- ALL DIMENSIONS ARE IN MILLIMETRES UNLESS SHOWN OTHERWISE.
- DUMMY JOINTS SHALL BE 25mm DEEP, FRONT, BACK AND TOP OF SECTION AT 4m SPACING OR MATCH JOINTING WHERE SIDEWALK IS ADJACENT.
- FOR DEPRESSIONED CURB AT ENTRANCES USE 250.
- DEPRESSIONED CURB HEIGHT - FOR PEDESTRIAN CURB RAMPS 0 TO 6 mm AND FOR PRIVATE ENTRANCES 0 TO 13mm.

Ottawa CONCRETE BARRIER CURB FOR GRANULAR BASE PAVEMENT (MODIFIED OPSD-600.110)

| | |
|------------|--------------|
| DATE: | JANUARY 2003 |
| REV. DATE: | MARCH 2021 |
| DWG. No.: | SC1.1 |

PRIVATE ENTRANCE DETAIL - RURAL

NOTES

- APPROVED NEW CULVERT MATERIAL ONLY, MIN. 500mm UNLESS SPECIFIED OTHERWISE, DITCH AND CULVERT TO BE SIZED ACCORDING TO SEWER DESIGN GUIDELINE MANUAL.
- LENGTH OF CULVERTS IS DEPENDENT UPON THE DEPTH OF DITCH AND WIDTH OF ENTRANCE.
- ENTRANCE CULVERTS GREATER THAN 900mm DIA OR MULTIPLE CULVERTS MUST BE APPROVED PRIOR TO INSTALLATION. CULVERTS OVER 12m LONG AND HEADWALLS REQUIRE APPROVAL AND PERMIT BY THE CITY.
- IN FROST SUSCEPTIBLE SOILS SPECIAL BEDDING CONDITIONS WILL BE REQUIRED.
- REMOVE ALL ORGANICS FROM SIDE SLOPES AND DITCH BOTTOM PRIOR TO PLACING CULVERT AND GRANULARS.
- CULVERT TO BE COUNTERSUNK 10% OF ITS DIAMETER BELOW FINISHED DITCH INVERT.
- WHERE SPECIFIED, APPROVED DITCHED PIPE TO BE AT A MINIMUM GRADE OF 0.5% AND BE NON-PERFORATED TYPE UNDER CULVERTS.
- SEE MS 22.15 FOR APPROVED PRODUCTS UNLESS OTHERWISE STATED IN THE CONTRACT, CONSTRUCTION AS PER OPS 421.
- ALL DIMENSIONS ARE IN MILLIMETRES UNLESS SHOWN OTHERWISE.

Ottawa PRIVATE ENTRANCE DETAIL - RURAL

| | |
|------------|------------|
| DATE: | MAY 2001 |
| REV. DATE: | MARCH 2016 |
| DWG. No.: | S26 |

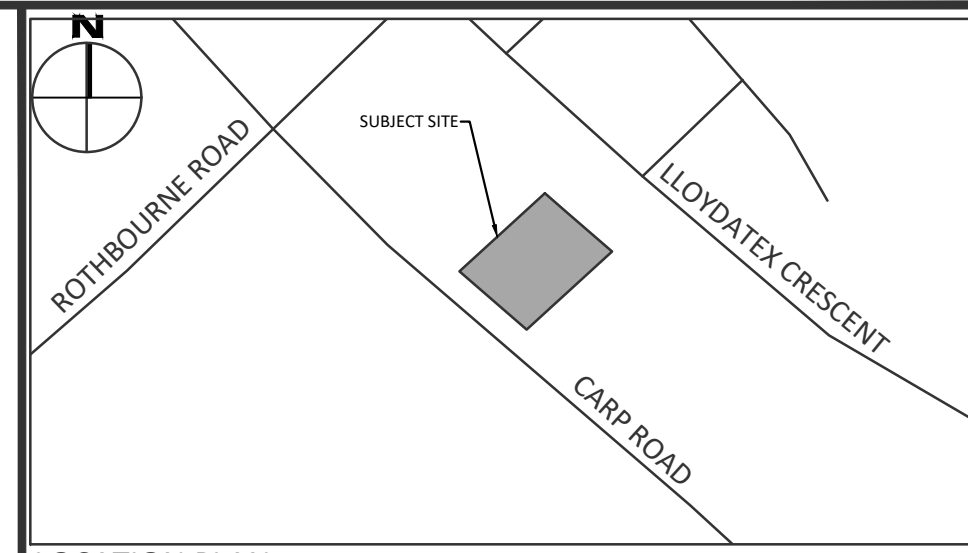

LEGEND

APPROVED
By Kersten Nitsche at 2:24 pm, Apr 26, 2024

Kersten Nitsche
KERSTEN NITSCH, MCIP RPP
MANAGER (A), DEVELOPMENT REVIEW WEST
PLANNING, DEVELOPMENT AND BUILDING SERVICES
DEPARTMENT, CITY OF OTTAWA

| No. | Revisions | Date |
|-----|------------------------------|---------------|
| 04 | ISSUED FOR APPROVAL | MAR. 26, 2024 |
| 03 | ISSUED FOR SITE PLAN CONTROL | AUG. 04, 2023 |
| 02 | ISSUED FOR MUNICIPAL REVIEW | MAR. 24, 2023 |
| 01 | ISSUED FOR MUNICIPAL REVIEW | NOV. 29, 2022 |
| No. | Revisions | Date |

Check and verify all dimensions before proceeding with the work. Do not scale drawings.

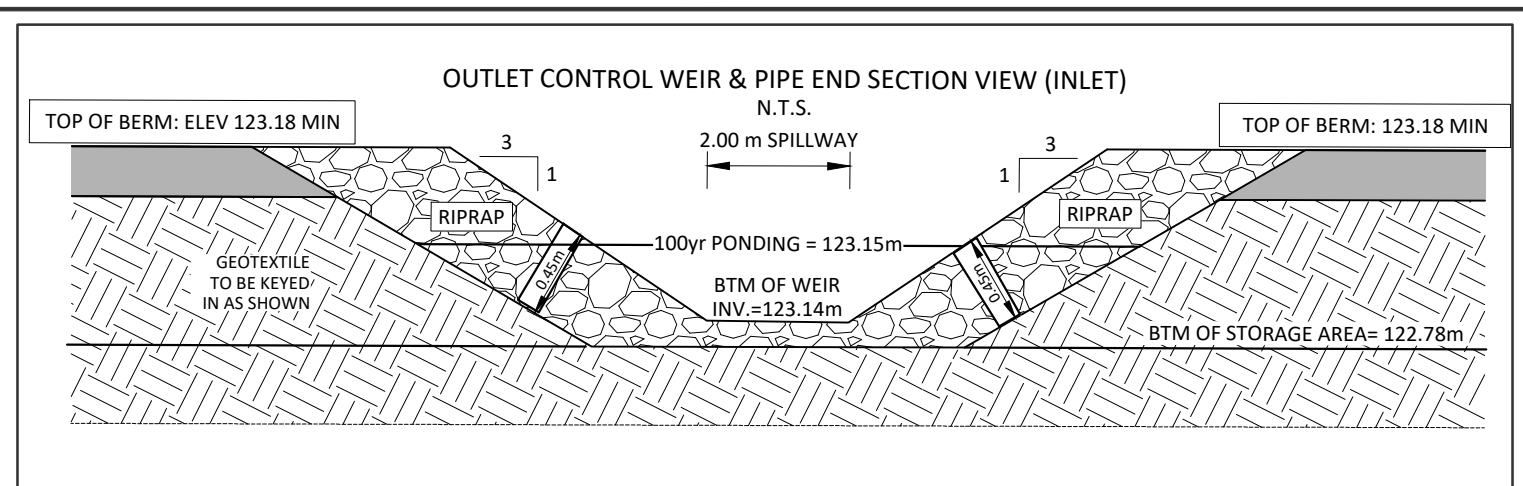
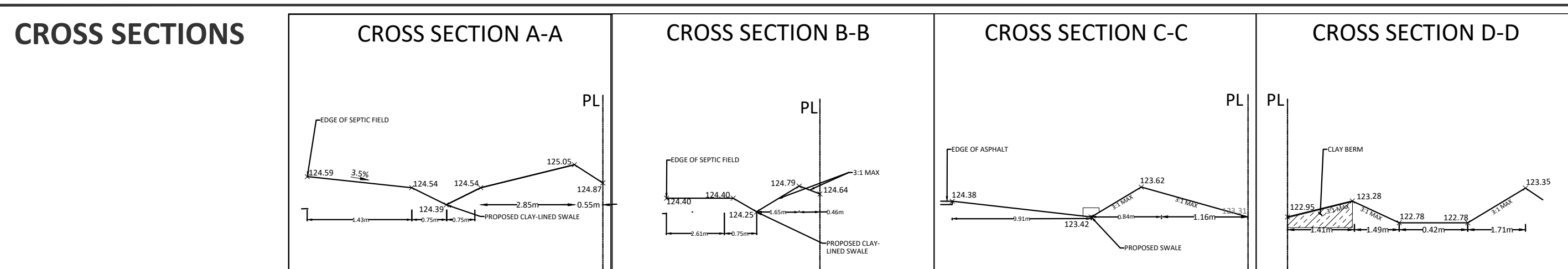
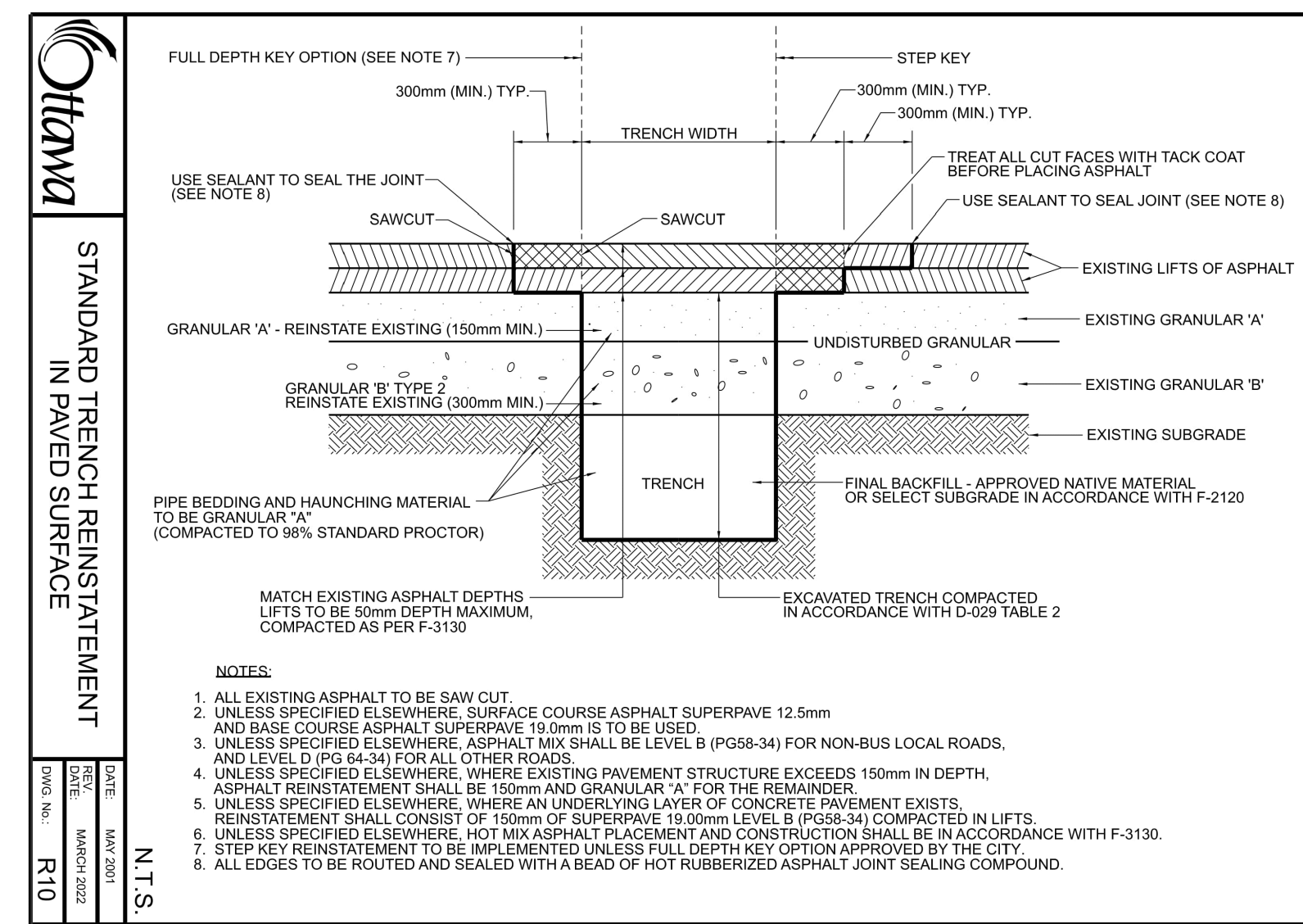
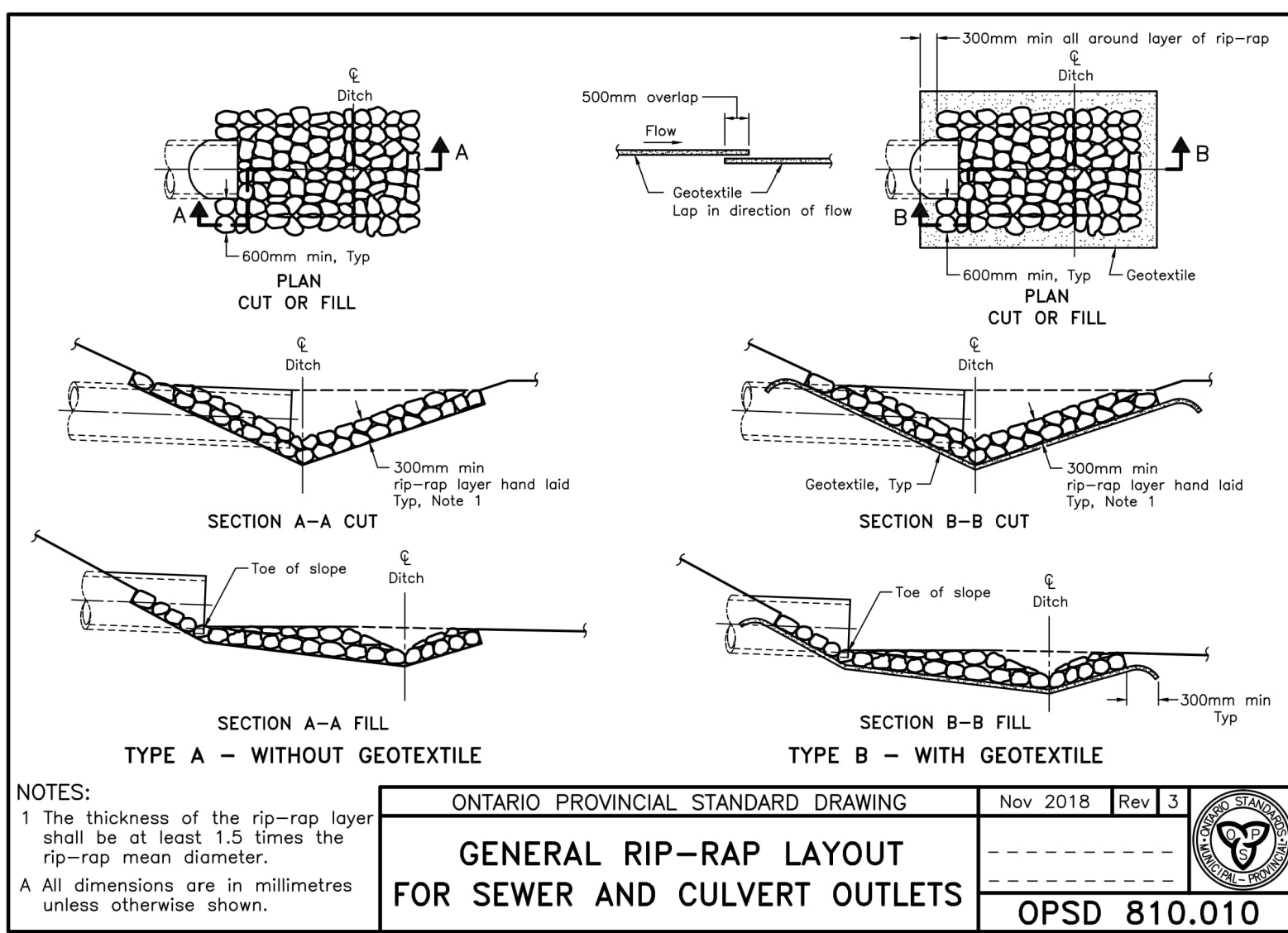
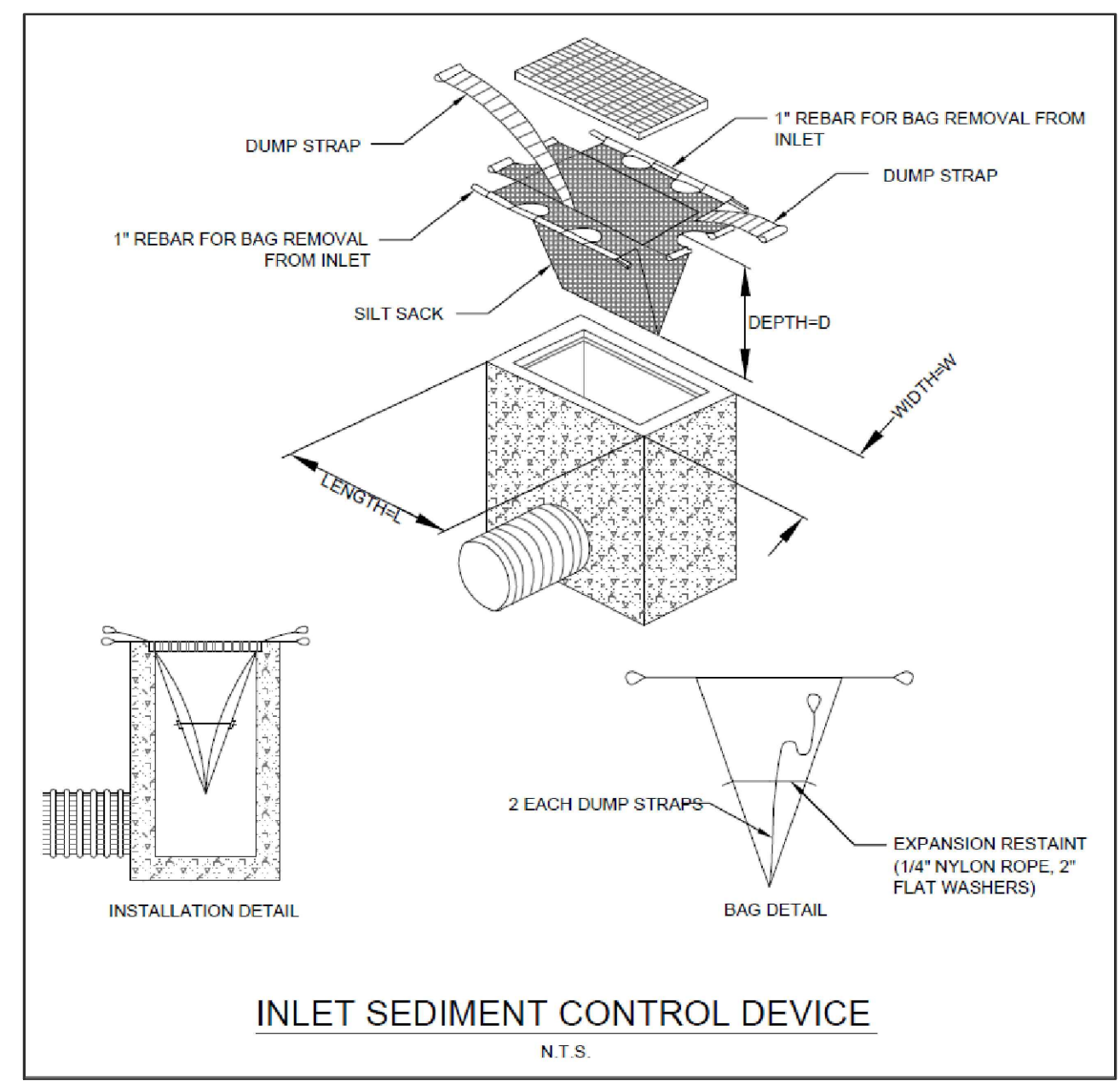

McINTOSH PERRY
115 Walgreen Road, RR3, Carp, ON K0A 1L0
Tel: 613-836-2184 Fax: 613-836-3742
www.mcintoshperry.com

Stamp:

Client:
JIM BELL ARCHITECTURE DESIGN INC.
26 BERT G ARGUE DRIVE
STITTSVILLE, ON K2S 1X9

Project:
PHASE 1 - Office Building
1037 CARP ROAD, OTTAWA, ON

Drawing Title:
DETAIL SHEET

| | | | |
|--------------|--------|-----------------|------------|
| Scale: | N.T.S. | Project Number: | CP-19-0125 |
| Drawn By: | FV | Checked By: | R.D.F. |
| Designed By: | B.G.S. | Drawing Number: | C100 |

FILENAME: U:\Ottawa\019\Project - 2004\03\2010\01\01\CP19-0125\01\01\01\CP19-0125_Presentation.dwg
LAST SAVED: Tuesday, March 26, 2024 12:54:44 PM
LAST PLOTTED: Tuesday, March 26, 2024 12:54:44 PM