

**GENERAL NOTES**

1. THE ORIGINAL TOPOGRAPHY, GROUND ELEVATION AND SURVEY DATA SHOWN ARE SUPPLIED FOR INFORMATION PURPOSES ONLY, AND IMPLY NO GUARANTEE OF ACCURACY. IT SHALL BE THE RESPONSIBILITY OF THE CONTRACTOR TO VERIFY ALL INFORMATION SHOWN.
2. THIS PLAN IS NOT A CADASTRAL SURVEY SHOWING LEGAL PROPERTY BOUNDARIES AND EASEMENTS. THE PROPERTY BOUNDARIES SHOWN HEREON HAVE BEEN DERIVED INFORMATION SUPPLIED BY (OR SHOWN ON) ANNIS, O'SULLIVAN, VOLLEBECK LTD. SURVEY PLAN #20095-19, DATED MARCH 9, 2020 AND CANNOT BE RELIED UPON TO BE ACCURATE OR COMPLETE. THE PRECISE LOCATION OF THE CURRENT PROPERTY BOUNDARIES AND EASEMENTS CAN ONLY BE DETERMINED BY AN UP-TO-DATE LAND TITLES SEARCH AND A SUBSEQUENT CADASTRAL SURVEY PERFORMED AND CERTIFIED BY AN ONTARIO LAND SURVEYOR.
3. THE CONTRACTOR IS TO OBTAIN AND PAY FOR ALL NECESSARY PERMITS AND APPROVALS FROM THE CITY BEFORE COMMENCING CONSTRUCTION.
4. THE CONTRACTOR IS RESPONSIBLE FOR ALL LAIOUT.
5. THE CONTRACTOR IS TO DETERMINE THE EXACT LOCATION, SIZE, MATERIAL AND ELEVATION OF ALL EXISTING UTILITIES PRIOR TO COMMENCING CONSTRUCTION. PROTECT AND ASSUME ALL RESPONSIBILITY FOR EXISTING UTILITIES WHETHER OR NOT SHOWN ON THESE DRAWINGS. IF THERE IS ANY DISCREPANCY THE CONTRACTOR IS TO NOTIFY THE ENGINEER PROMPTLY.
6. RESTORE ALL TRENCHES AND SURFACES OF PUBLIC ROAD ALLOWANCES TO CONDITION EQUAL OR BETTER THAN ORIGINAL CONDITION AND TO THE SATISFACTION OF THE CITY AUTHORITIES.
7. EXCAVATE AND DISPOSE OF ALL EXCESS EXCAVATED MATERIAL, SUCH AS ASPHALT, CURBING AND DEBRIS, OFF SITE AS DIRECTED BY THE ENGINEER AND THE CITY.
8. TOPSOIL TO BE STRIPPED AND STOCKPILED FOR REHABILITATION. CLEAN FILL TO BE PLACED IN FILL AREAS AND COMPACTED TO 95% STANDARD PROCTOR DENSITY.
9. ALL DISTURBED AREAS TO BE RESTORED TO ORIGINAL CONDITION OR BETTER UNLESS OTHERWISE SPECIFIED.
10. THE CONTRACTOR SHALL BE RESPONSIBLE FOR ALL TRAFFIC CONTROL AND SAFETY MEASURES DURING THE CONSTRUCTION PERIOD, INCLUDING THE SUPPLY, INSTALLATION, AND REMOVAL OF ALL NECESSARY SIGNAGE, DELINEATORS, MARKERS AND BARRIERS.
11. DO NOT ALTER GRADING OF THE SITE WITHOUT PRIOR APPROVAL OF THE CITY.
12. ALL ROADWAY, PARKING LOT, AND GRADING WORKS TO BE UNDERTAKEN IN ACCORDANCE WITH CITY STANDARDS AND SPECIFICATIONS. THE CONTRACTOR IS TO PROVIDE POSITIVE DRAINAGE AWAY FROM THE BUILDING.
13. CONTACT THE CITY FOR INSPECTION OF ROUGH GRADING OF PARKING LOTS, ROADWAYS AND LANDSCAPED AREAS PRIOR TO PLACEMENT OF ASPHALT AND TOPSOIL. ALL DEFICIENCIES NOTED SHALL BE RECTIFIED TO THE CITY SATISFACTION PRIOR TO PLACEMENT OF ANY ASPHALT, TOPSOIL, SEED & MULCH AND/OR SOIL.
14. ALL DIMENSIONS AND INVERTS MUST BE VERIFIED PRIOR TO CONSTRUCTION, IF THERE IS ANY DISCREPANCY THE CONTRACTOR IS TO NOTIFY THE ENGINEER PROMPTLY.
15. ELECTRICAL, GAS, TELEPHONE AND TELEVISION SERVICE LOCATIONS ARE SUBJECT TO THE INDIVIDUAL AGENCY:
  - ELECTRICAL SERVICE - HYDRO OTTAWA,
  - GAS SERVICE - ENBRIDGE,
  - TELEPHONE SERVICE - BELL CANADA,
  - TELEVISION SERVICE - ROGERS.
17. INSTALLATION TO BE IN ACCORDANCE WITH CURRENT CODES AND STANDARDS OF APPROVAL AGENCIES HYDRO OTTAWA, BELL AND THE CITY.
18. ALL PROPOSED CURB SHALL BE CONCRETE BARRIER CURB UNLESS SPECIFIED.
19. ALL EXISTING REDUNDANT PRIVATE APPROACHES FRONTING THIS DEVELOPMENT MUST BE REMOVED TO THE SATISFACTION OF THE CITY.
20. NO EXCESS DRAINAGE, EITHER DURING OR AFTER CONSTRUCTION, IS TO BE DIRECTED TOWARDS NEIGHBORING PROPERTIES.
21. NO ALTERATION OF EXISTING GRADES AND DRAINAGE PATTERNS ON PROPERTY BOUNDARIES.

**SEWER NOTES:**

1. CONSTRUCT ALL SEWERS, CATCH BASINS, MANHOLES AND APPURTENANCES IN ACCORDANCE WITH OPSD STANDARDS AND SPECIFICATIONS, AS WELL AS CITY.
2. SEWER TRENCHING AND BEDDING SHALL CONFORM TO OPSD 802.010 AND 802.013 UNLESS NOTED OTHERWISE.
  - 2.1. BEDDING SHALL BE A MINIMUM 150mm OF GRANULAR "A", COMPACTED TO MINIMUM 95% STANDARD PROCTOR DRY DENSITY. CLEAR STONE BEDDING SHALL NOT BE PERMITTED.
  - 2.2. SUB-BEDDING, IF REQUIRED SHALL CONSIST OF 450mm OF COMPACTED GRANULAR "B" TYPE 1.
  - 2.3. BACKFILL TO AT LEAST 300mm ABOVE TOP OF PIPE WITH GRANULAR "A" OR GRANULAR "B" TYPE 1.
  - 2.4. TO MINIMIZE DIFFERENTIAL FROST HEAVING, TRENCH BACKFILL (FROM PAVEMENT SUBGRADE TO 2.0 METRES BELOW FINISHED GRADE) SHALL MATCH EXISTING SOIL CONDITIONS.
3. SANITARY SEWERS AND CONNECTIONS 150mmØ AND SMALLER TO BE PVC SDR-28.
4. SEWERS AND CONNECTIONS 200mmØ AND LARGER TO BE PVC SDR-35. BEDDING TO BE TYPE "B" EXCEPT AT RISERS, UNLESS NOTED OTHERWISE.
5. INSULATE ALL STORM AND SANITARY SEWERS/SERVICES THAT HAVE LESS THAN 2.0m OF COVER WITH THERMAL INSULATION AS PER OPSD 1109.030.
6. SEWER CONNECTIONS ARE TO BE MADE ABOVE THE SPRINGLINE OF THE SEWERMAIN AS PER CITY OF OTTAWA STANDARD DRAWING S11, S11.1 & S11.2.
7. SUPPLY AND INSTALL ALL PIPING AND APPURTENANCES AS SHOWN AND DETAILED TO WITHIN 1.0m OF BUILDING. ALL ENDS OF SERVICES TO BE PROPERLY CAPPED AND LOCATED WITH 2"x4"X8" LONG MARKER.
8. CONTRACTOR TO TELETYPE (CTV) ALL PROPOSED SEWERS ON SITE, OUTLET CONNECTION TO THE MAIN AND PIPES 150mmØ OR GREATER PRIOR TO BASE COURSE ASPHALT. UPON COMPLETION OF CONTRACT, THE CONTRACTOR IS RESPONSIBLE TO FLUSH AND CLEAN ALL SEWERS & APPURTENANCES.
9. DYE TESTING IS TO BE COMPLETED ON SANITARY SERVICE TO CONFIRM PROPER CONNECTION TO SANITARY SEWER MAIN.

**WATERMAIN NOTES**

1. CONSTRUCT ALL WATERMANS AND APPURTENANCES IN ACCORDANCE WITH OPSD STANDARDS AND SPECIFICATIONS, AS WELL AS CITY STANDARDS.
2. INDUSTRIAL/COMMERCIAL SERVICE CONNECTIONS TO BE 50mm COPPER PIPING AND SHALL CONFORM TO ASTM B88 TYPE "K" SOFT.
3. WATERMANS AND/OR WATER SERVICES ARE TO HAVE A MINIMUM COVER OF 2.4m. OTHERWISE THERMAL INSULATION IS REQUIRED AS PER CITY W22.
4. IF THE WATERMAIN MUST BE DEFLECTED TO MEET ALIGNMENT, ENSURE THAT THE AMOUNT OF DEFLECTION USED IS EQUAL TO OR LESS THAN THAT WHICH IS RECOMMENDED BY THE MANUFACTURER.
5. THERMAL INSULATION OF WATERMANS AT OPEN STRUCTURES AS PER CITY STANDARD W22 OR OPSD 1109.030.
6. VALVES TO BE OPERATED BY CITY STAFF ONLY.
7. NO CONNECTION TO EXISTING WATER NETWORK SHALL BE COMPLETED UNTIL A WATER PERMIT IS OBTAINED FROM THE CITY. CITY TO BE PRESENT FOR WATERMAIN CONNECTION, CONNECTION, EXCAVATION, BACKFILLING AND REINSTATEMENT TO BE COMPLETED BY CONTRACTOR.
8. IT WILL BE THE RESPONSIBILITY OF THE CONTRACTOR TO PERFORM ANY WATERMAIN CONNECTION(S) REQUIRED. THIS SHALL BE COMPLETED IN THE PRESENCE OF A DESIGNATED MUNICIPAL WATER OPERATOR AND THE SELECTED CONTRACTOR SHALL PROVE TO THE SATISFACTION OF THE CITY THAT THEY ARE COMMITTED TO PERFORM THE WORKS PRIOR TO INITIATING CONSTRUCTION.
9. ALL WATERMANS SHALL BE EQUIPPED WITH BUTTERFLY AND GATE VALVES AS PER OPSD 1100.011.
10. ALL FIRE HYDRANTS, VALVE AND VALVE BOX SHALL CONFORM TO OPSD 1103.020.
11. CONCRETE THRUST BLOCKS TO CONFORM TO OPSD 1103.010 AND OPSD 1103.020.
12. ALL WATERMAIN TO BE CLASS 150 DR-18 OR APPROVED EQUIVALENT.
13. ALL WATERMAIN TO BE EQUIPPED WITH TRACER WIRE.

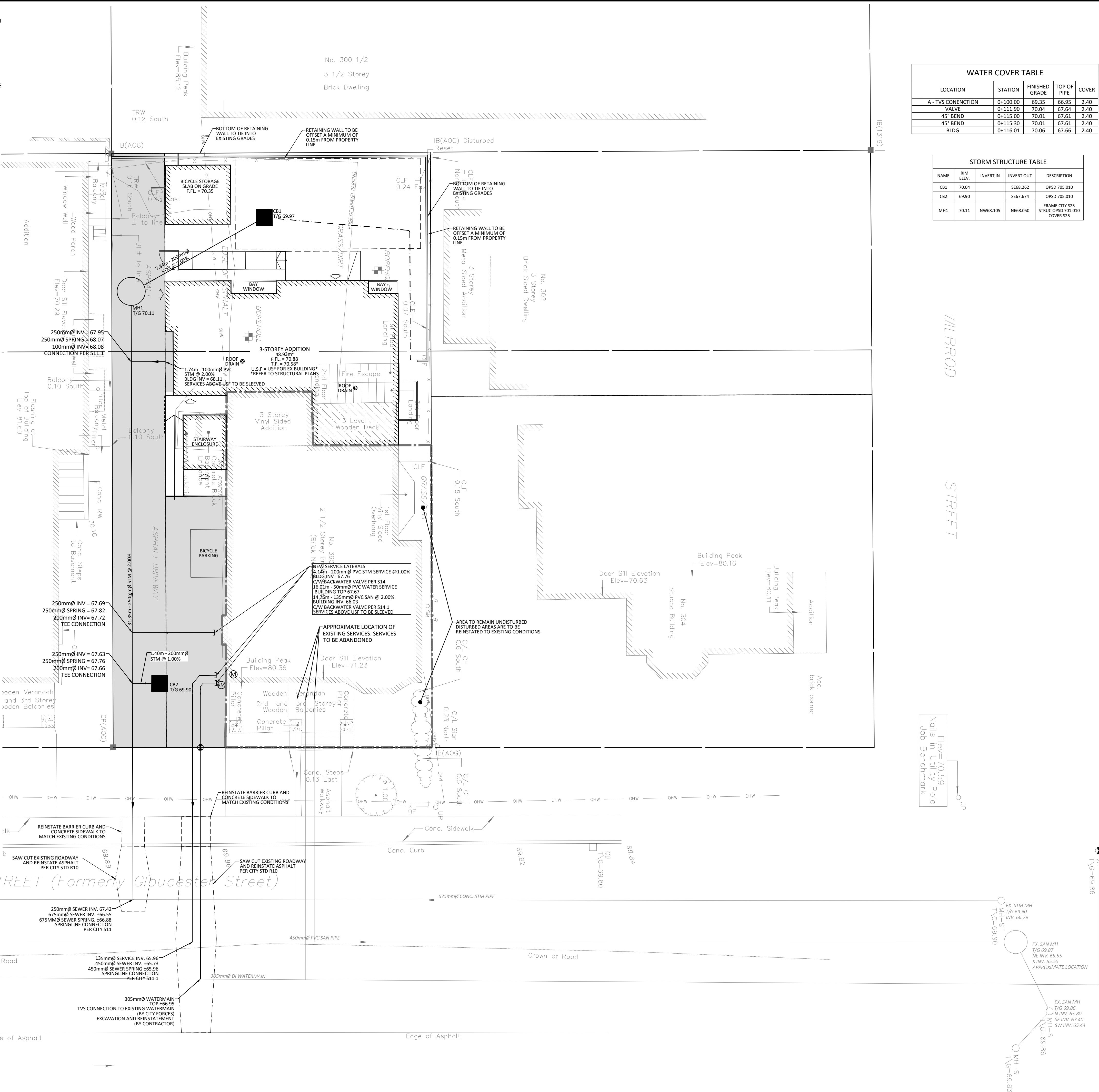

**WATER COVER TABLE**

LOCATION	STATION	FINISHED GRADE	TOP OF PIPE	COVER
A - TVS CONNECTION	0+100.00	69.35	66.95	2.40
VALVE	0+111.90	70.04	67.64	2.40
45° BEND	0+115.00	70.01	67.61	2.40
45° BEND	0+115.30	70.01	67.61	2.40
BLDG	0+116.01	70.06	67.66	2.40

**STORM STRUCTURE TABLE**

NAME	RIM ELEV.	INVERT IN	INVERT OUT	DESCRIPTION
CB1	70.04		SE68.262	OPSD 705.010
CB2	69.90		SE67.674	OPSD 705.010
MH1	70.11	NW68.105	NE68.050	FRAME CITY S23 STRUC OPSD 701.010 COVER S23

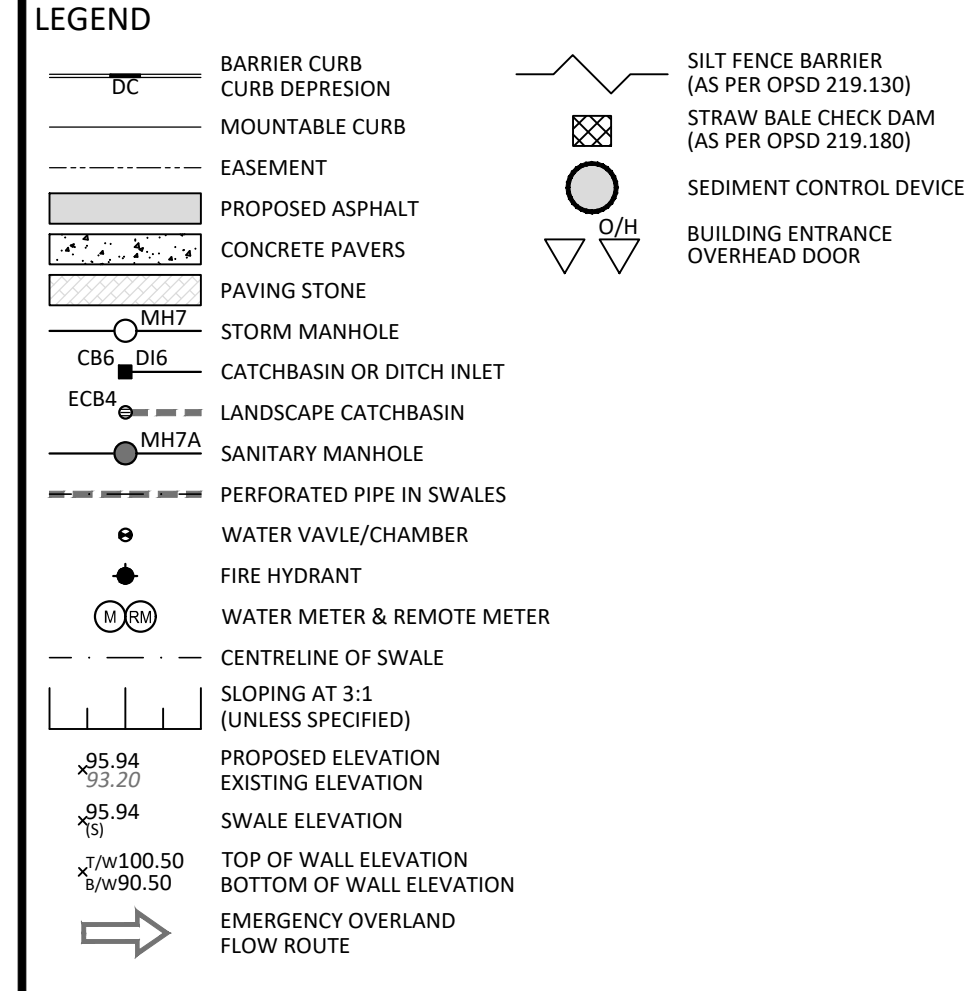
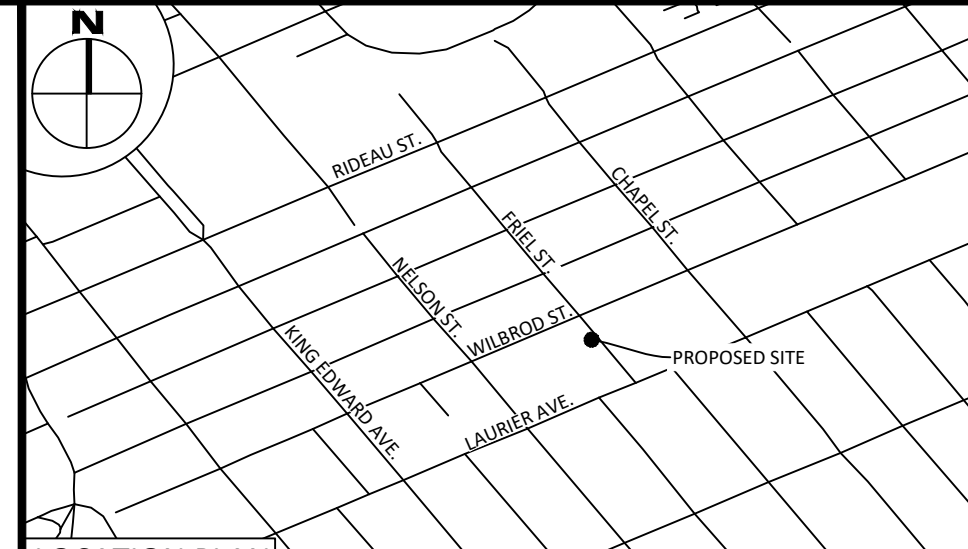

**SUBJECT TO APPROVAL**

No.	Revisions	Date
2	ISSUED FOR SITE PLAN CONTROL	APR. 28, 2022
1	ISSUED FOR SITE PLAN CONTROL	SEP. 16, 2021

Check and verify all dimensions before proceeding with the work. Do not scale drawings.

**SCALE 1:100**

0 2 4 6 8 10 Metres

**McINTOSH PERRY**  
 115 Walgreen Road, RR3, Carp, ON K0A 1L0  
 Tel: 613-836-2184 Fax: 613-836-3742  
 www.mcintoshperry.com

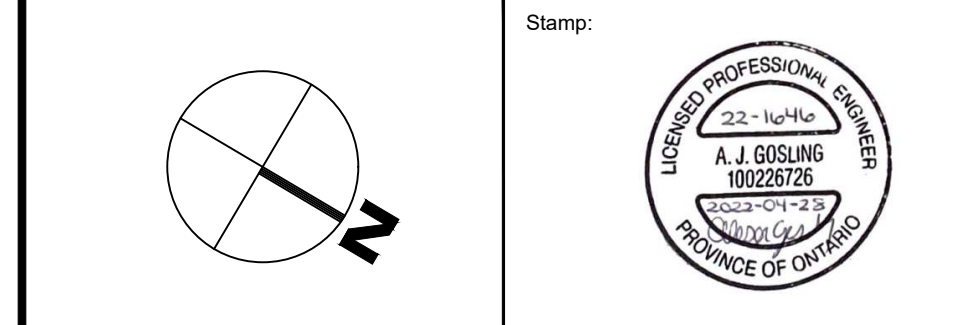

Client: **Smart Living Properties**  
 226 ARGYLE AVENUE  
 OTTAWA, ON K2P 1B9

Project: **360 FRIEL STREET**  
 OTTAWA, ON

Drawing Title: **SITE SERVICING PLAN**

Scale: 1:100 Project Number: CCO-22-1646

Drawn By: P.G.K. Drawing Number: C102

Checked By: A.J.G.

Designed By: P.G.K.

FILENAME: \\01\c:\projects\2022\1646\CCO-22-1646\_SmartLiving\_Apartment\_360 Friel Street\12 - Drawing\CCO-22-1646 - PRESENTATION.dwg  
 LAST SAVED: Thursday, April 28, 2022 10:58:22 AM  
 LAST SAVED BY: rrobins  
 LAST PLOTTED: Thursday, April 28, 2022 1:18:55 PM

D07-12-21-0166