

1 TREE CONSERVATION REPORT & LANDSCAPE PLAN- NORTH END OF SITE
SCALE: 1:100

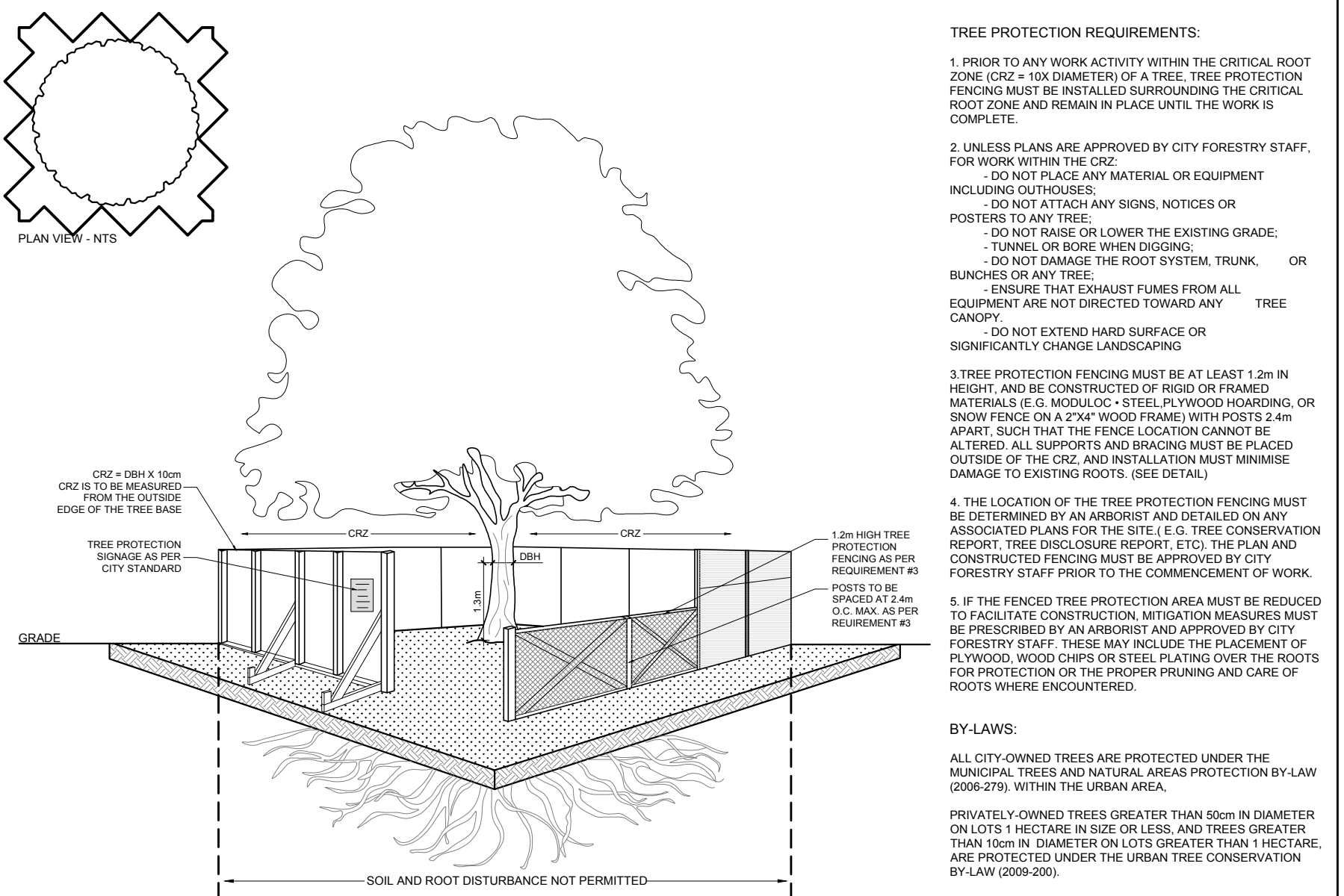

2 TREE PROTECTION FENCE
SCALE: NTS

TREE PROTECTION REQUIREMENTS:

- PRIOR TO ANY WORK ACTIVITY WITHIN THE CRITICAL ROOT ZONE (CRZ = 10x DIAMETER) OF A TREE, TREE PROTECTION FENCING MUST BE INSTALLED SURROUNDING THE CRITICAL ROOT ZONE AND REMAIN IN PLACE UNTIL THE WORK IS COMPLETE.
- UNLESS PLANS ARE APPROVED BY CITY FORESTRY STAFF, FOR WORK WITHIN THE CRZ, DO NOT PLACE ANY MATERIAL OR EQUIPMENT INCLUDING OUTHOUSES, DO NOT ATTACH ANY SIGNS, NOTICES OR POSTERS TO ANY TREE, DO NOT RAISE OR LOWER THE EXISTING GRADE, TUNNEL OR BORE WHEN DIGGING, DO NOT DAMAGE THE ROOT SYSTEM, TRUNK, BRANCHES OR ANY TREE, ENSURE THAT EXHAUST FUMES FROM ALL EQUIPMENT ARE NOT DIRECTED TOWARD ANY TREE CANOPY, DO NOT EXTEND HARD SURFACE OR SIGNIFICANTLY CHANGE LANDSCAPING
- TREE PROTECTION FENCING MUST BE AT LEAST 1.2m IN HEIGHT, AND BE CONSTRUCTED OF RIGID OR FRAMED MATERIALS (E.G. MODULOC, STEEL PLYWOOD BOARDING, OR SNOW FENCE ON A 2"x4" WOOD FRAME) WITH POSTS 2.4m APART, SUCH THAT THE FENCE LOCATION CANNOT BE ALTERED. ALL SUPPORTS AND BRACING MUST BE PLACED OUTSIDE OF THE CRZ, AND INSTALLATION MUST MINIMIZE DAMAGE TO EXISTING ROOTS. (SEE DETAIL)
- THE LOCATION OF THE TREE PROTECTION FENCING MUST BE DETERMINED BY AN ARBORIST AND DETAILED ON ANY ASSOCIATED PLANS FOR THE SITE (E.G. TREE CONSERVATION REPORT, TREE DISCUSSION REPORT, ETC). THE PLAN AND CONSTRUCTED FENCING MUST BE APPROVED BY CITY FORESTRY STAFF PRIOR TO THE COMMENCEMENT OF WORK.
- IF THE FENCED TREE PROTECTION AREA MUST BE REDUCED TO FACILITATE CONSTRUCTION, MITIGATION MEASURES MUST BE PRESCRIBED BY AN ARBORIST AND APPROVED BY CITY FORESTRY STAFF. THESE MAY INCLUDE THE PLACEMENT OF PLYWOOD, WOOD CHIPS OR STEEL PLATING OVER THE ROOTS FOR PROTECTION OR THE PROPER PRUNING AND CARE OF ROOTS WHERE ENCOUNTERED.

BY-LAWS:

ALL CITY OWNED TREES ARE PROTECTED UNDER THE MUNICIPAL TREES AND NATURAL AREAS PROTECTION BY-LAW (2005-275) WITHIN THE URBAN AREA.

PRIVATELY OWNED TREES GREATER THAN 10cm IN DIAMETER ON LOTS 1 HECTARE IN SIZE OR LESS, AND TREES GREATER THAN 10cm IN DIAMETER ON LOTS GREATER THAN 1 HECTARE, ARE PROTECTED UNDER THE URBAN TREE CONSERVATION BY-LAW (2009-200).

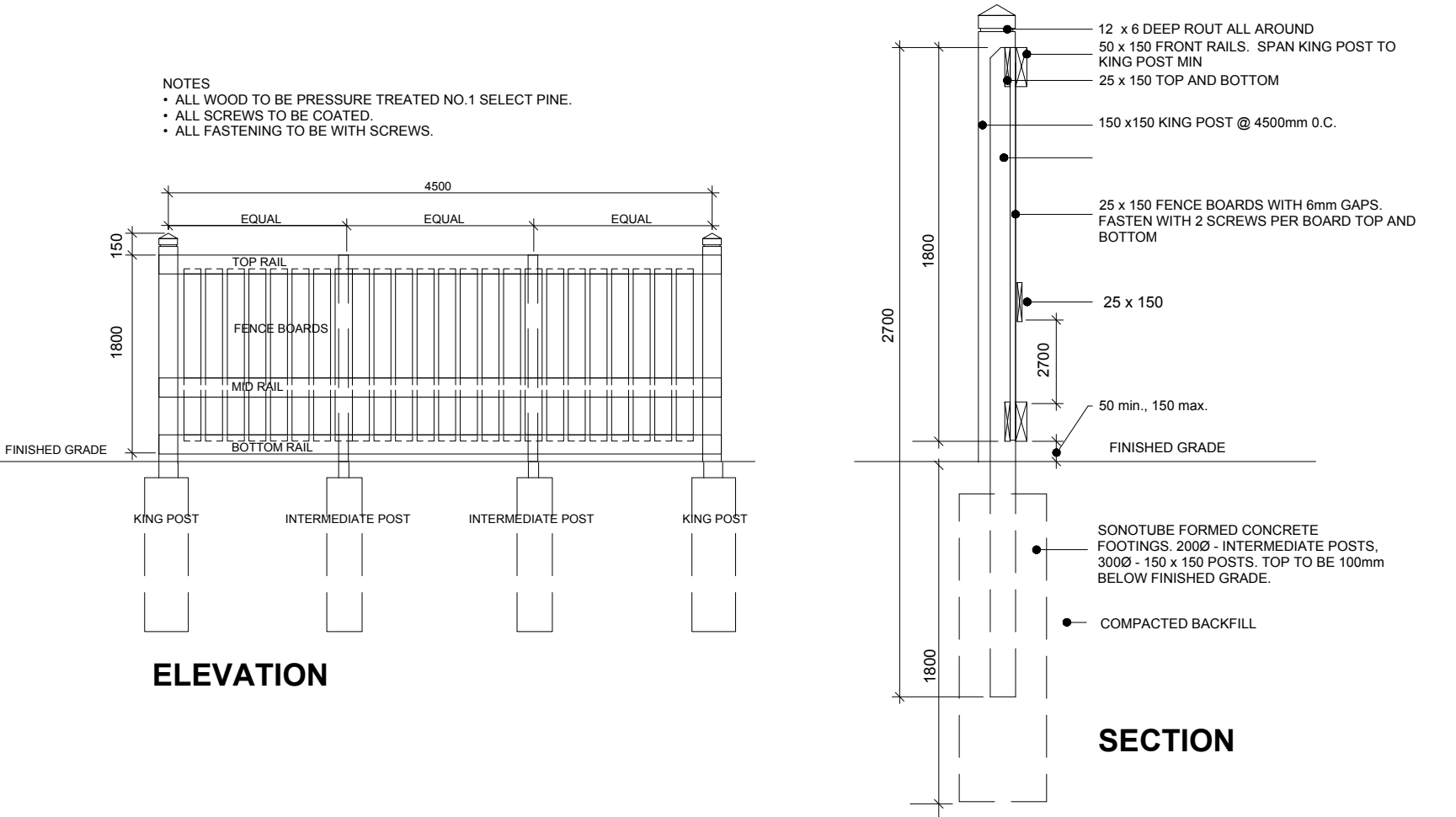

3 1.8m HT. PRIVACY SCREEN
SCALE: NTS

GENERAL NOTES:

- It is the responsibility of the appropriate contractor or official to report any errors, omissions or discrepancies on this plan with actual site conditions to the Landscape Architect before proceeding with construction.
- The contractor is to notify all utility companies and authorities prior to any excavation and ascertain locations of underground services.
- The contractor is to reinstate all areas and items damaged as a result of construction activity.
- The contractor is to comply with all pertinent codes and by-laws.
- The contractor is to maintain a positive surface run-off throughout the entire construction period.
- The Landscape Architect is not responsible for subsurface conditions.
- The contractor is to identify all existing trees to remain on site with the Landscape Architect prior to construction.
- The contractor is to stake the proposed location of all plant material in conjunction with the Landscape Architect prior to excavation.
- Minimum distances for selected deciduous trees are as follows:
 - Building Foundations 7.5m
 - Sidewalks 1.5m
 - Public Streets 2.5m
 - Underground Infrastructure 2.0m
- All trees within 1m of underground utility trenches are to be excavated by hand.
- Remove all protective wrapping from tree trunks after installation.
- Staking of trees shall only be performed if necessary.
- Ensure that mulch is pulled back a min. distance of 75mm from base of tree trunk.

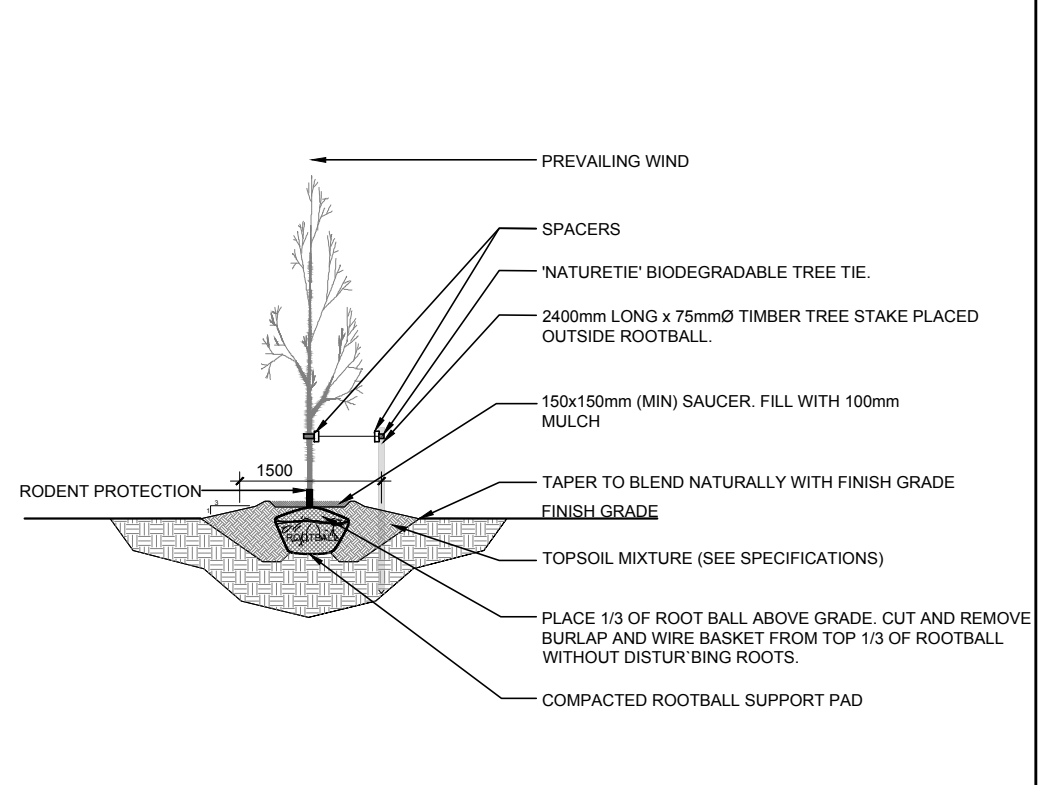

4 DECIDUOUS TREE PLANTING
SCALE: NTS

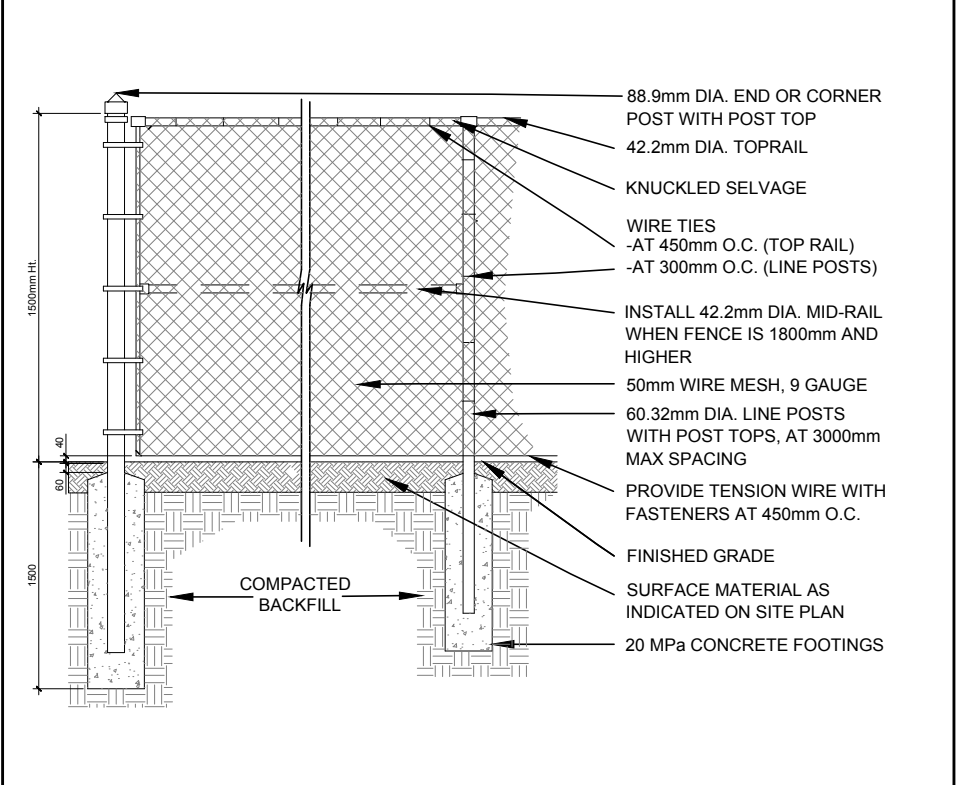

5 1.5m HT. CHAIN LINK FENCE
SCALE: NTS

EXISTING TREE LIST							
KEY	QTY	BOTANICAL NAME	COMMON NAME	SIZE	CONDITION	REMARKS	OWNERSHIP
TREES							
AN	2	<i>Acer negundo</i>	Manitoba Maple	200-500mm dbh	Fair	To be removed	330 & 340 McLeod St
AS	1	<i>Acer saccharum</i>	Sugar Maple	800mm dbh	Good	To remain	City of Ottawa
GT	1	<i>Gleditsia triacanthos</i>	Honey Locust	250mm dbh	Fair	To remain	328 McLeod Street
HL	1	<i>Gleditsia triacanthos</i>	Honey Locust	480mm dbh	Fair	To remain	City of Ottawa
MM	1	<i>Acer negundo</i>	Manitoba Maple	300mm dbh	Fair	To be removed	330 McLeod Street
PG	1	<i>Picea glauca</i>	White Spruce	250mm dbh	Good	To remain	328 McLeod Street

PROPOSED PLANT LIST						
KEY	QTY	BOTANICAL NAME	COMMON NAME	SIZE	CONDITION	Remarks
DECIDUOUS TREES						
JL	1	<i>Syringa reticulata</i>	Japanese Tree Lilac	60mm cal.	B&B	Single Leader

CLIENT

SMART LIVING PROPERTIES

226 Argyle Ave, Ottawa, ON K2P 1B9

CONSULTANTS

ARCHITECTS:

WOODMAN ARCHITECT ASSOCIATES LTD.

4 BEECHWOOD, SUITE 201, OTTAWA, ONTARIO, CANADA K1L 8L9
TEL: (613) 228-9850 • FAX: (613) 228-9888 • email: woodmanarchitect.com

CIVIL ENGINEERS:

McINTOSH PERRY

- LEGEND**
- EXISTING TREE TO REMAIN
 - EXISTING TREE TO BE REMOVED
 - PROPOSED DECIDUOUS TREE
 - PROPOSED SOD
 - PROPOSED RIVERSTONE MULCH
 - PROPOSED PRECAST CONCRETE PAVERS
 - PROPOSED TREE PROTECTION FENCE
 - PROPOSED 1.8m HT. PRIVACY SCREEN
 - PROPOSED 1.5m HT. CHAIN LINK FENCE
 - PROPERTY LINE
 - PROPOSED LANDSCAPE LIGHTING

No.	Issue	Date	By	DR	CK
6	REVISED PER NEW SITE PLAN	08/24/2023	ML	JL	
5	REVISED PER CITY COMMENTS	12/13/2022	ML	JL	
4	REVISED PER CITY COMMENTS	07/25/2022	ML	JL	
3	REVISED PER FOTENN COMMENTS	06/29/2022	WF	JL	
2	REVISED PER CITY COMMENTS	06/14/2022	ML	JL	
1	ISSUED FOR DISCUSSION & REVIEW	10/05/2021	ML	JL	

JAMES B. LENNOX & ASSOCIATES INC. LANDSCAPE ARCHITECTS

3332 CARLING AVE. OTTAWA, ONTARIO K2H 5A5
Tel. (613) 712-5168 Fax. (1866) 343-3942

PROJECT

PROPOSED FOUR STOREY ADDITION

330 McLEOD STREET, OTTAWA ON

DRAWING

TREE CONSERVATION REPORT & LANDSCAPE PLAN

SCALE

AS SHOWN

START DATE

AUGUST 2021

PROJECT NO.

21SM12109

PROJECT NORTH

DRAWING NO.

L.1

PLOT SIZE ARCH-D

D07-12-21-0172