

330 McLEOD STREET

CONTINUED ON 4/L.1 THIS SHEET

1 TREE CONSERVATION REPORT & LANDSCAPE PLAN- NORTH END OF SITE
L.1 SCALE 1:100

- GENERAL NOTES:**
- It is the responsibility of the appropriate contractor or official to report any errors, omissions or discrepancies on this plan with actual site conditions to the Landscape Architect before proceeding with construction.
 - The contractor is to notify all utility companies and authorities prior to any excavation and ascertain locations of underground services.
 - The contractor is to reinstate all areas and items damaged as a result of construction activity.
 - The contractor is to comply with all pertinent codes and by-laws.
 - The contractor is to maintain a positive surface run-off throughout the entire construction period.
 - The Landscape Architect is not responsible for subsurface conditions.
 - The contractor is to identify all existing trees to remain on site with the Landscape Architect prior to construction.
 - The contractor is to stake the proposed location of all plant material in conjunction with the Landscape Architect prior to excavation.
 - Minimum distances for selected deciduous trees are as follows:
 - Building Foundations 7.5m
 - Sidewalks 1.5m
 - Public Streets 2.5m
 - Underground Infrastructure 2.0m
 - All trees within 1m of underground utility trenches are to be excavated by hand.
 - Remove all protective wrapping from tree trunks after installation.
 - Staking of trees shall only be performed if necessary.
 - Ensure that mulch is pulled back a min. distance of 75mm from base of tree trunk.

EXISTING TREE LIST						
KEY	QTY	BOTANICAL NAME	COMMON NAME	SIZE	CONDITION	REMARKS
TREES						
AN	4	<i>Acer negundo</i>	Manitoba Maple	200-500mm dbh	Fair	See plan
AS	1	<i>Acer saccharum</i>	Sugar Maple	800mm dbh	Good	To remain
GT	2	<i>Gleditsia tricanthos</i>	Honey Locust	250-480mm dbh	Fair	To remain
PG	1	<i>Picea glauca</i>	White Spruce	250mm dbh	Good	To remain

PROPOSED PLANT LIST						
KEY	QTY	BOTANICAL NAME	COMMON NAME	SIZE	CONDITION	Remarks
DECIDUOUS TREES						
JL	1	<i>Syringa reticulata</i>	Japanese Tree Lilac	60mm cat.	B&B	Single Leader

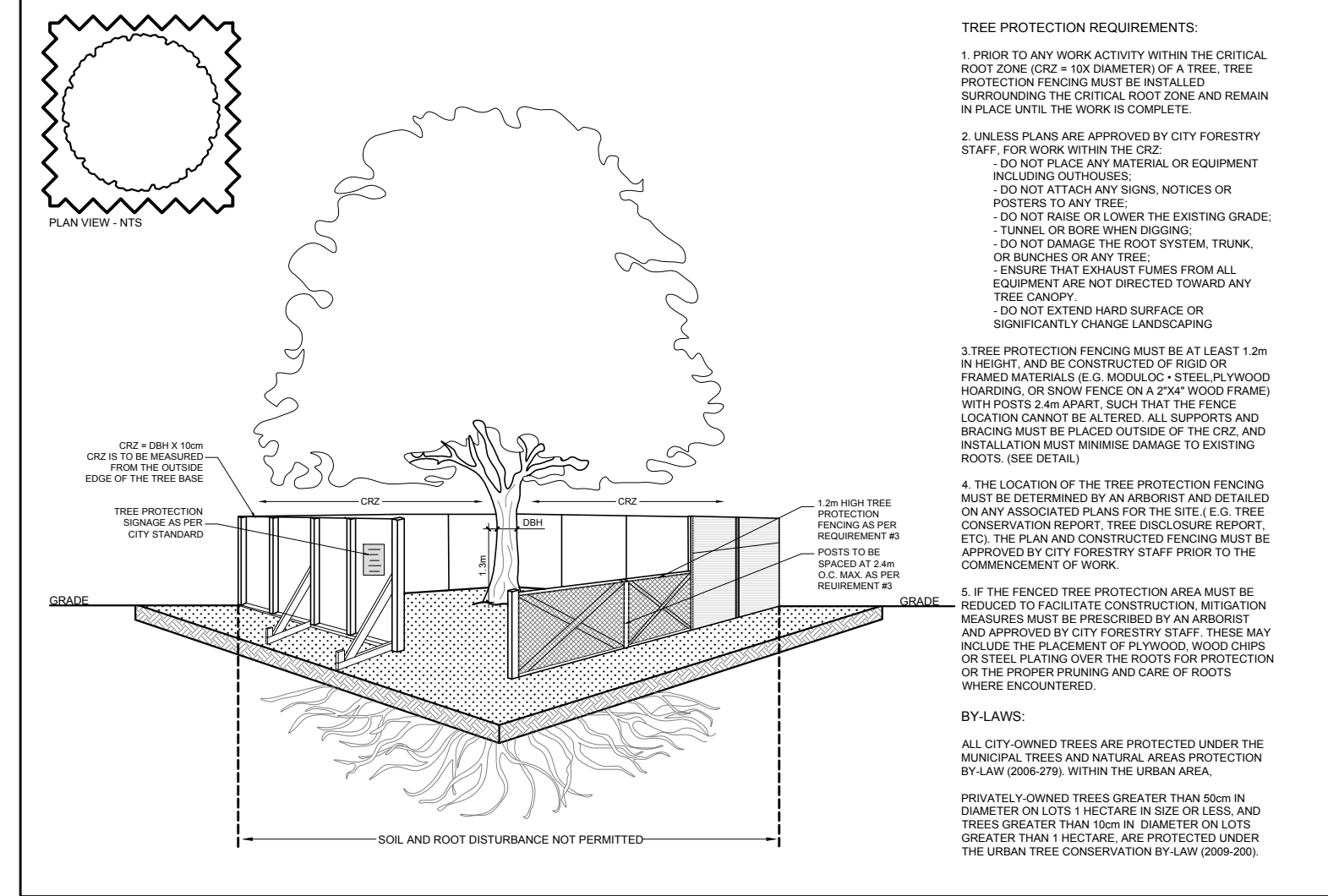

2 TREE PROTECTION FENCE
L.1 SCALE: NTS

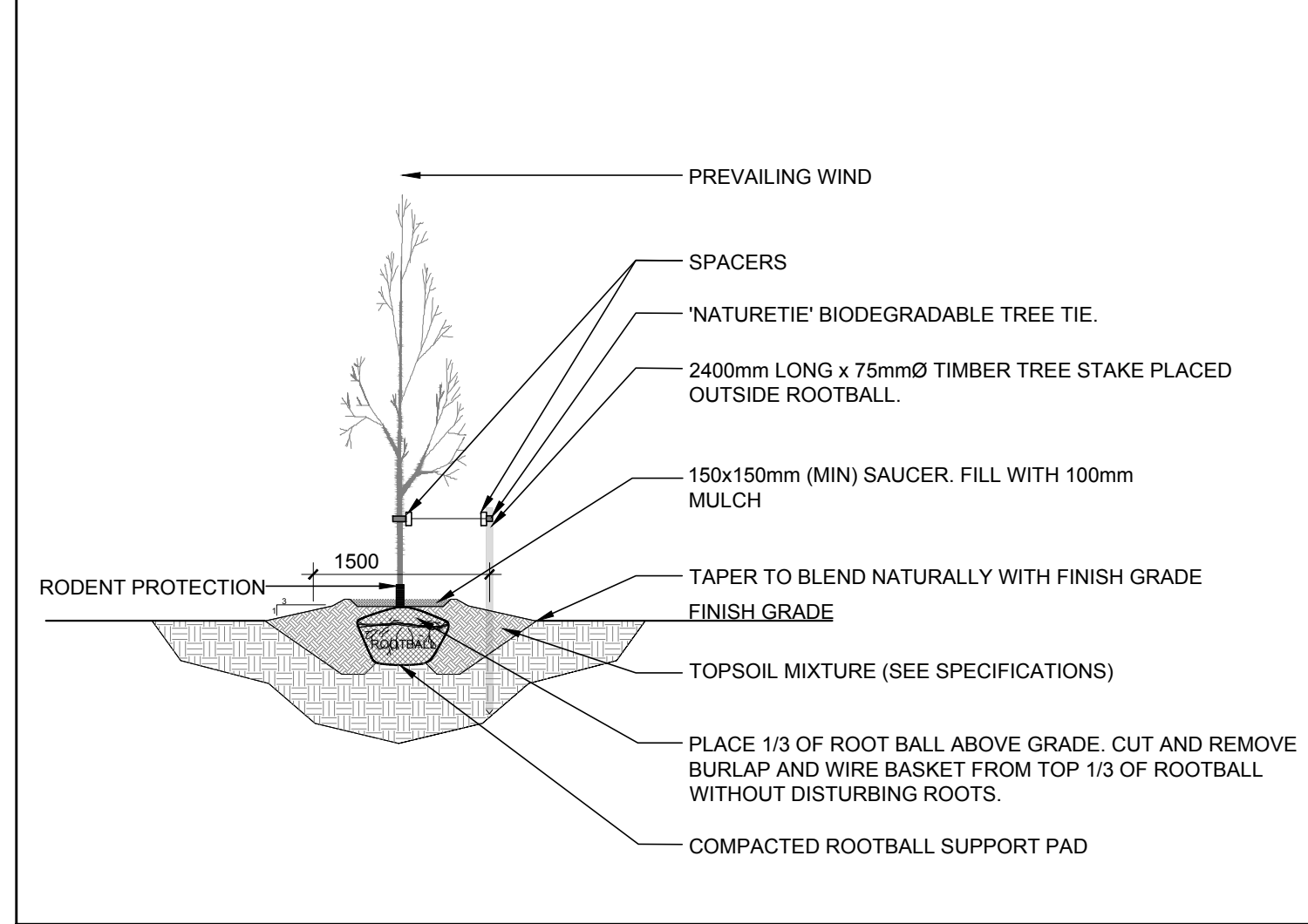

3 DECIDUOUS TREE PLANTING
L.1 SCALE: NTS

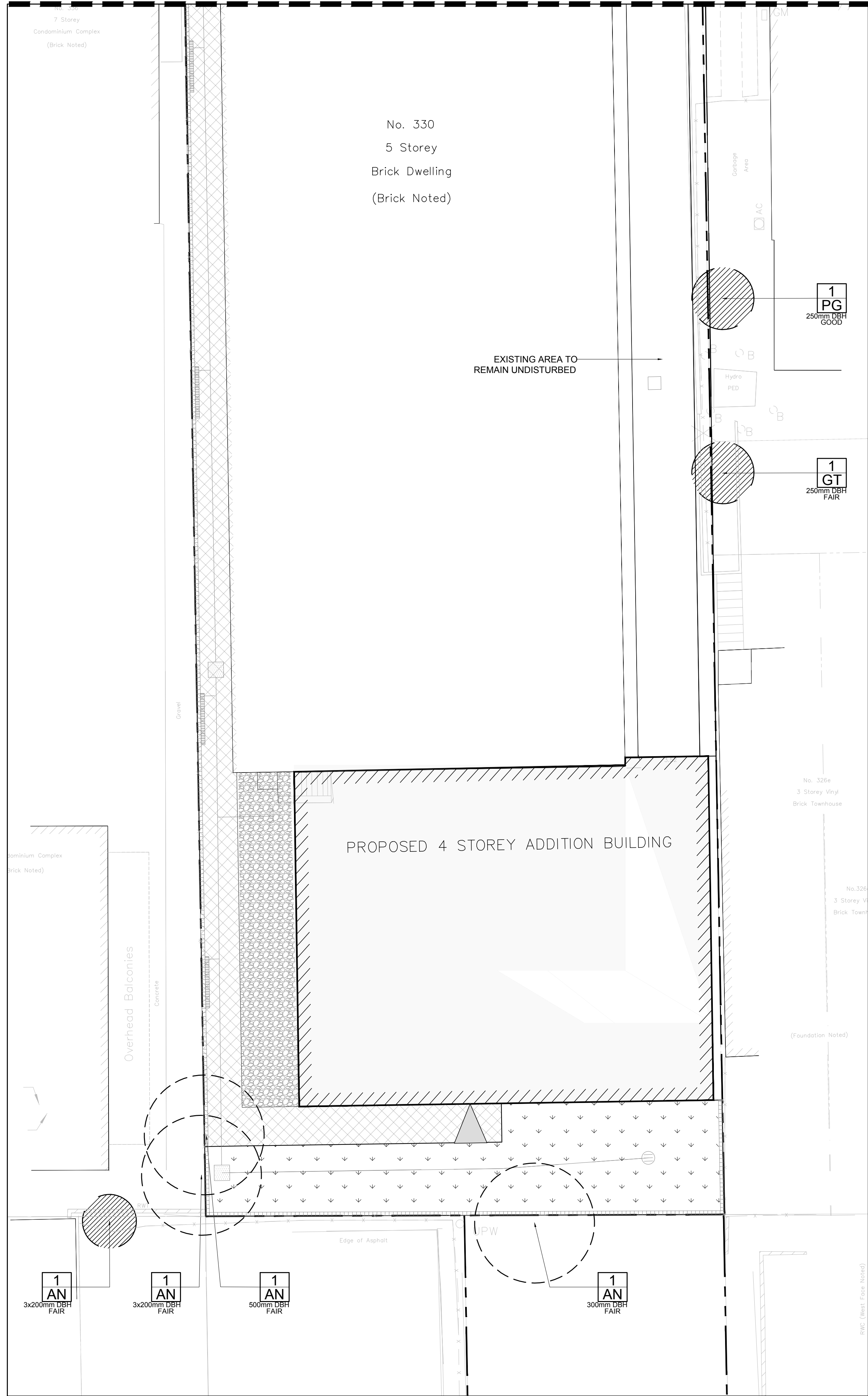

CONTINUED ON 1/L.1 THIS SHEET

No. 330
5 Storey
Brick Dwelling
(Brick Noted)

PROPOSED 4 STOREY ADDITION BUILDING

4 TREE CONSERVATION REPORT & LANDSCAPE PLAN- SOUTH END OF SITE
L.1 SCALE 1:100

CLIENT

SMART LIVING PROPERTIES

CONSULTANTS

ARCHITECTS: OPA open plan architects inc.
architecture | interiors | concepts
2305 HILLARY AVE. | OTTAWA | ON | K1H 7J2
613.883.5090 | info@openplan.ca

CIVIL ENGINEERS: McINTOSH PERRY

LEGEND

- EXISTING TREE TO REMAIN
- EXISTING TREE TO BE REMOVED
- PROPOSED DECIDUOUS TREE
- PROPOSED SOD
- PROPOSED RIVERSTONE MULCH
- PROPOSED PRECAST CONCRETE PAVERS
- PROPOSED TREE PROTECTION FENCE

No.	Issue	Date	ML	JL	DR	CK
1	ISSUED FOR DISCUSSION & REVIEW	10/05/2021				

JAMES B. LENNOX & ASSOCIATES INC.
LANDSCAPE ARCHITECTS
3332 CARLING AVE. OTTAWA, ONTARIO K2H 5A8
Tel. (613) 722-5168 Fax. (1866) 343-3942

PROJECT: PROPOSED FOUR STOREY ADDITION
330 McLEOD STREET, OTTAWA ON

DRAWING: TREE CONSERVATION REPORT & LANDSCAPE PLAN

STAMP: ASSOCIATION OF LANDSCAPE ARCHITECTS OF ONTARIO
MEMBER: JAMES B. LENNOX
SCALE: AS SHOWN
START DATE: AUGUST 2021
PROJECT NO.:
DRAWING NO.: L.1
PLOT SIZE ARCH-D