

SIZE, DEPTH AND LOCATION OF EXISTING SERVICES, UTILITIES AND STRUCTURES AS INDICATED ARE FOR GUIDANCE ONLY. ALL EXISTING SERVICES, UTILITIES AND STRUCTURES ARE NOT NECESSARILY SHOWN ON PLANS AND THOSE SHOWN ARE DERIVED FROM AVAILABLE INFORMATION AND MUST BE CONFIRMED ON SITE. UNDERGROUND LOCATES SHALL BE CONDUCTED PRIOR TO THE COMMENCEMENT OF ANY EXCAVATION. CONFIRM LOCATIONS OF BURIED SERVICES AND UTILITIES BY CAREFUL TEST EXCAVATIONS AND REPORT ANY DIFFERENCES TO THE ENGINEER.

LEGEND	
CB	CATCH-BASIN
MH	STORM MANHOLE
CB/MH	CATCH-BASIN/MANHOLE
MH	SANITARY MANHOLE
VC	VALVE CHAMBER
CS	CURB STOP & STANDPOST
VB	VALVE & VALVE BOX
FH	FIRE HYDRANT
SAN	SANITARY SEWER
ST	STORM SEWER
WS/WM	WATER SERVICE/WATERMAIN
SPL	SPRINGLINE OF PIPE
INV	INVERT OF PIPE
M	WATER METER
R	REMOTE WATER METER
FFL	FINISHED FLOOR ELEVATION
TOF	TOP OF FOUNDATION
BFL	BASEMENT FLOOR ELEVATION
USF	UNDERSIDE OF FOOTING
- - -	PROPERTY LINE
▨	ROAD CUT REINSTATEMENT

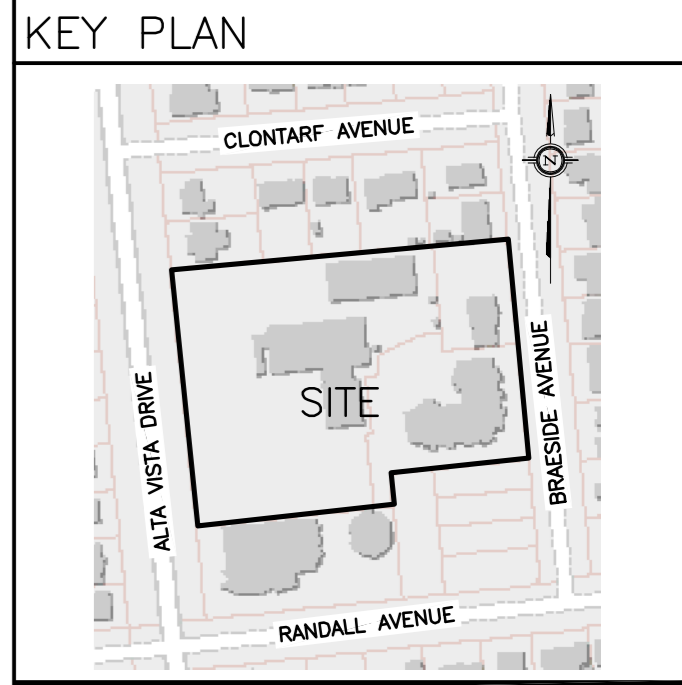

No.	DATE	REVISION
3	APR 14-22	RE-ISSUED FOR APPROVAL
2	OCT 25-21	ISSUED FOR APPROVAL
1	OCT 15-21	PRELIMINARY

**D. B. GRAY ENGINEERING INC.**  
 Stormwater Management - Grading & Drainage - Storm & Sanitary Sewers - Watermain  
 700 Long Point Circle 613-425-8044  
 Ottawa, Ontario d.gray@dbgrayengineering.com

Project  
**ELLWOOD HOUSE EXTENSION**  
 38-UNIT 3-STORY APARTMENT BUILDING  
 2262 BRAESIDE AVENUE  
 & **SITE IMPROVEMENTS**  
 2262-2270 BRAESIDE AVENUE  
 & 2345 ALTA VISTA DRIVE  
 OTTAWA, ONTARIO

**SITE SERVICING PLAN**

Drawing Title

Engineer's Seal  
  
 Drawn D.B.G.  
 H. Scale 1:250  
 V. Scale  
 Date OCT 15-21  
 Job No. 21028

Drawing No.  
**C-1**  
 of 9

REFER TO NOTES & DETAILS  
 ON DRAWINGS C-4 & C-5

#18637

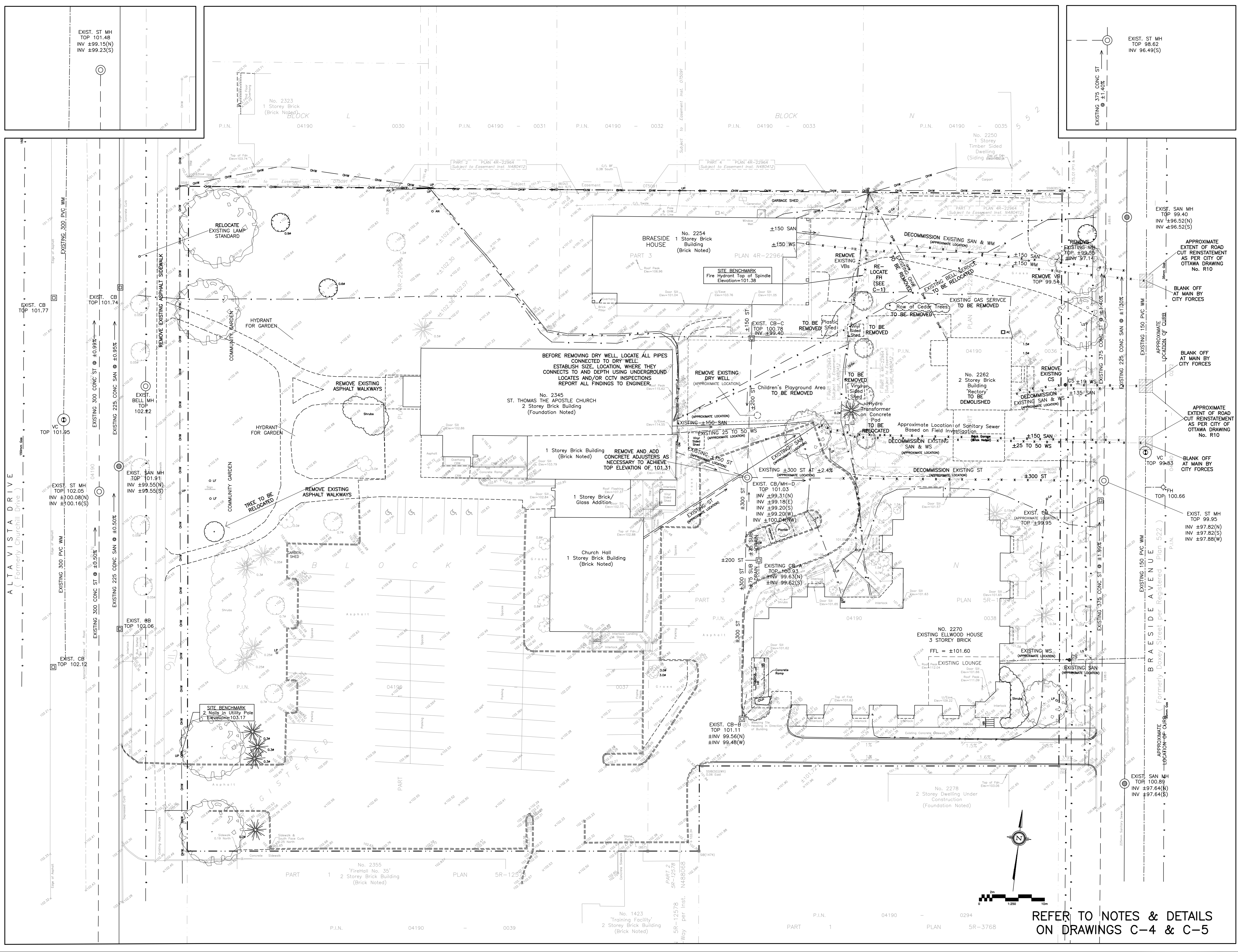

**LEGEND**

- CB CATCH-BASIN
- MH STORM MANHOLE
- CB/MH CATCH-BASIN/MANHOLE
- MH SANITARY MANHOLE
- VC VALVE CHAMBER
- CS CURB STOP & STANDPOST
- VB VALVE & VALVE BOX
- FH FIRE HYDRANT
- SAN SANITARY SEWER
- ST STORM SEWER
- WS/WM WATER SERVICE/WATERMAIN
- SPL SPRINGLINE OF PIPE
- INV INVERT OF PIPE
- M WATER METER
- R REMOTE WATER METER
- FFL FINISHED FLOOR ELEVATION
- TOF TOP OF FOUNDATION
- BFL BASEMENT FLOOR ELEVATION
- USF UNDERSIDE OF FOOTING
- - - PROPERTY LINE
- ROAD CUT REINSTATEMENT

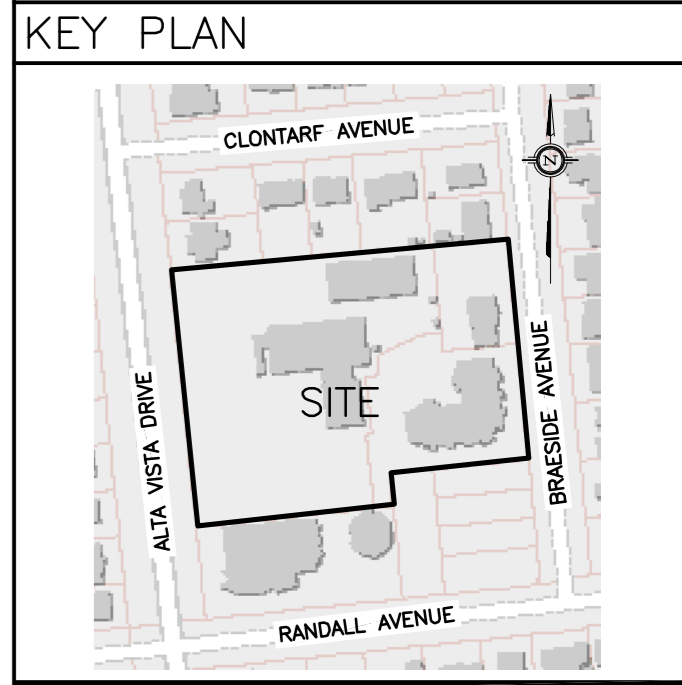

No.	DATE	REVISION
3	APR 14-22	RE-ISSUED FOR APPROVAL
2	OCT 25-21	ISSUED FOR APPROVAL
1	OCT 15-21	PRELIMINARY

**D. B. GRAY ENGINEERING INC.**  
 Stormwater Management - Grading & Drainage - Storm & Sanitary Sewers - Watermain  
 700 Long Point Circle 613-425-8044  
 Ottawa, Ontario d.gray@dgrayengineering.com

Project  
**ELLWOOD HOUSE EXTENSION**  
 38-UNIT 3-STORY APARTMENT BUILDING  
 2262 BRAESIDE AVENUE  
 & **SITE IMPROVEMENTS**  
 2262-2270 BRAESIDE AVENUE  
 & 2345 ALTA VISTA DRIVE  
 OTTAWA, ONTARIO

Drawing Title  
**EXISTING CONDITIONS,  
 REMOVALS &  
 DECOMMISSIONING**

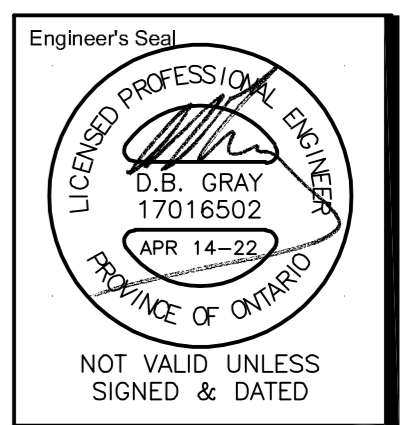

Drawn D.B.G.  
 H. Scale 1:250  
 V. Scale  
 Date OCT 15-21  
 Job No. 21028

Drawing No.  
**C-2**  
 of 9

REFER TO NOTES & DETAILS  
 ON DRAWINGS C-4 & C-5

SIZE, DEPTH AND LOCATION OF EXISTING SERVICES, UTILITIES AND STRUCTURES AS INDICATED ARE FOR GUIDANCE ONLY. ALL EXISTING SERVICES, UTILITIES AND STRUCTURES ARE NOT NECESSARILY SHOWN ON PLANS AND THOSE SHOWN ARE DERIVED FROM AVAILABLE INFORMATION AND MUST BE CONFIRMED ON SITE. UNDERGROUND LOCATES SHALL BE CONDUCTED PRIOR TO THE COMMENCEMENT OF ANY EXCAVATION. CONFIRM LOCATIONS OF BURIED SERVICES AND UTILITIES BY CAREFUL TEST EXCAVATIONS AND REPORT ANY DIFFERENCES TO THE ENGINEER.

LEGEND	
CB	CATCH-BASIN
MH	STORM MANHOLE
CB/MH	CATCH-BASIN/MANHOLE
MH	SANITARY MANHOLE
F.F.L.	FINISHED FLOOR ELEVATION
T.O.F.	TOP OF FOUNDATION
B.F.L.	BASEMENT FLOOR ELEVATION
U.S.F.	UNDERSIDE OF FOOTING
---	PROPERTY LINE
+99.99	EXISTING GRADE ELEVATION
+99.99	PROPOSED GRADE ELEVATION
2%	EXISTING SLOPE OF GRADE
2%	PROPOSED SLOPE OF GRADE
→	OVERLAND FLOW
T.O.S.	TOP OF SLOPE
B.O.S.	BOTTOM OF SLOPE
---	CENTRELINE OF SWALE
D.C.	DEPRESSED CURB
C.R.Z.	CRITICAL ROOT ZONE
---	SILT FENCE BARRIER
---	LIGHT-DUTY PAVEMENT
---	HEAVY-DUTY PAVEMENT
---	CONCRETE WALKWAY/SIDEWALK
---	LANDSCAPE
---	INTERLOCK
---	ASPHALT WALKWAY/SIDEWALK

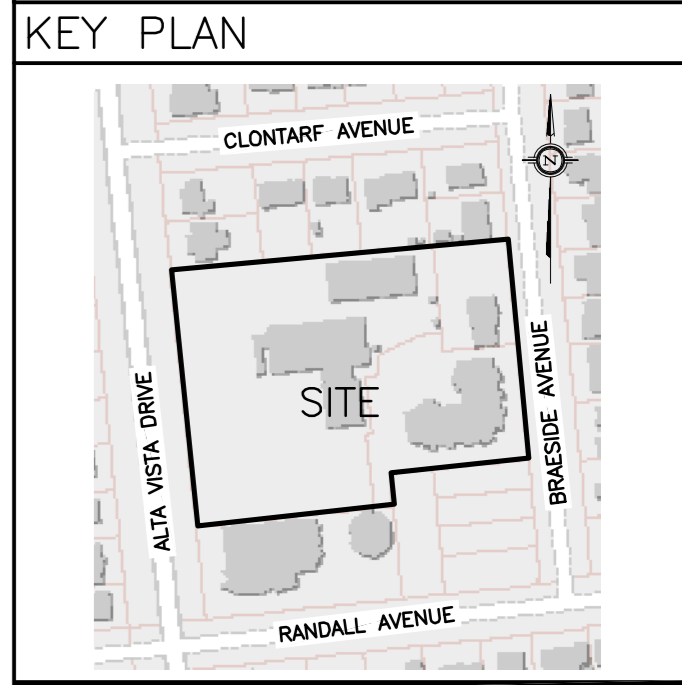

No.	DATE	REVISION
3	APR 14-22	RE-ISSUED FOR APPROVAL
2	OCT 25-21	ISSUED FOR APPROVAL
1	OCT 15-21	PRELIMINARY

**D. B. GRAY ENGINEERING INC.**  
 Stormwater Management Grading & Drainage Stone & Sanitary Sewers Watermain  
 700 Long Point Circle 613-425-8044  
 Ottawa, Ontario d.gray@dbgrayengineering.com

Project  
**ELLWOOD HOUSE EXTENSION**  
 38-UNIT 3-STORY APARTMENT BUILDING  
 2262 BRAESIDE AVENUE  
**& SITE IMPROVEMENTS**  
 2262-2270 BRAESIDE AVENUE  
 & 2345 ALTA VISTA DRIVE  
 OTTAWA, ONTARIO

Drawing Title  
**GRADING PLAN AND EROSION & SEDIMENT CONTROL PLAN**

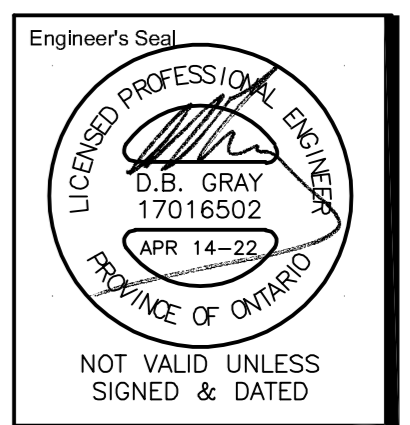

Drawn D.B.G.  
 H. Scale 1:250  
 V. Scale  
 Date OCT 15-21  
 Job No. 21028  
 Drawing No.  
**C-3**  
 of 9

NOT VALID UNLESS SIGNED & DATED  
 #18637

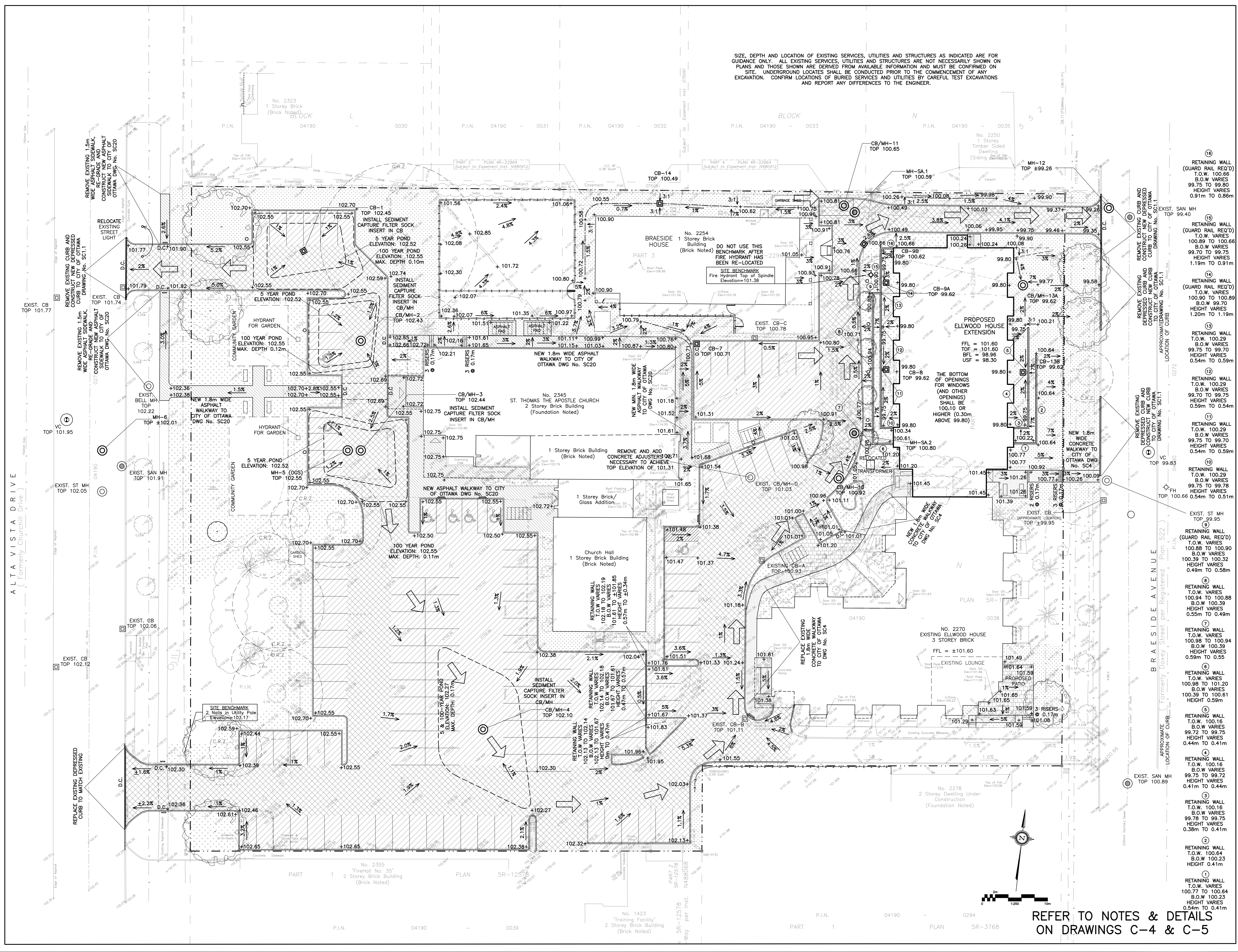

REFER TO NOTES & DETAILS ON DRAWINGS C-4 & C-5

D07-12-21-0174



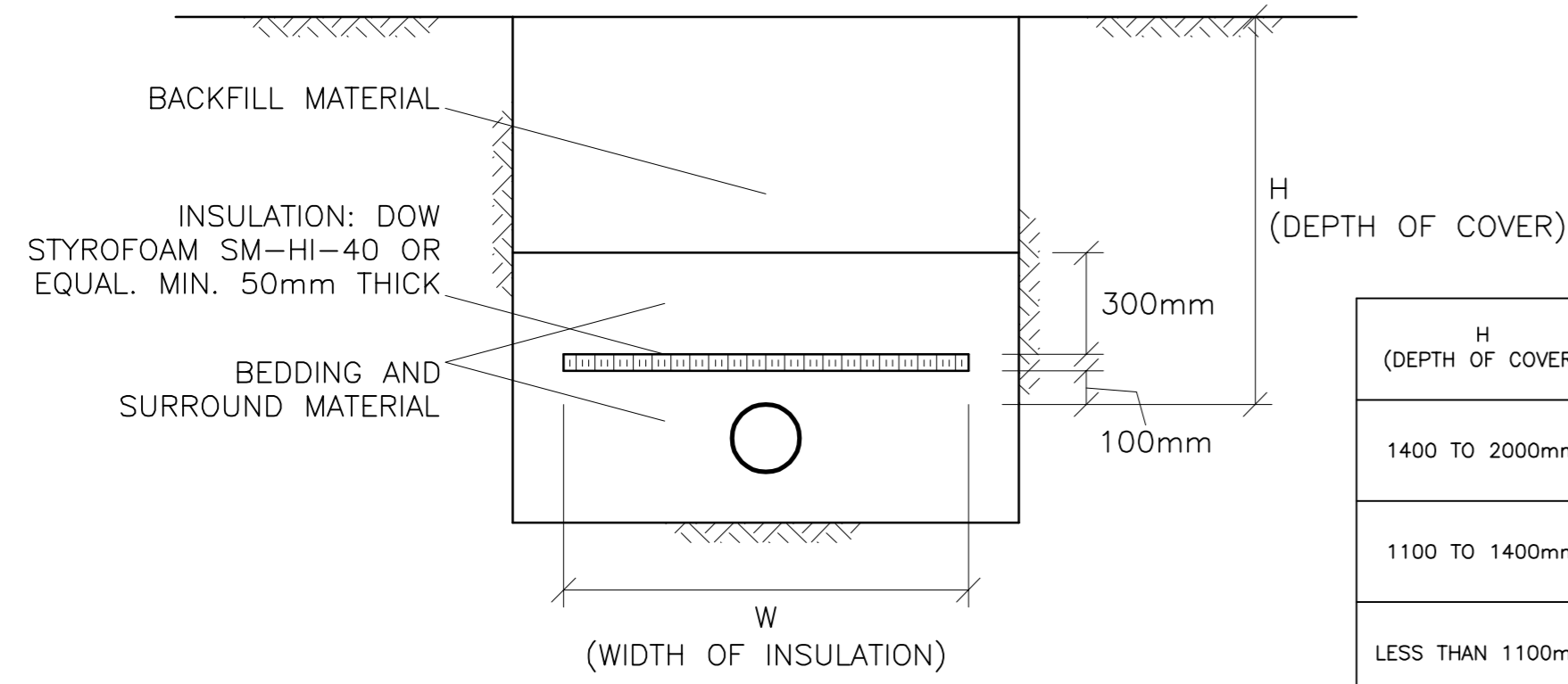

H (DEPTH OF COVER)	INSULATION THICKNESS	W (WIDTH OF INSULATION)
1400 TO 2000mm	50mm	1200mm + DIAMETER OF PIPE
1100 TO 1400mm	75mm	1800mm + DIAMETER OF PIPE
LESS THAN 1100mm	100mm	2400mm + DIAMETER OF PIPE

INSULATE SEWER AS INDICATED AND WHERE DEPTH OF COVER IS LESS THAN 2000mm. CENTER INSULATION OVER PIPE. JOINTS BETWEEN SHEETS OF INSULATION SHALL BE STAGGERED.

### INSULATION OF SEWERS IN SHALLOW TRENCHES N.T.S

### WATER SERVICE PROFILE TABLE

MATERIAL:  
150mm-200mm PVC PRESSURE CLASS 150 DR18

STATION	DESCRIPTION	GRADE ELEVATION	TOP OF PIPE	DEPTH OF COVER	NOTES
A+00.0	150mm x 150mm TEE CONNECTION IN 150mm MUNICIPAL WATERMAIN TO CITY OF OTTAWA STANDARDS	±99.35	±97.55	±1.80	--
A+00.5	150mm 45° VERTICAL BEND DOWN TO CITY OF OTTAWA STANDARDS	±99.38	97.55	±1.83	--
A+02.0	150mm 45° VERTICAL BEND UP TO CITY OF OTTAWA STANDARDS	±99.42	96.05	±3.37	--
A+03.0	-	±99.45	96.05	±3.40	CROSSING 225 SAN INV ±96.55 ±500mm CLEARANCE (MIN. 500mm REQUIRED)
A+06.2	-	±99.34	96.05	±3.04	CROSSING 375 ST INV ±97.29 ±240mm CLEARANCE (MIN. 500mm REQUIRED)
A+07.2	150mm 45° VERTICAL BEND UP TO CITY OF OTTAWA STANDARDS	±99.35	96.05	±3.30	BOTTOM OF CURB
A+08.1	150mm 45° VERTICAL BEND DOWN TO CITY OF OTTAWA STANDARDS	99.36	96.96	2.40	--
A+09.0	200mm TO 150mm REDUCER TO CITY OF OTTAWA STANDARDS	99.39	96.96	2.43	--
A+12.9	200mm VALVE & VALVE BOX TO CITY OF OTTAWA STANDARDS	99.46	96.96	2.50	ON PROPERTY LINE
A+19.3	-	99.72	96.96	2.76	CROSSING 250 ST INV 97.48 520mm CLEARANCE (MIN. 500mm REQUIRED)
A+27.7	-	100.06	97.39	2.67	--
A+35.9	-	100.28	97.81	2.47	50mm INSULATION AS PER CITY OF OTTAWA DWG W22 50 FROM A+39.2 TO A+49.5
A+42.5 (B+00.0)	200mm x 150mm TEE (TO FIRE HYDRANT) TO CITY OF OTTAWA STANDARDS	100.48	98.15	2.33	--
A+45.0	-	100.60	98.28	2.32	CROSSING 200 SAN TOP 97.13 WM U/S 98.17 1040mm CLEARANCE
A+46.7	-	100.66	98.37	2.29	CROSSING 300 ST TOP 97.91 WM U/S 98.17 - 260mm CLEARANCE (MIN. 250mm REQUIRED)
A+47.8	200mm 45° HORIZONTAL BEND TO CITY OF OTTAWA STANDARDS	100.78	98.38	2.40	--
A+48.8	200mm TO 150mm REDUCER TO CITY OF OTTAWA STANDARDS	100.78	98.42	2.36	--
A+49.5	-	100.93	98.44	2.49	CROSSING 150 SAN INV ±98.70 ±380mm CLEARANCE 50mm INSULATION AS PER CITY OF OTTAWA DWG W22 50 FROM A+8.1 TO A+49.5
A+50.5 (C+00.0)	TVS CONNECTION TO 150mm WATERMAIN TO CITY OF OTTAWA STANDARDS	-	-	-	--
A+51.5	150mm 45° HORIZONTAL BEND TO CITY OF OTTAWA STANDARDS	100.95	±98.49	±2.46	CONNECT TO EXISTING 150mm WS

### WATER SERVICE PROFILE TABLE

MATERIAL:  
150mm PVC PRESSURE CLASS 150 DR18

STATION	DESCRIPTION	GRADE ELEVATION	TOP OF PIPE	DEPTH OF COVER	NOTES
B+00.0 (A+42.5)	200mm x 150mm TEE TO CITY OF OTTAWA STANDARDS	100.48	98.15	2.33	50mm INSULATION AS PER CITY OF OTTAWA DWG W22 50 FROM B+00.0 TO B+03.7
B+01.0	150mm VALVE & VALVE BOX TO CITY OF OTTAWA STANDARDS	100.48	98.15	2.33	
B+03.7	-	100.51	98.15	2.36	
B+07.0	FIRE HYDRANT TO CITY OF OTTAWA STANDARDS	100.81	98.15	2.63	--

MATERIAL:  
50mm PEX TUBING TO AWWA C-904 SDR 9 (CTS)

STATION	DESCRIPTION	GRADE ELEVATION	TOP OF PIPE	DEPTH OF COVER	NOTES
C+00.0 (A+50.5)	TVS CONNECTION TO 150mm MUNICIPAL WATERMAIN AS PER CITY OF OTTAWA STANDARDS	100.94	98.47	2.47	--
C+05.6	50mm CURB STOP TO CITY OF OTTAWA STANDARDS	100.75	98.35	2.40	--
C+16.0	-	100.78	98.38	2.40	CROSSING 250 ST TOP 97.98 WM U/S 98.33 - 350mm CLEARANCE (MIN. 250mm REQUIRED)
C+24.5	-	100.88	98.48	2.40	--
C+30.5	50mm x 25mm REDUCER TO CITY OF OTTAWA STANDARDS (IF REQUIRED)	±101.27	98.87	2.40	CONNECT TO EXISTING WS (SIZE UNKNOWN - 25mm TO 50mm)

MATERIAL:  
50mm COPPER ASTM B88 TYPE "K" SOFT

STATION	DESCRIPTION	GRADE ELEVATION	TOP OF PIPE	DEPTH OF COVER	NOTES
E+00.0	TVS CONNECTION TO 150mm MUNICIPAL WATERMAIN AS PER CITY OF OTTAWA DRAWING No. W33	±99.78	±97.98	±1.80	--
E+03.0	-	±99.88	97.41	2.47	CROSSING 225 SAN TOP ±97.16 WM U/S 97.36 - 250mm CLEARANCE
E+06.3	-	±99.77	97.21	2.56	CROSSING 375 ST INV ±97.71 500mm CLEARANCE
E+07.3	-	±99.74	97.34	2.40	BOTTOM OF CURB
E+13.0	50mm CURB STOP TO CITY OF OTTAWA STANDARDS	100.13	97.68	2.45	ON PROPERTY LINE
E+20.6	-	100.69	98.29	2.40	ENTRY INTO BUILDING

### CATCH-BASIN & MANHOLE SCHEDULE

REF	TOP	SIZE	TYPE	INVERT AT INLET	INVERT AT OUTLET	NOTES
STORM SEWER						
CB-1	102.45	600mm x 600mm	PRE-CAST CONCRETE CATCH-BASIN	-	100.36	TO OPSD 705.010 & CITY OF OTTAWA STANDARDS - FRAME & COVER TO CITY OF OTTAWA DRAWING No. S19
CB/MH-2	102.43	1200mm	PRE-CAST CONCRETE CATCH-BASIN/MANHOLE	100.29(NW)	100.29(S)	TO OPSD 701.010 & CITY OF OTTAWA STANDARDS - FRAME & COVER TO CITY OF OTTAWA DRAWING No. S25 & S28.1 OR OPSD 401.010
CB/MH-3	102.44	1200mm	PRE-CAST CONCRETE CATCH-BASIN/MANHOLE	100.22(N)	100.22(W)	TO OPSD 701.010 & CITY OF OTTAWA STANDARDS - FRAME & COVER TO CITY OF OTTAWA DRAWING No. S25 & S28.1 OR OPSD 401.010 INSTALL ICID IN OUTLET PIPE
CB/MH-4	102.10	1200mm	PRE-CAST CONCRETE CATCH-BASIN/MANHOLE	-	100.39	TO OPSD 701.010 & CITY OF OTTAWA STANDARDS - FRAME & COVER TO CITY OF OTTAWA DRAWING No. S25 & S28.1 OR OPSD 401.010 INSTALL ICID IN OUTLET PIPE
MH-5	102.55	CDS PMSU2015-4	PRE-CAST CONCRETE MANHOLE	100.21(E) 100.23(SE)	100.20(W)	TO OPSD 701.010 & CITY OF OTTAWA STANDARDS EXCEPT WITH A DEEP SLUMP AS REQUIRED BY CDS INSTALLED WITH A WATERTIGHT COVER
MH-6	102.01	1200mm	PRE-CAST CONCRETE MANHOLE	100.07(E) ±100.03(S)	100.01(N)	TO OPSD 701.010 & CITY OF OTTAWA STANDARDS - FRAME & COVER TO CITY OF OTTAWA DRAWING No. S25 & S24.1 OR OPSD 401.010
CB-7	100.71	600mm x 600mm	PRE-CAST CONCRETE CATCH-BASIN	-	97.74	TO OPSD 705.010 & CITY OF OTTAWA STANDARDS - FRAME & COVER TO CITY OF OTTAWA DRAWING No. S19
CB-8	99.62	600mm x 600mm	PRE-CAST CONCRETE CATCH-BASIN	-	97.68	TO OPSD 705.010 & CITY OF OTTAWA STANDARDS - FRAME & COVER TO CITY OF OTTAWA DRAWING No. S19
CB-9A	99.62	600mm x 600mm	PRE-CAST CONCRETE CATCH-BASIN	-	97.65	TO OPSD 705.010 & CITY OF OTTAWA STANDARDS - FRAME & COVER TO CITY OF OTTAWA DRAWING No. S19
CB-9B	100.62	600mm x 600mm	PRE-CAST CONCRETE CATCH-BASIN	-	97.62	TO OPSD 705.010 & CITY OF OTTAWA STANDARDS - FRAME & COVER TO CITY OF OTTAWA DRAWING No. S19
CB/MH-10	100.92	1200mm	PRE-CAST CONCRETE CATCH-BASIN/MANHOLE	±98.84(W)	97.73(N)	TO OPSD 701.010 & CITY OF OTTAWA STANDARDS - FRAME & COVER TO CITY OF OTTAWA DRAWING No. S25 & S28.1 OR OPSD 401.010 INSTALL ICID IN OUTLET PIPE
CB/MH-11	100.65	1200mm	PRE-CAST CONCRETE CATCH-BASIN/MANHOLE	97.53(S) 98.12(W)	97.47(E)	TO OPSD 701.010 & CITY OF OTTAWA STANDARDS - FRAME & COVER TO CITY OF OTTAWA DRAWING No. S25 & S28.1 OR OPSD 401.010 INSTALL ICID IN OUTLET PIPE
MH-12	99.26	1200mm	PRE-CAST CONCRETE MANHOLE	97.37(W) ±97.24(S)	±97.24(N)	TO OPSD 701.010 & CITY OF OTTAWA STANDARDS - FRAME & COVER TO CITY OF OTTAWA DRAWING No. S25 & S24.1 OR OPSD 401.010
CB/MH-13A	99.62	1200mm	PRE-CAST CONCRETE CATCH-BASIN/MANHOLE	97.53(S)	97.52(N)	TO OPSD 701.010 & CITY OF OTTAWA STANDARDS - FRAME & COVER TO CITY OF OTTAWA DRAWING No. S25 & S28.1 OR OPSD 401.010
CB-13B	99.62	600mm x 600mm	PRE-CAST CONCRETE CATCH-BASIN	-	97.59	TO OPSD 705.010 & CITY OF OTTAWA STANDARDS - FRAME & COVER TO CITY OF OTTAWA DRAWING No. S19
CB-14	100.49	600mm x 600mm	PRE-CAST CONCRETE CATCH-BASIN	-	98.24	TO OPSD 705.010 & CITY OF OTTAWA STANDARDS - FRAME & COVER TO CITY OF OTTAWA DRAWING No. S19
SANITARY SEWER						
MH-SA.1	100.59	1200mm	PRE-CAST CONCRETE MANHOLE	96.91(S)	96.85(E)	TO OPSD 701.010 & CITY OF OTTAWA STANDARDS - FRAME & COVER TO CITY OF OTTAWA DRAWING No. S25 & S24 OR OPSD 401.010
MH-SA.2	100.85	1200mm	PRE-CAST CONCRETE MANHOLE	-	97.93	TO OPSD 701.010 & CITY OF OTTAWA STANDARDS - FRAME & COVER TO CITY OF OTTAWA DRAWING No. S25 & S24 OR OPSD 401.010

### KEY PLAN

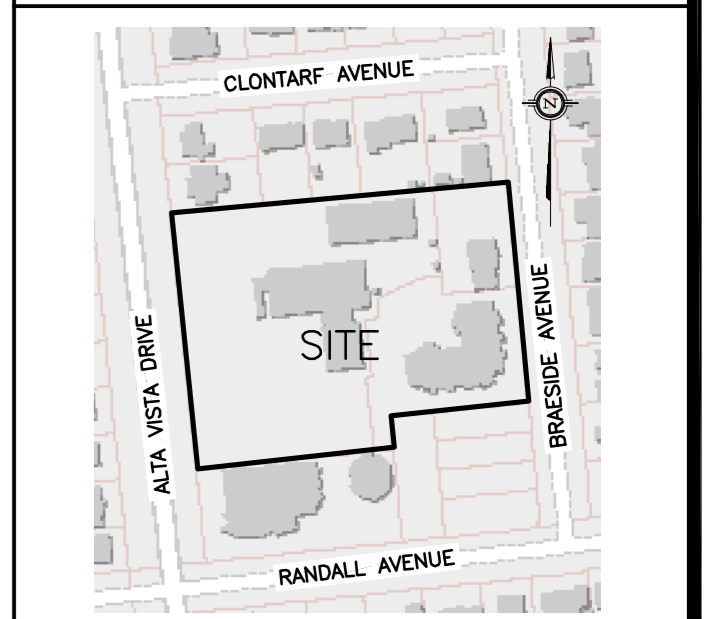

No.	DATE	REVISION
3	APR 14-22	RE-ISSUED FOR APPROVAL
2	OCT 25-21	ISSUED FOR APPROVAL
1	OCT 15-21	PRELIMINARY

**D. B. GRAY ENGINEERING INC.**  
Stormwater Management - Grading & Drainage - Storm & Sanitary Sewers - Watermain  
700 Long Point Circle 613-425-8044  
Ottawa, Ontario d.gray@dbgrayengineering.com

Project  
**ELLWOOD HOUSE EXTENSION**  
38-UNIT 3-STORY APARTMENT BUILDING  
2262 BRAESIDE AVENUE  
& **SITE IMPROVEMENTS**  
2262-2270 BRAESIDE AVENUE  
& 2345 ALTA VISTA DRIVE  
OTTAWA, ONTARIO

### DETAILS

Engineer's Seal

Drawn D.B.G.  
H. Scale 1:250  
V. Scale  
Date OCT 15-21  
Job No. 21028

Drawing No.  
**C-5**  
of 9

NOT VALID UNLESS SIGNED & DATED

SIZE, DEPTH AND LOCATION OF EXISTING SERVICES, UTILITIES AND STRUCTURES AS INDICATED ARE FOR GUIDANCE ONLY. ALL EXISTING SERVICES, UTILITIES AND STRUCTURES ARE NOT NECESSARILY SHOWN ON PLANS AND THOSE SHOWN ARE DERIVED FROM AVAILABLE INFORMATION AND MUST BE CONFIRMED ON SITE. UNDERGROUND LOCATES SHALL BE CONDUCTED PRIOR TO THE COMMENCEMENT OF ANY EXCAVATION. CONFIRM LOCATIONS OF BURIED SERVICES AND UTILITIES BY CAREFUL TEST EXCAVATIONS AND REPORT ANY DIFFERENCES TO THE ENGINEER.

**LEGEND**

	AREAS CHANGING FROM SOFT TO HARD SURFACES
	AREAS CHANGING FROM HARD TO SOFT SURFACES

TOTAL SOFT TO HARD AREAS = 1769 sq.m  
 TOTAL HARD TO SOFT AREAS = 553 sq.m  
 NET INCREASE IN HARD AREAS = 1,216 sq.m

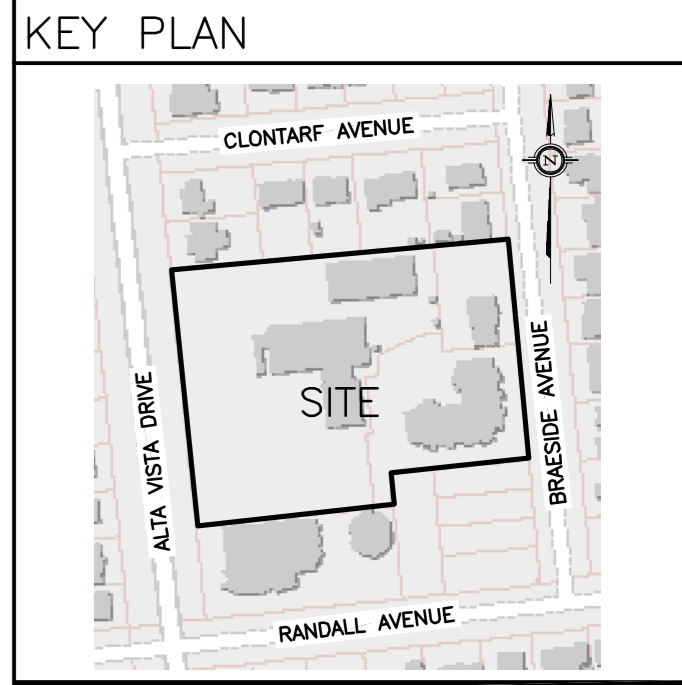
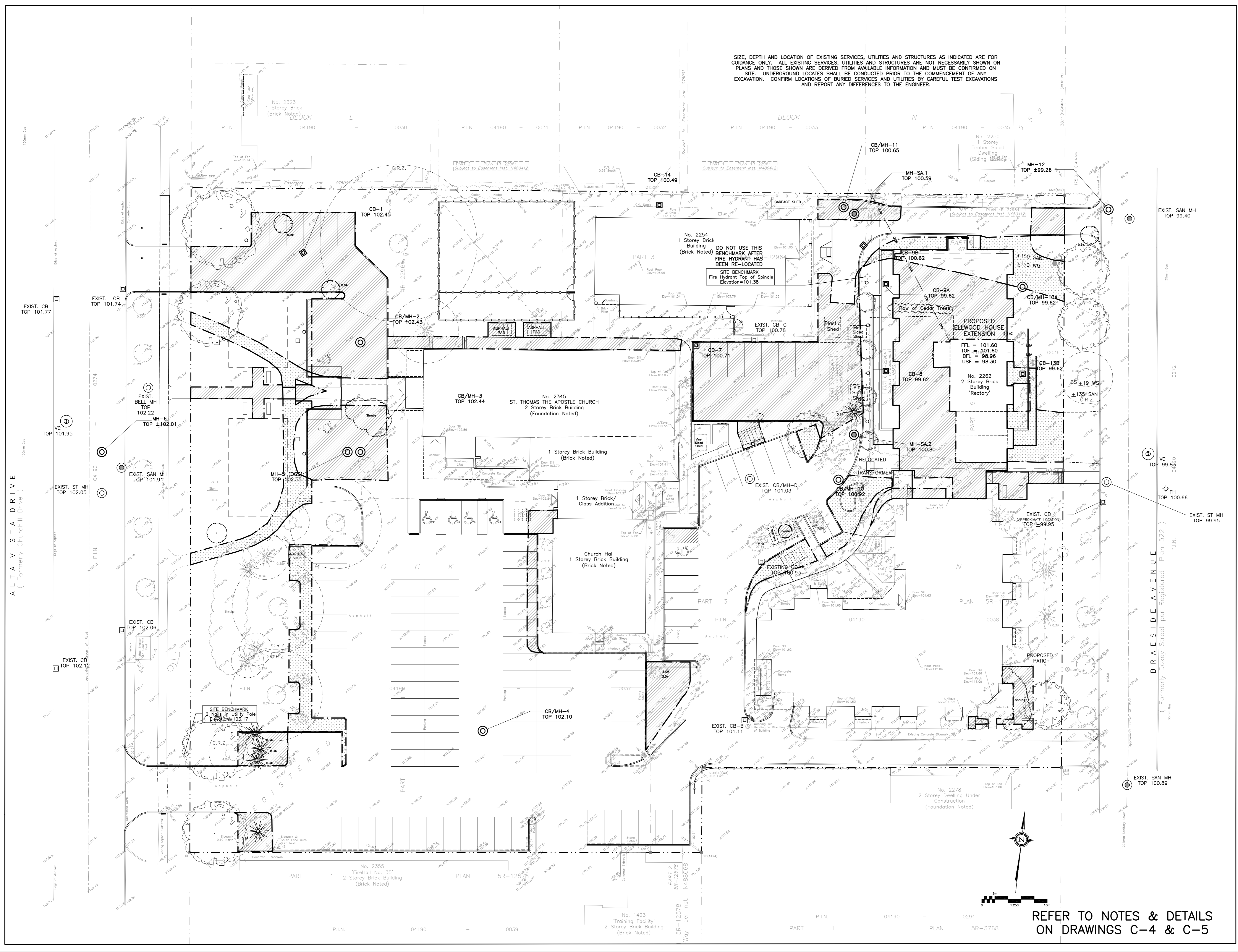

No.	DATE	REVISION
3	APR 14-22	RE-ISSUED FOR APPROVAL
2	OCT 25-21	ISSUED FOR APPROVAL
1	OCT 15-21	PRELIMINARY

**D. B. GRAY ENGINEERING INC.**  
*Stormwater Management - Grading & Drainage - Stone & Sanitary Sewers - Watermain*  
 700 Long Point Circle 613-425-8044  
 Ottawa, Ontario d.gray@dbgrayengineering.com

**Project**  
**ELLWOOD HOUSE EXTENSION**  
 38-UNIT 3-STORY APARTMENT BUILDING  
 2262 BRAESIDE AVENUE  
**& SITE IMPROVEMENTS**  
 2262-2270 BRAESIDE AVENUE  
 & 2345 ALTA VISTA DRIVE  
 OTTAWA, ONTARIO

**Drawing Title**  
 AREAS CHANGING FROM SOFT TO HARD SURFACES AND HARD TO SOFT SURFACES

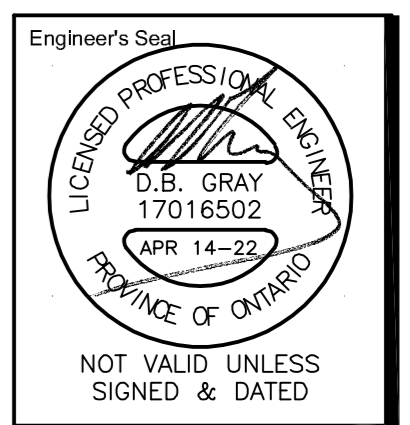

Drawn D.B.G.  
 H. Scale 1:250  
 V. Scale  
 Date OCT 15-21  
 Job No. 21028

Drawing No.  
**C-6**  
 of 9

REFER TO NOTES & DETAILS ON DRAWINGS C-4 & C-5

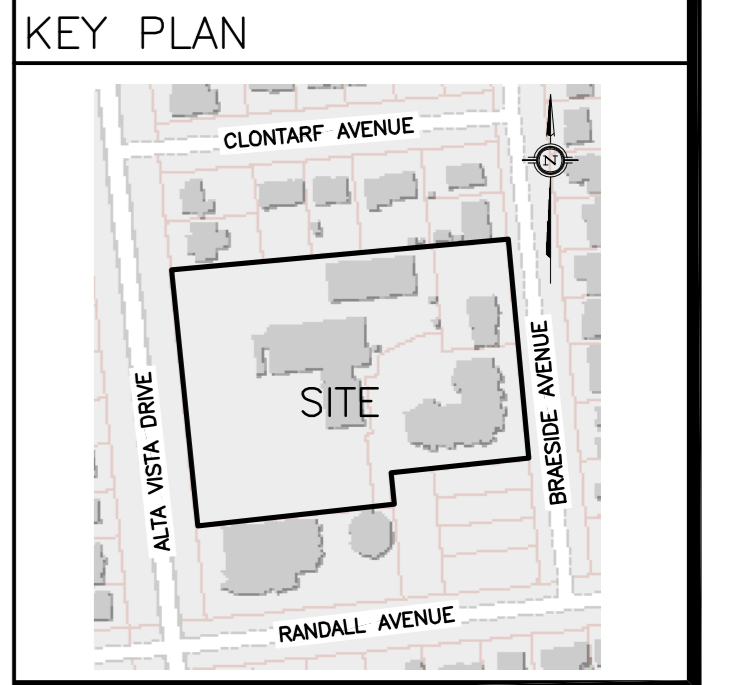
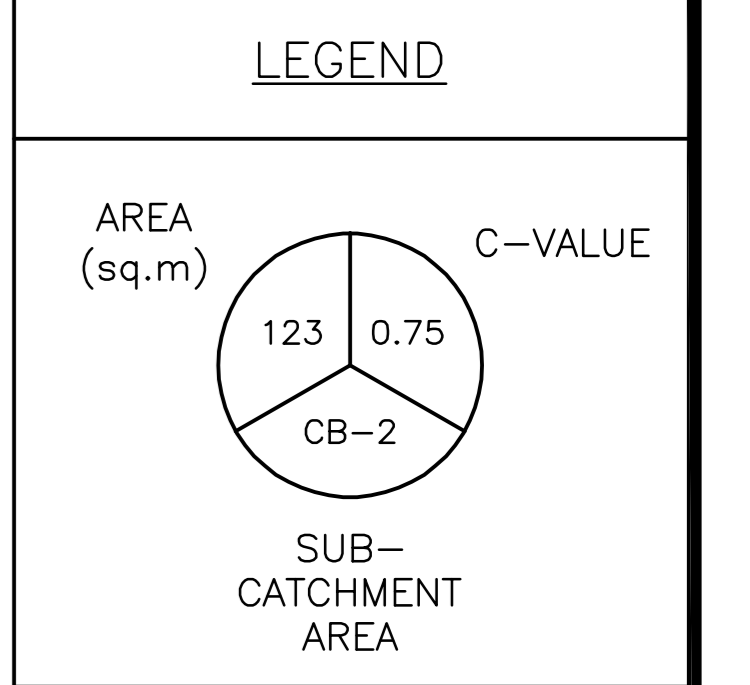
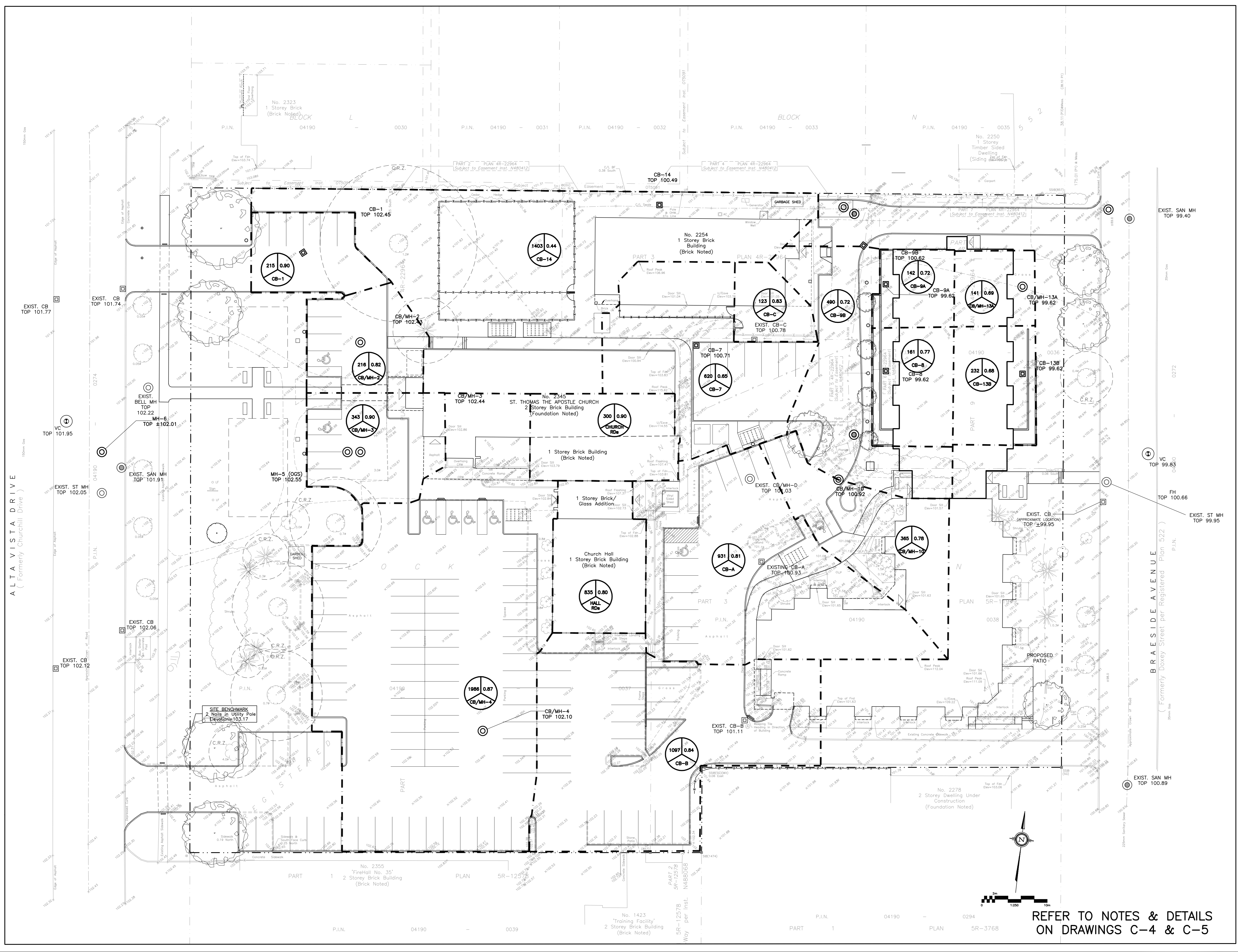

No.	DATE	REVISION
3	APR 14-22	RE-ISSUED FOR APPROVAL
2	OCT 25-21	ISSUED FOR APPROVAL
1	OCT 15-21	PRELIMINARY

**D. B. GRAY ENGINEERING INC.**  
*Stormwater Management - Grading & Drainage - Stone & Sanitary Sewers - Watermain*  
 700 Long Point Circle      613-425-8044  
 Ottawa, Ontario      d.gray@dbgrayengineering.com

Project  
**ELLWOOD HOUSE EXTENSION**  
 38-UNIT 3-STORY APARTMENT BUILDING  
 2262 BRAESIDE AVENUE  
**& SITE IMPROVEMENTS**  
 2262-2270 BRAESIDE AVENUE  
 & 2345 ALTA VISTA DRIVE  
 OTTAWA, ONTARIO

Drawing Title  
**SUB-CATCHMENT AREA DRAINAGE PLAN**

Engineer's Seal  
  
 NOT VALID UNLESS SIGNED & DATED

Drawn      D.B.G.  
 H. Scale      1:250  
 V. Scale  
 Date      OCT 15-21  
 Job No.      21028

Drawing No.  
**C-7**  
 of 9

REFER TO NOTES & DETAILS ON DRAWINGS C-4 & C-5

#18637

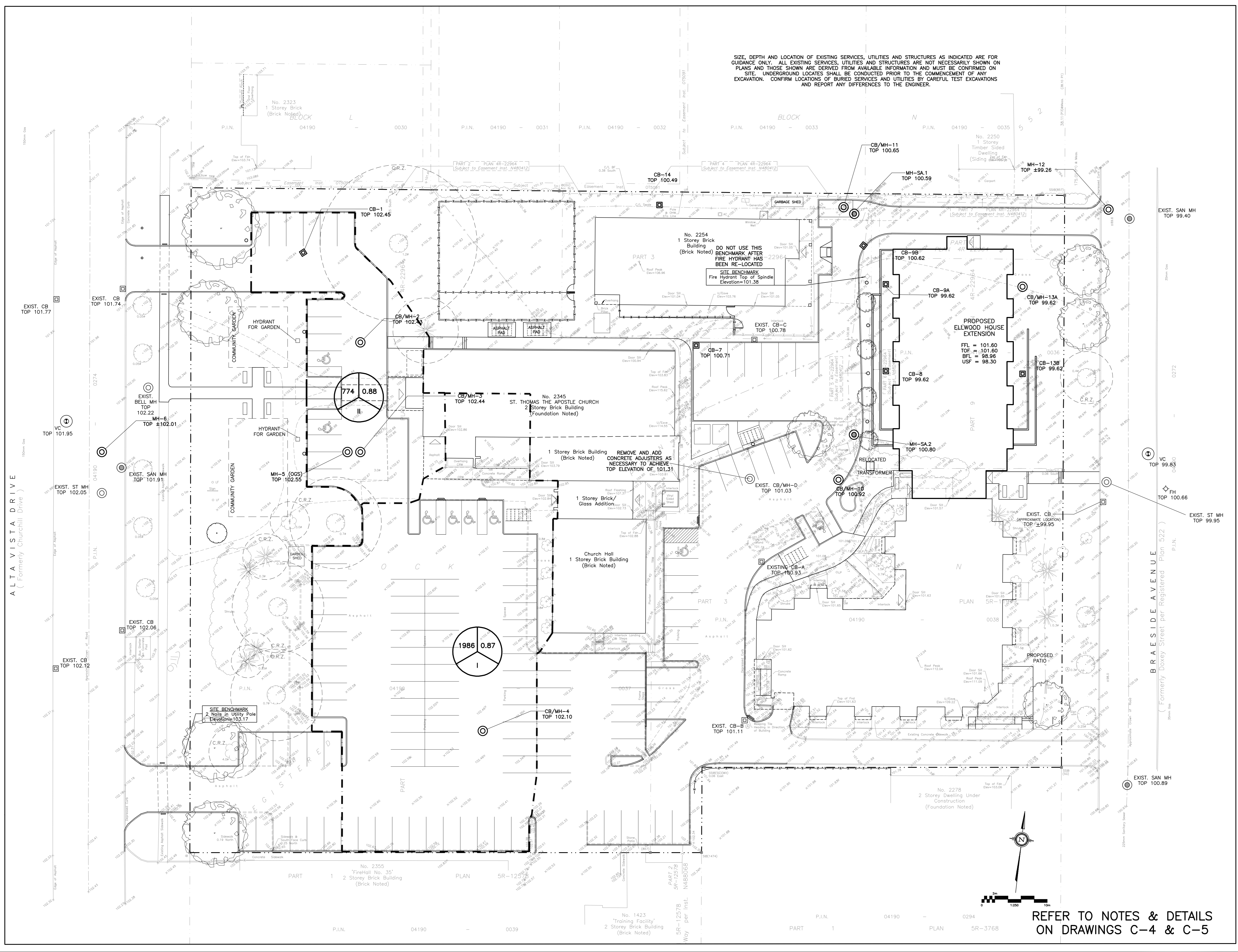

SIZE, DEPTH AND LOCATION OF EXISTING SERVICES, UTILITIES AND STRUCTURES AS INDICATED ARE FOR GUIDANCE ONLY. ALL EXISTING SERVICES, UTILITIES AND STRUCTURES ARE NOT NECESSARILY SHOWN ON PLANS AND THOSE SHOWN ARE DERIVED FROM AVAILABLE INFORMATION AND MUST BE CONFIRMED ON SITE. UNDERGROUND LOCATES SHALL BE CONDUCTED PRIOR TO THE COMMENCEMENT OF ANY EXCAVATION. CONFIRM LOCATIONS OF BURIED SERVICES AND UTILITIES BY CAREFUL TEST EXCAVATIONS AND REPORT ANY DIFFERENCES TO THE ENGINEER.

LEGEND

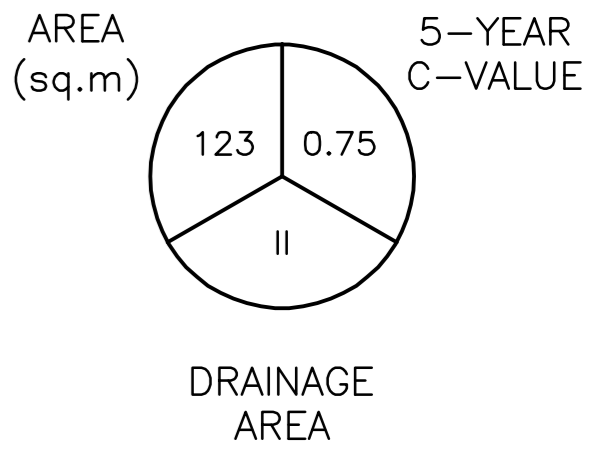

KEY PLAN

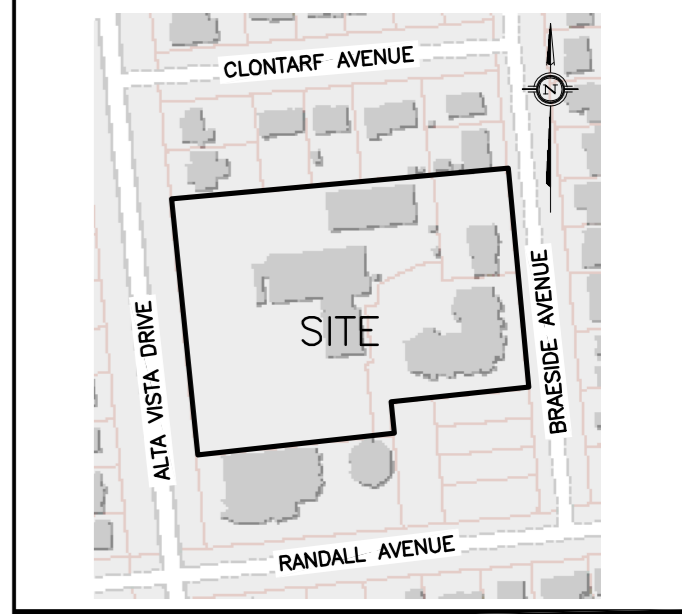

No.	DATE	REVISION
1	APR 14-22	ISSUED FOR APPROVAL

**D. B. GRAY ENGINEERING INC.**  
 Stormwater Management - Grading & Drainage - Stone & Sanitary Sewers - Watermain  
 700 Long Point Circle 613-425-8044  
 Ottawa, Ontario d.gray@dbgrayengineering.com

Project  
**ELLWOOD HOUSE EXTENSION**  
 38-UNIT 3-STORY APARTMENT BUILDING  
 2262 BRAESIDE AVENUE  
 & **SITE IMPROVEMENTS**  
 2262-2270 BRAESIDE AVENUE  
 & 2345 ALTA VISTA DRIVE  
 OTTAWA, ONTARIO

Drawing Title  
**STORMWATER MANAGEMENT DRAINAGE PLAN**

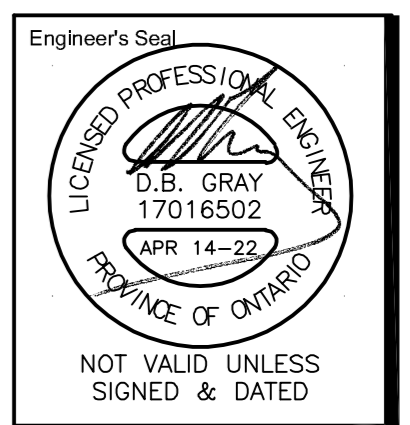

Drawn D.B.G.  
 H. Scale 1:250  
 V. Scale  
 Date OCT 15-21  
 Job No. 21028

Drawing No.  
**C-8**  
 of 9

REFER TO NOTES & DETAILS ON DRAWINGS C-4 & C-5



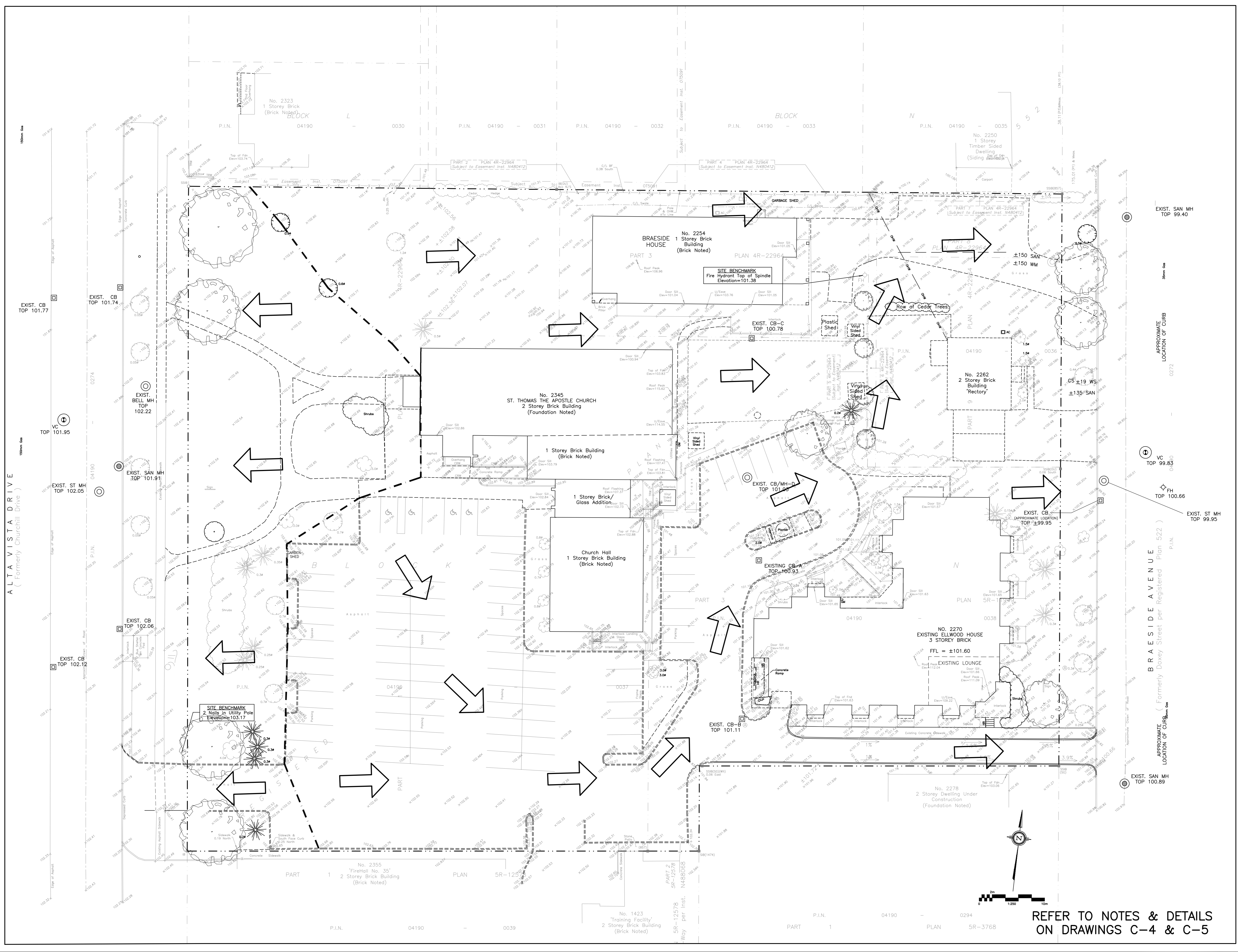

**KEY PLAN**

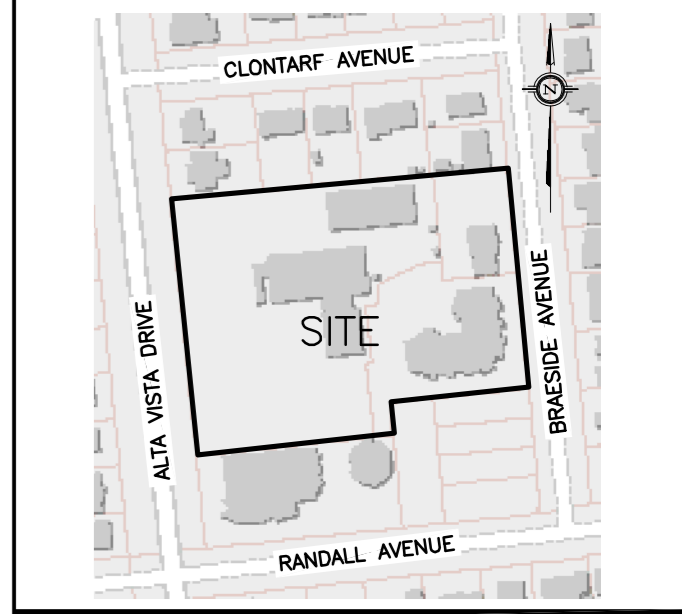

No.	DATE	REVISION
1	APR 14-22	ISSUED FOR APPROVAL

**D. B. GRAY ENGINEERING INC.**  
*Stormwater Management - Grading & Drainage - Storm & Sanitary Sewers - Watermain*  
 700 Long Point Circle 613-425-8044  
 Ottawa, Ontario d.gray@dbgrayengineering.com

**Project**  
**ELLWOOD HOUSE EXTENSION**  
 38-UNIT 3-STORY APARTMENT BUILDING  
 2262 BRAESIDE AVENUE  
**& SITE IMPROVEMENTS**  
 2262-2270 BRAESIDE AVENUE  
 & 2345 ALTA VISTA DRIVE  
 OTTAWA, ONTARIO

**Drawing Title**  
**PRE-DEVELOPMENT DRAINAGE PLAN**

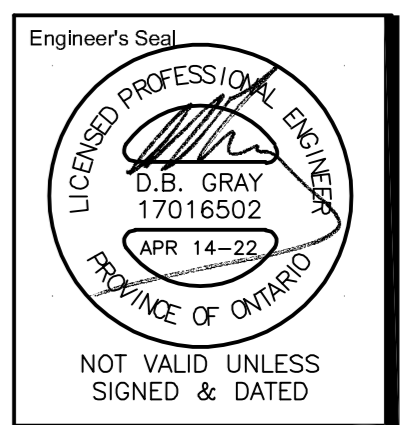

Drawn D.B.G.  
 H. Scale 1:250  
 V. Scale  
 Date OCT 15-21  
 Job No. 21028

Drawing No.  
**C-9**  
 of 9

**REFER TO NOTES & DETAILS ON DRAWINGS C-4 & C-5**