

WATER SERVICE PROFILE TABLE

MATERIAL:
150mm - 200mm PVC PRESSURE CLASS 150 DR18

STATION	DESCRIPTION	GRADE ELEVATION	TOP OF PIPE	DEPTH OF COVER	NOTES
A+00.0	150mm x 150mm TEE CONNECTION IN 150mm MUNICIPAL WATERMAIN TO CITY OF OTTAWA STANDARDS	±99.35	±97.55	±1.80	-
A+00.5	150mm 45° VERTICAL BEND DOWN TO CITY OF OTTAWA STANDARDS	±99.38	97.55	±1.83	-
A+02.0	150mm 45° VERTICAL BEND UP TO CITY OF OTTAWA STANDARDS	±99.42	96.05	±3.37	-
A+03.0	-	±99.45	96.05	±3.40	CROSSING 225 SAN INV ±96.55 (MIN. 500mm REQUIRED)
A+06.2	-	±99.34	96.05	±3.04	CROSSING 375 ST INV ±97.29 (MIN. 500mm REQUIRED)
A+07.2	150mm 45° VERTICAL BEND UP TO CITY OF OTTAWA STANDARDS	±99.31	96.05	±3.26	BOTTOM OF CURB
A+08.1	150mm 45° VERTICAL BEND DOWN TO CITY OF OTTAWA STANDARDS	99.41	97.01	2.40	-
A+09.0	200mm TO 150mm REDUCER TO CITY OF OTTAWA STANDARDS	99.44	97.04	2.40	-
A+12.9	200mm VALVE & VALVE BOX TO CITY OF OTTAWA STANDARDS	99.59	97.19	2.40	ON PROPERTY LINE
A+27.7	-	100.09	97.69	2.40	50mm INSULATION AS PER CITY OF OTTAWA DWG W22.50 FROM A+27.7 TO A+51.5
A+35.9	-	100.31	97.98	2.33	-
A+42.5 (B+00.0)	200mm x 150mm TEE (TO FIRE HYDRANT) TO CITY OF OTTAWA STANDARDS	100.49	98.22	2.27	-
A+45.0	-	100.57	98.31	2.26	CROSSING 200 SAN TOP 97.13 WM U/S 88.17 1040mm CLEARANCE
A+46.7	-	100.88	98.37	2.21	CROSSING 300 ST TOP 97.92 WM U/S 88.17 250mm CLEARANCE (MIN. 250mm REQUIRED)
A+47.8	200mm 45° HORIZONTAL BEND TO CITY OF OTTAWA STANDARDS	100.70	98.38	2.32	-
A+48.8	200mm TO 150mm REDUCER TO CITY OF OTTAWA STANDARDS	100.71	98.42	2.29	-
A+49.5	-	100.72	98.44	2.28	CROSSING 150 SAN INV ±98.70 ±380mm CLEARANCE
A+50.5 (C+00.0)	TVS CONNECTION TO 150mm WATERMAIN TO CITY OF OTTAWA STANDARDS	100.73	98.47	2.26	-
A+51.5	150mm 45° HORIZONTAL BEND TO CITY OF OTTAWA STANDARDS	±100.74	±98.49	±2.25	CONNECT TO EXISTING 150mm WS 50mm INSULATION AS PER CITY OF OTTAWA DWG W22.50 FROM A+27.7 TO A+51.5

WATER SERVICE PROFILE TABLE

MATERIAL:
150mm PVC PRESSURE CLASS 150 DR18

STATION	DESCRIPTION	GRADE ELEVATION	TOP OF PIPE	DEPTH OF COVER	NOTES
B+00.0 (A+42.5)	150mm x 150mm TEE TO CITY OF OTTAWA STANDARDS	100.49	98.22	2.27	-
B+01.0	150mm VALVE & VALVE BOX TO CITY OF OTTAWA STANDARDS	100.48	98.22	2.28	50mm INSULATION AS PER CITY OF OTTAWA DWG W22.50 FROM B+00.0 TO B+03.7
B+03.7	-	100.51	98.22	2.29	-
B+07.0	FIRE HYDRANT TO CITY OF OTTAWA STANDARDS	100.81	98.22	2.59	-
MATERIAL: 50mm PEX TUBING TO AWWA C-904 SDR 9 (CTS)					
C+00.0 (A+50.5)	TVS CONNECTION TO 150mm WATERMAIN TO CITY OF OTTAWA STANDARDS	100.73	98.42	2.31	-
C+02.3	50mm CURB STOP TO CITY OF OTTAWA STANDARDS	100.75	98.35	2.40	-
C+16.0	-	100.78	98.38	2.40	CROSSING 250 ST TOP 97.89 WM U/S 88.17 350mm CLEARANCE
C+24.5	-	100.88	98.48	2.40	-
C+30.5	50mm 25mm REDUCER TO CITY OF OTTAWA STANDARDS (IF REQUIRED)	±101.27	98.87	2.40	CONNECT TO EXISTING WS (SIZE UNKNOWN - 25mm TO 50mm)
MATERIAL: 50mm COPPER ASTM B88 TYPE "K" SOFT					
E+00.0	TVS CONNECTION TO 150mm WATERMAIN TO CITY OF OTTAWA DRAWING No. W33	±99.78	±97.98	±1.80	-
E+03.0	-	±99.88	97.41	2.47	CROSSING 225 SAN TOP ±97.16 WM U/S 88.17 200mm CLEARANCE
E+06.3	-	±99.77	97.41	2.36	CROSSING 375 ST INV ±97.71 300mm CLEARANCE
E+07.3	-	±99.74	97.34	2.40	BOTTOM OF CURB
E+13.0	50mm CURB STOP TO CITY OF OTTAWA STANDARDS	100.13	97.68	2.45	ON PROPERTY LINE
E+20.6	-	100.69	98.29	2.40	ENTRY INTO BUILDING

CATCH-BASIN & MANHOLE SCHEDULE

REF	TOP	SIZE	TYPE	INVERT AT INLET	INVERT AT OUTLET	NOTES
STORM SEWER						
CB-1	102.45	600mm x 600mm	PRE-CAST CONCRETE CATCH-BASIN	-	100.36	TO OFSD 705.010 & CITY OF OTTAWA DRAWING No. S19
CB/MH-2	102.43	1200mm	PRE-CAST CONCRETE CATCH-BASIN/MANHOLE	100.29(W)	100.29(S)	TO OFSD 705.010 & CITY OF OTTAWA STANDARDS - FRAME & COVER TO CITY OF OTTAWA DRAWING No. S25 & S24.1 OR OFSD 40.010
CB/MH-3	102.44	1200mm	PRE-CAST CONCRETE CATCH-BASIN/MANHOLE	100.22(N)	100.22(W)	TO OFSD 705.010 & CITY OF OTTAWA STANDARDS - FRAME & COVER TO CITY OF OTTAWA DRAWING No. S25 & S24.1 OR OFSD 40.010 INSTALL ICD IN OUTLET PIPE
CB/MH-4	102.10	1200mm	PRE-CAST CONCRETE CATCH-BASIN/MANHOLE	-	100.39	TO OFSD 705.010 & CITY OF OTTAWA STANDARDS - FRAME & COVER TO CITY OF OTTAWA DRAWING No. S25 & S24.1 OR OFSD 40.010 INSTALL ICD IN OUTLET PIPE
MH-5	102.55	600mm x 600mm	PRE-CAST CONCRETE MANHOLE	100.21(E) 100.23(SE)	100.20(W)	TO OFSD 705.010 & CITY OF OTTAWA STANDARDS EXCEPT WITH A DEEP SUMP AS REQUIRED BY CBS INSTALLED WITH A WATERTIGHT COVER
MH-6	102.01	1200mm	PRE-CAST CONCRETE MANHOLE	100.07(E) ±100.03(S)	100.01(N)	TO OFSD 705.010 & CITY OF OTTAWA STANDARDS - FRAME & COVER TO CITY OF OTTAWA DRAWING No. S19
CB-7	100.69	600mm x 600mm	PRE-CAST CONCRETE CATCH-BASIN	-	97.81	TO OFSD 705.010 & CITY OF OTTAWA STANDARDS - FRAME & COVER TO CITY OF OTTAWA DRAWING No. S19
CB-8	99.66	600mm x 600mm	PRE-CAST CONCRETE CATCH-BASIN	-	97.77	TO OFSD 705.010 & CITY OF OTTAWA STANDARDS - FRAME & COVER TO CITY OF OTTAWA DRAWING No. S19
CB-9	99.66	600mm x 600mm	PRE-CAST CONCRETE CATCH-BASIN	-	97.71	TO OFSD 705.010 & CITY OF OTTAWA STANDARDS - FRAME & COVER TO CITY OF OTTAWA DRAWING No. S19
CB/MH-10	100.92	1200mm	PRE-CAST CONCRETE CATCH-BASIN/MANHOLE	±88.84(W)	97.78(N)	TO OFSD 705.010 & CITY OF OTTAWA STANDARDS - FRAME & COVER TO CITY OF OTTAWA DRAWING No. S25 & S24.1 OR OFSD 40.010 INSTALL ICD IN OUTLET PIPE
CB/MH-11	100.59	1200mm	PRE-CAST CONCRETE CATCH-BASIN/MANHOLE	97.60(S)	97.54(E)	TO OFSD 705.010 & CITY OF OTTAWA STANDARDS - FRAME & COVER TO CITY OF OTTAWA DRAWING No. S25 & S24.1 OR OFSD 40.010 INSTALL ICD IN OUTLET PIPE
MH-12	99.26	1200mm	PRE-CAST CONCRETE MANHOLE	97.27(W) ±97.24(S)	97.24(N)	TO OFSD 705.010 & CITY OF OTTAWA STANDARDS - FRAME & COVER TO CITY OF OTTAWA DRAWING No. S25 & S24.1 OR OFSD 40.010
CB-13	99.60	600mm x 600mm	PRE-CAST CONCRETE CATCH-BASIN	-	97.65	TO OFSD 705.010 & CITY OF OTTAWA STANDARDS - FRAME & COVER TO CITY OF OTTAWA DRAWING No. S19
SANITARY SEWER						
MH-SA-1	100.56	1200mm	PRE-CAST CONCRETE MANHOLE	96.91(S)	96.85(E)	TO OFSD 705.010 & CITY OF OTTAWA STANDARDS - FRAME & COVER TO CITY OF OTTAWA DRAWING No. S25 & S24.1 OR OFSD 40.010
MH-SA-2	100.85	1200mm	PRE-CAST CONCRETE MANHOLE	-	97.93	TO OFSD 705.010 & CITY OF OTTAWA STANDARDS - FRAME & COVER TO CITY OF OTTAWA DRAWING No. S25 & S24.1 OR OFSD 40.010

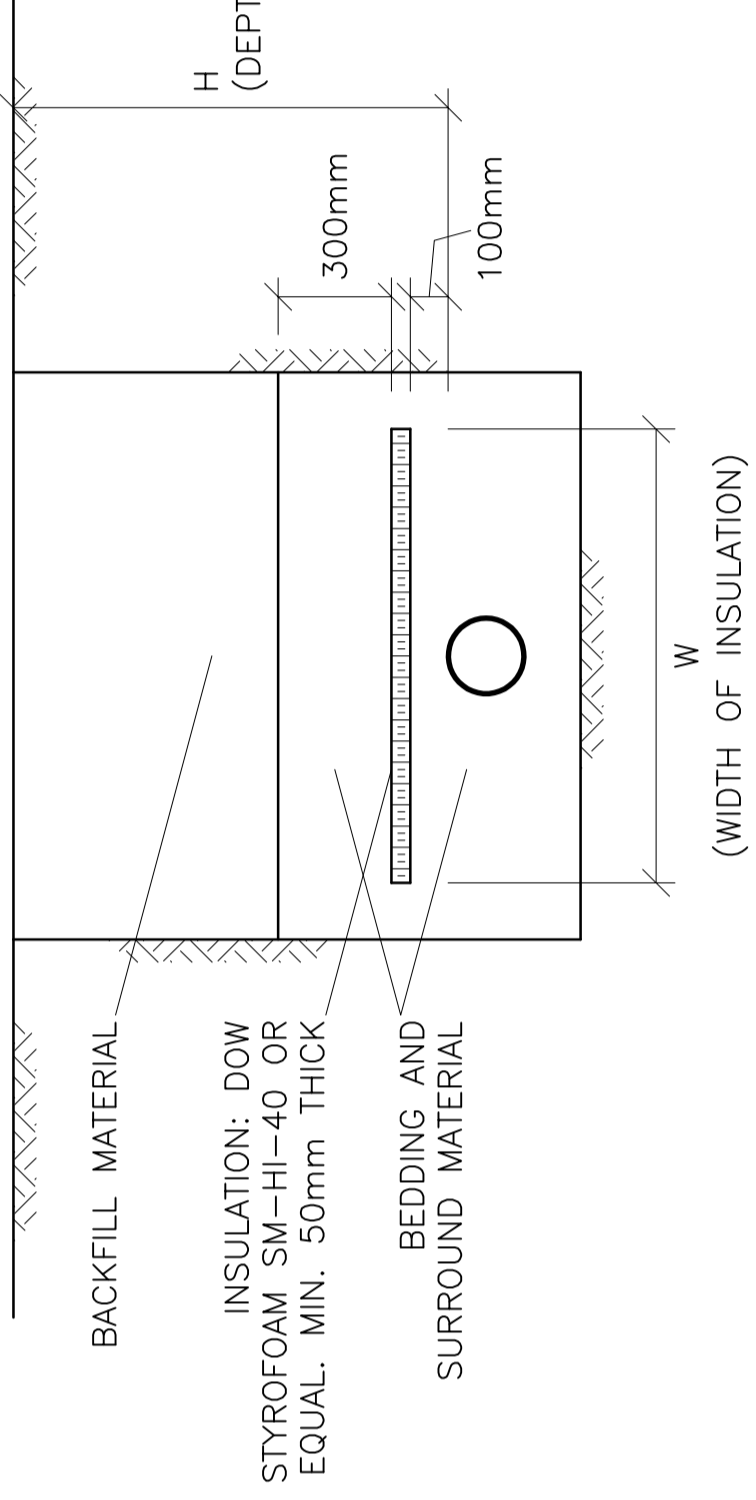

INSULATE SEWER AS INDICATED AND WHERE DEPTH OF COVER IS LESS THAN 2000mm, CENTER INSULATION OVER PIPE. JOINTS BETWEEN SHEETS OF INSULATION SHALL BE STAGGERED.

INSULATION OF SEWERS
IN SHALLOW TRENCHES
N.T.S

(DEPTH OF COVER)	H	INSULATION THICKNESS	W
1400 TO 2000mm	1400	50mm	1200mm + DIAMETER OF PIPE
1100 TO 1400mm	1100	75mm	1800mm + DIAMETER OF PIPE
LESS THAN 1100mm	LESS THAN 1100mm	100mm	2400mm + DIAMETER OF PIPE

KEY PLAN



No.	DATE	REVISION
2	OCT 25-21	ISSUED FOR APPROVAL
1	OCT 15-21	PRELIMINARY

D. B. GRAY ENGINEERING INC.
 700 Long Point Circle
 Ottawa, Ontario K1J 1P4
 613-425-8044
 d.gray@dbgrayengineering.com

**ELLWOOD HOUSE EXTENSION
& SITE IMPROVEMENTS**
 2262 BRAESIDE AVENUE
 & 2345 ALTA VISTA DRIVE
 OTTAWA, ONTARIO

DETAILS

Engineer's Seal
 Drawn: D.B.G.
 H. Scale: 1:250
 V. Scale: 1:250
 Date: OCT 15-21
 Job No.: 21023
 Drawing No.: C-5 of 7
 NOT VALID UNLESS SIGNED & DATED