

**GENERAL NOTES**

- This drawing shall be read in conjunction with all relevant Architectural, Engineering and related Drawings and Documents.
- Refer to Engineering Drawings for Grading and Servicing.
- Refer to Architectural Drawings for Site Layout.
- Contractor shall provide the location(s) of all services/utilities by consulting Municipal Authorities and Utility companies and shall be responsible for adequate protection from damage during construction.
- Plant material shall be No. 1 Grade and shall comply with the Metric Guide Specifications For Nursery Stock (latest edition), published by the Canadian Nursery Trades Association.
- Plant Material locations are Schematic / Approximate only. Contractor shall stake out locations on site prior to work.
- Contractor shall guarantee all plant material for a period of one (1) full year from the date of final acceptance.
- Shrubs shall be planted in a continuous prepared bed of 450mm depth planting soil mix covered over with a woven polypropylene weed control fabric (LANDSCAPE FABRIC-Green-Line by Thrace-LINQ) and 75mm depth composted pine mulch to finish grade, as specified.
- Perennials and Ornamental Grasses shall be planted in a continuous prepared bed of 450mm depth planting soil mix covered over with 75mm depth composted pine mulch to finish grade (NO WEED CONTROL FABRIC), as specified.
- Sod areas to receive 125mm topsoil. Sod shall be No. 1 quality conforming to the Canadian Nursery Sod Growers Specification.
- Reinstatement all areas damaged or disturbed beyond the limit of Work.
- Plant Material substitutions shall not be permitted without written approval from the Consultant.
- Contractor shall advise Consultant a minimum of 48hrs. prior to proceeding landscape work and any required Field Reviews.
- THIS PLAN HAS BEEN PREPARED FOR MUNICIPAL SITE PLAN APPROVAL ONLY AND MAY NOT BE USED FOR ANY OTHER PURPOSE.**

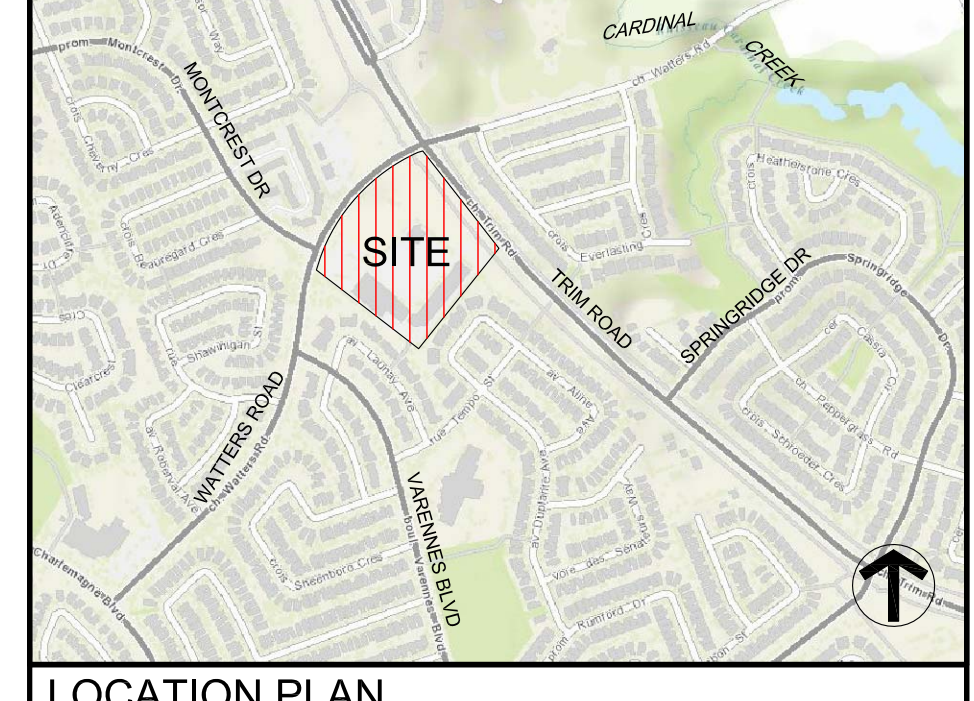

**LEGEND / SYMBOL**

- EXISTING TREE TO BE RETAINED (Refer to Schedule of Existing Trees) CRZ (Critical Root Zone)
- EXISTING TREE TO BE REMOVED (Refer to Schedule of Existing Trees) CRZ (Critical Root Zone)
- PROPOSED DECIDUOUS TREE DETAIL 11.2.01
- PROPOSED CONIFEROUS TREE DETAIL 11.2.01
- PROPOSED SHRUBS / GROUNDCOVERS DETAIL 11.2.01
- PROPOSED BICYCLE RACK 4-RING (7 CAPACITY) DETAIL 31.2.01
- PROPOSED UNIFORM PAVING: 50x50x25mm (70 x 295 x 295mm) Type: ASPEN (fibrous) Colour: ASH CHARCOAL Pattern: Linear DETAIL 41.2.01
- PROPOSED TREE PROTECTION BARRIER DETAIL 21.2.01
- PROPOSED LIMIT OF WORK

**PLANT MATERIAL SCHEDULE**

CODE	BOTANICAL NAME	COMMON NAME	QTY.	SIZE	REMARKS
<b>DECIDUOUS TREES</b>					
AC	AMEL ANCHER CANADENSIS	SHADBLW SERVICEBERRY	6	50mm cal	B&B, Single Stem
AFJ	ACER X FREEMANII JEFFERSRED	AUTUMN BLAZE MAPLE	4	50mm cal	B&B, Single Stem
AR	ACER RUBRUM	RED MAPLE	3	50mm cal	B&B, Single Stem
CO	CELTIS OCCIDENTALIS	COMMON HACKBERRY	3	50mm cal	B&B, Single Stem
GBP	GINKGO BILOBA 'PRINCETON SENTRY'	'PRINCETON SENTRY' MAIDENHAIR TREE	2	50mm cal	B&B, Single Stem
QM	QUERCUS MACROCARPA	BUR OAK	6	50mm cal	B&B, Single Stem
QR	QUERCUS RUBRA	RED OAK	7	50mm cal	B&B, Single Stem
SR	SYRINGA RETICULATA 'IVORY SILK'	IVORY SILK JAPANESE TREE LILAC	3	50mm cal	B&B, Single Stem
<b>CONIFEROUS TREES</b>					
PG	PICEA GLAUCA	WHITE SPRUCE	12	200 cm ht	B&B
PN	PINUS NIGRA	AUSTRIAN PINE	3	200 cm ht	B&B
PPP	PICEA PUNGENS	COLORADO GREEN SPRUCE	3	200 cm ht	B&B
<b>DECIDUOUS SHRUBS</b>					
CAR	CORNUS ALTERNIFOLIA	PAGODA DOGWOOD	3	150cm ht.	B&B, multi-stem
CAS	CORNUS ALBA ARGENTEO-MARGINATA	SILVERLEAF DOGWOOD	74	60cm ht	potted, 100cm o/c
CK	CORNUS SERICEA 'KELSEY'	KELSEY RED OSIER DOGWOOD	9	50cm ht	potted, 80cm o/c
CR	CORNUS RACEMOSA	GRAY DOGWOOD	40	50cm ht	potted, 100cm o/c
CS	CORNUS SERICEA	RED OSIER DOGWOOD	75	50cm ht	potted, 100cm o/c
HAA	HYDRANGEA ARBORESCENS ANNABELLE	ANNABELLE HYDRANGEA	60	50cm ht	potted, 100cm o/c
HPG	HYDRANGEA PANICULATA GRANDIFLORA	PEE GEE HYDRANGEA	190	50cm ht	potted, 100cm o/c
PFA	POTENTILLA FRUTICOSA ABBOTTSWOOD	ABBOTTSWOOD CINQUEFOIL	70	50cm ht	potted, 80cm o/c
PO	PHYSCARPUS OPLIFOLIUS	COMMON NINEBARK	48	50cm ht	potted, 100cm o/c
TRAU	RIBES ALBUM	FLOWERING CURRANT	102	50cm ht	potted, 100cm o/c
RB	ROSA BLANDA	SHRUB ROSE	131	50cm ht	potted, 100cm o/c
VD	VIBURNUM DENTATUM	ARROWWOOD	62	50cm ht	potted, 100cm o/c
WFP	WEIGELA FLORIDA PINK PRINCESS	PINK PRINCESS WEIGELA	30	50cm ht	potted, 100cm o/c
<b>CONIFEROUS SHRUBS</b>					
JSW	JUNIPERUS SCOPULORUM	WICHITA BLUE JUNIPER	36	100cm ht	potted, 100cm o/c
PM	PINUS MUGHO MUGHUS	MUGHO PINE	20	50cm ht	potted, 100cm o/c
<b>PERENNIALS</b>					
Ech	ECHINACEA pallida	PALE PURPLE CONEFLOWER	120	15 cm pot	plant 60cm o/c
Sai	SALVIA nemorosa 'May Light'	MAY LIGHT MEADOW SAGE	86	15 cm pot	plant 60cm o/c
<b>ORNAMENTAL GRASSES</b>					
Cal	CALAMAGROSTIS x acutiflora 'Karl Foerster'	KARL FOERSTER REED GRASS	308	15cm pot	plant 75cm o/c
Pv	PANICUM virgatum	SWITCH GRASS	95	15cm pot	plant 75cm o/c
Spo	SPOROBOLUS heterolepis	PRAIRIE DROPSSEED	82	15cm pot	plant 75cm o/c

**SCHEDULE OF EXISTING TREES**  
(Inventory conducted Sept. 24, 2021)

CODE	SPECIES	CONDITION	DBH <sup>1</sup> (cm)	OWNERSHIP	ACTION NOTES
1	Honeylocust	good	22	Private (Owner)	RETAIN / PROTECT
2	Honeylocust	good	18	Private (Owner)	RETAIN / PROTECT
3	Honeylocust	good	25	Private (Owner)	REMOVE / Development conflict;
4	Poplar	good	40	Private (Owner)	REMOVE / Development conflict;
5	Poplar	good	30	Private (Owner)	REMOVE / Development conflict;
6	Honeylocust	poor	7	Private (Owner)	REMOVE / Development conflict;
7	Honeylocust	good	6	Private (Owner)	REMOVE / Development conflict;
8	Honeylocust	good	7	Private (Owner)	REMOVE / Development conflict;
9	Honeylocust	good	7	Private (Owner)	REMOVE / Development conflict;
10	Maple	good	7	City ROW	RETAIN / PROTECT
11	Honeylocust	good	7	City ROW	RETAIN / PROTECT
12	Maidenhair Tree	good	7	City ROW	RETAIN / PROTECT
13	Oak	good	7	City ROW	RETAIN / PROTECT
14	Honeylocust	good	15	Private (Owner)	REMOVE / Development conflict;
15	Honeylocust	good	13	Private (Owner)	REMOVE / Development conflict;
16	Schubert Cheekcherry	poor	16	Private (Owner)	REMOVE / Development conflict;
17	Honeylocust	good	13	Private (Owner)	REMOVE / Development conflict;
18	Hackberry	good	15	Private (Owner)	REMOVE / Development conflict;
19	Hackberry	good	16	Private (Owner)	REMOVE / Development conflict;
20	Hackberry	good	16	Private (Owner)	REMOVE / Development conflict;
21	Hackberry	good	18	Private (Owner)	REMOVE / Development conflict;
22	Honeylocust	good	10	Private (Owner)	REMOVE / Development conflict;
23	Honeylocust	good	9	Private (Owner)	REMOVE / Development conflict;
24	Honeylocust	good	9	Private (Owner)	REMOVE / Development conflict;
25	Honeylocust	good	9	Private (Owner)	REMOVE / Development conflict;
26	Hackberry	good	15	Private (Owner)	REMOVE / Development conflict;
27	Hackberry	good	16	Private (Owner)	REMOVE / Development conflict;
28	Hackberry	fair	13	Private (Owner)	REMOVE / Development conflict;
29	Hackberry	good	15	Private (Owner)	REMOVE / Development conflict;
30	Hackberry	good	16	Private (Owner)	RETAIN / PROTECT
31	Hackberry	good	15	Private (Owner)	RETAIN / PROTECT
32	Hackberry	good	15	Private (Owner)	RETAIN / PROTECT
33	Maidenhair Tree	good	6	Private (Owner)	RETAIN / PROTECT
34	Oak	good	6	Private (Owner)	RETAIN / PROTECT
35	unknown	dead	4	Private (Owner)	REMOVE
36	unknown	dead	4	Private (Owner)	REMOVE
37	Maidenhair Tree	poor	5	Private (Owner)	RETAIN / PROTECT

**NOTE:**  
1. No tree species at risk, as identified under the Province of Ontario Endangered Species Act (ESA), were found on subject property or within 25m of adjacent properties.  
2. In conformance to the guidelines outlined in the City of Ottawa Protocol for Wildlife Protection During Construction, no clearing of vegetation shall occur between April 15 and August 15, unless a qualified biologist has determined that no bird nesting is occurring within 5 days prior to clearing. A pre-clearing survey for active stick nests and cavity nests shall also be conducted between April 1 and April 15 in order to identify and protect early nesting owls and raptors.

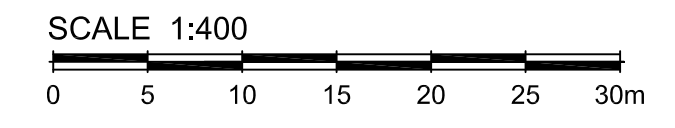

**FOR APPROVAL ONLY**

no.	date	revision
5.	FEB.4/22	PER CITY COMMENTS (1)
4.	DEC.16/21	ISSUE FOR 90% DESIGN SUBMISSION
3.	NOV.18/21	ISSUE FOR 60% DESIGN SUBMISSION
2.	OCT.28/21	ISSUE FOR SPA
1.	OCT.20/21	ISSUE FOR SPA REVIEW/COORDINATION

Contractor shall check and verify all dimensions on site and report all errors and/or omissions to the Consultant.  
Work to be done in accordance with all applicable codes and by-laws.  
Do not scale Drawing.  
This Drawing shall not be used for construction until signed by the Consultant.  
Copyright reserved. This Drawing is the exclusive property of Levstek Consultants Inc. and shall not be used without consent.

Consultant  
**LEVSTEK CONSULTANTS**  
5871 Hugh Creechway, Ottawa, Ontario K2A 2W9  
613-826-0518

Client  
**TAGGART REALTY MANAGEMENT**  
225 METCALFE ST., SUITE 708  
OTTAWA, ONTARIO

Project  
**CROWN POINTE PHASE 3**  
900 WATERS ROAD

Drawing Title  
**LANDSCAPE / TCR PLAN**

Drawing No.  
**L1.01**

Scale  
**1:400**

Date  
**SEPT 2021**

Project No.  
**1149**

D07-12-21-0183



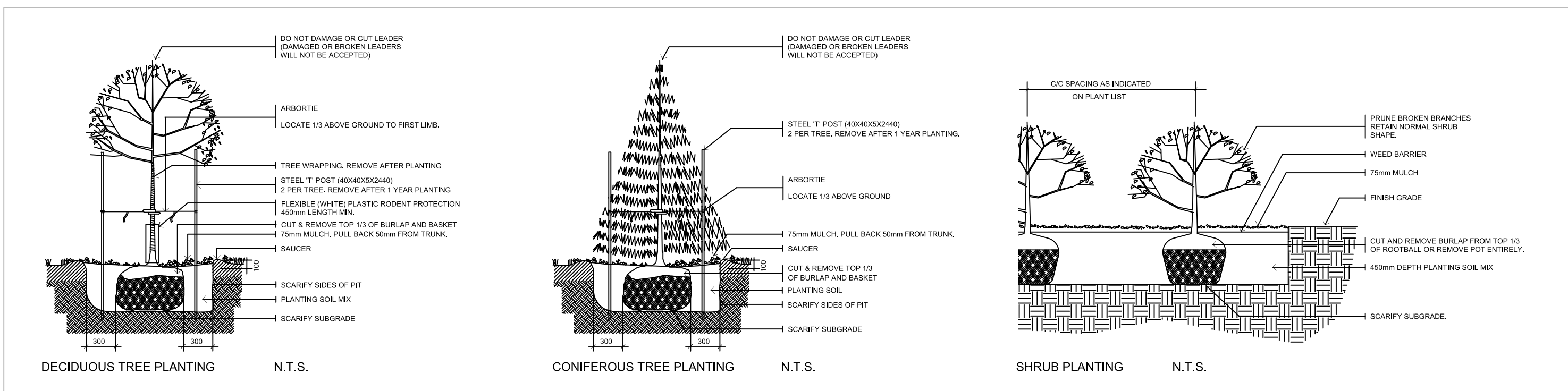

1 L2.01 PLANTING DETAILS (TYPICAL) NTS

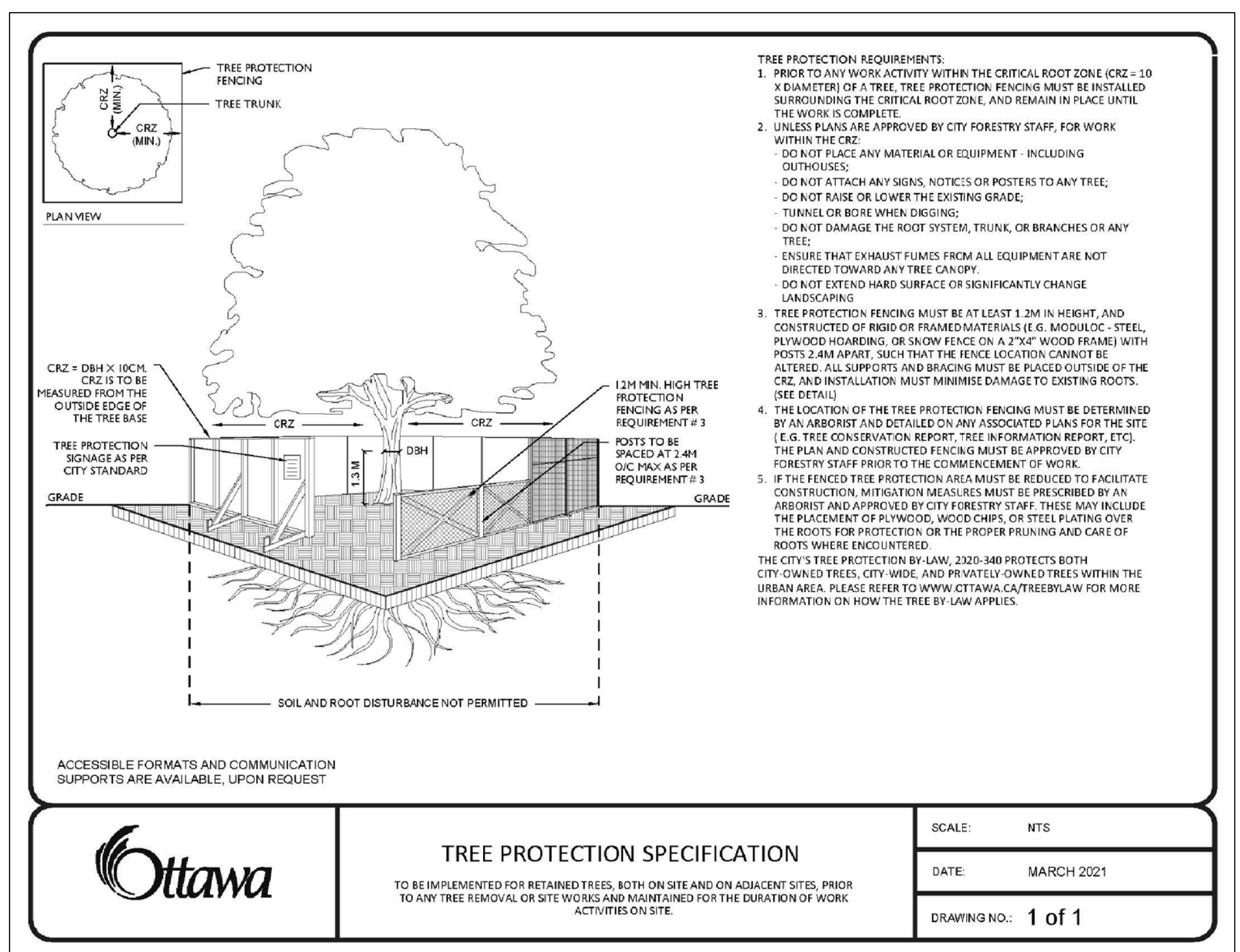

2 L2.01 TREE PROTECTION BARRIER NTS

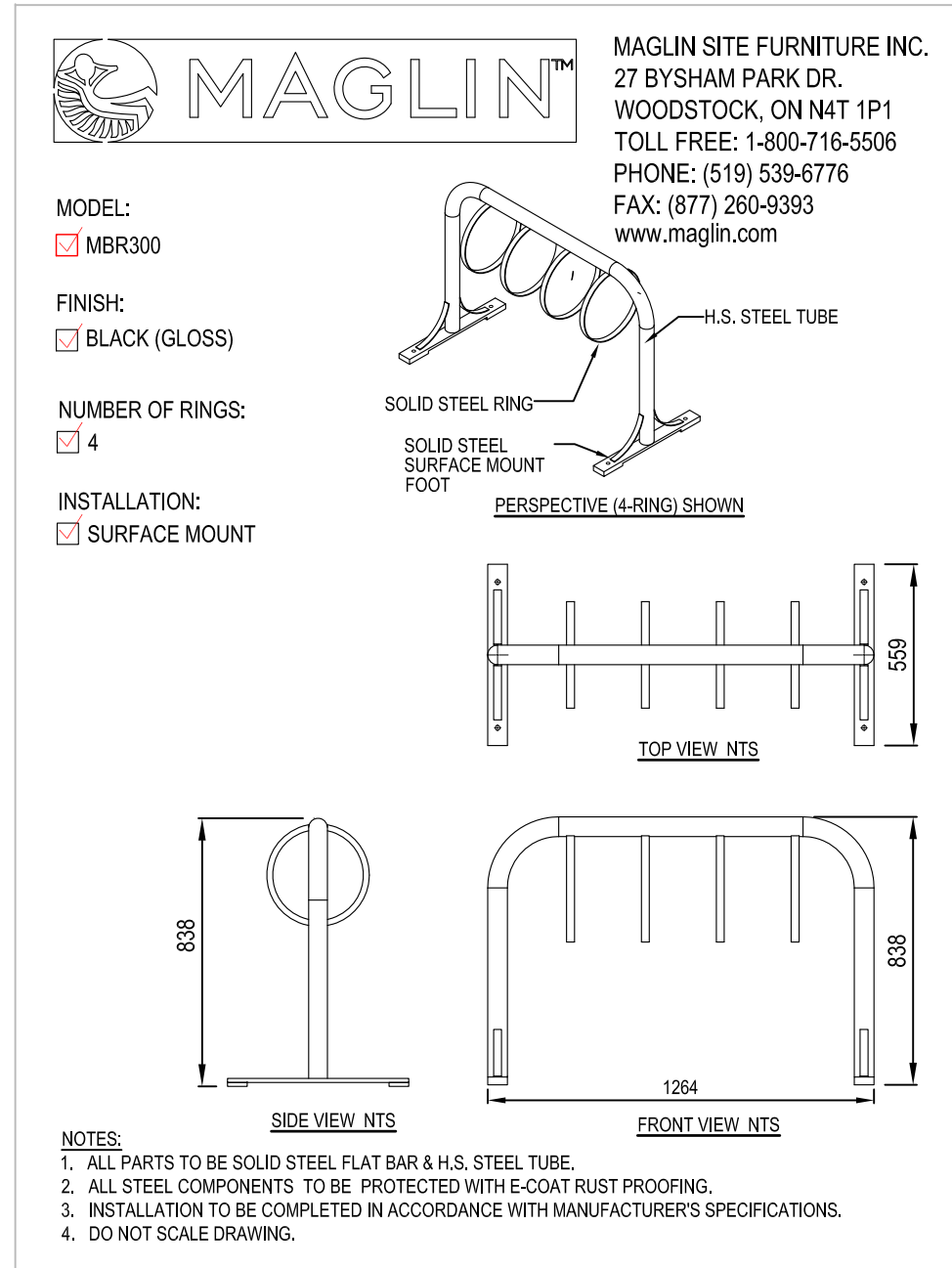

3 L2.01 BICYCLE RACK - 4-RING NTS

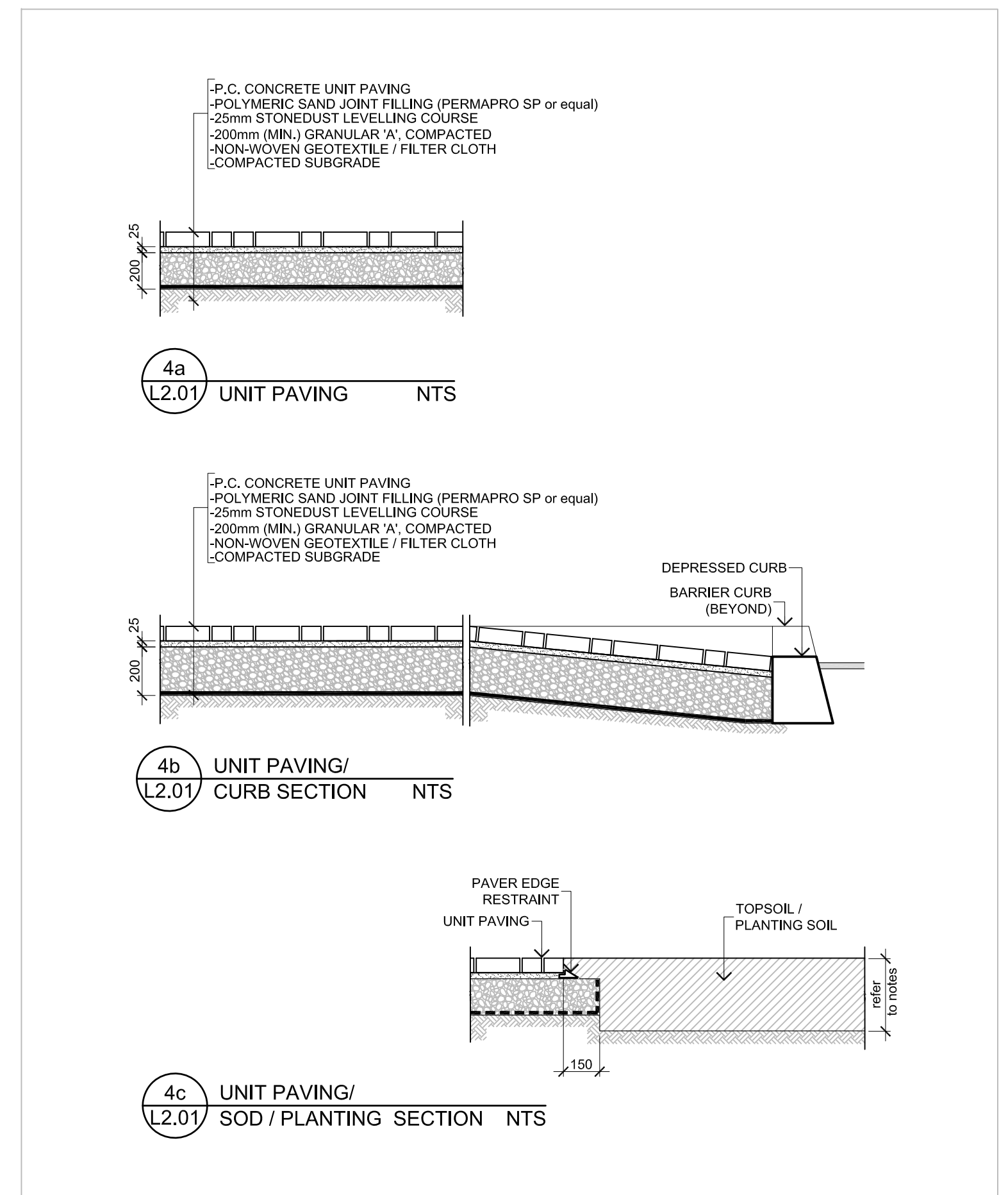

4 L2.01 UNIT PAVING DETAILS NTS

FOR APPROVAL ONLY

no.	date	revision
5.	FEB.4/22	PER CITY COMMENTS (1)
4.	DEC.16/21	ISSUE FOR 90% DESIGN SUBMISSION
3.	NOV.18/21	ISSUE FOR 60% DESIGN SUBMISSION
2.	OCT.28/21	ISSUE FOR SPA
1.	OCT.19/21	ISSUE FOR SPA REVIEW/COORDINATION

Contractor shall check and verify all dimensions on site and report all errors and/or omissions to the Consultant.  
 Work to be done in accordance with all applicable codes and by-laws.  
 Do not scale Drawing.  
 This Drawing shall not be used for construction until signed by the Consultant.  
 Copyright reserved. This Drawing is the exclusive property of Levstek Consultants Inc. and shall not be used without consent.

Consultant  
**LEVSTEK CONSULTANTS**  
 L A N D S C A P E A R C H I T E C T S  
 5871 Hugh Crescent, Ottawa, Ontario, K2A 2W9  
 613 - 826 - 0518

Client  
**TAGGART REALTY MANAGEMENT**  
 225 METCALFE ST. SUITE 708  
 OTTAWA, ONTARIO

Project  
**CROWN POINTE PHASE 3**  
**900 WATTERS ROAD**

Drawing Title  
**LANDSCAPE DETAILS**

Drawn: MGB Date: SEPT 2021 Drawing No.:  
 Scale: AS NOTED Project No.: 1149 L2.01

D07-12-21-0183