

- GENERAL NOTES**
- This drawing shall be read in conjunction with all relevant Architectural, Engineering and related Drawings and Documents. Refer to Engineering Drawings for Grading and Servicing.
  - Refer to Architectural Drawings for Site layout.
  - Contractor shall provide the location(s) of all services/utilities by consulting Municipal Authorities and Utility companies and shall be responsible for adequate protection from damage during construction.
  - Plant material shall be No. 1 Grade and shall comply with the Metric Guide Specifications For Nursery Stock (latest edition), published by the Canadian Nursery Trades Association.
  - Plant Material locations are Schematic / Approximate only. Contractor shall stake out locations on site prior to work.
  - Contractor shall guarantee all plant material for a period of one (1) full year from the date of final acceptance.
  - Shrubs shall be planted in a continuous prepared bed of 450mm depth planting soil mix covered over with a woven polypropylene weed control fabric (LANDSCAPE FABRIC-Green-Line by Trace-LiNQ) and 75mm depth composted pine mulch to finish grade, as specified.
  - Perennials and Ornamental Grasses shall be planted in a continuous prepared bed of 450mm depth planting soil mix covered over with 75mm depth composted pine mulch to finish grade (NO WEED CONTROL FABRIC), as specified.
  - Soil areas to receive 125mm topsoil. Sod shall be No. 1 quality conforming to the Canadian Nursery Sod Growers Specification.
  - Reinstatement all areas damaged or disturbed beyond the limit of Work.
  - Plant Material substitutions shall not be permitted without written approval from the Consultant.
  - Contractor shall advise Consultant a minimum of 48hrs. prior to proceeding landscape work and any required Field Reviews.
  - THIS PLAN HAS BEEN PREPARED FOR MUNICIPAL SITE PLAN APPROVAL ONLY AND MAY NOT BE USED FOR ANY OTHER PURPOSE.**

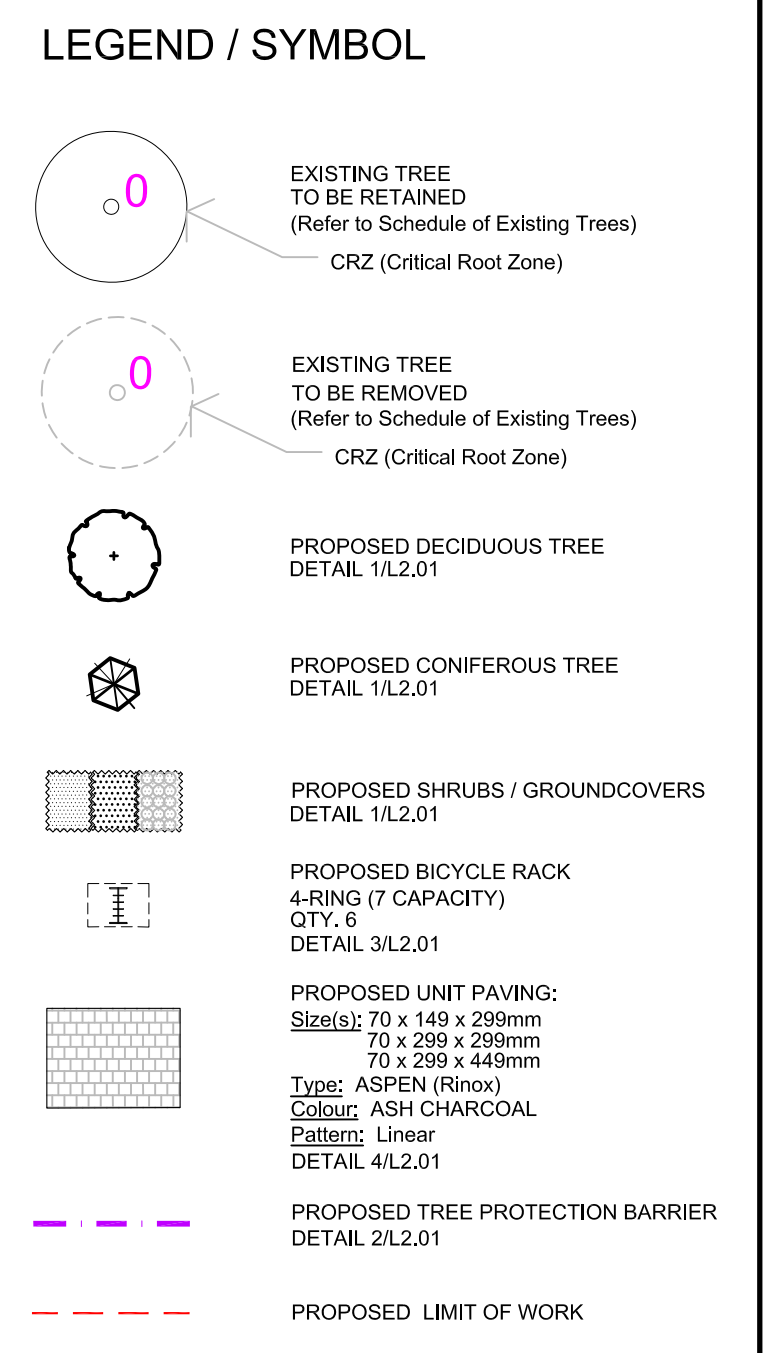
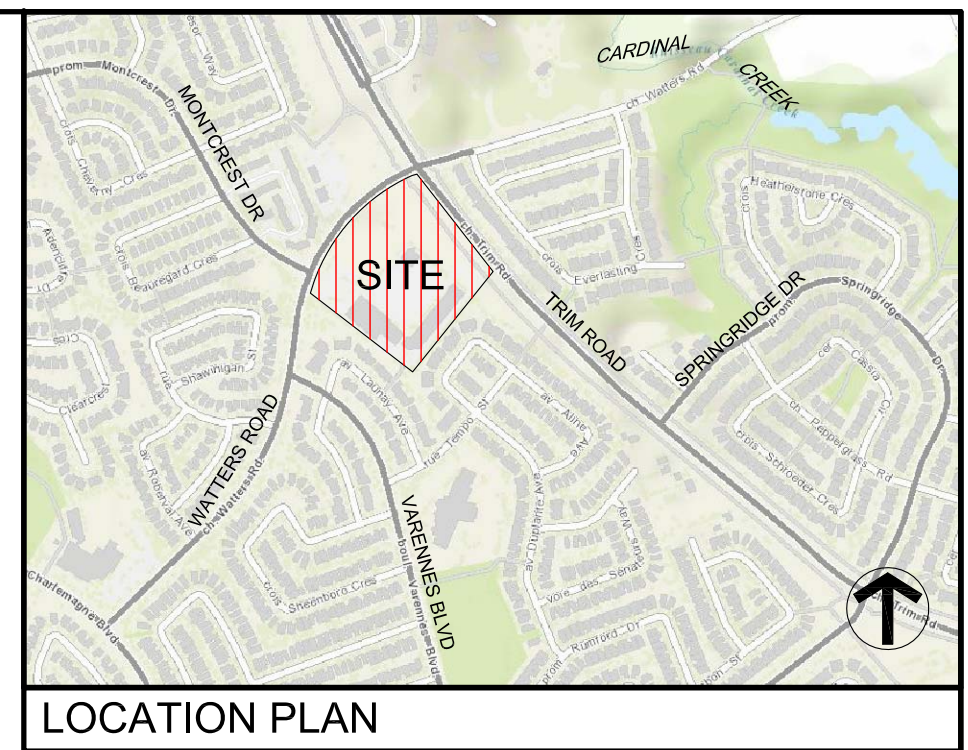

**PLANT MATERIAL SCHEDULE**

CODE	BOTANICAL NAME	COMMON NAME	QTY.	SIZE	REMARKS
<b>DECIDUOUS TREES</b>					
AC	AMELANCHIER CANADENSIS	SHADBLOW SERVICEBERRY	6	50mm cal	B&B, Single Stem
AFJ	ACER x FREEMANT JEFFERSRED	AUTUMN BLUE MAPLE	6	50mm cal	B&B, Single Stem
AR	ACER RUBRUM	RED MAPLE	3	50mm cal	B&B, Single Stem
CO	CELTIS OCCIDENTALIS	COMMON HACKBERRY	3	50mm cal	B&B, Single Stem
GBP	GINKGO BILOBA PRINCEPTON SENTRY	PRINCEPTON SENTRY MAIDENHAIR TREE	2	50mm cal	B&B, Single Stem
QM	QUERCUS MACROCARPA	BURK OAK	6	50mm cal	B&B, Single Stem
QR	QUERCUS RUBRA	RED OAK	7	50mm cal	B&B, Single Stem
SR	SYRINGA RETICULATA IVORY SILK	IVORY SILK JAPANESE TREE LILAC	3	50mm cal	B&B, Single Stem
<b>CONIFEROUS TREES</b>					
PG	PICEA GLAUCA	WHITE SPRUCE	12	200 cm ht	B&B
PN	PINUS NIGRA	AUSTRAL PINE	3	200 cm ht	B&B
PP	PICEA PUGENSIS	COLORADO GREEN SPRUCE	3	200 cm ht	B&B
<b>DECIDUOUS SHRUBS</b>					
CAR	CORNUS ALTERNIFOLIA	PAGODA DOGWOOD	3	150cm ht	B&B, multi-stem
CAS	CORNUS ALBA ARGENTEO-MARGINATA	SILVERLEAF DOGWOOD	74	90cm ht	potted, 100cm o/c
CK	CORNUS SERICEA 'KELSEY'	KELSEY RED OSIER DOGWOOD	9	50cm ht	potted, 80cm o/c
CR	CORNUS RACEMOSA	GRAY DOGWOOD	10	50cm ht	potted, 100cm o/c
CS	CORNUS SERICEA	RED OSIER DOGWOOD	70	50cm ht	potted, 100cm o/c
HAA	HYDRANGEA ARBORESCENS	ANNABELLE HYDRANGEA	60	50cm ht	potted, 100cm o/c
HPG	HYDRANGEA PANICULATA	PEE GEE HYDRANGEA	190	50cm ht	potted, 100cm o/c
PFA	POTENTILLA FRUTICOSA	ABBOTT'S WOOD CINQUEFOIL	106	50cm ht	potted, 80cm o/c
PO	PHYSCALOPUS OPULIFOLIUS	COMMON NINEBARK	46	50cm ht	potted, 100cm o/c
RAu	RIBES AUREUM	FLOWERING CURRANT	102	50cm ht	potted, 100cm o/c
RB	ROSA BLANDA	SHRUB ROSE	116	50cm ht	potted, 100cm o/c
VD	VIBURNUM DENTATUM	ARROWWOOD	62	50cm ht	potted, 100cm o/c
WFP	WEIGELA FLORIDA PINK PRINCESS	PINK PRINCESS WEIGELA	30	50cm ht	potted, 100cm o/c
<b>CONIFEROUS SHRUBS</b>					
JSW	JUNIPUS SCOPULORUM	WICHITA BLUE JUNIPER	36	100cm ht	potted, 100cm o/c
PN	PINUS MUGO MUGHUS	MUGHO PINE	20	50cm ht	potted, 100cm o/c
<b>PERENNIALS</b>					
Ech	ECHINACEA pallida	PALE PURPLE CONEFLOWER	160	15 cm pot	plant 60cm o/c
Sst	SALVIA nemorosa 'May Light'	MAY LIGHT MEADOW SAGE	86	15 cm pot	plant 60cm o/c
<b>ORNAMENTAL GRASSES</b>					
Cal	CALAMAGROSTIS x acutiflora 'Karl Foerster'	KARL FOERSTER REED GRASS	326	15cm pot	plant 75cm o/c
Pv	PANICUM virgatum	SWITCH GRASS	95	15cm pot	plant 75cm o/c
Spo	SPOROBOLUS heterolepis	PRAIRIE DROPSEED	82	15cm pot	plant 75cm o/c

**SCHEDULE OF EXISTING TREES**  
(Inventory conducted Sept. 24, 2021)

CODE	SPECIES	CONDITION	DBH <sup>1</sup> (cm)	OWNERSHIP	ACTION NOTES
1	Honeylocust	good	22	Private (Owner)	RETAIN / PROTECT
2	Honeylocust	good	18	Private (Owner)	RETAIN / PROTECT
3	Honeylocust	good	25	Private (Owner)	REMOVE / Development conflict.
4	Poplar	good	40	Private (Owner)	REMOVE / Development conflict.
5	Poplar	good	30	Private (Owner)	REMOVE / Development conflict.
6	Honeylocust	poor	7	Private (Owner)	REMOVE / Development conflict.
7	Honeylocust	good	6	Private (Owner)	REMOVE / Development conflict.
8	Honeylocust	good	7	Private (Owner)	REMOVE / Development conflict.
9	Honeylocust	good	7	Private (Owner)	REMOVE / Development conflict.
10	Maple	good	6	City ROW	RETAIN / PROTECT
11	Honeylocust	good	7	City ROW	RETAIN / PROTECT
12	Maidenhair Tree	good	7	City ROW	RETAIN / PROTECT
13	Oak	good	7	City ROW	RETAIN / PROTECT
14	Honeylocust	good	15	Private (Owner)	REMOVE / Development conflict.
15	Honeylocust	good	13	Private (Owner)	REMOVE / Development conflict.
16	Schubert Chokecherry	poor	13	Private (Owner)	REMOVE / Development conflict.
17	Honeylocust	good	13	Private (Owner)	REMOVE / Development conflict.
18	Hackberry	good	15	Private (Owner)	REMOVE / Development conflict.
19	Hackberry	good	16	Private (Owner)	REMOVE / Development conflict.
20	Hackberry	good	16	Private (Owner)	REMOVE / Development conflict.
21	Hackberry	good	18	Private (Owner)	REMOVE / Development conflict.
22	Honeylocust	good	10	Private (Owner)	REMOVE / Development conflict.
23	Honeylocust	good	9	Private (Owner)	REMOVE / Development conflict.
24	Honeylocust	good	9	Private (Owner)	REMOVE / Development conflict.
25	Honeylocust	good	9	Private (Owner)	REMOVE / Development conflict.
26	Hackberry	good	15	Private (Owner)	REMOVE / Development conflict.
27	Hackberry	good	16	Private (Owner)	REMOVE / Development conflict.
28	Hackberry	good	13	Private (Owner)	REMOVE / Development conflict.
29	Hackberry	good	15	Private (Owner)	REMOVE / Development conflict.
30	Hackberry	good	16	Private (Owner)	RETAIN / PROTECT
31	Hackberry	good	15	Private (Owner)	RETAIN / PROTECT
32	Hackberry	good	15	Private (Owner)	RETAIN / PROTECT
33	Maidenhair Tree	good	6	Private (Owner)	RETAIN / PROTECT
34	Oak	good	6	Private (Owner)	RETAIN / PROTECT
35	unknown	dead	4	Private (Owner)	REMOVE;
36	unknown	dead	4	Private (Owner)	REMOVE;
37	Maidenhair Tree	poor	5	Private (Owner)	RETAIN / PROTECT

**NOTE:**

- No tree species at risk, as identified under the Province of Ontario Endangered Species Act (ESA), were found on subject property or within 25m of adjacent properties.
- In conformance to the guidelines outlined in the City of Ottawa Protocol for Wildlife Protection During Construction, no clearing of vegetation shall occur between April 15 and August 15, unless a qualified biologist has determined that no bird nesting is occurring within 5 days prior to clearing. A pre-clearing survey for active stick nests and cavity nests shall also be conducted between April 1 and April 15 in order to identify and protect early nesting owls and raptors.

**FOR APPROVAL ONLY**

no.	date	revision
7.	APR.7/22	ALTERNATE PEDESTRIAN ROUTE
6.	FEB.20/22	1FT
5.	FEB.4/22	PER CITY COMMENTS (1)
4.	DEC.16/21	ISSUE FOR 90% DESIGN SUBMISSION
3.	NOV.19/21	ISSUE FOR 60% DESIGN SUBMISSION
2.	OCT.28/21	ISSUE FOR SPA
1.	OCT.20/21	ISSUE FOR SPA REVIEW/COORDINATION

Contractor shall check and verify all dimensions on site and report all errors and/or omissions to the Consultant.  
Work to be done in accordance with all applicable codes and by-laws.  
Do not scale Drawing.  
This Drawing shall not be used for construction until signed by the Consultant.  
Copyright reserved. This Drawing is the exclusive property of Levstek Consultants Inc. and shall not be used without consent.

Consultant  
**LEVSTEK CONSULTANTS**  
LANDSCAPE ARCHITECTS  
5871 High Crescent, Ottawa, Ontario K2A 3W6  
613.828.9188

Client  
**TAGGART REALTY MANAGEMENT**  
225 METCALFE ST. SUITE 708  
OTTAWA, ONTARIO

Project  
**CROWN POINTE PHASE 3**  
900 WATERS ROAD

Drawing Title  
**LANDSCAPE / TCR PLAN**

Drawn: MGB Date: SEPT 2021 Drawing No.: L1.01  
Scale: 1:400 Project No.: 1149

*G. Wildman*  
**APPROVED**  
By wildmange at 12:54 pm, May 23, 2022

**GERALDINE WILDMAN**  
ACTING MANAGER, DEVELOPMENT REVIEW EAST PLANNING, REAL ESTATE & ECONOMIC DEVELOPMENT DEPARTMENT, CITY OF OTTAWA

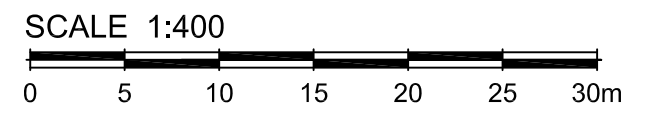

D07-12-21-0183

#18633