

NOTE:
THE POSITION OF ALL POLE LINES, CONDUITS,
WATERMAINS, SEWERS AND OTHER
UNDERGROUND AND OVERGROUND UTILITIES AND
STRUCTURES IS NOT NECESSARILY SHOWN ON
THE CONTRACT DRAWINGS, AND WHERE SHOWN,
THE ACCURACY OF THE POSITION OF SUCH
UTILITIES AND STRUCTURES IS NOT GUARANTEED.
BEFORE STARTING WORK, DETERMINE THE EXACT
LOCATION OF ALL SUCH UTILITIES AND
STRUCTURES AND ASSUME ALL LIABILITY FOR
DAMAGE TO THEM.

NOT FOR
CONSTRUCTION

SOIL VOLUME CALCULATIONS

Planting Area No.	Available Soil Area (sq m)	Available Soil Depth (m)	Available Soil Volume (cu m)	No. of Proposed Trees				Total No. of trees	Min. required Soil Volume total (cu m)
				Small 20m ² or 12m ²	Medium 25m ² or 15m ²	Large 30m ² or 18m ²	Evergreen 25m ² or 15m ²		
Planting Area 1	36.69	0.60	22.01	1	0	0	0	1	20m ²
Planting Area 2	35.85	0.60	21.51	1	0	0	0	1	20m ²
Planting Area 3	69.81	0.60	41.89	0	0	1	0	1	30m ²
Planting Area 4	52.14	0.60	31.28	2	0	0	0	2	24m ²

PROPOSED CANOPY COVERAGE AT MATURITY CALCULATION

SIZE OF PROPOSED TREE	AVERAGE MATURE SPREAD	CANOPY COVERAGE PER TREE AT MATURITY (m ²)	QUANTITY OF TREES	TOTAL PROPOSED CANOPY COVERAGE AT MATURITY (m ²)
Deciduous - Small (less than 6m Ht)	5.0m	20	4	78
Deciduous - Medium (6m to 14m Ht)	11m	95	0	0
Deciduous - Large (15m+ Ht)	14m	154	30	4620
TOTAL PROPOSED CANOPY COVERAGE (m ²):				4698

1. Area of a circle = $(\pi \times r^2) \times \pi$
2. Canopy coverage per tree calculation: (average mature spread/2) x (average mature spread/2) x π

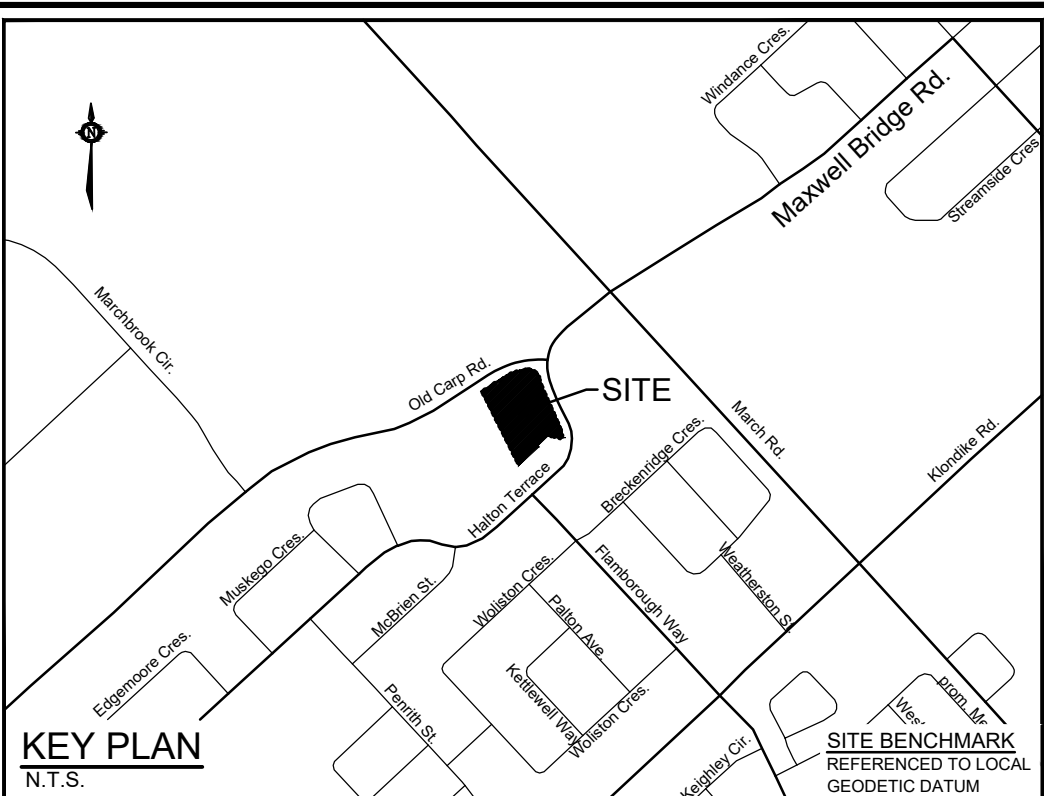
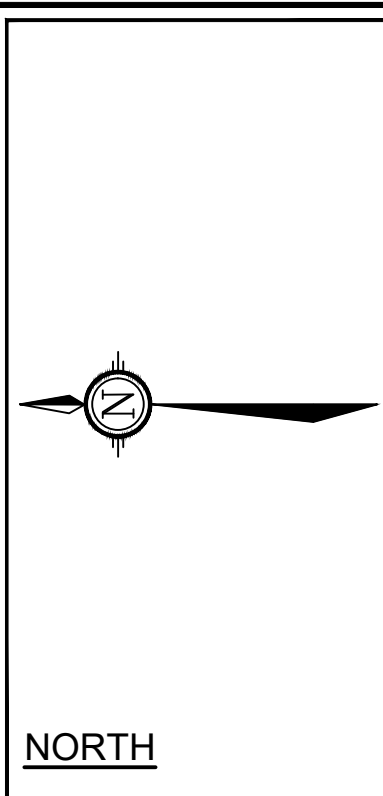

LEGEND

- PROPERTY LIMIT
- PROPOSED PAVERS
- PEA STONE
- RIVER STONE
- PROPOSED PERENNIALS/SHRUBS
- ORNAMENTAL GRASSES
- DECIDUOUS TREE
- SPECIES (SEE PLANT LIST)
- QUANTITY
- OVERHANG
- RETAINING WALL
- BOULDERS RETAINED FROM SITE EXCAVATION. SEE BOULDER NOTE ON SHEET L2
- WOOD PRIVACY FENCE
- TREE PROTECTION FENCE
- SITE FURNISHINGS, SEE SHEET L2 FOR INFORMATION

SOIL VOLUME CALCULATIONS

This plan has trees proposed in some areas where the soil volume may be questionable. In these instances the soil volumes have been calculated and reviewed to determine an appropriate size of tree. Other trees are proposed in open areas with extensive soil volumes available on the site and/or on adjacent properties.

Note that some bedrock removal will likely be required on the west side of the site. In such cases a minimum soil depth of 600mm is to be provided. Bedrock removal is unlikely to be required on the east side of the site. Imported topsoil is to be consolidated in place to avoid excessive settlement over time.

PLANT LIST

KEY	QTY	BOTANICAL NAME	COMMON NAME	SIZE	COND	SPACING
Deciduous Trees						
AFAP	5	Acer x freemanii 'Autumn Fantasy'	Autumn Fantasy Maple	50mm Cal	WB	As Shown
ARA	9	Acer rubrum 'Armstrong'	Armstrong Red Maple	50mm Cal	WB	As Shown
AC	4	Amelanchier canadensis (Single stem)	Shadblow Serviceberry	45mm Cal	WB	As Shown
CO	6	Celtis occidentalis	Hackberry	50mm Cal	WB	As Shown
GBP	3	Ginkgo biloba 'Princeton Sentry'	Princeton Sentry Ginkgo	50mm Cal	WB	As Shown
GTS	4	Gleditsia triacanthos var. inermis 'Shademaster'	Shademaster Honeylocust	50mm Cal	WB	As Shown
QM	5	Quercus macrocarpa	Bur Oak	50mm Cal	WB	As Shown
Coniferous Shrubs						
lvb	61	Ilex verticillata 'Berry Poppins'	Berry Poppins Winterberry (Female)	2g	PT	150cm O.C.
lvb	14	Ilex verticillata 'Mr. Poppins'	Mr. Poppins Winterberry (Male)	2g	PT	150cm O.C.
Jcm	25	Juniperus chinensis 'Mountainbatten'	Mountainbatten Juniper	125cm Ht	PT	As Shown
Jpw	44	Juniperus horitz. 'Prince Of Wales'	Prince Of Wales Juniper	40cm Spr	PT	120 cm O.C.
Toe	4	Thuja occidentalis 'Smaragd'	Emerald Cedar	200cm Ht	PT	100cm O.C.
Deciduous Shrubs						
Csa	89	Cornus sericea 'Farrow'	Arctic Fire Dogwood	50cm Ht	PT	100cm O.C.
Csk	25	Cornus sericea 'Kelsey'	Kelsey Dogwood	40cm Ht	PT	100cm O.C.
Rt	17	Rhus typhina	Staghorn Sumac	50cm Ht	PT	150cm O.C.
Perennials/Vines						
ba	116	Baptisia australis	Blue False Indigo	1g	PT	70cm O.C.
gpr	106	Geranium 'Rozanne'	Rozanne Cranebill	1g	PT	80cm O.C.
hhr	105	Hemerocallis 'Happy Returns'	Happy Returns Daylily	1g	PT	60cm O.C.
Ornamental Grasses						
ckf	147	Calamagrostis acutiflora 'Karl Foerster'	Karl Foerster Feather Reed Grass	1g	PT	80cm O.C.
cpe	326	Carex pensylvanica	Pennsylvania Sedge	1g	PT	50cm O.C.
db	127	Deschampsia cespitosa 'Bronzeschleier'	Bronze Veil Tufted Hair Grass	1g	PT	80cm O.C.

SCALE

1:250

1:250

0 2 4 6 8 10

DESIGN

JK/KEW

CHECKED

RGJ

DRAWN

JK/KEW

CHECKED

RGJ

APPROVED

RGJ

FOR REVIEW ONLY



NOVATECH

Engineers, Planners & Landscape Architects
Suite 200, 240 Michael Copland Drive
Ottawa, Ontario, Canada K2M 1P6
Telephone (613) 254-9643
Facsimile (613) 254-5867
Website www.novatech-eng.com

LOCATION
CITY OF OTTAWA
1104 HALTON TERRACE

DRAWING NAME
LANDSCAPE PLAN

PROJECT No.

119024

REV

REV # 6

DRAWING No.

119024-L1

M:\2019\119024\CAD\Landscape\L-Plan\119024_L.dwg, L1 (landscape), Jul 18, 2025 - 11:58am, mlaet

118654

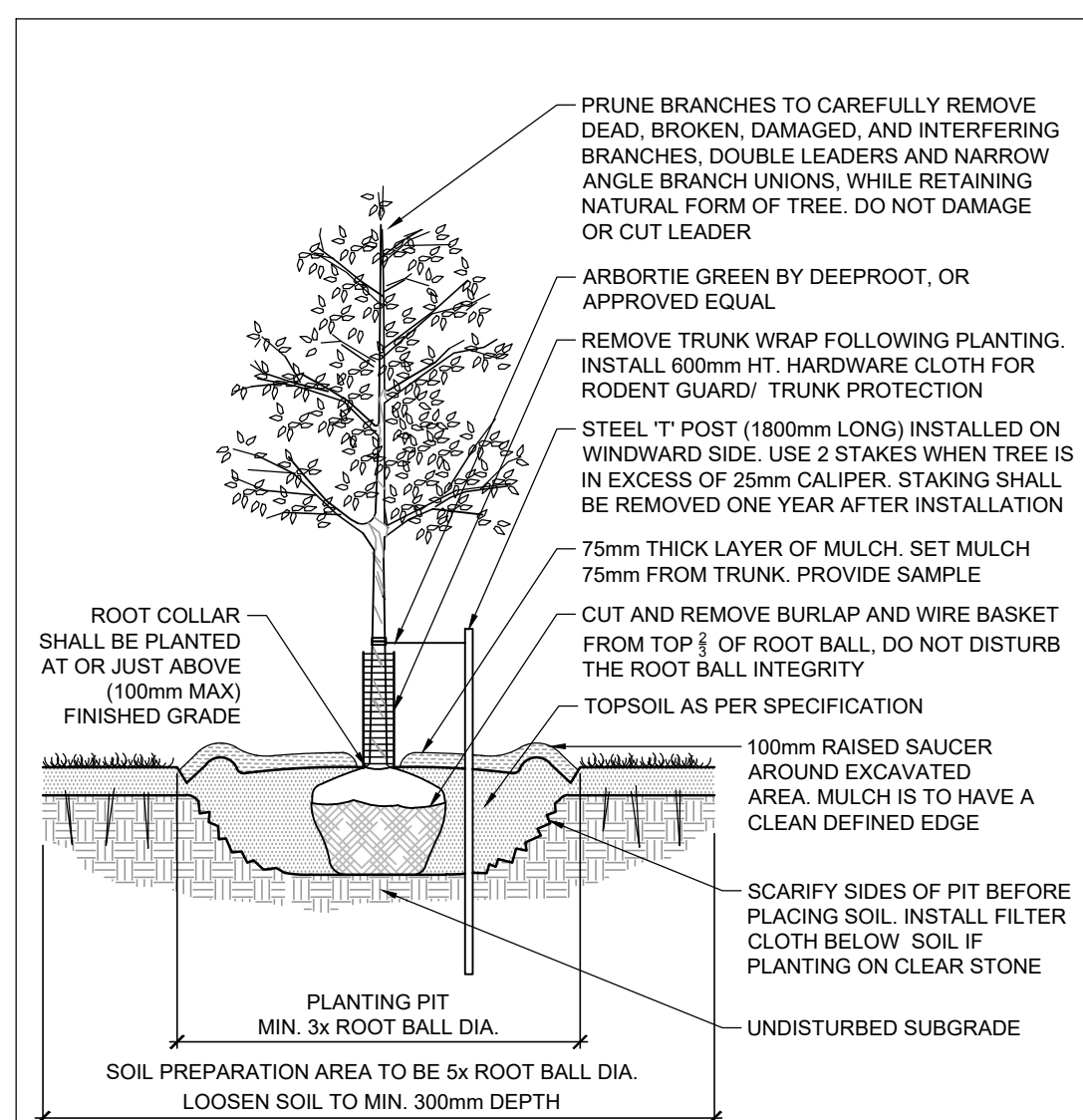

STANDARD DECIDUOUS TREE PLANTING

D1

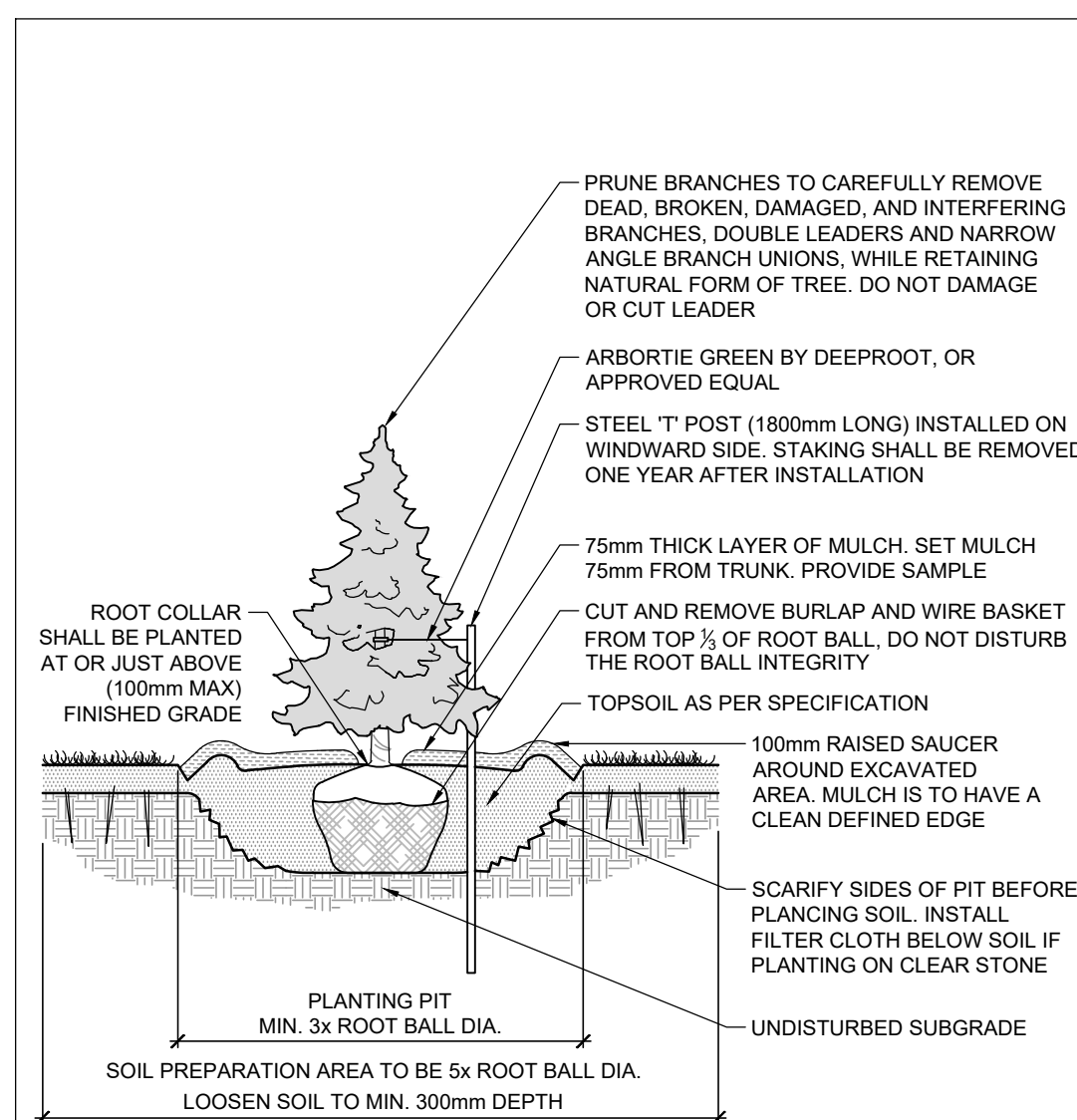

STANDARD CONIFEROUS TREE PLANTING

D2

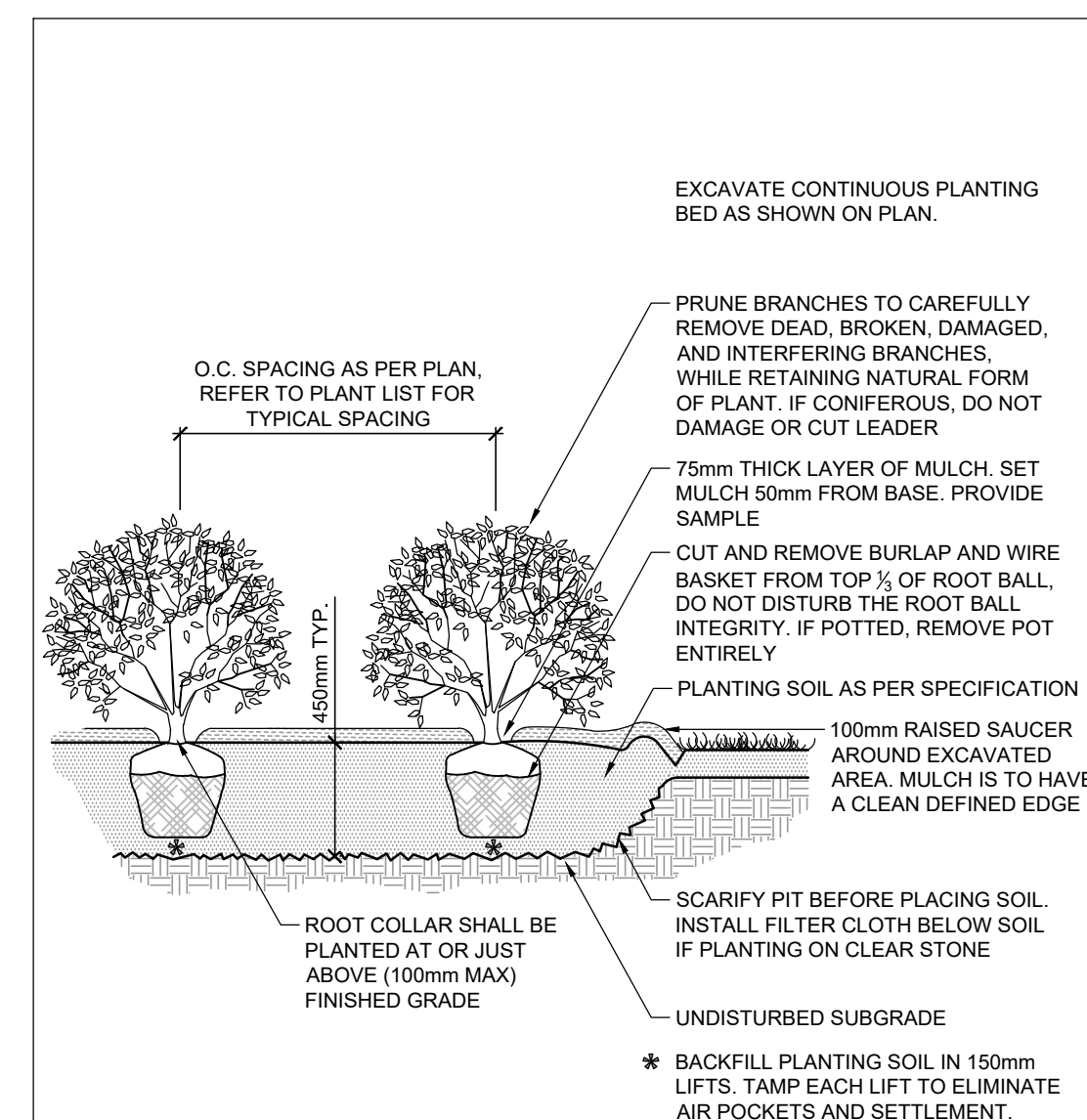

SHRUB AND PERENNIAL PLANTING

D3

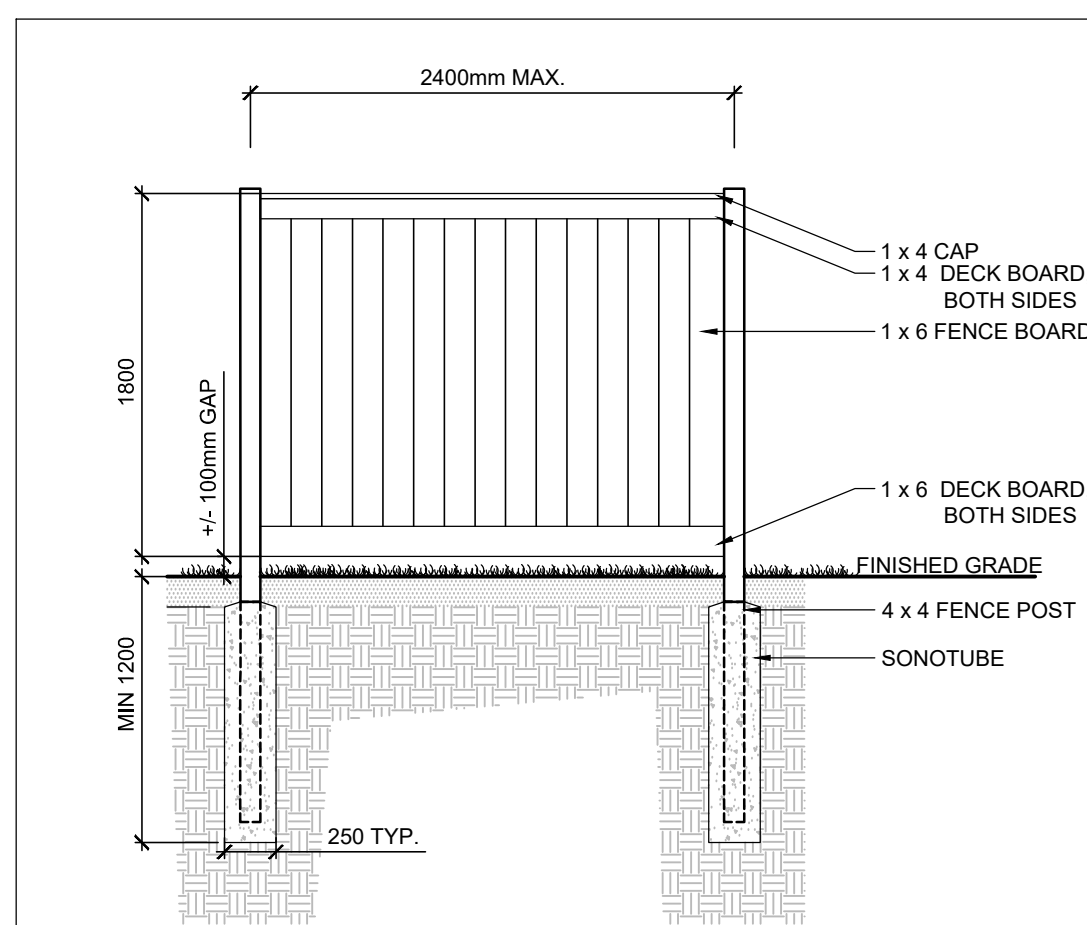

NOTE:

1. ALL WOOD TO BE PRESSURE TREATED SPF OR WESTERN RED CEDAR
2. FASTEN WOOD MEMBERS WITH GALVANIZED SCREWS.
3. ALL CONCRETE TO BE C1 EXPOSURE, 35MPa @28 DAYS, INCLUDING 5-8% AIR ENTRAINMENT.

WOOD SCREEN DETAIL

D4

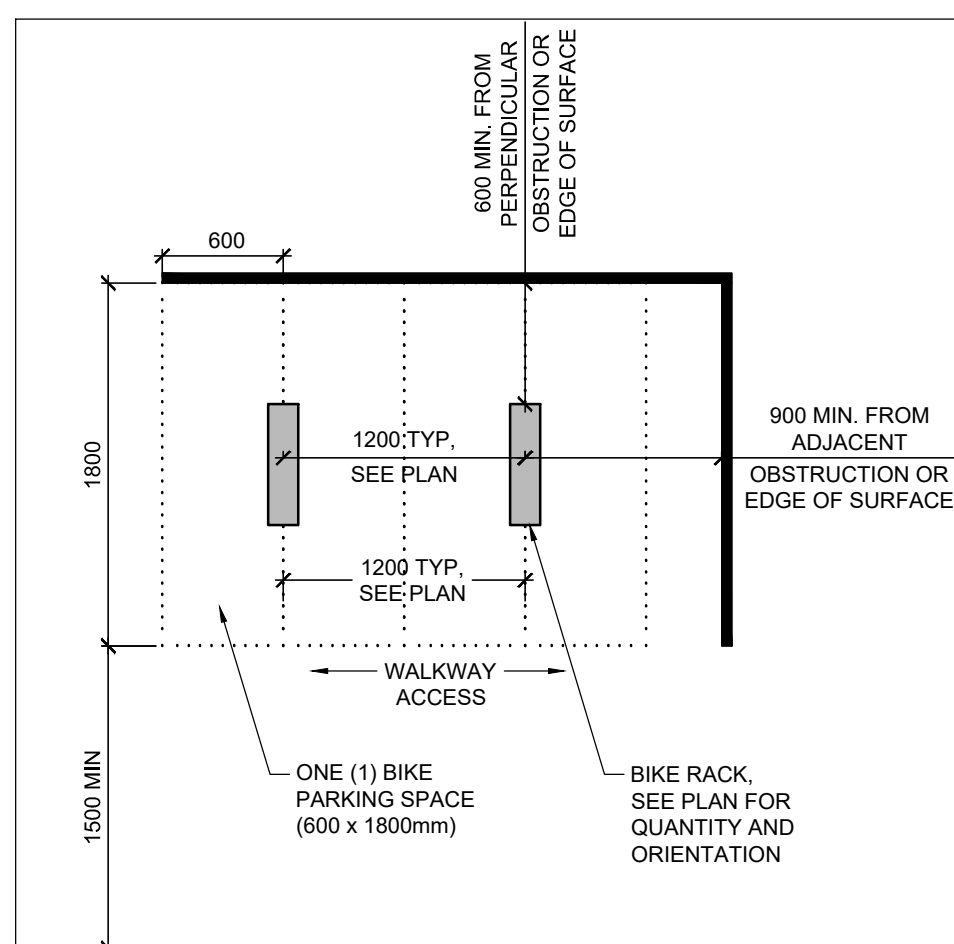

NOTE:

1. FASTEN ALL SITE FURNISHINGS TO SURFACE WITH STAINLESS STEEL ANTI-VANDAL ANCHORS.

BIKE LAYOUT

D5

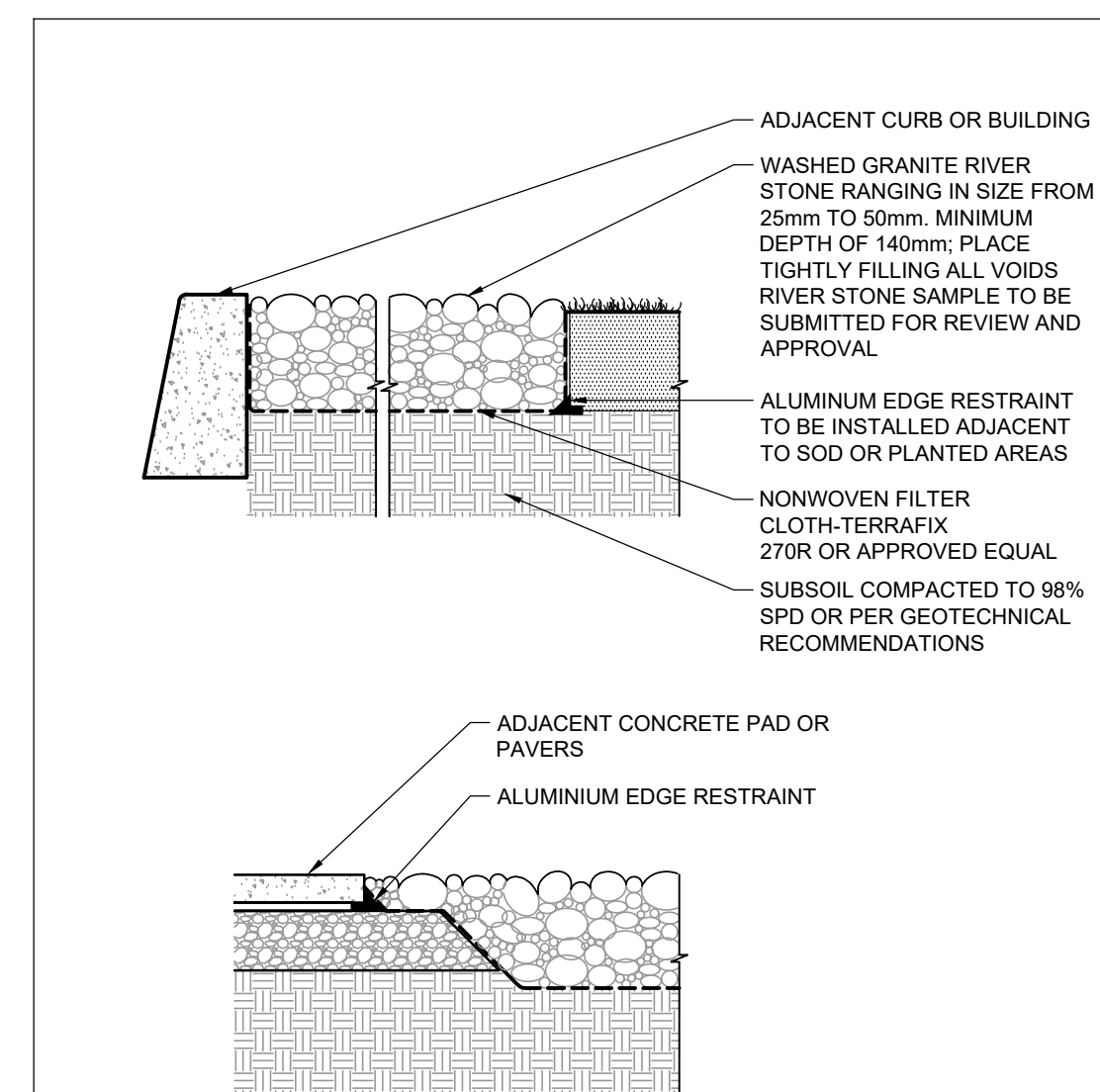

RIVER STONE

D6

PRODUCT INFORMATION

Install products as per manufacturer specifications. Shop drawings required.

PRECAST SITE FURNITURE

- GALET series by Ed's Concrete Products
Colour: Standard Precast Grey Smooth

PAVERS

Edge of pavers to receive edge restraint.

- Mega Melville Paver by Permacon
Size: 80mm x 570mm x 950mm
Pattern: Offset 1/3
Colour: Range Norvick Grey

BOULDERS

Boulders are to be retained from site excavation or grading works. Boulders should be a minimum of 600mm wide x 900mm long.

NOTE:
THE POSITION OF ALL POLE LINES, CONDUITS,
WATERMANS, SEWERS AND OTHER
UNDERGROUND AND OVERGROUND UTILITIES AND
STRUCTURES IS NOT NECESSARILY SHOWN ON
THE CONTRACT DRAWINGS, AND WHERE SHOWN,
THE ACCURACY OF THE POSITION OF SUCH
UTILITIES AND STRUCTURES IS NOT GUARANTEED.
BEFORE STARTING WORK, DETERMINE THE EXACT
LOCATION OF ALL SUCH UTILITIES AND
STRUCTURES AND ASSUME ALL LIABILITY FOR
DAMAGE TO THEM.

NOT FOR
CONSTRUCTION

				SCALE		DESIGN
						JK/KEW
6.	ISSUED FOR CITY SUBMISSION	JUL 18/25	RGJ			CHECKED
5.	ISSUED FOR CITY SUBMISSION	MAY 7/25	RGJ			RGJ
4.	ISSUED FOR CITY SUBMISSION	SEPT 19/24	RGJ			DRAWN
3.	ISSUED FOR CITY SUBMISSION	NOV 6/23	RGJ			JK/KEW
2.	ISSUED FOR SITE PLAN APPLICATION	OCT 18/21	RGJ			CHECKED
1.	ISSUED FOR CLIENT REVIEW	OCT 12/21	RGJ			RGJ
No.	REVISION	DATE	BY			APPROVED
						RGJ

FOR REVIEW ONLY



NOVATECH
Engineers, Planners & Landscape Architects
Suite 200, 240 Michael Cowpland Drive
Ottawa, Ontario, Canada K2M 1P6

Telephone (613) 254-9643
Facsimile (613) 254-5867
Website www.novatech-eng.com

LOCATION
CITY OF OTTAWA
1104 HALTON TERRACE

DRAWING NAME

LANDSCAPE DETAILS

PROJECT No.	
-------------	--

REV

REV # 6

REV # 0
DRAWING No.

119024-L2

PLANA1.DWG - 841mmx594mm
#10CF4

#18654

54 2 6 4 D07-12-21-0186