

LAYOUT NOTES:

- CONTRACTOR TO CONFIRM ALL DIMENSIONS AND REPORT ANY DISCREPANCIES TO CONTRACTOR ADMINISTRATOR PRIOR TO CONSTRUCTION
- LAYOUT TO BE APPROVED BY CONTRACT ADMINISTRATOR PRIOR TO ANY CONSTRUCTION OR REMOVALS
- ALL DIMENSIONS ARE IN METRIC UNLESS OTHERWISE NOTED
- CONTRACTOR IS RESPONSIBLE FOR ALL EXCAVATIONS, REMOVALS, DISPOSALS AND ROUGH GRADING AS REQUIRED TO CONSTRUCTION ALL WORKS AS SHOWN ON ALL PLANS, DETAILS AND SPECIFICATIONS
- LOCATION OF ALL UTILITIES SHOWN FOR ILLUSTRATION ONLY. CONTRACTOR MUST CONTACT ALL UTILITIES REGARDING RULES FOR WORKING IN THE AREA OF THE UTILITIES PRIOR TO COMMENCEMENT OF ANY WORK. CONTRACTOR MUST CONFIRM LOCATION OF ALL UTILITIES PRIOR TO CONSTRUCTION
- ALL EXISTING ROADS, SIDEWALKS, CURBS, FENCING, PAVING, SODDED AREAS, AND APPROACHES, ETC. TO REMAIN TO BE PROTECTED DURING CONSTRUCTION TO CONTRACT ADMINISTRATOR'S APPROVAL AT THE CONTRACTOR'S OWN COSTS.
- ALL EXISTING TREES, SHRUB BEDS, MULCH BEDS, AND SOD TO REMAIN TO BE PROTECTED DURING CONSTRUCTION. AREAS DAMAGED DURING CONSTRUCTION TO BE REPAIRED TO CONTRACT ADMINISTRATOR'S APPROVAL AT THE CONTRACTOR'S OWN COST.
- USE SPECIFIED BACKFILL IN ALL TRENCHES RUNNING BELOW ALL STRUCTURES, PAVING, WALKWAYS, ETC.
- FILL ALL HOLES AND LOW AREAS TO DESIGN SUBGRADE WITH COMPACTED FILL (SUITABLE TO SURFACE FINISH), FOR SODDED/PLANTED AREAS USE COMPACTED CLEAN EARTH FILL SUITABLE FOR PLANT GROWTH. FOR PAVED AREAS USE COMPACTED GRANULAR BASE.
- ALL TREES WITHIN OR IMMEDIATELY ADJACENT TO AREA OF WORK TO BE PROTECTED TO CITY OF OTTAWA TREE PROTECTION STANDARDS.

ACCESS PROPERTY DEVELOPMENTS

PROPOSED SELF-STORAGE

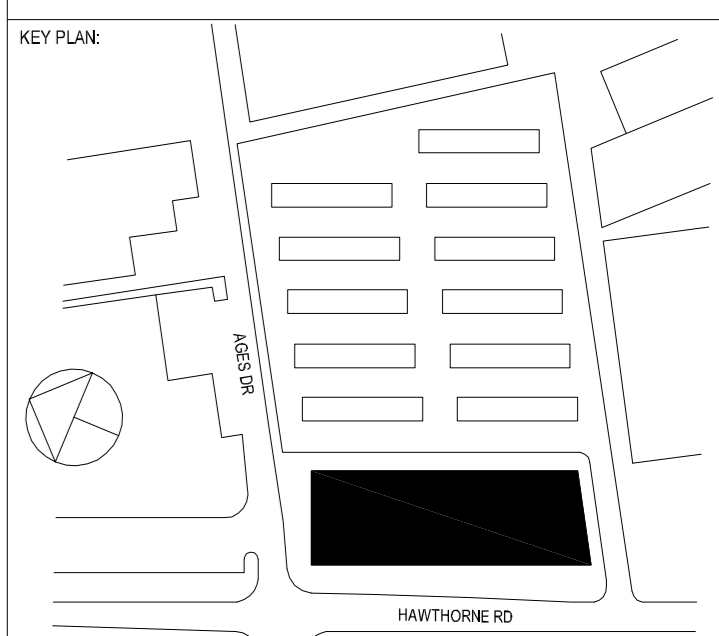

DISCLAIMER: THE DRAWING AND DESIGN IS COPYRIGHT PROTECTED WHICH SHALL NOT BE REPRODUCED OR REFERRED WITHOUT WRITTEN PERMISSION BY ARCHITECTURE 49. THE CONTRACTOR SHALL CHECK THE EXISTING UTILITIES AND FIELD CONDITIONS AND REPORT ALL ERRORS AND OMISSIONS PRIOR TO COMMENCING WORK. THE DRAWING IS NOT TO BE SCALED.

ISSUED FOR: REVIEWOR

DATE: 2021-09-13

ORIGINAL SCALE: As Indicated

DESIGNED BY: GML / NR

DRAWN BY: GML / NR

CHECKED BY: AH

DISCIPLINE: LANDSCAPE ARCHITECTURE

TITLE: PROPOSED LANDSCAPE PLAN

SHEET NUMBER: L101

ISSUE: ISSUED FOR DEVELOPMENT PERMIT

DATE OF: 2021-07-16

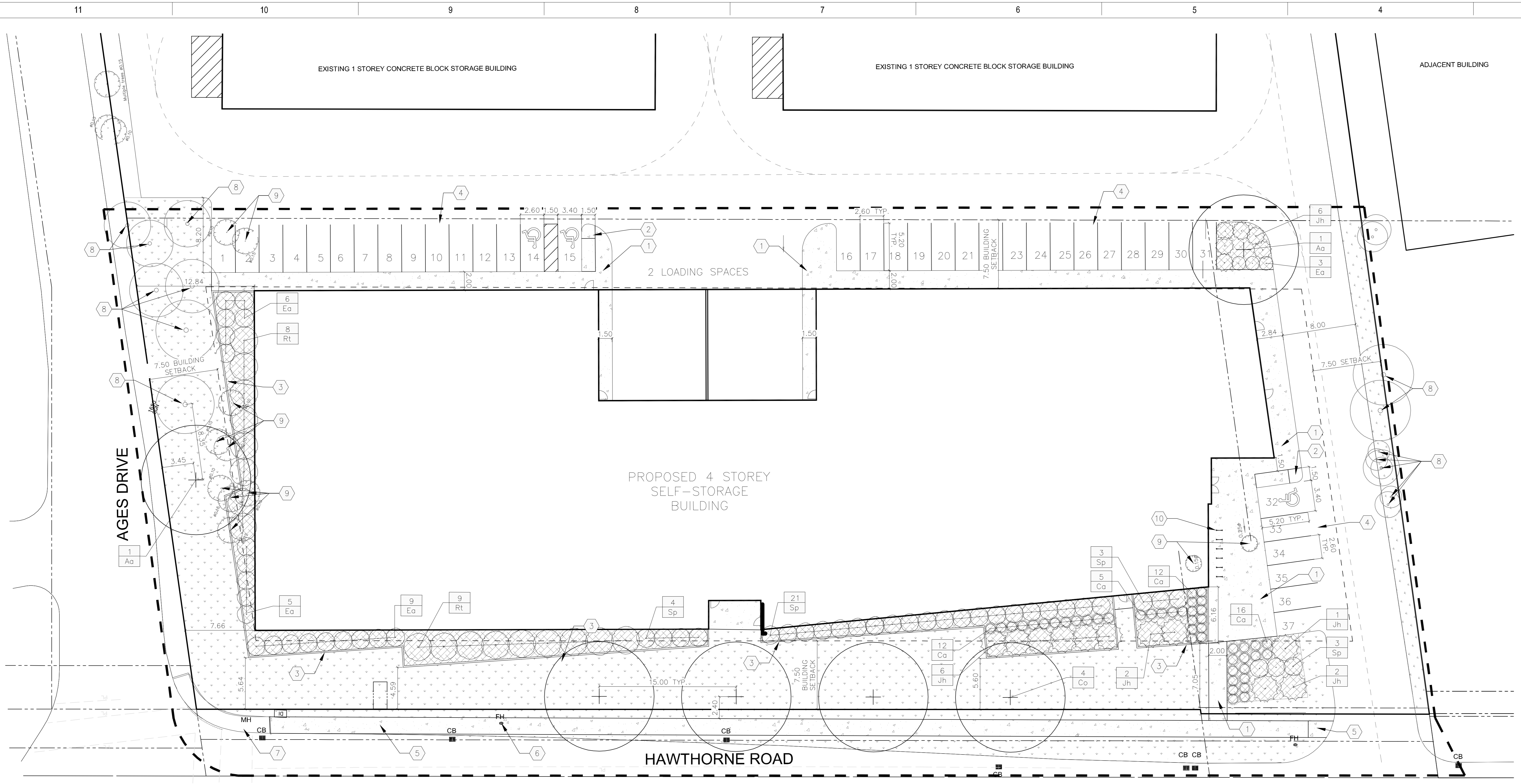

2 ENLARGEMENT: LANDSCAPE PLAN
L101 1:200

PROPOSED PLANT LIST

KEY	QUANTITY	BOTANICAL NAME	COMMON NAME	SPACING (mm) (75%)	SIZE	COMMENTS
TREES - Deciduous						
Co	4	Celtis occidentalis	Hackberry	as shown	65mm Cal. B&B	TREES TO BE BALL & BURLAP. SOURCED IN SAME GROWING ZONE. ALL TREES SHOULD HAVE 5 TO 7 MAIN BRANCHES WITH DOMINANT LEADER BRANCH AND WITHOUT DEFECT. MIN ROOT ZONE VOLUME PER TREE: 30 CU. M.
Aa	2	Amelanchier alnifolia	Serviceberry	as shown	50mm Cal. B&B	
SHRUBS - Deciduous						
Ea	23	Euonymus alatus 'Compactus'	Winged Burning Bush	900	5 gal.	SHRUBS TO BE IN POTS. SOURCED IN SAME GROWING ZONE. ALL SHRUBS SHOULD HAVE DENSE GROWTH, WELL ROOTED AND WITHOUT DEFECT. MIN ROOT ZONE VOLUME PER SHRUB: 5 CU. M.
Rt	17	Rhus typhina 'Bailliger'	Tiger Eyes Sumac	900	5 gal.	
Sp	31	Syringa patula 'Miss Kim'	Miss Kim Lilac	900	5 gal.	
SHRUBS - Coniferous						
Jh	17	Juniperus horizontalis 'Prince of Wales'	Prince of Wales Juniper	900	5 gal.	SHRUBS TO BE IN POTS. SOURCED IN SAME GROWING ZONE. ALL SHRUBS SHOULD HAVE DENSE GROWTH, WELL ROOTED AND WITHOUT DEFECT. MIN ROOT ZONE VOLUME PER SHRUB: 5 CU. M.
PERENNIALS/GROUDDCOVERS						
Ca	45	Calamagrostis acutiflora 'Karl Foerster'	Karl Foerster Feather Reed Grass	600	2 gal.	PERENNIALS TO BE IN POTS. SOURCED IN SAME GROWING ZONE. ALL SHRUBS SHOULD HAVE DENSE GROWTH, WELL ROOTED AND WITHOUT DEFECT.

LEGEND:

- TOPSOIL AND SOD
 - PLANT BED
 - CONCRETE SIDEWALK
 - PROPERTY LINE
 - APPROXIMATE AREA OF WORK
 - EXISTING CURB
 - NEW CURB
 - ACCESSIBLE PARKING STALL
 - PROPOSED DECIDUOUS TREE
 - EXISTING TREE TO REMAIN, TREES TO REMAIN ARE TO BE PROTECTED TO CITY OF OTTAWA STANDARDS
 - EXISTING TREE TO BE REMOVED
 - PROPOSED DECIDUOUS SHRUB
 - PROPOSED CONIFEROUS SHRUB
 - PROPOSED PERENNIAL GRASS
- PLANT KEY
- # - PLANT QUANTITY
 - Ps - PLANT SPECIES

KEYNOTES:

- CONCRETE SIDEWALK
- ACCESSIBLE RAMP WITH TACTILE WARNING SURFACE INDICATOR (TWSI)
- 150mm HT CONCRETE CURB
- ASPHALT PARKING LOT (37 STALLS, INCLUDING 1 TYPE A & 2 TYPE B ACCESSIBLE STALLS)
- NEW PUBLIC SIDEWALK c/w ACCESSIBLE RAMP TACTILE WARNING SURFACE INDICATOR (TWSI) TO CITY OF OTTAWA CONSTRUCTION STANDARDS
- EXISTING FIRE HYDRANT TO BE RELOCATED
- EXISTING CONCRETE SIDEWALK
- EXISTING TREE TO REMAIN
- EXISTING TREE TO BE REMOVED
- BICYCLE RACKS