

Copyright Reserved

The Contractor shall verify and be responsible for all dimensions. DO NOT scale the drawing - any errors or omissions shall be reported to Stantec without delay.
The Copyrights to all designs and drawings are the property of Stantec. Reproduction or use for any purpose other than that authorized by Stantec is forbidden.

Legend

- AREA ID
- RUNOFF COEFFICIENT
- STORM DRAINAGE AREA BOUNDARY
- DIRECTION OF OVERLAND FLOW
- DIRECTION OF EXISTING OVERLAND FLOW
- PROPOSED STORM SEWER
- PROPOSED CATCHBASIN MANHOLE
- PROPOSED CATCHBASIN
- CIRCULAR ORIFICE (SEE ICD TABLE ON SSP-1 AND SD-1)
- EXISTING STORM SEWER
- EXISTING CATCHBASIN
- THERMAL INSULATION ON STORM SEWER WHERE COVER IS LESS THAN 1.5m. THERMAL INSULATION ON WATERMAIN WHERE COVER IS LESS THAN 2.4m AS PER W22.
- MAXIMUM STATIC PONDING LIMITS
- 100YR. STATIC PONDING LIMITS

Notes

2	REVISED AS PER CITY COMMENTS	MJS	KJK	22.08.30
1	REVISED AS PER CITY COMMENTS	WAJ	KJK	22.06.03
0	ISSUED FOR SPA	MJS	TR	21.04.08

Revision	By	Appd.	YY.MM.DD
----------	----	-------	----------

File Name:	160401620 DB.dwg	MJS	KK	MJS	21.01.15
		Dwn.	Chkd.	Dgn.	YY.MM.DD

Permit-Seal

Client/Project
2441736 ONTARIO INC.
125 LUSK STREET, OTTAWA, ON, K2J 6S5
PHONE: 613-307-0412

BLOCK 10
HOME 2 - PROPOSED 6 STOREY
OTTAWA, ON, CANADA

Title
STORM DRAINAGE PLAN

Project No.	Scale	0	2.5	7.5	12.5m
160401620	1:250				

Drawing No.	Sheet	Revision
SD-1	6 of 7	2

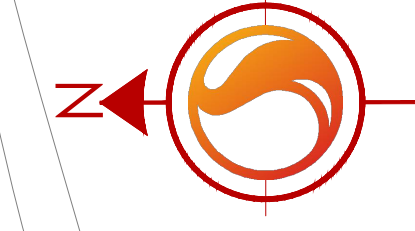
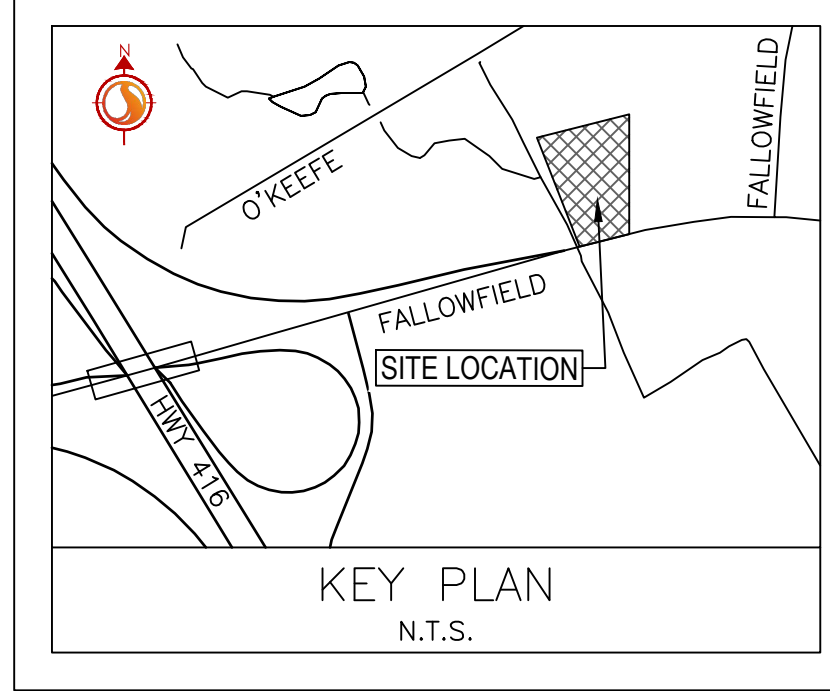
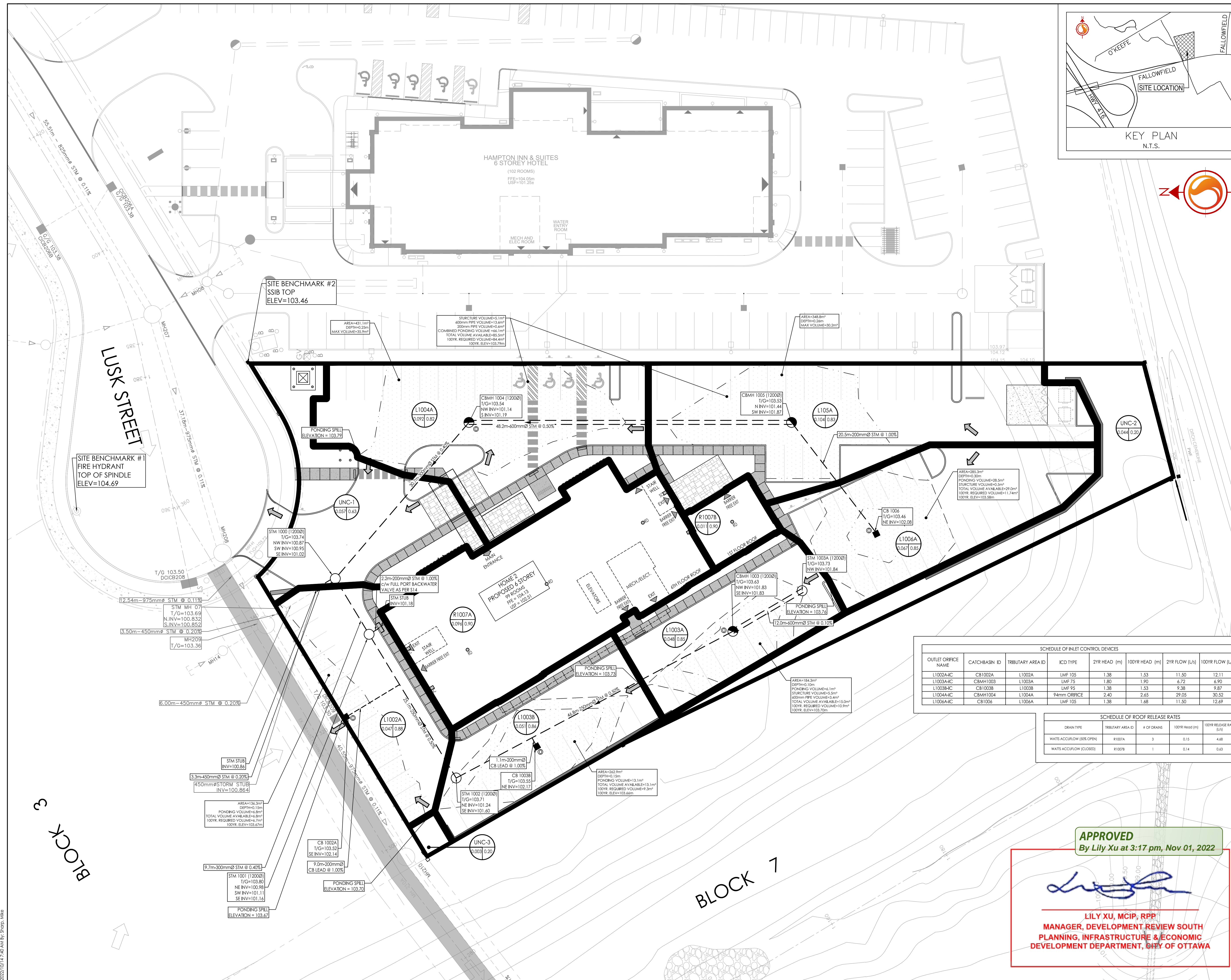

OUTLET ORIFICE NAME	CATCHBASIN ID	TRIBUTARY AREA ID	ICD TYPE	2YR HEAD (m)	100YR HEAD (m)	2YR FLOW (L/s)	100YR FLOW (L/s)
L1002A-C	CB1002A	L1002A	LMF 105	1.38	1.53	11.50	12.11
L1003A-C	CBM11003	L1003A	LMF 75	1.30	1.90	4.72	6.90
L1003B-C	CB1003B	L1003B	LMF 55	1.38	1.53	9.38	9.87
L1004A-C	CBMH1004	L1004A	94mm ORIFICE	2.40	2.65	29.05	30.52
L1006A-C	CB1006	L1006A	LMF 105	1.38	1.68	11.50	12.69

DRAIN TYPE	TRIBUTARY AREA ID	# OF DRAIN	100YR HEAD (m)	100YR RELEASE RATE (l/s)
WATS ACCURFLOW (ROOF OPEN)	R1007A	3	0.15	4.68
WATS ACCURFLOW (CLOSED)	R1007B	1	0.14	0.63

APPROVED
By Lily Xu at 3:17 pm, Nov 01, 2022

LILY XU, MCIP, RPP
MANAGER, DEVELOPMENT REVIEW SOUTH
PLANNING, INFRASTRUCTURE & ECONOMIC
DEVELOPMENT DEPARTMENT, CITY OF OTTAWA