

Copyright Reserved

The Contractor shall verify and be responsible for all dimensions. DO NOT scale the drawing - any errors or omissions shall be reported to Stantec without delay.  
The Copyrights to all designs and drawings are the property of Stantec. Reproduction or use for any purpose other than that authorized by Stantec is forbidden.

Legend

- AREA ID
- RUNOFF COEFFICIENT
- STORM DRAINAGE AREA ID
- STORM DRAINAGE BOUNDARY
- DIRECTION OF OVERLAND FLOW
- DIRECTION OF EXISTING OVERLAND FLOW
- PROPOSED STORM SEWER
- PROPOSED CATCHBASIN MANHOLE
- PROPOSED CATCHBASIN
- CIRCULAR ORIFICE (SEE ICD TABLE ON SSP-1 AND SD-1)
- EXISTING STORM SEWER
- EXISTING CATCHBASIN
- THERMAL INSULATION ON STORM SEWER WHERE COVER IS LESS THAN 1.5m, THERMAL INSULATION ON WATERMAIN WHERE COVER IS LESS THAN 2.4m AS PER W22.
- MAXIMUM STATIC PONDING LIMITS
- 100YR. STATIC PONDING LIMITS

Notes

Revision	By	Appd.	Date
1	WAJ	KJK	22.06.03
0	MJS	TR	21.04.08

File Name:	MJS	KK	MJS	21.01.15
160401620 DB.dwg	Dwn.	Chkd.	Dgn.	YY.MM.DD

Permit-Seal

Client/Project  
2441736 ONTARIO INC.  
125 LUSK STREET, OTTAWA, ON, K2J 6S5  
PHONE: 613-307-0412  
BLOCK 10  
HOME 2 - PROPOSED 6 STOREY  
OTTAWA, ON, CANADA

Title  
STORM DRAINAGE PLAN

Project No.	Scale	Sheet	Revision
160401620	1:250	6 of 7	1

Drawing No. SD-1  
Revision PLAN #18665

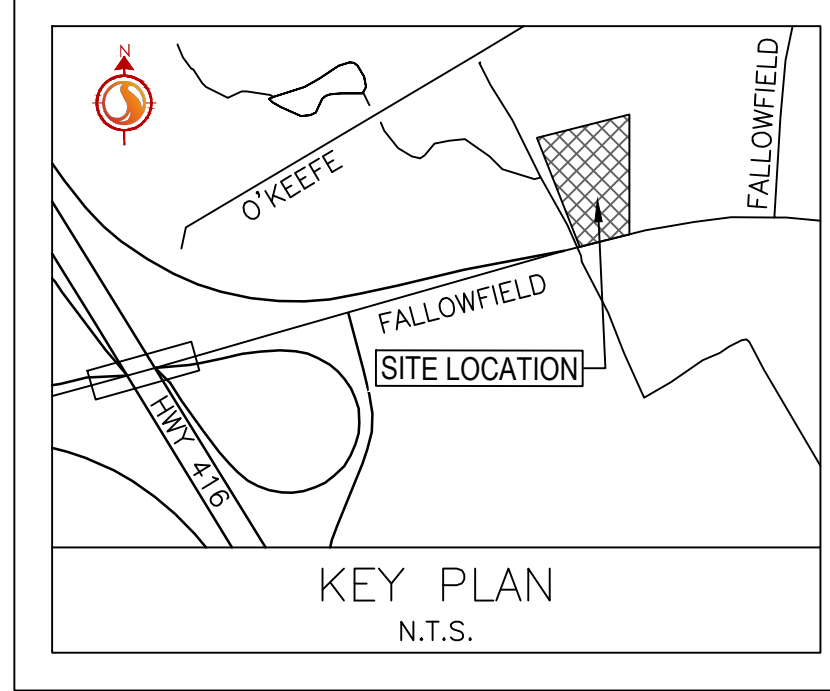
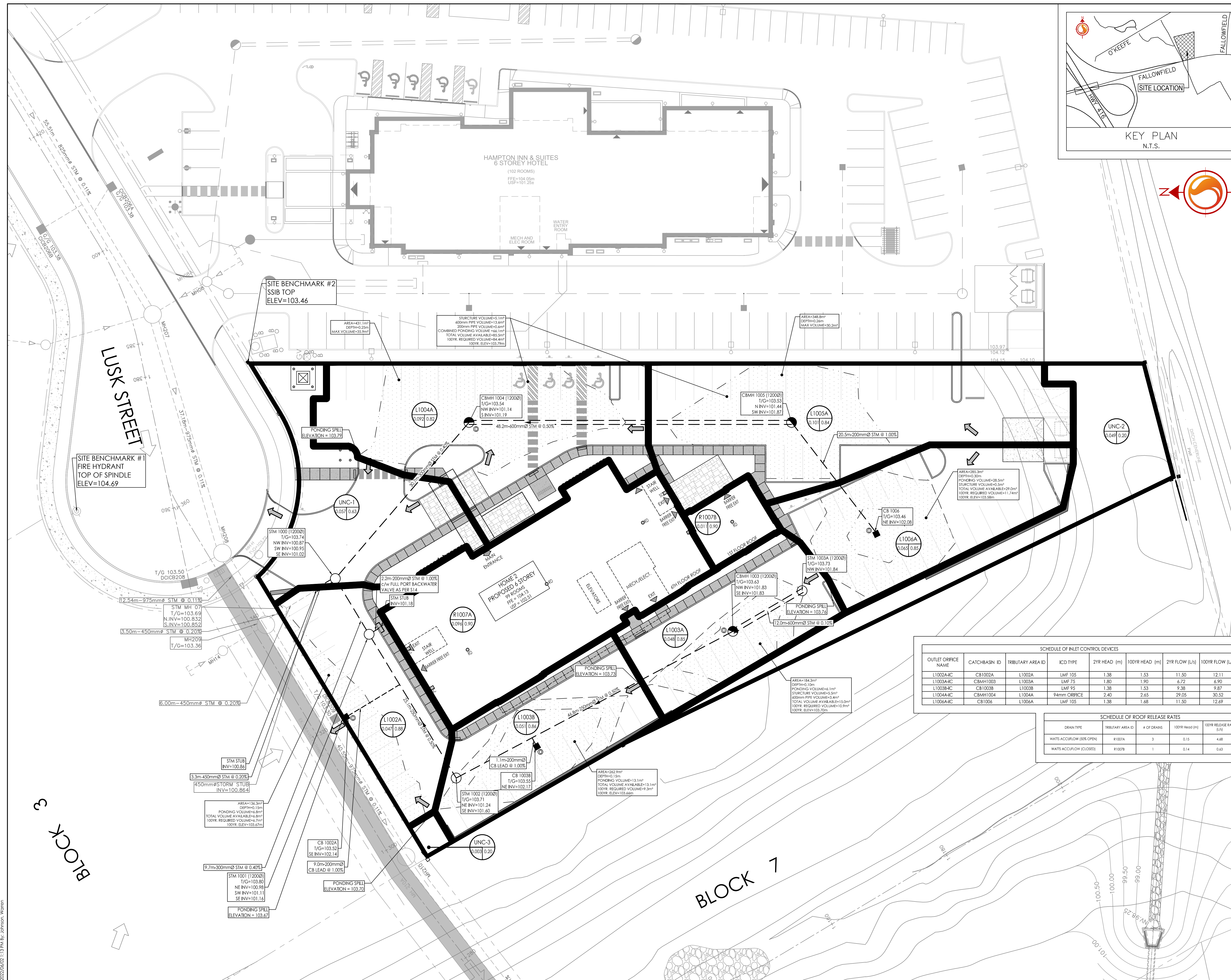

SCHEDULE OF INLET CONTROL DEVICES

OUTLET ORIFICE NAME	CATCHBASIN ID	TRIBUTARY AREA ID	ICD TYPE	2YR HEAD (m)	100YR HEAD (m)	2YR FLOW (L/s)	100YR FLOW (L/s)
L1002A-IC	CB1002A	L1002A	LMF 105	1.38	1.53	11.50	12.11
L1003A-IC	CBM11003	L1003A	LMF 75	1.80	1.90	4.72	6.90
L1003B-IC	CB1003B	L1003B	LMF 95	1.38	1.53	9.38	9.87
L1004A-IC	CBMH1004	L1004A	94mm ORIFICE	2.40	2.65	29.05	30.52
L1006A-IC	CB1006	L1006A	LMF 105	1.38	1.68	11.50	12.69

SCHEDULE OF ROOF RELEASE RATES

DRAIN TYPE	TRIBUTARY AREA ID	# OF DRAIN	100YR Head (m)	100YR RELEASE RATE (l/s)
WATS ACCURFLOW (OZE OPEN)	W1007A	3	0.15	4.68
WATS ACCURFLOW (CLOSED)	R1007B	1	0.14	0.63

2022/06/02 13:19:46 design.dwg 160401620 DB.dwg  
 2022/06/02 13:19:46 design.dwg 160401620 DB.dwg