

PRE-DEVELOPMENT STORMWATER RUN-OFF

POST-DEVELOPMENT STORMWATER MANAGEMENT

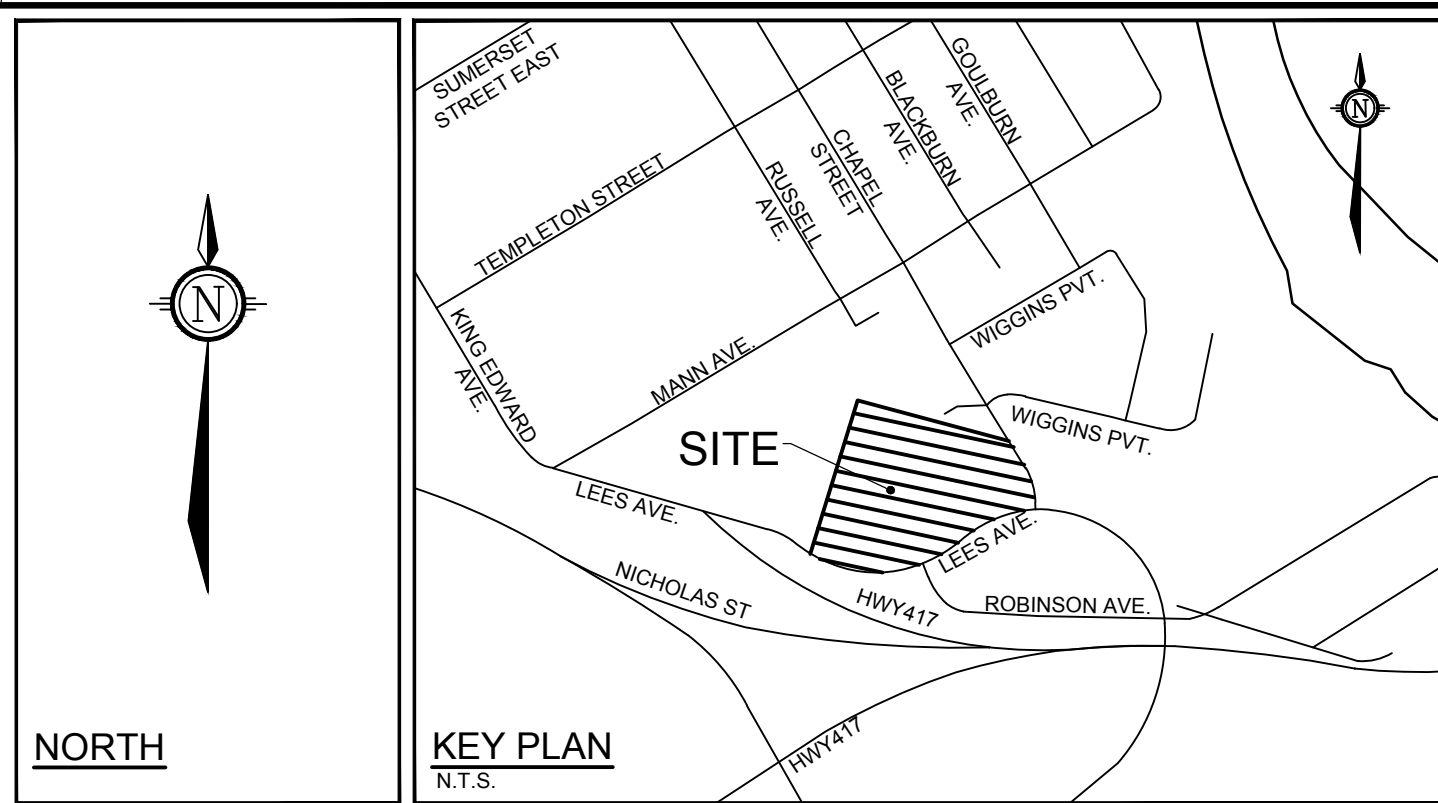
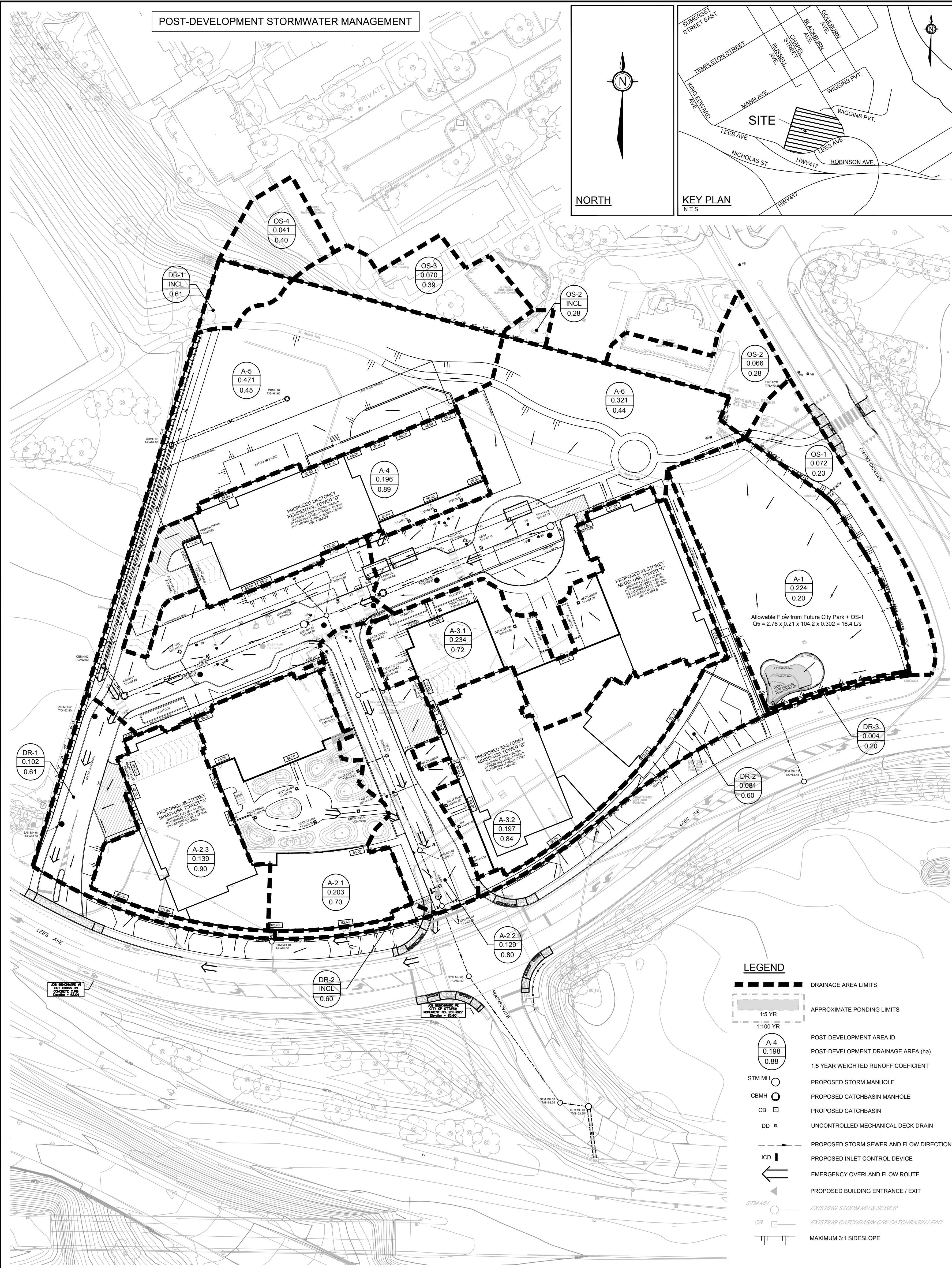

LEGEND

- DRAINAGE AREA LIMITS
- - - APPROXIMATE PONDING LIMITS
- 1:5 YR
- 1:100 YR
- A-4
0.196
0.89
- POST-DEVELOPMENT AREA ID
- POST-DEVELOPMENT DRAINAGE AREA (ha)
- 1:5 YEAR WEIGHTED RUNOFF COEFFICIENT
- STM MH
- PROPOSED STORM MANHOLE
- CB MH
- PROPOSED CATCHBASIN MANHOLE
- CB
- PROPOSED CATCH-BASIN
- DD
- UNCONTROLLED MECHANICAL DECK DRAIN
- PROPOSED STORM SEWER AND FLOW DIRECTION
- ICD
- PROPOSED INLET CONTROL DEVICE
- ←
- EMERGENCY OVERLAND FLOW ROUTE
- ←
- PROPOSED BUILDING ENTRANCE / EXIT
- STM MH
- EXISTING STORM MH & SEWER
- CB
- EXISTING CATCHBASIN / CB
- |||
- MAXIMUM 3:1 SIDESLOPE

NOTE:
 THE POSITION OF ALL POLE LINES, CONDUITS,
 WATERMANS, SEWERS AND OTHER
 UNDERGROUND AND OVERGROUND UTILITIES AND
 STRUCTURES IS NOT NECESSARILY SHOWN ON
 THE CONTRACT DRAWINGS, AND WHERE SHOWN,
 THE ACCURACY OF THE POSITION OF SUCH
 UTILITIES AND STRUCTURES IS NOT GUARANTEED.
 BEFORE STARTING WORK, DETERMINE THE EXACT
 LOCATION OF ALL SUCH UTILITIES AND
 STRUCTURES AND ASSUME ALL LIABILITY FOR
 DAMAGE TO THEM.

OWNER INFORMATION
 2 ROBINSON AVENUE LIMITED PARTNERSHIP
 88 ALBERT STREET
 OTTAWA, ONTARIO, K1P 5E9
 CONTACT: MR. KIERAN WAUGH
 PHONE: (416) 903-1377
 EMAIL: kwaugh@placედore.com

NO.	REVISION	DATE	BY
3	RE-ISSUED FOR SITE PLAN APPROVAL	OCT 07/22	FST
2	REVISED PER CITY COMMENTS / UPDATED SITE PLAN	MAR 30/21	FST
1	ISSUED FOR SITE PLAN APPROVAL	NOV 15/21	FST

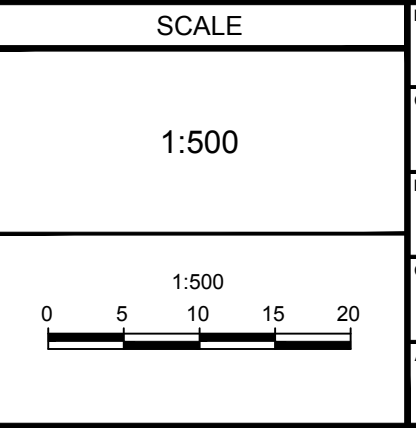

FOR REVIEW ONLY

DESIGN	SM / FST
CHECKED	FST
DRAWN	DM / SM
CHECKED	SM / FST
APPROVED	FST



LOCATION
 CITY OF OTTAWA
 320 LEES AVENUE (2 ROBINSON AVENUE)

DRAWING NAME
**STORMWATER
 MANAGEMENT PLAN**

PROJECT NO.: 119171
 REV # 3
 DRAWING NO.: 119171-SWM

NOVATECH
 Engineers, Planners & Landscape Architects
 Suite 200, 240 Michael Copland Drive
 Ottawa, Ontario, Canada K2M 1P6
 Telephone: (613) 254-9643
 Facsimile: (613) 254-5867
 Website: www.novatech-eng.com

D07-12-21-0202