

PRE-DEVELOPMENT STORMWATER RUN-OFF

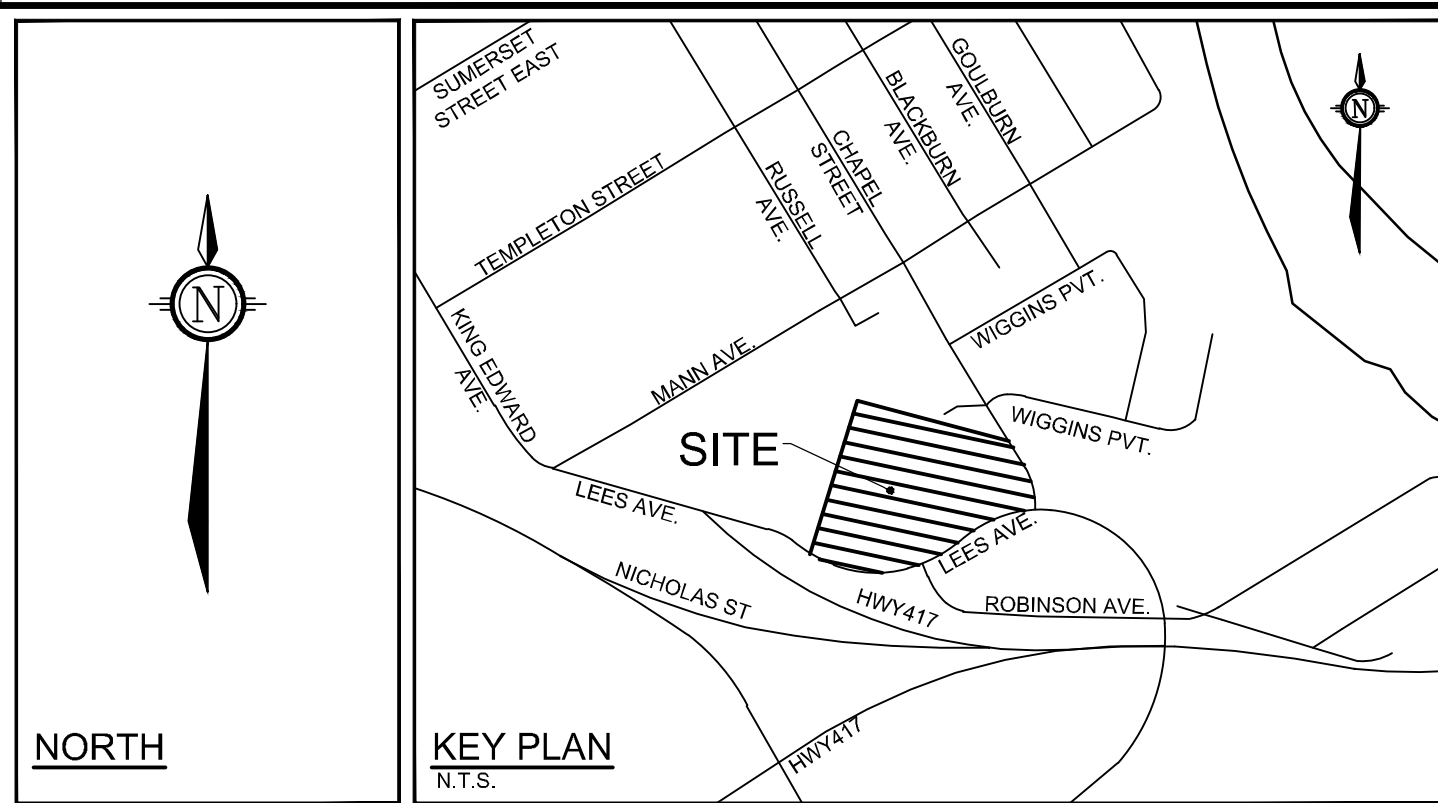

POST-DEVELOPMENT STORMWATER MANAGEMENT

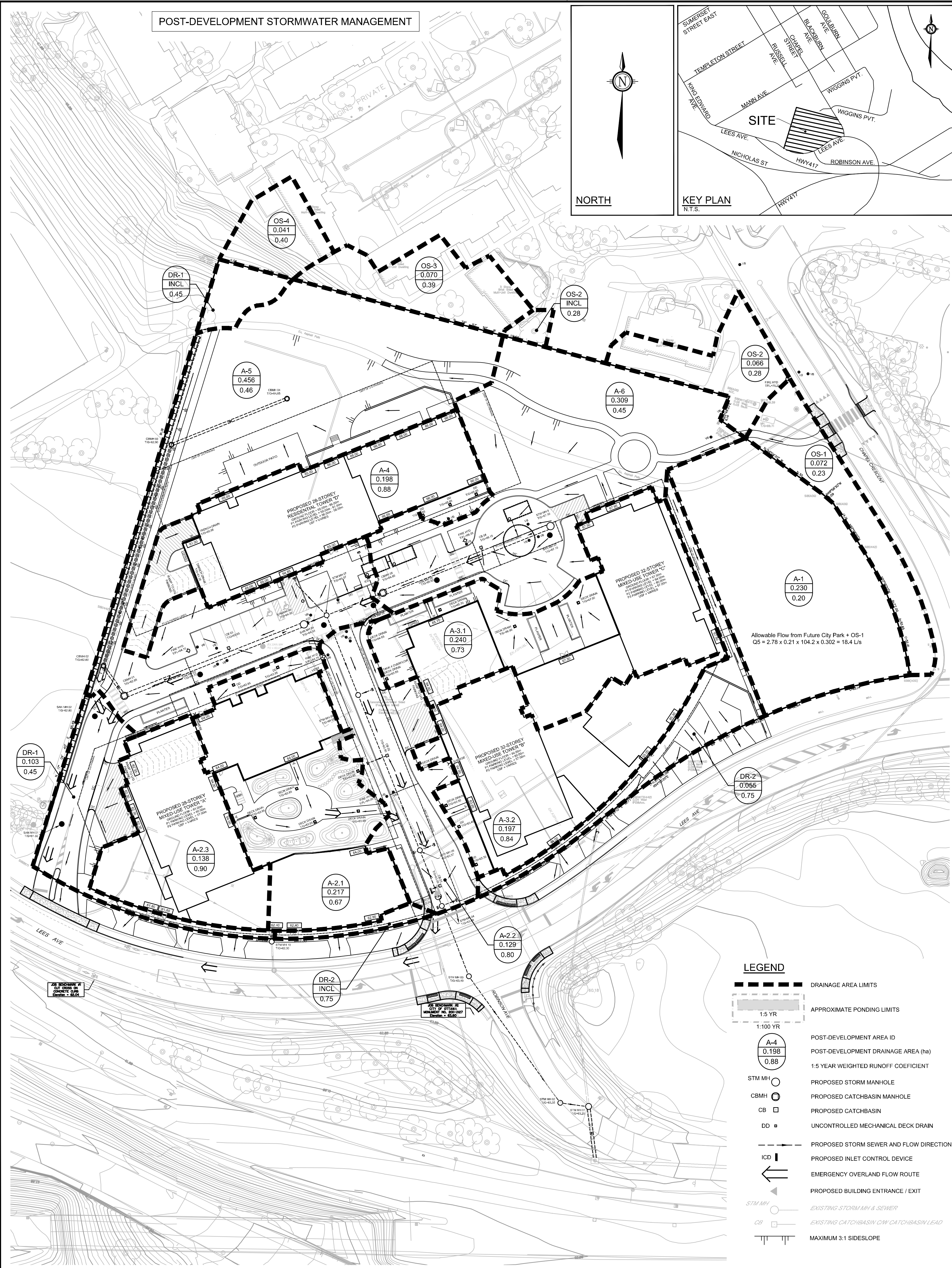

LEGEND

- DRAINAGE AREA LIMITS
- - - APPROXIMATE PONDING LIMITS
- 1:5 YR
- 1:100 YR
- A-4
0.198
0.88
- STM MH
- CBMH
- CB
- DD
- PROPOSED STORM SEWER AND FLOW DIRECTION
- ICD
- ← EMERGENCY OVERLAND FLOW ROUTE
- ← PROPOSED BUILDING ENTRANCE / EXIT
- STM MH
- CB
- ||| MAXIMUM 3:1 SIDESLOPE

NOTE:
 THE POSITION OF ALL POLE LINES, CONDUITS,
 WATERMANS, SEWERS AND OTHER
 UNDERGROUND AND OVERGROUND UTILITIES AND
 STRUCTURES IS NOT NECESSARILY SHOWN ON
 THE CONTRACT DRAWINGS, AND WHERE SHOWN,
 THE ACCURACY OF THE POSITION OF SUCH
 UTILITIES AND STRUCTURES IS NOT GUARANTEED.
 BEFORE STARTING WORK, DETERMINE THE EXACT
 LOCATION OF ALL SUCH UTILITIES AND
 STRUCTURES AND ASSUME ALL LIABILITY FOR
 DAMAGE TO THEM.

OWNER INFORMATION
 2 ROBINSON AVENUE LIMITED PARTNERSHIP
 88 ALBERT STREET
 OTTAWA, ONTARIO, K1P 5E9
 CONTACT: MR. KIERAN WAUGH
 PHONE: (416) 903-1377
 EMAIL: kwaugh@placედore.com

No.	REVISION	DATE	BY
2	REVISED PER CITY COMMENTS / UPDATED SITE PLAN	MAR 2021	FST
1	ISSUED FOR SITE PLAN APPROVAL	NOV 1521	FST

SCALE

1:500

0 5 10 15 20

FOR REVIEW ONLY

DESIGN	SM / FST
CHECKED	FST
DRAWN	DM / SM
CHECKED	SM / FST
APPROVED	FST



NOVATECH
 Engineers, Planners & Landscape Architects
 Suite 200, 240 Michael Cowpland Drive
 Ottawa, Ontario, Canada K2M 1P6
 Telephone: (613) 254-9643
 Facsimile: (613) 254-5867
 Website: www.novatech-eng.com

LOCATION
 CITY OF OTTAWA
 2 ROBINSON AVENUE

DRAWING NAME
**STORMWATER
 MANAGEMENT PLAN**

PROJECT No.: 119171
 REV # 2
 DRAWING No.: 119171-SWM