

C:\temp\pub\119171\FD.dwg, ED, Mar 08, 2022, 12:24pm, Miller

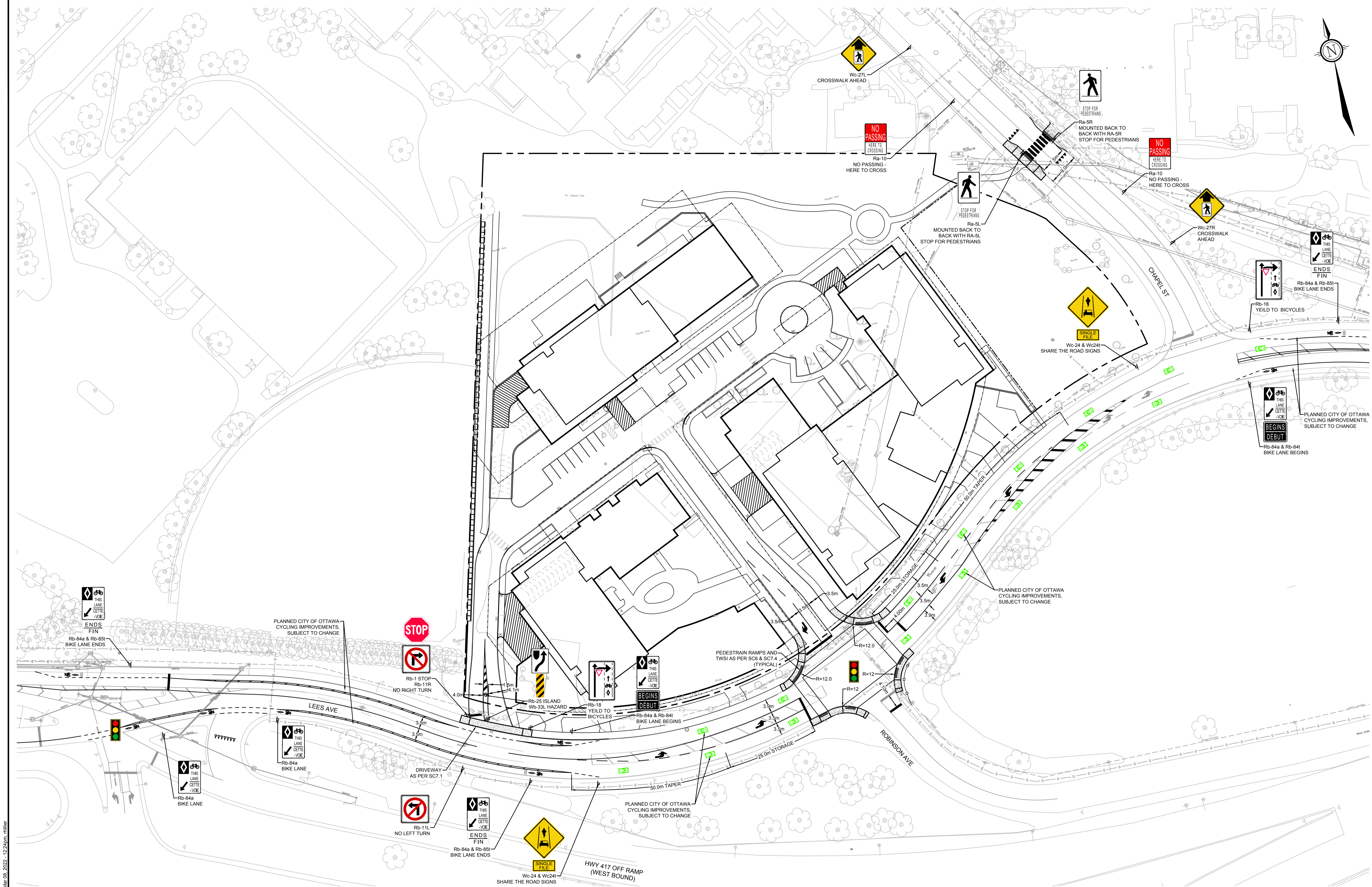

**NOTE:**  
THE POSITION OF ALL POLE LINES, CONDUITS, WATERMANS, SEWERS AND OTHER UNDERGROUND AND OVERGROUND UTILITIES AND STRUCTURES IS NOT NECESSARILY SHOWN ON THE CONTRACT DRAWINGS, AND WHERE SHOWN, THE ACCURACY OF THE POSITION OF SUCH UTILITIES AND STRUCTURES IS NOT GUARANTEED. BEFORE STARTING WORK, DETERMINE THE EXACT LOCATION OF ALL SUCH UTILITIES AND STRUCTURES AND ASSUME ALL LIABILITY FOR DAMAGE TO THEM.

LEGEND	
	PROPOSED CONCRETE
	PROPOSED DEPRESSED CURB
	EXISTING LIGHT STANDARD
	EXISTING SANITARY MANHOLE
	EXISTING STORM MANHOLE
	EXISTING CATCHBASIN
	EXISTING HYDRO DUCT
	EXISTING BELL DUCT
	EXISTING ROGERS DUCT
	EXISTING GAS MAIN
	EXISTING GUIDERAIL
	SIGNALIZED INTERSECTION

No.	REVISION	DATE	BY
5.	ISSUED FOR SITEPLAN RESUBMISSION	MAR 08/22	JLL
4.	ISSUED FOR SITEPLAN RESUBMISSION	FEB 25/22	RAF
3.	ISSUED FOR SITEPLAN SUBMISSION	NOV 12/21	DWM
2.	ISSUED FOR ZONING RESUBMISSION	JUN 25/21	RAF
1.	ISSUED FOR CITY REVIEW	DEC 21/20	BJB

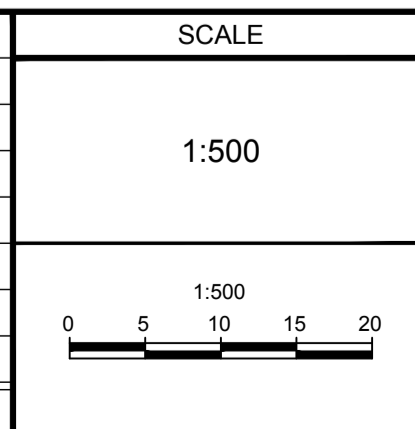

DESIGN		FOR REVIEW ONLY	
CHECKED	RCH		
CHECKED	RAF		
DRAWN	RCH		
CHECKED	JLL		
APPROVED	BJB		

**NOVATECH**  
Engineers, Planners & Landscape Architects  
Suite 200, 240 Michael Cowpland Drive  
Ottawa, Ontario, Canada K2M 1P6

Telephone (613) 254-9643  
Facsimile (613) 254-5867  
Website www.novatech-eng.com

LOCATION CITY OF OTTAWA 2 ROBINSON AVENUE		PROJECT No. 119171-0
DRAWING NAME FUNCTIONAL DESIGN		REV # 5
		DRAWING No. 119171-FD