

LEGEND

---	PROPERTY LINE
SAN MH	PROPOSED SANITARY MH & SEWER
CBMH 3	PROPOSED CATCHBASIN MH & SEWER
STM MH 1	PROPOSED STORM MH & SEWER
CB 2	PROPOSED CATCHBASIN & LEAD
PMSU 2020_5	STORMWATER QUALITY CONTROL UNIT
ICD	PROPOSED INLET CONTROL DEVICE
DD	PROPOSED DECK DRAIN
WM	PROPOSED WATER METER AND REMOTE METER
DC	PROPOSED BARRIER CURB
150mmØ	PROPOSED DEPRESSED CURB
150mmØ	PROPOSED WATER SERVICE AND DIAMETER
HYD	PROPOSED HYDRANT c/w VALVE & VALVE BOX
VB	PROPOSED VALVE & VALVE BOX
⊖	PROPOSED CAP
DMC	PROPOSED DISTRICT METERING CHAMBER (PER W3)
⊕	SEWER CROSSINGS (REFER TO TABLE ON 119171-NDT)
⊕	PROPOSED BUILDING ENTRANCE
X	REMOVALS
GF	GROUND FLOOR FINISHED FLOOR ELEVATION OF GROUND FLOOR
P1	P1 PARKING FINISHED FLOOR ELEVATION OF PARKING LEVEL 1
P2	P2 PARKING FINISHED FLOOR ELEVATION OF PARKING LEVEL 2
USF	UNDERSIDE OF FOOTING ELEVATION
OHW	EXISTING OVERHEAD WIRES
---	EXISTING CONCRETE CURB
SAN MH	EXISTING SANITARY MANHOLE & SEWER
CBMH	EXISTING CATCHBASIN MANHOLE
STM MH	EXISTING STORM MANHOLE & SEWER
CB	EXISTING CATCHBASIN c/w CATCHBASIN LEAD
HYD	EXISTING HYDRANT & VALVE
EX VP	EXISTING TREES / VEGETATION
---	EXISTING UTILITY POLE
---	EXISTING FENCE
---	EXISTING WATERMAIN
---	EXISTING HYDRANT c/w VALVE & LEAD

REFER TO PLAN 119171-PR1 FOR OFF-SITE WATERMAIN WORKS

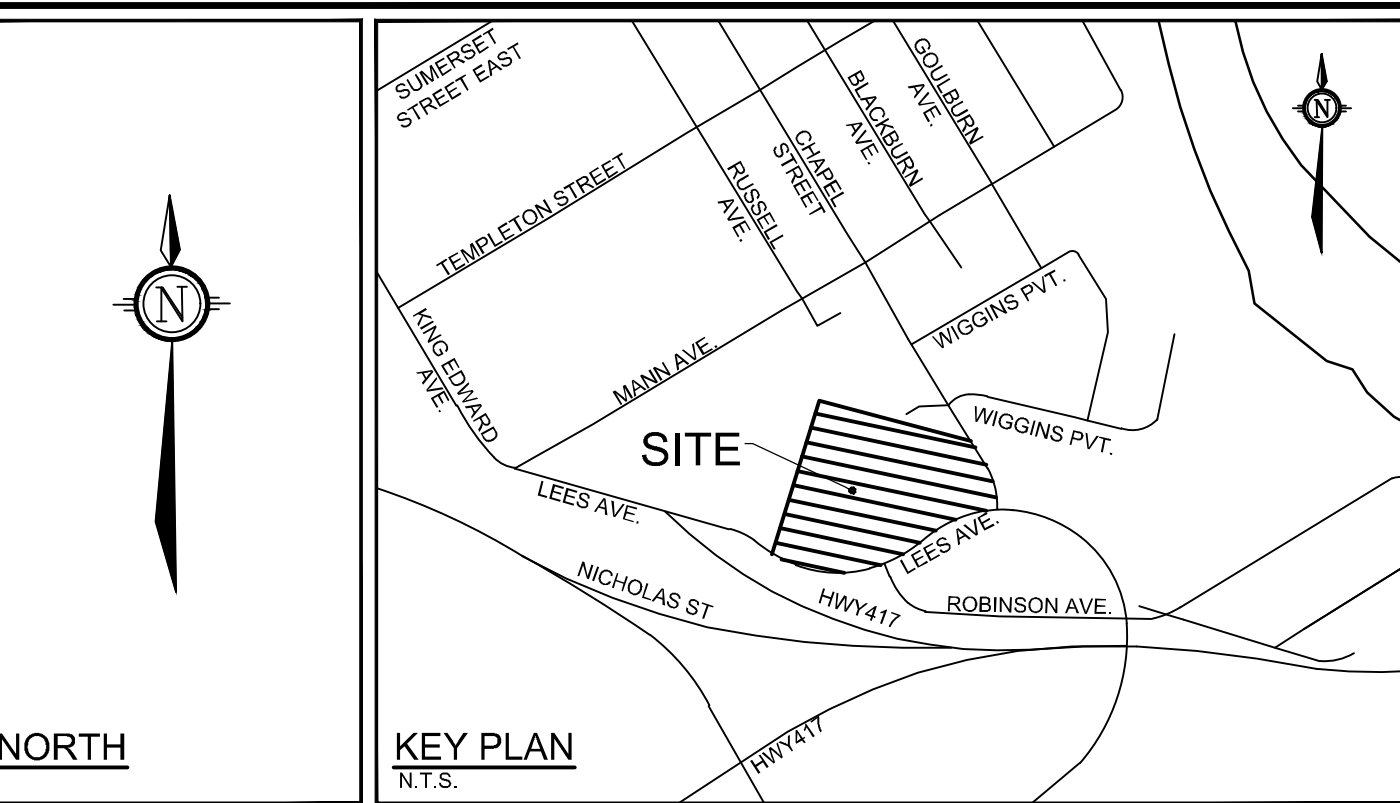

BENCHMARK INFO:
 CITY OF OTTAWA MONUMENT No. 2011-0127 LOCATED NEAR THE SOUTH-WEST CORNER OF THE INTERSECTION OF LEES AVENUE AND ROBINSON AVENUE. GEODEIC ELEVATION = 63.60m.
 ALL ELEVATIONS ARE REFERRED TO THE COVD28 GEODETIC DATUM. DERIVED FROM VERTICAL CONTROL MONUMENT NO. 3603 HAVING AN ELEVATION OF 76.959 METRES. BEARINGS ARE GRID, DERIVED FROM THE NORTHERLY LIMIT OF PART 1 ON PLAN 4R-1381 AND ARE REFERRED TO THE CENTRAL MERIDIAN OF MTM ZONE 9 (76°30' WEST LONGITUDE NAD-83 (ORIGINAL)).
 THE EXISTING GRADES SHOWN ON THE PLANS ARE TAKEN DIRECTLY FROM TOPOGRAPHICAL SURVEY PLAN (Ref. # 21029-20, RE. L1 PL. 49 F.), PREPARED BY ANNE O'SULLIVAN, VOLLEBERG SIGNED AND DATED JULY 18, 2020.
 SURROUNDING BACKGROUND TOPO INFORMATION BEYOND THE LIMITS OF THE SITE SURVEY ARE SHOWN FROM CITY OF OTTAWA 1:1000 MAPPING FOR CONTEXT ONLY.

JOB BENCHMARK #1 CUT CROSS ON CONCRETE CURB Elevation = 62.04

PROPOSED CITY PARK BLOCK SERVING TO BE DETERMINED BY OTHERS. STORM AND WATER SERVICES SHOWN ARE CONCEPTUAL UNTIL SUCH TIME AS THE CITY PARK BLOCK IS FULLY DESIGNED.

JOB BENCHMARK #3 CUT CROSS ON CONCRETE SIDEWALK Elevation = 68.57

REFER TO PLANS 119171-PR1 AND 119171-PR2 FOR OFF-SITE WATERMAIN AND STORM SEWER WORKS

REFER TO 119171-NDT FOR NOTES, DETAILS AND TABLES

NOTE:
 THE POSITION OF ALL POLE LINES, CONDUITS, WATERMANS, SEWERS AND OTHER UNDERGROUND AND OVERGROUND UTILITIES AND STRUCTURES IS NOT NECESSARILY SHOWN ON THE CONTRACT DRAWINGS, AND WHERE SHOWN, THE ACCURACY OF THE POSITION OF SUCH UTILITIES AND STRUCTURES IS NOT GUARANTEED. BEFORE STARTING WORK, DETERMINE THE EXACT LOCATION OF ALL SUCH UTILITIES AND STRUCTURES AND ASSUME ALL LIABILITY FOR DAMAGE TO THEM.

OWNER INFORMATION
 2 ROBINSON AVENUE LIMITED PARTNERSHIP
 88 ALBERT STREET
 OTTAWA, ONTARIO, K1P 5E9
 CONTACT: MR. MIKE MARCELLA
 PHONE: (343) 550-9661
 EMAIL: mike@placedorae.com

SCALE	
SM / FST	1:300
DM / SM	1:300
SM / FST	1:300
FST	1:300

FOR REVIEW ONLY



LOCATION CITY OF OTTAWA 2 ROBINSON AVENUE	PROJECT NO. 119171
DRAWING NAME GENERAL PLAN OF SERVICES	REV #1
NOVATECH Engineers, Planners & Landscape Architects Suite 200, 240 Michael Copland Drive Ottawa, Ontario, Canada K2M 1P6 Telephone: (613) 254-9643 Facsimile: (613) 254-5867 Website: www.novatech-eng.com	DRAWING NO. 119171-GP

No.	REVISION	DATE	BY
1	ISSUED FOR SITE PLAN APPROVAL	NOV 15 21	FST