



- EXISTING VEGETATION TO BE PRESERVED
- INDIVIDUAL TREE/STAND OF TREES TO BE PRESERVED AND KEY NO. - REFER TO TABLE # & REPORT FOR PRESERVATION TECHNIQUES DURING CONSTRUCTION
- INDIVIDUAL TREE/STAND OF TREES TO BE REMOVED AND KEY NO. - REFER TO TABLE #
- TREE PROTECTION FENCING
- AREA OF STUDY

11	re-issued TGR for SPA	2024/02/23
10	re-issued for SPA	2024/01/26
09	re-issued for SPA	2023/11/13
08	re-issued for SPA	2023/10/31
07	re-issued for SPA	2023/01/06
06	re-issued for SPA	2022/10/07
05	re-issued for SPA	2022/03/30
04	issued for SPA	2021/11/19
03	issued for coordination	2021/11/10
02	issued for client review	2021/10/29
01	issued for coordination	2021/01/26
00	issued for ZBLA	2020/12/22
rev'n	description / la description	yyyy/mm/dd

FOTENN Planning + Design

396 Cooper Street, Suite 300
 Ottawa, ON, CANADA K2P 2H7
 613.730.5709
 fotenn.com

north / le nord stamp / le cachet

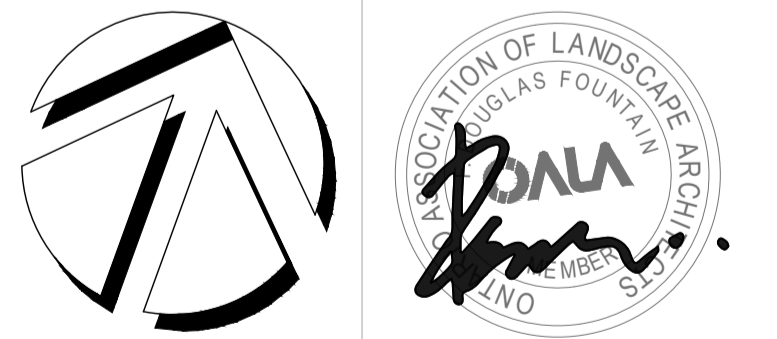

project / projet
320 LEES AVENUE (2 ROBINSON)

drawing / dessin
TREE CONSERVATION PLAN

designed / conçu ST / DF	drawn / dessiné ST / MB	reviewed / examiné DF
date JAN 2023	project number / No. du projet D07-12-21-0202 / #18357	

drawing number / No. du dessin

#18357

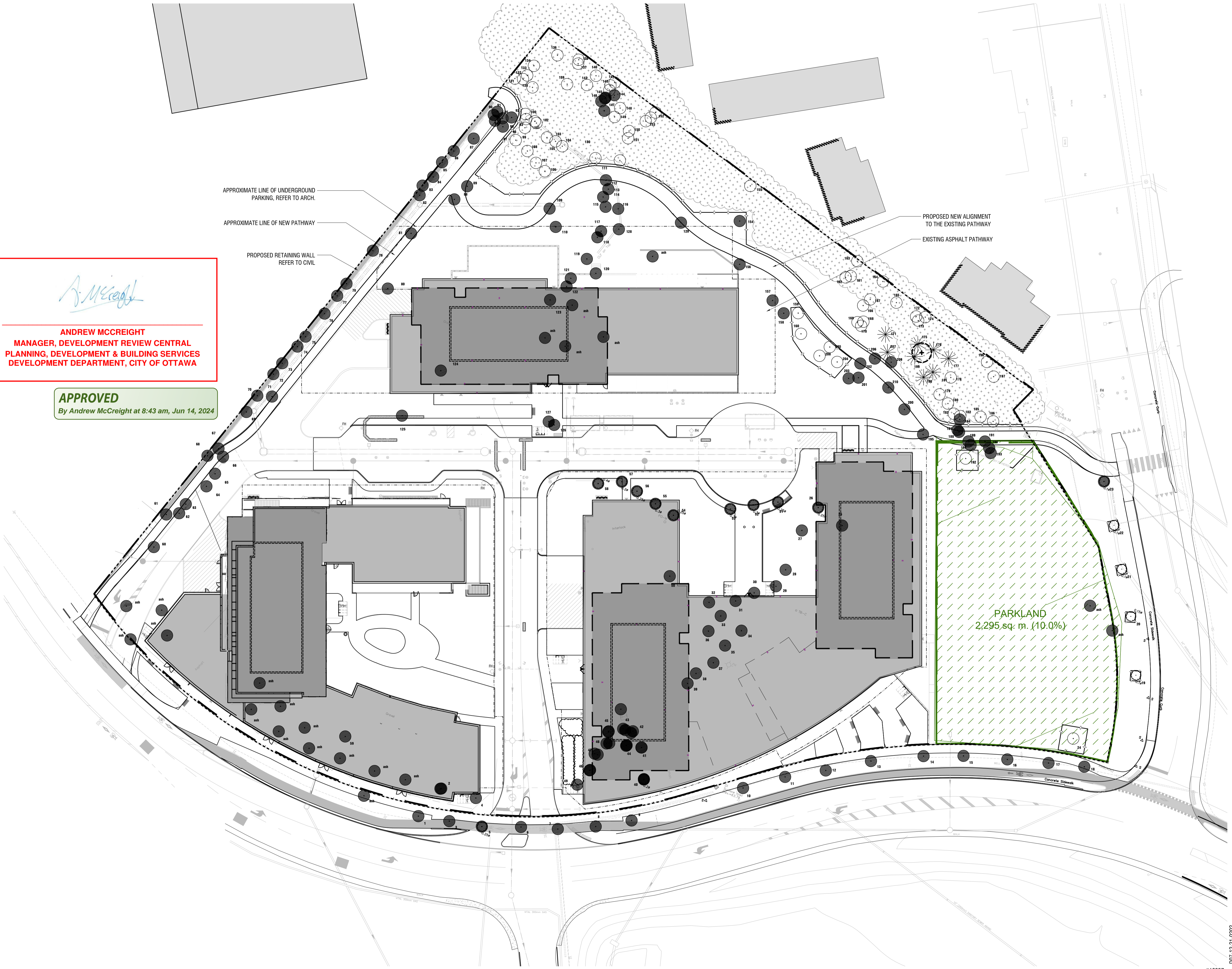

Andrew McCreight
ANDREW MCCREIGHT
 MANAGER, DEVELOPMENT REVIEW CENTRAL
 PLANNING, DEVELOPMENT & BUILDING SERVICES
 DEVELOPMENT DEPARTMENT, CITY OF OTTAWA

APPROVED
 By Andrew McCreight at 8:43 am, Jun 14, 2024

Tree No.	Species	Condition	Size (Diameter)	Age	Notes	Reason for removal (if applicable)
1	Red oak (Quercus rubra)	24	24	Co-dominant leaders at 3.5m from grade; maturing; salt spray damage to crown to be removed	Conflicts with construction access	Conflicts with construction access
2	Red oak	19	19	Tri-dominant leaders at 3m from grade; maturing; salt spray damage to crown to be removed	Conflicts with construction access	Conflicts with construction access
3	Red oak	23	23	Salt spray damage to crown; maturing; to be removed	Conflicts with construction access	Conflicts with construction access
4	Red oak	20	20	Divergent form; maturing; to be removed	Conflicts with construction access	Conflicts with construction access
5	Red oak	20	20	Sweep in main stem at 4m from grade; maturing; to be removed	Conflicts with construction access	Conflicts with construction access
6	Red oak	24	24	Frost crack in main stem from grade to 2.5m; maturing; to be removed	Conflicts with construction access	Conflicts with construction access
7	Honey-locust (Gleditsia triacanthos)	28	28	Encroaching on light standard; mature; to be removed	Conflicts with construction access	Conflicts with construction access
8	Honey-locust	15	15	Stem divergent at 1m from grade to be removed	Conflicts with construction access	Conflicts with construction access
9	Honey-locust	16	16	Minor salt spray damage to be removed	Conflicts with construction access	Conflicts with construction access
10	Honey-locust	24	24	Broad crown; maturing; epicormic shoot at 1m from grade to be removed	Conflicts with construction access	Conflicts with construction access
11	Honey-locust	18	18	Good condition to be removed	Conflicts with construction access	Conflicts with construction access
12	Honey-locust	25	25	Good condition to be removed	Conflicts with construction access	Conflicts with construction access
13	Honey-locust	25	25	Good condition to be removed	Conflicts with construction access	Conflicts with construction access
14	Honey-locust	20	20	Epicormic growth at 1m from grade to be removed	Conflicts with construction access	Conflicts with construction access
15	Honey-locust	11 avg.	11	Tri-stemmed from grade to be removed	Conflicts with construction access	Conflicts with construction access
16	Honey-locust	23	23	Good condition to be removed	Conflicts with construction access	Conflicts with construction access
17	Honey-locust	22	22	Good condition to be removed	Conflicts with construction access	Conflicts with construction access
18	Honey-locust	26	26	Good condition to be removed	Conflicts with construction access	Conflicts with construction access
19	Freeman maple (Acer freemanii)	10	10	Co-dominant leaders at 4m from grade to be preserved and protected	NA	NA
20	Freeman maple	9	9	Co-dominant leaders at 2m from grade to be preserved and protected	NA	NA
21	Red oak	7	7	Divergent leader to be preserved and protected	NA	NA
22	Red oak	7	7	Divergent leader to be preserved and protected	NA	NA
23	Red oak	5	5	Low vigour, heavy basal damage to be removed	Conflicts with pathway	Conflicts with pathway
24	Norway maple	27	27	Good condition to be preserved and protected	NA	NA
25	Norway maple	37	37	Multiple leaders at 2m from grade, branch cluster to be removed	Conflicts with construction access	Conflicts with construction access
26	Norway maple	24	24	Co-dominant stem at 2m from grade, included bark union to be removed	Conflicts with construction access	Conflicts with construction access
27	Colorado spruce	31	31	Good condition to be removed	Conflicts with construction access	Conflicts with construction access
28	Norway maple	32	32	Branch cluster at 2m from grade to be removed	Conflicts with construction access	Conflicts with construction access
29	Norway maple	33	33	Co-dominant stems at 2.5m from grade to be removed	Conflicts with construction access	Conflicts with construction access
30	Norway maple	25	25	Tri-dominant stems at 2.5m from grade to be removed	Conflicts with construction access	Conflicts with construction access
31	Austrian pine	33	33	Significant sap sucker damage to be removed	Conflicts with construction access	Conflicts with construction access
32	Austrian pine	40	40	Asymmetrical to be removed	Conflicts with construction access	Conflicts with construction access
33	Austrian pine	36	36	Good condition to be removed	Conflicts with construction access	Conflicts with construction access
34	Colorado spruce	31	31	Visible signs of pitch mass borers to be removed	Conflicts with construction access	Conflicts with construction access
35	Colorado spruce	37	37	Good condition to be removed	Conflicts with construction access	Conflicts with construction access
36	Austrian pine	31	31	Sap sucker damage to be removed	Conflicts with construction access	Conflicts with construction access
37	Colorado spruce	31	31	Good condition to be removed	Conflicts with construction access	Conflicts with construction access
38	Colorado spruce	33	33	Good condition to be removed	Conflicts with construction access	Conflicts with construction access
39	Colorado spruce	43	43	Good condition to be removed	Conflicts with construction access	Conflicts with construction access
40	Norway maple	24	24	Good condition to be removed	Conflicts with construction access	Conflicts with construction access
41	Norway maple	34	34	4 competing stems at 4m from grade to be removed	Conflicts with construction access	Conflicts with construction access
42	Colorado spruce	27	27	Mild sweep to be removed	Conflicts with construction access	Conflicts with construction access
43	Colorado spruce	28	28	Mild sweep to be removed	Conflicts with construction access	Conflicts with construction access
44	Colorado spruce	21	21	Mild sweep to be removed	Conflicts with construction access	Conflicts with construction access
45	Colorado spruce	21	21	Mild sweep to be removed	Conflicts with construction access	Conflicts with construction access
46	Colorado spruce	26	26	Mild sweep to be removed	Conflicts with construction access	Conflicts with construction access
47	Colorado spruce	20	20	Good condition to be removed	Conflicts with construction access	Conflicts with construction access
48	Colorado spruce	33	33	Good condition to be removed	Conflicts with construction access	Conflicts with construction access
49	Colorado spruce	33	33	Competing parallel stems at 2.5m from grade to be removed	Conflicts with construction access	Conflicts with construction access
50	Norway maple	10	10	Good condition to be removed	Conflicts with construction access	Conflicts with construction access
51	Norway maple	24	24	Severely decayed stem from grade to 4m to be removed	Conflicts with construction access	Conflicts with construction access
52	Norway maple	20	20	Significant lower deadwood to be removed	Conflicts with construction access	Conflicts with construction access
53	Norway maple	27	27	Severely decayed from grade to 2.5m to be removed	Conflicts with construction access	Conflicts with construction access
54	Honey-locust	21	21	Asymmetrical to be removed	Conflicts with construction access	Conflicts with construction access
55	Honey-locust	29	29	Good condition to be removed	Conflicts with construction access	Conflicts with construction access
56	Honey-locust	22	22	Good condition to be removed	Conflicts with construction access	Conflicts with construction access
57	Honey-locust	17	17	Low vigour to be removed	Conflicts with construction access	Conflicts with construction access
58	Honey-locust	36	36	Major physical basal damage to be removed	Conflicts with construction access	Conflicts with construction access
59	Eastern cottonwood (Populus deltoides)	14	14	Good condition to be removed	Conflicts with construction access	Conflicts with construction access
60	Eastern cottonwood	20	20	Good condition to be removed	Conflicts with construction access	Conflicts with construction access
61	Trembling aspen (Populus tremuloides)	14	14	Good condition to be removed	Conflicts with construction access	Conflicts with construction access

NOTES:
1. THE TABLE ABOVE IS FROM THE TREE CONSERVATION REPORT PREPARED BY CERTIFIED ARBORIST, IFS ASSOCIATES, DATED March 29, 2022.
2. REFER TO 'TREE PRESERVATION AND PROTECTION MEASURES' ON THE ARBORIST REPORT PRIOR TO ANY CONSTRUCTION WORKS ON SITE.
3. ANY WORKS WITHIN CRITICAL ROOT ZONE OF THE EXISTING TREES TO BE RETAINED NEEDS TO BE UNDERTAKEN BY HAND AND LIGHT EQUIPMENT TO THE SATISFACTION OF THE ARBORIST/LANDSCAPE ARCHITECT. SEE ALSO NOTE (5) ON #2/TC-2 FOR MORE INFORMATION.

1 TABLE 1 n.t.s.

62	Eastern cottonwood	13	13	Good condition to be removed	Conflicts with construction access	Conflicts with construction access
63	Eastern cottonwood	13	13	Good condition to be removed	Conflicts with construction access	Conflicts with construction access
64	Eastern cottonwood	11	11	Good condition to be removed	Conflicts with construction access	Conflicts with construction access
65	Eastern cottonwood	19	19	Good condition to be removed	Conflicts with construction access	Conflicts with construction access
66	Balsam poplar (Populus balsamifera)	14	14	Divergent to be removed	Conflicts with construction access	Conflicts with construction access
67	Siberian elm (Ulmus pumila)	17 & 10	17 & 10	Divergent to be removed	Conflicts with retaining wall	Conflicts with retaining wall
68	Eastern cottonwood	32 & 40	32 & 40	Double stems from grade, infested with wild grape vine, growing into chain link fence to be removed	Conflicts with retaining wall	Conflicts with retaining wall
69	American elm (Ulmus americana)	17 & 20	17 & 20	Double stem from grade to be removed	Conflicts with retaining wall	Conflicts with retaining wall
70	Manitoba maple (Acer negundo)	13	13	4 stemmed at grade to be removed	Conflicts with retaining wall	Conflicts with retaining wall
71	Manitoba maple	13 & 17	13 & 17	Double stem at 0.3m from grade, heavily divergent to be removed	Conflicts with retaining wall	Conflicts with retaining wall
72	Manitoba maple	17	17	Divergent to be removed	Conflicts with retaining wall	Conflicts with retaining wall
73	Manitoba maple	17	17	Upright form, encroaching on chain link fence to be removed	Conflicts with retaining wall	Conflicts with retaining wall
74	Manitoba maple	17 avg.	17	4 stemmed at grade to be removed	Conflicts with retaining wall	Conflicts with retaining wall
75	Crab apple (Malus spp.)	10 avg.	10	5 stemmed at grade to be removed	Conflicts with retaining wall	Conflicts with retaining wall
76	Manitoba maple	12 avg.	12	7 stemmed at grade to be removed	Conflicts with retaining wall	Conflicts with retaining wall
77	Manitoba maple	10 avg.	10	Tri-stemmed at grade to be removed	Conflicts with retaining wall	Conflicts with retaining wall
78	Manitoba maple	14 avg.	14	9 stemmed at grade to be removed	Conflicts with retaining wall	Conflicts with retaining wall
79	Manitoba maple	16 avg.	16	6 stemmed at grade, infested with wild grape vine to be removed	Conflicts with retaining wall	Conflicts with retaining wall
80	Eastern cottonwood	13	13	Good condition to be removed	Conflicts with construction access	Conflicts with construction access
81	Eastern cottonwood	29	29	Infested with wild grape vine to be removed	Conflicts with construction access	Conflicts with construction access
82	Siberian elm	12 & 15	12 & 15	Co-dominant stems at 0.5m to be removed	Conflicts with retaining wall	Conflicts with retaining wall
83	Manitoba maple	10	10	Divergent to be removed	Conflicts with retaining wall	Conflicts with retaining wall
84	Siberian elm	14 & 11	14 & 11	Stems growing on either side of chain link fence to be removed	Conflicts with retaining wall	Conflicts with retaining wall
85	Eastern cottonwood	12	12	Slightly divergent to be removed	Conflicts with retaining wall	Conflicts with retaining wall
86	Eastern cottonwood	15	15	Divergent to be removed	Conflicts with retaining wall	Conflicts with retaining wall
87	Siberian elm	16	16	Good condition to be removed	Conflicts with construction access	Conflicts with construction access
88	Siberian elm	16	16	Good condition to be removed	Conflicts with construction access	Conflicts with construction access
89	Eastern cottonwood	10	10	Co-dominant leaders to be removed	Conflicts with pathway	Conflicts with pathway
90	Manitoba maple	12	12	Strongly divergent to be removed	Conflicts with grade changes	Conflicts with grade changes
91	Siberian elm	17	17	Good condition to be removed	Conflicts with grade changes	Conflicts with grade changes
92	Siberian elm	18	18	Good condition to be removed	Conflicts with grade changes	Conflicts with grade changes
93	Eastern cottonwood	14	14	Divergent to be removed	Conflicts with grade changes	Conflicts with grade changes
94	Siberian elm	10 & 12	10 & 12	Double stem at 0.2m from grade to be removed	Conflicts with pathway	Conflicts with pathway
95	Siberian elm	20	20	Good condition to be removed	Conflicts with pathway	Conflicts with pathway
96	Siberian elm	12	12	Good condition to be removed	Conflicts with grade changes	Conflicts with grade changes
97	Eastern cottonwood	19	19	Divergent to be removed	Conflicts with pathway	Conflicts with pathway
98	Eastern cottonwood	14	14	Divergent to be removed	Conflicts with pathway	Conflicts with pathway
99	Eastern cottonwood	15 & 15	15 & 15	Double stem at grade, divergent to be removed	NA	NA
100	Manitoba maple	13 & 13	13 & 13	Double stem at grade to be preserved and protected	NA	NA
101	Siberian elm	17	17	Good condition, upright to be preserved and protected	NA	NA
102	Manitoba maple	14 avg.	14	4 stemmed at grade to be preserved and protected	NA	NA
103	Eastern cottonwood	15	15	Slight divergence to be preserved and protected	NA	NA
104	Eastern cottonwood	21	21	Slight divergence to be preserved and protected	NA	NA
105	Eastern cottonwood	18	18	Good condition to be preserved and protected	NA	NA
106	Eastern cottonwood	12	12	Slight divergence to be preserved and protected	NA	NA
107	Eastern cottonwood	15	15	Slight divergence to be preserved and protected	NA	NA
108	Eastern cottonwood	11	11	Slight divergence to be preserved and protected	NA	NA
109	Eastern cottonwood	11	11	Slight divergence to be removed	Conflicts with pathway	Conflicts with pathway
110	Eastern cottonwood	13	13	Good condition to be removed	Conflicts with grade changes	Conflicts with grade changes
111	Eastern cottonwood	10 & 10	10 & 10	Co-dominant stems at grade to be preserved and protected	NA	NA
112	Largetooth aspen (Populus grandidentata)	13 & 10	13 & 10	Double stem at grade to be removed	Conflicts with grade changes	Conflicts with grade changes
113	Eastern cottonwood	12	12	Good condition to be removed	Conflicts with grade changes	Conflicts with grade changes
114	Largetooth aspen	17	17	Good condition to be removed	Conflicts with grade changes	Conflicts with grade changes
115	Eastern cottonwood	13	13	Divergent to be removed	Conflicts with grade changes	Conflicts with grade changes
116	Eastern cottonwood	15	15	Good condition to be removed	Conflicts with construction access	Conflicts with construction access
117	Largetooth aspen	18	18	Sap sucker damage to be removed	Conflicts with construction access	Conflicts with construction access
118	Eastern cottonwood	15 & 17	15 & 17	Double stemmed at grade, good condition, upright to be removed	Conflicts with grade changes	Conflicts with grade changes
119	Eastern cottonwood	18 & 13	18 & 13	Double stemmed at grade to be removed	Conflicts with grade changes	Conflicts with grade changes
120	Eastern cottonwood	19	19	Good condition, upright to be removed	Conflicts with construction access	Conflicts with construction access
121	Eastern cottonwood	14	14	Slight divergence to be removed	Conflicts with construction access	Conflicts with construction access
122	Eastern cottonwood	16	16	Slight divergence to be removed	Conflicts with construction access	Conflicts with construction access
123	Eastern cottonwood	19	19	Good condition, upright to be removed	Conflicts with construction access	Conflicts with construction access
124	Eastern cottonwood	12 avg.	12	5 stemmed at grade to be removed	Conflicts with construction access	Conflicts with construction access

125	Eastern cottonwood	21	21	Good condition to be removed	Conflicts with construction	Conflicts with construction
126	Largetooth aspen	10	10	Good condition to be removed	Conflicts with construction	Conflicts with construction
127	Eastern cottonwood	14	14	Slight divergence to be removed	Conflicts with construction	Conflicts with construction
128	Siberian elm	13 & 18	13 & 18	Double stem at grade, stems growing on either side of fence to be removed	Conflicts with grade changes	Conflicts with grade changes
129	Red oak	32	32	Good condition to be removed	Conflicts with underground garage	Conflicts with underground garage
130	Siberian elm	35	35	Co-dominant leaders at 2.5m from grade to be preserved and protected	NA	NA
131	Manitoba maple	16	16	Divergent to be preserved and protected	NA	NA
132	Manitoba maple	30	30	Heavily divergent to be preserved and protected	NA	NA
133	Manitoba maple	15	15	Divergent leader to be preserved and protected	NA	NA
134	American elm	17	17	Good condition to be preserved and protected	NA	NA
135	Manitoba maple	22	22	Heavily divergent to be preserved and protected	NA	NA
136	American elm	14	14	Thin canopy, overshadowed to be preserved and protected	NA	NA
137	Manitoba maple	32	32	Heavily divergent to be preserved and protected	NA	NA
138	American elm	26	26	Good condition to be preserved and protected	NA	NA
139	American elm	29	29	Divergent to be preserved and protected	NA	NA
140	American elm	20	20	Good condition to be preserved and protected	NA	NA
141	American elm	28	28	Divergent leader to be preserved and protected	NA	NA
142	American elm	13	13	Divergent to be preserved and protected	NA	NA
143	American elm	22	22	Divergent leader at 3m from grade to be preserved and protected	NA	NA
144	Siberian elm	35	35	In advanced decline to be removed	Poor condition	Poor condition
145	Siberian elm	26	26	In advanced decline to be removed	Poor condition	Poor condition
146	Siberian elm	27	27	In advanced decline to be removed	Poor condition	Poor condition
147	Siberian elm	17	17	In advanced decline to be removed	Poor condition	Poor condition
148	American elm	12	12	Slightly divergent to be preserved and protected	NA	NA
149	Manitoba maple	56	56	Co-dominant leader at 2m from grade, divergent leader to be preserved and protected	NA	NA
150	American elm	14	14	Slightly divergent to be preserved and protected	NA	NA
151	American elm	17	17	Slightly divergent to be preserved and protected	NA	NA
152	Siberian elm	16	16	Slightly divergent to be preserved and protected	NA	NA
153	Manitoba maple	24	24	Major crown dieback to be preserved and protected	NA	NA
154	Siberian elm	45	45	Co-dominant leaders from grade to be removed	Conflicts with underground garage	Conflicts with underground garage
155	Siberian elm	37	37	Co-dominant leaders from grade to be preserved and protected	NA	NA
156	Manitoba maple	24	24	Fair condition, deadwood in crown to be removed	Conflicts with underground garage	Conflicts with underground garage
157	Manitoba maple	10	10	Heavily divergent		