

BENCHMARK INFO:
 CITY OF OTTAWA MONUMENT No. 2011-0127 LOCATED NEAR THE SOUTH-WEST CORNER OF THE INTERSECTION OF LEES AVENUE AND ROBINSON AVENUE. GEODETIC ELEVATION = 63.60m.
 ALL ELEVATIONS ARE REFERRED TO THE COVID28 GEODETIC DATUM. DERIVED FROM VERTICAL CONTROL MONUMENT NO. 3603 HAVING AN ELEVATION OF 76.959 METRES. BEARINGS ARE GRID, DERIVED FROM THE NORTHERLY LIMIT OF PART 1 ON PLAN 4R-1381 AND ARE REFERRED TO THE CENTRAL MERIDIAN OF MTM ZONE 9 (76°30' WEST LONGITUDE) NAD-83 (ORIGINAL).
 THE EXISTING GRADES SHOWN ON THE PLANS ARE TAKEN DIRECTLY FROM TOPOGRAPHICAL SURVEY PLAN (Ref. # 21028-20 JRE L17 PL 49 T F), PREPARED BY ANNIS, O'SULLIVAN, VOLLEBERG SIGNED AND DATED AUGUST 14, 2020.
 SURROUNDING BACKGROUND TOPO INFORMATION BEYOND THE LIMITS OF THE SITE SURVEY ARE SHOWN FROM CITY OF OTTAWA 1:1000 MAPPING FOR CONTEXT ONLY.

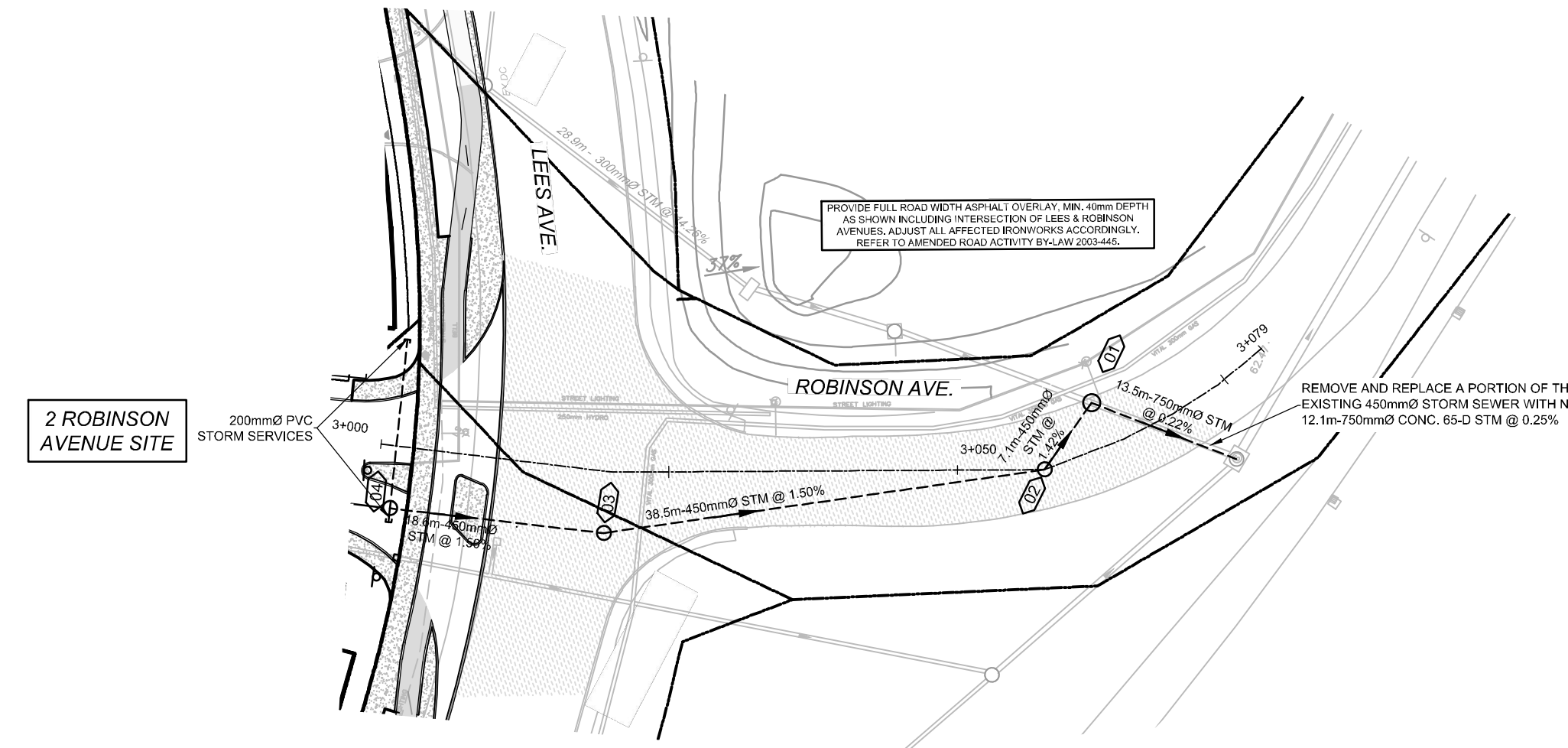

ROBINSON AVENUE

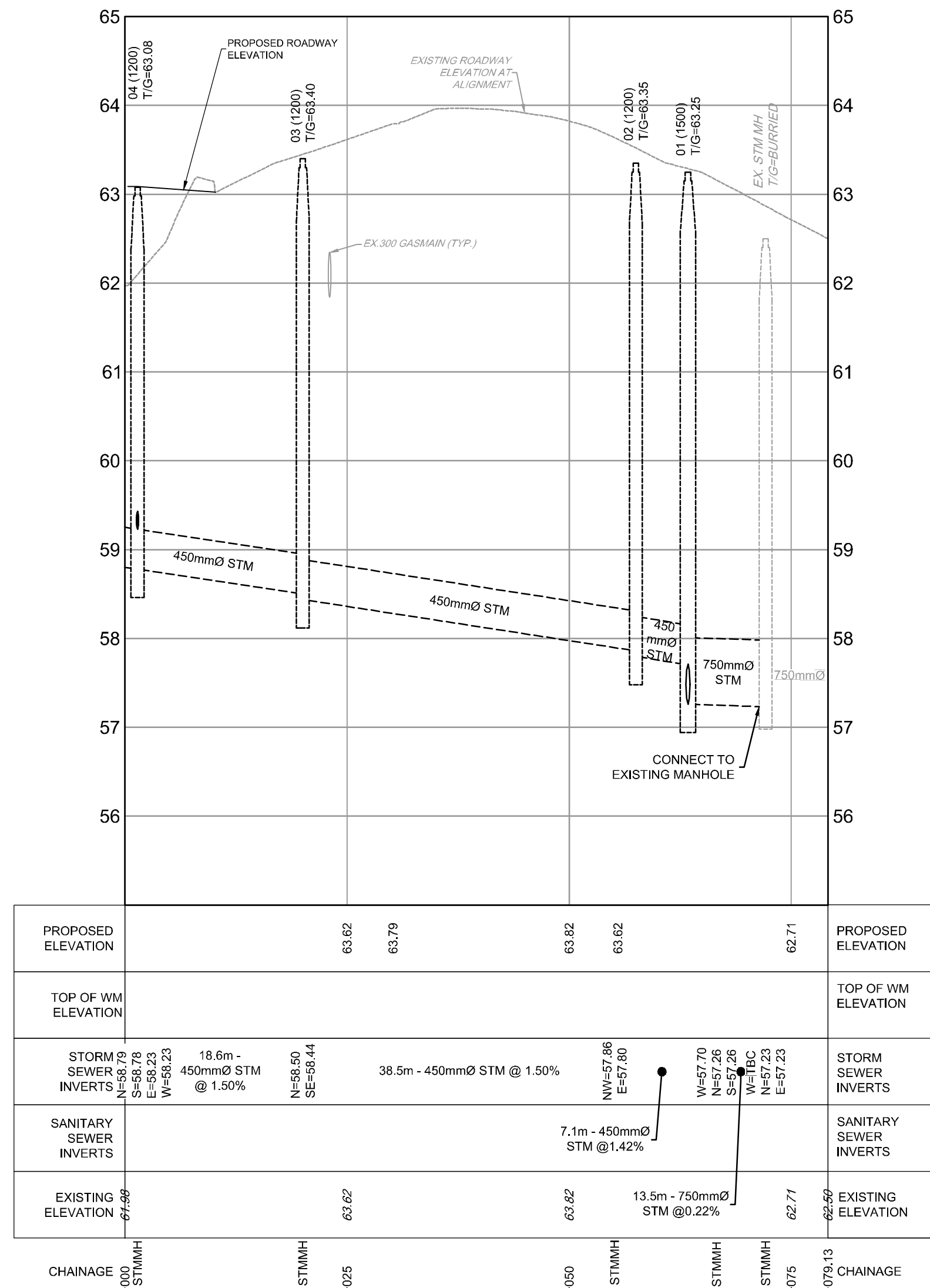

Andrew McCreight
ANDREW MCCREIGHT
 MANAGER, DEVELOPMENT REVIEW CENTRAL
 PLANNING, DEVELOPMENT & BUILDING SERVICES
 DEVELOPMENT DEPARTMENT, CITY OF OTTAWA

APPROVED
 By Andrew McCreight at 8:42 am, Jun 14, 2024

REFER TO 119171-NDT FOR ADDITIONAL NOTES

NOTE:
 THE POSITION OF ALL POLE LINES, CONDUITS, WATERMANS, SEWERS AND OTHER UNDERGROUND AND OVERGROUND UTILITIES AND STRUCTURES IS NOT NECESSARILY SHOWN ON THE CONTRACT DRAWINGS, AND WHERE SHOWN, THE ACCURACY OF THE POSITION OF SUCH UTILITIES AND STRUCTURES IS NOT GUARANTEED. BEFORE STARTING WORK, DETERMINE THE EXACT LOCATION OF ALL SUCH UTILITIES AND STRUCTURES AND ASSUME ALL LIABILITY FOR DAMAGE TO THEM.

No.	REVISION	DATE	BY
6	REVISED PER CITY COMMENTS	JAN 18/24	FST
5	ISSUED FOR MUNICIPAL CONSENT	NOV 17/23	FST
4	REVISED SIDEWALK/BICYCLE TRACK ALONG LEES AVE.	NOV 3/23	FST
3	RE-ISSUED FOR SITE PLAN APPROVAL	OCT 07/22	FST
2	REVISED PER CITY COMMENTS	MAR 30/21	FST
1	ISSUED FOR SITE PLAN APPROVAL	NOV 15/21	FST

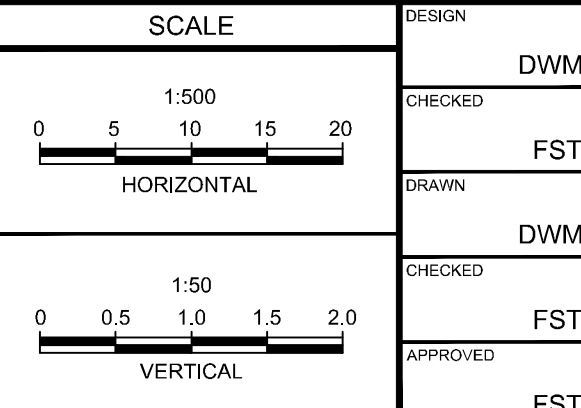

DESIGN	FOR REVIEW ONLY
CHECKED	DWM
DRAWN	FST
CHECKED	DWM
APPROVED	FST
	FST



NOVATECH
 Engineers, Planners & Landscape Architects
 Suite 200, 240 Michael Cowpland Drive
 Ottawa, Ontario, Canada K2M 1P6
 Telephone: (613) 254-9643
 Facsimile: (613) 254-5867
 Website: www.novatech-eng.com

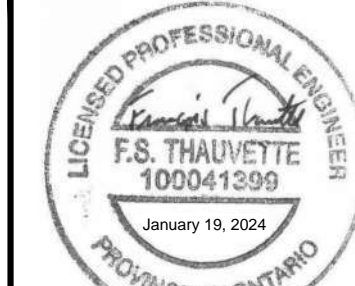

LOCATION OTTAWA, ONTARIO 2 ROBINSON AVE.	PROJECT No. 119171
DRAWING NAME PLAN AND PROFILE ROBINSON AVENUE STATION 3+000 TO 3+079	REV # 6
	DRAWING No. 119171-PR2

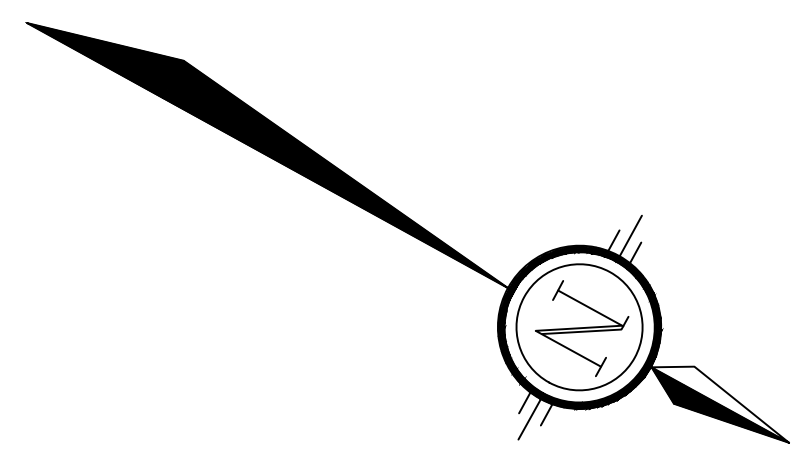

BENCHMARK INFO:

CITY OF OTTAWA MONUMENT No. 2011-0127 LOCATED NEAR THE SOUTH-WEST CORNER OF THE INTERSECTION OF LEES AVENUE AND ROBINSON AVENUE. GEODETIC ELEVATION = 63.60m.

ALL ELEVATIONS ARE REFERRED TO THE CGVD28 GEODETIC DATUM, DERIVED FROM VERTICAL CONTROL MONUMENT NO. 3603 HAVING AN ELEVATION OF 76.959 METRES. BEARINGS ARE GRID, DERIVED FROM THE NORTHERLY LIMIT OF PART 1 ON PLAN 4R-1381 AND ARE REFERRED TO THE CENTRAL MERIDIAN OF MTM ZONE 9 (70°30' WEST LONGITUDE) NAD-83 (ORIGINAL).

THE EXISTING GRADES SHOWN ON THE PLANS ARE TAKEN DIRECTLY FROM TOPOGRAPHICAL SURVEY PLAN (Ref. # 21029-20 JRE L17 PL 49 F), PREPARED BY ANNIS, O'SULLIVAN, VOLLEBERG SIGNED AND DATED AUGUST 14, 2020.

SURROUNDING BACKGROUND TOPO INFORMATION BEYOND THE LIMITS OF THE SITE SURVEY ARE SHOWN FROM CITY OF OTTAWA 1:1000 MAPPING FOR CONTEXT ONLY.

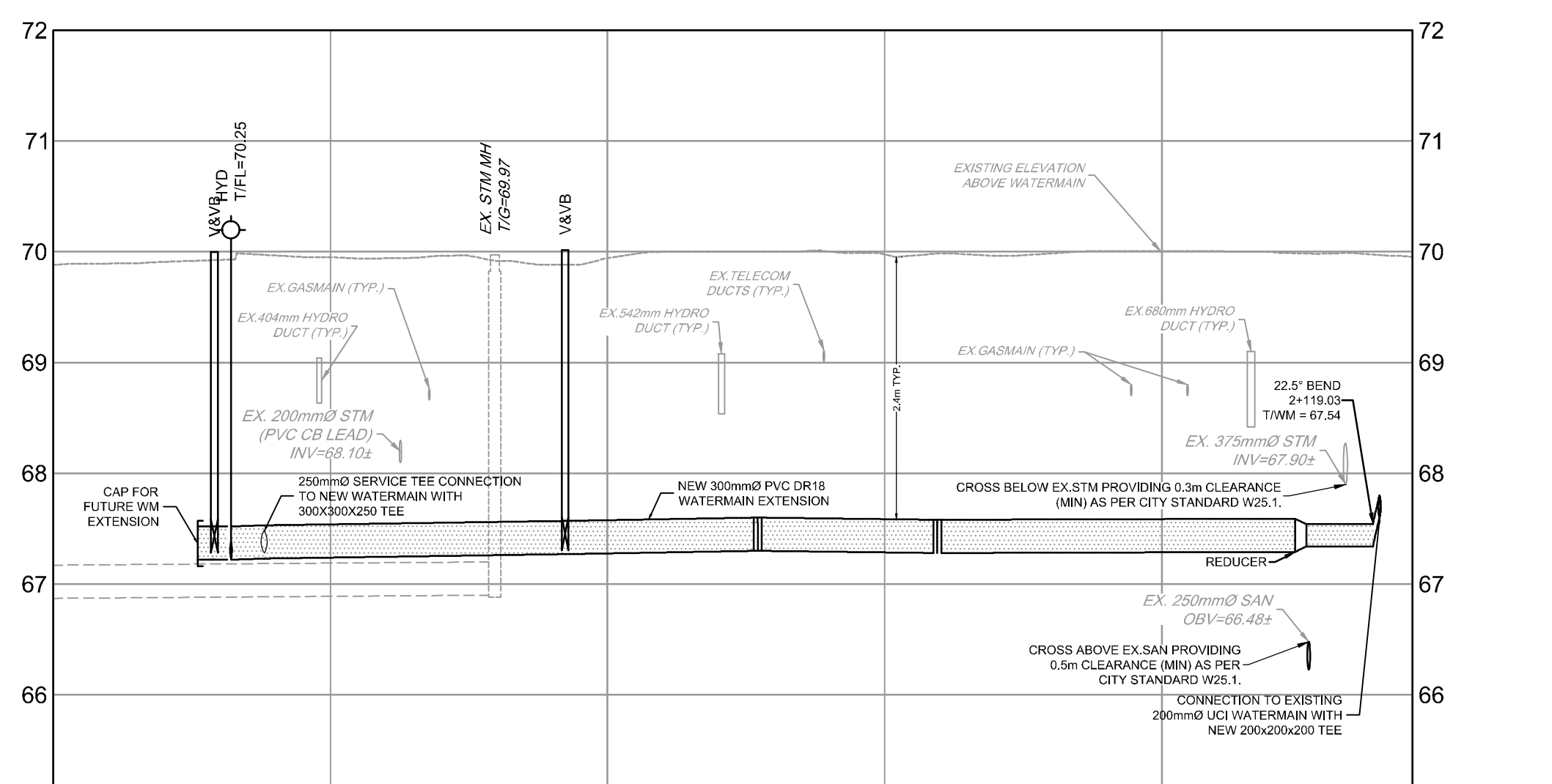
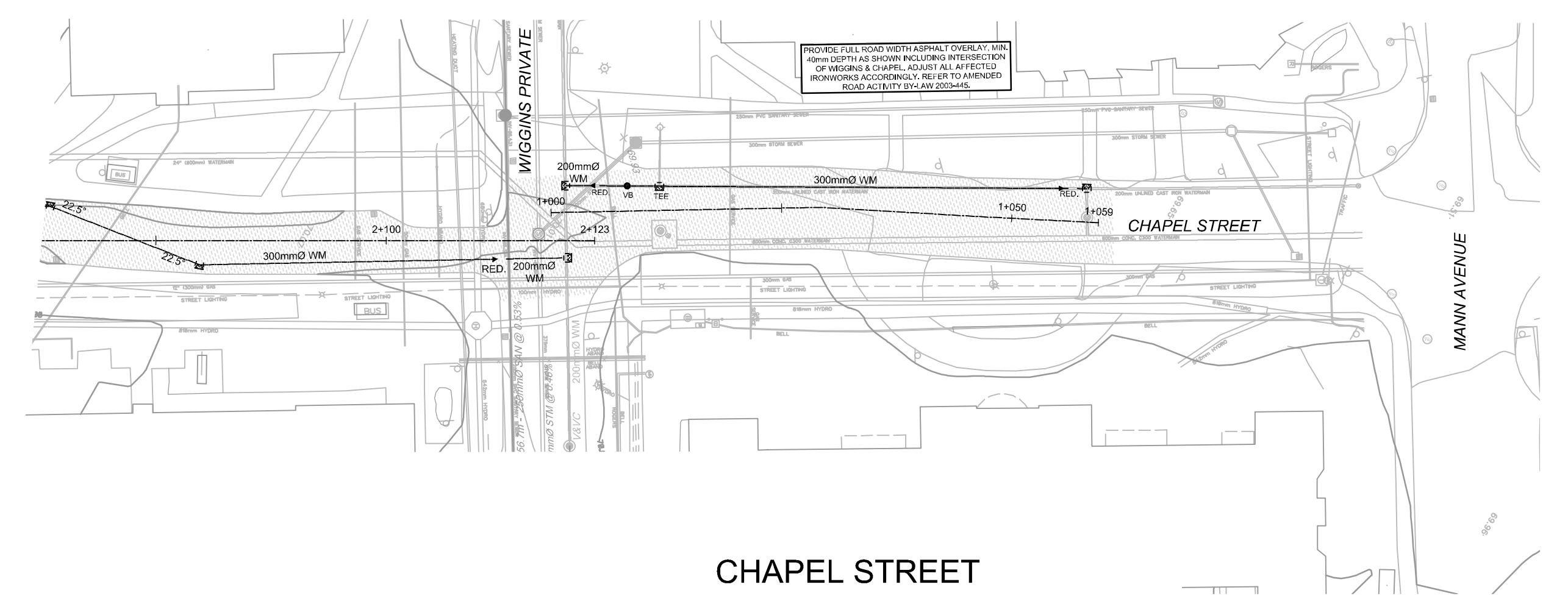
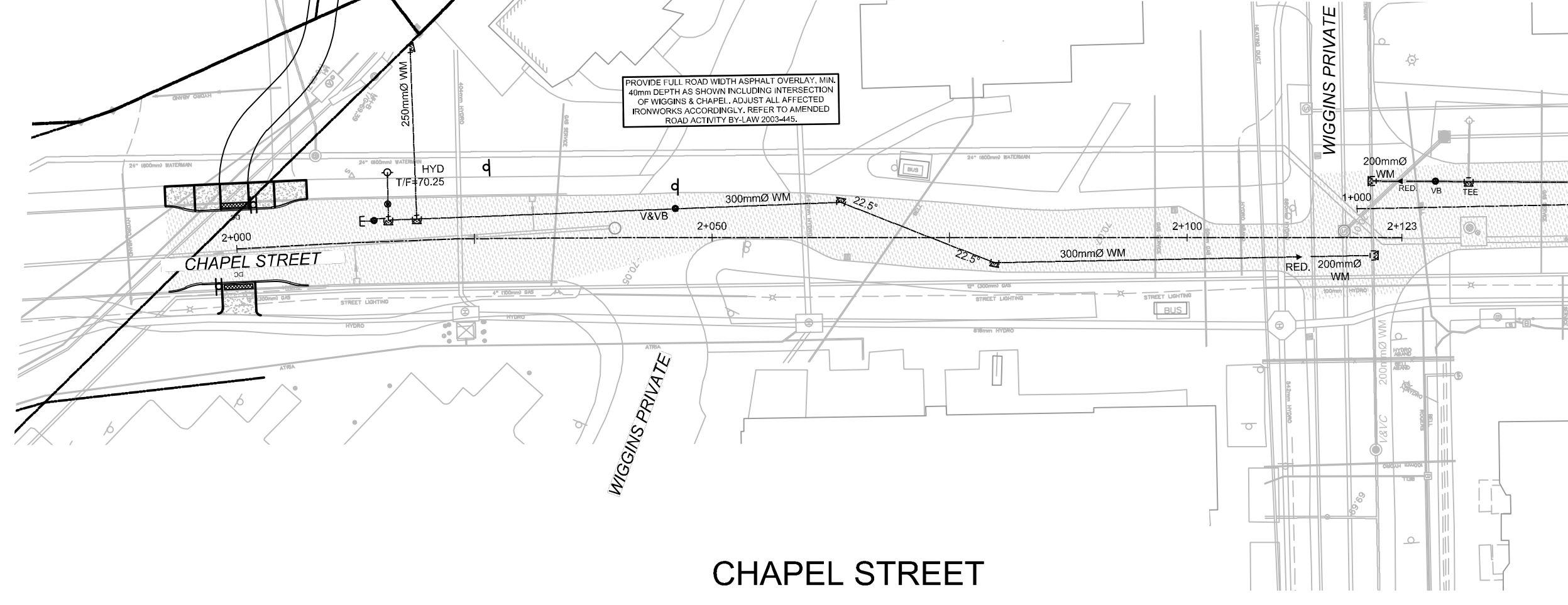
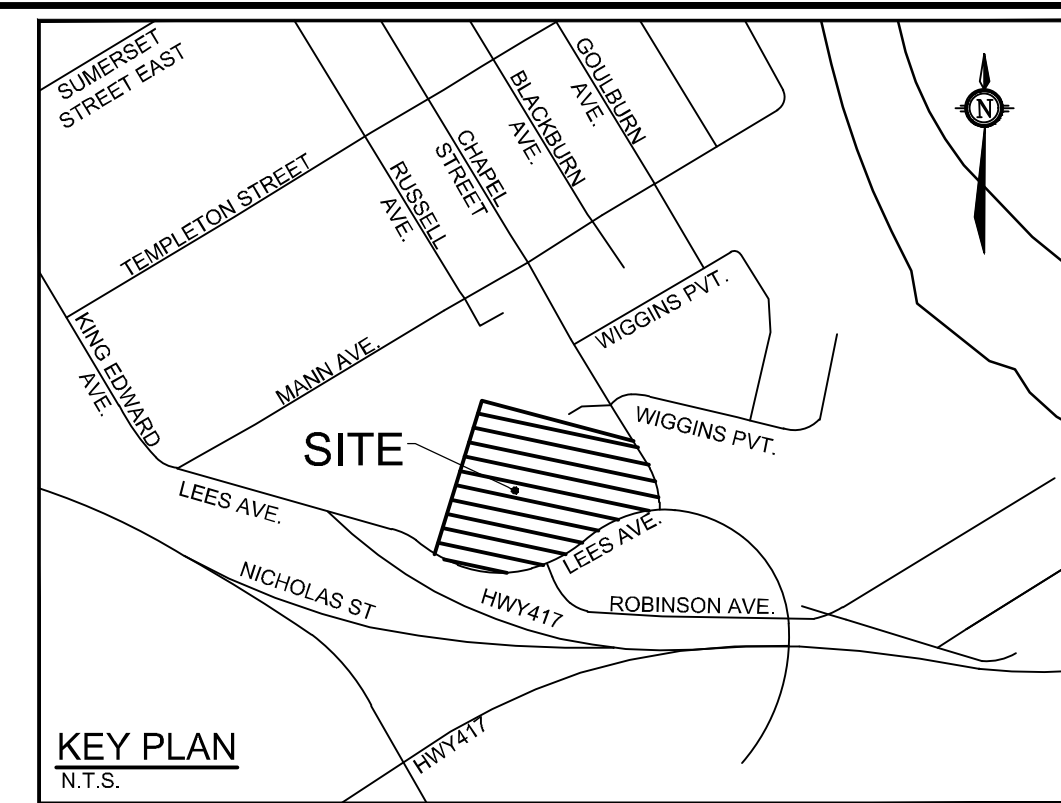

PROPOSED ELEVATION	69.91	69.97	69.95	69.94	69.92	69.94	70.00	70.00	69.97	69.98	69.98	70.00	70.00	69.97	PROPOSED ELEVATION
TOP OF WM ELEVATION	67.52	67.53	67.55	67.54	67.52	67.54	67.60	67.60	67.57	67.58	67.58	67.60	67.60	67.57	TOP OF WM ELEVATION
STORM SEWER INVERTS															STORM SEWER INVERTS
SANITARY SEWER INVERTS															SANITARY SEWER INVERTS
EXISTING ELEVATION	69.99	69.97	69.95	69.94	69.92	69.94	70.00	70.00	69.97	69.98	69.98	70.00	70.00	69.97	EXISTING ELEVATION
CHAINAGE	2+000	2+103.65 EX. 18" V&V	2+103.65 EX. 18" V&V	2+103.65 EX. 18" V&V	2+103.65 EX. 18" V&V	2+103.65 EX. 18" V&V	2+103.65 EX. 18" V&V	2+103.65 EX. 18" V&V	2+103.65 EX. 18" V&V	2+103.65 EX. 18" V&V	2+103.65 EX. 18" V&V	2+103.65 EX. 18" V&V	2+103.65 EX. 18" V&V	2+103.65 EX. 18" V&V	CHAINAGE

Andrew McCreight

ANDREW MCCREIGHT
MANAGER, DEVELOPMENT REVIEW CENTRAL
PLANNING, DEVELOPMENT & BUILDING SERVICES
DEVELOPMENT DEPARTMENT, CITY OF OTTAWA

APPROVED
By Andrew McCreight at 8:45 am, Jun 14, 2024

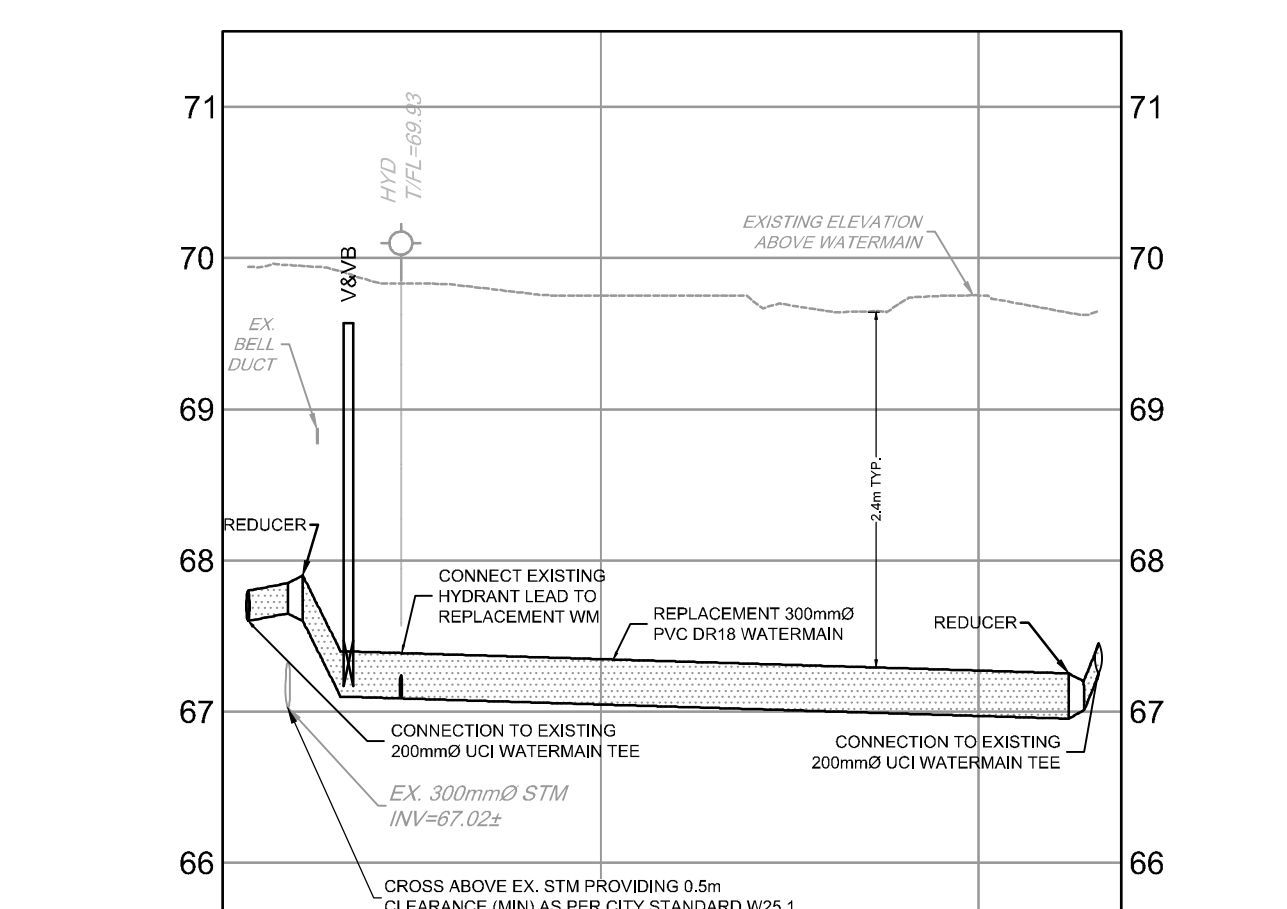

PROPOSED ELEVATION	69.96	69.97	69.95	69.94	69.92	PROPOSED ELEVATION
TOP OF WM ELEVATION	67.50	67.51	67.53	67.52	67.50	TOP OF WM ELEVATION
STORM SEWER INVERTS						STORM SEWER INVERTS
SANITARY SEWER INVERTS						SANITARY SEWER INVERTS
EXISTING ELEVATION	69.94	69.97	69.95	69.94	69.92	EXISTING ELEVATION
CHAINAGE	1+000	1+004.32 REDUCER	1+008.33 V&V	1+012.34 EX. 18" V&V	1+016.35 EX. 18" V&V	CHAINAGE

REFER TO 119171-NDT FOR ADDITIONAL NOTES

NOTE: THE POSITION OF ALL POLE LINES, CONDUITS, WATERMANS, SEWERS AND OTHER UNDERGROUND AND OVERGROUND UTILITIES AND STRUCTURES IS NOT NECESSARILY SHOWN ON THE CONTRACT DRAWINGS, AND WHERE SHOWN, THE ACCURACY OF THE POSITION OF SUCH UTILITIES AND STRUCTURES IS NOT GUARANTEED. BEFORE STARTING WORK, DETERMINE THE EXACT LOCATION OF ALL SUCH UTILITIES AND STRUCTURES AND ASSUME ALL LIABILITY FOR DAMAGE TO THEM.

No.	REVISION	DATE	BY
6	REVISED PER CITY COMMENTS	JAN 19/24	FST
5	ISSUED FOR MUNICIPAL CONSENT	NOV 17/23	FST
4	REVISED SIDEWALK/BICYCLE TRACK ALONG LEES AVE.	NOV 3/23	FST
3	RE-ISSUED FOR SITE PLAN APPROVAL	OCT 07/22	FST
2	REVISED PER CITY COMMENTS	MAR 30/21	FST
1	ISSUED FOR SITE PLAN APPROVAL	NOV 15/21	FST

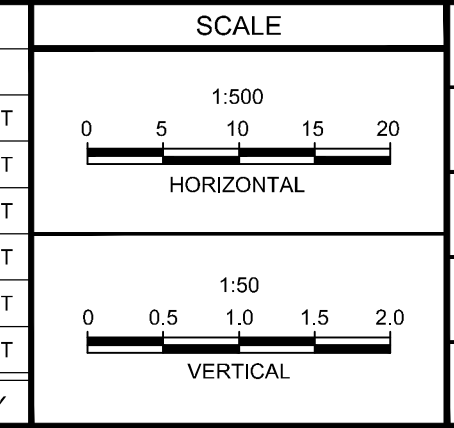

FOR REVIEW ONLY	DESIGN
CHECKED	DWM
DRAWN	FST
CHECKED	DWM
APPROVED	FST
	FST



LOCATION
OTTAWA, ONTARIO
2 ROBINSON AVE.

DRAWING NAME
PLAN AND PROFILE
CHAPEL AVENUE, STATION 1+000 TO 1+060
CHAPEL AVENUE, STATION 2+000 TO 2+123

PROJECT No. 119171
REV # 6
DRAWING No. 119171-PR1

NOVATECH
Engineers, Planners & Landscape Architects
Suite 200, 240 Michael Cowland Drive
Ottawa, Ontario, Canada K2M 1P6
Telephone (613) 254-9643
Facsimile (613) 254-5867
Website www.novatech-eng.com

C:\03\119171-NDT\Design\119171-PR1.dwg PRT_1 Jun 19, 2024 - 8:02am cadswr

18357