

Plant List					
ID	Qty	Botanical Name	Common Name	Scheduled Size	Remarks
TREES					
As	1	Acer rubrum 'Autumn Spire'	Red Maple	100mm caliper	WB, Staked
Co	1	Celtis occidentalis	Common Hackberry	60mm caliper	WB, Staked
GD	1	Gleditsia triacanthos inermis 'Draves'	Streetkeeper Honeylocust	70mm caliper	WB, Staked
Mj	1	Malus Evereste	Domestic Apple	50mm caliper	WB, Staked
MHG	1	Malus x 'Harvest Gold'	Harvest Gold Crabapple	50mm caliper	WB, Staked
PcN	1	Pinus cembra 'Nana'	Dwarf Swiss Stone Pine	100 cm ht	WB, specimen
Pc	2	Pyrus calleryana	Callery Pear	70mm caliper	WB, Staked
SHRUBS					
CaW	1	Caragana arborecens 'Walker'	Walker's Weeping Peashrub	125cm STEM	WB, specimen
PODM	1	Physocarpus opulifolius 'Donna May'	Little Devil Ninebark	2 gallon pot	Potted
Sp	8	Spiraea prunifolia	Bridal Wreath Spirea	50 cm ht.	Bare root
SPMK	11	Syringa patula 'Miss Kim'	Miss Kim Dwarf Lilac	100cm ht.	3 gallon Pot
ToH	10	Thuja occidentalis 'Holmstrup'	Holmstrup Eastern Arborvitae	100 cm ht.	Potted
ORNAMENTAL GRASSES					
CaKF	120	Calamagrostis x acutiflora 'Karl Foerster'	Karl Foerster Feather Reed Grass	1 gallon pot	Potted
PvHM	37	Panicum virgatum 'Heavy Metal'	Heavy Metal Switch Grass	1 gallon pot	Potted
PERENNIALS					
PvA	122	Sun perennials (minimum 3 species mix)	Purple Coneflower, Shasta Daisy, Russian Sage		
PvB	41	Shade perennials (minimum 3 species mix)	Hostas, Ferns, Rodgersia		
PvC	47	Shade groundcovers (minimum 3 species mix)	Cranesbill, Spotted Dead Nettle, Woodland Stoncrop		

CONTRACTOR TO REPORT ANY DISCREPANCIES FOUND BETWEEN PLAN & PLANT LIST PRIOR TO PLANTING

3996 Innes				
Soil Volume Area, Tree Quantity and Size	Tree Quantity	OTTAWA TARGET SOIL VOLUME (m3)	Design Soil Volume	SOIL ADEQUACY percentage
AREA A - 1 medium shade tree				
plant bed (34.5 sq m x 0.7 avg metre deep)	1	25.0	24.2	96.60%
AREA B - 1 small columnar evergreen (10cm DBH)*				
plant bed (11 sq m x 0.6 avg metre deep)	1	6.0	6.6	110.00%
AREA C - 1 small shade tree, 1 small ornamental tree (15cm DBH)*, 1 small ornamental tree (8cm DBH)*				
plant bed (67 sq m x 0.4 avg metre deep)	3	21.1	26.8	127.01%
AREA D - 2 large shade trees				
plant bed (24 sq m x 1.2 avg metre deep)	2	36.0	28.8	80.00%
AREA E - 4 large shrubs*				
plant bed (14.8 sq m x 0.4 avg metre deep)	4	5.6	5.9	105.71%

4.5 metre offset – allowance for low water requirement plants such as small ornamental plants such as horticultural cedars, junipers, grafted deciduous such as caragana, small crab apples under 4.5 metre height.

4.5 to 7.5 metre offset – allowance for low water requirement trees up to 7.5 metre mature height.

Beyond 7.5 metres – low water requirement trees 7.5 to 14 metre mature height.
Trees over 14 metre mature height to be planted mature height away from building.

ALL PLANT MATERIAL SHALL BE WARRANTIED FOR TWO YEARS FROM THE DATE OF SUBSTANTIAL PERFORMANCE AS DETERMINED BY THE CITY OF OTTAWA.

NOTE
THIS PLAN IS ISSUED FOR SITE PLAN CONTROL SUBMISSION ONLY.
ADDITIONAL DETAILING AND SPECIFICATIONS ARE REQUIRED PRIOR TO TENDERING OR
CONSTRUCTION.

DRAWING TO BE READ IN CONJUNCTION WITH TREE CONSERVATION REPORT. REFER TO TREE CONSERVATION REPORT PREPARED BY JFS DATED 2021-11-18 FOR TREE PROTECTION MEASURES AND DETAILS. MAP REVISED 2022-07-08

GENERAL NOTES

- 1 All general site information and conditions compiled from existing plans, surveys and consultant's field notes. Report all discrepancies to you for any work. No responsibility is born by the Consultant for unknown subsurface conditions.
- 2 The location of the utilities is approximate only, and the exact location should be determined by consulting the municipal authorities and utility companies concerned. The Contractor shall prove the location of utilities and shall be responsible for adequate protection from damage.
- 3 All dimensions shown are to be verified on site prior to any construction. No deviations are to be made from the layouts as shown on this plan without prior consultation with the Landscape Architect and Owner.
- 4 Obtain approval of Landscape Architect for granular base and layout of all pavement areas prior to construction.
- 5 Stake planting locations and receive approval of Landscape Architect, prior to excavation of any planting pits. No substitutions of plant material shall be made without prior approval of the Landscape Architect.
- 6 Where clay is encountered proper drainage must be ensured in trees/shrub pits, prior to planting. Have method approved by Landscape Architect.
- 7 All sodded areas to receive a minimum of 150mm of topsoil over graded sub-base. If sod with mesh is used, mesh to be removed completely during sodding operations. Sod shall come from an approved source and shall be laid within 24 hours of being cut in the nursery. Only nursery sod shall be used.
- 8 Final subgrade is to approved by the Landscape Architect prior to sod being laid.
- 9 Maintain positive surface runoff through the entire construction period.
- 10 Reinststate all areas and items damaged as a result of construction activities.

7	Re-issued SPC submission	2024/11/01
6	Issued for Coordination	2024/10/01
6	Re-issued SPC submission	2024/07/05
5	Re-issued SPC submission	2023/07/20
4	Re-issued SPC submission	2023/04/24
3	Re-issued SPC submission	2023/01/09
2	Re-issued SPC submission	2022/07/08
1	Issued for SPC submission	2021/11/22
no.	issue / revision	date

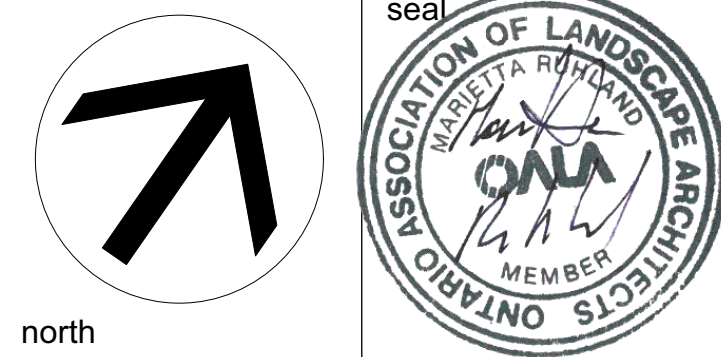

Ruhland & Associates Ltd
landscape architecture • urban design • site planning
Ph 613-224-4744 Fx 613-224-1131 info@rala.ca www.rala.ca

project

**3996 INNES RD,
OTTAWA ON**

drawing title

LANDSCAPE PLAN

scale 1:100	drawn by D.A / T. F	designed by M. Ruhland
	checked by M. Ruhland	
project number 21-1647	drawing number L - 01	

Contractor to check and verify all dimensions on the job

SOIL VOLUME NOTES TO GO WITH L1

TREE SOIL VOLUME REQUIREMENTS:
- STANDARD TREE SOIL VOLUMES
QUANTITIES INCLUDE THE TOP 900-1000mm
OF SOIL/EXISTING SUBSOIL LAYER TO
CALCULATE TOTAL SOIL VOLUMES REQUIRED
BY CITY OF OTTAWA FOR SUSTAINABLE TREE
GROWTH. WHERE LARGER SOFT AREAS ARE
AVAILABLE, THE TOP 400-500mm LAYER IS
USED TO CALCULATE SOIL VOLUMES.

- WHERE EXISTING MATERIAL BELOW THE
SPECIFIED TOPSOIL IS NOT CONDUCTIVE TO
TREE GROWTH, AN ADDITIONAL LAYER OF
PLANTING MEDIUM IS TO BE INSTALLED
BELOW SPECIFIED TOPSOIL DEPTH TO OBTAIN
THE SOIL VOLUME DEPTH REQUIRED.

- REFER TO SOIL VOLUME CHART AND PLANS
FOR AREA WHERE TREE SOIL VOLUMES ARE
REQUIRED.

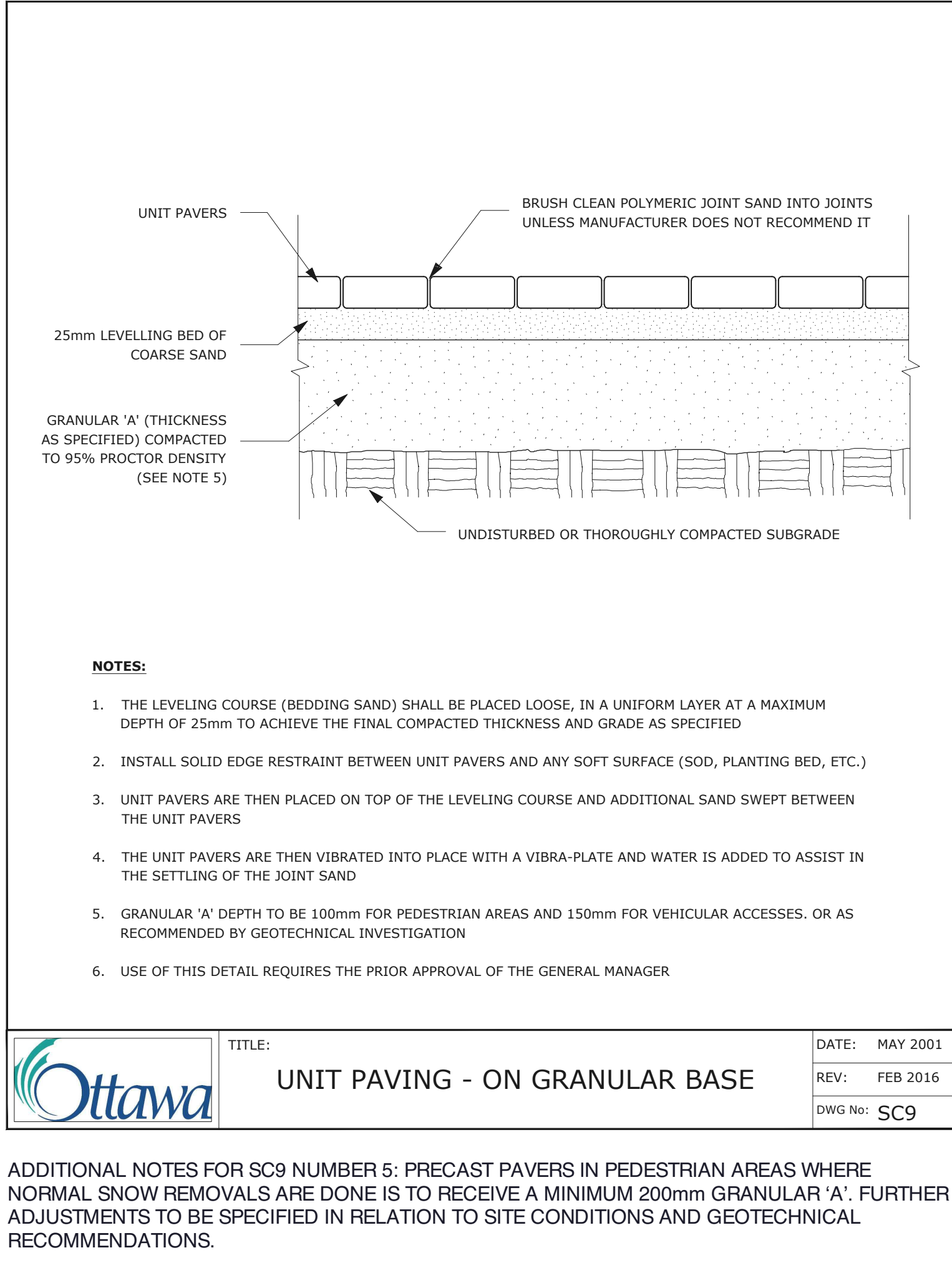
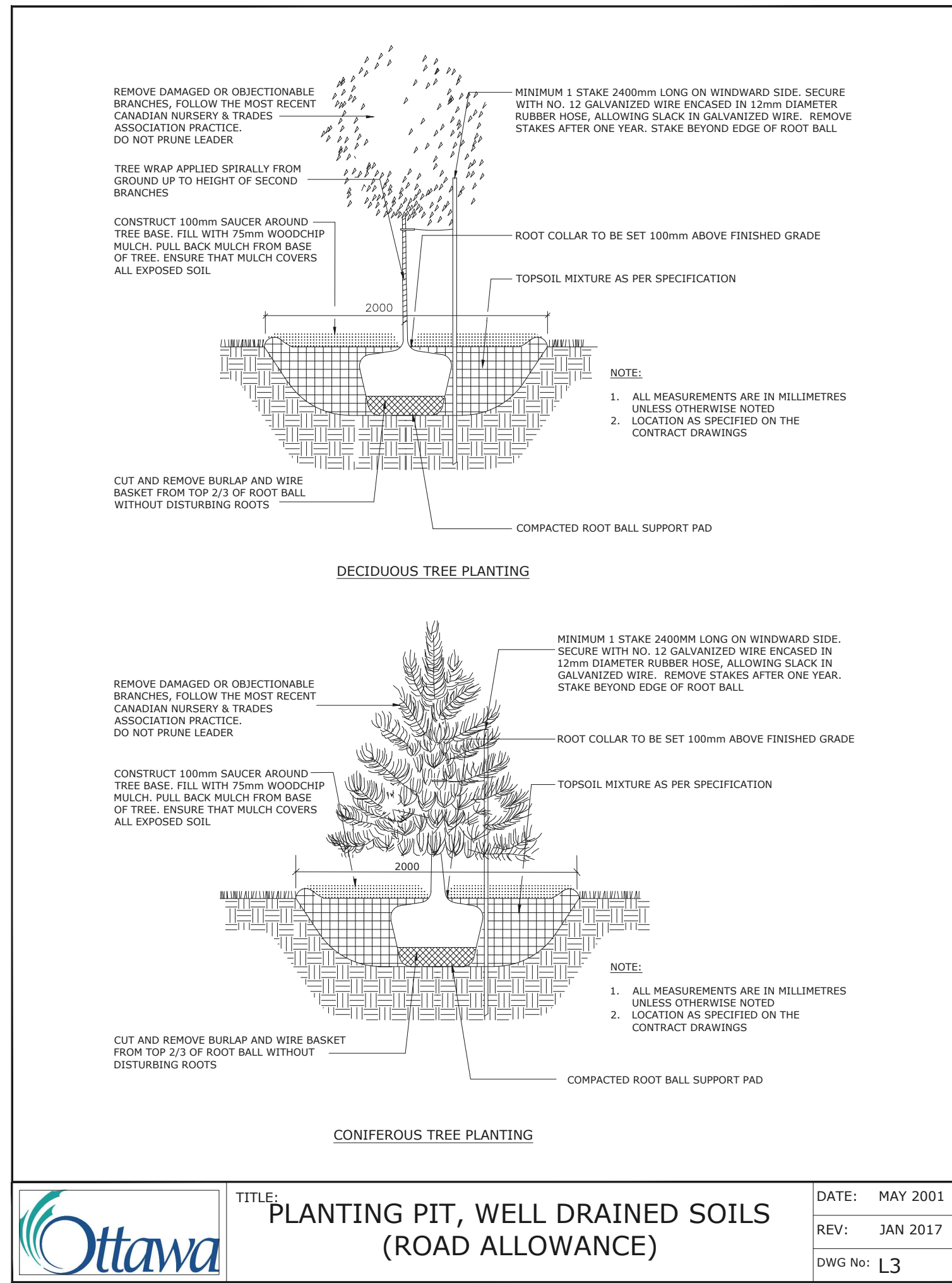
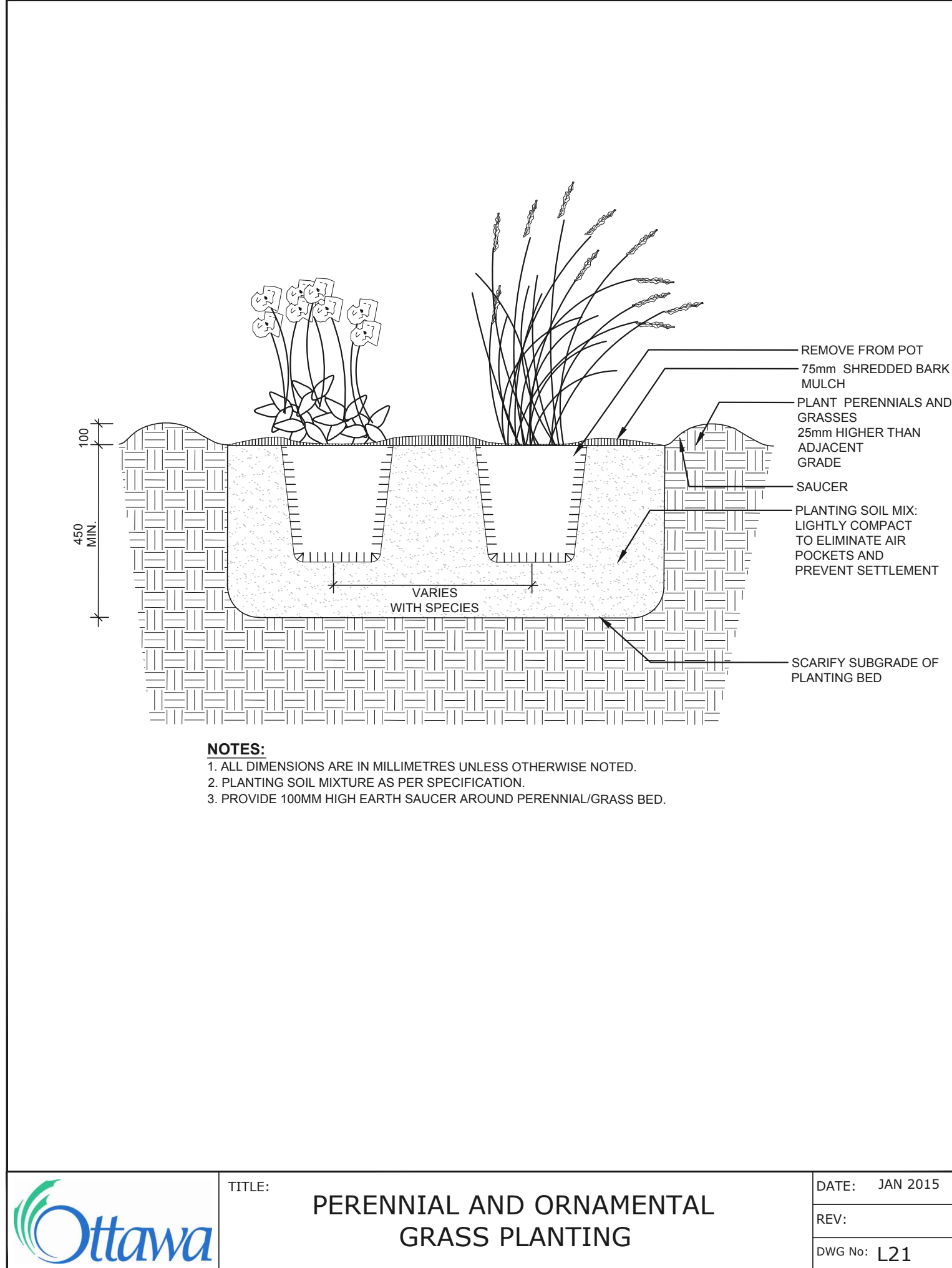
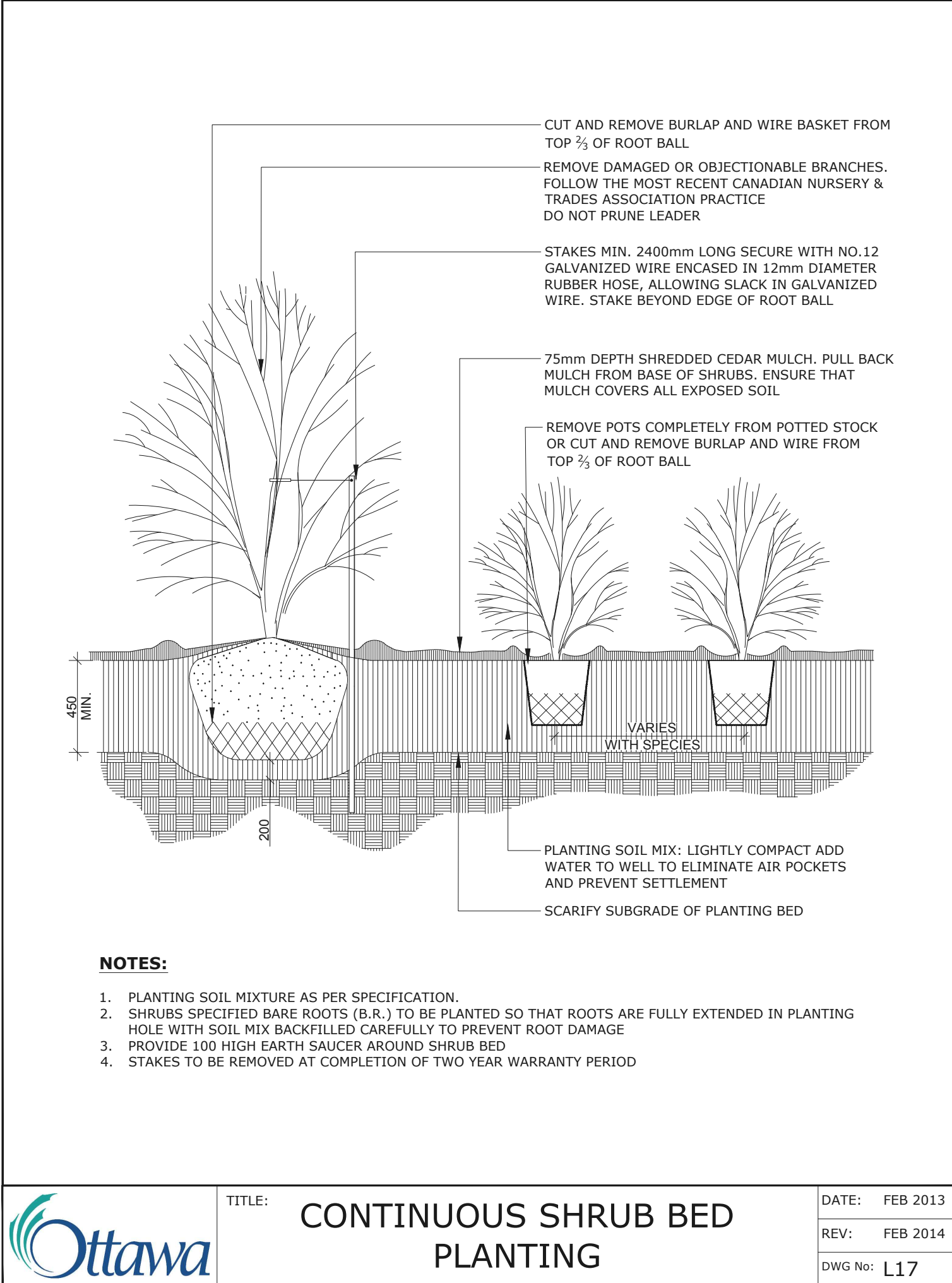
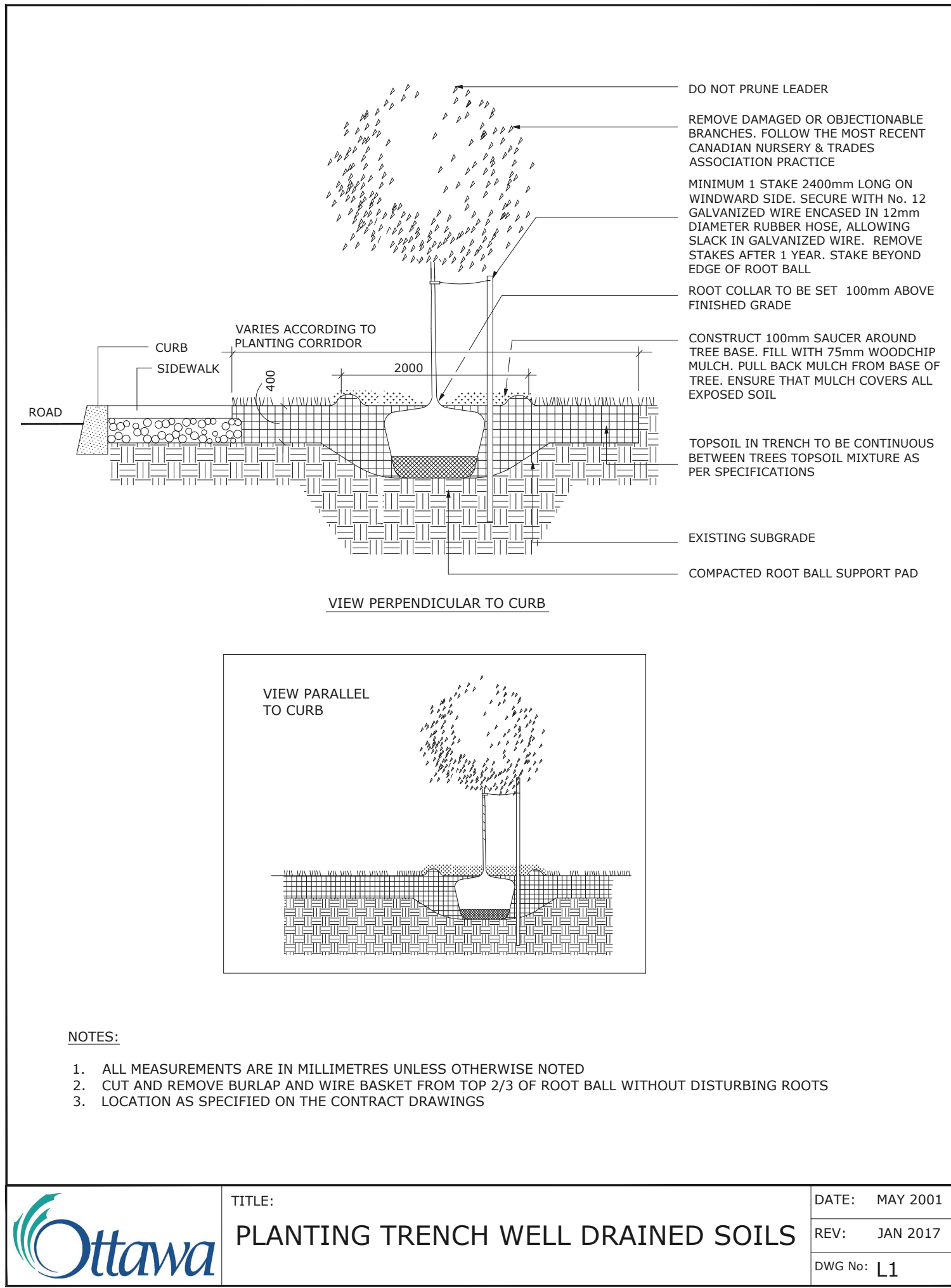

GENERAL NOTES

1. All general site information and conditions compiled from existing plans, surveys and consultant's field notes. Report all discrepancies prior to any work. No responsibility is born by the Consultant for unknown subsurface conditions.
2. The location of the utilities is approximate only, and the exact location should be determined by consulting the municipal authorities and utility companies concerned. The Contractor shall prove the location of utilities and shall be responsible for adequate protection from damage.
3. All dimensions shown are to be verified on site prior to any construction. No deviations are to be made from the layouts as shown on this plan without prior consultation with the Landscape Architect and Owner.
4. Obtain approval of Landscape Architect for granular base and layout of all pavement areas prior to construction.
5. Stake planting locations and receive approval of Landscape Architect, prior to excavation of any planting pits. No substitutions of plant material shall be made without prior approval of the Landscape Architect.
6. Where clay is encountered proper drainage must be ensured in tree/shrub pits, prior to planting. Have method approved by Landscape Architect.
7. All sodded areas to receive a minimum of 150mm of topsoil over graded sub-base. If sod with mesh is used, mesh to be removed completely during sodding operations. Sod shall come from an approved source and shall be laid within 24 hours of being cut in the nursery. Only nursery sod shall be used.
8. Final subgrade is to approved by the Landscape Architect prior to sod being laid.
9. Maintain positive surface runoff through the entire construction period.
10. Reinststate all areas and items damaged as a result of construction activities.

7	Re-issued SPC submission	2024/11/01
6	Issued for Coordination	2024/10/01
6	Re-issued SPC submission	2024/07/05
5	Re-issued SPC submission	2023/07/20
4	Re-issued SPC submission	2023/04/24
3	Re-issued SPC submission	2023/01/09
2	Re-issued SPC submission	2022/07/08
1	Issued for SPC submission	2021/11/22
no.	issue / revision	date



north



project

3996 INNES RD,
OTTAWA ON

drawing title

DETAILS

scale	drawn by D.A. / T. F.	designed by M. Ruhland
	checked by M. Ruhland	
project number	drawing number	
21-1647	L - 02	

Contractor to check and verify all dimensions on the job

JOHN SEVIGNY C.E.T.
MANAGER (A), DEVELOPMENT REVIEW EAST
PLANNING, DEVELOPMENT & BUILDING SERVICES
DEPARTMENT, CITY OF OTTAWA

APPROVED
By sevignyjo at 4:04 pm, May 27, 2025

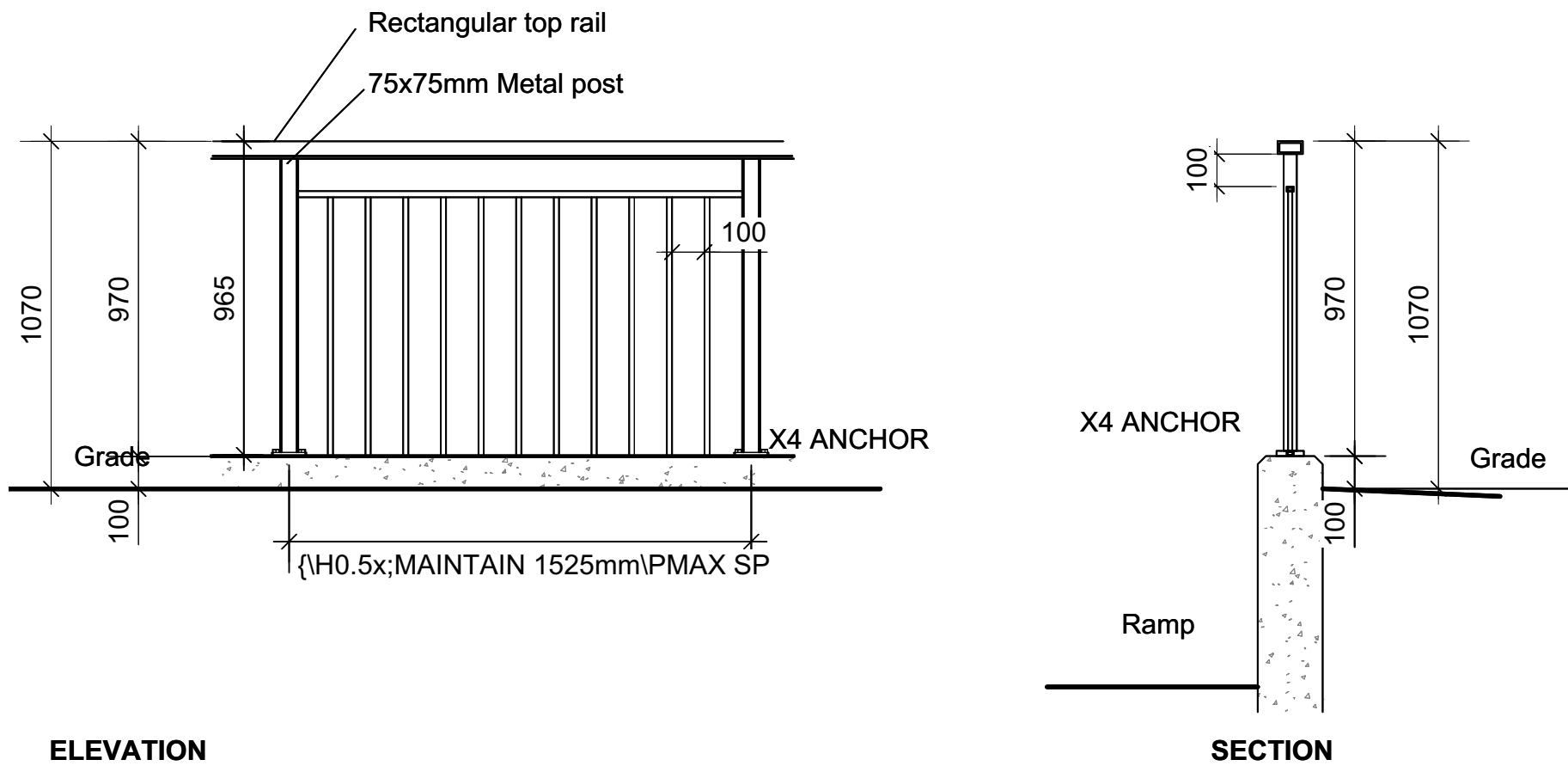

ELEVATION

1
L-03

METALLIC GUARD RAIL

Scale: NTS

REFER TO SITE PLAN FOR LOCATIONS

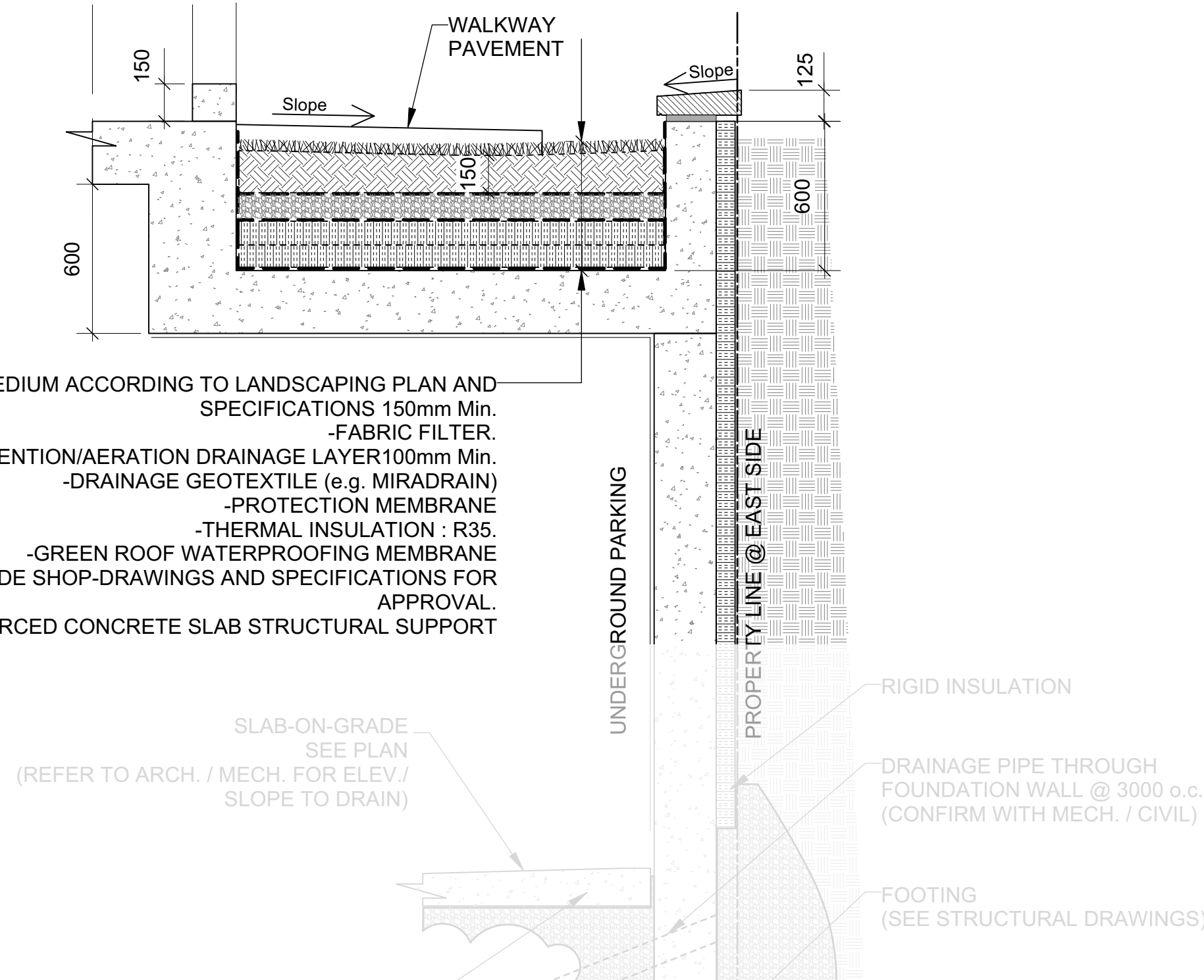

2
L-03

SECTION ALONG EAST PROPERTY LINE

Scale: NTS



3
L-03

SKYLINE OUTDOOR PATIO HARD-TOP GAZEBO

Canvas, w/ Bug Net, Black 10'x12'



4
L-03

GLOBAL INDUSTRIAL 4' PARK BENCH

Tan, w/Backrest

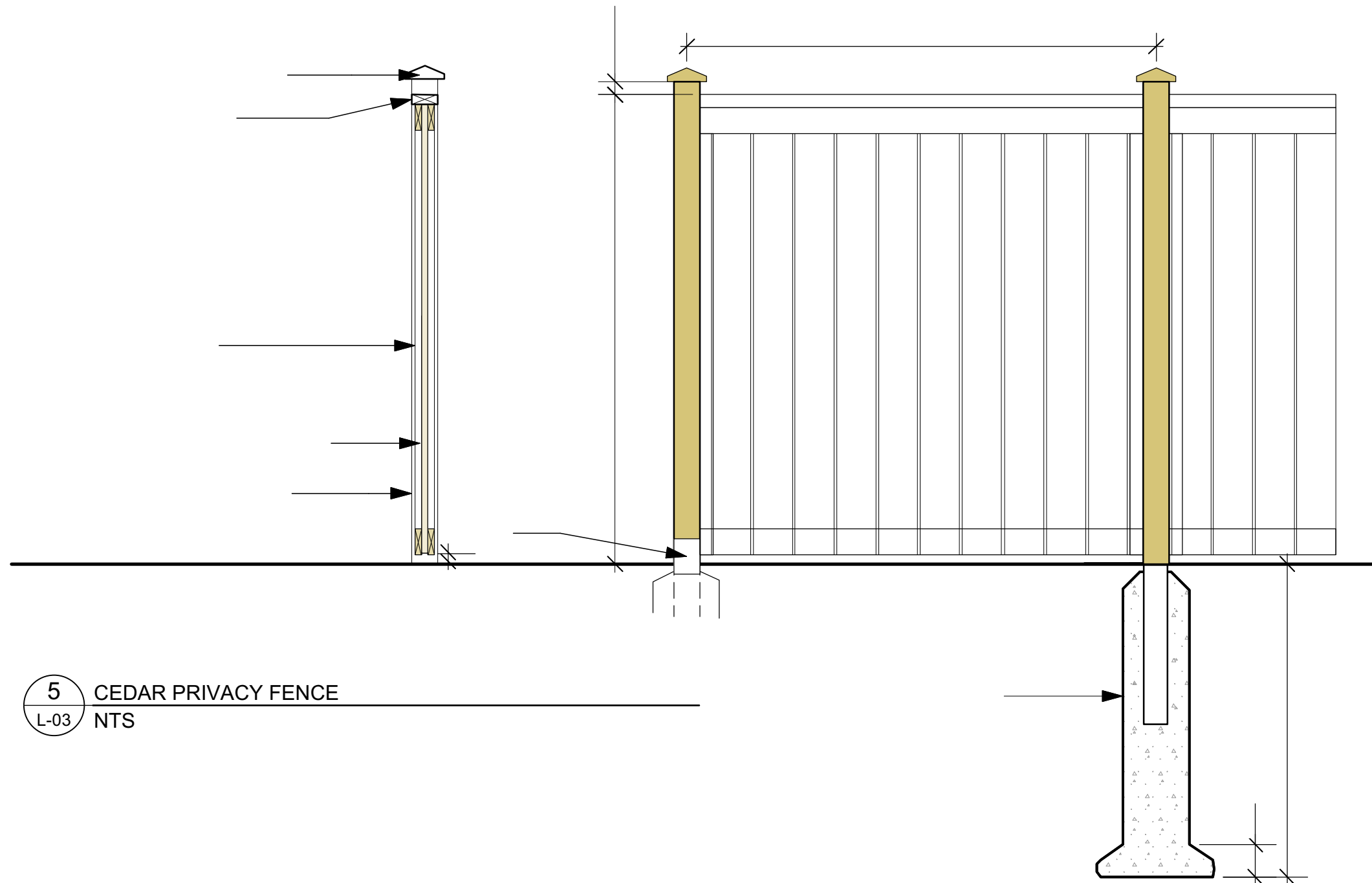

5
L-03

CEDAR PRIVACY FENCE

NTS



JOHN SEVIGNY C.E.T.
MANAGER (A), DEVELOPMENT REVIEW EAST
PLANNING, DEVELOPMENT & BUILDING SERVICES
DEPARTMENT, CITY OF OTTAWA

APPROVED
By sevignyjo at 4:05 pm, May 27, 2025

GENERAL NOTES

- 1 All general site information and conditions compiled from existing plans, surveys and consultant's field notes. Report all discrepancies prior to any work. No responsibility is born by the Consultant for unknown subsurface conditions.
- 2 The location of the utilities is approximate only, and the exact location should be determined by consulting the municipal authorities and utility companies concerned. The Contractor shall prove the location of utilities and shall be responsible for adequate protection from damage.
- 3 All dimensions shown are to be verified on site prior to any construction. No deviations are to be made from the layouts as shown on this plan without prior consultation with the Landscape Architect and Owner.
- 4 Obtain approval of Landscape Architect for granular base and layout of all pavement areas prior to construction.
- 5 Stake planting locations and receive approval of Landscape Architect, prior to excavation of any planting pits. No substitutions of plant material shall be made without prior approval of the Landscape Architect.
- 6 Where clay is encountered proper drainage must be ensured in tree/shrub pits, prior to planting. Have method approved by Landscape Architect.
- 7 All sodded areas to receive a minimum of 150mm of topsoil over graded sub-base. If sod with mesh is used, mesh to be removed completely during sodding operations. Sod shall come from an approved source and shall be laid within 24 hours of being cut in the nursery. Only nursery sod shall be used.
- 8 Final subgrade is to approved by the Landscape Architect prior to sod being laid.
- 9 Maintain positive surface runoff through the entire construction period.
- 10 Reinststate all areas and items damaged as a result of construction activities.

7	Re-issued SPC submission	2024/11/01
6	Issued for Coordination	2024/10/01
6	Re-issued SPC submission	2024/07/05
5	Re-issued SPC submission	2023/07/20
4	Re-issued SPC submission	2023/04/24
3	Re-issued SPC submission	2023/01/09
2	Re-issued SPC submission	2022/07/08
1	Issued for SPC submission	2021/11/22

no.	issue / revision	date
		

Ruhland & Associates Ltd
landscape architecture • urban design • site planning
Ph 613-224-4744 Fx 613-224-1331 info@rala.ca www.rala.ca

project

**3996 INNES RD,
OTTAWA ON**

drawing title

DETAILS

scale	drawn by D.A. / T. F.	designed by M. Ruhland
	checked by M. Ruhland	
project number 21-1647	drawing number L - 03	

Contractor to check and verify all dimensions on the job