

CONSULTANT - S.U. CONSULTANT

CONSULTANT - S.U. CONSULTANT

CLIENT REF #

PROJECT

ACCESS STORAGE LEGGET DRIVE

KEY PLAN

DISCLAIMER: THE DRAWING AND DESIGN IS COPYRIGHT PROTECTED WHICH SHALL NOT BE REPRODUCED OR TRANSMITTED IN ANY FORM OR BY ANY MEANS, ELECTRONIC OR MECHANICAL, INCLUDING PHOTOCOPYING, RECORDING, OR BY ANY INFORMATION STORAGE AND RETRIEVAL SYSTEM, WITHOUT THE WRITTEN PERMISSION OF ARCHITECTURE 49. THIS DRAWING IS NOT TO BE SCALED.

ISSUED FOR: REVISION

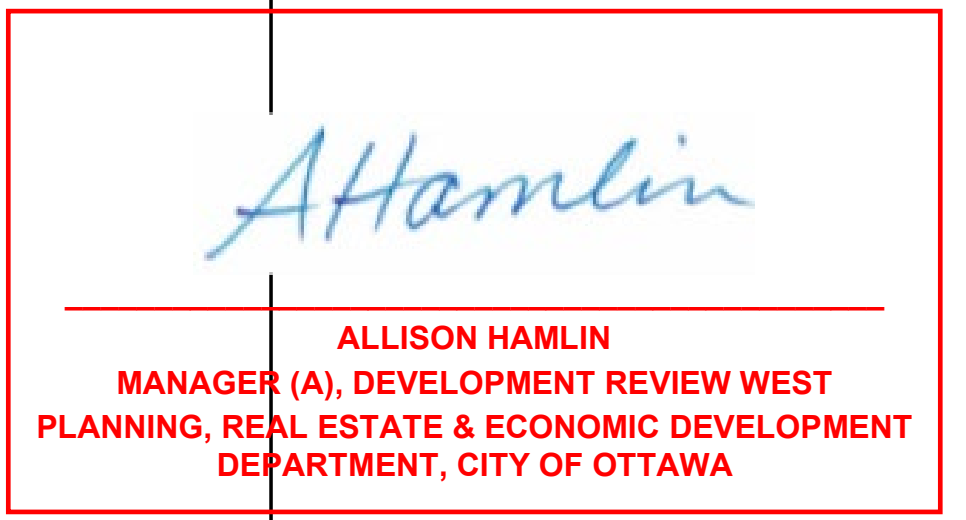

**APPROVED**  
By Allison Hamlin at 5:22 pm, Aug 23, 2023

PROJECT NO: 216-0000043  
ISSUE DATE: MARCH 23, 2022  
DATE: OCT 25, 2023  
IF THE BAR IS NOT SHOWN, PLEASE CONSULT YOUR PLOTTING SCALE.

NO.	DATE	DESCRIPTION
1	3 AUG 31, 2022	ISSUED FOR SITE PLAN CONTROL, RESUBMISSION
2	1 MAR 23, 2022	ISSUED FOR SITE PLAN CONTROL, RESUBMISSION 2
3	1 MAR 23, 2022	ISSUED FOR SITE PLAN CONTROL, RESUBMISSION
4	1 OCT 25, 2023	ISSUED FOR SITE PLAN APPROVAL

TITLE: TREE PRESERVATION PLAN

SHEET NUMBER: L200 OF 2

DATE OF: 2023

LEGEND:

- PROPERTY LINE
- APPROXIMATE AREA OF WORK
- TREE PROTECTION BOUNDARY
- EXISTING DECIDUOUS TREE TO REMAIN. TREES TO REMAIN ARE TO BE PROTECTED TO CITY OF OTTAWA STANDARDS
- EXISTING DECIDUOUS TREE TO BE REMOVED
- EXISTING CONIFEROUS TREE TO REMAIN. TREES TO REMAIN ARE TO BE PROTECTED TO CITY OF OTTAWA STANDARDS
- EXISTING CONIFEROUS TREE TO BE REMOVED
- KEYNOTES:  
1. CLEAR AND GRUB EXISTING VEGETATED AREA AS SHOWN

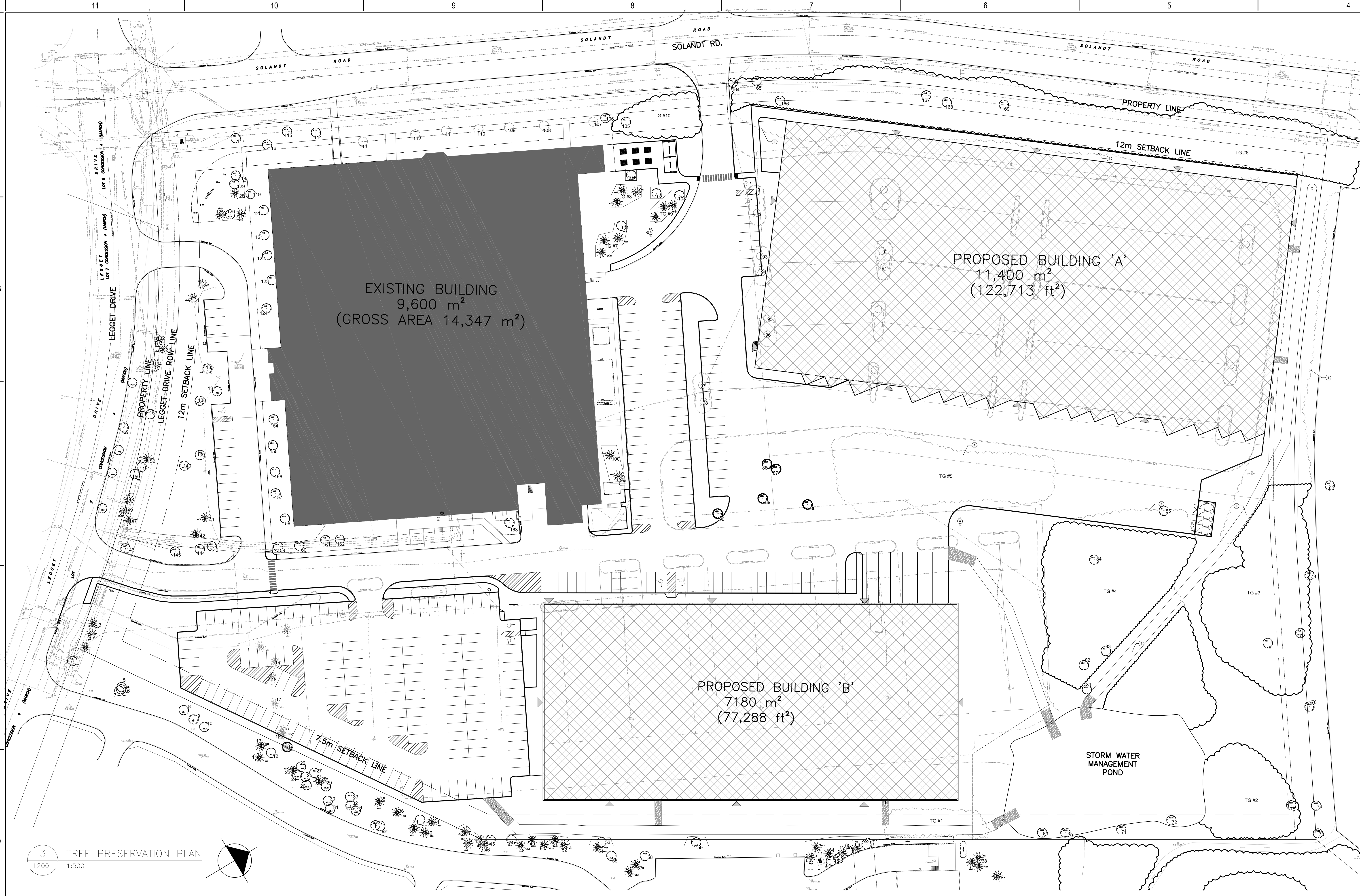

3 TREE PRESERVATION PLAN  
L200 1:500

TREE INVENTORY

Tree / Grouping ID	Species	DBH	Health Condition	EIS / TCR Notes	Planned Action	LA Remarks	Ownership	On Site
1	White spruce	30			Retain	No protection needed, outside scope of work.	Private on Site	
2	White spruce	54			Retain	No protection needed, outside scope of work.	Private on Site	
3	White spruce	30			Retain	No protection needed, outside scope of work.	Private on Site	
4	Freemans maple	32			Retain	No protection needed, outside scope of work.	Private on Site	
5	White elm	45			Retain	No protection needed, outside scope of work.	Private on Site	
6	White elm	26			Retain	No protection needed, outside scope of work.	Private on Site	
7	White elm	36			Retain	No protection needed, outside scope of work.	Private on Site	
8	White elm	43			Retain	No protection needed, outside scope of work.	Private on Site	
9	White elm	40			Retain	No protection needed, outside scope of work.	Private on Site	
10	White elm	50			Retain	No protection needed, outside scope of work.	Private on Site	
11	Norway spruce	20			Retain	No protection needed, outside scope of work.	Private on Site	
12	White elm	30			Retain	No protection needed, outside scope of work.	Private on Site	
13	Norway spruce	26			Retain	No protection needed, outside scope of work.	Private on Site	
14	Norway spruce	32			Remove	To be removed - within proposed building area	Private on Site	
15	Norway spruce	46			Remove	To be removed - within proposed building area	Private on Site	
16	Norway spruce	27			Remove	To be removed - within proposed building area	Private on Site	
17	Norway spruce	37			Remove	To be removed - within proposed building area	Private on Site	
18	Norway spruce	36			Remove	To be removed - within proposed building area	Private on Site	
19	Norway spruce	41			Remove	To be removed - within proposed building area	Private on Site	
20	Scots pine	41			Remove	To be removed - within proposed building area	Private on Site	
21	Norway spruce	31			Remove	To be removed - within proposed building area	Private on Site	
22	Marble maple			Multi stemmed, 3 stems, 17, 11, 28 dbh	Retain	No protection needed, outside scope of work.	Private on Site	
23	Norway spruce	15			Retain	No protection needed, outside scope of work.	Private on Site	
24	White elm	20			Retain	No protection needed, outside scope of work.	Private on Site	
25	Marble maple			Multi stemmed, 4 stems, 14, 11, 10, 11 dbh	Retain	No protection needed, outside scope of work.	Private on Site	
26	Norway maple	13			Retain	No protection needed, outside scope of work.	Private on Site	
27	White elm	23			Retain	No protection needed, outside scope of work.	Private on Site	
28	White cedar	20			Retain	No protection needed, outside scope of work.	Private on Site	
29	White elm	26			Retain	No protection needed, outside scope of work.	Private on Site	
30	Marble maple			Multi stemmed, 4 stems, 14, 13, 12, 10 dbh	Retain	No protection needed, outside scope of work.	Private on Site	
31	White elm	30			Retain	No protection needed, outside scope of work.	Private on Site	
32	Marble maple			Multi stemmed, 3 stems, 27, 12, 26 dbh	Retain	No protection needed, outside scope of work.	Private on Site	
33	Norway spruce	17			Retain	No protection needed, outside scope of work.	Private on Site	
34	Super maple	17			Retain	No protection needed, outside scope of work.	Private on Site	
35	White cedar			Multi stemmed, 8 stems, 10-12 dbh	Retain	No protection needed, outside scope of work.	Private on Site	
36	White cedar			Multi stemmed, 5 stems, 10-15 dbh	Retain	No protection needed, outside scope of work.	Private on Site	
37	Amur maple			Multi stemmed, 4 stems, 16, 16, 16, 11 dbh	Retain	No protection needed, outside scope of work.	Private on Site	
38	White spruce	21			Retain	No protection needed, outside scope of work.	Private on Site	
39	White spruce	20			Retain	No protection needed, outside scope of work.	Private on Site	
40	White spruce	20			Retain	No protection needed, outside scope of work.	Private on Site	
41	White spruce	20			Retain	No protection needed, outside scope of work.	Private on Site	
42	White spruce	28			Retain	No protection needed, outside scope of work.	Private on Site	
43	White spruce	32			Retain	No protection needed, outside scope of work.	Private on Site	
44	White spruce	32			Retain	No protection needed, outside scope of work.	Private on Site	
45	White spruce	37			Retain	No protection needed, outside scope of work.	Private on Site	
46	White spruce	27			Retain	No protection needed, outside scope of work.	Private on Site	
47	White elm	32			Retain	No protection needed, outside scope of work.	Private on Site	
48	White spruce	28			Retain	No protection needed, outside scope of work.	Private on Site	
49	White spruce	23			Retain	No protection needed, outside scope of work.	Private on Site	
50	White spruce	24			Retain	No protection needed, outside scope of work.	Private on Site	
51	White spruce	22			Retain	No protection needed, outside scope of work.	Private on Site	
52	White spruce	19			Retain	No protection needed, outside scope of work.	Private on Site	
53	White cedar				Retain	No protection needed, outside scope of work.	Private on Site	

Tree / Grouping ID	Species	DBH	Health Condition	EIS / TCR Notes	Planned Action	LA Remarks	Ownership	On Site
54	White elm	25			Retain	Protect during construction.	Private on Site	
55	White elm	28			Retain	No protection needed, outside scope of work.	Private on Site	
56	White spruce	28			Retain	No protection needed, outside scope of work.	Private on Site	
57	White cedar			Multi stemmed, 7 stems, 10-15 dbh	Retain	No protection needed, outside scope of work.	Private on Site	
58	White elm	28			Retain	No protection needed, outside scope of work.	Private on Site	
59	Red oak	42			Retain	Protect during construction.	Private on Site	
60	White spruce	28			Retain	No protection needed, outside scope of work.	Private on Site	
61	White elm	29			Retain	No protection needed, outside scope of work.	Private on Site	
62	White elm	18			Retain	No protection needed, outside scope of work.	Private on Site	
63	White spruce	18			Retain	Protect during construction.	Private on Site	
64	White spruce	25			Retain	No protection needed, outside scope of work.	Private on Site	
65	Ash	22			Retain	No protection needed, outside scope of work.	Private on Site	
66	White spruce	20			Retain	No protection needed, outside scope of work.	Private on Site	
67	White elm	25			Retain	Protect during construction.	Private on Site	
68	Marble maple	24			Retain	No protection needed, outside scope of work.	Private on Site	
69	White birch	12			Retain	No protection needed, outside scope of work.	Private on Site	
70	White birch	20			Retain	No protection needed, outside scope of work.	Private on Site	
71	White birch	22			Retain	No protection needed, outside scope of work.	Private on Site	
72	White birch	15			Retain	No protection needed, outside scope of work.	Private on Site	
73	Cottonwood	42			Retain	No protection needed, outside scope of work.	Private on Site	
74	Balsam poplar	24			Retain	No protection needed, outside scope of work.	Private on Site	
75	Balsam poplar	33			Retain	No protection needed, outside scope of work.	Private on Site	
76	Balsam poplar	56			Retain	No protection needed, outside scope of work.	Private on Site	
77	Balsam poplar	31			Retain	No protection needed, outside scope of work.	Private on Site	
78	Marble maple			Multi stemmed, 2 stems, 27 dbh	Retain	No protection needed, outside scope of work.	Private on Site	
79	Marble maple				Retain	No protection needed, outside scope of work.	Private on Site	
80	Balsam poplar	31			Retain	No protection needed, outside scope of work.	Private on Site	
81	Cottonwood	52			Remove	To be removed - within proposed building area	Private on Site	
82	Marble maple	34			Retain	No protection needed, outside scope of work.	Private on Site	
83	Marble maple	31			Remove	To be removed - within proposed building area	Private on Site	
84	Balsam poplar	30			Retain	No protection needed, outside scope of work.	Private on Site	
85	White spruce	18			Remove	To be removed - within proposed building area	Private on Site	
86	Cottonwood	70			Retain	No protection needed, outside scope of work.	Private on Site	
87	Maple sp	21			Remove	To be removed - within proposed building area	Private on Site	
88	Ash	30			Remove	To be removed - within proposed building area	Private on Site	
89	Freemans maple	31			Remove	To be removed - within proposed building area	Private on Site	
90	Freemans maple	15			Remove	To be removed - within proposed building area	Private on Site	
91	Freemans maple	11			Remove	To be removed - within proposed building area	Private on Site	
92	Freemans maple	11			Remove	To be removed - within proposed building area	Private on Site	
93	Freemans maple	17			Remove	To be removed - within proposed building area	Private on Site	
94	Freemans maple	15			Remove	To be removed - within proposed building area	Private on Site	
95	Freemans maple	16			Remove	To be removed - within proposed building area	Private on Site	
96	Freemans maple	16			Remove	To be removed - within proposed building area	Private on Site	
97	Freemans maple	16			Remove	To be removed - within proposed building area	Private on Site	
98	Freemans maple	16			Remove	To be removed - within proposed building area	Private on Site	
99	Scots pine	16			Remove	Branches to be pruned. Protect during construction.	Private on Site	
100	White spruce	12			Retain	Branches to be pruned. Protect during construction.	Private on Site	
101	White spruce			Grouping, 3 individuals, 15-20 dbh	Retain	Branches to be pruned. Protect during construction.	Private on Site	
102	Red oak	28			Retain	Branches to be pruned. Protect during construction.	Private on Site	
103	White spruce			Grouping, 3 individuals, 20-25 dbh	Retain	Branches to be pruned. Protect during construction.	Private on Site	
104	Marble maple	45			Retain	Branches to be pruned. Protect during construction.	Private on Site	

Tree / Grouping ID	Species	DBH	Health Condition	EIS / TCR Notes	Planned Action	LA Remarks	Ownership	On Site
107	Red oak	18			Retain	No protection needed, outside scope of work.	Private on Site	
108	Green ash	22	Damaged		Retain	No protection needed, outside scope of work.	Private on Site	
109	Thornling aspen			Grouping, 13 individuals, 10-20 dbh	Retain	No protection needed, outside scope of work.	Private on Site	
110	Freemans maple	11			Retain	No protection needed, outside scope of work.	Private on Site	
111	Freemans maple	18			Retain	No protection needed, outside scope of work.	Private on Site	
112	Freemans maple	12			Retain	No protection needed, outside scope of work.	Private on Site	
113	Freemans maple	15			Retain	No protection needed, outside scope of work.	Private on Site	
114	Freemans maple	17			Retain	No protection needed, outside scope of work.	Private on Site	
115	Freemans maple	17			Retain	No protection needed, outside scope of work.	Private on Site	
116	Freemans maple	15			Retain	No protection needed, outside scope of work.	Private on Site	
117	Freemans maple	15			Retain	No protection needed, outside scope of work.	Private on Site	
118	Freemans maple	16			Retain	No protection needed, outside scope of work.	Private on Site	
119	Cherry sp	12			Retain	No protection needed, outside scope of work.	Private on Site	
120	Cherry sp	13			Retain	No protection needed, outside scope of work.	Private on Site	
121	Cherry sp	10			Retain	No protection needed, outside scope of work.	Private on Site	
122	Cherry sp	13			Retain	No protection needed, outside scope of work.	Private on Site	
123	Cherry sp	10			Retain	No protection needed, outside scope of work.	Private on Site	
124	Cherry sp	11			Retain	No protection needed, outside scope of work.	Private on Site	
125	Cherry sp	11			Retain	No protection needed, outside scope of work.	Private on Site	
126	Cherry sp	10			Retain	No protection needed, outside scope of work.	Private on Site	
127	Cherry sp	11			Retain	No protection needed, outside scope of work.	Private on Site	
128	Cherry sp	12			Retain	No protection needed, outside scope of work.	Private on Site	
129	Cherry sp	12			Retain	No protection needed, outside scope of work.	Private on Site	
130	White spruce	12			Retain	No protection needed, outside scope of work.	Private on Site	
131	White spruce	15			Retain	No protection needed, outside scope of work.	Private on Site	
132	White spruce	11			Retain	No protection needed, outside scope of work.	Private on Site	
133	Red pine	16			Retain	No protection needed, outside scope of work.	Private on Site	
134	White spruce	12			Retain	No protection needed, outside scope of work.	Private on Site	
135	Scots pine	44			Retain	No protection needed, outside scope of work.	Private on Site	
136	Scots pine	40			Retain	No protection needed, outside scope of work.	Private on Site	
137	Scots pine	32			Retain	No protection needed, outside scope of work.	Private on Site	
138	Scots pine	25			Retain	No protection needed, outside scope of work.	Private on Site	
139	White spruce	28			Retain	No protection needed, outside scope of work.	Private on Site	
140	Freemans maple	22			Retain	No protection needed, outside scope of work.	Private on Site	
141	Freemans maple	31			Retain	No protection needed, outside scope of work.	Private on Site	
142	Freemans maple	36			Retain	No protection needed, outside scope of work.	Private on Site	
143	Freemans maple	18			Retain	No protection needed, outside scope of work.	Private on Site	
144	Freemans maple	31			Retain	No protection needed, outside scope of work.	Private on Site	
145	Freemans maple	27			Retain	No protection needed, outside scope of work.	Private on Site	
146	Scots pine	37			Retain	No protection needed, outside scope of work.	Private on Site	
147	Scots pine	39			Retain	No protection needed, outside scope of work.	Private on Site	
148	Cherry sp	12			Retain	No protection needed, outside scope of work.	Private on Site	
149	Cherry sp	11			Retain	No protection needed, outside scope of work.	Private on Site	
150	Cherry sp	10			Retain	No protection needed, outside scope of work.	Private on Site	
151	Cherry sp	11			Retain	No protection needed, outside scope of work.	Private on Site	
152	Scots pine	17			Retain	No protection needed, outside scope of work.	Private on Site	
153	Scots pine	20			Retain	No protection needed, outside scope of work.	Private on Site	
154	Scots pine	30			Retain	No protection needed, outside scope of work.	Private on Site	
155	Maple sp	23			Retain	No protection needed, outside scope of work.	Private on Site	
156								