

Copyright Reserved  
The Contractor shall verify and be responsible for all dimensions. DO NOT scale the drawing - any errors or omissions shall be reported to Stantec without delay.  
The Copyrights to all designs and drawings are the property of Stantec. Reproduction or use for any purpose other than that authorized by Stantec is forbidden.

Legend

- R100A** SANITARY DRAINAGE AREA ID#
- 0.31 | 50** POPULATION COUNT
- SANITARY DRAINAGE AREA ha.
- G100A** SANITARY DRAINAGE AREA ID#
- 0.11 | INFL** INFILTRATION RATE OF 0.33 L/s/Ha APPLIED
- SANITARY DRAINAGE AREA ha.
- SANITARY DRAINAGE AREA
- PROPOSED SANITARY MH AND SEWER
- EXISTING SANITARY MH AND SEWER

Notes

SANITARY STATS	
<b>BUILDING A</b>	
71 - 1 BEDROOM UNITS @ 1.4 PPU = 98 PEOPLE	
127 - 2 BEDROOM UNITS @ 2.1 PPU = 267 PEOPLE	
5 - 3 BEDROOM UNITS @ 3.1 PPU = 16 PEOPLE	
6 - STUDIO UNITS @ 1.4 PPU = 8 PEOPLE	
<b>BUILDING B</b>	
77 - 1 BEDROOM UNITS @ 1.4 PPU = 108 PEOPLE	
78 - 2 BEDROOM UNITS @ 2.1 PPU = 164 PEOPLE	
2 - TOWNHOUSES @ 2.7 PPU = 5	
<b>TOTAL POPULATION = 667</b>	

Revision	By	Appd.	YY.MM.DD
4	JP	DT	23.09.01
3	JP	DT	23.02.27
2	JP	DT	22.11.29
1	JP	DT	22.05.25
0	MJS	DT	21.11.22

File Name:	MJS	DT	MJS	21.09.22
160401672.DB	Dwn.	Chkd.	Dgn.	YY.MM.DD

Permit-Seal



Client/Project  
WESTRICH PACIFIC CORP.

MULTI-FAMILY RESIDENTIAL DEVELOPMENT  
1125-1149 CYRVILLE ROAD  
OTTAWA, ON, CANADA

Title  
SANITARY DRAINAGE AREA PLAN

Project No. 160401672	Scale 1:250	Sheet 7 of 7	Revision 4
Drawing No. SA-1	DWG# 18599		

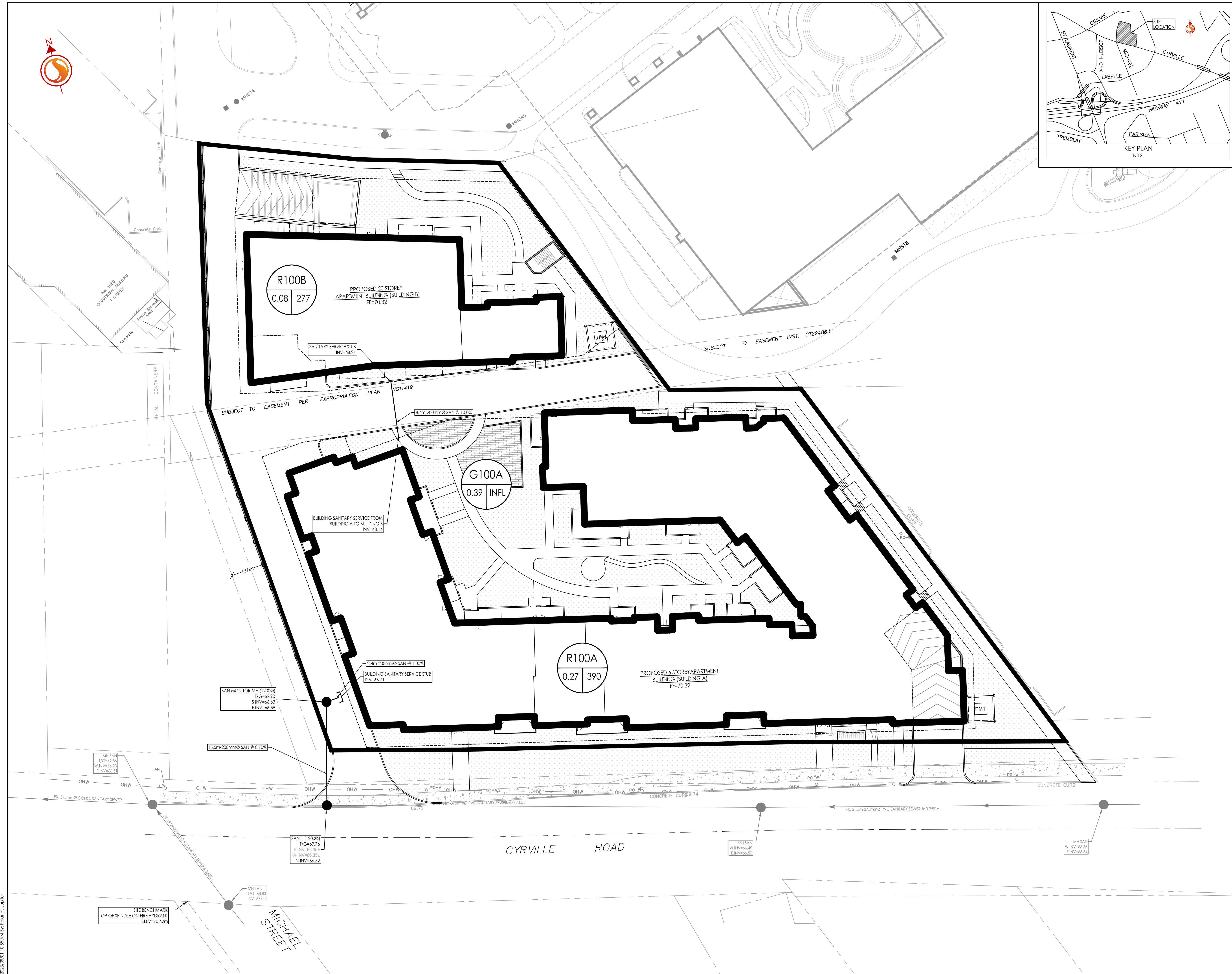

W:\Projects\160401672\Multi-Family Residential Development\160401672.Dwg  
 2023/09/01 10:55 AM A:\Users\jmoroz\Documents\160401672.Dwg