

Legend

- R100A** — SANITARY DRAINAGE AREA ID#
- 0.31 50** — POPULATION COUNT
- SANITARY DRAINAGE AREA ha.
- G100A** — SANITARY DRAINAGE AREA ID#
- 0.11 INFL** — INFILTRATION RATE OF 0.33 L/s/Ha APPLIED
- SANITARY DRAINAGE AREA ha.
- SANITARY DRAINAGE AREA
- — PROPOSED SANITARY MH AND SEWER
- — EXISTING SANITARY MH AND SEWER

Notes

SANITARY STATS	
<b>BUILDING A</b>	
71 - 1 BEDROOM UNITS @ 1.4 PPU = 99 PEOPLE	
133 - 2 BEDROOM UNITS @ 2.1 PPU = 279 PEOPLE	
5 - 3 BEDROOM UNITS @ 3.1 PPU = 16 PEOPLE	
<b>BUILDING B</b>	
78 - 1 BEDROOM UNITS @ 1.4 PPU = 109 PEOPLE	
78 - 2 BEDROOM UNITS @ 2.1 PPU = 164 PEOPLE	
TOTAL POPULATION = 667	

Revision	By	Appd.	YY.MM.DD
1	JP	DT	22.05.25
0	MJS	DT	21.11.22

File Name: 160401672.DB MJS DT MJS 21.09.22  
Dwn. Chkd. Dgn. YY.MM.DD

Permit-Seal

Client/Project  
WESTRICH PACIFIC CORP.

MULTI-FAMILY RESIDENTIAL DEVELOPMENT  
1125-1149 CYRVILLE ROAD  
OTTAWA, ON, CANADA

Title  
SANITARY DRAINAGE AREA PLAN

Project No. 160401672	Scale 1:250	0 2.5 7.5 12.5m
Drawing No. SA-1	Sheet 7 of 7	Revision 1

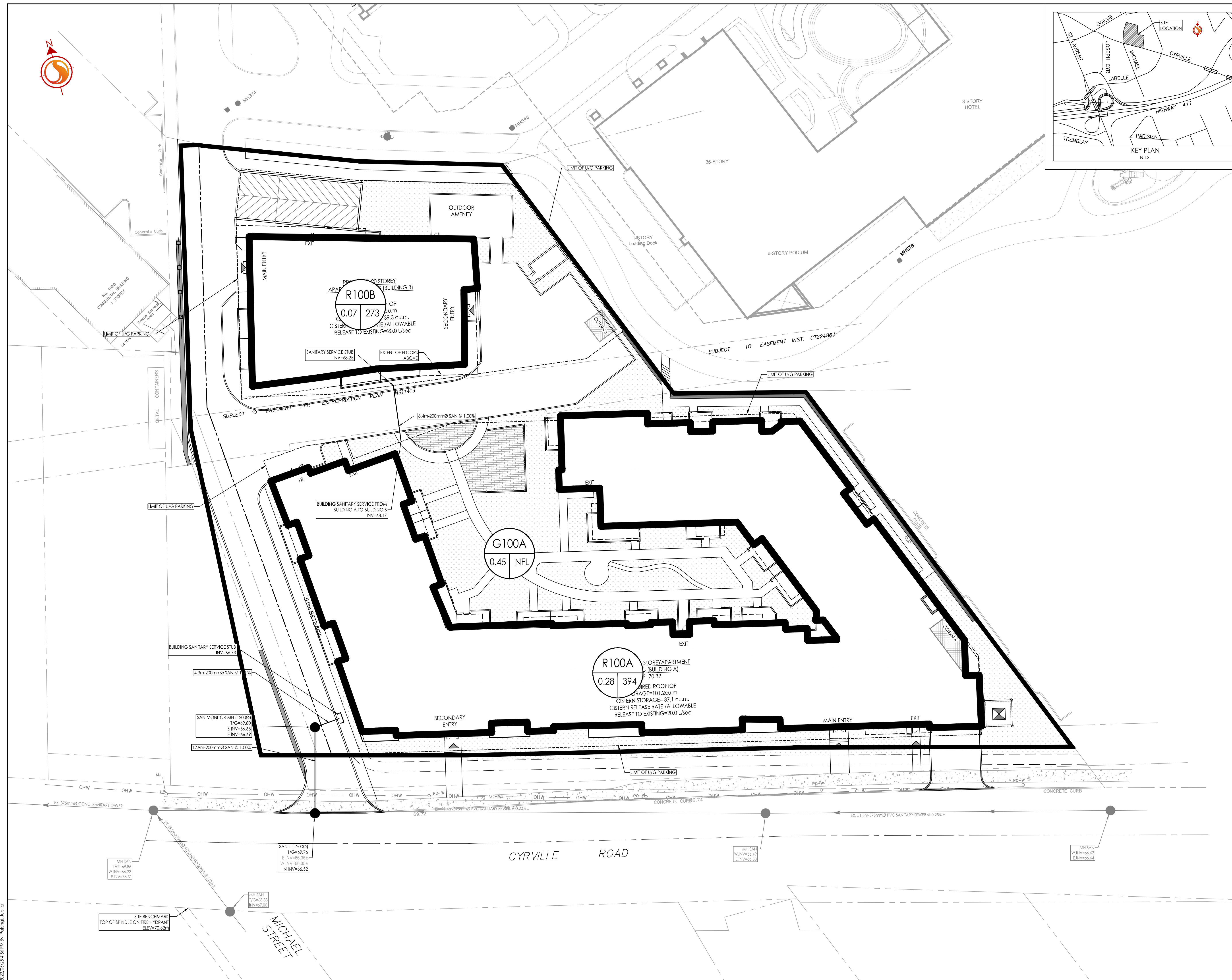

W:\Projects\160401672 Design\Drawings\160401672 SA.dwg  
 2022/05/25 10:58 AM by: J.P. [Signature]  
 ORIGINAL SHEET - ARCH-D