

Copyright Reserved

The Contractor shall verify and be responsible for all dimensions. DO NOT scale the drawing - any errors or omissions shall be reported to Stantec without delay.
The Copyrights to all designs and drawings are the property of Stantec. Reproduction or use for any purpose other than that authorized by Stantec is forbidden.

Legend

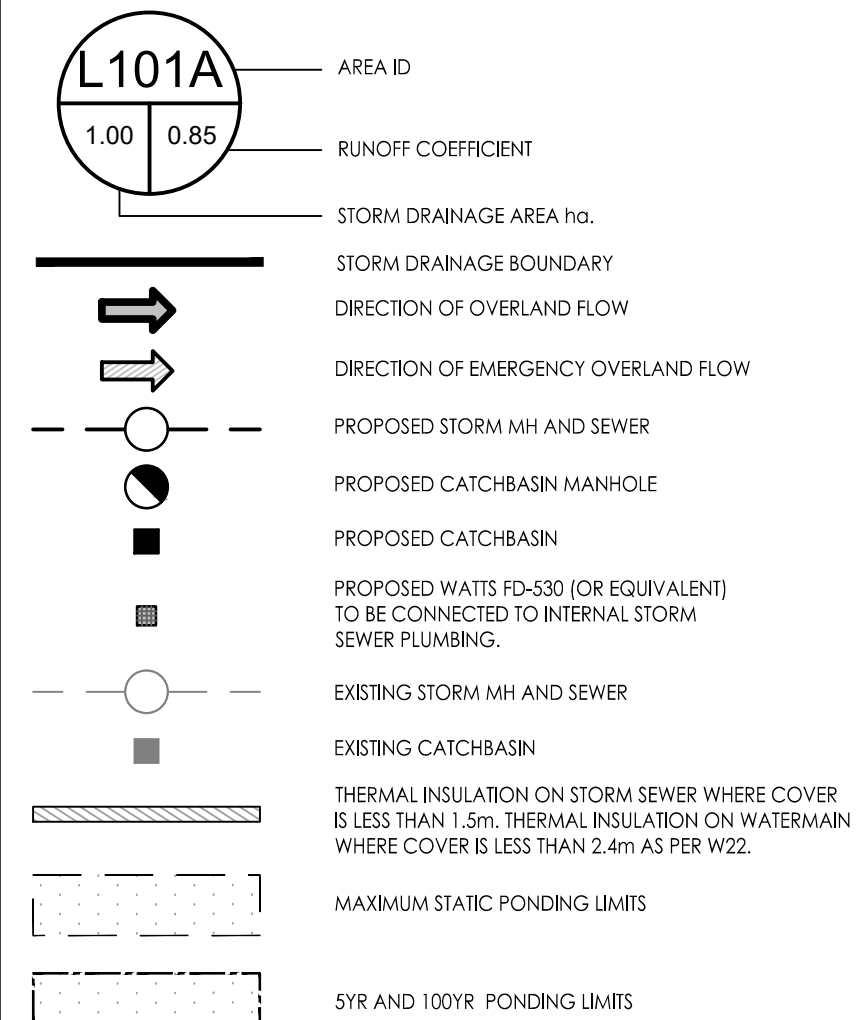

Notes

- INTERNAL PLUMBING AND SUMP PUMPS TO BE DESIGNED BY THE MECHANICAL CONSULTANT.
- THE INTERNAL PLUMBING IN BUILDING B TO ACCOMMODATE THE INDEPENDENT CONNECTIONS OF BUILDING B TO THE SANITARY, WATER AND STORM SERVICE STUBS AT BUILDING A.
- STORMWATER MANAGEMENT TO BE PROVIDED THROUGH A CISTERN IN EACH BUILDING. CISTERN TO BE LOCATED IN THE ASSOCIATED UNDERGROUND PARKING.
 - BUILDING 1 CISTERN A = 45.0m³ AND RELEASE RATE 32L/s PUMP RATE
 - BUILDING 2 CISTERN B = 40.0m³ AND RELEASE RATE 10L/s PUMP RATE
 - TOTAL PERMITTED RELEASE RATE FROM SITE = 72.6 L/s
 - TOTAL POST DEVELOPMENT RELEASE RATE FROM SITE = 72.3 L/s (100 YR)

Revision	By	Appd.	YY.MM.DD	
6	ISSUED FOR SPA	JP	PM	23.11.29
5	ISSUED FOR SPA	JP	DT/PM	23.10.08
4	ISSUED FOR SPA	JP	DT	23.09.01
3	ISSUED FOR SPA	JP	DT	23.02.27
2	ISSUED FOR SPA	JP	DT	22.11.29
1	ISSUED FOR SPA	JP	DT	22.05.25
0	ISSUED FOR SPA	MJS	DT	21.11.22

Revision

File Name:	MJS	DT	MJS	21.09.22
160401672.DB	Dwn.	Chkd.	Dgn.	YY.MM.DD

Permit-Seal



Client/Project
WESTRICH PACIFIC CORP.

MULTI-FAMILY RESIDENTIAL DEVELOPMENT
1125-1149 CYRVILLE ROAD
OTTAWA, ON, CANADA

Title
STORM DRAINAGE AREA PLAN

Project No.	Scale	0	2.5	7.5	12.5m
160401672	1:250				
Drawing No.	Sheet	Revision			
SD-1	6 of 7	5			

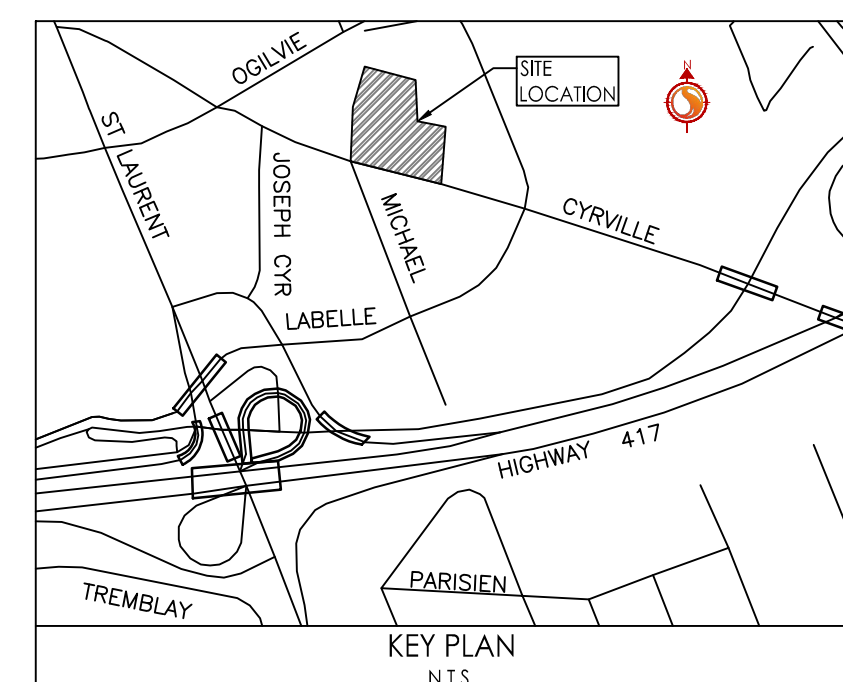
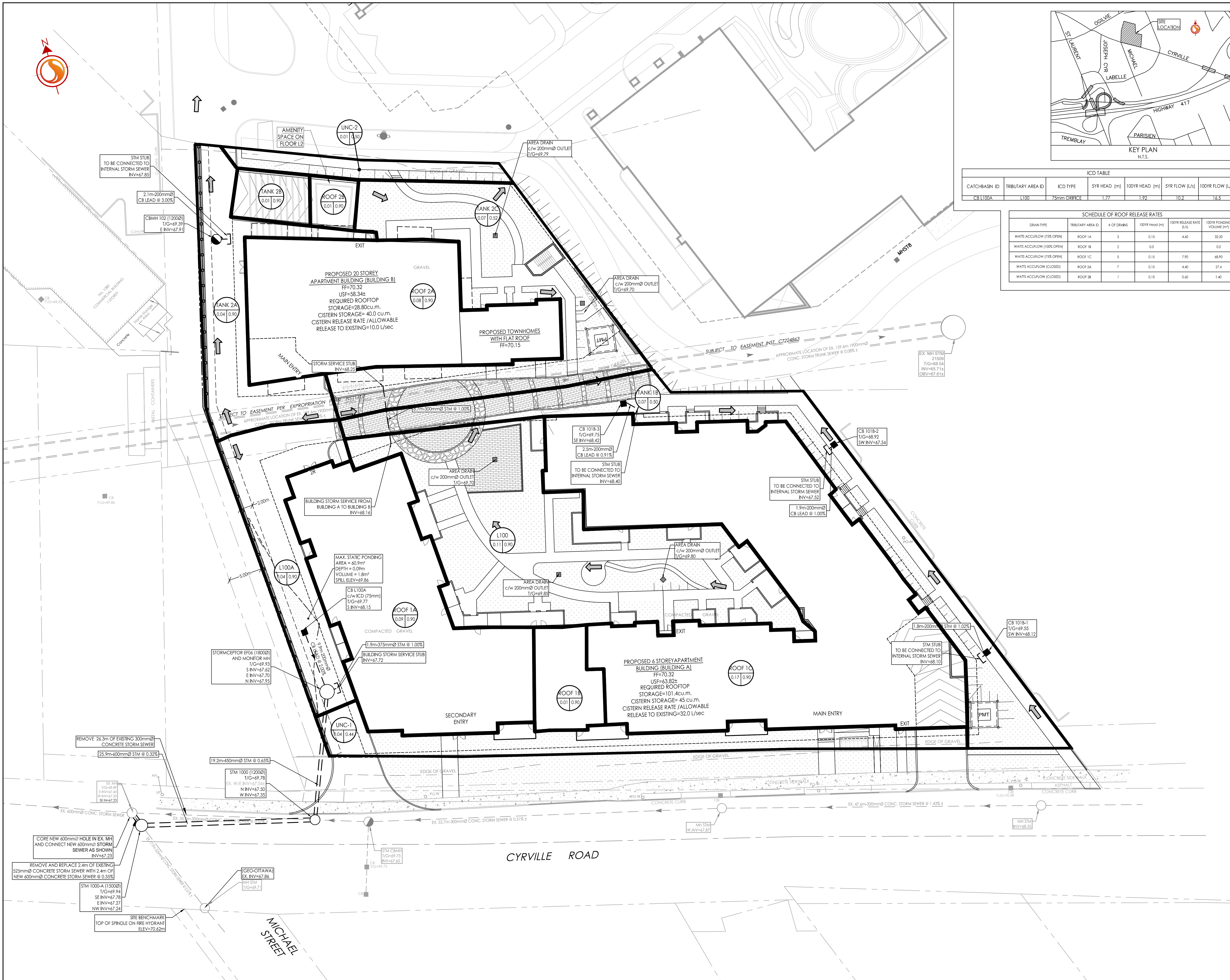

ICD TABLE						
CATCHBASIN ID	TRIBUTARY AREA ID	ICD TYPE	5YR HEAD (m)	100YR HEAD (m)	5YR FLOW (L/s)	100YR FLOW (L/s)
CB L100A	L100	75mm ORIFICE	1.77	1.92	10.2	16.5

SCHEDULE OF ROOF RELEASE RATES						
DRAIN TYPE	TRIBUTARY AREA ID	# OF DRAINS	100YR HEAD (m)	100YR RELEASE RATE (L/s)	100YR PONDING VOLUME (m ³)	
WATS ACC/FLOW (PSE OPEN)	ROOF 1A	3	0.15	4.60	32.50	
WATS ACC/FLOW (100% OPEN)	ROOF 1B	2	0.0	0.0	0.0	
WATS ACC/FLOW (PSE OPEN)	ROOF 1C	5	0.15	7.90	68.90	
WATS ACC/FLOW (CLOSED)	ROOF 2A	7	0.15	4.40	27.4	
WATS ACC/FLOW (CLOSED)	ROOF 2B	1	0.15	0.60	1.40	

2023/11/29 11:29 AM 67% Design drawing 160401672.Dwg
2023/11/29 11:29 AM 67% Design drawing 160401672.Dwg