

Copyright Reserved

The Contractor shall verify and be responsible for all dimensions. DO NOT scale the drawing - any errors or omissions shall be reported to Stantec without delay.
The Copyrights to all designs and drawings are the property of Stantec. Reproduction or use for any purpose other than that authorized by Stantec is forbidden.

Legend

- R100A** — SANITARY DRAINAGE AREA ID#
- 0.31 | 50** — POPULATION COUNT
- SANITARY DRAINAGE AREA ha.
- G100A** — SANITARY DRAINAGE AREA ID#
- 0.11 | INFL** — INFILTRATION RATE OF 0.33 L/s/ha APPLIED
- SANITARY DRAINAGE AREA ha.
- SANITARY DRAINAGE AREA
- — PROPOSED SANITARY MH AND SEWER
- — EXISTING SANITARY MH AND SEWER

Notes

SANITARY STATS	
BUILDING A	
71 - 1 BEDROOM UNITS @ 1.4 PPU = 99 PEOPLE	
133 - 2 BEDROOM UNITS @ 2.1 PPU = 279 PEOPLE	
5 - 3 BEDROOM UNITS @ 3.1 PPU = 16 PEOPLE	
BUILDING B	
78 - 1 BEDROOM UNITS @ 1.4 PPU = 109 PEOPLE	
78 - 2 BEDROOM UNITS @ 2.1 PPU = 164 PEOPLE	
TOTAL POPULATION = 667	

Revision	By	Appd.	YY.MM.DD
2	ISSUED FOR SPA	JP	DT 22.11.29
1	ISSUED FOR SPA	JP	DT 22.05.25
0	ISSUED FOR SPA	MJS	DT 21.11.22

File Name:	MJS	DT	MJS	21.09.22
160401672.DB	Dwn.	Chkd.	Dgn.	YY.MM.DD

Permit-Seal

Client/Project
WESTRICH PACIFIC CORP.

MULTI-FAMILY RESIDENTIAL DEVELOPMENT
1125-1149 CYRVILLE ROAD
OTTAWA, ON, CANADA

Title
SANITARY DRAINAGE AREA PLAN

Project No. 160401672	Scale 1:250	Sheet 7 of 7	Revision 2
Drawing No. SA-1	Scale 0 2.5 7.5 12.5m		Revision 2

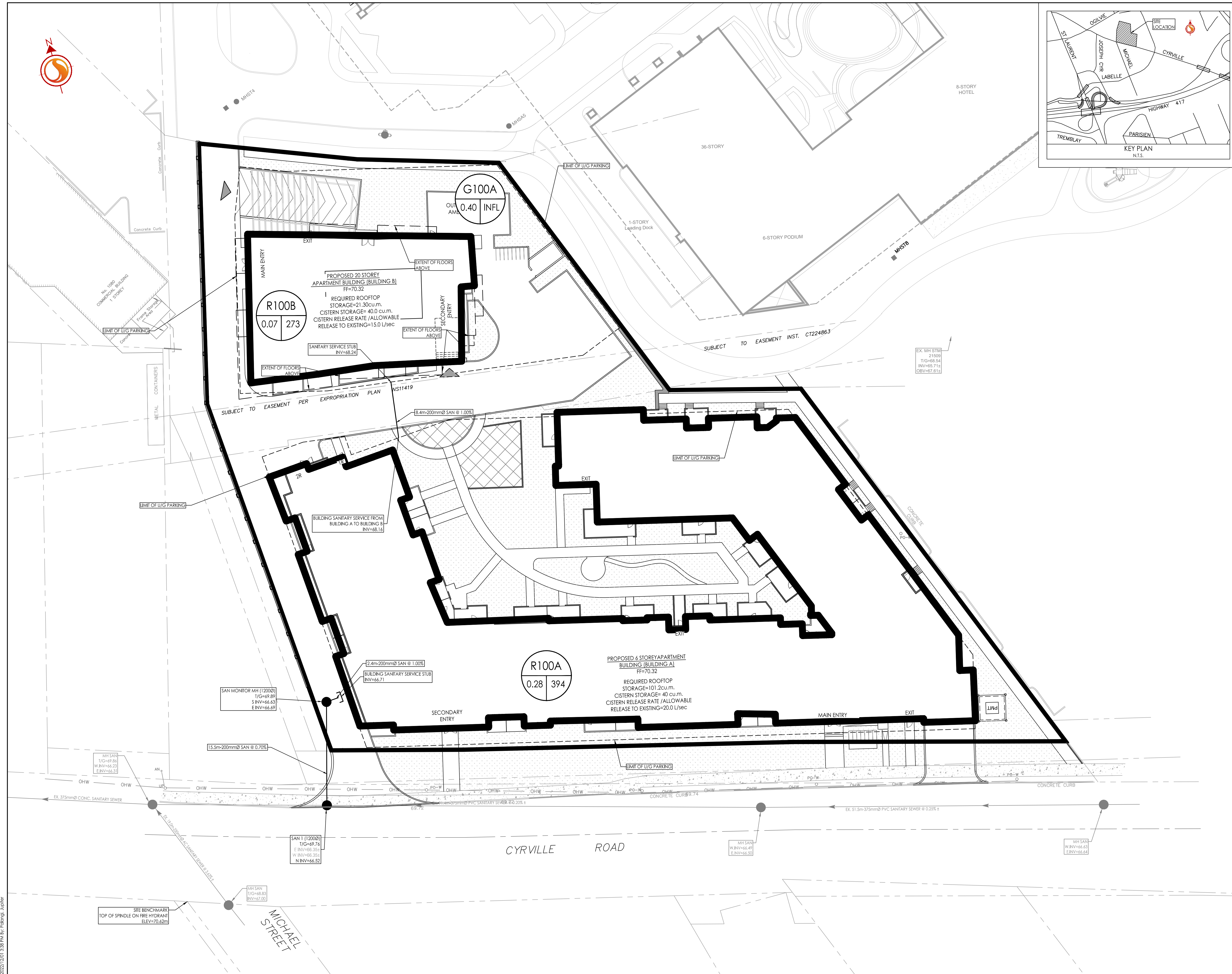

W:\Projects\160401672\Design\Drawings\160401672.Dwg
 2022/12/07 13:58:16 by: [Name]
 ORIGINAL SHEET - ARCH D

D07-12-21-0214