

Copyright Reserved

The Contractor shall verify and be responsible for all dimensions. DO NOT locate the drawings - any errors or omissions shall be reported to Stantec without delay.
The Copyrights to all designs and drawings are the property of Stantec. Reproduction or use for any purpose other than that authorized by Stantec is forbidden.

Legend

- PROPOSED SILT FENCE BOUNDARY AS PER OPSD 219.110
- PROPOSED CONSTRUCTION FENCE AS PER DETAIL.
- PROPOSED CATCH BASIN PROTECTION AS PER FLEX STORM INLET FILTERS DETAIL. ITEM CODE P-RD-240-223-FX
- PROPOSED CATCH BASIN MH PROTECTION AS PER FLEX STORM INLET FILTERS DETAIL. ITEM CODE P-RD-290-270-FX
- PROPOSED CATCH BASIN PROTECTION AS PER TERRAFOX SILTSACK DETAIL
- PROPOSED MUD MAT LOCATION
- PROPOSED VALVE BOX
- PROPOSED VALVE CHAMBER
- PROPOSED FIRE HYDRANT
- PROPOSED SANITARY SEWER MANHOLE
- PROPOSED STORM SEWER MANHOLE
- PROPOSED CATCHBASIN
- PROPOSED WATTS FD-530 (OR EQUIVALENT) TO BE CONNECTED TO INTERNAL STORM SEWER PLUMBING.

Best Management Practices

CONTRACTOR TO PROVIDE EROSION AND SEDIMENT CONTROL (BEST MANAGEMENT PRACTICES) DURING CONSTRUCTION OF THIS PROJECT. THE CONTRACTOR SHALL BE RESPONSIBLE FOR THE MANAGEMENT PRACTICES TO PROTECT THE PROTECTION OF THE SYSTEM AND THE NEIGHBORING WATERCOURSE. DURING CONSTRUCTION ACTIVITIES, THE CONTRACTOR ACKNOWLEDGES THAT FAILURE TO IMPLEMENT APPROPRIATE EROSION AND SEDIMENT CONTROL MEASURES MAY BE SUBJECT TO FINES BY ANY APPLICABLE REGULATORY AGENCY.

1. LIMIT THE EXTENT OF EXPOSED SOILS AT ANY GIVEN TIME.
2. REVEGETATE EXPOSED AREAS AND SLOPES AS SOON AS POSSIBLE.
3. MINIMIZE AREA TO BE CLEARED AND GRUBBED.
4. PROTECT EXPOSED SLOPES WITH PLASTIC OR SYNTHETIC MULCHES.
5. INSTALL CATCH BASIN INSERTS OR EQUIVALENT IN ALL PROPOSED CATCH BASINS AND CATCH BASIN MANHOLES AND IN ALL EXISTING CATCH BASINS THAT WILL RECEIVE RUNOFF FROM THE SITE.
6. A SILT FENCE SHALL BE INSTALLED AROUND THE PERIMETER OF ALL AND ANY STOCKPILES OF MATERIAL TO BE USED OR REMOVED FROM SITE. (LOCATION TO BE DETERMINED)
7. A VISUAL INSPECTION SHALL BE DONE DAILY ON SEDIMENT CONTROL MEASURES AND CLEANED OF ANY ACCUMULATED SILT AS REQUIRED. THE REPORTS WILL BE SUBMITTED OF THIS AS PER THE REQUIREMENTS OF THE CONTRACT.
8. SEDIMENT CONTROL BARRIERS MAY ONLY BE REMOVED TEMPORARILY WITH APPROVAL OF CONTRACT ADMINISTRATOR TO ACCOMMODATE CONSTRUCTION ACTIVITIES. ALL MATERIALS BEING REMOVED AT NIGHT WHEN CONSTRUCTION IS COMPLETED. NO REMOVAL WILL OCCUR IF THERE IS A SIGNIFICANT RAINFALL EVENT (ANTICIPATED) WITHIN UNLESS A NEW DEVICE HAS BEEN INSTALLED TO PROTECT EXISTING STORM OR SANITARY SEWER SYSTEMS OR DOWNSTREAM WATERCOURSES.
9. NO REVERSE OR CLOSING OF EQUIPMENT IS PERMITTED NEAR ANY CONTROLled WATERWAY.
10. CONTRACTOR SHALL REMOVE SEDIMENT CONTROL MEASURES WHEN IN THE OPINION OF THE CONTRACT ADMINISTRATOR, THE MEASURES ARE NO LONGER REQUIRED. NO CONTROL MEASURES SHALL BE PERMANENTLY REMOVED WITHOUT PRIOR WRITTEN APPROVAL FROM THE CONTRACT ADMINISTRATOR.
11. THE CONTRACTOR SHALL PERIODICALLY, OR WHEN REQUESTED BY THE CONTRACT ADMINISTRATOR, CLEAN OUT ACCUMULATED SEDIMENTS AS REQUIRED.
12. THE CONTRACTOR SHALL IMMEDIATELY REPORT TO THE ENGINEER ANY ACCIDENTAL DISCHARGES OF SEDIMENT MATERIAL INTO THE NEIGHBORING APPROPRIATE RESOURCES MEASURES INCLUDING ANY REVERSE TO EXISTING CONTROL MEASURES OR THE IMPLEMENTATION OF ADDITIONAL CONTROL MEASURES. SHALL BE CARRIED OUT BY THE CONTRACTOR WITHOUT DELAY.
13. CONTRACTOR SHALL INSTALL MUD MATS AT ALL CONSTRUCTION ENTRANCES TO THE SITE.

NO.	DESCRIPTION	DATE	BY	APPD.
14	ISSUED FOR SPA	JAN 2021	JP	PM
15	REVISED PER CITY COMMENT	FEB 2021	JP	PM
12	REVISED PER CITY COMMENT	JAN 2021	JP	PM
13	REVISED PER CITY COMMENT	FEB 2021	JP	PM
11	ISSUED FOR SPA	JAN 2021	JP	PM
10	ISSUED FOR SPA	JAN 2021	JP	PM
9	ISSUED FOR SPA	JAN 2021	JP	PM
8	ISSUED FOR SPA	JAN 2021	JP	PM
7	ISSUED FOR SPA	JAN 2021	JP	PM
6	ISSUED FOR SPA	JAN 2021	JP	PM
5	ISSUED FOR SPA	JAN 2021	JP	PM
4	ISSUED FOR SPA	JAN 2021	JP	PM
3	ISSUED FOR SPA	JAN 2021	JP	PM
2	ISSUED FOR SPA	JAN 2021	JP	PM
1	ISSUED FOR SPA	JAN 2021	JP	PM
0	ISSUED FOR SPA	JAN 2021	JP	PM

Revision	By	Appd.	YY.MM.DD
15	JP	PM	24.04.20
14	JP	PM	24.05.24
13	JP	PM	24.05.06
12	JP	PM	24.04.19
11	JP	PM	24.02.01
10	JP	PM	24.01.26
9	JP	PM	23.11.29
8	JP	PM	23.11.29
7	JP	PM	23.11.29
6	JP	PM	23.11.29
5	JP	PM	23.11.29
4	JP	PM	23.11.29
3	JP	PM	23.11.29
2	JP	PM	23.11.29
1	JP	PM	23.11.29

File Name:	MJS	DT	MJS	21.09.22
160401672.DB	Dwn.	Chkd.	Dgn.	YY.MM.DD

Permit-Seal



Client/Project
WESTRICH PACIFIC CORP.

MULTI-FAMILY RESIDENTIAL DEVELOPMENT
1125-1149 CYRVILLE ROAD
OTTAWA, ON, CANADA

Title
EROSION CONTROL PLAN
AND DETAIL SHEET
PHASE 1

Project No.	Scale	0	5	15	25m
160401672	1:500				
Drawing No.	Sheet	Revision			
ECDS-1	5 of 10	14			

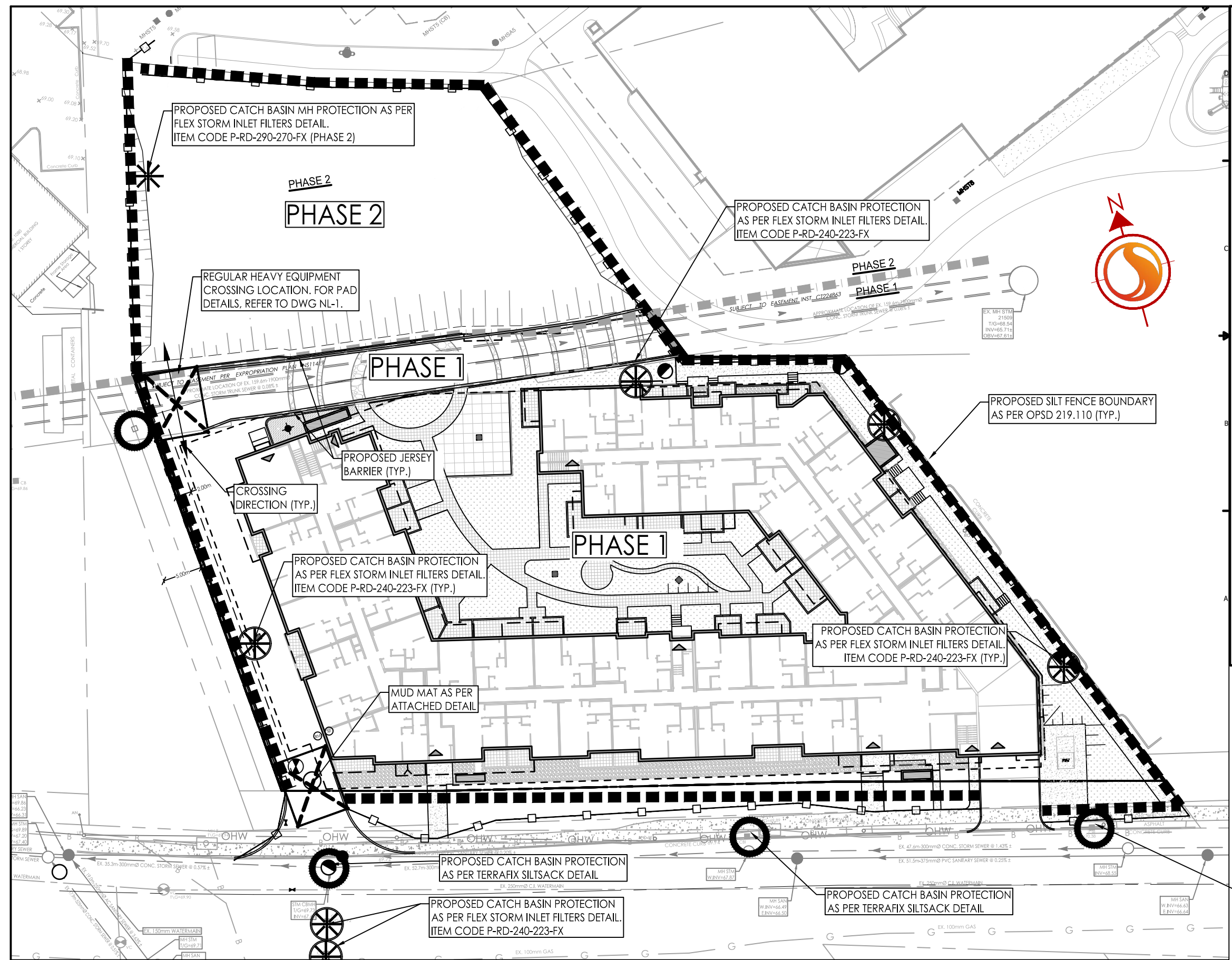

FLEXSTORM P/Ns 62MHRFX & 62MHRFXP

RD INLET TYPE: RAISED CAST IRON FRAME AND ROUND GRATE

Pure Frame with FX Bag	Frame Dimensions	Frame Weight (kg)	Frame Volume (m³)	Frame Capacity (m³)	Pure Frame with FX Bag	Frame Dimensions	Frame Weight (kg)	Frame Volume (m³)	Frame Capacity (m³)
62MHRFX	2170 x 2170	21.2	0.51	1.4	62MHRFXP	2170 x 2170	21.2	0.51	1.4
62MHRFX	2780 x 2780	27.8	0.70	1.9	62MHRFXP	2780 x 2780	27.8	0.70	1.9
62MHRFX	3390 x 3390	33.9	0.85	2.3	62MHRFXP	3390 x 3390	33.9	0.85	2.3
62MHRFX	3990 x 3990	39.9	1.00	2.7	62MHRFXP	3990 x 3990	39.9	1.00	2.7
62MHRFX	4600 x 4600	46.0	1.15	3.1	62MHRFXP	4600 x 4600	46.0	1.15	3.1
62MHRFX	5200 x 5200	52.0	1.30	3.5	62MHRFXP	5200 x 5200	52.0	1.30	3.5
62MHRFX	5800 x 5800	58.0	1.45	3.9	62MHRFXP	5800 x 5800	58.0	1.45	3.9
62MHRFX	6400 x 6400	64.0	1.60	4.3	62MHRFXP	6400 x 6400	64.0	1.60	4.3
62MHRFX	7000 x 7000	70.0	1.75	4.7	62MHRFXP	7000 x 7000	70.0	1.75	4.7
62MHRFX	7600 x 7600	76.0	1.90	5.1	62MHRFXP	7600 x 7600	76.0	1.90	5.1
62MHRFX	8200 x 8200	82.0	2.05	5.5	62MHRFXP	8200 x 8200	82.0	2.05	5.5
62MHRFX	8800 x 8800	88.0	2.20	5.9	62MHRFXP	8800 x 8800	88.0	2.20	5.9
62MHRFX	9400 x 9400	94.0	2.35	6.3	62MHRFXP	9400 x 9400	94.0	2.35	6.3
62MHRFX	10000 x 10000	100.0	2.50	6.7	62MHRFXP	10000 x 10000	100.0	2.50	6.7
62MHRFX	10600 x 10600	106.0	2.65	7.1	62MHRFXP	10600 x 10600	106.0	2.65	7.1
62MHRFX	11200 x 11200	112.0	2.80	7.5	62MHRFXP	11200 x 11200	112.0	2.80	7.5
62MHRFX	11800 x 11800	118.0	2.95	7.9	62MHRFXP	11800 x 11800	118.0	2.95	7.9
62MHRFX	12400 x 12400	124.0	3.10	8.3	62MHRFXP	12400 x 12400	124.0	3.10	8.3
62MHRFX	13000 x 13000	130.0	3.25	8.7	62MHRFXP	13000 x 13000	130.0	3.25	8.7
62MHRFX	13600 x 13600	136.0	3.40	9.1	62MHRFXP	13600 x 13600	136.0	3.40	9.1
62MHRFX	14200 x 14200	142.0	3.55	9.5	62MHRFXP	14200 x 14200	142.0	3.55	9.5
62MHRFX	14800 x 14800	148.0	3.70	9.9	62MHRFXP	14800 x 14800	148.0	3.70	9.9
62MHRFX	15400 x 15400	154.0	3.85	10.3	62MHRFXP	15400 x 15400	154.0	3.85	10.3
62MHRFX	16000 x 16000	160.0	4.00	10.7	62MHRFXP	16000 x 16000	160.0	4.00	10.7

NOTES:
1. RATINGS SHOWN ARE FOR STANDARD 22" BAG DEPTH "SHORT" 12" DEPTH BAGS ARE AVAILABLE WITH ~5 SUFFIX RATINGS REDUCED BY ~50%.
2. THE FOLLOWING REQUIRES ADDITIONAL REVIEW
-GRATES WITH EXTENDED BOTTOMS
-ANY OBSTRUCTED INLET OPENINGS

ALL PRODUCTS MANUFACTURED BY INLET & PIPE PROTECTION, INC. A DIVISION OF ADS, INC. 1400 INLET FILTERS DR. (866) 887-8655 PH. (866) 295-3477 FAX (866) 295-3477 INFO@INLETFILTERS.COM

APPROVED
By Allison Hamlin at 4:29 pm, Jul 17, 2024

ALLISON HAMLIN, MCIP, RPP
(ACTING) MANAGER,
DEVELOPMENT REVIEW ALL WARDS PLANNING,
DEPARTMENT, CITY OF OTTAWA

