

Copyright Reserved
The Contractor shall verify and be responsible for all dimensions. DO NOT scale the drawing - any errors or omissions shall be reported to Stantec without delay.
The Copyrights to all designs and drawings are the property of Stantec. Reproduction or use for any purpose other than that authorized by Stantec is forbidden.

Legend

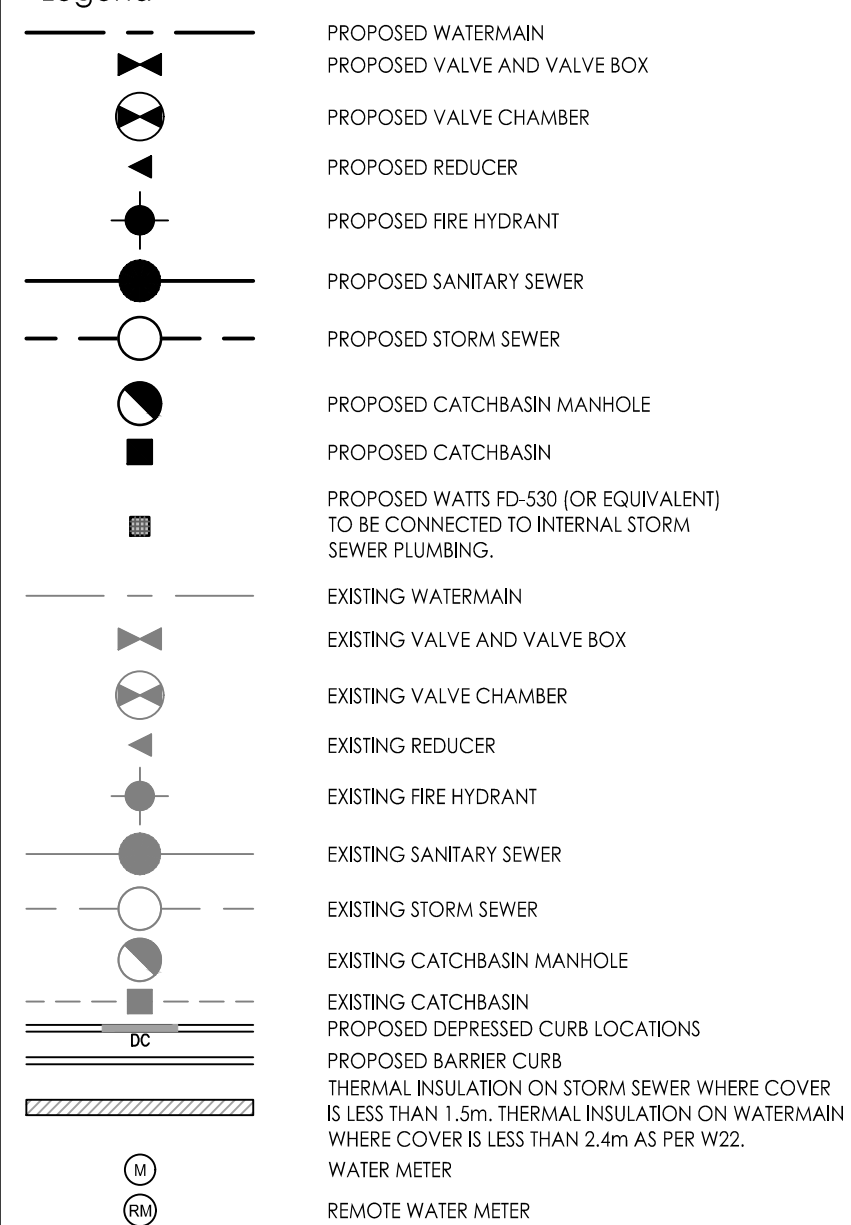

Notes

- FINAL METER AND REMOTE METER LOCATIONS TO BE CONFIRMED BY MECHANICAL CONSULTANT.
- THE LOCATION OF UTILITIES IS APPROXIMATE ONLY AND THE EXACT LOCATION SHOULD BE DETERMINED BY CONSULTING THE MUNICIPAL AUTHORITIES AND UTILITY COMPANIES CONCERNED. THE CONTRACTOR SHALL PROTECT THE LOCATION OF UTILITIES AND SHALL BE RESPONSIBLE FOR THEIR PROTECTION AND THE IMPLEMENTATION OF ANY NECESSARY PROCEDURES CALLED FOR IN THE APPROPRIATE STANDARD AND REGULATIONS.
- INTERNAL PLUMBING AND SUMP PUMPS TO BE DESIGNED BY THE MECHANICAL CONSULTANT.
- UNDERGROUND PARKING STRUCTURE FLOOR DRAINS TO BE CONNECTED TO SANITARY SEWER SERVICE.
- THE INTERNAL PLUMBING IN BUILDING A TO ACCOMMODATE THE INDEPENDENT CONNECTIONS OF BUILDING B TO THE SANITARY, WATER AND STORM SERVICE STUBS AT BUILDING A.
- STORMWATER MANAGEMENT TO BE PROVIDED THROUGH A CISTERN IN EACH BUILDING. CISTERN TO BE LOCATED IN THE ASSOCIATED UNDERGROUND PARKING.
 - BUILDING 1 CISTERN A = 40.0m³ AND RELEASE RATE 20L/s PUMP RATE
 - BUILDING 2 CISTERN B = 40.0m³ AND RELEASE RATE 15L/s PUMP RATE
 - TOTAL PERMITTED RELEASE RATE FROM SITE = 72.0 L/S
 - TOTAL POST DEVELOPMENT RELEASE RATE FROM SITE= 68.9 L/S (100 YR)

Revision	By	Appd.	YY.MM.DD
2	ISSUED FOR SPA	JP	DT 22.11.29
1	ISSUED FOR SPA	JP	DT 22.05.25
0	ISSUED FOR SPA	MJS	DT 21.11.22

File Name:	MJS	DT	MJS	21.09.22
160401672.DB	Dwn.	Chkd.	Dgn.	YY.MM.DD

Permit-Seal

Client/Project
WESTRICH PACIFIC CORP.

MULTI-FAMILY RESIDENTIAL DEVELOPMENT
1125-1149 CYRVILLE ROAD
OTTAWA, ON, CANADA

Title
SITE SERVICING PLAN

Project No. 160401672	Scale 1:250	Sheet SSP-1	Revision 3 of 7
Drawing No.	Sheet	Revision	2

D07-12-21-0214
DWG# 18599

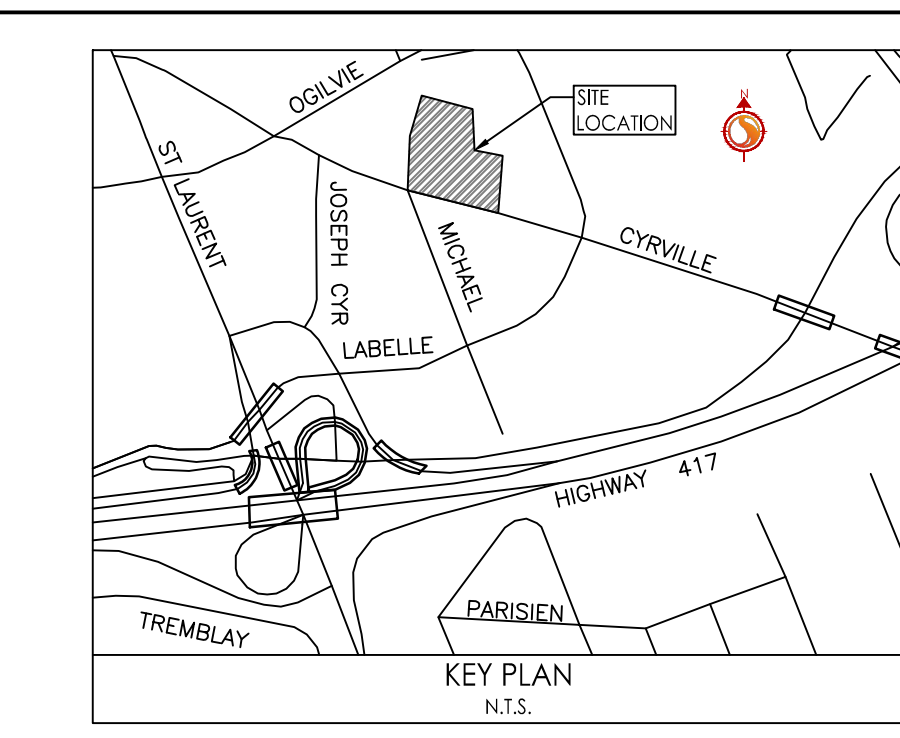
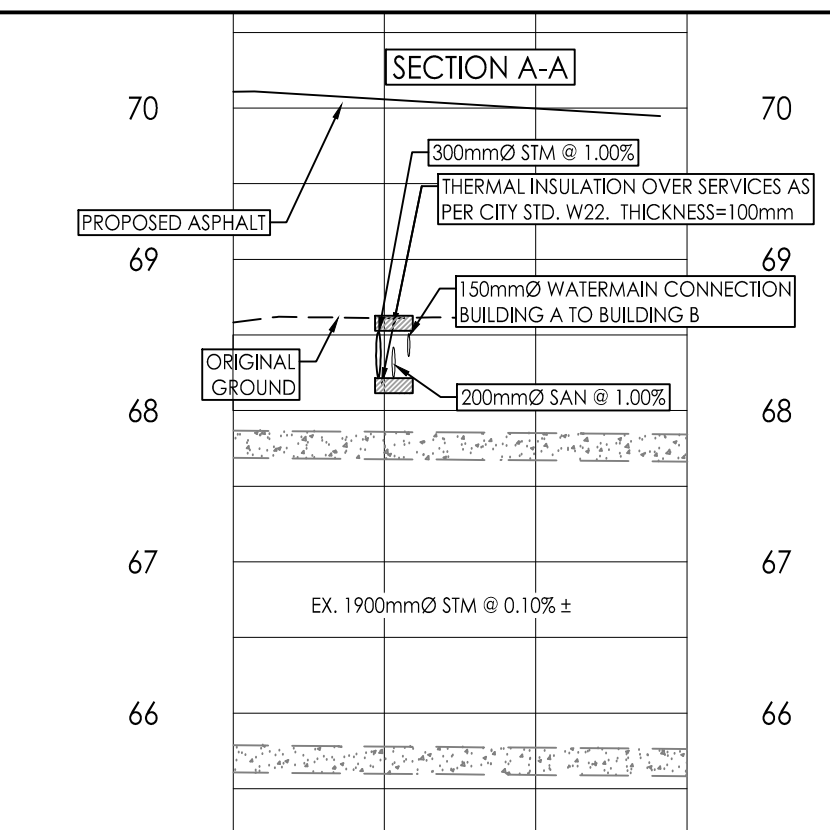
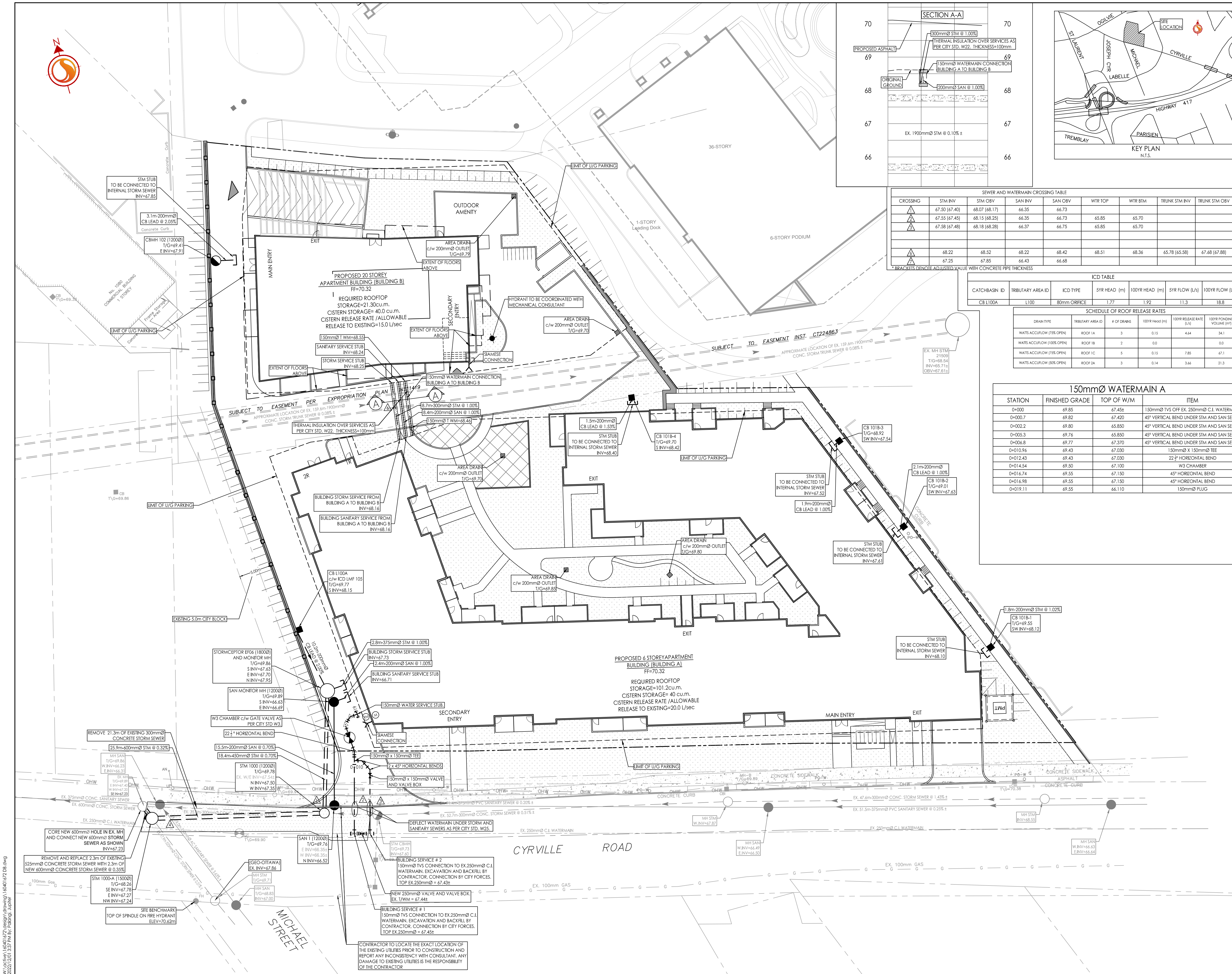

CROSSING	STM INV	STM OBV	SAN INV	SAN OBV	WTR TOP	WTR STM	TRUNK STM INV	TRUNK STM OBV
▲	67.50 (67.40)	68.07 (68.17)	66.35	66.73	65.85	65.70		
▲	67.55 (67.45)	68.15 (68.25)	66.35	66.73	65.85	65.70		
▲	67.58 (67.48)	68.18 (68.28)	66.37	66.75	65.85	65.70		
▲	68.22	68.52	68.22	68.42	68.51	68.36	65.78 (65.58)	67.68 (67.88)
▲	67.25	67.85	66.43	66.68				

CATCHBASIN ID	TRIBUTARY AREA ID	ICD TYPE	STR HEAD (m)	100YR HEAD (m)	STR FLOW (L/S)	100YR FLOW (L/S)
CB L100A	L100	80mm ORIFICE	1.77	1.92	11.3	18.8

DRAIN TYPE	TRIBUTARY AREA ID	# OF DRAINS	100YR HEAD (m)	100YR RELEASE RATE (L/S)	100YR PONDING VOLUME (m ³)
WATTS ACCUR/OFF (15% OPEN)	ROOF 1A	3	0.15	4.64	34.1
WATTS ACCUR/OFF (15% OPEN)	ROOF 1B	2	0.0	0.0	0.0
WATTS ACCUR/OFF (15% OPEN)	ROOF 1C	5	0.15	7.85	47.1
WATTS ACCUR/OFF (15% OPEN)	ROOF 2A	3	0.14	3.66	21.3

STATION	FINISHED GRADE	TOP OF W/M	ITEM
0+000	69.85	67.45E	150mmØ TVS OFF EX. 250mmØ C.I. WATERMAIN
0+000.7	69.82	67.420	45° VERTICAL BEND UNDER STM AND SAN SEWER
0+002.2	69.80	65.850	45° VERTICAL BEND UNDER STM AND SAN SEWER
0+005.3	69.76	65.850	45° VERTICAL BEND UNDER STM AND SAN SEWER
0+006.8	69.77	67.370	45° VERTICAL BEND UNDER STM AND SAN SEWER
0+010.96	69.43	67.030	150mmØ X 150mmØ TEE
0+012.43	69.43	67.030	22 1/2" HORIZONTAL BEND
0+014.54	69.50	67.100	W3 CHAMBER
0+016.74	69.55	67.150	45° HORIZONTAL BEND
0+016.98	69.55	67.150	45° HORIZONTAL BEND
0+019.11	69.55	66.110	150mmØ PLUG