

Legend

- R100A** — SANITARY DRAINAGE AREA ID#
- 0.31 | 50** — POPULATION COUNT
- SANITARY DRAINAGE AREA ha.
- G100A** — SANITARY DRAINAGE AREA ID#
- 0.11 | INFL** — INFILTRATION RATE OF 0.33 L/s/Ha APPLIED
- SANITARY DRAINAGE AREA ha.
- SANITARY DRAINAGE AREA
- — PROPOSED SANITARY MH AND SEWER
- — EXISTING SANITARY MH AND SEWER

Notes

SANITARY STATS	
BUILDING A	
71 - 1 BEDROOM UNITS @ 1.4 PPU = 98 PEOPLE	
127 - 2 BEDROOM UNITS @ 2.1 PPU = 267 PEOPLE	
5 - 3 BEDROOM UNITS @ 3.1 PPU = 16 PEOPLE	
6 - STUDIO UNITS @ 1.4 PPU = 8 PEOPLE	
BUILDING B	
77 - 1 BEDROOM UNITS @ 1.4 PPU = 108 PEOPLE	
78 - 2 BEDROOM UNITS @ 2.1 PPU = 164 PEOPLE	
2 - TOWNHOUSES @ 2.7 PPU = 5	
TOTAL POPULATION = 667	

10	ISSUED FOR CITY REVIEW	JP	PM	24.04.09
9	ISSUED FOR SPA	JP	PM	24.02.01
8	ISSUED FOR SPA	JP	PM	24.01.26
7	ISSUED FOR SPA	JP	PM	23.12.22
6	ISSUED FOR SPA	JP	PM	23.11.29
5	ISSUED FOR SPA	JP	DT/PM	23.10.08
4	ISSUED FOR SPA	JP	DT	23.09.01
3	ISSUED FOR SPA	JP	DT	23.02.27
2	ISSUED FOR SPA	JP	DT	22.11.29
1	ISSUED FOR SPA	JP	DT	22.05.25
0	ISSUED FOR SPA	MJS	DT	21.11.22

Revision		By	Appd.	YY.MM.DD

File Name:	MJS	DT	MJS	21.09.22
160401672.DB	Dwn.	Chkd.	Dgn.	YY.MM.DD

Permit-Seal

Client/Project
WESTRICH PACIFIC CORP.

MULTI-FAMILY RESIDENTIAL DEVELOPMENT
1125-1149 CYRVILLE ROAD
OTTAWA, ON, CANADA

Title
SANITARY DRAINAGE AREA PLAN

Project No. 160401672
Scale 1:250

Drawing No. SA-1
Sheet 7 of 7
Revision 10

DWG# 18599

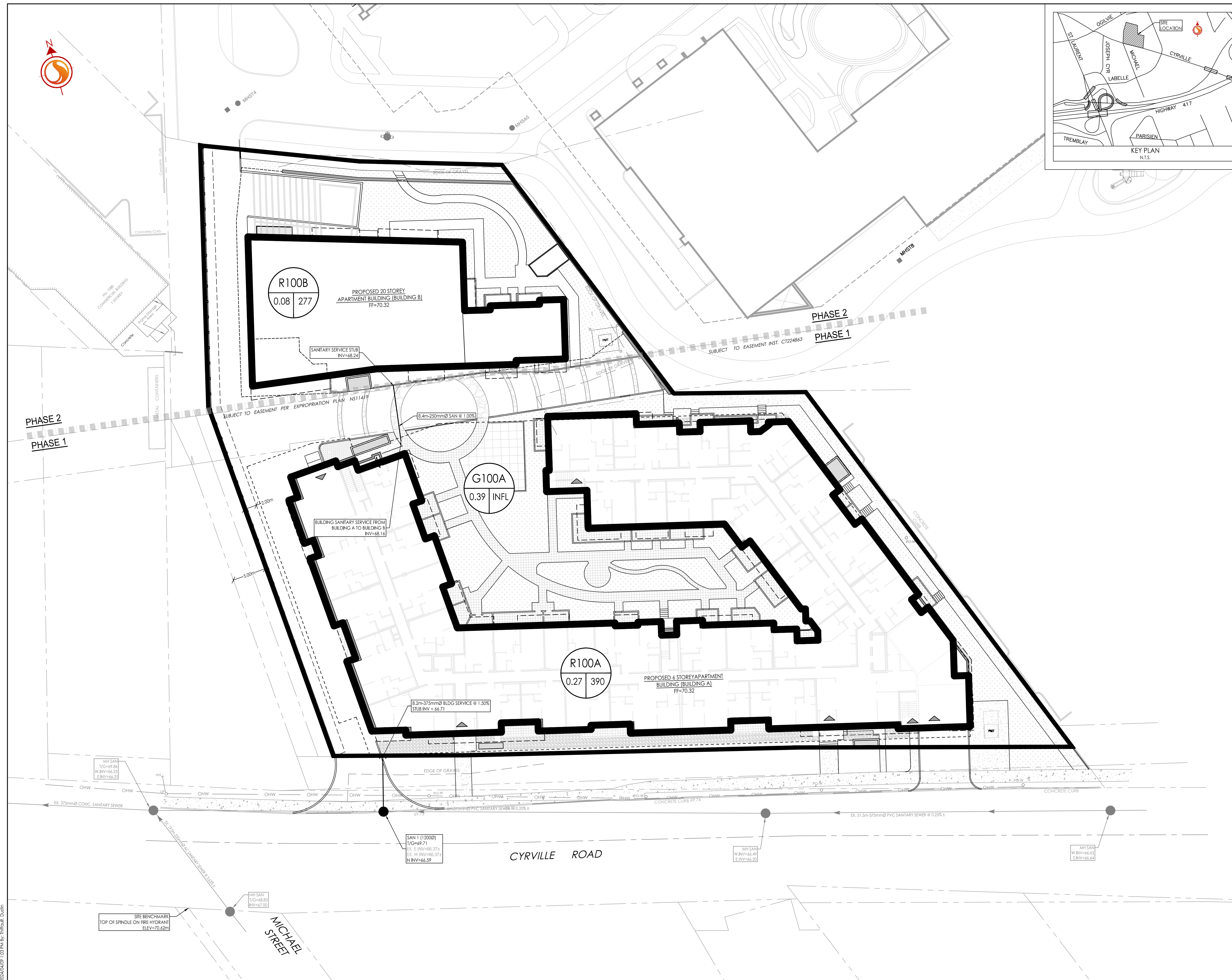

160401672.DWG
 2024/04/02 10:53 AM
 160401672.DWG
 ORIGINAL SHEET - ARCH-D