

Copyright Reserved

The Contractor shall verify and be responsible for all dimensions. DO NOT scale the drawing - any errors or omissions shall be reported to Stantec without delay.
The Copyrights to all designs and drawings are the property of Stantec. Reproduction or use for any purpose other than that authorized by Stantec is forbidden.

Legend

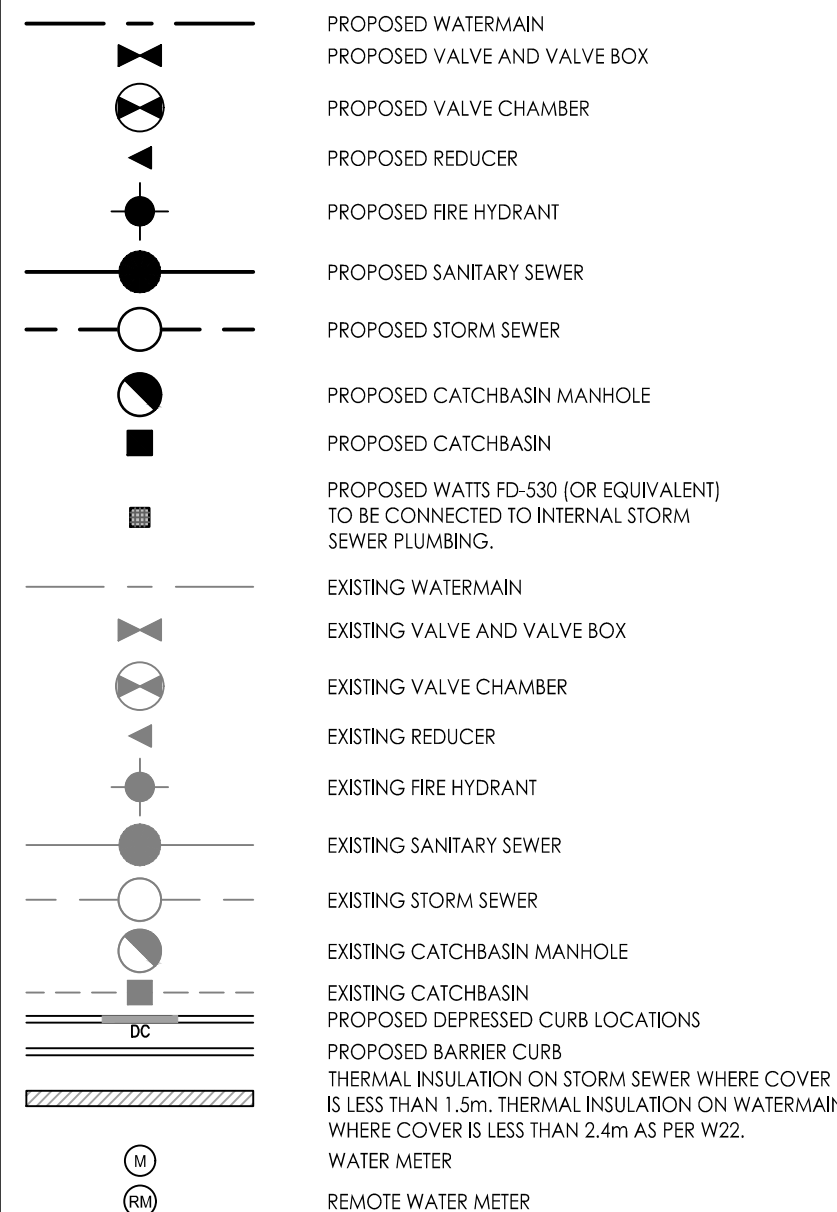

Notes

- FINAL METER AND REMOTE METER LOCATIONS TO BE CONFIRMED BY MECHANICAL CONSULTANT.
- THE LOCATION OF UTILITIES IS APPROXIMATE ONLY AND THE EXACT LOCATION SHOULD BE DETERMINED BY CONSULTING THE MUNICIPAL AUTHORITIES AND UTILITY COMPANIES CONCERNED. THE CONTRACTOR SHALL PROVE THE LOCATION OF UTILITIES AND SHALL BE RESPONSIBLE FOR THEIR PROTECTION AND THE IMPLEMENTATION OF ANY NECESSARY PROCEDURES CALLED FOR IN THE APPROPRIATE STANDARD AND REGULATIONS.
- INTERNAL PLUMBING AND SUMP PUMPS TO BE DESIGNED BY THE MECHANICAL CONSULTANT.
- UNDERGROUND PARKING STRUCTURE FLOOR DRAINS TO BE CONNECTED TO SANITARY SEWER SERVICE.
- THE INTERNAL PLUMBING IN BUILDING A TO ACCOMMODATE THE INDEPENDENT CONNECTIONS OF BUILDING B TO THE SANITARY, WATER AND STORM SERVICE STUBS AT BUILDING A.
- STORMWATER MANAGEMENT TO BE PROVIDED THROUGH A CISTERN IN EACH BUILDING. CISTERN TO BE LOCATED IN THE ASSOCIATED UNDERGROUND PARKING.
 - BUILDING 1 CISTERN A = 37.1m³ AND RELEASE RATE 20L/s PUMP RATE
 - BUILDING 2 CISTERN B = 39.3m³ AND RELEASE RATE 20L/s PUMP RATE
 - PRE DEVELOPMENT RELEASE RATE FROM SITE (TARGET) = 78.2 L/S
 - POST DEVELOPMENT RELEASE RATE FROM SITE = 72.0 L/S (100 YR)

Revision	By	Appd.	YY.MM.DD
1	ISSUED FOR SPA	JP	D1 22.05.25
0	ISSUED FOR SPA	MJS	D1 21.11.22

File Name:	MJS	DT	MJS	21.09.22
160401672.DB	Dwn.	Chkd.	Dgn.	YY.MM.DD

Permit-Seal

Client/Project
WESTRICH PACIFIC CORP.

MULTI-FAMILY RESIDENTIAL DEVELOPMENT
1125-1149 CYRVILLE ROAD
OTTAWA, ON, CANADA

Title
SITE SERVICING PLAN

Project No.	Scale	Sheet	Revision
160401672	1:250	3 of 7	1
Drawing No.	SSP-1		

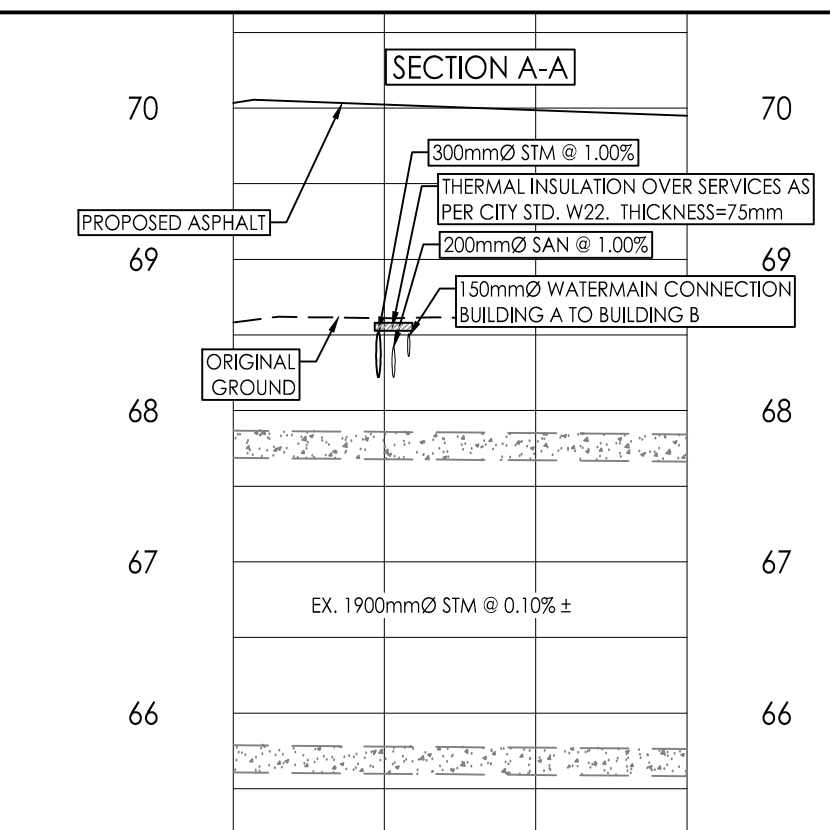
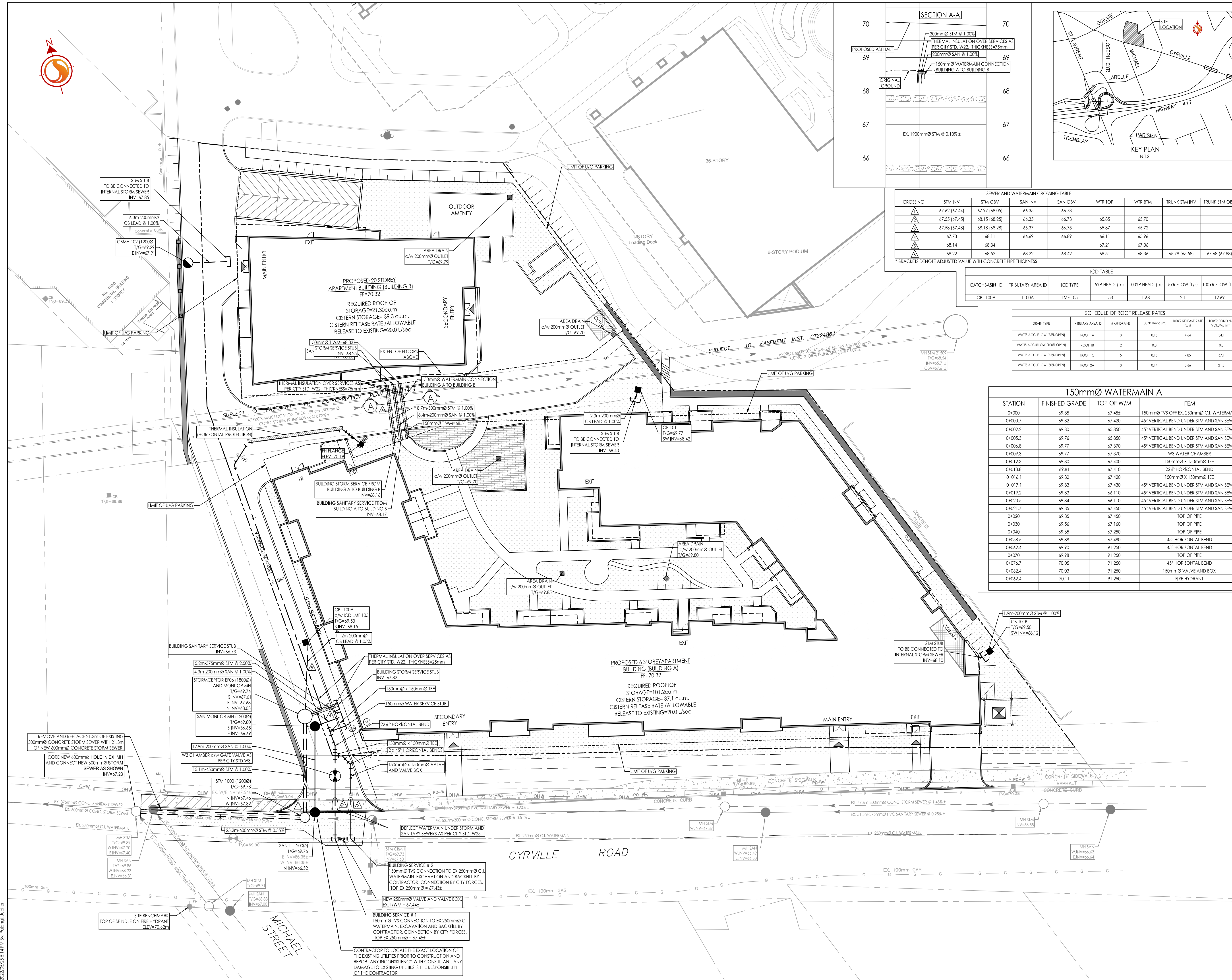

CROSSING	STM INV	STM OBV	SAN INV	SAN OBV	WTR TOP	WTR BTM	TRUNK STM INV	TRUNK STM OBV
▲	67.42 (67.44)	67.97 (68.05)	66.35	66.73				
▲	67.55 (67.45)	68.15 (68.25)	66.35	66.73	65.85	65.70		
▲	67.58 (67.48)	68.16 (68.28)	66.37	66.75	65.87	65.72		
▲	67.73	68.11	66.69	66.89	66.11	65.96		
▲	68.14	68.34			67.21	67.06		
▲	68.22	68.52	68.22	68.42	68.51	68.36	65.78 (65.58)	67.68 (67.88)

* BRACKETS DENOTE ADJUSTED VALUE WITH CONCRETE PIPE THICKNESS

CATCHBASIN ID	TRIBUTARY AREA ID	ICD TYPE	SYR HEAD (m)	100YR HEAD (m)	SYR FLOW (L/s)	100YR FLOW (L/s)
CB L100A	L100A	LMF 105	1.53	1.68	12.11	12.69

DRAIN TYPE	TRIBUTARY AREA ID	# OF DRAINS	100YR HEAD (m)	100YR RELEASE RATE (L/s)	100YR PONDING VOLUME (m ³)
WATTS ACCURFLOW (15% OPEN)	ROOF 1A	3	0.15	4.64	34.1
WATTS ACCURFLOW (15% OPEN)	ROOF 1B	2	0.0	0.0	0.0
WATTS ACCURFLOW (15% OPEN)	ROOF 1C	5	0.15	7.85	67.1
WATTS ACCURFLOW (15% OPEN)	ROOF 2A	3	0.14	3.66	21.3

STATION	FINISHED GRADE	TOP OF W/M	ITEM
0+000	69.85	67.45±	150mmØ TVS OFF EX. 250mmØ C.I. WATERMAIN
0+000.7	69.82	67.420	45° VERTICAL BEND UNDER STM AND SAN SEWER
0+002.2	69.80	65.850	45° VERTICAL BEND UNDER STM AND SAN SEWER
0+005.3	69.76	65.850	45° VERTICAL BEND UNDER STM AND SAN SEWER
0+006.8	69.77	67.370	45° VERTICAL BEND UNDER STM AND SAN SEWER
0+009.3	69.77	67.370	W3 WATER CHAMBER
0+012.3	69.80	67.400	150mmØ x 150mmØ TEE
0+013.8	69.81	67.410	22° HORIZONTAL BEND
0+016.1	69.82	67.420	150mmØ x 150mmØ TEE
0+017.1	69.83	67.430	45° VERTICAL BEND UNDER STM AND SAN SEWER
0+019.2	69.83	66.110	45° VERTICAL BEND UNDER STM AND SAN SEWER
0+020.5	69.84	66.110	45° VERTICAL BEND UNDER STM AND SAN SEWER
0+021.7	69.85	67.450	45° VERTICAL BEND UNDER STM AND SAN SEWER
0+020	69.85	67.450	TOP OF PIPE
0+030	69.56	67.160	TOP OF PIPE
0+040	69.65	67.250	TOP OF PIPE
0+058.5	69.88	67.480	45° HORIZONTAL BEND
0+062.4	69.90	91.250	45° HORIZONTAL BEND
0+070	69.98	91.250	TOP OF PIPE
0+076.7	70.05	91.250	45° VERTICAL BEND
0+062.4	70.03	91.250	150mmØ VALVE AND BOX
0+062.4	70.11	91.250	FIRE HYDRANT