

Copyright Reserved

The Contractor shall verify and be responsible for all dimensions. DO NOT scale the drawing - any errors or omissions shall be reported to Stantec without delay.
The Copyrights to all designs and drawings are the property of Stantec. Reproduction or use for any purpose other than that authorized by Stantec is forbidden.

Legend

- EXISTING WATERMAIN
- EXISTING VALVE AND VALVE BOX
- EXISTING VALVE CHAMBER
- EXISTING REDUCER
- EXISTING FIRE HYDRANT
- EXISTING SANITARY MH AND SEWER
- EXISTING STORM MH AND SEWER
- EXISTING CATCHBASIN MANHOLE
- EXISTING CATCHBASIN
- REMOVAL ITEMS
- DIRECTION OF EXISTING OVERLAND FLOW
- FLOW DIRECTION AND GRADE OF EXISTING GROUND
- PHASING LINE

Notes

14	REVISED PER CITY COMMENT	JP	PM	24.04.20
13	REVISED PER CITY COMMENT	JP	PM	24.05.24
12	REVISED PER CITY COMMENT	JP	PM	24.05.06
11	ISSUED FOR SPA	JP	PM	24.04.19
10	ISSUED FOR SPA	JP	PM	24.04.09
9	ISSUED FOR SPA	JP	PM	24.02.01
8	ISSUED FOR SPA	JP	PM	24.01.26
7	ISSUED FOR SPA	JP	PM	23.12.22
6	ISSUED FOR SPA	JP	PM	23.11.29
5	ISSUED FOR SPA	JP	DT/PM	23.10.08
4	ISSUED FOR SPA	JP	DT	23.09.01
3	ISSUED FOR SPA	JP	DT	23.02.27
2	ISSUED FOR SPA	JP	DT	22.11.29
1	ISSUED FOR SPA	JP	DT	22.05.25
0	ISSUED FOR SPA	MJS	DT	21.11.22
Revision		By	Appd.	YY.MM.DD

File Name:	160401672.DB	MJS	DT	MJS	21.09.22
		Dwn.	Chkd.	Dgn.	YY.MM.DD

Permit-Seal



Client/Project
WESTRICH PACIFIC CORP.

MULTI-FAMILY RESIDENTIAL DEVELOPMENT
1125-1149 CYRVILLE ROAD
OTTAWA, ON, CANADA

Title
EXISTING CONDITIONS AND
REMOVALS PLAN

Project No.	Scale	0	2.5	7.5	12.5m
160401672	1:250				
Drawing No.	Sheet	Revision			
EX-1	2 of 10	14			

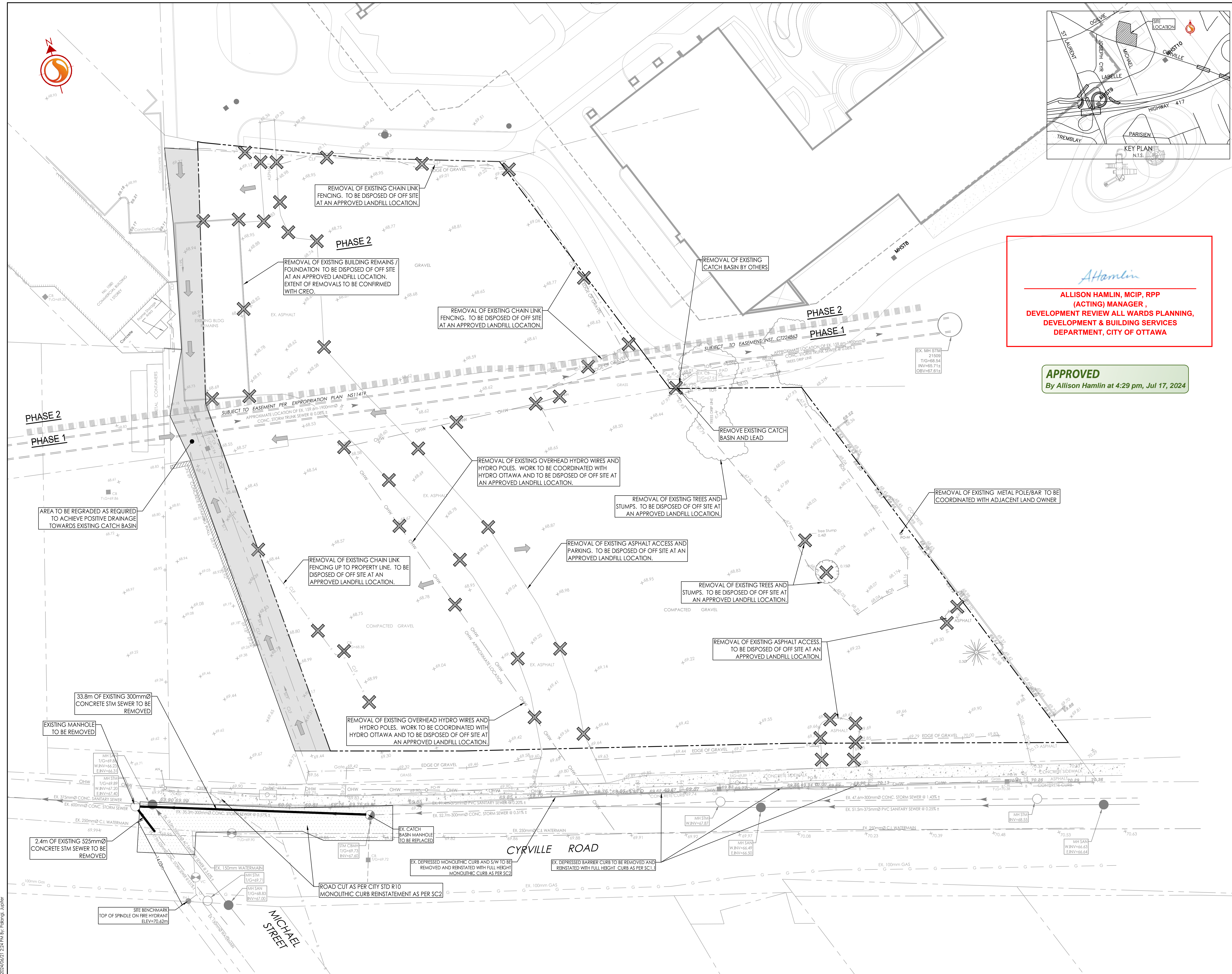

Allison Hamlin
**ALLISON HAMLIN, MCIP, RPP
(ACTING) MANAGER,
DEVELOPMENT REVIEW ALL WARDS PLANNING,
DEVELOPMENT & BUILDING SERVICES
DEPARTMENT, CITY OF OTTAWA**

APPROVED
By Allison Hamlin at 4:29 pm, Jul 17, 2024

W:\Projects\160401672 Design\Drawings\160401672.Dwg
 2024/07/17 14:06:16
 2024/07/17 14:06:16
 2024/07/17 14:06:16
 ORIGINAL SHEET - ARCH D