

Legend

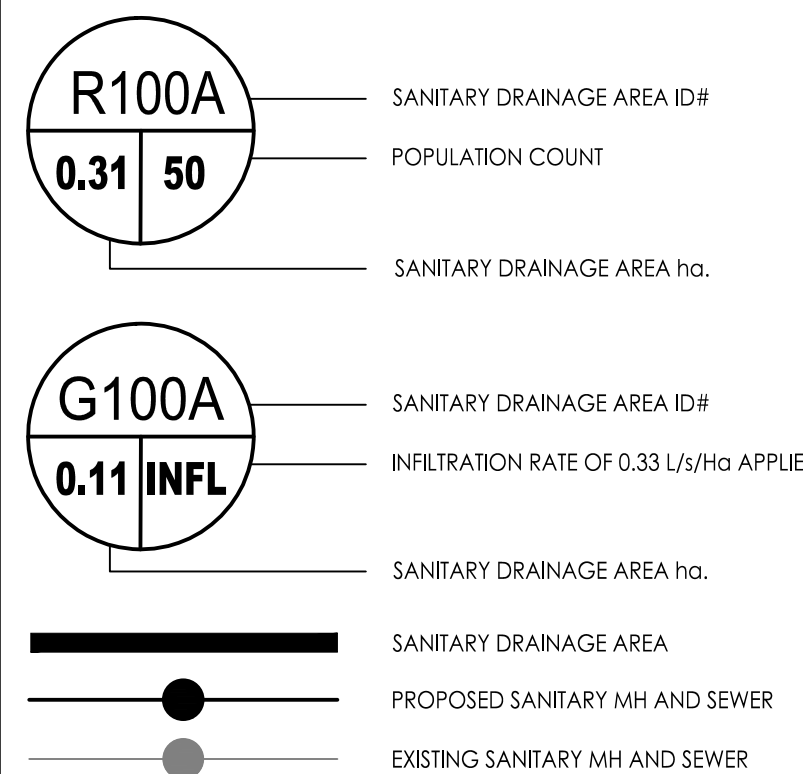

Notes

**SANITARY STATS**

**BUILDING A**

71 - 1 BEDROOM UNITS @ 1.4 PPU = 98 PEOPLE  
127 - 2 BEDROOM UNITS @ 2.1 PPU = 267 PEOPLE  
5 - 3 BEDROOM UNITS @ 3.1 PPU = 16 PEOPLE  
6 - STUDIO UNITS @ 1.4 PPU = 8 PEOPLE

**BUILDING B**

77 - 1 BEDROOM UNITS @ 1.4 PPU = 108 PEOPLE  
78 - 2 BEDROOM UNITS @ 2.1 PPU = 164 PEOPLE  
2 - TOWNHOUSES @ 2.7 PPU = 5

TOTAL POPULATION = 667

8	ISSUED FOR SPA	JP	PM	24.01.26
7	ISSUED FOR SPA	JP	PM	23.12.22
6	ISSUED FOR SPA	JP	PM	23.11.29
5	ISSUED FOR SPA	JP	DT/PM	23.10.08
4	ISSUED FOR SPA	JP	DT	23.09.01
3	ISSUED FOR SPA	JP	DT	23.02.27
2	ISSUED FOR SPA	JP	DT	22.11.29
1	ISSUED FOR SPA	JP	DT	22.05.25
0	ISSUED FOR SPA	MJS	DT	21.11.22
Revision		By	Appd.	YY.MM.DD

File Name:	160401672.DB	MJS	DT	MJS	21.09.22
		Dwn.	Chkd.	Dgn.	YY.MM.DD

Permit-Seal

Client/Project  
WESTRICH PACIFIC CORP.

MULTI-FAMILY RESIDENTIAL DEVELOPMENT  
1125-1149 CYRVILLE ROAD  
OTTAWA, ON, CANADA

Title  
SANITARY DRAINAGE AREA PLAN

Project No.	160401672	Scale	0 2.5 7.5 12.5m
Drawing No.	SA-1	Sheet	7 of 7
		Revision	8

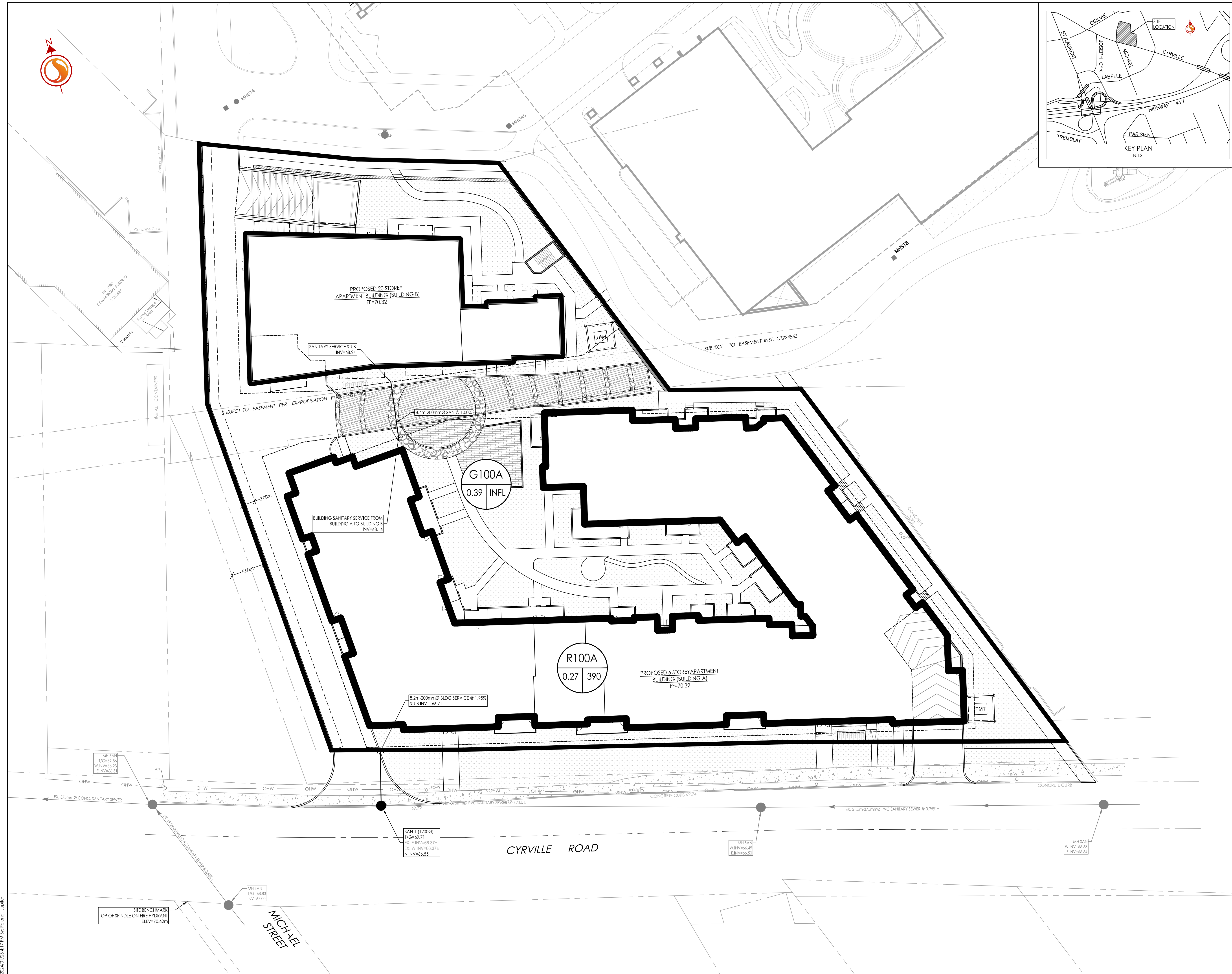

W:\Projects\160401672 Design\Drawings\160401672.Dwg  
 2024/07/26 4:17 PM  
 2024/07/26 4:17 PM  
 ORIGINAL SHEET - ARCH-D

D07-12-21-0214