

Copyright Reserved
The Contractor shall verify and be responsible for all dimensions. DO NOT scale the drawing - any errors or omissions shall be reported to Stantec without delay.
The Copyrights to all designs and drawings are the property of Stantec. Reproduction or use for any purpose other than that authorized by Stantec is forbidden.

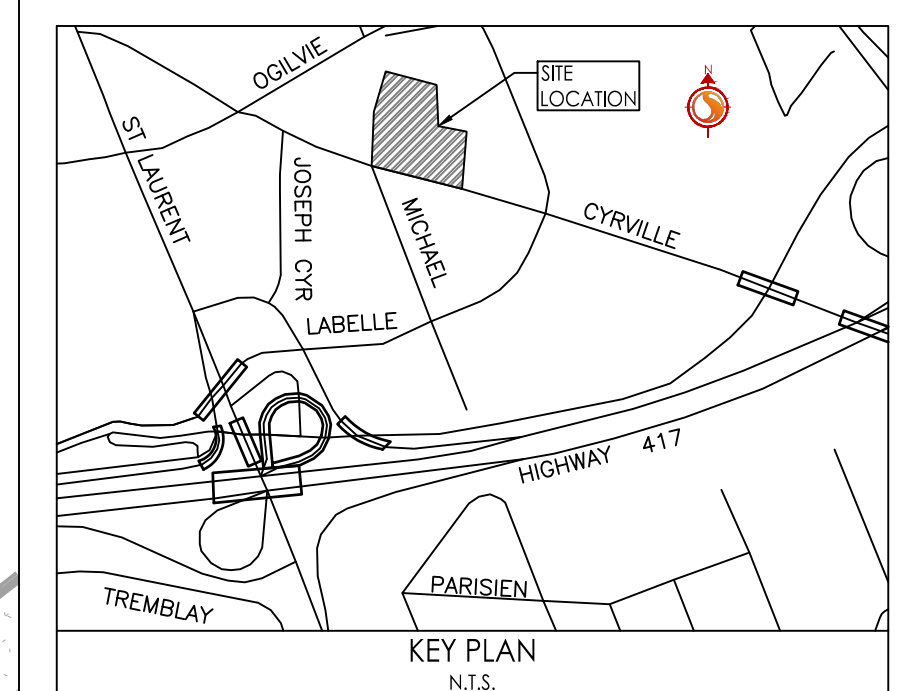

- Legend**
- R100A** SANITARY DRAINAGE AREA ID#
 - 0.31 50** POPULATION COUNT
 - SANITARY DRAINAGE AREA ha.
 - G100A** SANITARY DRAINAGE AREA ID#
 - 0.11 INFL** INFILTRATION RATE OF 0.33 L/s/ha APPLIED
 - SANITARY DRAINAGE AREA ha.
 - SANITARY DRAINAGE AREA
 - PROPOSED SANITARY MH AND SEWER
 - EXISTING SANITARY MH AND SEWER

Notes

SANITARY STATS

BUILDING A

71 - 1 BEDROOM UNITS @ 1.4 PPU = 98 PEOPLE
127 - 2 BEDROOM UNITS @ 2.1 PPU = 267 PEOPLE
5 - 3 BEDROOM UNITS @ 3.1 PPU = 16 PEOPLE
6 - STUDIO UNITS @ 1.4 PPU = 8 PEOPLE

BUILDING B

77 - 1 BEDROOM UNITS @ 1.4 PPU = 108 PEOPLE
78 - 2 BEDROOM UNITS @ 2.1 PPU = 164 PEOPLE
2 - TOWNHOUSES @ 2.7 PPU = 5

TOTAL POPULATION = 667

Revision	By	Appd.	YY.MM.DD
14	JP	PM	24.04.20
13	JP	PM	24.05.24
12	JP	PM	24.05.06
11	JP	PM	24.04.19
10	JP	PM	24.04.09
9	JP	PM	24.02.01
8	JP	PM	24.01.26
7	JP	PM	23.12.22
6	JP	PM	23.11.29
5	JP	DT/PM	23.10.08
4	JP	DT	23.09.01
3	JP	DT	23.02.27
2	JP	DT	22.11.29
1	JP	DT	22.05.25
0	MJS	DT	21.11.22

File Name:	MJS	DT	MJS	21.09.22
160401672.DB	Dwn.	Chkd.	Dgn.	YY.MM.DD

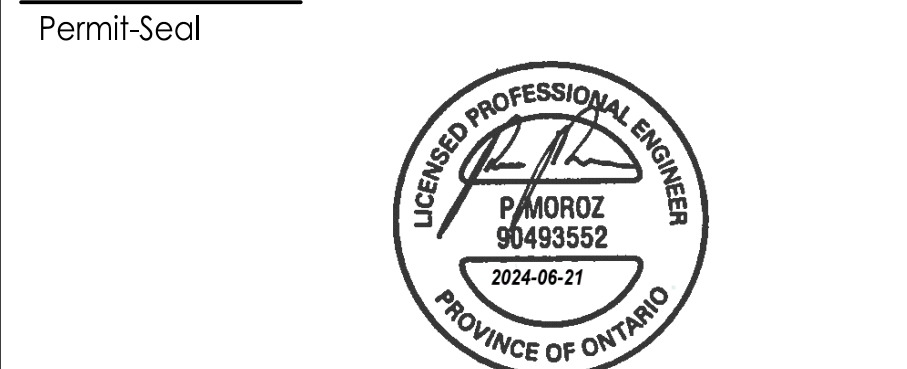

Client/Project
WESTRICH PACIFIC CORP.

MULTI-FAMILY RESIDENTIAL DEVELOPMENT
1125-1149 CYRVILLE ROAD
OTTAWA, ON, CANADA

Title
SANITARY DRAINAGE AREA PLAN

Project No. 160401672	Scale 1:250	Sheet 7 of 10	Revision 14
--------------------------	----------------	------------------	----------------

Allison Hamlin
ALLISON HAMLIN, MCIP, RPP
(ACTING) MANAGER,
DEVELOPMENT REVIEW ALL WARDS PLANNING,
DEPARTMENT & BUILDING SERVICES
DEPARTMENT, CITY OF OTTAWA

APPROVED
By Allison Hamlin at 4:30 pm, Jul 17, 2024

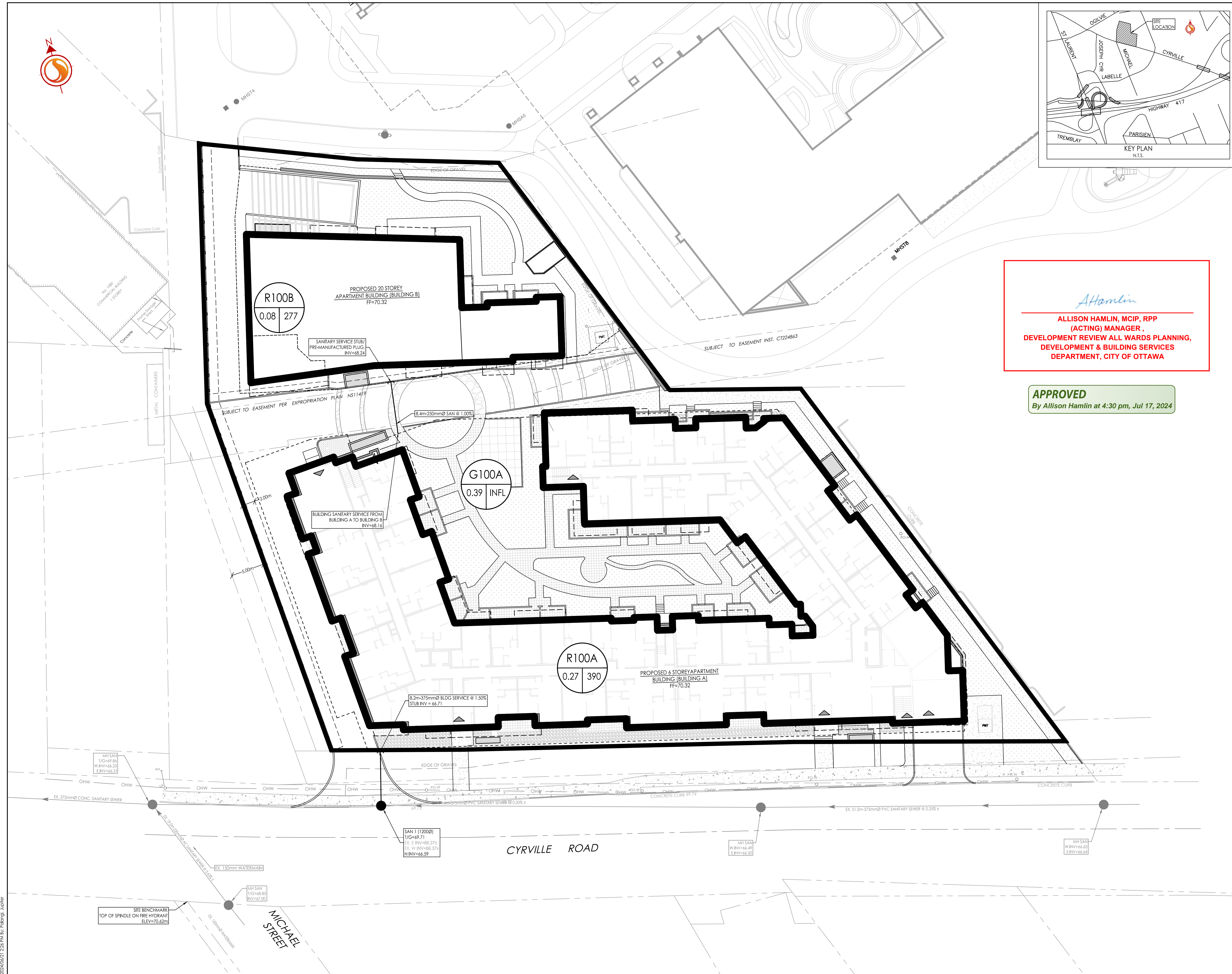

W:\Projects\160401672 Design\Drawings\160401672.Dwg
 2024/07/23 10:16:16 AM
 2024/07/23 10:16:16 AM
 ORIGINAL SHEET - ARCH D

D07-12-21-021.4