

P2 FLOOR - 53 PARKING STALLS

P2 FLOOR - 129 PARKING STALL

CYRVILLE ROAD

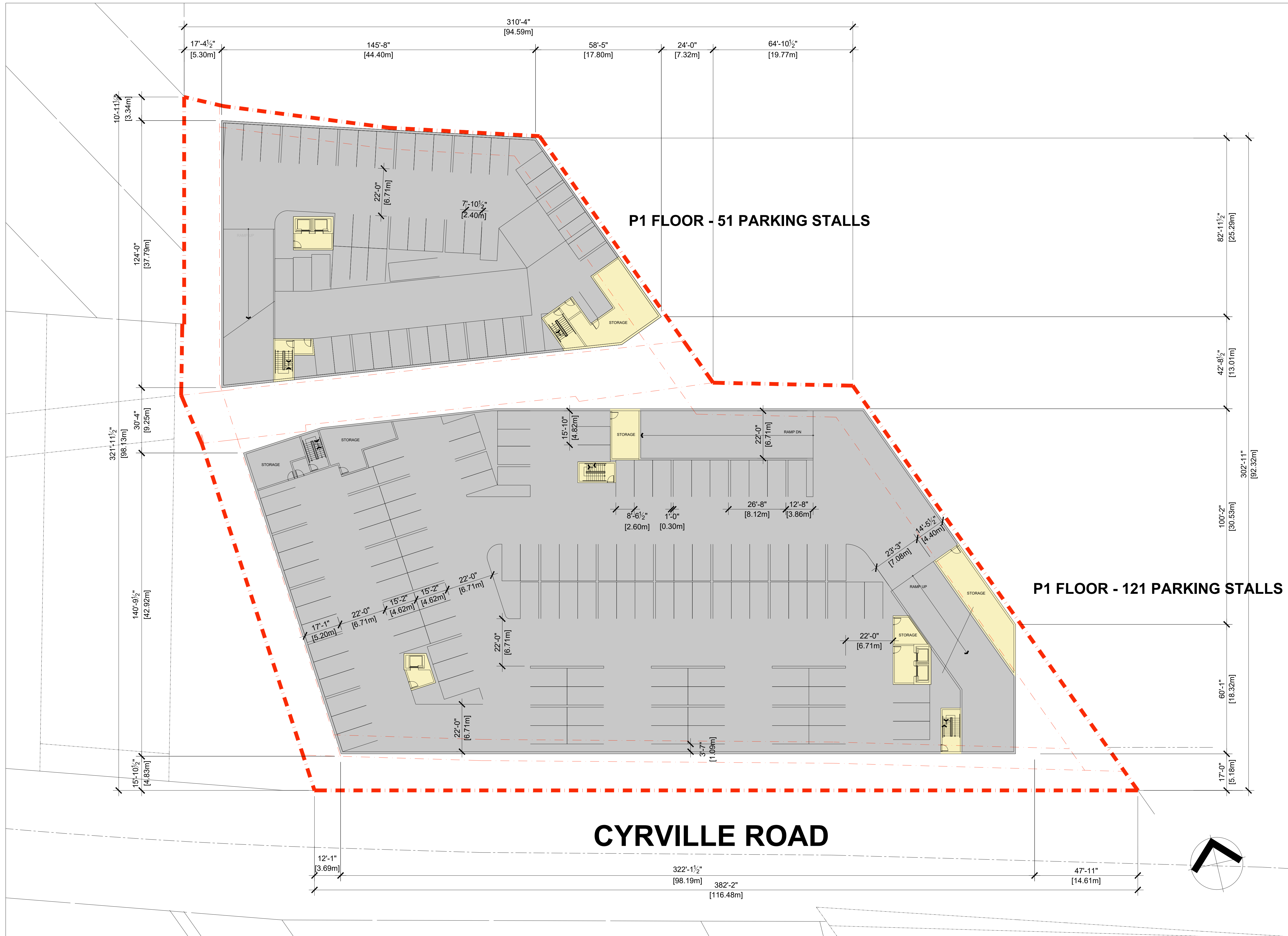

Copyright reserved. This plan and design are and at all times remain the exclusive property of J+S Architect Inc and may not be used or reproduced without their consent.

NO.	REVISIONS	DATE(D/M/Y)

PROJECT:
MULTI-FAMILY RESIDENTIAL DEVELOPMENT
 1125-1149 Cyrville Road, Ottawa, ON



SCALE: 1:150
 DATE: 06/08/2021
 DRAWN BY:
 CHECKED BY:
 JOB NO:
 2021-010
 SHEET TITLE:

SEAL:

BUILDING A & B P1 FLOOR PLAN