

Legend

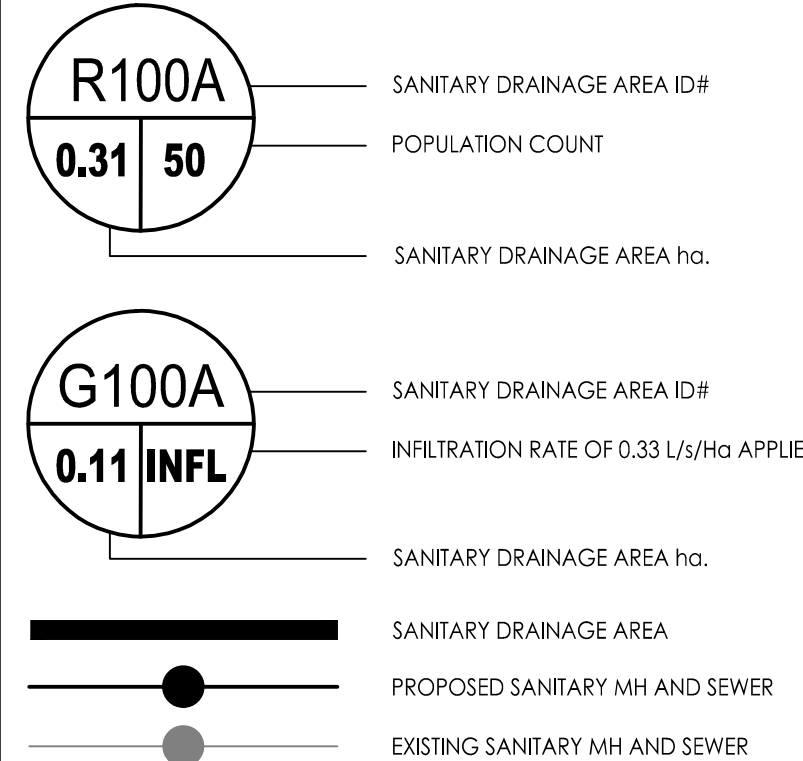

Notes

SANITARY STATS

BUILDING A
71 - 1 BEDROOM UNITS @ 1.4 PPU = 98 PEOPLE
127 - 2 BEDROOM UNITS @ 2.1 PPU = 267 PEOPLE
5 - 3 BEDROOM UNITS @ 3.1 PPU = 16 PEOPLE
6 - STUDIO UNITS @ 1.4 PPU = 8 PEOPLE

BUILDING B
77 - 1 BEDROOM UNITS @ 1.4 PPU = 108 PEOPLE
78 - 2 BEDROOM UNITS @ 2.1 PPU = 164 PEOPLE
2 - TOWNHOUSES @ 2.7 PPU = 5

TOTAL POPULATION = 667

6	ISSUED FOR SPA	JP	PM	23.11.29
5	ISSUED FOR SPA	JP	DT/PM	23.10.08
4	ISSUED FOR SPA	JP	DT	23.09.01
3	ISSUED FOR SPA	JP	DT	23.02.27
2	ISSUED FOR SPA	JP	DT	22.11.29
1	ISSUED FOR SPA	JP	DT	22.05.25
0	ISSUED FOR SPA	MJS	DT	21.11.22
Revision		By	Appd.	YY.MM.DD

File Name:	160401672.DB	MJS	DT	MJS	21.09.22
		Dwn.	Chkd.	Dsgn.	YY.MM.DD

Permit-Seal



Client/Project
WESTRICH PACIFIC CORP.

MULTI-FAMILY RESIDENTIAL DEVELOPMENT
1125-1149 CYRVILLE ROAD
OTTAWA, ON, CANADA

Title
SANITARY DRAINAGE AREA PLAN

Project No.	160401672	Scale	0 2.5 7.5 12.5m 1:250
Drawing No.	SA-1	Sheet	7 of 7
		Revision	5

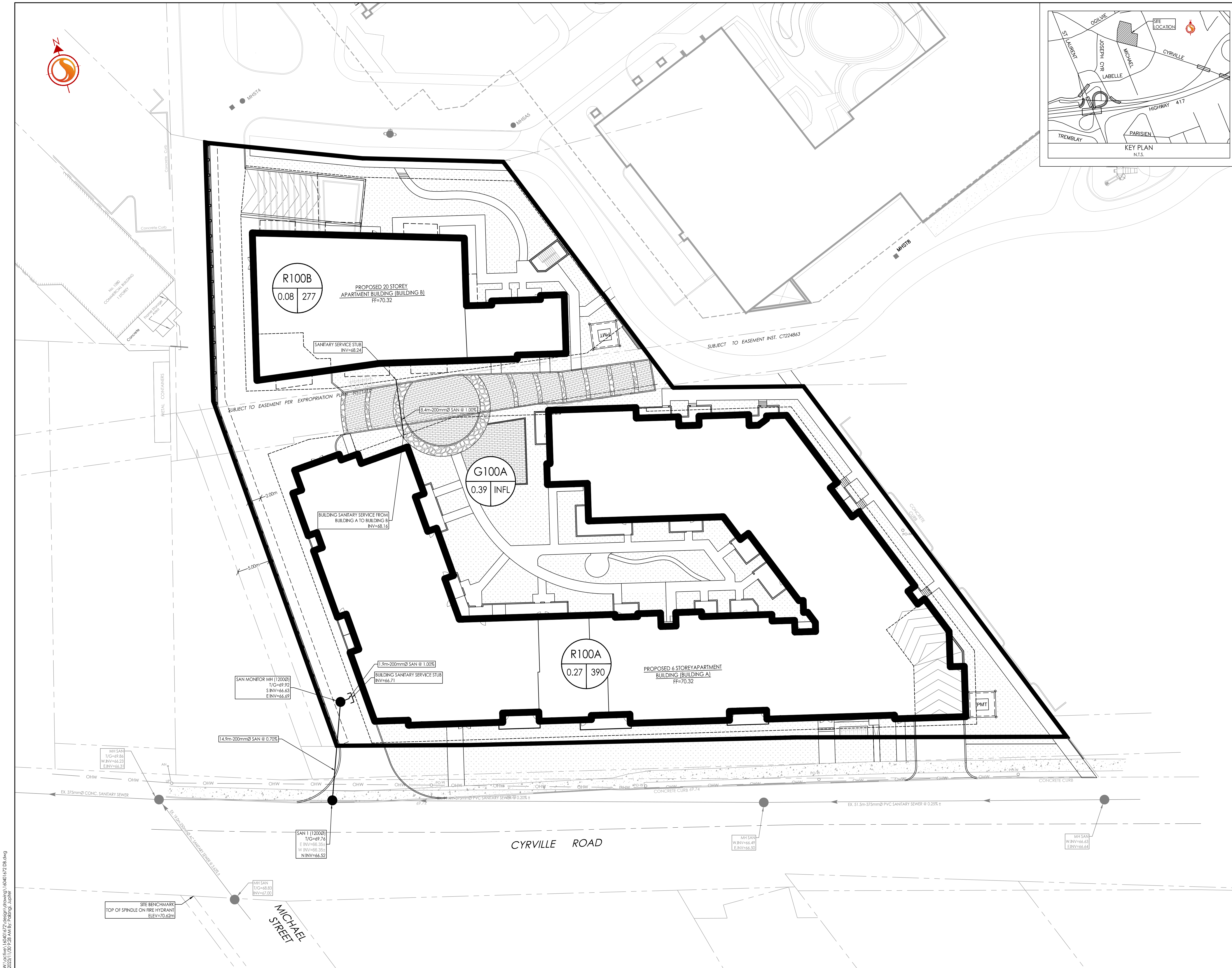

W:\Projects\160401672\Design\Drawings\160401672.Dwg
 2023/11/29 10:58 AM 67/1000000
 ORIGINAL SHEET - ARCH D

D07-12-21-0214