

**SECTION A-A**

NOTE:  
A All dimensions are in millimetres unless otherwise shown.

ONTARIO PROVINCIAL STANDARD DRAWING Nov 2015 Rev 2

**LIGHT-DUTY SILT FENCE BARRIER**

OPSD 219.110

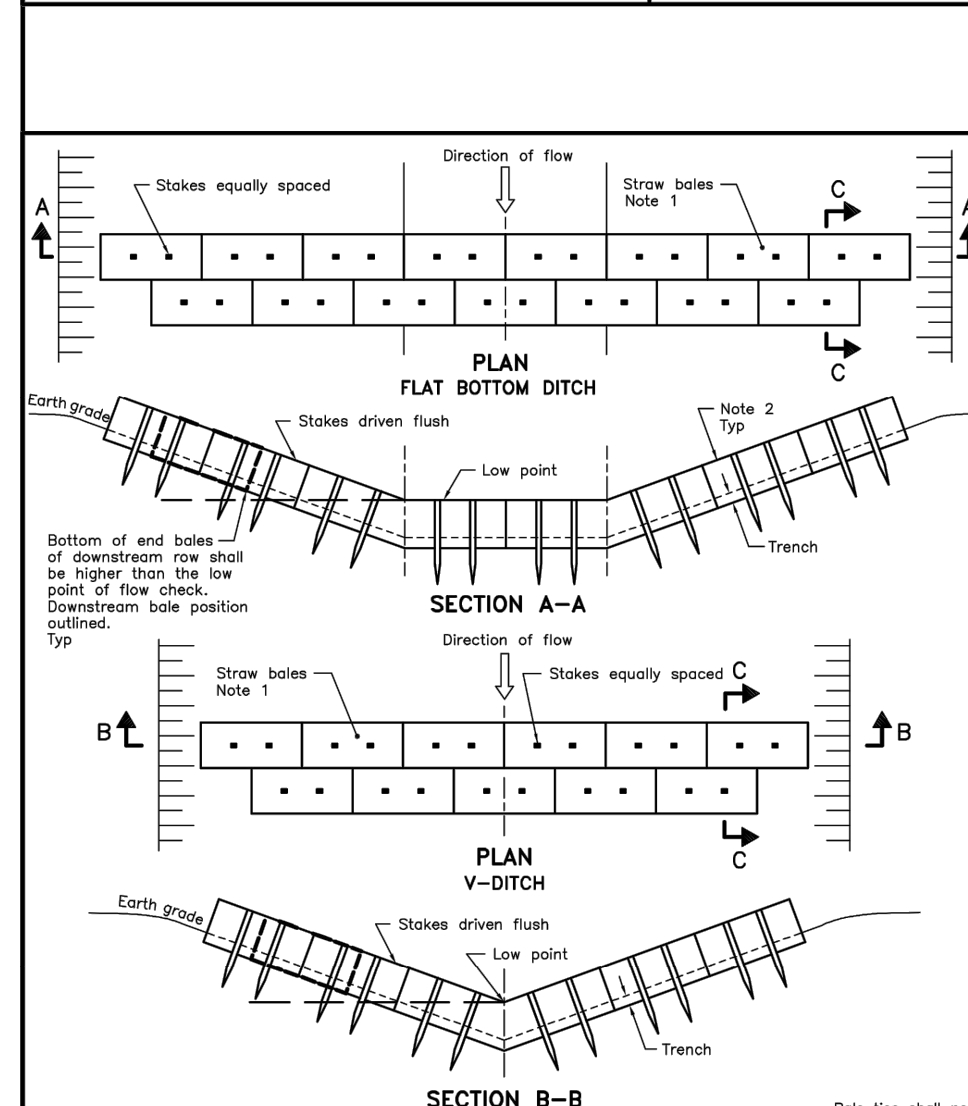

**SECTION A-A**

**SECTION B-B**

NOTE:  
1 Number of bales varies and shall suit ditch.  
2 Straw bales shall be butted tightly against adjoining bales and shaped to conform to the sides of the ditch to prevent water flow through barrier.

ONTARIO PROVINCIAL STANDARD DRAWING Nov 2015 Rev 2

**STRAW BALE FLOW CHECK DAM**

OPSD 219.180

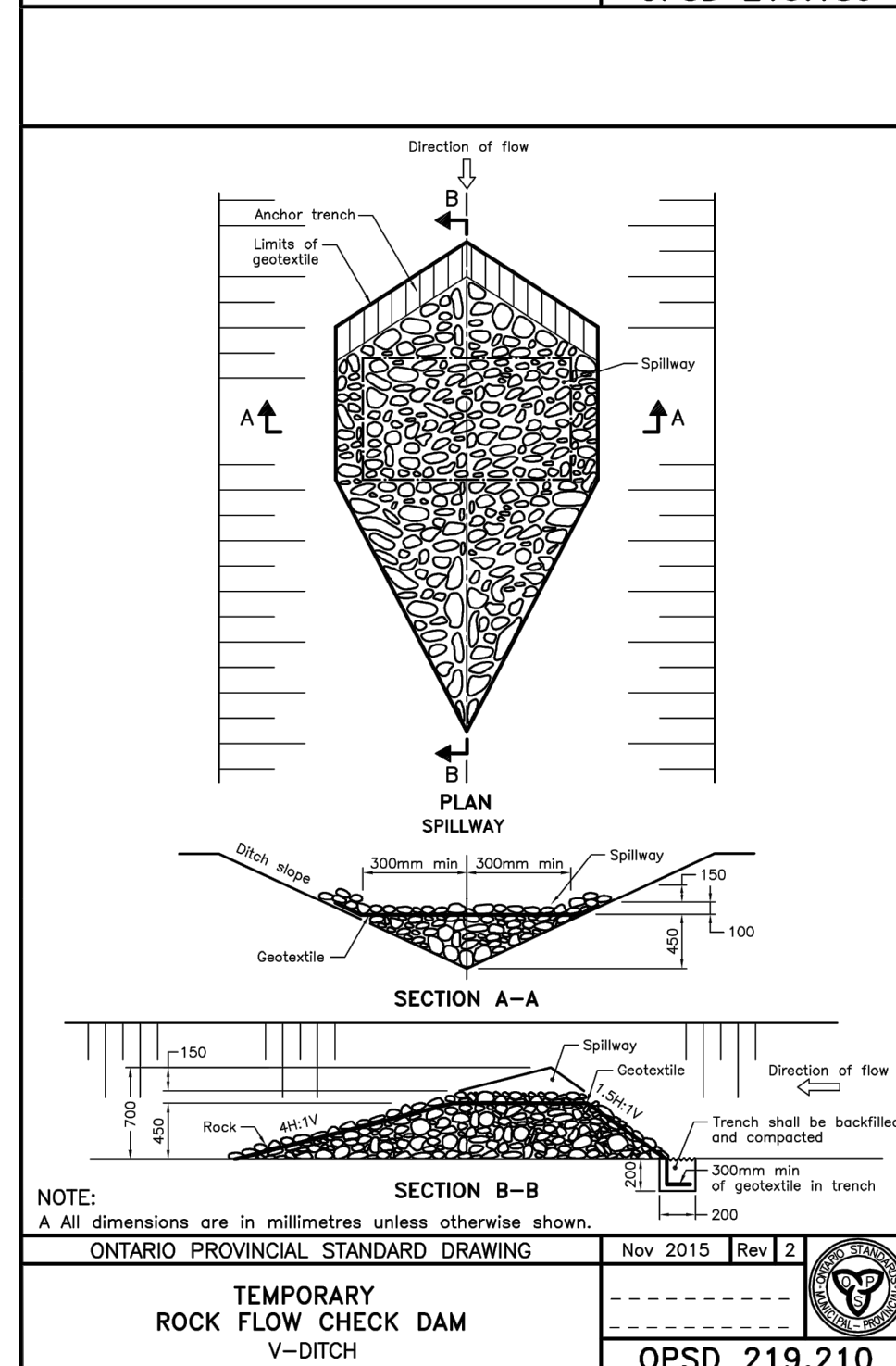

**SECTION A-A**

**SECTION B-B**

NOTE:  
A All dimensions are in millimetres unless otherwise shown.

ONTARIO PROVINCIAL STANDARD DRAWING Nov 2015 Rev 2

**TEMPORARY ROCK FLOW CHECK DAM V-DITCH**

OPSD 219.210

- NOTES:**
- THE CONTRACTOR SHALL IMPLEMENT BEST MANAGEMENT PRACTICES, TO PROVIDE FOR PROTECTION OF THE AREA DRAINAGE SYSTEM AND THE RECEIVING WATERCOURSE, DURING CONSTRUCTION ACTIVITIES. THE CONTRACTOR ACKNOWLEDGES THAT FAILURE TO IMPLEMENT APPROPRIATE EROSION AND SEDIMENT CONTROL MEASURES MAY BE SUBJECT TO PENALTIES IMPOSED BY ANY APPLICABLE REGULATORY AGENCY.
  - SILT FENCE TO BE ERECTED PRIOR TO EARTH WORKS BEING COMMENCED. SILT FENCE TO BE MAINTAINED UNTIL VEGETATION IS ESTABLISHED OR UNTIL START OF SUBSEQUENT PHASE.
  - SILT SACK TO BE PLACED AND MAINTAINED UNDER COVER OF ALL CATCHBASINS. GEOTEXTILE SILT SACK IN STREET CBs TO REMAIN UNTIL ALL CURBS ARE CONSTRUCTED. GEOTEXTILE FABRIC IN RYCBs TO REMAIN UNTIL VEGETATION IS ESTABLISHED. ALL CATCHBASINS TO BE REGULARLY INSPECTED AND CLEANED, AS NECESSARY, UNTIL SOD AND CURBS ARE CONSTRUCTED.
  - WORKS NOTED ABOVE ARE TO BE INSTALLED, INSPECTED, MAINTAINED AND ULTIMATELY REMOVED BY SERVICING CONTRACTOR.
  - THIS IS A "LIVING DOCUMENT" AND MAY BE MODIFIED IN THE EVENT THE PROPOSED CONTROL MEASURES ARE INSUFFICIENT
  - SEE DRAWING C-010 FOR ADDITIONAL DETAILS AND NOTES.

- LEGEND:**
- LIGHT DUTY SILT FENCE AS PER OPSD-219.110
  - SNOW FENCE
  - STRAW BALE CHECK DAM AS PER OPSD-219.180
  - ROCK CHECK DAM AS PER OPSD-219.210
  - SILT SACK PLACED UNDER EXISTING CB COVER
  - TEMPORARY MUD MAT 0.15m THICK 50mm CLEAR STONE ON NON WOVEN FILTER CLOTH

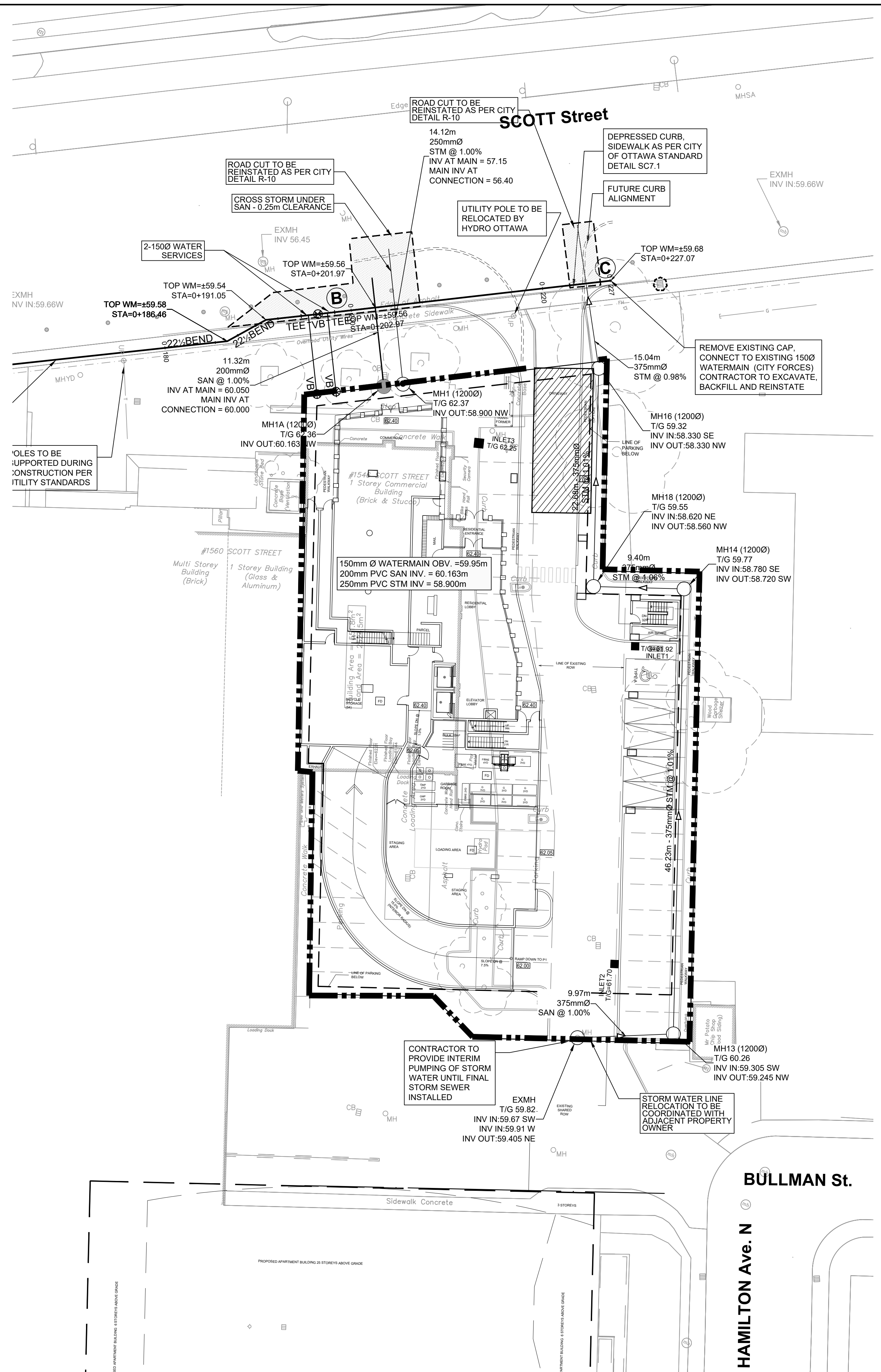

**CLIENT**

**REID'S**  
Heritage Properties

**COPYRIGHT**  
This drawing has been prepared solely for the intended use. Any reproduction or distribution for any purpose other than authorized by IBI Group is forbidden. Written dimensions shall have precedence over scaled dimensions. Contractors shall verify and be responsible for all dimensions and conditions on the job, and IBI Group shall be informed of any variations from the dimensions and conditions shown on the drawing. Shop drawings shall be submitted to IBI Group for general concurrence before proceeding with fabrication.

**IBI Group Professional Services (Canada) Inc.**  
is a member of the IBI Group of companies.

**ISSUES**

No.	DESCRIPTION	DATE
1	ISSUED FOR SPA	2021-11-24
2	REVISED PER CITY COMMENTS	2022-07-20
2	REVISED PER NEW SITE PLAN	2022-08-05

**KEY PLAN**

**CONSULTANTS**

**SCALE**

1:500

**SEAL**

LICENCED PROFESSIONAL ENGINEER  
J.D. K. Yarnopoulos  
2022/08/05  
PROVINCE OF ONTARIO

LICENCED PROFESSIONAL ENGINEER  
S.E. LABADIE  
100214983  
2022/08/05  
PROVINCE OF ONTARIO

**IBI GROUP**  
Suite 400 - 333 Preston Street  
Ottawa ON K1S 5N4 Canada  
Tel: 613 225 1311 / 613 241 3300 Fax: 613 225 9868  
ibigroup.com

**PROJECT**

**EVOKE**

1546 Scott Street, Ottawa

**PROJECT NO:**  
132902

**DRAWN BY:**  
D.D.

**CHECKED BY:**  
J.B.

**PROJECT MGR:**  
D.G.Y.

**APPROVED BY:**  
J.B.

**SHEET TITLE**

**EROSION AND SEDIMENT CONTROL PLAN**

**SHEET NUMBER**

**C-900**

**ISSUE**

**2**

**CITY PLAN No. 18666**

CITY FILE No. D02-02-21-0148  
Scale Check  
File Location: W:\132902\_1546\_Scott\_0\_Production\02\_Design\04\_Civil\Sheets\C-900 EROSION AND SEDIMENT CONTROL PLAN.dwg  
Last Saved: July 7, 2022, by ddore  
Plotted: Tuesday, August 16, 2022 9:51:38 AM by Samantha Labadie